

PALMIT FOUNTAIN No. 24

### SOVENTIX SA - DE AAR PHASE 3 SENSITIVITY MAP: SOLAR PV SITE & SUBSTATION

The development of a 400 MW solar photovoltaic (PV) facility and associated infrastructure (Phase 3) on the Remainder of Farm Goede Hoop 26C, Portion 3 of Farm Goede Hoop 26C and other properties, between De Aar & Hanover, Emthanjeni Local Municipality, Pixley Ka Seme District Municipality, Northern Cape Province, South Africa."

#### NOTES:

1. The full map extent is covered by the layer: Strategic Transmission Corridor (Central Corridor).
2. The full map extent is covered by the layer: Strategic Water Resource Area (De Aar Region).
3. The full map extent is covered by the layer: Important Bird and Biodiversity Areas.

#### Legend

- Secondary Road
- Railway Line
- Existing Distribution Line
- Proposed Distribution Line
- Application Site Property
- Solar PV Area & Fence
- Substation
- Farm Portion
- Parent Farm
- Phase 3 Sensitivity Layers**
- Proposed Borehole
- De-ionisation Plant
- Proposed Quarry
- Heritage Site
- Bat No-Go Area
- Avian 50m Watercourse Buffer
- Watercourse 20m Buffer
- Watercourse Delineation
- Large Impoundments (800m Buffer)
- Visual & Massing Buffer
- Terrestrial Sensitivity**
- High
- Medium
- Northern Cape CBA**
- Critical Biodiversity Area One
- Ecological Support Area

DATE: 06/12/2022  
 LOCAL AUTHORITY: EMTHANJENI LOCAL MUNICIPALITY  
 PLAN NUMBER: Ph3 Sensitivity Map Solar PV Site & Substation  
 SCALE: 1:20 000  
 PREPARED FOR: Ecologes Environmental Consultants  
 DRAWN: DIGITAL EARTH  
 linda@digitalearth.co.za  
 COORDINATE SYSTEM: GCS WGS 1984

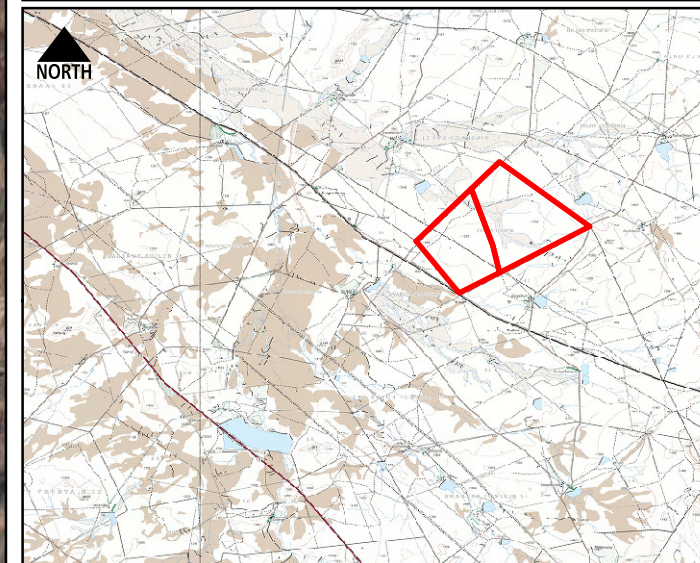

APPLICATION SITE

NGI\_TOPO50\_Mosaic\_DEC2015

