

- Manual safety shower with eye-wash.
- Louvers & ducts as per the mechanical eng's specifications.
- Line of roof overhang.
- Roller shutter fire door.
- Sampling & dispensing area.**
Floor Finish: Flowcrete, 9mm Flowfresh HF ESD (CR) resin floor screed with antistatic.
All bund walls to have a wall coving system.
High level louvre as per the mechanical eng's specifications.
New brickwork.
- Existing adjoining building.
Waterproof gap between old & new brickwork.
- Storage 1: Flammable Chemicals**
Isopropyl Alcohol = 270 units (240W x 290D) 6750Lts
Floor Finish: Flowcrete, 9mm Flowfresh HF ESD (CR) resin floor screed with antistatic.
All bund walls to have a wall coving system.
Screed to be laid to fall to sump.
150mm high rc up-stand above the ramp fill.
1000mm high stainless steel balustrades fixed to top of rc up-stand.
- Storage 2: Hazardous Chemicals**
88 units (240W x 290D) 2200Lts
Floor Finish: Flowcrete, 9mm Flowfresh HF ESD (CR) resin floor screed with antistatic.
All bund walls to have a wall coving system.
- A: Caustic = 10 x 25L = 250L
B: Nitric = 10 x 25L = 250L
C: Electrolyte = 8 x 25L = 200L
D: Chlorine dioxide = 60 x 25L = 1500L.

KEY:

- Man movement =
- Material movement =

GROUND STOREY FLOOR PLAN: 1:50

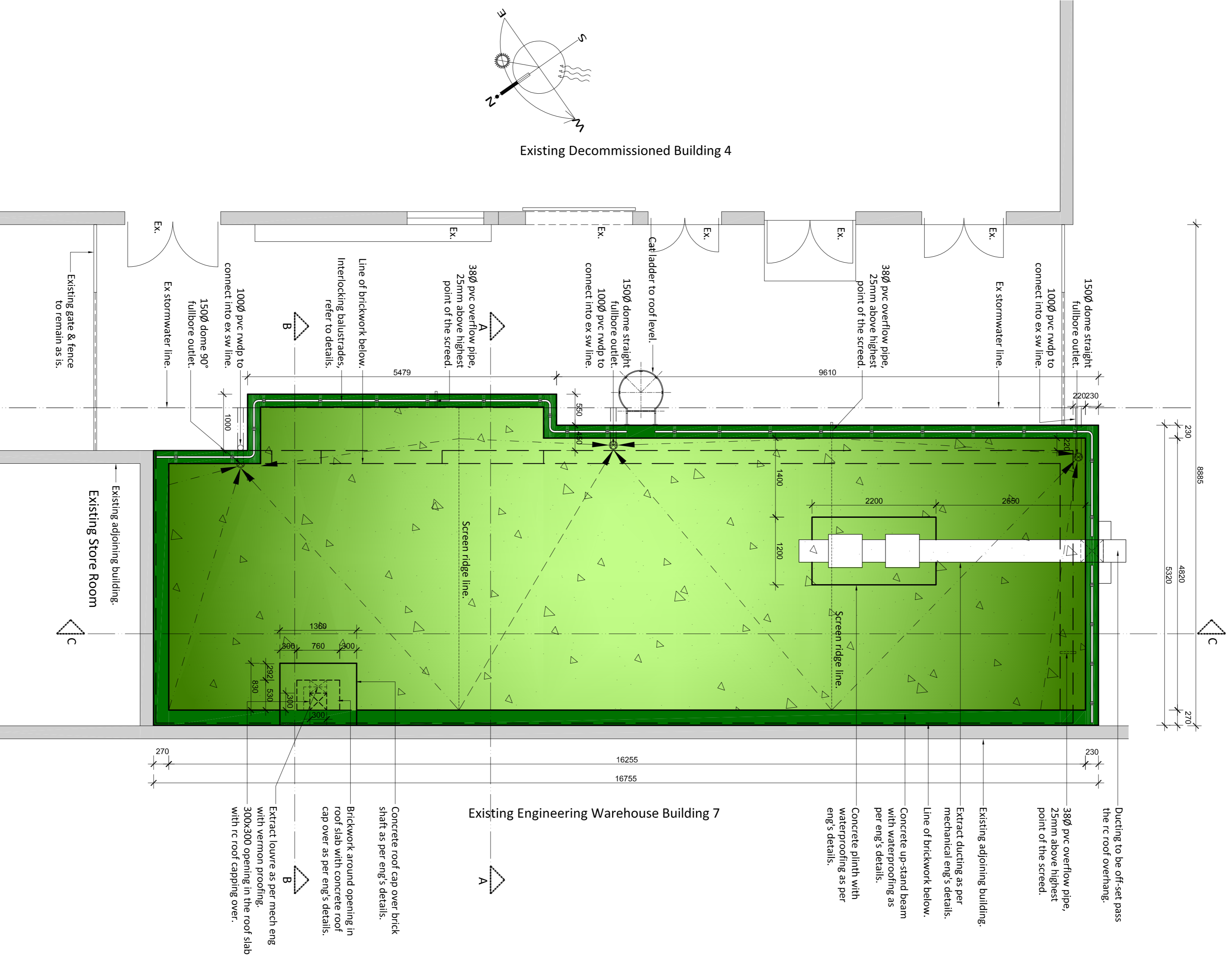

- During to be off-set pass the rc roof overhang.
- 38Ø pvc overflow pipe, 25mm above highest point of the screed.
- Existing adjoining building.
Extract ducting as per mechanical eng's details.
Line of brickwork below.
Concrete up-stand beam with waterproofing as per eng's details.
Concrete plinth with waterproofing as per eng's details.
- Existing Engineering Warehouse Building 7**
Concrete roof cap over brick shaft as per eng's details.
Brickwork around opening in roof slab with concrete roof cap over as per eng's details.
Extract louvre as per mech eng with vermin proofing.
300x300 opening in the roof slab with rc roof capping over.

ROOF PLAN: 1:50

<p>Kuppans Architectural Designs</p> <p>CONTRACT DETAILS: REF: 031_255_1838 TEL: 0835071487 CELL: 0835071487 Email: shervin@kadedesigns.co.za Address: 210 Floor, Master Builders Centre, 40 Essex Terrace, Westville Postal: P.O. Box 1274 Vredehoek, 7923 NAME: Shivu Kuppans & Vahmani (Pty) Ltd ID/CP No: ST023 & RV0202923</p>	<p>Client / Owners Details: Metboard (Properties Limited) Metboard (Properties Limited)</p>
<p>CONSULTANT: REFERENCE: 2014/02/06 Issued for Heritage approval DATE:</p>	<p>PROJECT TITLE: Proposed New Flammable Liquid Storage Area on Existing ERF 730, at 1474 South Coast Road, Mobeini</p>
<p>DRAWING NUMBER: 034_SK_1002</p>	<p>DRAWING TITLE: GROUND STOREY FLOOR PLAN AND ROOF PLAN</p>
<p>SCALE: 1:50 (A1)</p>	<p>DATE: 2014-03-06</p>
<p>ISSUED FOR: HERITAGE APPROVAL</p>	<p>ISSUED DATE: 2014-03-06</p>