

P.N.

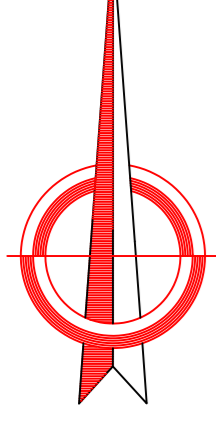

DETAIL 3

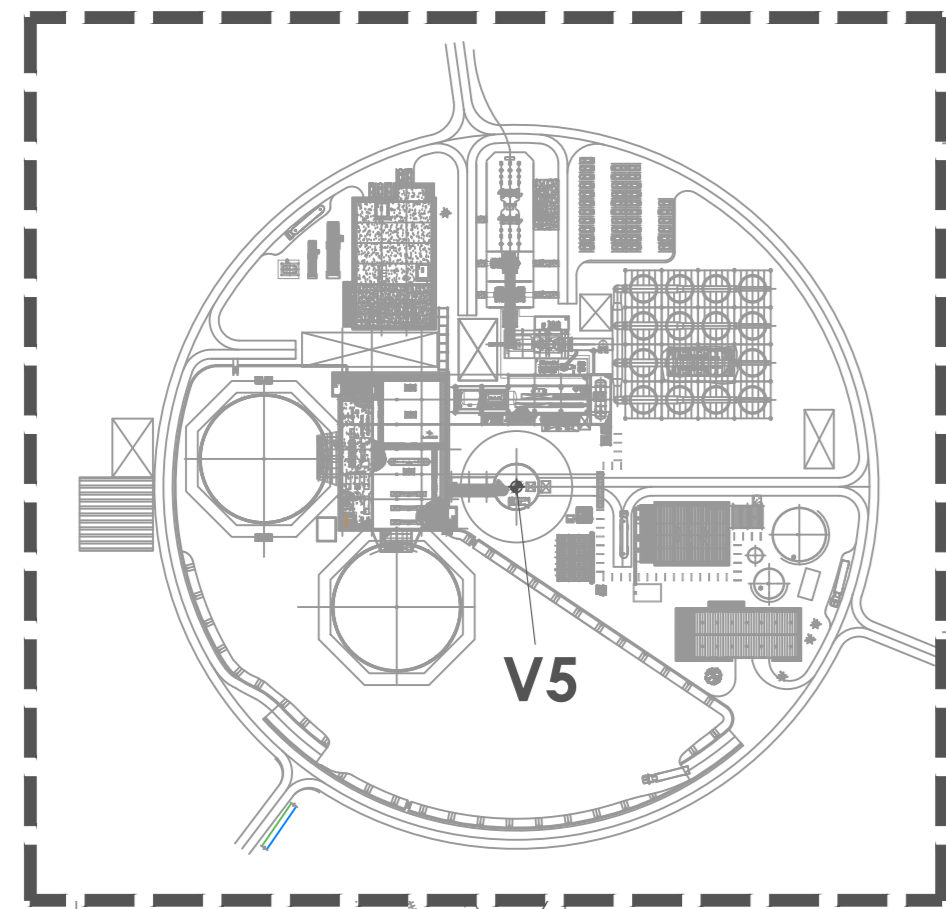

DETAIL 1

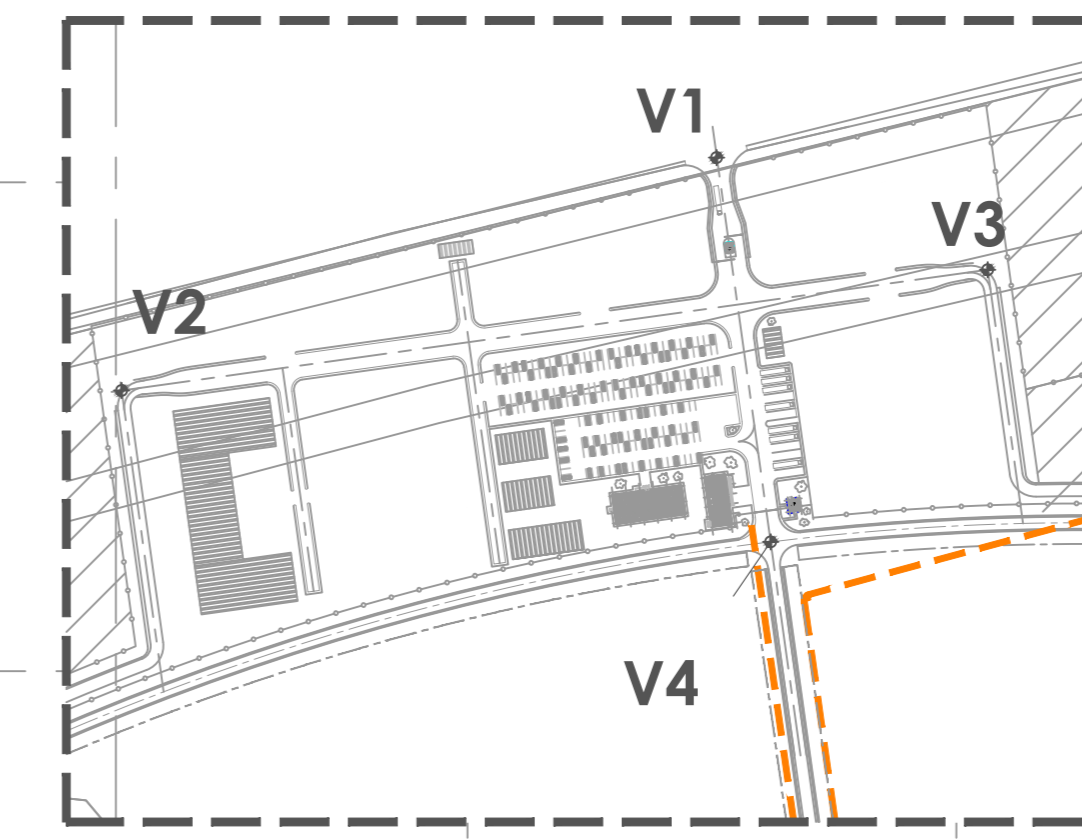

NOTES:

- 1. ARRANGEMENT OF ROADS, CABLEWAY AND PIPES SHOWN IN THIS DRAWING ARE PRELIMINARY AND WILL BE DEFINE LATER.
- 2. ALL UNITS REFERENCED IN THE PLAN ARE IN M.

LEGEND:

- 1 SOLAR FIELD
- 2 RAILWAY (50M BUFFER)
- 3 POWER BLOCK
- 4 ACCESS
- 5 MANCAMP OPTION (±1.5ha)
- 6 ROAD R-385
- 7 WATER PIPELINE ROUTE
- 8 WASTE WATER PIPELINE
- 9 EVAPORATION POND
- 10 PERIMETRAL ROAD
- 11 TRANSVERSAL ROAD
- 12 OVERHEAD LINE 132kV OHL
- 13 FACILITY METERING INSTALLATION
- 14 CABLES UP TO DELIVERY POINT
- 15 HERITAGE
- 16 OVERHEAD LINE 132kV OHL
- 17 PERIMETRAL FENCE
- 18 DUCT BANK
- 19 ADMINISTRATIVE BUILDING
- 20 VISITOR BUILDING
- 21 INTERNAL ROAD
- 22 HELIOSTAT MAINTENANCE PATHS

COORDINATES GAUSS CONFORM Lo. 23°(WGS84)

ACCESS		
VERTICE	Y	X
V1	-35807,1377	3130114,8612
V2	-35502,9314	3130233,9784
V3	-35945,7628	3130172,2352
V4	-35834,7867	3130311,3865
SOLAR RECEIVER TOWER		
VERTICE	Y	X
V5	-35995,9301	3131463,9280
EVAPORATION POND		
VERTICE	Y	X
V6	-34952,3380	3132885,1720
V7	-35260,7575	3133093,2080
V8	-35388,2490	3132904,1670
V9	-35079,8300	3132696,1580
HERITAGE PGS 06		
VERTICE	Y	X
V10	-34999,5060	3133324,8950
VAAL GAMAGARA CONNECTION		
VERTICE	Y	X
V11	-34933,8550	3133337,5331
PIPELINE		
VERTICE	Y	X
P1	-34215,267	3132370,0760
P2	-34261,2340	3132472,6310
P3	-34202,1370	3132563,9040
P4	-34343,0130	3132655,1460
P5	-34385,4440	3132745,5930
P6	-34437,0970	3132831,2330
P7	-34505,0240	3132903,7760
P8	-34577,5120	3132972,6690
P9	-34649,9980	3133041,5620
P10	-34722,4840	3133110,4550
P11	-34794,9690	3133179,3510
P12	-34867,4530	3133248,2150
P13	-34939,9360	3133317,1100
P14	-35015,1520	3133382,8740
P15	-35095,3440	3133442,4340
P16	-35180,1310	3133495,4210
P17	-35264,9450	3133548,4080

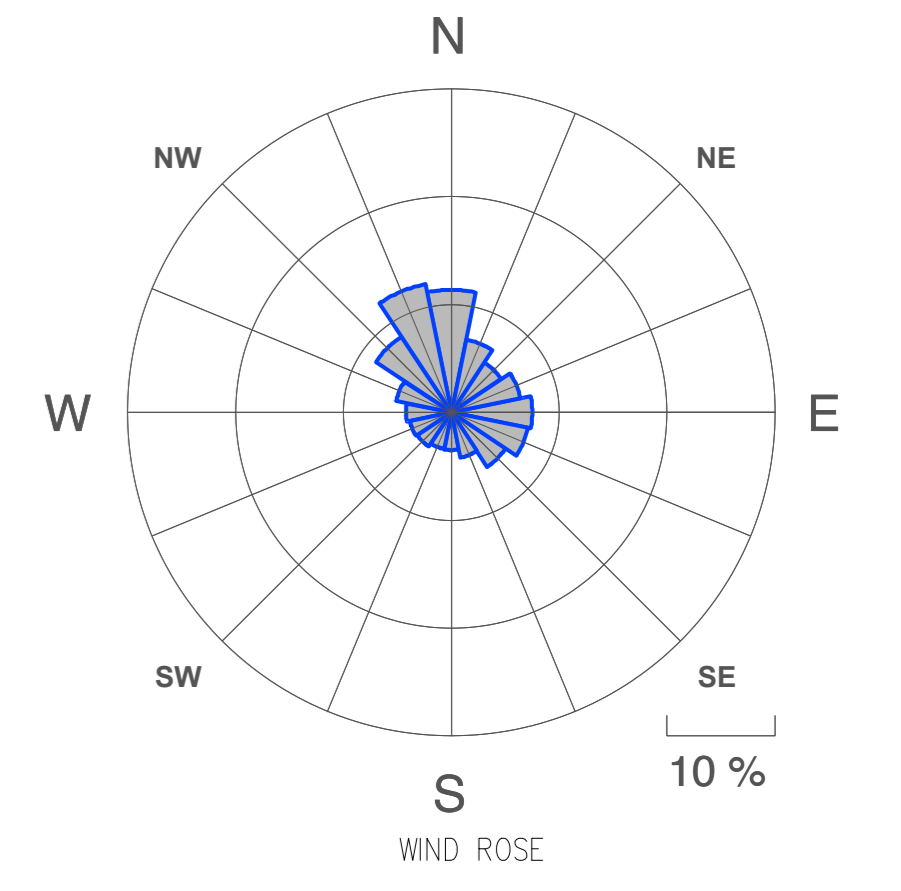

CR TOWER COORDINATES		
	Y (m)	X (m)
GAUSS CONFORM Lo. 23° (WGS84)	-35995,9301	3131463,928

COORDINATES OF PLANT BOUNDARY REDSTONE		
POINT	Y (m)	X (m)
A	-34979.93	3130318.39
B	-36347.35	3129978.25
C	-38152.63	3130908.85
D	-38213.33	3131269.11
E	-38165.5	3131445.77
F	-37814.27	3131826.32
G	-37632.98	3132179.22
H	-37287.32	3132035.18
J	-37163.52	3132340.3
K	-36995.76	3132591.78
L	-36814.69	3132741.56
M	-36814.69	3132887.14
N	-36787.39	3132888.43
P	-36554.81	3132888.63
Q	-36361.36	3132964.44
R	-36160.62	3133008.9
S	-35385.03	3133009.43
T	-35339.05	3133087.62
U	-35135.9	3133431.58
V	-35072.65	3133388.43
W	-35013.38	3133339.23
Y	-34542.63	3132908.55
X	-34487.72	3132850.87
Z	-34440.44	3132785.487
A1	-34403.32	3132716.49
B1	-34232.33	3132337.91

- FLOODPLAINS (50M BUFFER)
- MOUNTAIN WOODLAND (50M BUFFER)
- NON-PERENNIAL STREAMS (15M BUFFER)
- ROCKY OUTCROPS (50M BUFFER)
- SHRUBVELD PLAINS
- WOODLAND PLAINS & HILLS (50MBUFFER)

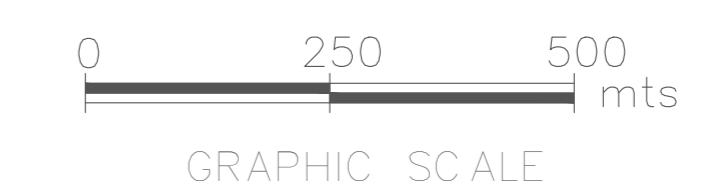

PROPRIETARY INFORMATION

This document contains proprietary information of Empresarios Agrupados Internacional S.A. and is to be used solely for the Project and the purpose for which it is furnished. It may not be disclosed to others for a different use without the written permission of Empresarios Agrupados Internacional S.A.

CONTAINS INFORMATION FOR THE DESIGN OF STRUCTURES SYSTEM OR COMPONENTS. YES  NO  VERIFICATION: NA  SUP.  VERIFIER L1  L2

OWNER <b>Acwa POWER</b> <b>SOLARRESERVE</b>	EPC CONTRACTOR <b>acciona</b>
PROJECT Concentrated Solar Power Redstone	
FORMAT <b>A0</b>	DRAWING TITLE GENERAL ARRANGEMENT
SCALE 1:7.500	DETA SUBMISSION REDSTONE LAYOUT
DRAWING N°	PROJECT N°
SUBCONTRACTOR N°	SHEET 1 OF 1

WORK COPY

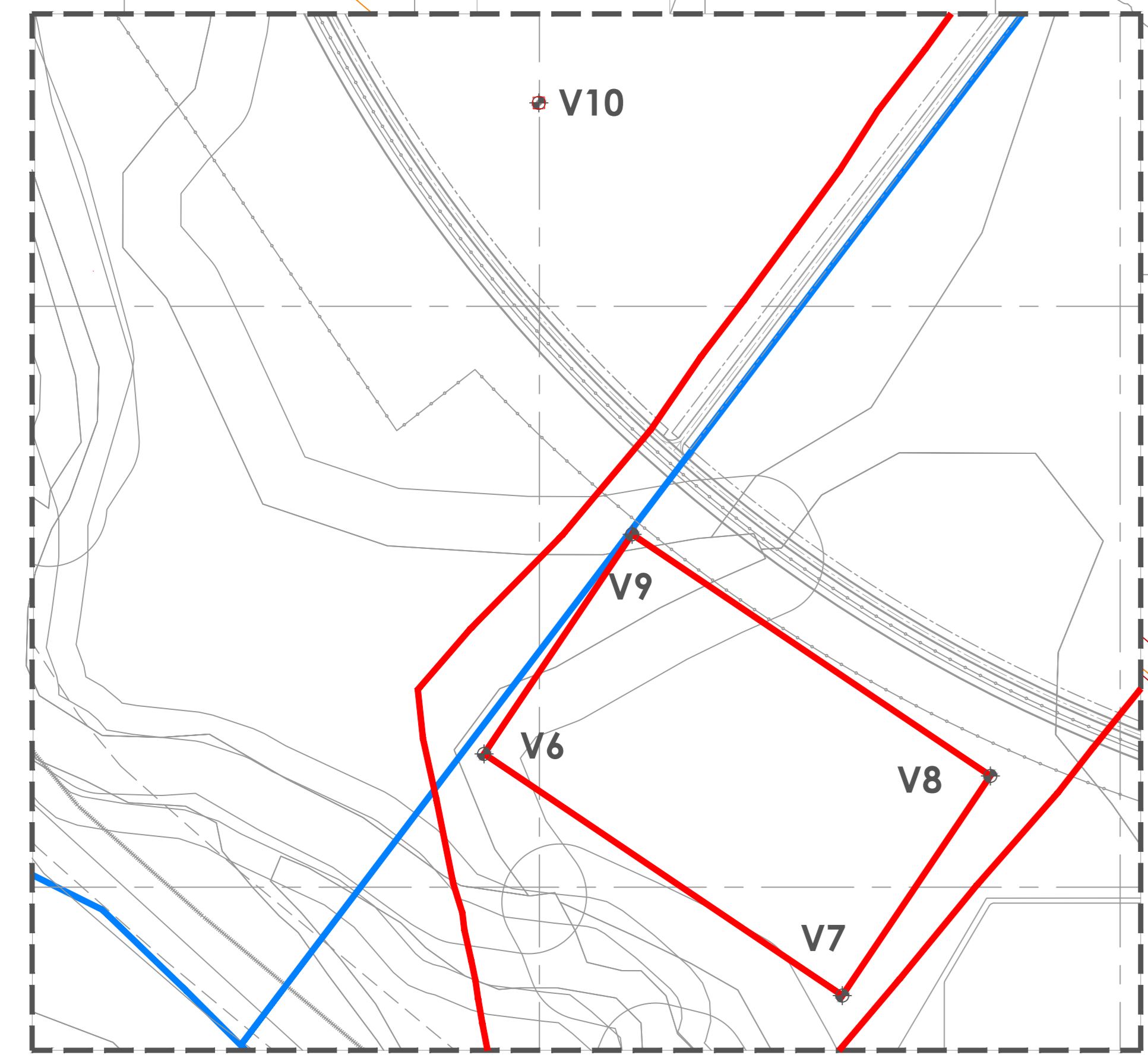

DETAIL 2

DETAIL 2

DETAIL 3

DETAIL 1

POWER BLOCK & SOLAR RECEIVER TOWER  
X = 3131463,928

132kV UNDERGROUND INSULATED CABLE (DIRECT BURIED)

PERIMETRAL FENCE

SITE PERIMETER SECURITY ROAD

HELIOSTATS EXCLUSION ZONE (TYP)

EXTERNAL FENCE

INTERNAL RING ROAD

HELIOSTAT COLLECTOR FIELD  
X = 3131629,9184

BUFFER 50M

N=3130500

N=3131000

N=3131500

N=3132000

N=3132500

N=3133000

E=350500

E=350500

E=350500

E=350500

E=350500

E=350500

E=350500

E=350500

E=350500