

APPENDIX 4:

PETROLEUM EXPLORATION WELL DRILLING APPLICATION AREA

APPENDIX 4.1:

REGULATION 2(2) PLAN OF THE WELL DRILLING ER APPLICATION AREA

**REGULATION 2(2) PLAN OF LAND
UNDER APPLICATION FOR AN
EXPLORATION RIGHT FOR OIL, GAS AND
NATURAL GAS**

PERMIT No. :
 PASA REFERENCE No. :
 SIGNATURE :
 DATE :
 CHIEF EXECUTIVE OFFICER PETROLEUM
 AGENCY SA : CAPE TOWN

APPLICANT:
 RHINO OIL & GAS EXPLORATION
 SOUTH AFRICA LTD
 SIGNATURE:
 DATE:

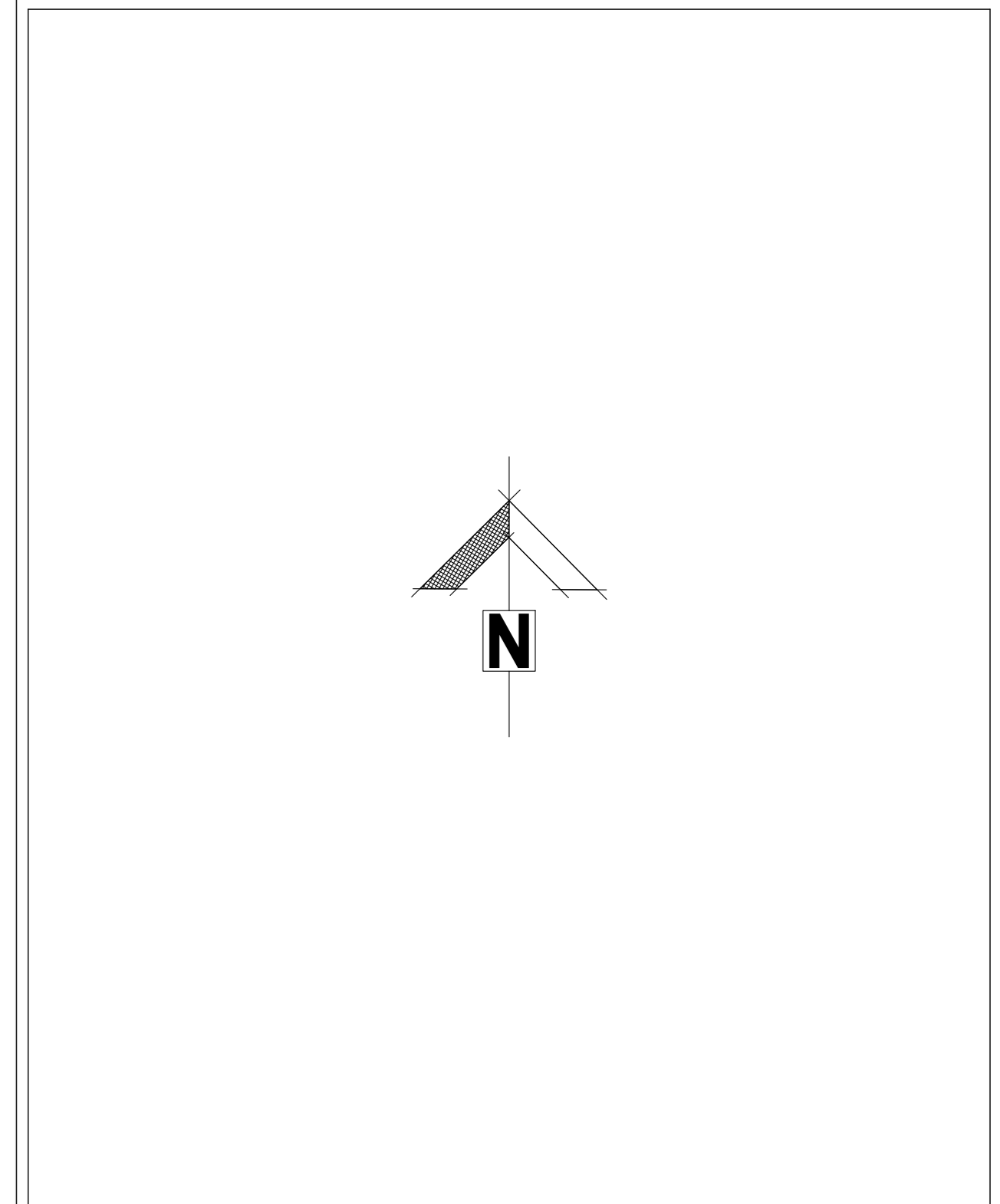

SCALE 1:250 000 (A0)



LEGEND

- denotes technical co-operation permit area
- denotes farm portion boundary
- denotes parent farms boundary
- denotes Administrative District boundary
- denotes Provincial boundary

AREA DESCRIPTION

The figure 1 to 31, middle of stream, 32, middle of stream, 33, middle of stream, 34, middle of stream, 35 to 139. Excluding the figure 140 to 142, middle of stream, 143, middle of stream, 144, middle of stream, 145, middle of stream, 146, and the figure 147 to 156, middle of stream, 157, and the figure 158 to 167, middle of stream, 168 to 174 represents 2647 farms and farm portions identified hereto together measuring approximately 6005 (six thousand and five) square kilometres of land situated partly in the Administrative Districts of Bothaville, Bultfontein, Kroonstad, Lindley, Odendaalsrus, Theunissen, Viljoenskroon, Welkom and Wesselsbron in the Province of Free State the subject of this application for a Technical Co-operation Permit in terms of Section 76 of the Mineral and Petroleum Resources Development Act 2002 (28 of 2002)

NOTES

1. All co-ordinates are in the Hartbeeshoek 94 datum - WGS77
2. All sides are thumb lines: i.e. lines of constant geographical direction.
3. This plan was framed from information provided by the Petroleum Agency SA and the Chief Surveyor General

Prepared by: R. C. ABRAHAMSE - PLS No. 0002
 Professional Land Surveyor

In accordance with Regulation 2(2) of the regulations in terms of the Mining Titles Registration Act, 16 of 1967, provided that the figure depicted and described on this plan, the area of the figure and the co-ordinates listed thereon are subject to change, as may be necessary, to conform to the requirements in respect of the definition of co-ordinated point, contained in regulation 3 of the regulations in terms of the Mining Titles Registration Act, 16 of 1967

PASA REFERENCE No. 12/2/108 & 109

Signature : *R. C. Abrahamse*

date	19 January 2022	
scale	1 / 250 000 (A0)	
drawing ref & no.	ER 318 (Rev. A)	(M.B.)
drawing no.	Free State Precinct (sheet 1 of 14)	

dh+a david hellig + abrahamse
 professional land surveyors
 2nd floor wale street chambers
 38 wale street, cape town
 Tel : +27 021 426 2613
 info@dhaa.co.za www.dhale.co.za

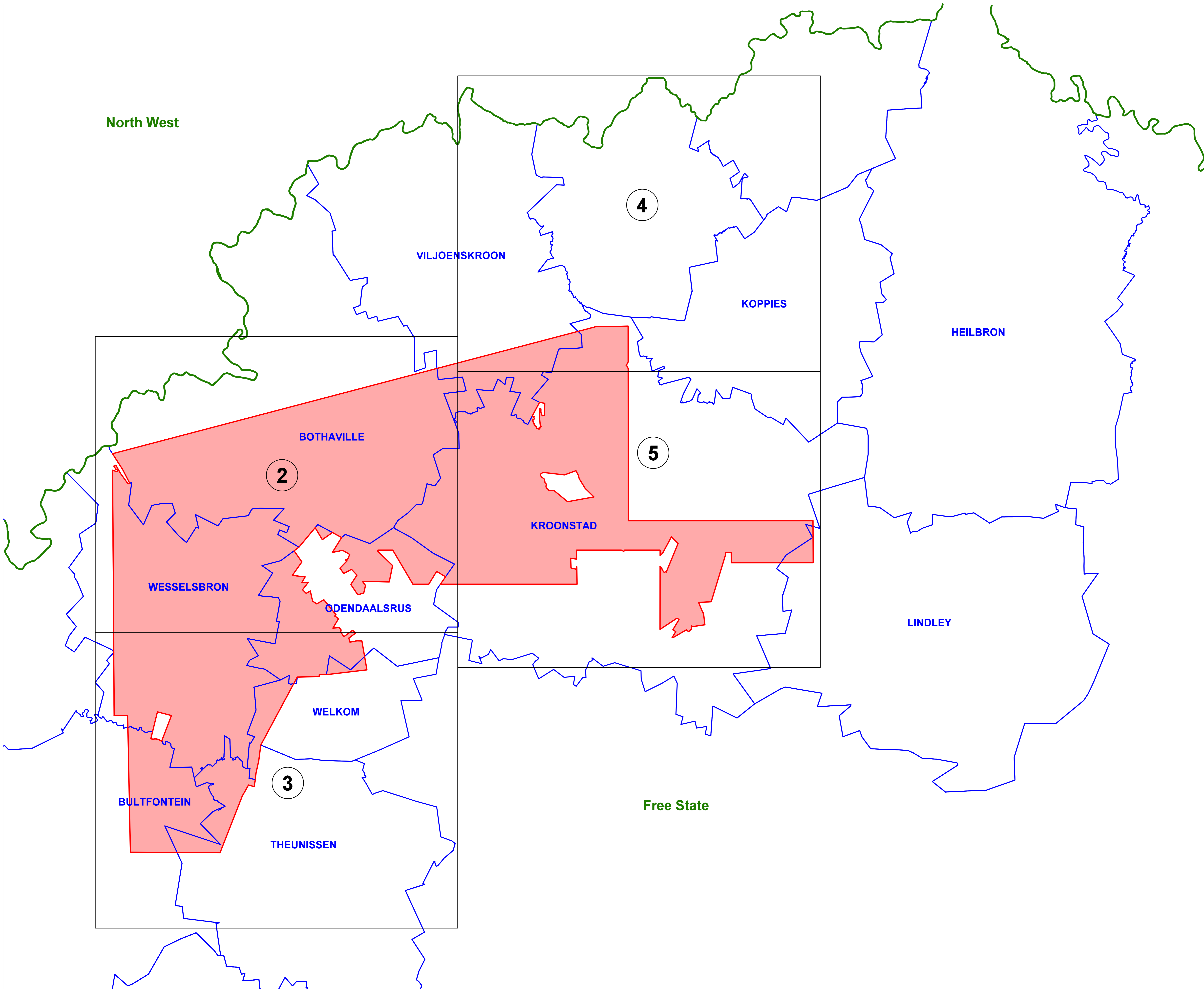

REGULATION 2(2) PLAN OF LAND UNDER APPLICATION FOR AN EXPLORATION RIGHT FOR OIL, GAS AND NATURAL GAS

PERMIT No. :
 PASA REFERENCE No. :
 SIGNATURE :
 DATE :
 CHIEF EXECUTIVE OFFICER PETROLEUM AGENCY SA : CAPE TOWN

APPLICANT: **RHINO OIL & GAS EXPLORATION SOUTH AFRICA LTD**

SIGNATURE :
 DATE:

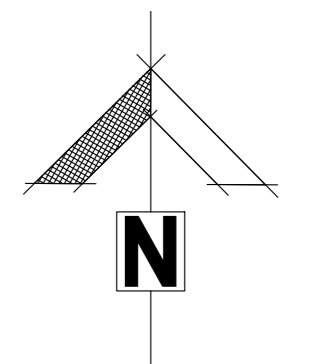

LOCALITY INSET (not to scale)

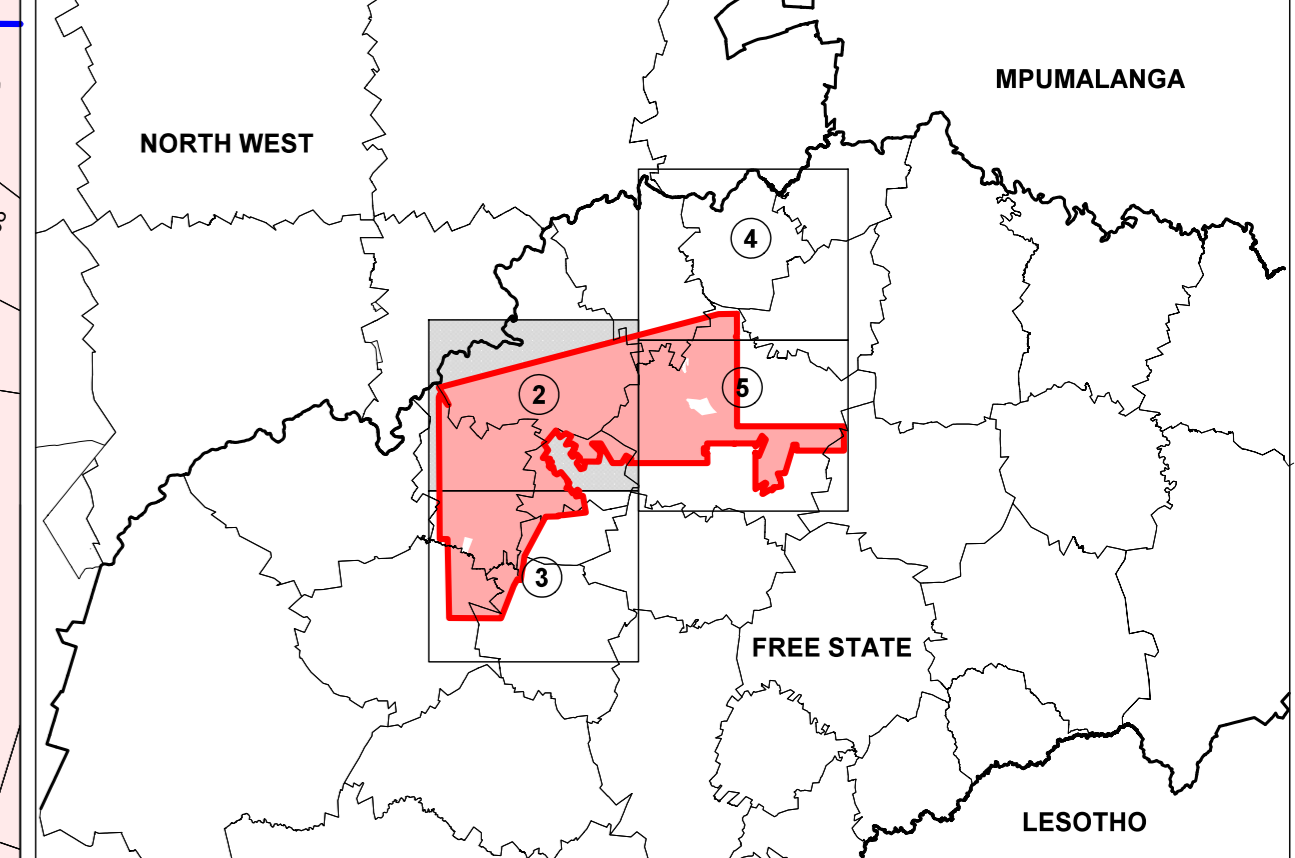

SCALE 1:75 000 (A0)



LEGEND

- ▬ denotes technical co-operation permit area
- ▬ denotes farm portion boundary
- ▬ denotes parent farms boundary
- ▬ denotes Administrative District boundary
- ▬ denotes Provincial boundary

AREA DESCRIPTION

The figure 1 to 31, middle of stream, 32, middle of stream, 33, middle of stream, 34, middle of stream, 35 to 139. Excluding the figure 140 to 142, middle of stream, 143, middle of stream, 144, middle of stream, 145, middle of stream, 146, and the figure 147 to 156, middle of stream, 157, and the figure 158 to 167, middle of stream, 168 to 174 represents 2647 farms and farm portions identified hereto together measuring approximately 6005 (six thousand and five) square kilometres of land situated partly in the Administrative Districts of Bothaville, Bultfontein, Kroonstad, Lindley, Odendaalsrus, Theunissen, Viljoenskroon, Welkom and Wesselsbron in the Province of Free State the subject of this application for a Technical Co-operation Permit in terms of Section 76 of the Mineral and Petroleum Resources Development Act 2002 (28 of 2002)

NOTES

1. All co-ordinates are in the Hartbeeshoek 94 datum - WGS27
2. All sides are numb lines i.e. lines of constant geographical direction.
3. This plan was framed from information provided by the Petroleum Agency SA and the Chief Surveyor General

Prepared by: R. C. ABRAHAMSE - PLS No. 0002
 Professional Land Surveyor

in accordance with Regulation 2(2) of the regulations in terms of the Mining Titles Registration Act 16 of 1997, provided that the figure depicted and described on this plan, the area of the figure and the co-ordinates listed thereon are subject to change, as may be necessary, to conform to the requirements in respect of the definition of co-ordinate point, contained in regulation 3 of the regulations in terms of the Mining Titles Registration Act, 16 of 1997

PASA REFERENCE No. 12/2/108 & 109

Signature: *R. C. Abrahamse*

date: 19 January 2022
 scale: 1 / 75 000 (A0)
 drawing ref & no.: ER 318 (Rev. A) (M.B.)
 drawing no.: Free State Precinct (sheet 2 of 14)

dh+a david hellig + abrahamse
 professional land surveyors
 2nd floor wale street chambers
 38 wale street, cape town
 Tel: +27 021 426 2613
 info@dhqa.co.za www.dhale.co.za

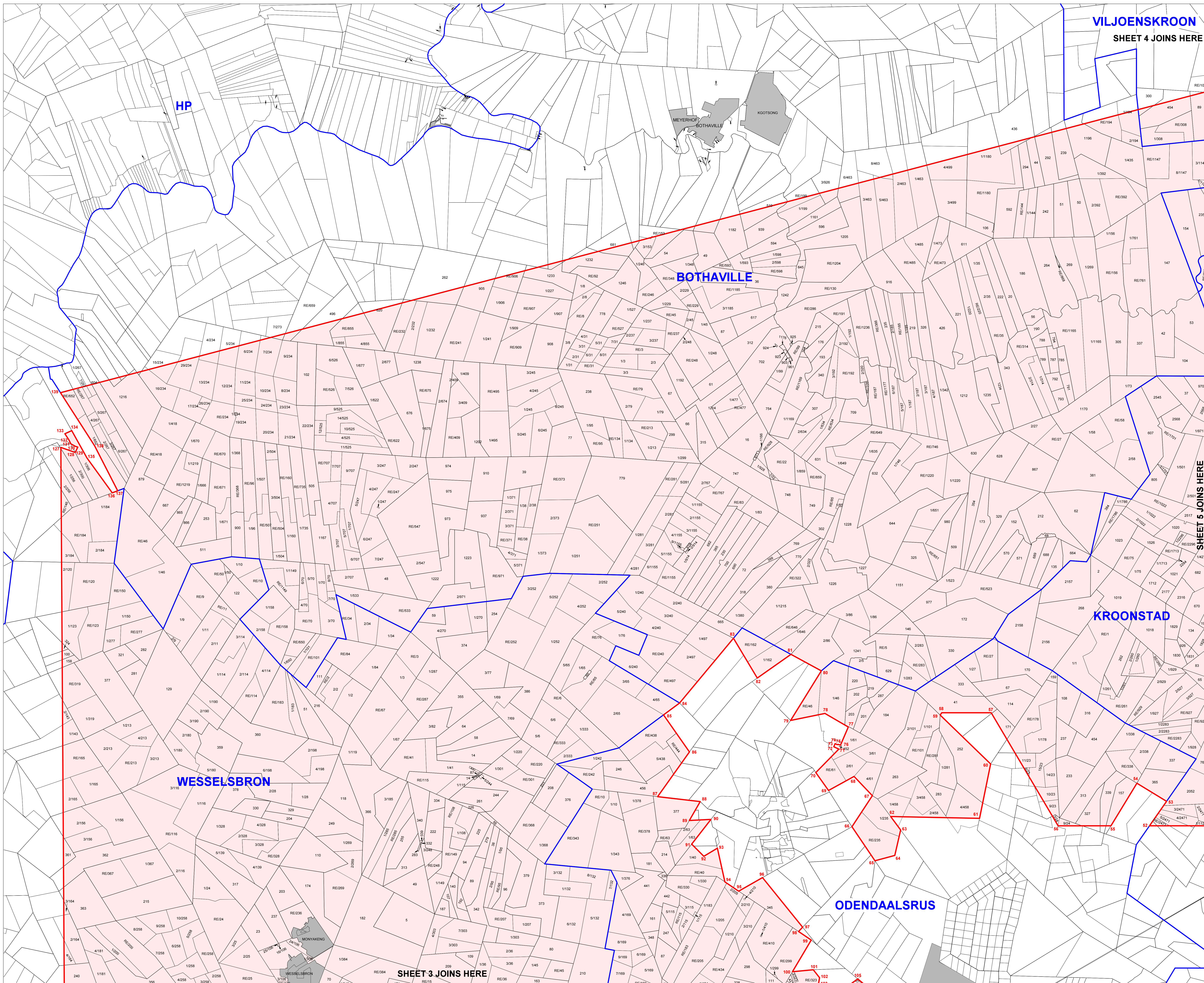

VILJOENSKROON
 SHEET 4 JOINS HERE

HP

BOTHAVILLE

KROONSTAD

WESSELSBRON

ODENDAALSRUS

SHEET 3 JOINS HERE

SHEET 5 JOINS HERE

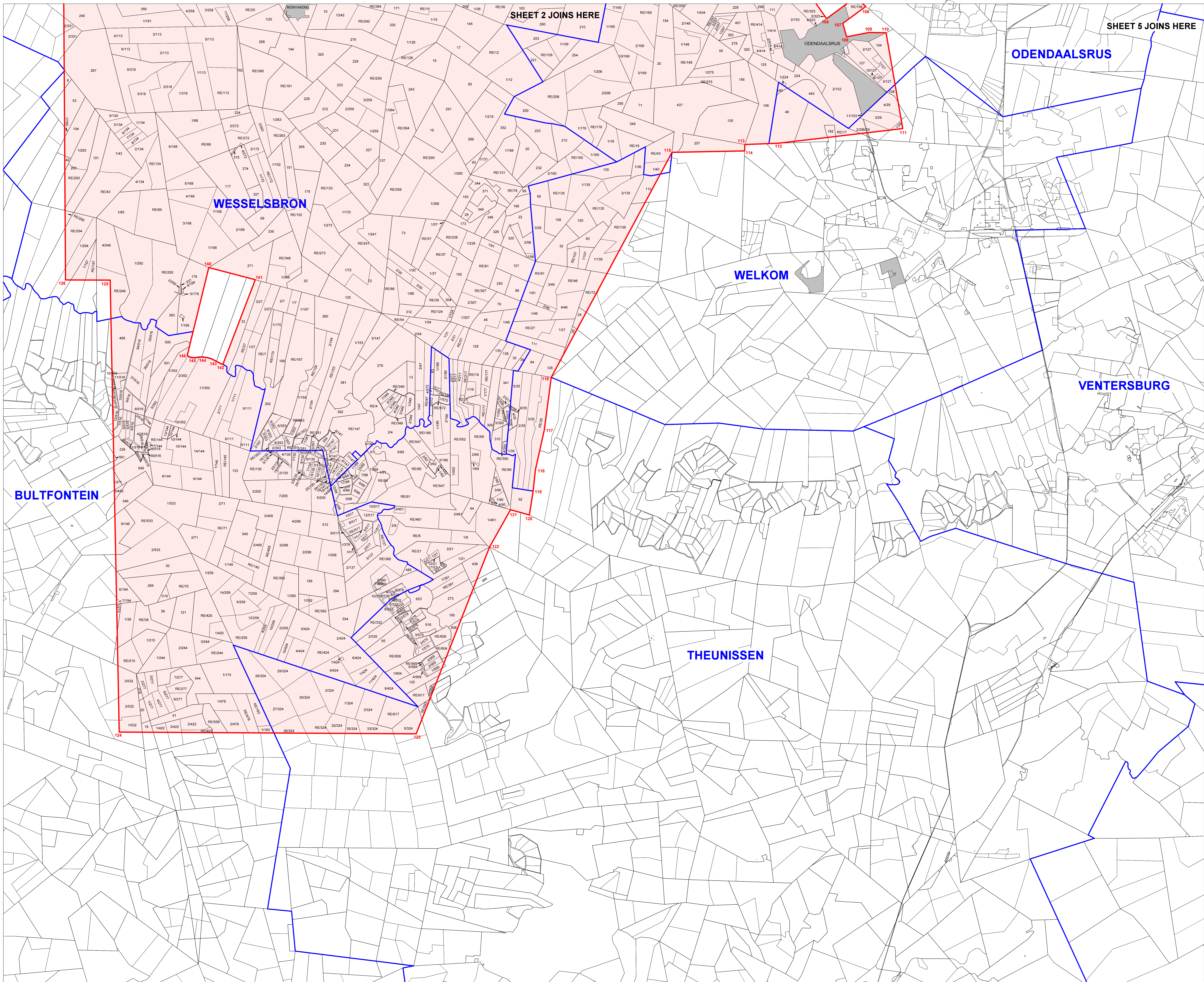

REGULATION 2(2) PLAN OF LAND UNDER APPLICATION FOR AN EXPLORATION RIGHT FOR OIL, GAS AND NATURAL GAS

PERMIT No. :
 PASA REFERENCE No. :
 SIGNATURE :
 DATE :
 CHIEF EXECUTIVE OFFICER PETROLEUM AGENCY SA : CAPE TOWN

APPLICANT:
RHINO OIL & GAS EXPLORATION SOUTH AFRICA LTD
 SIGNATURE:
 DATE:

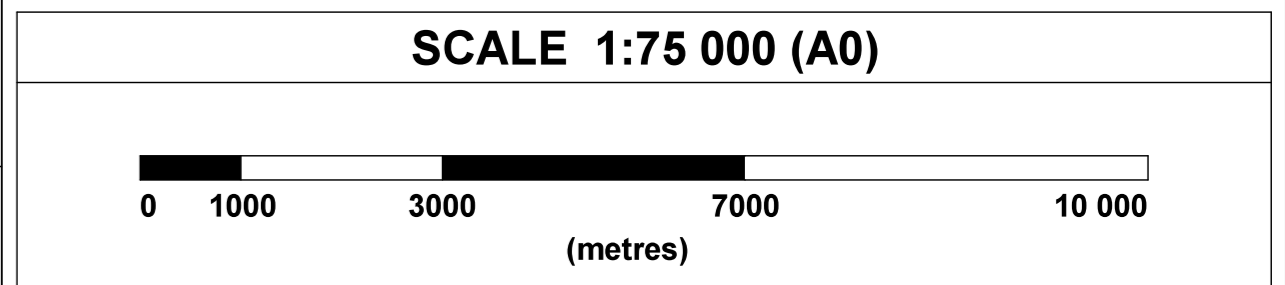
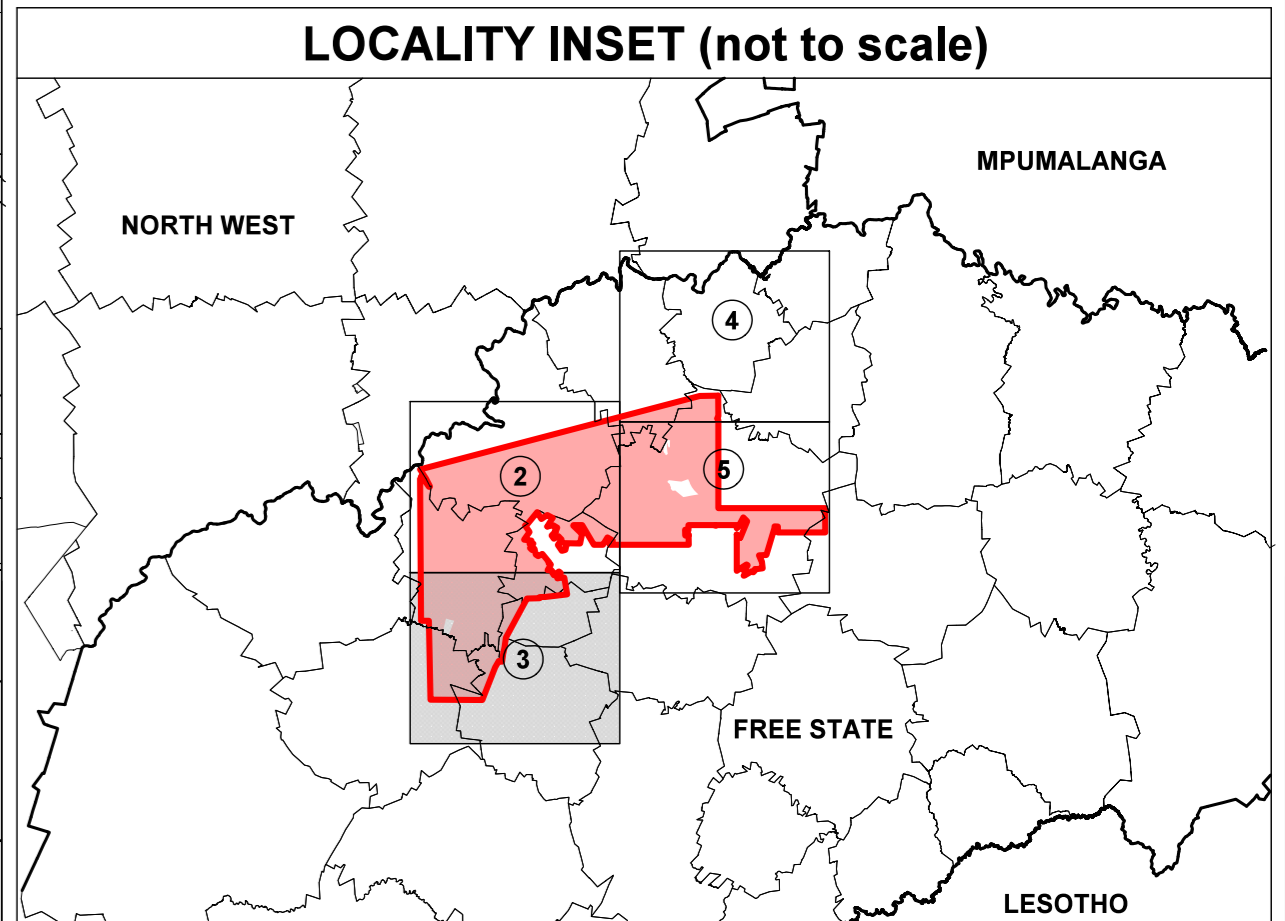
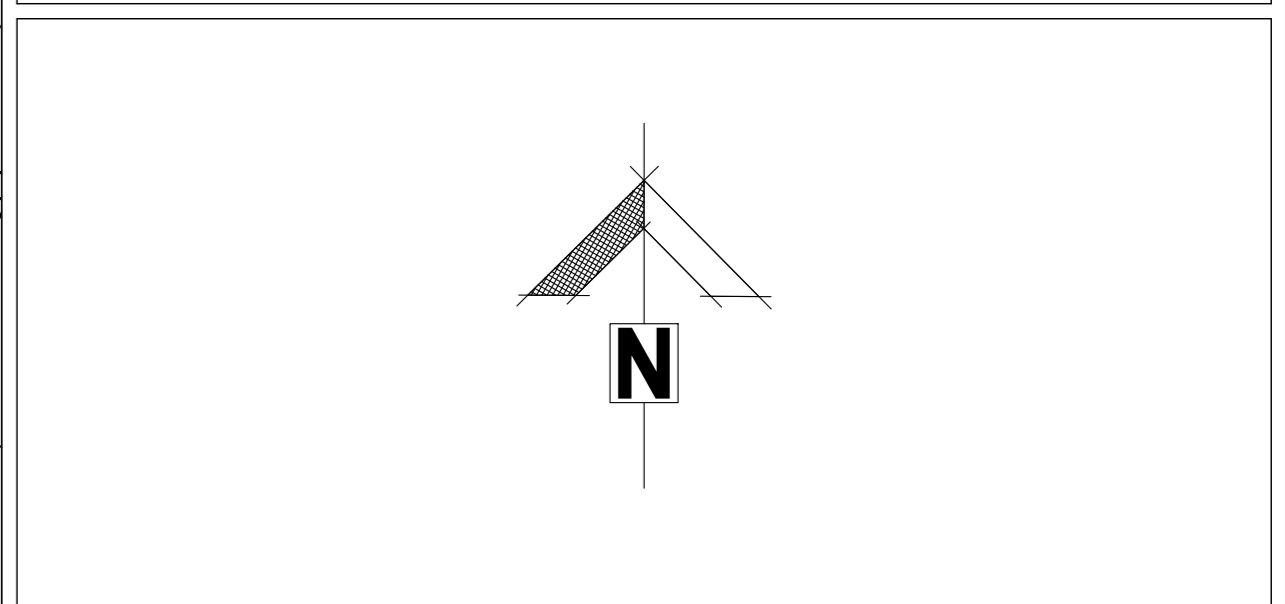

- LEGEND**
- denotes technical co-operation permit area
 - denotes farm portion boundary
 - denotes parent farms boundary
 - denotes Administrative District boundary
 - denotes Provincial boundary

AREA DESCRIPTION

The figure 1 to 31, middle of stream, 32, middle of stream, 33, middle of stream, 34, middle of stream, 35 to 139. Excluding the figure 140 to 142, middle of stream, 143, middle of stream, 144, middle of stream, 145, middle of stream, 146, and the figure 147 to 156, middle of stream, 157, and the figure 158 to 167, middle of stream, 168 to 174 represents 2647 farms and farm portions identified hereto together measuring approximately 6005 (six thousand and five) square kilometres of land situated partly in the Administrative Districts of Bothaville, Bultfontein, Kroonstad, Lindley, Odendaalsrus, Theunissen, Viljoenskroon, Welkom and Wesselsbron in the Province of Free State the subject of this application for a Technical Co-operation Permit in terms of Section 76 of the Mineral and Petroleum Resources Development Act 2002 (28 of 2002)

- NOTES**
1. All co-ordinates are in the Hartebeeshoek 94 datum - WG27
 2. All sides are number lines: i.e. lines of constant geographical direction.
 3. This plan was framed from information provided by the Petroleum Agency SA and the Chief Surveyor General

Prepared by: R. C. ABRAHAMSE - PLS No. 0002
 Professional Land Surveyor

In accordance with Regulation 2(2) of the regulations in terms of the Mining Titles Registration Act 16 of 1967, provided that the figure depicted and described on this plan, the area of the figure and the co-ordinates listed thereon are subject to change, as may be necessary, to conform to the requirements in respect of the definition of co-ordinated point, contained in regulation 3 of the regulations in terms of the Mining Titles Registration Act, 16 of 1967

PASA REFERENCE No. 12/2/108 & 109

Signature : *R. C. Abrahamse*

date	19 January 2022
scale	1 / 75 000 (A0)
drawing ref & no.	ER 318 (Rev. A) (M.B.)
drawing no.	Free State Precinct (sheet 3 of 14)

david hellig + abrahamse
 professional land surveyors
 2nd floor wale street chambers
 38 wale street, cape town
 Tel : +27 021 426 2613
 info@dhaa.co.za www.dhale.co.za

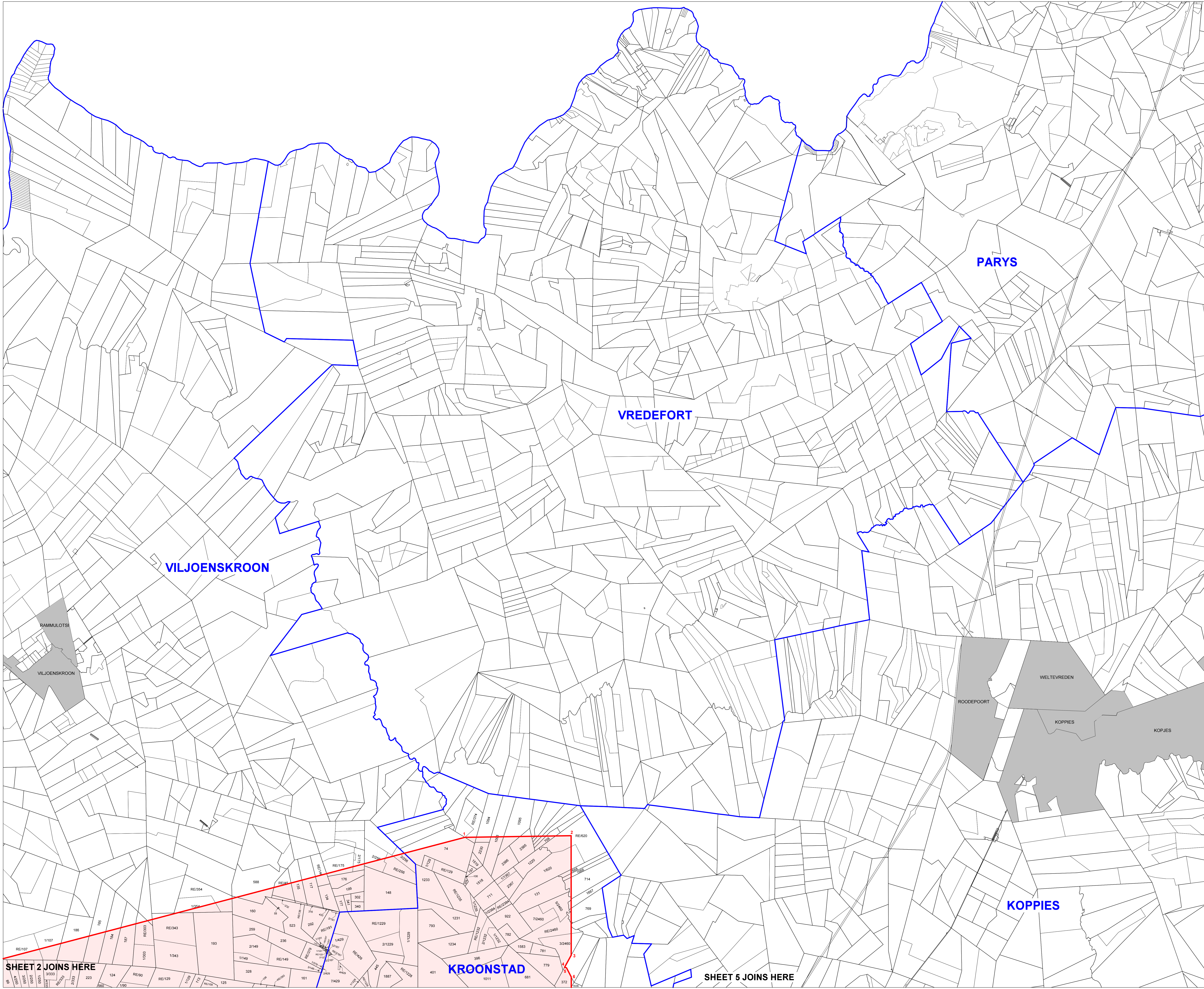

REGULATION 2(2) PLAN OF LAND UNDER APPLICATION FOR AN EXPLORATION RIGHT FOR OIL, GAS AND NATURAL GAS

PERMIT No. :
 PASA REFERENCE No. :
 SIGNATURE :
 DATE :
 CHIEF EXECUTIVE OFFICER PETROLEUM AGENCY SA : CAPE TOWN

APPLICANT:
RHINO OIL & GAS EXPLORATION SOUTH AFRICA LTD
 SIGNATURE:
 DATE:

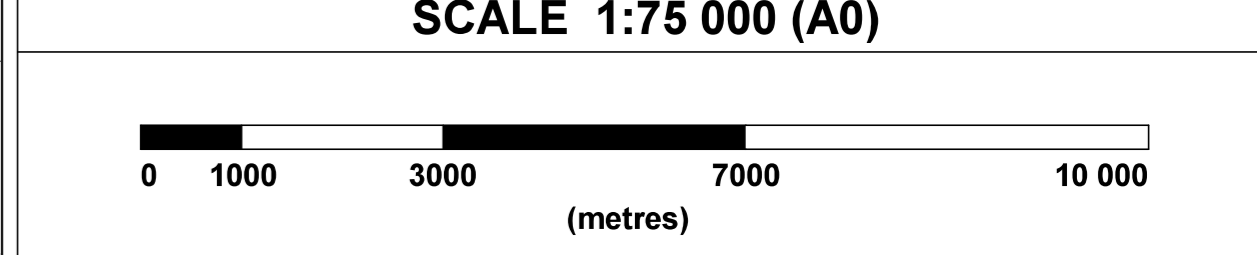
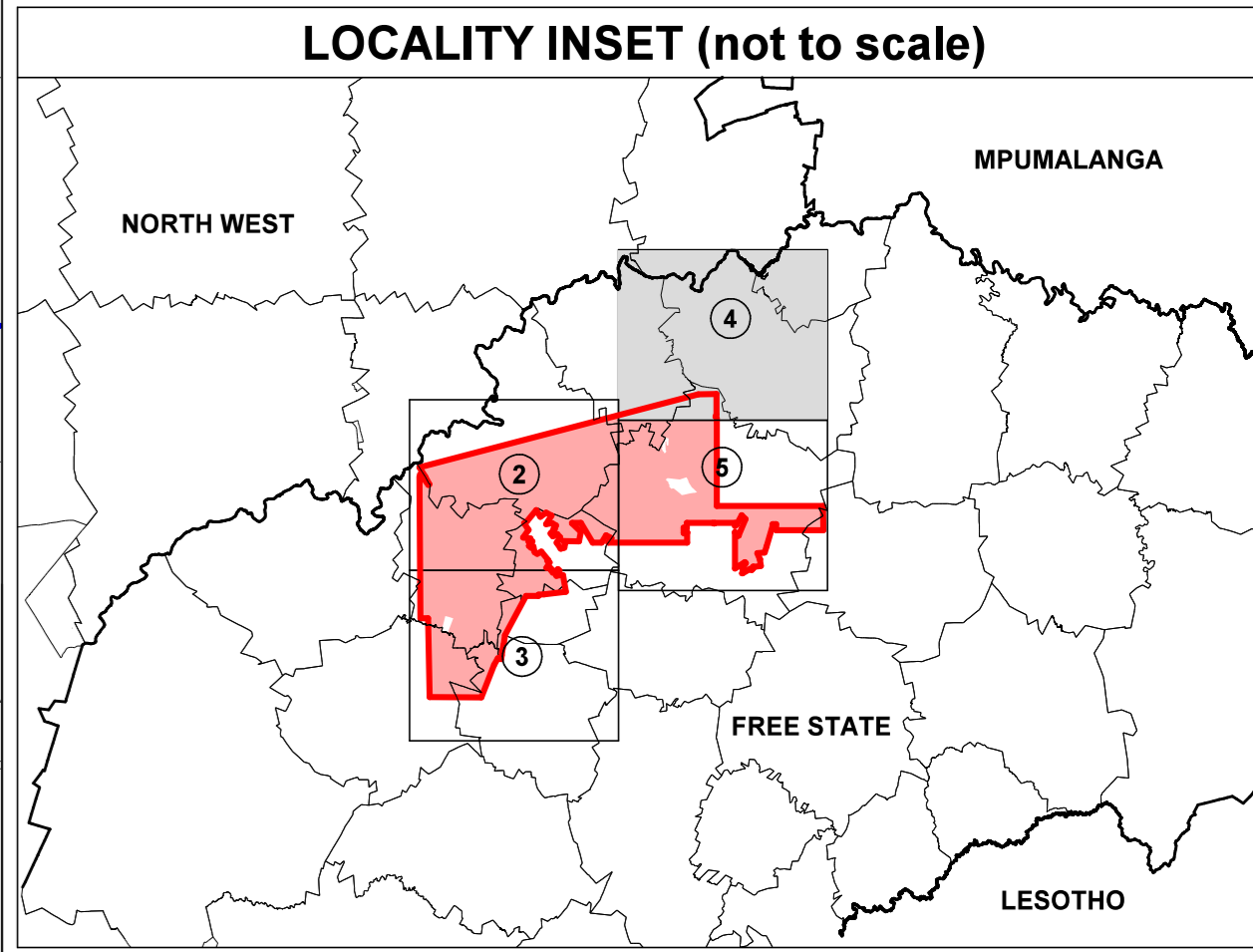
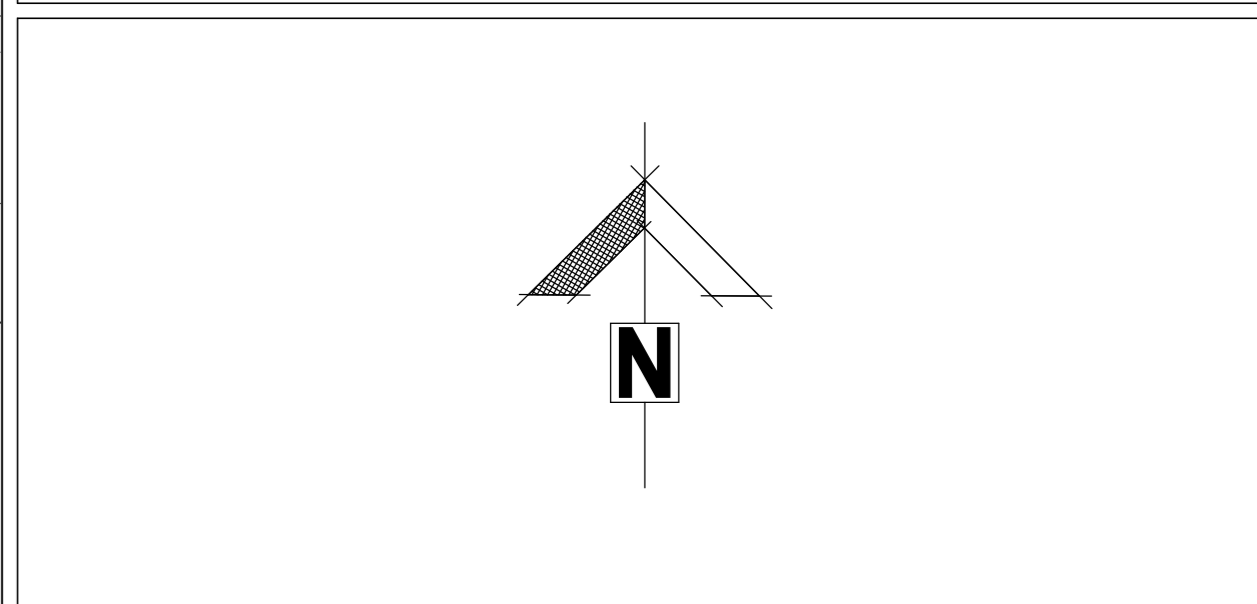

- LEGEND**
- denotes technical co-operation permit area
 - denotes farm portion boundary
 - denotes parent farms boundary
 - denotes Administrative District boundary
 - denotes Provincial boundary

AREA DESCRIPTION

The figure 1 to 31, middle of stream, 32, middle of stream, 33, middle of stream, 34, middle of stream, 35 to 139. Excluding the figure 140 to 142, middle of stream, 143, middle of stream, 144, middle of stream, 145, middle of stream, 146, and the figure 147 to 156, middle of stream, 157, and the figure 158 to 167, middle of stream, 168 to 174 represents 2647 farms and farm portions identified hereto together measuring approximately 6005 (six thousand and five) square kilometres of land situated partly in the Administrative Districts of Bothaville, Bullfontein, Kroonstad, Lindley, Odenaarus, Theunissen, Viljoenskroon, Welkom and Wesselsbron in the Province of Free State the subject of this application for a Technical Co-operation Permit in terms of Section 76 of the Mineral and Petroleum Resources Development Act 2002 (28 of 2002)

- NOTES**
1. All co-ordinates are in the Hartbeeshoek 94 datum - WGS27
 2. All sides are rhumb lines: i.e. lines of constant geographical direction.
 3. This plan was framed from information provided by the Petroleum Agency SA and the Chief Surveyor General

Prepared by: R. C. ABRAHAMSE - PLS No. 0002
 Professional Land Surveyor

in accordance with Regulation 2(2) of the regulations in terms of the Mining Titles Registration Act 16 of 1967, provided that the figure depicted and described on this plan, the area of the figure and the co-ordinates listed thereon are subject to change, as may be necessary, to conform to the requirements in respect of the definition of co-ordinated point, contained in regulation 3 of the regulations in terms of the Mining Titles Registration Act, 16 of 1967

PASA REFERENCE No. 12/2/108 & 109

Signature : *R. C. Abrahamse*

date	19 January 2022
scale	1 / 75 000 (A0)
drawing ref & no.	ER 318 (Rev. A) (M.B.)
drawing no.	Free State Precinct (sheet 4 of 14)

david hellig + abrahamse
 professional land surveyors
 2nd floor wale street chambers
 38 wale street, cape town
 Tel : +27 021 426 2613
 info@dhaa.co.za www.dhale.co.za

SHEET 2 JOINS HERE

SHEET 5 JOINS HERE

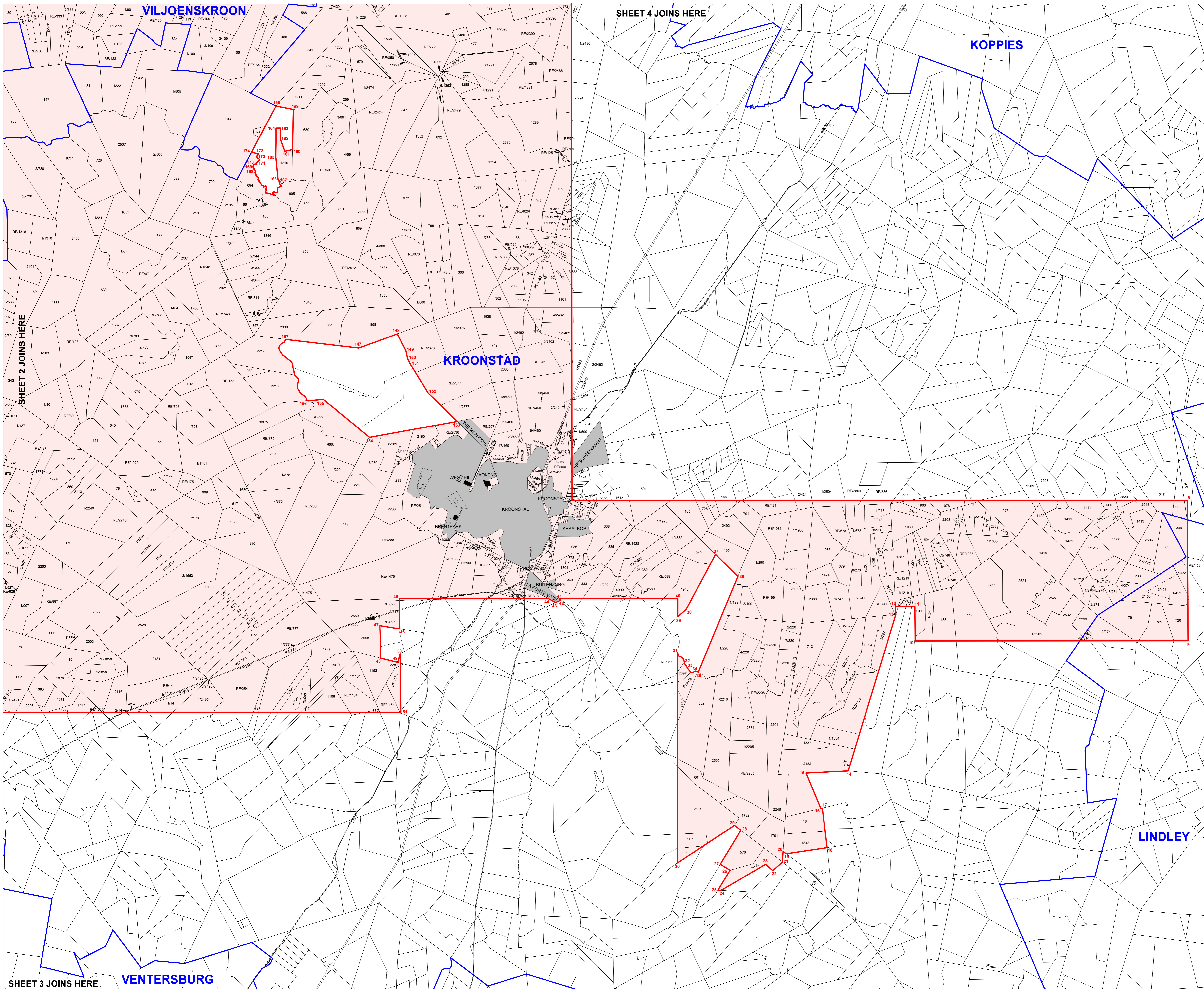

REGULATION 2(2) PLAN OF LAND UNDER APPLICATION FOR AN EXPLORATION RIGHT FOR OIL, GAS AND NATURAL GAS

PERMIT No. :

PASA REFERENCE No. :

SIGNATURE :

DATE :

CHIEF EXECUTIVE OFFICER PETROLEUM AGENCY SA : CAPE TOWN

APPLICANT: **RHINO OIL & GAS EXPLORATION SOUTH AFRICA LTD**

SIGNATURE:

DATE:

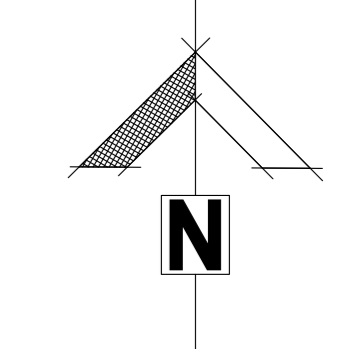

LOCALITY INSET (not to scale)

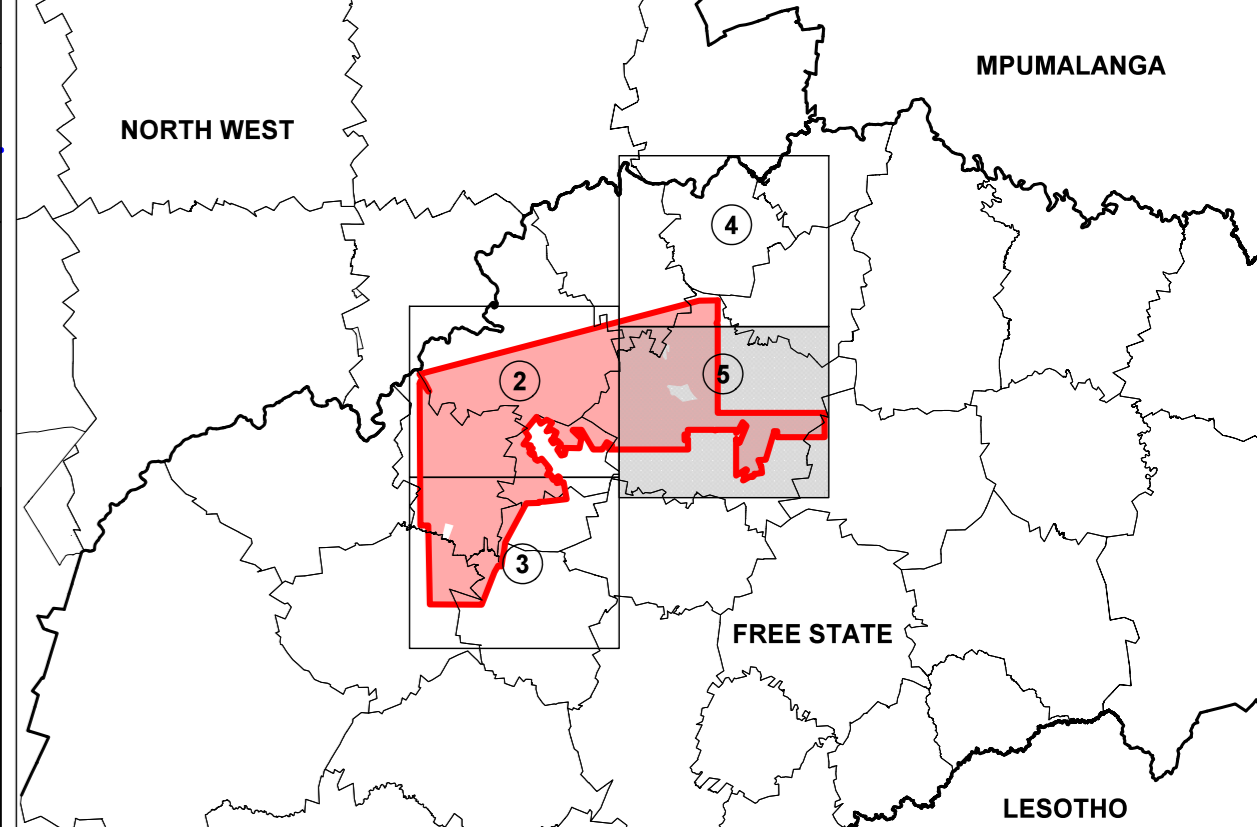

SCALE 1:75 000 (A0)

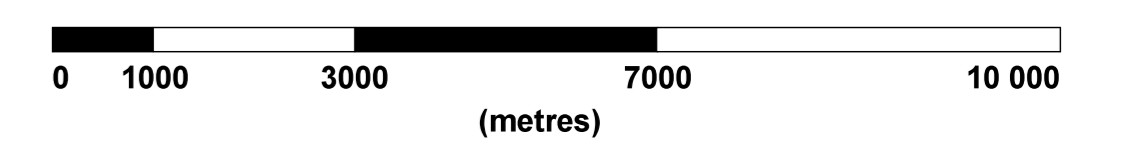

LEGEND

- denotes technical co-operation permit area
- denotes farm portion boundary
- denotes parent farms boundary
- denotes Administrative District boundary
- denotes Provincial boundary

AREA DESCRIPTION

The figure 1 to 31, middle of stream, 32, middle of stream, 33, middle of stream, 34, middle of stream, 35 to 139. Excluding the figure 140 to 142, middle of stream, 143, middle of stream, 144, middle of stream, 145, middle of stream, 146, and the figure 147 to 156, middle of stream, 157, and the figure 158 to 167, middle of stream, 168 to 174 represents 2647 farms and farm portions identified hereto together measuring approximately 6005 (six thousand and five) square kilometres of land situated partly in the Administrative Districts of Bothaville, Bullfontein, Kroonstad, Lindley, Odendaarsrus, Theunissen, Viljoenskroon, Welkom and Wesselsbron in the Province of Free State the subject of this application for a Technical Co-operation Permit in terms of Section 76 of the Mineral and Petroleum Resources Development Act 2002 (28 of 2002)

NOTES

1. All co-ordinates are in the Hartbeeshoek 94 datum - WGS27
2. All sides are rumb lines: i.e. lines of constant geographical direction.
3. This plan was framed from information provided by the Petroleum Agency SA and the Chief Surveyor General

Prepared by: R. C. ABRAHAMSE - PLS No. 0002 Professional Land Surveyor

in accordance with Regulation 2(2) of the regulations in terms of the Mining Titles Registration Act, 16 of 1967, provided that the figure depicted and described on this plan, the area of the figure and the co-ordinates listed thereon are subject to change, as may be necessary, to conform to the requirements in respect of the definition of co-ordinated point, contained in regulation 3 of the regulations in terms of the Mining Titles Registration Act, 16 of 1967

PASA REFERENCE No. 12/2/108 & 109

Signature : *R. C. Abrahamse*

date	19 January 2022
scale	1 / 75 000 (A0)
drawing ref & no.	ER 318 (Rev. A) (M.B.)
drawing no.	Free State Precinct (sheet 5 of 14)

dh+a david hellig + abrahamse professional land surveyors
 2nd floor wale street chambers
 38 wale street, cape town
 Tel: +27 021 426 2613
 info@dhaa.co.za www.dhale.co.za

APPENDIX 4.2:

LIST OF PROPERTIES WITHIN THE TARGET AREAS/AREAS OF INTEREST

NAME	Y	X	NAME	Y	X	NAME	Y	X	REGULATION 2(2) PLAN OF LAND UNDER APPLICATION FOR AN EXPLORATION RIGHT FOR OIL, GAS AND NATURAL GAS	
1	-19 811.82	3 021 137.49	56	16 856.11	3 072 633.68	111	26 054.71	3 089 762.00	PERMIT No.: _____ PASA REFERENCE No.: _____ SIGNATURE: _____ DATE: _____	
2	-26 188.63	3 021 040.83	57	20 886.26	3 065 824.61	112	33 579.72	3 090 650.28		
3	-26 197.66	3 028 207.07	58	23 865.52	3 065 824.55	113	35 587.09	3 090 724.48		
4	-25 799.37	3 028 931.34	59	23 959.77	3 065 964.51	114	35 601.63	3 091 111.50		
5	-25 914.85	3 028 964.60	60	20 920.72	3 068 907.57	115	39 986.22	3 091 197.13		
6	-26 199.31	3 029 516.31	61	21 588.50	3 072 183.53	116	47 278.61	3 104 790.68		
7	-26 237.66	3 059 949.71	62	26 941.25	3 072 074.48	117	47 696.67	3 107 965.74		
8	-63 157.29	3 059 949.71	63	26 339.81	3 072 884.47	118	48 233.56	3 110 376.38		
9	-63 198.87	3 068 345.35	64	26 691.96	3 074 416.95	119	48 370.97	3 111 658.38		
10	-46 825.65	3 068 353.32	65	27 887.61	3 074 737.61	120	48 596.04	3 113 103.33		
11	-46 806.29	3 066 293.22	66	29 272.23	3 072 687.91	121	49 734.59	3 112 782.91		
12	-45 640.73	3 066 271.98	67	28 042.93	3 070 818.27	122	50 996.66	3 115 025.10		
13	-45 664.19	3 066 763.03	68	29 145.09	3 069 658.46	123	55 430.50	3 126 319.77		
14	-42 805.46	3 076 145.69	69	30 684.02	3 070 504.62	124	73 362.92	3 126 213.80		
15	-40 275.65	3 076 276.81	70	31 449.50	3 069 426.80	125	73 908.96	3 098 916.85		
16	-41 161.02	3 078 400.10	71	30 062.46	3 068 011.99	126	76 604.38	3 098 903.96		
17	-41 251.45	3 078 378.47	72	30 366.30	3 067 874.54	127	76 914.25	3 049 846.57		
18	-41 536.61	3 080 748.14	73	30 286.90	3 067 685.30	128	76 048.79	3 050 148.62		
19	-39 084.70	3 081 114.98	74	30 152.84	3 067 741.00	129	75 894.13	3 049 828.81		
20	-38 901.72	3 080 976.75	75	30 081.17	3 067 731.76	130	76 043.94	3 049 779.88		
21	-38 856.45	3 081 612.29	76	29 966.44	3 067 781.03	131	76 310.79	3 049 630.19		
22	-38 280.09	3 082 131.76	77	29 493.23	3 066 684.63	132	76 431.40	3 049 391.13		
23	-37 849.52	3 081 751.66	78	30 899.85	3 065 865.52	133	76 670.67	3 049 021.84		
24	-35 174.04	3 083 312.06	79	32 967.20	3 066 289.16	134	76 257.16	3 048 834.53		
25	-34 984.38	3 083 302.53	80	31 116.51	3 063 302.26	135	75 341.97	3 050 479.82		
26	-35 715.09	3 082 106.35	81	32 945.04	3 062 308.53	136	73 818.61	3 052 581.19		
27	-35 126.80	3 081 750.57	82	34 973.98	3 063 735.17	137	73 490.52	3 052 459.04		
28	-36 361.82	3 079 707.86	83	36 407.11	3 061 339.02	138	74 878.93	3 049 749.69		
29	-35 977.47	3 079 418.04	84	39 651.46	3 065 237.47	139	76 935.06	3 046 550.27		
30	-32 567.16	3 081 665.93	85	40 619.65	3 065 953.69	140	67 955.41	3 098 155.55		
31	-32 578.87	3 069 065.45	86	39 059.07	3 068 184.60	141	65 147.92	3 098 891.33		
32	-32 969.64	3 069 619.89	87	40 974.10	3 070 876.48	142	67 106.52	3 104 011.37		
33	-33 361.16	3 070 227.48	88	38 409.01	3 071 173.26	143	67 494.07	3 103 808.87		
34	-33 759.13	3 070 192.74	89	39 063.10	3 072 309.79	144	68 378.34	3 103 555.07		
35	-33 809.08	3 070 220.08	90	37 764.31	3 072 247.35	145	68 493.20	3 103 554.82		
36	-36 178.67	3 064 491.56	91	38 923.81	3 073 735.87	146	69 253.11	3 103 442.82		
37	-34 843.98	3 063 164.04	92	38 191.08	3 074 468.79	147	-13 439.00	3 050 785.93		
38	-33 081.74	3 066 460.23	93	37 376.30	3 073 979.97	148	-15 748.44	3 049 945.99		
39	-32 580.44	3 066 901.99	94	36 922.72	3 076 009.58	149	-16 260.36	3 050 932.53		
40	-32 581.41	3 065 824.73	95	36 094.46	3 076 568.35	150	-16 369.29	3 051 423.24		
41	-25 464.40	3 065 824.36	96	34 659.14	3 075 751.80	151	-16 531.46	3 051 757.38		
42	-25 553.75	3 065 910.88	97	32 242.21	3 078 738.93	152	-17 604.48	3 053 498.15		
43	-25 252.41	3 066 050.00	98	32 487.74	3 078 998.57	153	-19 345.43	3 055 193.25		
44	-24 840.49	3 065 824.70	99	31 723.33	3 079 512.58	154	-14 083.49	3 056 143.16		
45	-15 864.68	3 065 824.62	100	32 855.32	3 081 419.70	155	-11 316.38	3 053 867.33		
46	-15 892.35	3 067 632.86	101	31 601.84	3 081 299.51	156	-10 345.21	3 053 946.36		
47	-14 705.41	3 067 435.61	102	31 221.78	3 081 779.39	157	-9 040.65	3 050 268.72		
48	-14 761.57	3 069 387.82	103	31 295.14	3 082 204.81	158	-8 470.88	3 036 271.37		
49	-15 786.01	3 069 641.07	104	30 654.74	3 083 122.02	159	-9 507.29	3 036 475.94		
50	-15 915.38	3 069 137.77	105	28 926.17	3 081 850.99	160	-9 462.21	3 038 879.25		
51	-15 968.84	3 072 631.92	106	28 284.47	3 082 386.90	161	-9 003.39	3 038 983.04		
52	11 353.43	3 072 633.38	107	29 674.89	3 083 407.34	162	-8 741.66	3 038 267.53		
53	10 325.17	3 071 159.04	108	29 440.40	3 084 221.03	163	-8 741.39	3 037 592.48		
54	12 111.42	3 070 068.62	109	28 092.65	3 083 958.23	164	-8 473.80	3 037 594.82		
55	13 675.24	3 072 633.51	110	27 062.18	3 083 974.58	165	-8 461.22	3 039 321.29		
Prepared by: R. C. Abrahamse - PLS No. 0002 Professional Land Surveyor									in accordance with Regulation 2(2) of the regulations in terms of the Mining Titles Registration Act 16 of 1967, provided that the figure depicted and described on this plan, the area of the figure and the co-ordinates listed thereon are subject to change, as may be necessary, to conform to the requirements in respect of the definition of co-ordinated point, contained in regulation 3 of the regulations in terms of the Mining Titles Registration Act, 16 of 1967	
PASA REFERENCE No. 12/2/108 & 109									Signature : <i>R. C. Abrahamse</i>	
Date									19 January 2022	
Reference No.									ER 318 (Rev. A)	
Drawing No.									FREE STATE FARMS (sheet 6 of 14)	
									david hellig+abrahamse professional land surveyors 2nd floor wale street chambers 38 wale street, cape town Tel : +27 021 426 2613 info@dhaa.co.za www.dhale.co.za	

NAME	Y	X	NAME	Y	X	NAME	Y	X	REGULATION 2(2) PLAN OF LAND UNDER APPLICATION FOR AN EXPLORATION RIGHT FOR OIL, GAS AND NATURAL GAS	
166	-8 597.86	3 040 702.14							PERMIT No.: _____	
167	-8 691.29	3 040 796.71							PASA REFERENCE No.: _____	
168	-7 443.39	3 039 439.29							SIGNATURE: _____	
169	-7 347.71	3 039 379.60							DATE: _____	
170	-7 323.39	3 039 326.82							CHIEF EXECUTIVE OFFICER PETROLEUM AGENCY SA : CAPE TOWN	
171	-7 339.94	3 039 247.35							APPLICANT: RHINO OIL & GAS EXPLORATION SOUTH AFRICA LTD	
172	-7 363.45	3 039 193.43							SIGNATURE: _____	
173	-7 439.23	3 039 142.87							DATE: _____	
174	-7 006.45	3 039 037.18							Prepared by: R. C. Abrahamse - PLS No. 0002 Professional Land Surveyor	
									in accordance with Regulation 2(2) of the regulations in terms of the Mining Titles Registration Act 16 of 1967, provided that the figure depicted and described on this plan, the area of the figure and the co-ordinates listed thereon are subject to change, as may be necessary, to conform to the requirements in respect of the definition of co-ordinated point, contained in regulation 3 of the regulations in terms of the Mining Titles Registration Act, 16 of 1967	
									PASA REFERENCE No. 12/2/108 & 109	
									Signature : <i>R. C. Abrahamse</i>	
									Date	19 January 2022
									Reference No.	ER 318 (Rev. A)
									Drawing No.	FREE STATE FARMS (sheet 7 of 14)
									 david hellig+abrahamse professional land surveyors 2nd floor wale street chambers 38 wale street, cape town Tel : +27 021 426 2613 info@dhaa.co.za www.dhale.co.za	

FREE STATE FARM SCHEDULE - ADMINISTRATIVE DISTRICT OF BOTHAVILLE.

FARM NO.	PORTION NO.	FARM NO.	PORTION NO.	FARM NO.	PORTION NO.	FARM NO.	PORTION NO.	FARM NO.	PORTION NO.	FARM NO.	PORTION NO.	FARM NO.	PORTION NO.	FARM NO.	PORTION NO.
3	1	70	7	187	RE	240	1	304		473	RE	632		767	RE
3	2	70	8	191	RE	240	2	305		477	1	634	1	769	
3	3	70	RE	192	1	240	3	307		477	RE	634	2	770	
3	RE	72		192	2	240	4	312		485	1	634	RE	778	
5	2	73	1	192	3	240	5	314	1	485	RE	635	1	779	
5	RE	77		192	RE	240	6	314	2	495	1	644		785	
8	1	79	1	193		240	RE	314	RE	495	RE	645		787	
8	2	79	2	194	1	241	1	315		496		646	1	788	
8	3	79	RE	194	2	241	RE	318		497	1	646	RE	789	
8	RE	83	1	194	RE	242		320	2	497	2	649	1	790	
16		83	RE	199	1	245	1	322	2	497	RE	649	RE	791	
20		85	1	199	RE	245	3	322	RE	499	3	650	1	792	
22	1	85	RE	212		245	4	325		499	4	650	RE	793	
22	RE	86	1	213	1	245	5	326		504	1	651	1	794	
27	2	86	2	213	RE	245	6	329		504	2	651	RE	855	1
27	RE	86	3	215		245	8	330		504	3	652	1	855	4
31	1	87		219		246	1	337		504	RE	652	RE	855	RE
31	2	92	RE	220	1	246	RE	338	RE	505		659	RE	859	1
31	3	95	1	220	RE	247	1	340		507	1	664		859	RE
31	4	95	RE	221		247	2	342	1	507	RE	665		865	
31	5	96	1	222		247	3	343		509		666	1	866	
31	6	96	RE	227	1	247	4	348	1	510		667		867	
31	7	99	1	229	1	247	5	348	RE	511		670	1	868	RE
31	8	99	RE	229	2	247	6	354		523	1	670	RE	871	
31	RE	101	1	229	RE	247	7	366	RE	523	RE	671	1	879	
35	1	101	RE	230		247	RE	368	1	525	4	671	RE	900	
35	2	102		232	1	248	1	368	RE	525	9	674	2	903	
35	RE	104		232	2	248	2	371	1	525	10	675	1	905	
36		106		232	RE	248	RE	371	2	525	11	675	RE	906	1
38	1	130	RE	234	1	251	1	371	3	525	12	676		906	RE
38	2	134	1	234	4	251	RE	371	4	525	14	677	1	907	1
38	RE	134	RE	234	5	253		371	5	526	6	677	2	907	RE
39		135		234	6	262		371	RE	526	7	681		908	
42		144	1	234	7	264		373	1	526	RE	682		909	1
44		144	RE	234	8	267	1	373	2	527	1	688		909	RE
45	1	146		234	9	267	2	373	RE	527	RE	689		910	
45	2	147		234	10	267	3	380	1	533	1	690		914	1
45	RE	152		234	11	267	4	380		533	RE	700		914	2
46	1	153	3	234	12	267	5	381		547	2	702		915	
46	RE	153	RE	234	13	267	6	385		547	RE	707	1	916	
48		156	1	234	15	267	7	392	1	570		707	2	923	
49		156	RE	234	16	267	RE	392	2	571		707	3	924	
50		158	1	234	17	269	1	392	RE	592		707	4	925	
51		158	2	234	19	269		399		593	1	707	5	926	3
53		158	RE	234	20	273	7	409	1	593	RE	707	6	928	1
54		160	1	234	21	281	1	409	2	594		707	7	928	RE
56		160	RE	234	22	281	2	409	3	596		707	9	937	
58	1	172		234	23	281	3	409	RE	598	1	707	RE	939	
58	2	173		234	24	281	4	418	1	598	2	709		961	
58	RE	176		234	25	281	5	418	RE	598	RE	735	1	971	2
61		185	1	234	26	281	RE	426		604		735	RE	971	RE
62		185	2	234	29	283	1	435	1	611		746	1	973	
66		185	RE	234	RE	283	2	436		617		746	RE	974	
67		186		235		283	RE	463	1	620		747		975	
68		187	1	237	1	286	RE	463	2	622	1	748		977	
70	1	187	2	237	2	292		463	3	622	RE	749		980	
70	3	187	3	237	3	294		463	5	628		754		1147	1
70	4	187	4	237	RE	299	1	463	6	629		761	1	1147	2
70	5	187	5	238		299		463	8	630		761	RE	1147	3
70	6	187	6	239		302		473	1	631		767	2	1147	8

REGULATION 2(2) PLAN OF LAND

UNDER APPLICATION FOR AN
EXPLORATION RIGHT FOR OIL, GAS
AND NATURAL GAS

PERMIT No.: _____

PASA REFERENCE No.: _____

SIGNATURE: _____

DATE: _____

CHIEF EXECUTIVE OFFICER PETROLEUM
AGENCY SA : CAPE TOWN

APPLICANT: RHINO OIL & GAS EXPLORATION
SOUTH AFRICA LTD

SIGNATURE: _____

DATE: _____

Prepared by: R. C. Abrahamse - PLS No. 0002
Professional Land Surveyor

in accordance with Regulation 2(2) of the regulations in terms of the Mining Titles Registration Act 16 of 1967, provided that the figure depicted and described on this plan, the area of the figure and the co-ordinates listed thereon are subject to change, as may be necessary, to conform to the requirements in respect of the definition of co-ordinated point, contained in regulation 3 of the regulations in terms of the Mining Titles Registration Act, 16 of 1967

PASA REFERENCE No. 12/2/108 & 109

Signature : *R. C. Abrahamse*

Date 19 January 2022

Reference No. ER 318 (Rev. A)

Drawing No. FREE STATE FARMS (sheet 8 of 14)

dh+a	david hellig+abrahamse professional land surveyors
	2nd floor wale street chambers 38 wale street, cape town Tel : +27 021 426 2613 info@dhaa.co.za www.dhale.co.za

FREE STATE FARM SCHEDULE - ADMINISTRATIVE DISTRICTS OF BOTHAVILLE and BULTFONTEIN .

BOTHAVILLE		BULTFONTEIN													
FARM NO.	PORTION NO.	FARM NO.	PORTION NO.	FARM NO.	PORTION NO.	FARM NO.	PORTION NO.	FARM NO.	PORTION NO.	FARM NO.	PORTION NO.	FARM NO.	PORTION NO.	FARM NO.	PORTION NO.
1147	RE	19		146	9	390	RE	517	4						
1149	1	20		175	1	392	1	517	5						
1149	RE	30		183	1	392	RE	517	6						
1151		38	1	183	RE	420	1	517	7						
1155	1	38	RE	194	6	420	RE	517	8						
1155	2	39		194	7	422	1	517	9						
1155	3	51		199		422	2	517	10						
1155	4	70	1	205	3	422	3	517	11						
1155	5	70	RE	205	5	422	RE	517	12						
1155	6	71	2	205	7	424	1	517	RE						
1155	9	71	3	212	1	424	2	532	1						
1155	RE	71	RE	215	1	424	4	532	2						
1161		88	14	215	RE	424	5	532	3						
1165	1	111	1	218		424	6	533	1						
1165	RE	111	2	236		424	7	533	2						
1166		111	5	244	1	424	8	533	RE						
1167		111	6	244	2	424	9	540							
1169	1	111	8	244	3	424	10	544							
1169	RE	121		244	RE	424	11	546							
1170		130	1	259	1	424	RE	549							
1176		130	2	259	2	450	3	554							
1177	RE	130	3	259	4	459	3	558	RE						
1180	1	130	4	259	6	478	1	561							
1180	RE	130	5	259	7	478	2								
1182		130	6	259	10	478	RE								
1185	3	130	7	259	12	485									
1185	RE	130	8	259	14	495	2								
1192		130	9	259	RE	495	RE								
1196		130	10	269		499									
1202		130	11	277	1	500									
1204	RE	130	12	277	2	501									
1205		130	13	277	3	512									
1212		130	14	277	4	516	3								
1214		130	15	277	6	516	4								
1215	1	130	18	277	7	516	5								
1216		130	19	277	8	516	6								
1219	1	130	22	277	RE	516	7								
1219	RE	130	23	294		516	8								
1220	1	130	24	298	1	516	9								
1220	RE	130	25	298	2	516	10								
1222		130	26	298	3	516	11								
1223		130	RE	298	4	516	12								
1226		133		310		516	13								
1227		137	2	352	1	516	14								
1228		137	3	352	2	516	15								
1232		137	RE	352	5	516	16								
1233		140	1	352	10	516	28								
1234		140	RE	352	11	516	29								
1235		144	1	371	7	516	30								
1236	RE	144	7	378	1	516	31								
1238		144	8	379	1	516	34								
1241		144	9	379	3	516	35								
1242		144	10	379	4	516	36								
1246		144	12	379	8	516	37								
		144	13	379	10	516	38								
		144	14	380	1	516	39								
		144	15	380	2	516	40								
		144	RE	380	5	516	42								
		145	1	380	RE	517	2								
		145	RE	390	1	517	3								

REGULATION 2(2) PLAN OF LAND

UNDER APPLICATION FOR AN
EXPLORATION RIGHT FOR OIL, GAS
AND NATURAL GAS

PERMIT No.: _____

PASA REFERENCE No.: _____

SIGNATURE: _____

DATE: _____

CHIEF EXECUTIVE OFFICER PETROLEUM
AGENCY SA : CAPE TOWN

APPLICANT: RHINO OIL & GAS EXPLORATION
SOUTH AFRICA LTD

SIGNATURE: _____

DATE: _____

Prepared by: R. C. Abrahamse - PLS No. 0002
Professional Land Surveyor

in accordance with Regulation 2(2) of the regulations in terms of the Mining Titles Registration Act 16 of 1967, provided that the figure depicted and described on this plan, the area of the figure and the co-ordinates listed thereon are subject to change, as may be necessary, to conform to the requirements in respect of the definition of co-ordinated point, contained in regulation 3 of the regulations in terms of the Mining Titles Registration Act, 16 of 1967

PASA REFERENCE No. 12/2/108 & 109

Signature : *R. C. Abrahamse*

Date 19 January 2022

Reference No. ER 318 (Rev. A)

Drawing No. FREE STATE FARMS (sheet 9 of 14)

	david hellig+abrahamse professional land surveyors 2nd floor wale street chambers 38 wale street, cape town Tel : +27 021 426 2613 info@dhaa.co.za www.dhale.co.za
---	--

FREE STATE FARM SCHEDULE - ADMINISTRATIVE DISTRICTS OF ODENDAALSRUS, THEUNISSEN and LINDLEY.

ODENDAALSRUS								THEUNISSEN				LINDLEY			
FARM NO.	PORTION NO.	FARM NO.	PORTION NO.	FARM NO.	PORTION NO.	FARM NO.	PORTION NO.	FARM NO.	PORTION NO.	FARM NO.	PORTION NO.	FARM NO.	PORTION NO.	FARM NO.	PORTION NO.
10	1	153	2	246		434	RE	8	1	324	5	274	2		
10	RE	153	11	247		437		8	2	324	26	274	3		
18	1	154		252		438	5	8	RE	324	27	274	RE		
18	RE	156		253		438	RE	21	1	324	28	453	1		
20		157		254		441		21	2	324	29	453	2		
23	6	159		257		442		21	6	324	30	453	3		
23	9	161		263		443		21	7	324	32	453	5		
23	10	162	1	275	1	444	RE	21	8	324	33	453	RE		
23	11	162	RE	275	RE	452		21	9	324	35	726			
23	14	169	1	278		454		21	11	324	RE	789			
23	15	169	2	281	1	456		21	12	332	1	791			
24	3	169	3	281	RE	458	1	21	RE	332	2				
24	9	169	4	283		458	2	61		332	3				
27	1	169	5	287		458	3	62	1	332	4				
27	RE	169	6	295		458	4	62	2	332	5				
40	1	169	7	297	1			62	3	332	6				
40	RE	169	8	297	2			62	4	332	RE				
41		169	9	297	3			65		335	1				
43	1	169	10	297	RE			69	1	335	2				
43	RE	169	RE	298				69	2	350	RE				
46	1	170		299	1			69	RE	381	1				
46	RE	171		299	RE			83		381	RE				
55		176	1	300				88	1	384					
61	1	176	RE	313				88	2	436					
61	2	178	1	316				88	3	461	1				
61	3	178	RE	323	2			88	4	461	2				
61	4	181		323	3			88	5	461	3				
61	RE	183	1	323	4			88	6	461	RE				
63	1	183	RE	323	RE			88	7	508					
63	2	184		327				88	9	547	RE				
63	RE	198	2	330	1			88	10	552	1				
67		198	6	330	RE			88	11	552	RE				
71		198	RE	333				88	12	568	16				
87		200		336				88	13	569	1				
101	1	201		337				88	16	569	2				
101	2	202		338	1			88	17	569	3				
101	RE	203		338	2			88	RE	569	4				
104		205	1	338	RE			89	5	569	6				
108		205	2	339				89	RE	569	RE				
109	1	205	RE	343	1			90	1	570	1				
109	RE	206	1	343	RE			90	2	570	2				
111		206	2	345				90	3	570	3				
114		206	RE	348				90	4	570	RE				
115	1	210	1	349				90	5	572	1				
115	2	210	2	365				90	RE	572	2				
115	3	210	3	376	1			91	1	572	3				
115	5	210	4	377				91	RE	572	4				
115	RE	214		378	1			92		572	RE				
125		219		378	RE			94		578	1				
127	2	220		383				125		578	2				
127	3	221		401				185		578	3				
127	7	224	1	410	1			186	1	578	4				
127	8	224		410	RE			186	2	578	RE				
127	10	228		414	1			186	3	593	RE				
127		233		414	2			186	6	604	1				
130		235	1	414	3			186	RE	604	RE				
146		235	RE	414	4			273		608	RE				
148	1	237		414	RE			324	1	616					
148	2	242	1	421				324	2	617	RE				
148	RE	242	RE	434	1			324	3	623					

REGULATION 2(2) PLAN OF LAND

UNDER APPLICATION FOR AN
EXPLORATION RIGHT FOR OIL, GAS
AND NATURAL GAS

PERMIT No.: _____

PASA REFERENCE No.: _____

SIGNATURE: _____

DATE: _____

CHIEF EXECUTIVE OFFICER PETROLEUM
AGENCY SA : CAPE TOWN

APPLICANT: RHINO OIL & GAS EXPLORATION
SOUTH AFRICA LTD

SIGNATURE: _____

DATE: _____

Prepared by: R. C. Abrahamse - PLS No. 0002
Professional Land Surveyor

in accordance with Regulation 2(2) of the regulations in terms of the Mining Titles Registration Act 16 of 1967, provided that the figure depicted and described on this plan, the area of the figure and the co-ordinates listed thereon are subject to change, as may be necessary, to conform to the requirements in respect of the definition of co-ordinated point, contained in regulation 3 of the regulations in terms of the Mining Titles Registration Act, 16 of 1967

PASA REFERENCE No. 12/2/108 & 109

Signature : *R. C. Abrahamse*

Date 19 January 2022

Reference No. ER 318 (Rev. A)

Drawing No. FREE STATE FARMS (sheet 10 of 14)

dh+a	david hellig+abrahamse professional land surveyors 2nd floor wale street chambers 38 wale street, cape town Tel : +27 021 426 2613 info@dhaa.co.za www.dhale.co.za
-------------	--

FREE STATE FARM SCHEDULE - ADMINISTRATIVE DISTRICT OF KROONSTAD.

FARM NO.	PORTION NO.	FARM NO.	PORTION NO.	FARM NO.	PORTION NO.	FARM NO.	PORTION NO.	FARM NO.	PORTION NO.	FARM NO.	PORTION NO.	FARM NO.	PORTION NO.	FARM NO.	PORTION NO.
1	1	164		290	RE	460	38	630		747	1	913		1095	
1	RE	165		292	1	460	45	631		747	2	914		1103	
2		166		292	2	460	47	632		747	RE	915	1	1104	1
3		168		292	4	460	55	633	3	748	1	915	RE	1104	RE
11		185		293		460	56	633	RE	748	2	916		1106	
14	1	195		294	1	460	57	635		748	3	917		1108	
14	2	197		294	2	460	58	636	1	748	RE	919	1	1113	RE
14	4	198		294	3	460	67	636	RE	749		920	1	1116	
14	5	198		294	RE	460	68	637		769		920	RE	1122	
14	RE	199	1	297	RE	460	89	639		772	1	921		1124	1
15		199	2	300		460	90	640		772	RE	922		1128	
37		199	3	302		460	91	642		777	1	926		1134	
51		199	RE	306		460	94	650		777	RE	927	1	1150	
65		200	1	317	1	460	102	657	1	778		927	2	1152	
67	1	200	RE	317	RE	460	120	657	2	779		927	3	1153	RE
67	2	215		322		460	123	657	2	781		927	RE	1154	RE
67	RE	219		323		460	125	657	3	782		928	1	1160	1
69		220	1	330	4	460	132	657	4	783	1	928	RE	1160	2
70		220	2	330	RE	460	142	657	5	783	2	929	1	1160	RE
71		220	3	333		460	165	657	6	783	3	929	2	1161	
72		220	4	334		460	167	657	RE	783	4	929	RE	1162	1
73	1	220	5	335		460	168	658		783	RE	930	1	1162	2
73	2	220	6	338		460	192	670		793		930	RE	1162	RE
73	3	220	7	339		460	196	672		794	1	932		1172	
73	4	220	RE	340		460	199	673	1	794	2	933		1186	
73	5	233		342		460	201	673	RE	794	RE	964	RE	1188	1
73	6	241		344	1	460	202	678	1	799		967		1188	RE
73	8	257		344	2	460	231	678	RE	800	1	970		1189	
73	RE	260	1	344	3	460	232	679		800	4	971	1	1193	1
74		260	2	344	4	460	RE	681		805		975		1193	RE
75	1	260	RE	344	RE	501	1	682		811	RE	986		1195	
75	RE	261	1	347		501	2	690		812		997	1	1198	
76		261	RE	349		504		691	3	819		997	RE	1207	
77	1	262		358		505	1	691	4	827	1	1011		1208	
77	2	266		372		505	2	691	RE	827	2	1018		1210	
77	3	268		373		529	RE	693		827	3	1019		1211	
77	4	273	1	374	RE	536	RE	694		827	4	1020		1212	3
77	5	273	2	384		537		695		827	5	1021		1217	1
77	7	273	3	396		558	1	701		827	RE	1022	1	1217	2
78		273	5	401		558	RE	703	1	850	1	1022	2	1217	RE
80	1	273	6	406	1	575		703	RE	850	RE	1022	RE	1218	1
80	RE	273	7	406	RE	576		704		851		1023		1219	1
82		273	8	413	1	579		707	2	857		1024		1219	RE
83		273	RE	413	RE	582		707	3	858		1025	1	1220	
84		274	1	421	2	589	2	707	4	859		1025	2	1228	1
90	1	274	2	421	RE	589	3	707	5	860		1025	3	1228	RE
90	RE	274	3	426		589	RE	707	6	865		1025	RE	1229	1
95		274	4	427	1	590	4	707	7	866		1037		1229	2
96	3	274	RE	427	RE	591		707	8	868		1043		1229	RE
103	1	280		429	1	594		707	9	869		1051		1231	
103	RE	283		429	2	601		707	RE	875	1	1078		1232	1
106		284		429	4	607		708		875	2	1079		1232	2
124		288	1	429	7	609		711		875	3	1080		1232	RE
129	1	288	RE	429	7	617		712		875	4	1082		1233	
129	RE	289	2	429	RE	620	1	714		875	RE	1083	1	1234	
131		289	3	438		620	RE	728		900	1	1083	RE	1235	1
134		289	6	445		622		730	2	900	2	1084		1235	RE
152	1	289	7	454		627	1	730	RE	900	RE	1086		1251	RE
152	RE	289	8	460	17	627	RE	733	1	909		1093		1253	
155		290	1	460	37	629		733	RE	910	1	1094		1263	

REGULATION 2(2) PLAN OF LAND

**UNDER APPLICATION FOR AN
EXPLORATION RIGHT FOR OIL, GAS
AND NATURAL GAS**

PERMIT No.: _____

PASA REFERENCE No.: _____

SIGNATURE: _____

DATE: _____

**CHIEF EXECUTIVE OFFICER PETROLEUM
AGENCY SA : CAPE TOWN**

**APPLICANT: RHINO OIL & GAS EXPLORATION
SOUTH AFRICA LTD**

SIGNATURE: _____

DATE: _____

Prepared by: R. C. Abrahamse - PLS No. 0002
Professional Land Surveyor

in accordance with Regulation 2(2) of the regulations in terms of the Mining Titles Registration Act 16 of 1967, provided that the figure depicted and described on this plan, the area of the figure and the co-ordinates listed thereon are subject to change, as may be necessary, to conform to the requirements in respect of the definition of co-ordinated point, contained in regulation 3 of the regulations in terms of the Mining Titles Registration Act, 16 of 1967

PASA REFERENCE No. 12/2/108 & 109

Signature : *R. C. Abrahamse*

Date: 19 January 2022

Reference No. ER 318 (Rev. A)

Drawing No. FREE STATE FARMS (sheet 11 of 14)

dh+a **david hellig+abrahamse**
professional land surveyors
2nd floor wale street chambers
38 wale street, cape town
Tel : +27 021 426 2613
info@dhaa.co.za www.dhale.co.za

FREE STATE FARM SCHEDULE - ADMINISTRATIVE DISTRICTS OF KROONSTAD and VILJOENSKROON														VILJOENSKROON		REGULATION 2(2) PLAN OF LAND	
FARM NO.	PORTION NO.	FARM NO.	PORTION NO.	FARM NO.	PORTION NO.	FARM NO.	PORTION NO.	FARM NO.	PORTION NO.	FARM NO.	PORTION NO.	FARM NO.	PORTION NO.	FARM NO.	PORTION NO.	REGULATION 2(2) PLAN OF LAND	
1268		1540	1	1775		1948		2209		2390	RE	2541	RE	176		<p>UNDER APPLICATION FOR AN EXPLORATION RIGHT FOR OIL, GAS AND NATURAL GAS</p> <p>PERMIT No.: _____</p> <p>PASA REFERENCE No.: _____</p> <p>SIGNATURE: _____</p> <p>DATE: _____</p> <p>CHIEF EXECUTIVE OFFICER PETROLEUM AGENCY SA : CAPE TOWN</p>	
1269		1540	RE	1781		1949		2210	1	2397		2542		177			
1273		1541		1782		1950	1	2211		2404		2543		183	1		
1287		1544	1	1786	1	1950	RE	2212		2460	3	2545		183	RE		
1288		1544	RE	1786	RE	1951		2213		2460	5	2547		184			
1289		1547		1790		1963		2214		2460	7	2551		185			
1290		1548	1	1791		1982		2215		2460	RE	2558	2	186			
1291	3	1548	RE	1792		1983	1	2217		2462	1	2558		187			
1291	4	1551		1807		1983	RE	2218		2462	2	2559	1	191	1		
1291	RE	1552		1828		2003		2219		2462	3	2559		191	2		
1292		1553	1	1828		2004		2222		2462	4	2564		191	RE		
1304		1553	2	1829		2005		2229		2462	9	2565		193			
1315	1	1553	RE	1830		2017		2230		2462	10	2568		199			
1315	RE	1554		1831		2018		2233		2462	RE	2572	RE	207	1		
1316	1	1568		1833		2019		2244		2464	1	2578		207	RE		
1316	RE	1578	1	1834		2021		2245		2464	2	2585		223			
1317		1578	RE	1837	2	2052		2246	1	2464	RE			232			
1334	1	1583		1837	3	2052		2246	RE	2471	1	VILJOENSKROON		234		<p>APPLICANT: RHINO OIL & GAS EXPLORATION SOUTH AFRICA LTD</p> <p>SIGNATURE: _____</p> <p>DATE: _____</p> <p>Prepared by: R. C. Abrahamse - PLS No. 0002 Professional Land Surveyor</p> <p>in accordance with Regulation 2(2) of the regulations in terms of the Mining Titles Registration Act 16 of 1967, provided that the figure depicted and described on this plan, the area of the figure and the co-ordinates listed thereon are subject to change, as may be necessary, to conform to the requirements in respect of the definition of co-ordinated point, contained in regulation 3 of the regulations in terms of the Mining Titles Registration Act, 16 of 1967</p> <p>PASA REFERENCE No. 12/2/108 & 109</p> <p>Signature : <i>W. Abrahamse</i></p>	
1334	RE	1588		1837	4	2056		2247	1	2471	2	VILJOENSKROON		235			
1336	1	1593		1840	1	2062		2247	RE	2471	3	45	RE	236			
1336	RE	1607		1840	RE	2079		2263		2471	4	58		250	1		
1337		1615		1842		2080		2271	1	2471	5	63		250	2		
1343		1628		1844		2081		2271	RE	2471	RE	89		250	3		
1346		1629		1858	1	2087		2275		2474	1	90	1	250	4		
1352		1630		1858	RE	2100		2276		2474	RE	90	RE	250	RE		
1353	1	1632		1862	1	2111		2283	1	2475	2	103		256	2		
1354		1636		1862	RE	2112		2283	2	2475	RE	106		256	3		
1367	1	1637		1883		2113		2283	RE	2477	1	107	1	256	RE		
1370		1653		1884		2116		2284		2477	RE	107	RE	259			
1372		1666		1887		2126		2287		2479	RE	109	1	292			
1378	RE	1667		1887		2127	1	2288		2480		109	2	300			
1382	1	1668		1894	1	2127	2	2293		2481	8	109	3	302			
1382	2	1670		1894		2127	RE	2296	1	2481	9	109	RE	303	1		
1382	RE	1671		1899	3	2139		2296	RE	2482		110		303	RE		
1383	1	1677		1901		2150		2297		2484		113		308	1		
1383	RE	1680		1908		2155		2299		2486	1	117		308	RE		
1384		1682	1	1912	1	2156		2313		2486	RE	122	1	316			
1404		1682		1912	RE	2157		2316		2487		122	2	328			
1410		1687		1915		2158		2323		2492		122	RE	332			
1411		1689		1916		2161		2330		2495	1	124		333	1		
1413		1692	1	1917		2162	RE	2331		2495	3	125		333	2		
1414		1699		1920	1	2165		2335		2496		129	1	333	3		
1419		1700		1920	RE	2167	1	2338		2502	RE	129	RE	333	4		
1421		1701	1	1923	2	2167	2	2340		2504	1	134		333	RE		
1422		1701	RE	1923	3	2167	RE	2349		2504	RE	135		340			
1466	1	1702		1923	4	2169		2365		2505	1	136	RE	341			
1466	RE	1703		1923	5	2176		2366		2508		140	RE	343	1		
1474		1708		1923	6	2177		2367		2509		147		343	RE		
1475	1	1712		1923	7	2178		2372	3	2510		148		354	1		
1475	RE	1713	1	1923	8	2179		2372	RE	2511	RE	149	1	354	RE		
1477		1713	RE	1923	9	2183		2376	1	2517		149	2	379	1		
1518		1717		1923	10	2184		2376	RE	2521		149	3	379	RE		
1519		1718		1923	11	2195		2377	1	2522		149	RE	393	RE		
1520		1719	RE	1923	12	2204		2377	RE	2527		154		433			
1522		1726		1923	13	2205	1	2384	1	2528		160		454			
1525		1751	1	1923	RE	2205	RE	2384	RE	2532		161		465			
1526		1751	RE	1928	1	2206	1	2388		2534		164	1	523			
1530		1758		1928	RE	2206	RE	2389		2536	RE	164	RE	559	RE		
1531		1770		1931		2207		2390	2	2537		175	2	560			
1532	1	1774		1938		2208		2390	4	2541	1	175	RE	588			

dh+a **david hellig+abrahamse**
 professional land surveyors
 2nd floor wale street chambers
 38 wale street, cape town
 Tel : +27 021 426 2613
 info@dhac.co.za www.dhale.co.za

FREE STATE FARM SCHEDULE - ADMINISTRATIVE DISTRICT OF WESSELSBRON.																REGULATION 2(2) PLAN OF LAND	
FARM NO.	PORTION NO.	FARM NO.	PORTION NO.	FARM NO.	PORTION NO.	FARM NO.	PORTION NO.	FARM NO.	PORTION NO.	FARM NO.	PORTION NO.	FARM NO.	PORTION NO.	FARM NO.	PORTION NO.	UNDER APPLICATION FOR AN EXPLORATION RIGHT FOR OIL, GAS AND NATURAL GAS	
2	1	34	RE	77	3	119	1	149	RE	182		230		269	1		
2	2	35		78	RE	120	2	150	1	183	1	231		269	2		
2	RE	36	1	79		120	RE	150	RE	183	RE	232		269	RE		
3	1	36	2	80		121		151		184	1	233		270	1		
3	RE	36	3	81	1	122		152	1	184	2	234		270	4		
4	2	36	RE	81	RE	123	1	152	RE	184	3	236	RE	271			PERMIT No.:
4	RE	37	1	82	3	123	RE	153	1	184	RE	237		272	2		PASA REFERENCE No.:
5		37	RE	84	1	124	1	153	RE	185	3	238	1	272	4		SIGNATURE:
6	5	38		84	RE	124	RE	154	1	187		238	RE	272	RE		DATE:
6	6	39		85	1	125		154	2	188	1	240		273	1		CHIEF EXECUTIVE OFFICER PETROLEUM AGENCY SA : CAPE TOWN
6	RE	41	1	85	RE	126	1	154	3	189	1	241	1	273	RE		
7	1	41	4	86	1	126	RE	154	RE	189	4	241	RE	274			
7	2	41	RE	86	RE	128		155		190	1	242	1	276			
7	RE	42		87		129		156	1	190	2	242	RE	277	1		
8		43	1	88		131	1	156	2	190	3	243		277	RE		
9	1	43	RE	89		131	RE	156	3	192		244	5	278			
9	2	45	1	93		132	1	158		193		244		279			
9	RE	45	RE	94		132	3	160	1	194		246	4	280			
10	1	47	1	95	1	132	5	160	2	196		246	RE	281			APPLICANT: RHINO OIL & GAS EXPLORATION SOUTH AFRICA LTD
10	RE	47	2	95	2	132	6	160	RE	197	1	248	3	282			
11	1	47	RE	95	RE	132	7	161	RE	197	RE	248	RE	283			SIGNATURE:
11	2	48	1	96		132	8	162		198	2	249		285	1		DATE:
11	RE	48		98	1	133	1	163		198	4	250		285	RE		
12	1	49		98	2	133	RE	163		198	6	252	1	287	1		
12	RE	50	1	99		134	1	164	2	200	1	252	2	287	RE		
13		50	RE	100		134	2	164	4	200	RE	252	3	289			
14		51		101		134	3	165	1	201		252	4	290	1		Prepared by: R. C. Abrahamse - PLS No. 0002 Professional Land Surveyor
15	1	52		104		134	4	165	2	203		252	5	290	RE		
15	RE	53		106	1	134	5	165	RE	204		252	RE	291			
16		54	1	106	3	134	6	166		207	1	254		292	1		in accordance with Regulation 2(2) of the regulations in terms of the Mining Titles Registration Act 16 of 1967, provided that the figure depicted and described on this plan, the area of the figure and the co-ordinates listed thereon are subject to change, as may be necessary, to conform to the requirements in respect of the definition of co-ordinated point, contained in regulation 3 of the regulations in terms of the Mining Titles Registration Act, 16 of 1967
17		54	2	106	16	134	7	167	1	207	RE	255		292	2		
18	1	54	RE	106	24	134	8	167	2	208		256	1	292	RE		
18	RE	56		106	25	134	RE	167	RE	209		256	2	293	1		
19		57	1	106	RE	135		168	1	209		258	1	293	RE		
20		57	RE	107		137		168	2	210		258	2	293			
22		58		108	1	138		168	3	210		258	3	294	1		
23		59		108	RE	139	4	168	4	212		258	3	294	RE		
24	1	60		109		139	5	168	5	213	1	258	4	295	RE		
24	RE	62		110		140		168	6	213	2	258	4	296			
25	1	64		111		143	1	168	7	213	3	258	5	300	2		PASA REFERENCE No. 12/2/108 & 109
25	2	65	1	113	1	143	2	169	1	213	4	258	6	301	1		
25	3	65	2	113	2	145		170	1	213	RE	258	7	301	RE		
25	RE	65	3	113	3	146	RE	170	RE	215		258	8	303	1		
27	1	65	4	113	4	147	3	171		216		258	9	303	3		Signature : R. C. Abrahamse
27	2	65	5	113	5	147	4	171		217	1	258	10	303	4		
27	3	65	RE	113	6	147	5	172	1	217	2	258	11	303	7		
27	RE	66	1	113	RE	147	6	172	2	217	3	258	RE	304			
28	1	66	RE	114	1	147	7	172	RE	217	4	259	1	306	1		
28	2	67	1	114	2	147	8	173		217	RE	259	2	307	1		
29		67	RE	114	3	147	9	174		218	1	259	3	307	2		
30	1	68		114	4	147	10	175		220	1	259	RE	307	RE		Date 19 January 2022
30	2	69	1	114	RE	147	11	176	5	220	RE	260		309			Reference No. ER 318 (Rev. A)
30	3	69	7	115	1	147	12	176		222		261		310			
30	RE	70		115	RE	147	13	177	1	223		262		311	2		Drawing No. FREE STATE FARMS (sheet 13 of 14)
31	1	72	1	116	1	147	14	177	RE	224		263	1	312			
31	2	72		116	2	147	15	180	1	225		263	2	313			
31	RE	73		116	3	147	18	180	2	226		263	RE	315			
33		74		116	RE	147	19	180	5	227		265		317			
34	1	76	1	117		147	RE	181	1	228		267		318	1		
34	2	76	RE	118		149	1	181	4	229		268		318	2		

dh+a david hellig+abrahamse professional land surveyors
2nd floor wale street chambers
38 wale street, cape town
Tel : +27 021 426 2613
info@dhaa.co.za www.dhale.co.za

FREE STATE FARM SCHEDULE - ADMINISTRATIVE DISTRICTS OF WESSELSBRON and WELKOM.

WESSELSBRON				WELKOM											
FARM NO.	PORTION NO.	FARM NO.	PORTION NO.	FARM NO.	PORTION NO.	FARM NO.	PORTION NO.	FARM NO.	PORTION NO.	FARM NO.	PORTION NO.	FARM NO.	PORTION NO.	FARM NO.	PORTION NO.
318	3	353	5	17	RE										
318	5	353	6	24											
319	1	353	7	26											
319	RE	353	8	27	1										
320		353	RE	27	RE										
321		354		29	1										
323		355		29	2										
325		356		29	3										
326		358	1	29	4										
327		358	RE	29	5										
328	1	359		32											
328	2	360		35	1										
328	3	361		35	2										
328	4	362		35	3										
328	RE	363		35	4										
329		364	1	35	5										
330		364	RE	35	6										
331	2	366		35	7										
331	3	367	1	35	8										
332		367	RE	35	RE										
333	1	368	1	36	1										
333	2	368	RE	39	3										
333	RE	371		46	1										
334		372		46	2										
335		373		46	3										
336		374		46	4										
337		376		46	RE										
339		377		48											
340		378		58											
341		379		72	RE										
342		381		83											
344		382		84											
345		383		91	1										
346		384	1	91	RE										
348	1	384	RE	107	1										
348	RE	385	RE	107	RE										
349	1	386		108											
349	2			111											
349	3			112											
349	4			120											
349	5			128											
349	6			130											
349	7			135	1										
349	RE			135	2										
350	1			135	RE										
350	2			138	1										
350	3			138	RE										
350	4			140											
350	5			158											
350	RE			162											
351	1														
351	2														
351	3														
351	4														
351	RE														
352															
353	1														
353	2														
353	3														
353	4														

REGULATION 2(2) PLAN OF LAND

UNDER APPLICATION FOR AN
EXPLORATION RIGHT FOR OIL, GAS
AND NATURAL GAS

PERMIT No.: _____

PASA REFERENCE No.: _____

SIGNATURE: _____

DATE: _____

CHIEF EXECUTIVE OFFICER PETROLEUM
AGENCY SA : CAPE TOWN

APPLICANT: RHINO OIL & GAS EXPLORATION
SOUTH AFRICA LTD

SIGNATURE: _____

DATE: _____

Prepared by: R. C. Abrahamse - PLS No. 0002
Professional Land Surveyor

in accordance with Regulation 2(2) of the regulations in terms of the Mining Titles Registration Act 16 of 1967, provided that the figure depicted and described on this plan, the area of the figure and the co-ordinates listed thereon are subject to change, as may be necessary, to conform to the requirements in respect of the definition of co-ordinated point, contained in regulation 3 of the regulations in terms of the Mining Titles Registration Act, 16 of 1967

PASA REFERENCE No. 12/2/108 & 109

Signature : *R. C. Abrahamse*

Date 19 January 2022

Reference No. ER 318 (Rev. A)

Drawing No. FREE STATE FARMS (sheet 14 of 14)

dh+a	david hellig+abrahamse professional land surveyors 2nd floor wale street chambers 38 wale street, cape town Tel : +27 021 426 2613 info@dhaa.co.za www.dhale.co.za
-------------	--