



**ARCHEAN** RESOURCES (PTY) LTD

Cell: +27 82 970 1513

Fax: 086 695 5990

Email: [moses@archeanresources.com](mailto:moses@archeanresources.com);

11 January 2022

**NOTICE OF THE PROPOSED PROSPECTING ACTIVITY IS HEREBY GIVEN IN TERMS OF THE (MPRDA) MINERALS AND PETROLEUM RESOURCES DEVELOPMENT ACT (ACT NO.28 OF 2002) AND (NEMA) NATIONAL ENVIRONMENTAL MANAGEMENT ACT (ACT NO 107 OF 1998): ENVIRONMENTAL IMPACT ASSESSMENT REGULATIONS 2021 (AS AMENDED):**

**DMR Reference:** NW 30/5/1/1/2/13240PR

**Attention:** Landowners, interested and affected parties

**Applicant:** North West Vanadium (Pty) Ltd

**Contact Person:** Yvonne Gutoona/Mphephu Moses

**Location:** The farms are located approximately 11km northeast of Brits Town, North West province.

## 1 BACKGROUND

Notice is hereby given in terms of the (MPRDA) Minerals And Petroleum Resources Development Act (Act No.28 Of 2002) hereafter as Amended Section by 12(D) of the MPRDA, 2008 (Act 49 Of 2008) together with Regulation 3 (6) of the National Environmental Management Act (Act No 107 Of 1998): Environmental Impact Assessment Regulations 2021 (As Amended) that North West Vanadium (Pty) Ltd has applied for a prospecting right and associated environmental authorization to prospect for the following minerals: Copper Ore (Cu); Gold Ore (Au); Iron Ore (Fe); Manganese Ore (Mn) ; Nickle Ore (Ni); Niobium (Columbiam) Ore (Nb); Platinum Group Metals (Pgm) Rare Earths (Re); Tantalum / Niobium Ore (Ta); Titanium (Ti), Vanadium Ore (V); Zinc Ore (Zn) with the DMRE on 1,220.93 hectares of portions:

- RE/14/420 Mamagalieskraal; 839/420 Mamagalieskraal
- 840/420 Mamagalieskraal; 841/420 Mamagalieskraal
- 842/420 Mamagalieskraal; RE/843/420 Mamagalieskraal
- 844/420 Mamagalieskraal; 845/420 Mamagalieskraal
- 846/420 Mamagalieskraal; 847/420 Mamagalieskraal
- 848/420 Mamagalieskraal; 849/420 Mamagalieskraal
- RE/850/420 Mamagalieskraal; 851/420 Mamagalieskraal
- 852/420 Mamagalieskraal; 896/420 Mamagalieskraal
- 897/420 Mamagalieskraal; 898/420 Mamagalieskraal
- 899/420 Mamagalieskraal; 900/420 Mamagalieskraal
- 421 Bokfontein; 1/426 Bokfontein
- 3/426 Bokfontein; 4/426 Bokfontein.

You have been identified as an interested and affected party (I&AP) in the project and the purpose of this letter is therefore to:

- ❖ Inform you of the development.
- ❖ Give you an opportunity to raise any concern you might have in respect of the prospecting activities, as under item 2 below.
- ❖ Incorporate your concerns in the impact assessment study, which is being done as part of the Basic Assessment /Environmental Management Plan (EMP). The BAR/EMP is a legal requirement for all prospecting activities and has to be approved by the Department of Mineral Resources (DMRE).



## 2 PROJECT DESCRIPTION

### 2.1 Application Area

The application area is approximately 1,220.93 hectares, located 11km northeast of Brits Town, North West province See map below.

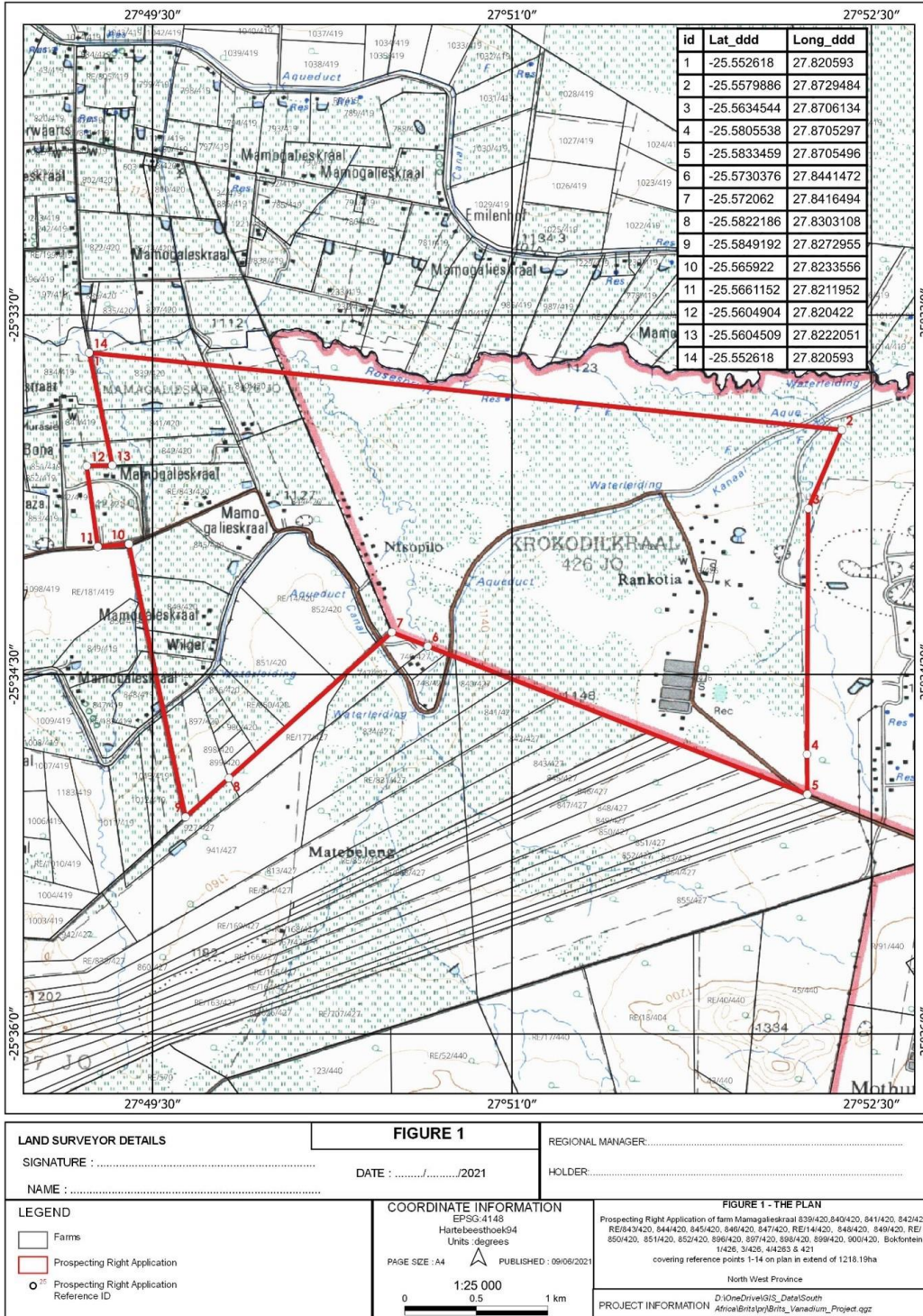

Figure 1: Regulation Map



**ARCHEAN** RESOURCES (PTY) LTD

Cell: +27 82 970 1513

Fax: 086 695 5990

Email: [moses@archeanresources.com](mailto:moses@archeanresources.com);

Interested and affected parties (e.g. surface right holders) will be consulted throughout the process and permission to access land will be sought prior to undertaking any field work.

### **3 PROSPECTING ACTIVITIES**

The quality and quantity of primarily Vanadium and associated mineral occurrences in the application area will be determined as follows:

#### **3.1 Data review and desktop studies**

Data acquisition from government and private sources, and analysis of any existing/previous prospecting and drilling data, satellite (Landsat) imagery, aerial photos, and terrain data, as well as geological map interpretation. The synthesis and interpretation of such information will contribute towards providing a clearer picture of the location and characteristics of the vanadium hosted magnetite occurrences and will guide the in-field prospecting programme.

#### **3.2 Mapping and surface sampling**

Detailed field mapping of any outcrops to determine the orientation (strike and dip) and contact of the Bierkraal Magnetite Gabbro with the underlying Pyramid Gabbro-Norite will be conducted by the Project Geologist and Assistants. Such mapping will encompass GPS controlled traverses and aerial photo mapping.

Sampling of any observed outcrops (rock chips) will be undertaken to assess whole rock chemistry and petrology will enable the development of the stratigraphic model. Surface soil sampling will be collected on a fixed 200m grid to further assist in the definition of the stratigraphic model and geochemical anomalies. Samples will be analysed by an appropriate laboratory certified to provide quality assured results.

Data from the mapping, sampling and sample analysis campaigns will be integrated and interpreted. Targets for follow-up during the subsequent study phase will be identified and prioritised.

#### **3.3 Magnetic Survey**

A ground magnetic survey with N-S traverse lines (perpendicular to the main mineralised and structural trend) will be undertaken over the identified target areas. Line spacing would initially be set at 500m and would be infilled down to 50m spacing where required. Each line would be approximately 1,000m in length.

Captured magnetic data will be integrated with observed geological and geochemical datasets and the deposit geophysical model will be developed. Targets for follow-up through core drilling will be defined.

#### **3.4 Reconnaissance Drilling**

The objective of the initial reconnaissance diamond drilling is to accurately define the depth and orientation (strike and orientation) of the Bierkraal Magnetite Gabbro. Samples will also be collected from recovered core for geochemical and density analysis. Results will be used to further define the stratigraphic model and develop the geochemical model for the project.

Drill hole traverses will be drilled on a N-S orientation, perpendicular to the main mineralised and structural trend. Each drill traverse will comprise two to three drill collars with the following specification:

- Collar A will be positioned 25 to 75m down-dip from the Bierkraal Magnetite Gabbro subcrop and Collar B will be positioned 25 to 75m down-dip from Collar A.
- Two holes will be drilled at each of the collars: A1 will be drilled vertically (-90 degrees inclination) and A2 will be drilled inclined at -70 degrees South.
- The main objectives of these initial drillholes will be to achieve accurate stratigraphic control of the layered intrusions and to assess the vanadium content of the magnetite bearing layers.
- This strategy will enable the calculation of the grade and true thickness of the magnetite bearing seams. It should also enable the estimation of an Exploration Target category mineral resource estimate.



A total of 15 diamond drill holes is estimated which would amount to approximately 2,000m. Refer to Figure 5.1 showing the drill hole orientation.

Figure below showing Drill hole orientation

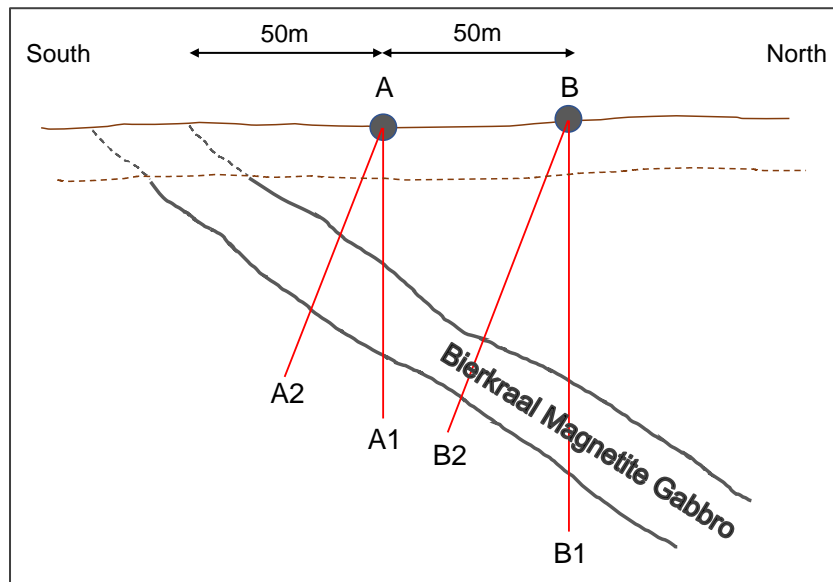

### 3.5 Infill Drilling

The most anomalous areas will be follow-up with infill diamond drilling traverses and narrower spaced drill hole collars along the traverses. The objective of the infill drilling would be to illustrate geological and grade continuity and enable the reporting of Inferred and Indicated Mineral Resource Estimates (MRE).

The duration of this phase of work could be 1-2 years depending on geological model complexity.

### 3.6 Preliminary Economic Assessment (PEA)

A Preliminary Economic Assessment will be initiated once a resource has been reported. The assessment would consider all capital and operating costs associated with grade control, mining and haulage, processing, bulk services and infrastructure requirements for the project development.

Project phases and schedule

Phase	Timeframe	Year 1				Year 2				Year 3				Year 4				Year 5			
		Q1	Q2	Q3	Q4	Q1	Q2	Q3	Q4	Q1	Q2	Q3	Q4	Q1	Q2	Q3	Q4	Q1	Q2	Q3	Q4
Phase 1: Project Set-up																					
Data Review and Desktop Studies	3 months	■																			
Mapping and Surface Sampling.	3 months		■																		
Phase 2: Exploration																					
Magnetic Survey	6 months			■	■																
Reconnaissance Drilling	6 months					■	■														
Phase 3: Mineral Resource Estimation and PEA																					
Infill Drilling	18 months									■	■	■	■								
Scoping Study	6 months																	■	■	■	■



**ARCHEAN** RESOURCES (PTY) LTD

Cell: +27 82 970 1513

Fax: 086 695 5990

Email: [moses@archeanresources.com](mailto:moses@archeanresources.com);

## **ACTIVITIES TO BE AUTHORISED**

Listing 1 & 3- GNR 325 & 326 requiring a Basic Assessment

## **4 YOUR INVOLVEMENT**

You are requested to submit your concerns (if any) and register as an I&AP in this project by way of the accompanying comments form. This consultation process is important as it raises your awareness about the nature of the operation and allows you to raise any positive and/or negative concerns you might have regarding the proposed project. Your concerns will then be investigated further as part of the environmental impact study to determine their impacts; management measures will then be developed to address these impacts.

**Basic Assessment Report/ Environmental Management Plan and Specialist Studies** will be available for review from 17<sup>th</sup> of January ending on 17<sup>th</sup> February 2020 for at least 30 days. Reports will be emailed to registered interested and affected parties and upon request; hard copies will be available at:

- Madibeng Public Library (Brits) and Damonsville Hall

**Public Meeting-** A public meeting will be held on the 10th of February at 11am at Rantsou Creche (Rankotea) 0250.

In order to participate in the process and/or provide comments and or to register as an Interested and Affected Party (I & AP) pertaining to the above-proposed activity, you are invited to contact us as above quoting the reference number of the project you have interest in within 30 days of this notice ending on 17<sup>th</sup> of February via the following methods: [moses@archeanresources.com](mailto:moses@archeanresources.com)/[infomation@archeanresources.com](mailto:infomation@archeanresources.com) **Cc:** [archeanresources@outlook.com](mailto:archeanresources@outlook.com) or alternatively on Tel: (+27) 67 103 2562 (+27) 82 9701513 and Fax: (+27) 86 695 5990



**ARCHEAN** RESOURCES (PTY) LTD

Cell: +27 82 970 1513

Fax: 086 695 5990

Email: [moses@archeanresources.com](mailto:moses@archeanresources.com);

**COMMENT FORM**

**Applicant: North West Vanadium (Pty) Ltd**

**DMR Reference: NW 30/5/1/1/2/13240PR**

<b>Title:</b>		<b>Surname:</b>	
<b>Name:</b>		<b>Organisation:</b>	
<b>Farm:</b>		<b>Portion:</b>	
<b>Tel:</b>	<b>Fax:</b>	<b>Email:</b>	