

APPENDIX 4.1:

REGULATION 2(2) PLAN OF THE WELL DRILLING ER APPLICATION AREA

**REGULATION 2(2) PLAN OF LAND
UNDER APPLICATION FOR AN
EXPLORATION RIGHT FOR OIL, GAS AND
NATURAL GAS**

PERMIT No. :
 PASA REFERENCE No. :
 SIGNATURE :
 DATE :
 CHIEF EXECUTIVE OFFICER PETROLEUM
 AGENCY SA : CAPE TOWN

APPLICANT:
 RHINO OIL & GAS EXPLORATION
 SOUTH AFRICA LTD
 SIGNATURE:
 DATE:

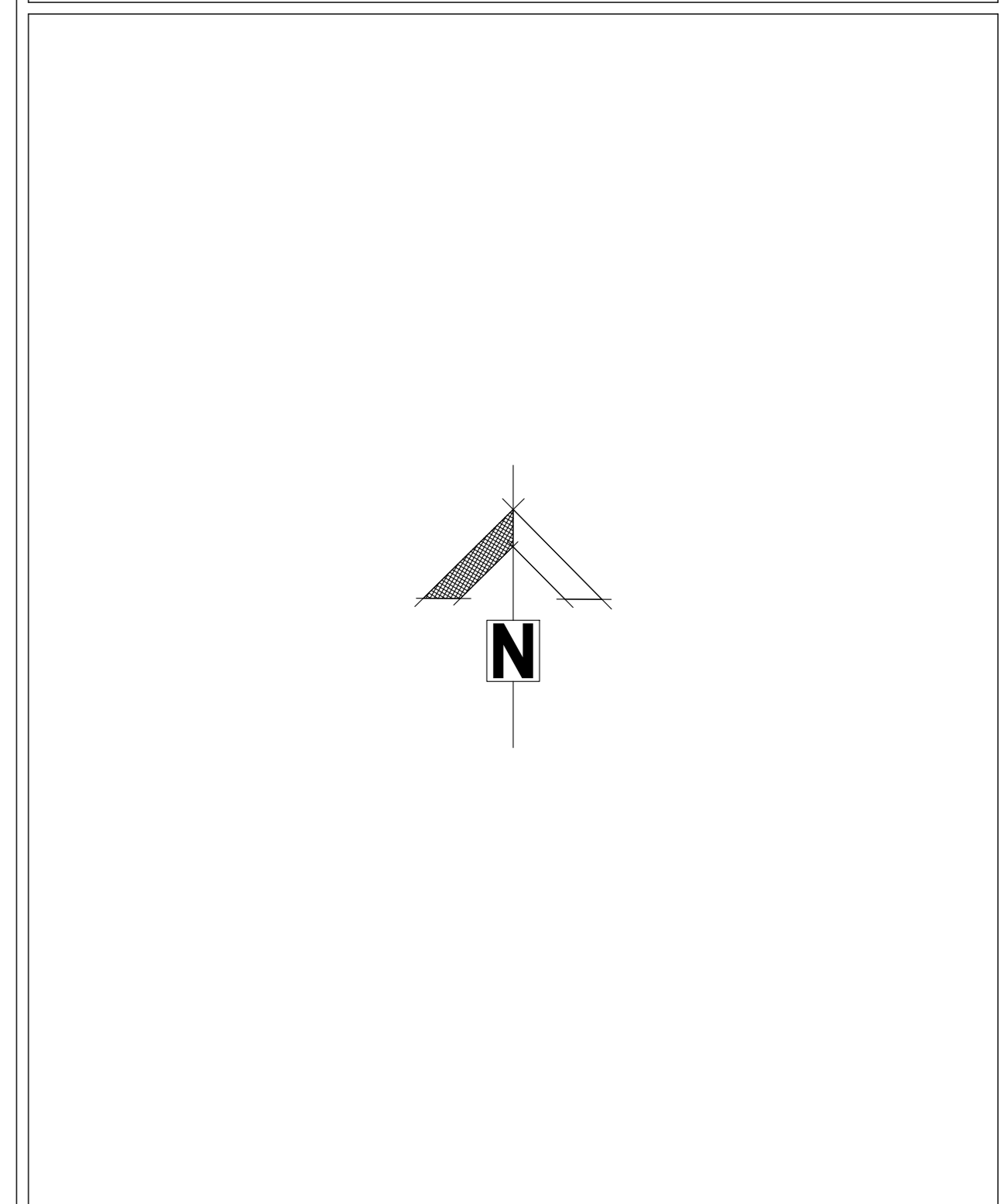

SCALE 1:250 000 (A0)

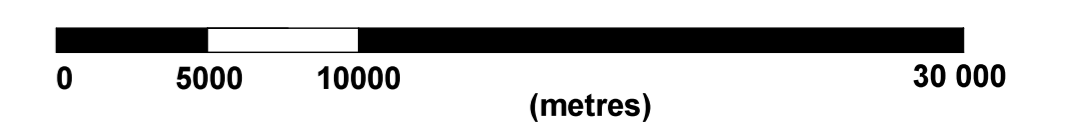

LEGEND

- denotes technical co-operation permit area
- denotes farm portion boundary
- denotes parent farms boundary
- denotes Administrative District boundary
- denotes Provincial boundary

AREA DESCRIPTION

The figure 1 to 31, middle of stream, 32, middle of stream, 33, middle of stream, 34, middle of stream, 35 to 139. Excluding the figure 140 to 142, middle of stream, 143, middle of stream, 144, middle of stream, 145, middle of stream, 146, and the figure 147 to 156, middle of stream, 157, and the figure 158 to 167, middle of stream, 168 to 174 represents 2647 farms and farm portions identified hereto together measuring approximately 6005 (six thousand and five) square kilometres of land situated partly in the Administrative Districts of Bothaville, Bultfontein, Kroonstad, Lindley, Odendaalsrus, Theunissen, Viljoenskroon, Welkom and Wesselsbron in the Province of Free State the subject of this application for a Technical Co-operation Permit in terms of Section 76 of the Mineral and Petroleum Resources Development Act 2002 (28 of 2002)

NOTES

1. All co-ordinates are in the Hartbeeshoek 94 datum - WGS77
2. All sides are thumb lines: i.e. lines of constant geographical direction.
3. This plan was framed from information provided by the Petroleum Agency SA and the Chief Surveyor General

Prepared by: R. C. ABRAHAMSE - PLS No. 0002
 Professional Land Surveyor

In accordance with Regulation 2(2) of the regulations in terms of the Mining Titles Registration Act, 16 of 1967, provided that the figure depicted and described on this plan, the area of the figure and the co-ordinates listed thereon are subject to change, as may be necessary, to conform to the requirements in respect of the definition of co-ordinated point, contained in regulation 3 of the regulations in terms of the Mining Titles Registration Act, 16 of 1967

PASA REFERENCE No. 12/2/108 & 109

Signature : *R. C. Abrahamse*

date	19 January 2022	
scale	1 / 250 000 (A0)	
drawing ref & no.	ER 318 (Rev. A)	(M.B.)
drawing no.	Free State Precinct (sheet 1 of 14)	

dh+a david hellig + abrahamse
 professional land surveyors
 2nd floor wale street chambers
 38 wale street, cape town
 Tel : +27 021 426 2613
 info@dhaa.co.za www.dhale.co.za

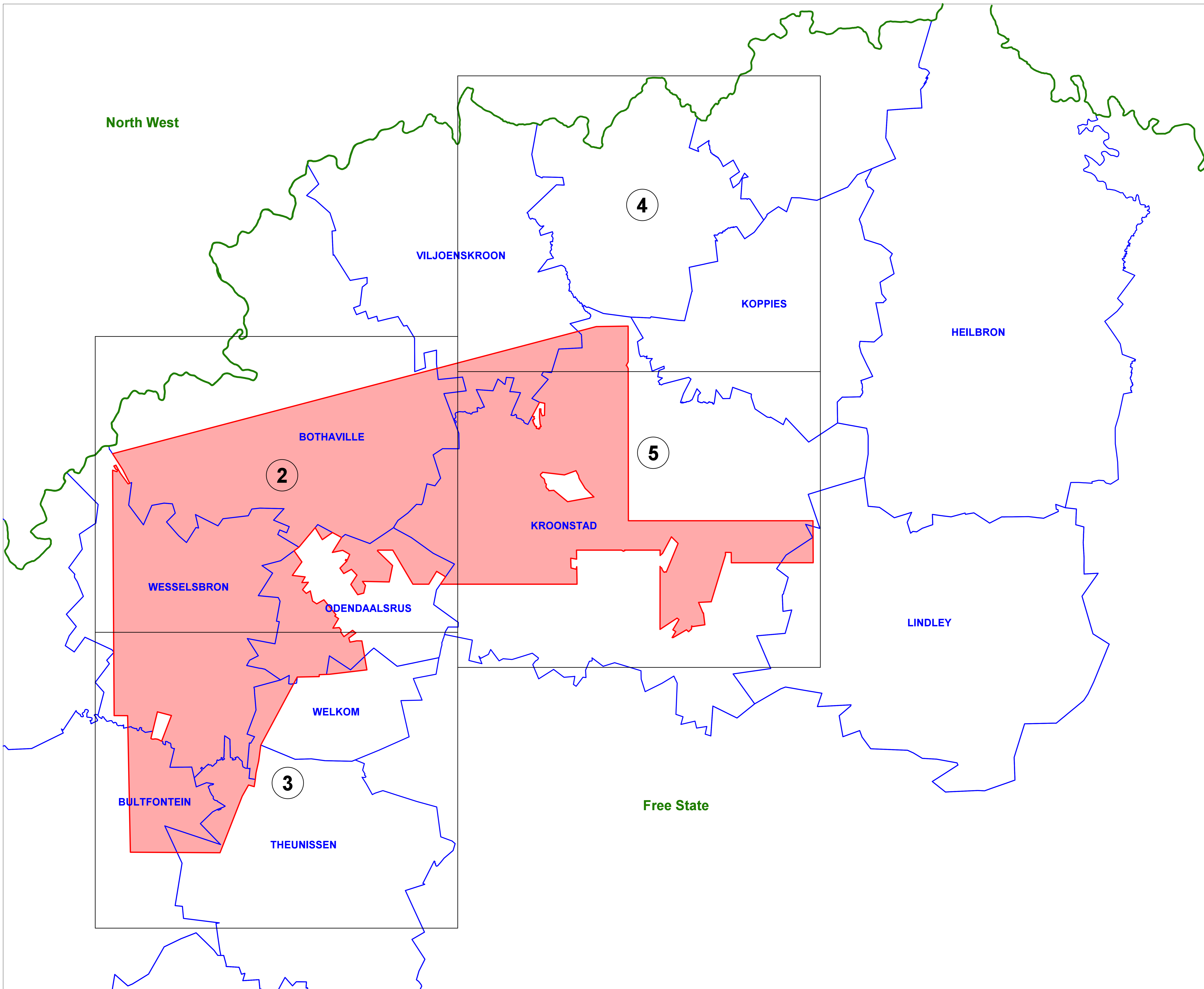

REGULATION 2(2) PLAN OF LAND UNDER APPLICATION FOR AN EXPLORATION RIGHT FOR OIL, GAS AND NATURAL GAS

PERMIT No. :
 PASA REFERENCE No. :
 SIGNATURE :
 DATE :
 CHIEF EXECUTIVE OFFICER PETROLEUM AGENCY SA : CAPE TOWN

APPLICANT: **RHINO OIL & GAS EXPLORATION SOUTH AFRICA LTD**

SIGNATURE :
 DATE:

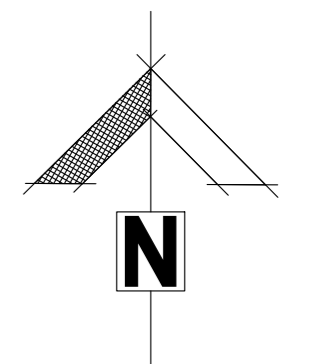

LOCALITY INSET (not to scale)

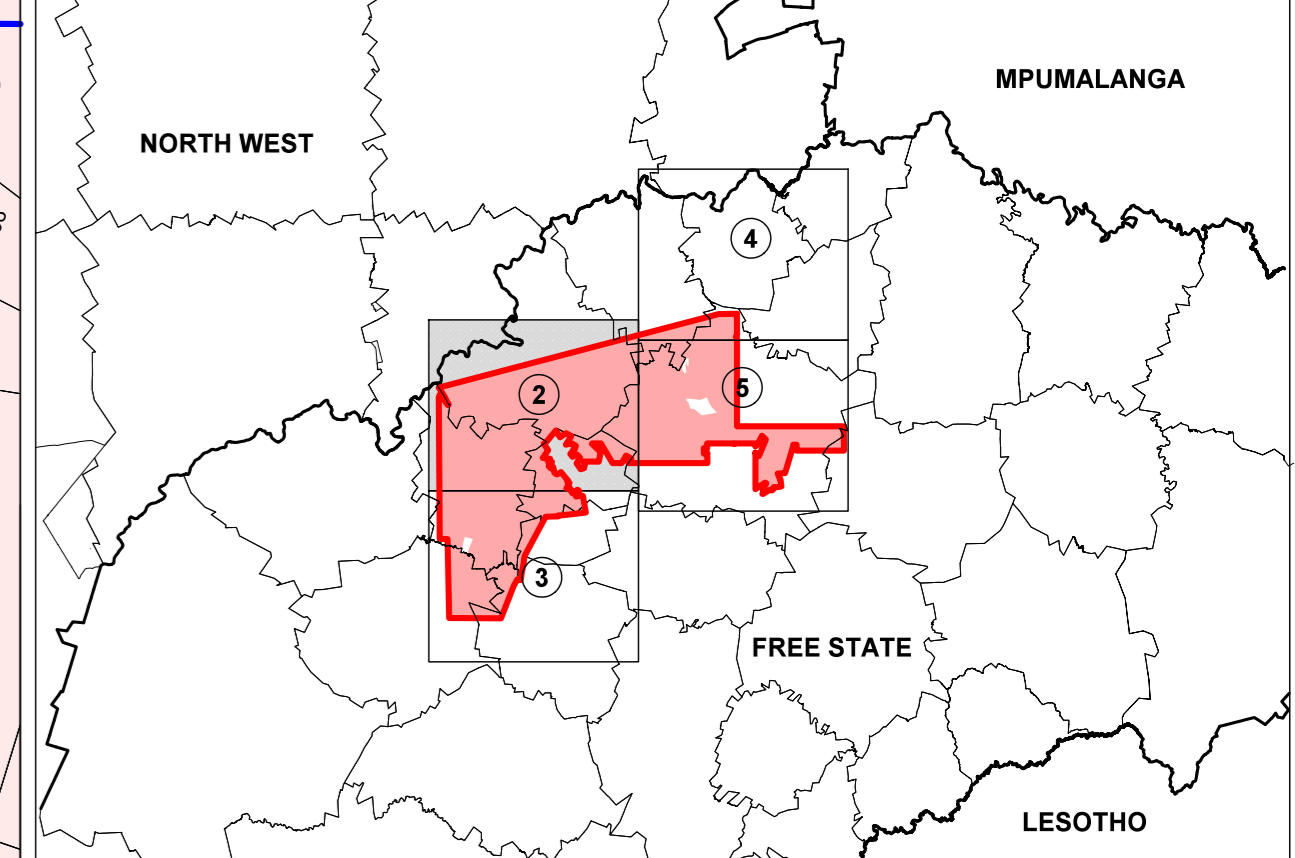

SCALE 1:75 000 (A0)



LEGEND

- denotes technical co-operation permit area
- denotes farm portion boundary
- denotes parent farms boundary
- denotes Administrative District boundary
- denotes Provincial boundary

AREA DESCRIPTION

The figure 1 to 31, middle of stream, 32, middle of stream, 33, middle of stream, 34, middle of stream, 35 to 139. Excluding the figure 140 to 142, middle of stream, 143, middle of stream, 144, middle of stream, 145, middle of stream, 146, and the figure 147 to 156, middle of stream, 157, and the figure 158 to 167, middle of stream, 168 to 174 represents 2647 farms and farm portions identified hereto together measuring approximately 6005 (six thousand and five) square kilometres of land situated partly in the Administrative Districts of Bothaville, Bultfontein, Kroonstad, Lindley, Odendaalsrus, Theunissen, Viljoenskroon, Welkom and Wesselsbron in the Province of Free State the subject of this application for a Technical Co-operation Permit in terms of Section 76 of the Mineral and Petroleum Resources Development Act 2002 (28 of 2002)

NOTES

1. All co-ordinates are in the Hartbeeshoek 94 datum - WGS27
2. All sides are numb lines i.e. lines of constant geographical direction.
3. This plan was framed from information provided by the Petroleum Agency SA and the Chief Surveyor General

Prepared by: R. C. ABRAHAMSE - PLS No. 0002
 Professional Land Surveyor

in accordance with Regulation 2(2) of the regulations in terms of the Mining Titles Registration Act 16 of 1967, provided that the figure depicted and described on this plan, the area of the figure and the co-ordinates listed thereon are subject to change, as may be necessary, to conform to the requirements in respect of the definition of co-ordinate point, contained in regulation 3 of the regulations in terms of the Mining Titles Registration Act, 16 of 1967

PASA REFERENCE No. 12/2/108 & 109

Signature: *R. C. Abrahamse*

date	19 January 2022
scale	1 / 75 000 (A0)
drawing ref & no.	ER 318 (Rev. A) (M.B.)
drawing no.	Free State Precinct (sheet 2 of 14)

dh+a david hellig + abrahamse
 professional land surveyors
 2nd floor wale street chambers
 38 wale street, cape town
 Tel: +27 021 426 2613
 info@dhqa.co.za www.dhale.co.za

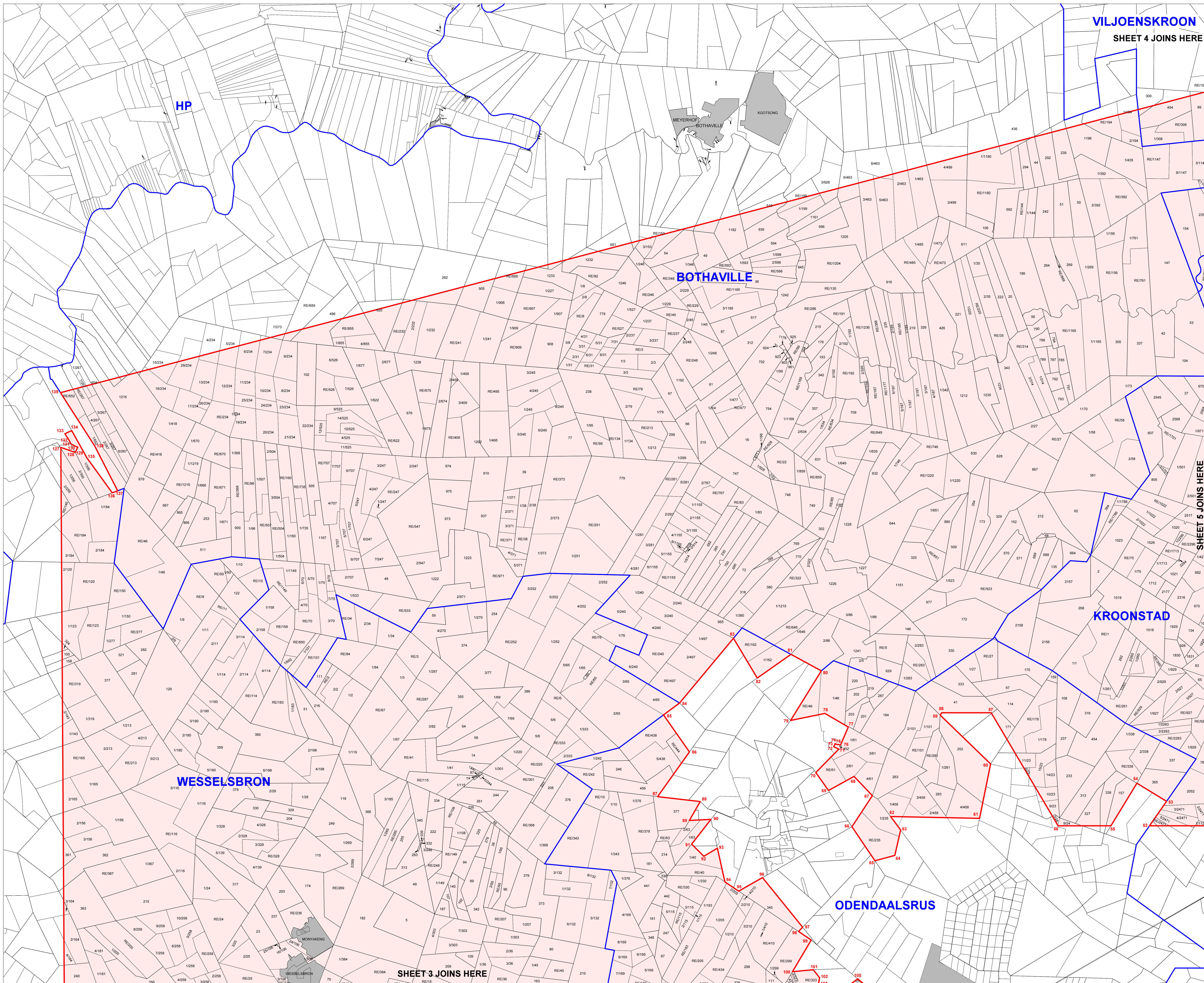

VILJOENSKROON
 SHEET 4 JOINS HERE

BOTHAVILLE

KROONSTAD

WESSELSBRON

ODENDAALSRUS

SHEET 3 JOINS HERE

SHEET 5 JOINS HERE

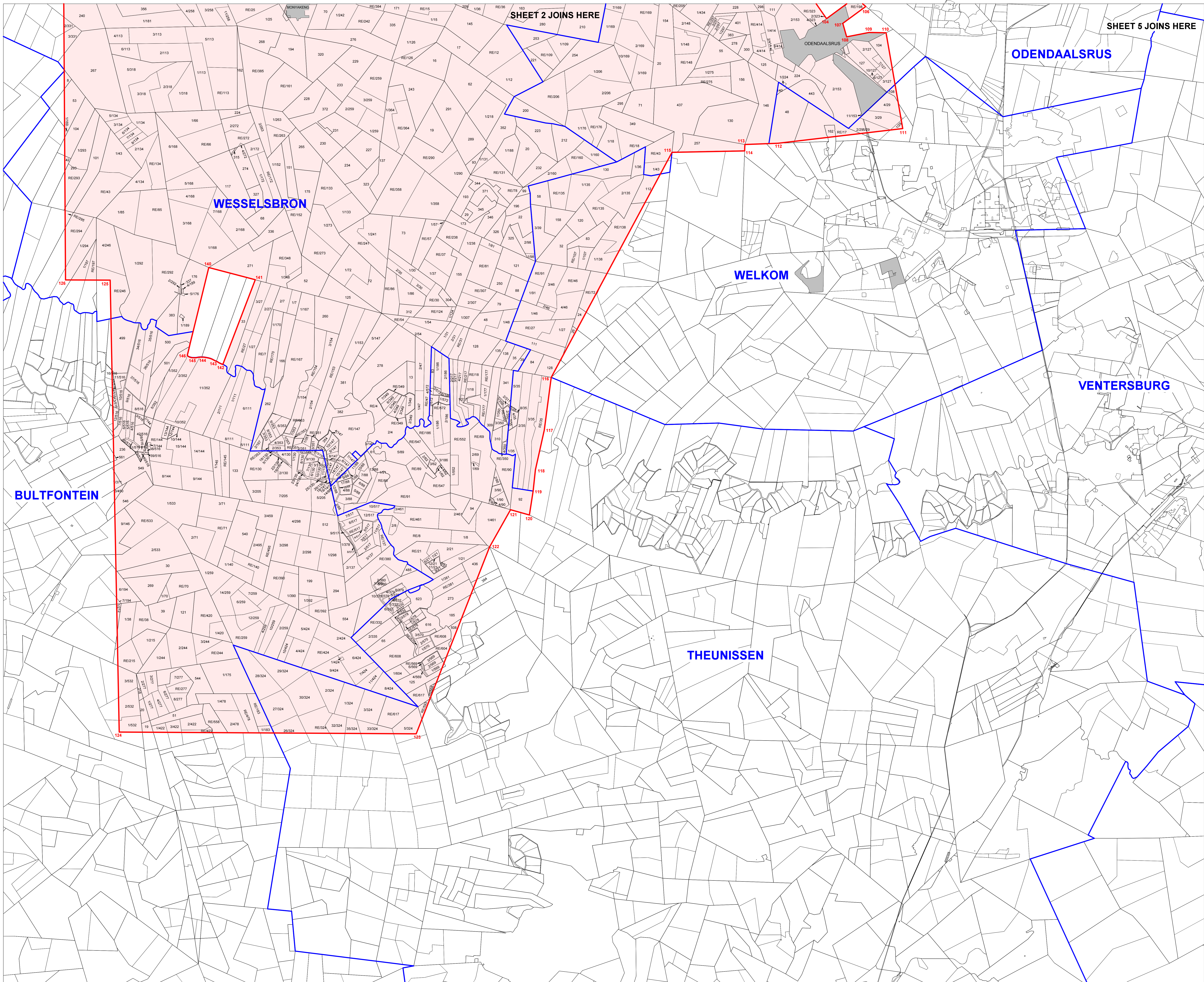

REGULATION 2(2) PLAN OF LAND UNDER APPLICATION FOR AN EXPLORATION RIGHT FOR OIL, GAS AND NATURAL GAS

PERMIT No. :
 PASA REFERENCE No. :
 SIGNATURE :
 DATE :

APPLICANT: **RHINO OIL & GAS EXPLORATION SOUTH AFRICA LTD**

SIGNATURE:
 DATE:

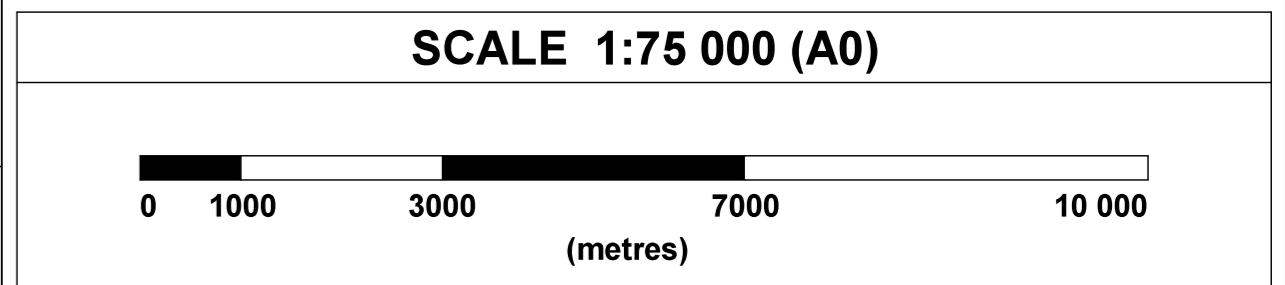
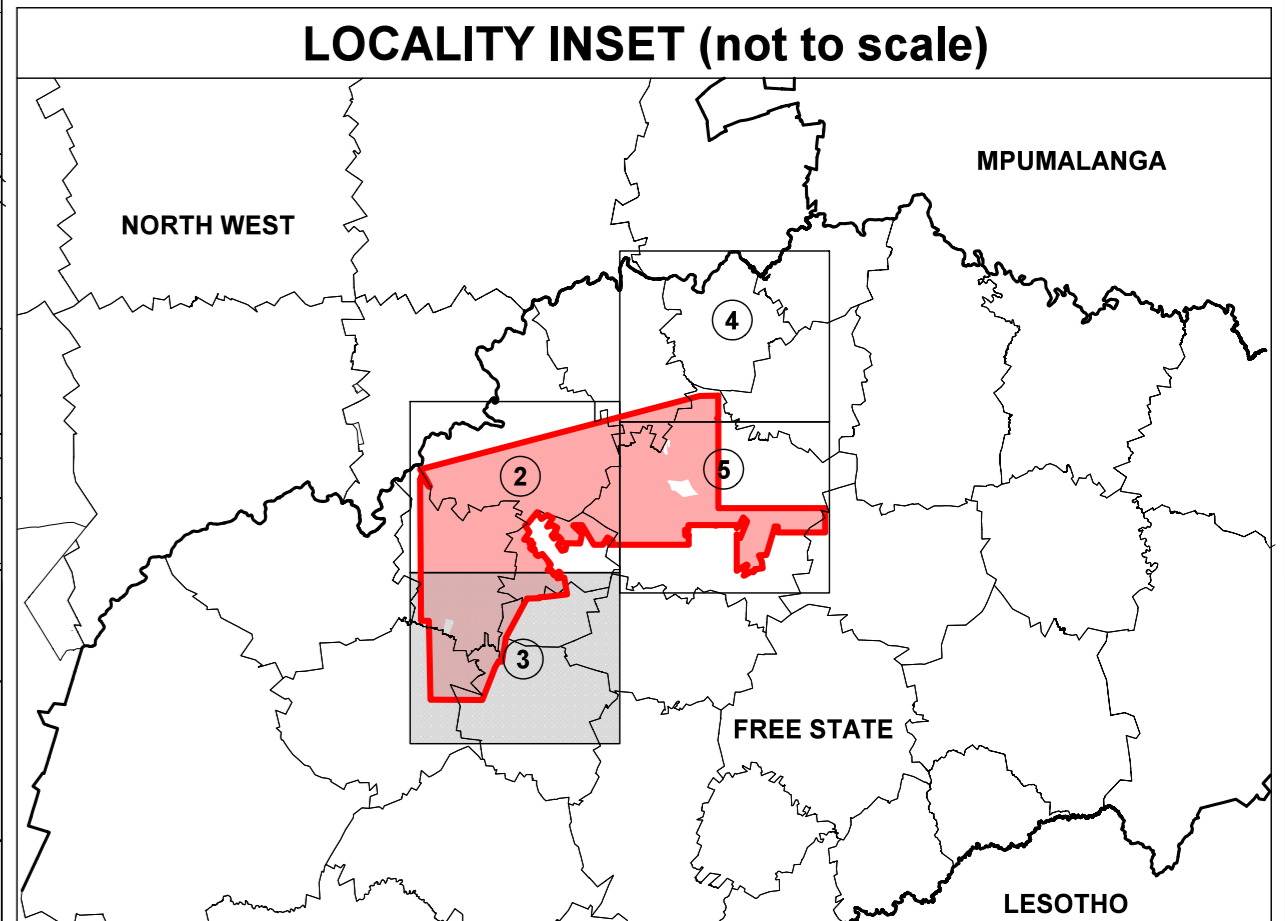
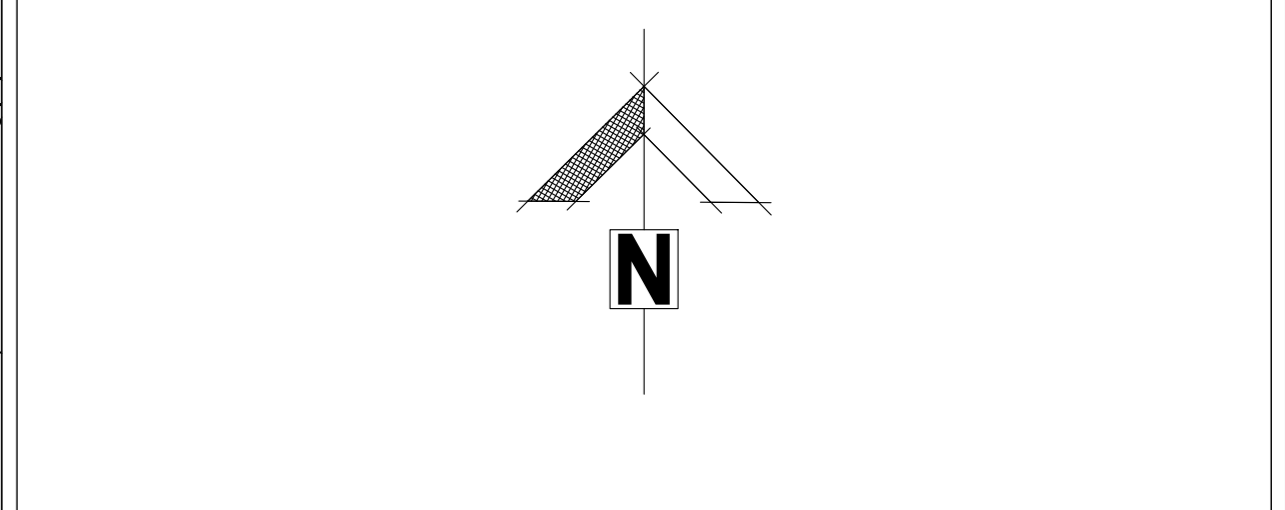

- LEGEND**
- denotes technical co-operation permit area
 - denotes farm portion boundary
 - denotes parent farms boundary
 - denotes Administrative District boundary
 - denotes Provincial boundary

AREA DESCRIPTION

The figure 1 to 31, middle of stream, 32, middle of stream, 33, middle of stream, 34, middle of stream, 35 to 139. Excluding the figure 140 to 142, middle of stream, 143, middle of stream, 144, middle of stream, 145, middle of stream, 146, and the figure 147 to 156, middle of stream, 157, and the figure 158 to 167, middle of stream, 168 to 174 represents 2647 farms and farm portions identified hereto together measuring approximately 6005 (six thousand and five) square kilometres of land situated partly in the Administrative Districts of Bothaville, Bultfontein, Kroonstad, Lindley, Odendaalsrus, Theunissen, Viljoenskroon, Welkom and Wesselsbron in the Province of Free State the subject of this application for a Technical Co-operation Permit in terms of Section 76 of the Mineral and Petroleum Resources Development Act 2002 (28 of 2002)

- NOTES**
1. All co-ordinates are in the Hartebeeshoek 94 datum - WG27
 2. All sides are number lines: i.e. lines of constant geographical direction.
 3. This plan was framed from information provided by the Petroleum Agency SA and the Chief Surveyor General

Prepared by: **R. C. ABRAHAMSE - PLS No. 0002**
 Professional Land Surveyor

In accordance with Regulation 2(2) of the regulations in terms of the Mining Titles Registration Act 16 of 1967, provided that the figure depicted and described on this plan, the area of the figure and the co-ordinates listed thereon are subject to change, as may be necessary, to conform to the requirements in respect of the definition of co-ordinated point, contained in regulation 3 of the regulations in terms of the Mining Titles Registration Act, 16 of 1967

PASA REFERENCE No. 12/2/108 & 109

Signature : *R. C. Abrahamse*

date	19 January 2022
scale	1 / 75 000 (A0)
drawing ref & no.	ER 318 (Rev. A) (M.B.)
drawing no.	Free State Precinct (sheet 3 of 14)

dh+a david hellig + abrahamse
 professional land surveyors
 2nd floor wale street chambers
 38 wale street, cape town
 Tel : +27 021 426 2613
 info@dhaa.co.za www.dhale.co.za

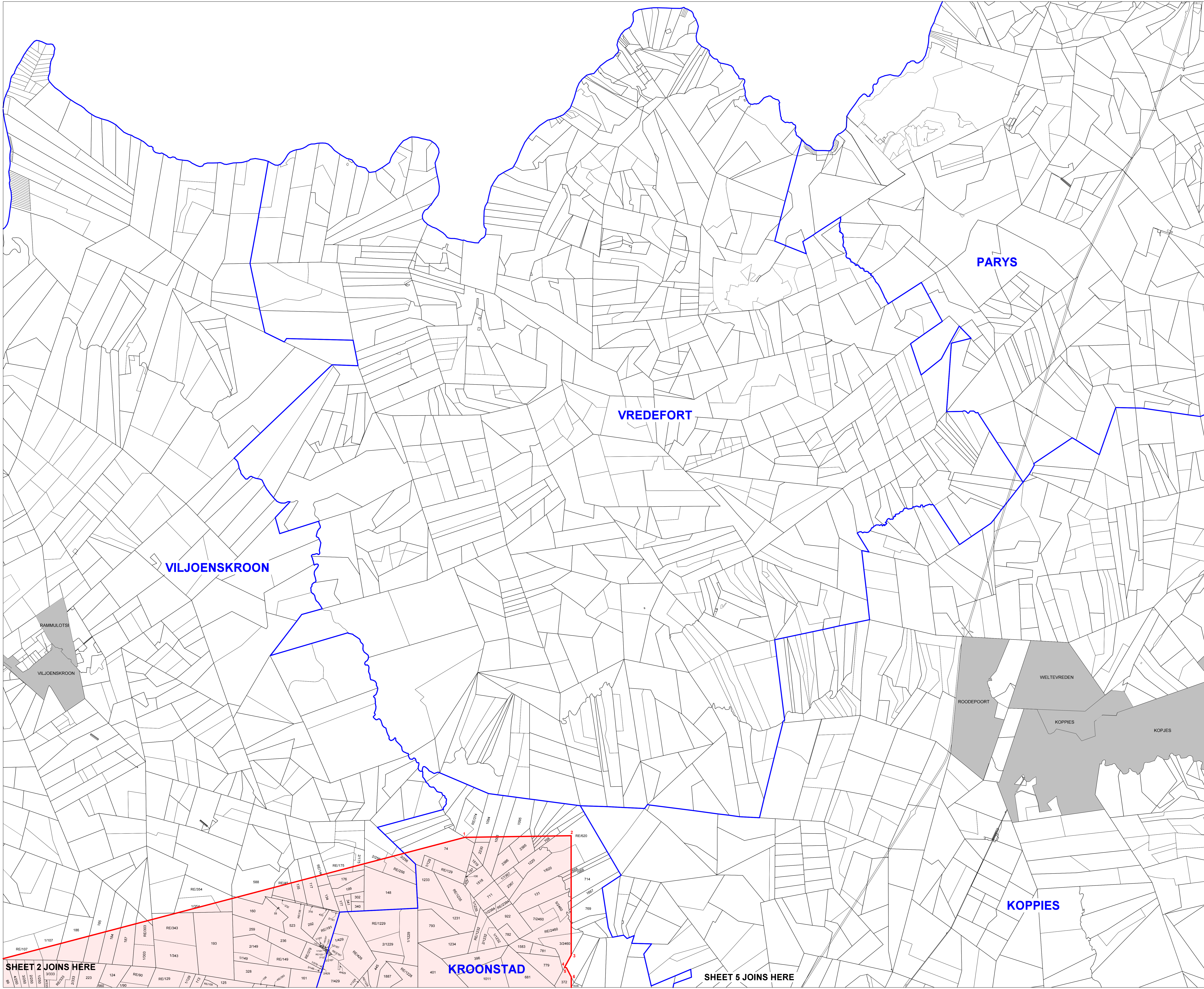

REGULATION 2(2) PLAN OF LAND UNDER APPLICATION FOR AN EXPLORATION RIGHT FOR OIL, GAS AND NATURAL GAS

PERMIT No. :
 PASA REFERENCE No. :
 SIGNATURE :
 DATE :
 CHIEF EXECUTIVE OFFICER PETROLEUM AGENCY SA : CAPE TOWN

APPLICANT:
RHINO OIL & GAS EXPLORATION SOUTH AFRICA LTD
 SIGNATURE:
 DATE:

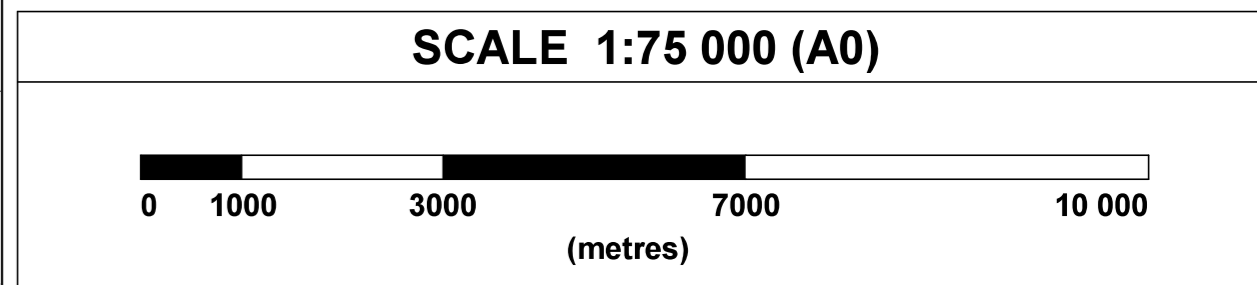
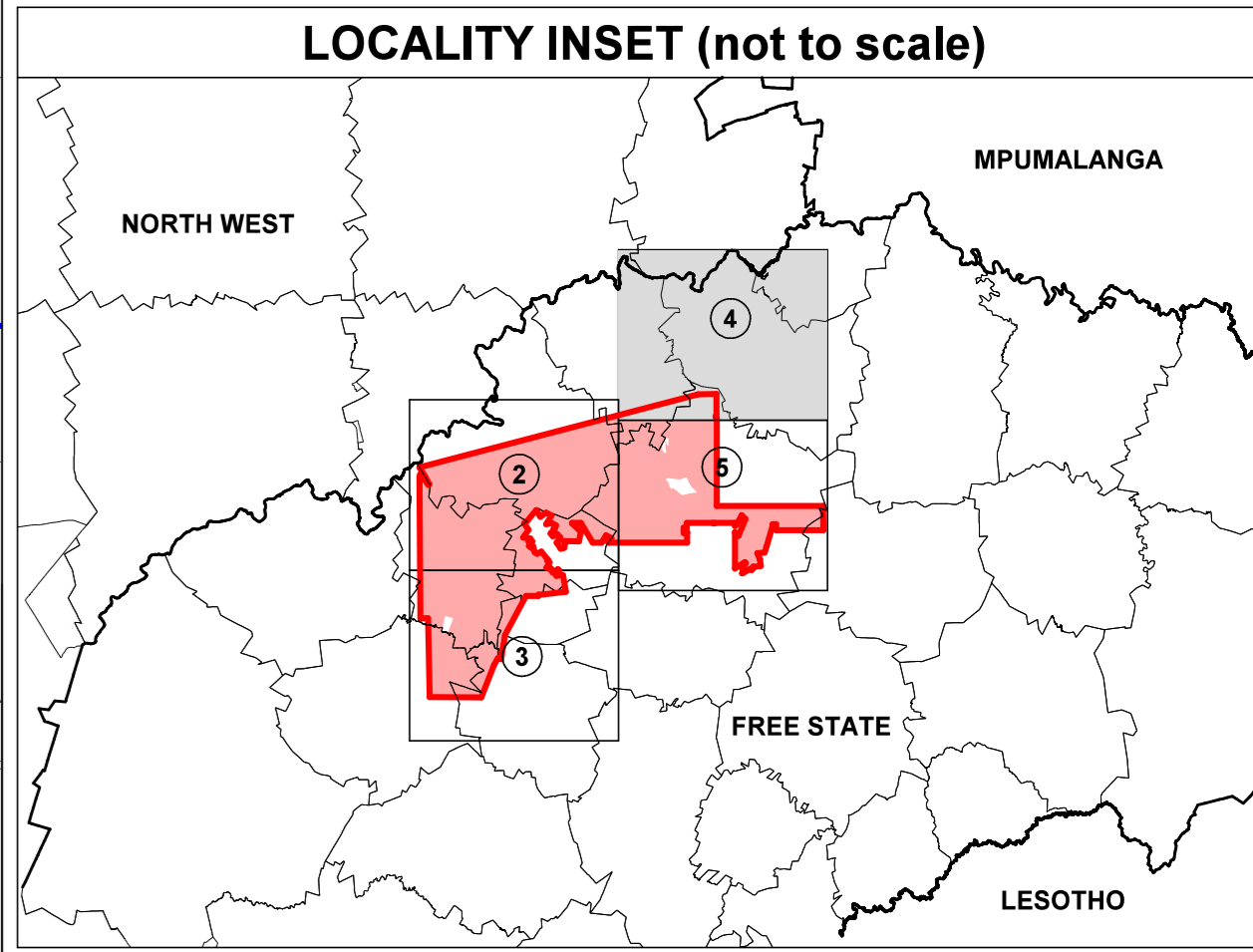
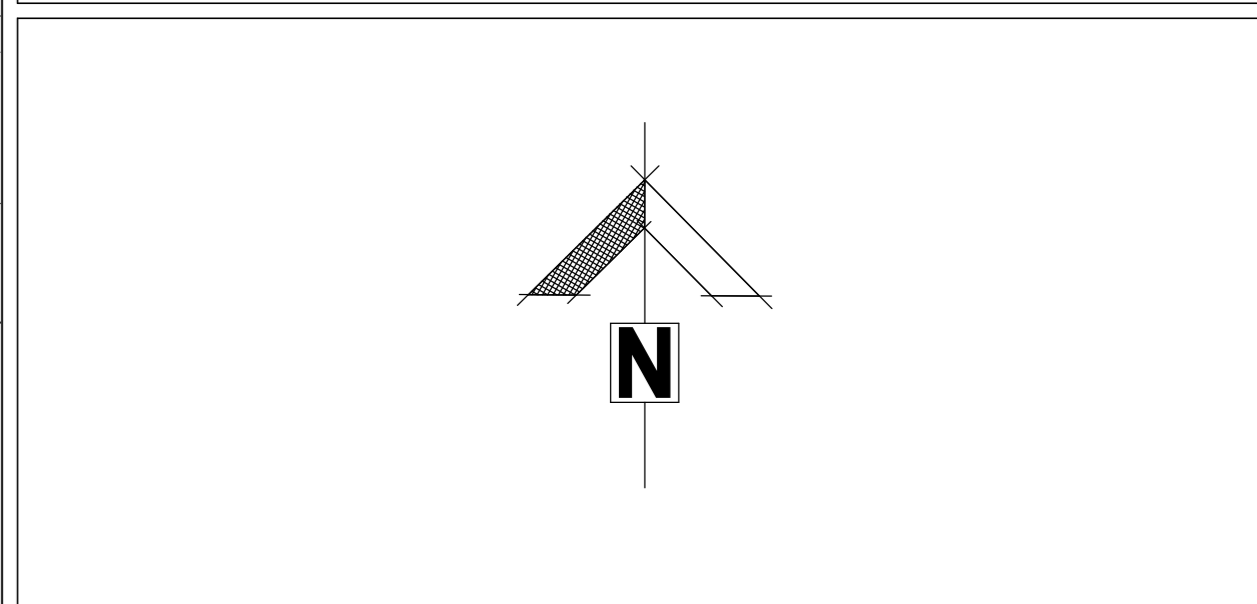

- LEGEND**
- denotes technical co-operation permit area
 - denotes farm portion boundary
 - denotes parent farms boundary
 - denotes Administrative District boundary
 - denotes Provincial boundary

AREA DESCRIPTION

The figure 1 to 31, middle of stream, 32, middle of stream, 33, middle of stream, 34, middle of stream, 35 to 139. Excluding the figure 140 to 142, middle of stream, 143, middle of stream, 144, middle of stream, 145, middle of stream, 146, and the figure 147 to 156, middle of stream, 157, and the figure 158 to 167, middle of stream, 168 to 174 represents 2647 farms and farm portions identified hereto together measuring approximately 6005 (six thousand and five) square kilometres of land situated partly in the Administrative Districts of Bothaville, Bullfontein, Kroonstad, Lindley, Odenaarus, Theunissen, Viljoenskroon, Welkom and Wesselsbron in the Province of Free State the subject of this application for a Technical Co-operation Permit in terms of Section 76 of the Mineral and Petroleum Resources Development Act 2002 (28 of 2002)

- NOTES**
1. All co-ordinates are in the Hartbeeshoek 94 datum - WGS27
 2. All sides are rhumb lines: i.e. lines of constant geographical direction.
 3. This plan was framed from information provided by the Petroleum Agency SA and the Chief Surveyor General

Prepared by: R. C. ABRAHAMSE - PLS No. 0002
 Professional Land Surveyor

in accordance with Regulation 2(2) of the regulations in terms of the Mining Titles Registration Act 16 of 1967, provided that the figure depicted and described on this plan, the area of the figure and the co-ordinates listed thereon are subject to change, as may be necessary, to conform to the requirements in respect of the definition of co-ordinated point, contained in regulation 3 of the regulations in terms of the Mining Titles Registration Act, 16 of 1967

PASA REFERENCE No. 12/2/108 & 109

Signature : *R. C. Abrahamse*

date	19 January 2022
scale	1 / 75 000 (A0)
drawing ref & no.	ER 318 (Rev. A) (M.B.)
drawing no.	Free State Precinct (sheet 4 of 14)

david hellig + abrahamse
 professional land surveyors
 2nd floor wale street chambers
 38 wale street, cape town
 Tel : +27 021 426 2613
 info@dhaa.co.za www.dhale.co.za

SHEET 2 JOINS HERE

SHEET 5 JOINS HERE

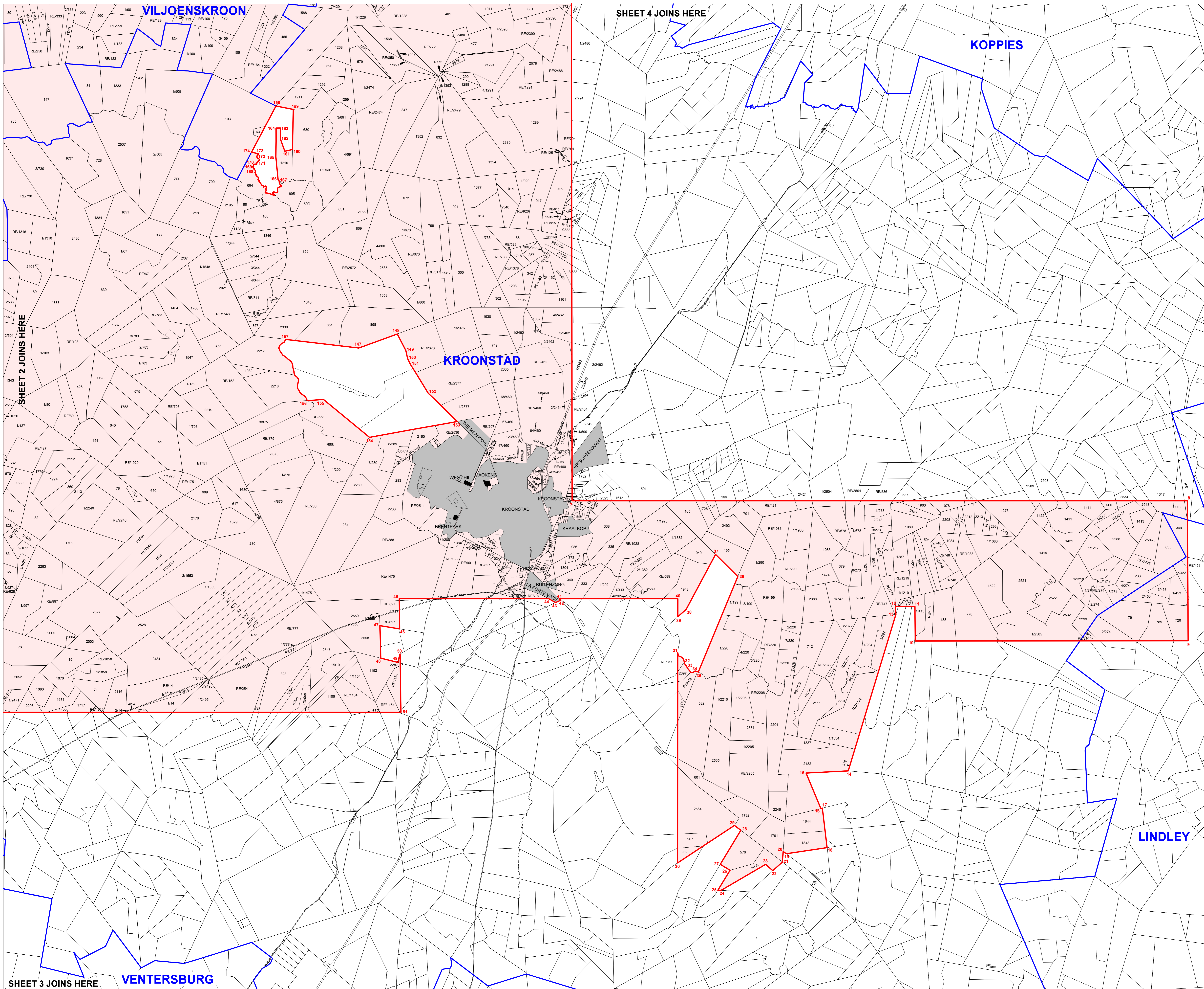

REGULATION 2(2) PLAN OF LAND UNDER APPLICATION FOR AN EXPLORATION RIGHT FOR OIL, GAS AND NATURAL GAS

PERMIT No. :

PASA REFERENCE No. :

SIGNATURE :

DATE :

CHIEF EXECUTIVE OFFICER PETROLEUM AGENCY SA : CAPE TOWN

APPLICANT:..... **RHINO OIL & GAS EXPLORATION SOUTH AFRICA LTD**

SIGNATURE:

DATE:

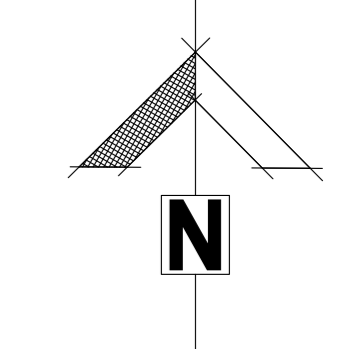

LOCALITY INSET (not to scale)

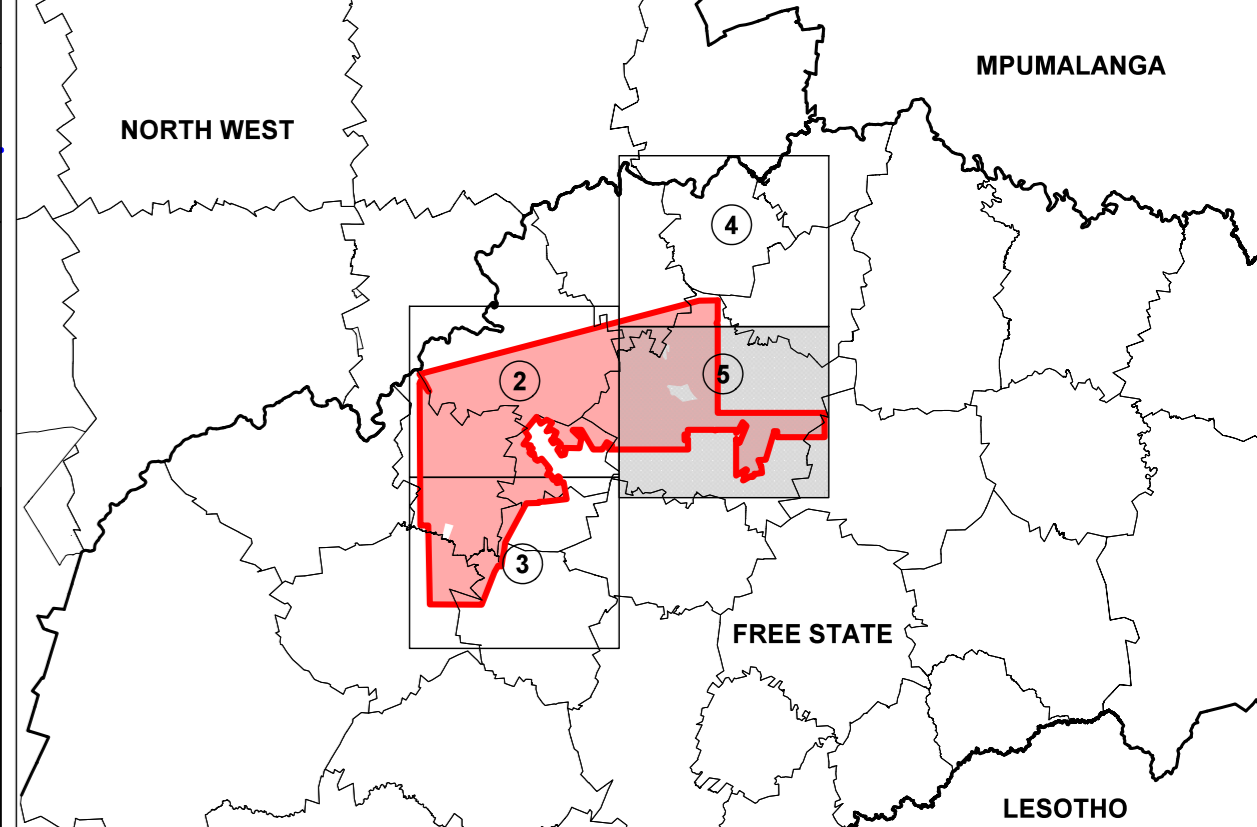

SCALE 1:75 000 (A0)

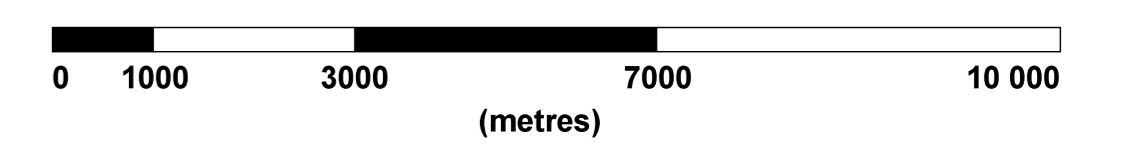

LEGEND

- denotes technical co-operation permit area
- denotes farm portion boundary
- denotes parent farms boundary
- denotes Administrative District boundary
- denotes Provincial boundary

AREA DESCRIPTION

The figure 1 to 31, middle of stream, 32, middle of stream, 33, middle of stream, 34, middle of stream, 35 to 139. Excluding the figure 140 to 142, middle of stream, 143, middle of stream, 144, middle of stream, 145, middle of stream, 146, and the figure 147 to 156, middle of stream, 157, and the figure 158 to 167, middle of stream, 168 to 174 represents 2647 farms and farm portions identified hereto together measuring approximately 6005 (six thousand and five) square kilometres of land situated partly in the Administrative Districts of Bothaville, Bullfontein, Kroonstad, Lindley, Odendaarsrus, Theunissen, Viljoenskroon, Welkom and Wesselsbron in the Province of Free State the subject of this application for a Technical Co-operation Permit in terms of Section 76 of the Mineral and Petroleum Resources Development Act 2002 (28 of 2002)

NOTES

1. All co-ordinates are in the Hartbeeshoek 94 datum - WGS27
2. All sides are rumb lines: i.e. lines of constant geographical direction.
3. This plan was framed from information provided by the Petroleum Agency SA and the Chief Surveyor General

Prepared by: R. C. ABRAHAMSE - PLS No. 0002 Professional Land Surveyor

in accordance with Regulation 2(2) of the regulations in terms of the Mining Titles Registration Act, 16 of 1967, provided that the figure depicted and described on this plan, the area of the figure and the co-ordinates listed thereon are subject to change, as may be necessary, to conform to the requirements in respect of the definition of co-ordinated point, contained in regulation 3 of the regulations in terms of the Mining Titles Registration Act, 16 of 1967

PASA REFERENCE No. 12/2/108 & 109

Signature : *R. C. Abrahamse*

date	19 January 2022
scale	1 / 75 000 (A0)
drawing ref & no.	ER 318 (Rev. A) (M.B.)
drawing no.	Free State Precinct (sheet 5 of 14)

david hellig + abrahamse
 professional land surveyors
 2nd floor wale street chambers
 38 wale street, cape town
 Tel: +27 021 426 2613
 info@dhaa.co.za www.dhale.co.za

SHEET 3 JOINS HERE VENTERSBURG

SHEET 4 JOINS HERE