

## Hylton Allison

---

**From:** Steven Mukhola [SMukhola@nwpg.gov.za]  
**Sent:** 18 January 2012 01:33 PM  
**To:** Hylton Allison  
**Subject:** Re: Proof of delivery of the amended PPM application form and PPM Tuschenkomst extended pit addendum EIA/EMP (in terms of the MPRDA process)

Received.

Thanks

>>> Hylton Allison <[hallison@slrconsulting.com](mailto:hallison@slrconsulting.com)> 11/18/2011 10:05 AM >>>  
Good morning Mr Mukhola

Please find attached the Proof of delivery of the amended PPM application form and PPM Tuschenkomst extended pit addendum EIA/EMP (in terms of the MPRDA process) to your offices yesterday.

**Hylton Allison**  
**Environmental Consultant**  
SLR Consulting (Africa) (Pty) Ltd

Email: [hallison@slrconsulting.com](mailto:hallison@slrconsulting.com)

Mobile: +27 82 789 2666

Tel: +27 11 467 0945

Fax: +27 11 467 0978

SLR Africa (Block 7)  
Fourways Manor Office Park  
2191, Cnr Roos and Macbeth Streets  
Fourways, Johannesburg  
South Africa, Johannesburg, 2060, South Africa



### Confidentiality Notice and Disclaimer

This communication and any attachment(s) contains information which is confidential and may also be legally privileged. It is intended for the exclusive use of the recipient(s) to whom it is addressed. If you are not the intended recipient, any disclosure, copying, distribution or any action taken or omitted to be taken in reliance on it, is prohibited and may be unlawful. If you have received this communication in error please email us by return mail and then delete the email from your system together with any copies of it. Please note that you are not permitted to print, copy, disclose or use part or all of the content in any way.

Emails and any information transmitted thereunder may be intercepted, corrupted or delayed. As a result, SLR does not accept any responsibility for any errors or omissions howsoever caused and SLR accepts no responsibility for changes made to this email or any attachment after transmission from SLR. Whilst all reasonable endeavours are taken by SLR to screen all emails for known viruses, SLR cannot guarantee that any transmission will be virus free.

Any views or opinions are solely those of the author and do not necessarily represent those of SLR Management Ltd, or any of its subsidiaries, unless specifically stated.

**PILANESBERG PLATINUM MINES (PTY) LTD**

**PILANESBERG PLATINUM MINE  
TUSCHENKOMST OPEN PIT EXTENSION PROJECT**

**ENVIRONMENTAL IMPACT ASSESSMENT AND  
ENVIRONMENTAL MANAGEMENT PROGRAMME**

**DMR REFERENCE NUMBER: NW30/5/1/2/2/320MR**

**This is to certify that I  
Stephen Mukhola**

*Stephen Mukhola* .....

**in my capacity as a representative of**

.....North West Department of Economic Development, Environment,.....

.....Conservation and Tourism .....

**have received the following documents:**

**Please tick box:**

<b>1 hard copy (consisting of 2 files each) and 1 electronic copy (CD) of the Environmental Impact Assessment and Environmental Management Programme report for the Pilanesberg Platinum Mines</b>	<input checked="" type="checkbox"/>
--	-------------------------------------

**Signature:** *Stephen Mukhola*

**Date:** 17/11/2011

To whom it may concern, please sign and stamp as proof of receipt.



the DEDECT

Department:  
Economic Development, Environment, Conservation and Tourism  
North West Provincial Government  
Republic of South Africa

Agricentre Building  
Cnr. Dr. James Moroka &  
Stadium Road  
Private Bag X2039,  
Mmabatho. 2735

**DIRECTORATE: ENVIRONMENTAL  
QUALITY & PROTECTION**

Tel: (018) 389 5959/ 5156  
Fax: (018) 389 5006  
Smukhola@nwpg.gov.za

**APPLICATION FORM FOR ENVIRONMENTAL AUTHORISATION**

File Reference Number:  
NEAS Reference Number:  
Date Received:

(For official use only)

Application for authorisation in terms of the National Environmental Management Act, 1998 (Act No. 107 of 1998), as amended and the Environmental Impact Assessment Regulations, 2010

**PROJECT TITLE**

**THE PROPOSED CONSTRUCTION OF SURFACE INFRASTRUCTURE AND THE EXPANSION OF THE SURFACE AREA OF THE TUSCHENKOMST OPENCAST PIT AT PILANESBERG PLATINUM MINES**

**Kindly note that:**

1. This application form is current as of 2 August 2010. It is the responsibility of the applicant to ascertain whether subsequent versions of the form have been published or produced by the competent authority.
2. The application must be typed within the spaces provided in the form. The sizes of the spaces provided are not necessarily indicative of the amount of information to be provided. Spaces are provided in tabular format and will extend automatically when each space is filled with typing.
3. Where applicable **black out** the boxes that are not applicable in the form.
4. Incomplete applications may be returned to the applicant for revision.
5. The use of the phrase "not applicable" in the form must be done with circumspection. Should it be done in respect of material information required by the competent authority for assessing the application, it may result in the rejection of the application as provided for in the Regulations.
6. This application must be handed in at the offices of the relevant competent authority as determined by the Act and regulations.
7. No faxed or e-mailed applications will be accepted.
8. Unless protected by law, all information filled in on this application will become public information on receipt by the competent authority. Any interested and affected party should be provided with the information contained in this application on request, during any stage of the application process.

*K.C. SHABANE* 17/11/2011 08:08



the DEDECT

Department:  
Economic Development, Environment, Conservation and Tourism  
North West Provincial Government  
Republic of South Africa

Agricentre Building  
Cnr. Dr. James Moroka &  
Stadium Road  
Private Bag X2039,  
Mmabatho. 2735

**DIRECTORATE: ENVIRONMENTAL  
QUALITY & PROTECTION**

Tel: (018) 389 5959/ 5156  
Fax: (018) 389 5006  
Smukhola@nwpg.gov.za

**APPLICATION FORM FOR ENVIRONMENTAL AUTHORISATION**

File Reference Number:  
NEAS Reference Number:  
Date Received:

(For official use only)

Application for authorisation in terms of the National Environmental Management Act, 1998 (Act No. 107 of 1998), as amended and the Environmental Impact Assessment Regulations, 2010

**PROJECT TITLE**

**THE PROPOSED CONSTRUCTION OF SURFACE INFRASTRUCTURE AND THE EXPANSION OF THE SURFACE AREA OF THE TUSCHENKOMST OPENCAST PIT AT PILANESBERG PLATINUM MINES**

**Kindly note that:**

1. This application form is current as of 2 August 2010. It is the responsibility of the applicant to ascertain whether subsequent versions of the form have been published or produced by the competent authority.
2. The application must be typed within the spaces provided in the form. The sizes of the spaces provided are not necessarily indicative of the amount of information to be provided. Spaces are provided in tabular format and will extend automatically when each space is filled with typing.
3. Where applicable **black out** the boxes that are not applicable in the form.
4. Incomplete applications may be returned to the applicant for revision.
5. The use of the phrase "not applicable" in the form must be done with circumspection. Should it be done in respect of material information required by the competent authority for assessing the application, it may result in the rejection of the application as provided for in the Regulations.
6. This application must be handed in at the offices of the relevant competent authority as determined by the Act and regulations.
7. No faxed or e-mailed applications will be accepted.
8. Unless protected by law, all information filled in on this application will become public information on receipt by the competent authority. Any interested and affected party should be provided with the information contained in this application on request, during any stage of the application process.

Queries must be addressed to the contact hereunder:

**Departmental Details/Provincial Authority**

<p><b>Postal address:</b>                  Department of Agriculture, Conservation, Environment and Rural Development                  Attention: Director: Environmental Quality and Protection                  Private Bag X2039                  Mmabatho                  2735</p> <p><b>Physical address:</b>                  Department of Agriculture, Conservation, Environment and Rural Development                  Agricentre Building                  Cnr. Dr. James Moroka &amp; Stadium Road                  Mmabatho                  2735</p> <p>Queries should be directed to the Directorate: Environmental Quality and Protection at:</p> <p>Tel: 018-389 5959/5156                  Fax: 018-389 5006</p> <p><b>Applications to be couriered for attention Mr. NS Mukhola Office E10</b></p>
---

**SITE IDENTIFICATION AND LINKAGE**

Please indicate all the Surveyor-general 21 digit site (erf/farm/portion) reference numbers for all sites (including portions of sites) that are part of the application.

T	0	J	Q	0	0	0	0	0	0	0	0	0	0	0	2	0	0	0	0	0
T	0	J	Q	0	0	0	0	0	0	0	0	0	0	4	6	0	0	0	0	1
T	0	J	P	0	0	0	0	0	0	0	0	0	1	3	3	0	0	0	0	0
T	0	J	Q	0	0	0	0	0	0	0	0	0	0	4	8	0	0	0	0	0
T	0	J	P	0	0	0	0	0	0	0	0	0	1	3	6	0	0	0	R	E
T	0	J	P	0	0	0	0	0	0	0	0	0	1	3	4	0	0	0	0	0

(if there are more than 6, please attach a list with the rest of the numbers)

(These numbers will be used to link various different applications, authorisations, permits etc. that may be connected to a specific site)

# PROJECT TITLE

**THE PROPOSED CONSTRUCTION OF SURFACE INFRASTRUCTURE AND THE EXPANSION OF THE SURFACE AREA OF THE TUSCHENKOMST OPENCAST PIT AT PILANESBERG PLATINUM MINES**

## 1. BACKGROUND INFORMATION

Project applicant:	<b>Pilanesberg Platinum Mines (Pty) Ltd</b>		
Trading name (if any):			
Contact person:	<b>Mr Dean Riley</b>		
Physical address:	<b>6 Ecofusion Office Park, Block B, 324 Witch-hazel Ave., Highveld Park X59, 0157</b>		
Postal address:	<b>Private Bag X11, Highveld</b>		
Postal code:	<b>0067</b>	Cell:	<b>+2782 802 2981</b>
Telephone:	<b>+2712 661 4280</b>	Fax:	<b>+2712 661 4139</b>
E-mail:	<b>DRiley@platmin.com</b>		

Landowner:	<b>Republic of South Africa and the Bakgatla Ba-Kgafala tribe (See Appendix A)</b>		
Contact person:			
Postal address:			
Postal code:		Cell:	
Telephone:		Fax:	
E-mail:			

In instances where there is more than one landowner, please attach a list of landowners with their contact details to this application. (See Appendix A). Landowner notification contained in Appendix B.

Local authority in whose jurisdiction the proposed activity will fall:	<b>Moses Kotane Local Municipality</b>		
Nearest town or districts:	<b>Mogwase</b>		
Contact person:	<b>Mr Tikologo Mokhoana</b>		
Postal address:	<b>Private Bag 1011, Mogwase</b>		
Postal code:	<b>0314</b>	Cell:	<b>+2779 507 3883</b>
Telephone:	<b>+2714 5551312</b>	Fax:	<b>+2786 508 1866</b>
E-mail:	<b>Tikologo@moseskotane.gv.za</b>		

In instances where there is more than one local authority involved, please attach a list of local authorities with their contact details to this application.



## 2. ACTIVITIES APPLIED FOR TO BE AUTHORISED

For an application for authorisation that involves more than one listed or specified activity that, together, make up one development proposal, all the listed activities pertaining to this application must be indicated.

Indicate the number and date of the relevant notice:      Activity No (s) (in terms of the relevant notice) :      Describe each listed activity as per project description<sup>1</sup>:

544, 02 August 2010	11	<i>PPM will construct a diversion berm around the extended open pit, a storm water channel and two 30m wide bridges within 32m of the Wilgespruit River and its tributary.</i>
	12	<i>PPM proposes to construct two storm water control dams at the base of the Sedibelo waste rock dump and each dam will have the capacity to hold more than 100 000 cubic meters of storm water at any one time.</i>
	18	<i>PPM will remove and deposit more than 5 cubic meters of infilling material into the Wilgespruit River and its tributary for the construction of two 30m wide bridges.</i>
	22	<i>PPM has proposed three possible alternatives to divert the P50-1 Provincial Road. Either of the proposed diversions will have a width in excess of 9m. PPM will also construct a 30m wide haul road for the hauling of waste rock on surface.</i>
	47	<i>PPM will extend their existing 30m wide haul road network by 7-10km</i>
545, 02 August 2011	15	<i>PPM proposes to develop and transform the following surface areas by more than 20hectares: the open pit extension (approximately 170 hectares), the footprint of the proposed tailings storage facility wall (approximately 71 hectares), the proposed waste rock dump (approximately 184 hectares), the proposed road diversion (&gt;160ha) and the proposed haul road (approximately 30 hectares).</i>
	5	<i>The changes to the waste rock dump, the open pit and the storm water management system at the existing mine will require an amendment to the current water use license application.</i>
	19	<i>PPM proposes to construct of one storm water dam on the site. The highest part of the dam wall, as measured from the outside toe of the wall to the highest part of the wall, will be less than 5 metres and the high-water mark of the dam will cover an area of approximately 10 hectares.</i>
546, 02 August 2011	3	<i>PPM proposes to construct one - three 16m high communications mast within the North West Province. This communications tower will be located outside any urban areas and this mast will be within a distance of 5km from the Pilaesberg National Park.</i>
	4	<i>PPM proposes to construct diversion and haul roads that will be wider than 16m and 30m wide respectively. These roads will be located within a distance of 5km from the Pilaesberg National Park.</i>
	14	<i>PPM proposes to clear more than 5ha of indigenous vegetation (i.e.</i>

<sup>1</sup> Please note that this description should not be a verbatim repetition of the listed activity as contained in the relevant Government Notice, but should be a brief description of activities to be undertaken as per the project description

		<i>75% and more of this vegetation cover constitutes indigenous vegetation) within the North West Province outside of an urban area as follows: PPM proposes to develop and transform the following surface areas by more than 20hectares: the open pit extension (approximately 170 hectares), the footprint of the proposed tailings storage facility wall (approximately 71 hectares), the proposed waste rock dump (approximately 184 hectares), the proposed road diversion (&gt;160ha) and the proposed haul road (approximately 30 hectares).</i>
	19	<i>PPM proposes to extend its 16m wide road diversion by 5-10km and its 30m wide haul roads by up to 10km. These roads will be located within a distance of 5km from the Pilanesberg National Park.</i>

Please note that any authorisation that may result from this application will only cover activities specifically applied for.

### 3. SOCIO-ECONOMIC BENEFITS

3.1 What is the expected capital value to be contributed for North West Province Growth Domestic Product?

This information is not available at this stage of the project.

3.2 How many new employment opportunities will be created in the development phase?

No new employment opportunities will be created but it should be noted that the extension of the pit will prolong the life of the mining operation by six years and so ensure continued employment for existing employees.

3.3 How many permanent employment opportunities will be created during operational phase?

No new employment opportunities will be created but it should be noted that the extension of the pit will prolong the life of the mining operation by six years and so ensure continued employment for existing employees.

### 4. OTHER AUTHORISATIONS REQUIRED

4.1 DO YOU NEED ANY AUTHORISATIONS IN TERMS OF ANY OF THE FOLLOWING LAWS?

- 4.1.1 National Environmental Management: Waste Act
- 4.1.2 National Environmental Management: Air Quality Act
- 4.1.3 National Environmental Management: Protected Areas Act
- 4.1.4 National Environmental Management: Biodiversity Act
- 4.1.5 Mineral Petroleum Development Resources Act
- 4.1.6 National Water Act
- 4.1.7 National Heritage Resources Act
- 4.1.8 Other (please specify)

Yes  No   
 No   
 No   
 No   
Yes   
Yes   
Yes   
 No

4.2 Have such applications been lodged already?

Yes

### 5 ACTIVITY POSTITIONS



Indicate the position of the activity using the latitude and longitude of the centre point of the site for each alternative site. The co-ordinates should be in degrees and decimal minutes. The minutes should have at least three decimals to ensure adequate accuracy. The projection that must be used in all cases is the WGS84 spheroid in a national or local projection.

List alternative sites, if applicable.

**Co-ordinates of the proposed activity sites:  
Open Pit extension**

**Alternative:** **Latitude (S):** **Longitude (E):**

Alternative S1<sup>2</sup> (preferred or only site alternative)

-25	5.795		27	0.475	
-----	-------	--	----	-------	--

Alternative S2 (if any)

--	--	--	--	--	--

Alternative S3 (if any)

--	--	--	--	--	--

**Co-ordinates of the proposed activity sites:**

**Latitude (S):** **Longitude (E):**

**Mineral abandonment area on the Wilgespruit farm (telecommunications tower, bridge, road, storm water infrastructure)**

**Alternative:**

Alternative S1<sup>3</sup> (preferred or only site alternative)

-25	5.716		27	1.039	
-----	-------	--	----	-------	--

Alternative S2 (if any)

--	--	--	--	--	--

Alternative S3 (if any)

--	--	--	--	--	--

**In the case of linear activities:**

**Alternative: Proposed Roads**

**Latitude (S):** **Longitude (E):**

Alternative S1 (preferred or only route alternative)

- Starting point of the activity
- Middle/Additional point of the activity
- End point of the activity

-25	3.337		26	55.733	
-25	2.545		26	57.920	
-25	2.545		26	59.546	

<sup>2</sup> "Alternative S.." refer to site alternatives.  
<sup>3</sup> "Alternative S.." refer to site alternatives.

Alternative S2 (if any)

- Starting point of the activity
- Middle/Additional point of the activity
- End point of the activity

---

-25	6.774		27	0.396	
-25	7.330		27	0.790	
-25	7.170		27	1.640	

Alternative S3 (if any)

- Starting point of the activity
- Middle/Additional point of the activity
- End point of the activity

-25	6.594		26	59.805	
-25	8.208		27	0.842	
-25	7.368		27	2.179	

**Site Location: See Appendix C for the locality Plan**

6. DECLARATIONS

6.1 The Applicant

I Dean Ruel declare that I -  
• am, or represent<sup>4</sup>, the applicant in this application;

- have appointed / will appoint (delete that which is not applicable) an environmental assessment practitioner to act as the independent environmental assessment practitioner for this application / will obtain exemption from the requirement to obtain an environmental assessment practitioner<sup>5</sup>;
- will provide the environmental assessment practitioner and the competent authority with access to all information at my disposal that is relevant to the application;
- will be responsible for the costs incurred in complying with the Environmental Impact Assessment Regulations, 2010, including but not limited to –
  - costs incurred in connection with the appointment of the environmental assessment practitioner or any person contracted by the environmental assessment practitioner;
  - costs incurred in respect of the undertaking of any process required in terms of the Regulations;
  - costs in respect of any fee prescribed by the Minister or MEC in respect of the Regulations;
  - costs in respect of specialist reviews, if the competent authority decides to recover costs; and
  - the provision of security to ensure compliance with conditions attached to an environmental authorisation, should it be required by the competent authority;
- will ensure that the environmental assessment practitioner is competent to comply with the requirements of these Regulations and will take reasonable steps to verify whether the EAP complies with the Regulations;
- will inform all registered interested and affected parties of any suspension of the application as well as of any decisions taken by the competent authority in this regard;
- am responsible for complying with the conditions of any environmental authorisation issued by the competent authority;
- hereby indemnify the Government of the Republic, the competent authority and all its officers, agents and employees, from any liability arising out of the content of any report, any procedure or any action which the applicant or environmental assessment practitioner is responsible for in terms of these Regulations;
- will not hold the competent authority responsible for any costs that may be incurred by the applicant in proceeding with an activity prior to obtaining an environmental authorisation or prior to an appeal being decided in terms of these Regulations;
- will perform all other obligations as expected from an applicant in terms of the Regulations;  
all the particulars furnished by me in this form are true and correct; and
- I realise that a false declaration is an offence in terms of regulation 71 and is punishable in terms of section 24F of the Act.



Signature of the applicant<sup>6</sup>/ Signature on behalf of the applicant:

**Pilanesberg Platinum Mines (Pty) Ltd**

Name of company (if applicable):

Date: 16 NOVEMBER 2011

<sup>4</sup> If this is signed on behalf of the applicant, proof of such authority from the applicant must be attached.

<sup>5</sup> If exemption is obtained from appointing an EAP, the responsibilities of an EAP will automatically apply to the person conducting the environmental impact assessment in terms of the Regulations.

<sup>6</sup> If the applicant is a juristic person, a signature on behalf of the applicant is required as well as proof of such authority. An EAP may not sign on behalf of an applicant.

**APPENDIX A: LANDOWNER DETAILS (INCLUDING CONTACT DETAILS)**

**Land Portion/s:** Rooderand 46 JQ Portion 1 (T8993/191BP), Witkleifontein 136 JP (T11640/1937BP), Bierkraal 134 JP (T9309/1938BP)  
**Landowner Owner:** Republic of South Africa c/o Department of Land Affairs

**Contact Person:** Ms Jacqueline Nkosi  
**Postal address:** PO Box 3955 Brits  
**Postal Code:** 0250  
**Telephone:** 012-252 3505  
**Cell:** 082 313 1334  
**Fax:** 012-252 4100  
**E-mail:** JKNKOSI@DLA.GOV.ZA

**Land Portion/s:** Wilgespruit 2JQ (T1230/1919BP), Welwaagd 133 JQ (T10729/1926), Legkraal 45 JQ (T17606/1935BP)  
**Landowner Owner:** Bakgatla Ba-Kgafela tribe

**Contact Person:** Mr Kgosi Pilane  
**Postal address:** PO Box 200 Saulspoort  
**Postal Code:** 0318  
**Telephone:** 014 556 1889/1751  
**Cell:**  
**Fax:** 014 556 1716  
**E-mail:** [bbkta@worldonline.co.za](mailto:bbkta@worldonline.co.za)

## **APPENDIX B: LANDOWNERS DETAILS OF NOTIFICATION**

Pilanesberg Platinum Mines contacted the following landowners telephonically and the proof of consultation is contained below:

RECEIVED BY: Bm MOLOPE - CEO. BAKGATLA.

DATE: 29/09/2011

SIGNATURE: [Handwritten Signature]



27 September 2011

**BAKGATLA-BA-KGAFELA TRIBAL AUTHORITY  
SAULSPOORT  
ATTENTION: DR MISHACK MOLOPE (ADVISOR TO KGOSI PILANE)  
CC: MR LESTER NAPIER**

**LANDOWNER NOTIFICATION  
ENVIRONMENTAL ASSESSMENT PROCESS FOR VARIOUS MINING DEVELOPMENTS IN THE  
MOSES KOTANE LOCAL MUNICIPALITY**

Dear Dr Molope

**1. INTRODUCTION**

Following our telephone conversation earlier today, this letter serves as formal notification for various mining related Environmental Impact Assessments (EIAs) that will take place in the Moses Kotane Local Municipality of the North West Province. Further detail on the proposed projects is included below and the local setting is illustrated in Appendix A.

**1.1. PILANESBERG PLATINUM MINE – TUSCHENKOMST PIT EXTENSION**

Introduction to the proposed activities

Pilanesberg Platinum Mine (PPM) holds a mining right and currently operates an existing opencast platinum mine on the farms Tuschenkomst 135 JP and Witkleifontein 136 JP. As part of the proposed project, PPM is planning to extend the Tuschenkomst Pit and stormwater management infrastructure, enlarge the footprint of the existing waste rock dump, and establish a communications tower and construct a bridge over the Wilgespruit River. In addition, it is proposed that the provincial P50-1 be diverted around the pit extension area. At this stage of the EIA, a number of possible routes for the road diversion are being considered.

Farms and landownership

The farms that will be affected by the proposed pit expansion project, and the relevant landowner details, are included in Table 1 below.

**Table 1: Farms that will be affected by the proposed Tuschenkomst Pit Extension and Road Diversion**

Farm	Portion	Title deed number	Landowner
Wilgespruit 2 JQ	The farm*	T1230/1919BP	Bakgatla-Ba-Kgafela Tribe
Welgewaagd 133 JP	Remaining Extent	T10729/1926	Bakgatla Tribe
Rooderand 46 JQ	1	T8993/191BP	Republic of South Africa
	2	T16014/1971BP	
	3	T3648/1940BP	
Legkraal 45 JQ	The farm	T17606/1935BP	
Tuschenkomst 135 JP	The farm	T594/1938BP	
Bierkraal 134 JP	The farm	T9309/1938BP	

\* Note: In an agreement between PPM and the Itereleng Bakgatla Mineral Resources (IBMR), PPM will utilise the western portion of the farm Wilgespruit 2 JQ for its mining operations. This area is known as the Mineral Rights Abandonment Area (see Appendix A).

## 1.2. SEDIBELO PLATINUM MINE – CHANGES TO SURFACE INFRASTRUCTURE AT THE MINE

### Introduction to the proposed activities

The Itereleng Bakgatla Mineral Resources (IBMR) hold the mining right and are in the process of developing an opencast and underground platinum mine on the farm Wilgespruit 2 JQ. As part of the proposed project, the IBMR plans to reposition and/or redesign the approved infrastructure and include additional infrastructure to better access the ore reserves, particularly in the ore reserves in the eastern portion of the mining right area.

### Farms and landownership

The farms that will be affected as part of the proposed project, and the relevant landowner details, are included in Table 2.

**Table 2: Farms that will be affected by the project at Sedibelo Platinum Mine**

Farm	Portion	Title deed number	Landowner
Wilgespruit 2 JQ	The farm*	T1230/1919BP	Bakgatla-Ba-Kgafela Tribe
Koedoesfontein 42 JQ	The farm	T5841/1919BP	Palane Tchinangoe
Rooderand 46 JQ	1	T8993/191BP	Republic of South Africa
Legkraal 45 JQ	The farm	T17606/1935BP	

## 1.3. MAGAZYNSKRAAL PROJECT – ESTABLISHMENT OF AN UNDERGROUND PLATINUM MINING OPERATION

### Introduction to the proposed activities

Richtrau No 123 (Pty) Ltd (Richtrau) holds prospecting rights for the farm Magazynskraal 3 JQ. As part of the proposed project, it is planned to submit a mining right application and develop an underground mining operation on Magazynskraal 3 JQ. At this stage various options are being considered for mineral processing, such as: a) utilise infrastructure on the neighbouring Sedibelo Platinum Mine; and b) establish a processing plant and related infrastructure on Magazynskraal 3 JQ.

Farms and landownership

The farms that will be affected as part of the proposed project, and the relevant landowner details, are included in Table 3 below.

**Table 3: Farms that will be affected by the Magazynskraal Project**

Farm	Portion	Title deed number	Landowner
Magazynskraal 3 JQ	The farm	T56447/2000 (by endorsement)	Republic of South Africa

## 2. ENVIRONMENTAL PROCESS

SLR Consulting (Africa) (previously Metago Environmental Engineers (Pty) Ltd), an independent consulting firm, has been appointed to conduct the EIAs for these projects. It is planned that the three above-mentioned projects will operate as a combined mining operation, and therefore Metago is proposing to conduct one environmental process to cover the three projects. However, as each mining/prospecting right is currently held by a different party, a separate set of documents will be produced to support each right. In this regard, a scoping report will be produced for each project; PPM will require an EIA/EMP amendment to cater for the extended pit; Sedibelo will require an EIA/EMP amendment to cater for the changes and additions to surface infrastructure; and Magazynskraal will require an EIA/EMP to cater for the proposed activities.

As the landowner, and land user, for a number of the properties that will be affected by the proposed developments, the Bakgatla-Ba-Kgafela Tribe (care of the Tribal Authority) will receive all future information and documentation related to the proposed projects.

Should you wish to discuss any aspect of the proposed projects please feel free to contact us.

Regards



Hylton Allison (PrSciNat)  
(PPM Project Manager)



Linda Munro (PrSciNat)  
(Sedibelo Project Manager)



Fiona Bolton (EAP)  
(Magazynskraal Project Manager)

For SLR Consulting (Africa) (Pty) Ltd



**Appendix A: Figure showing the local setting of the proposed developments**

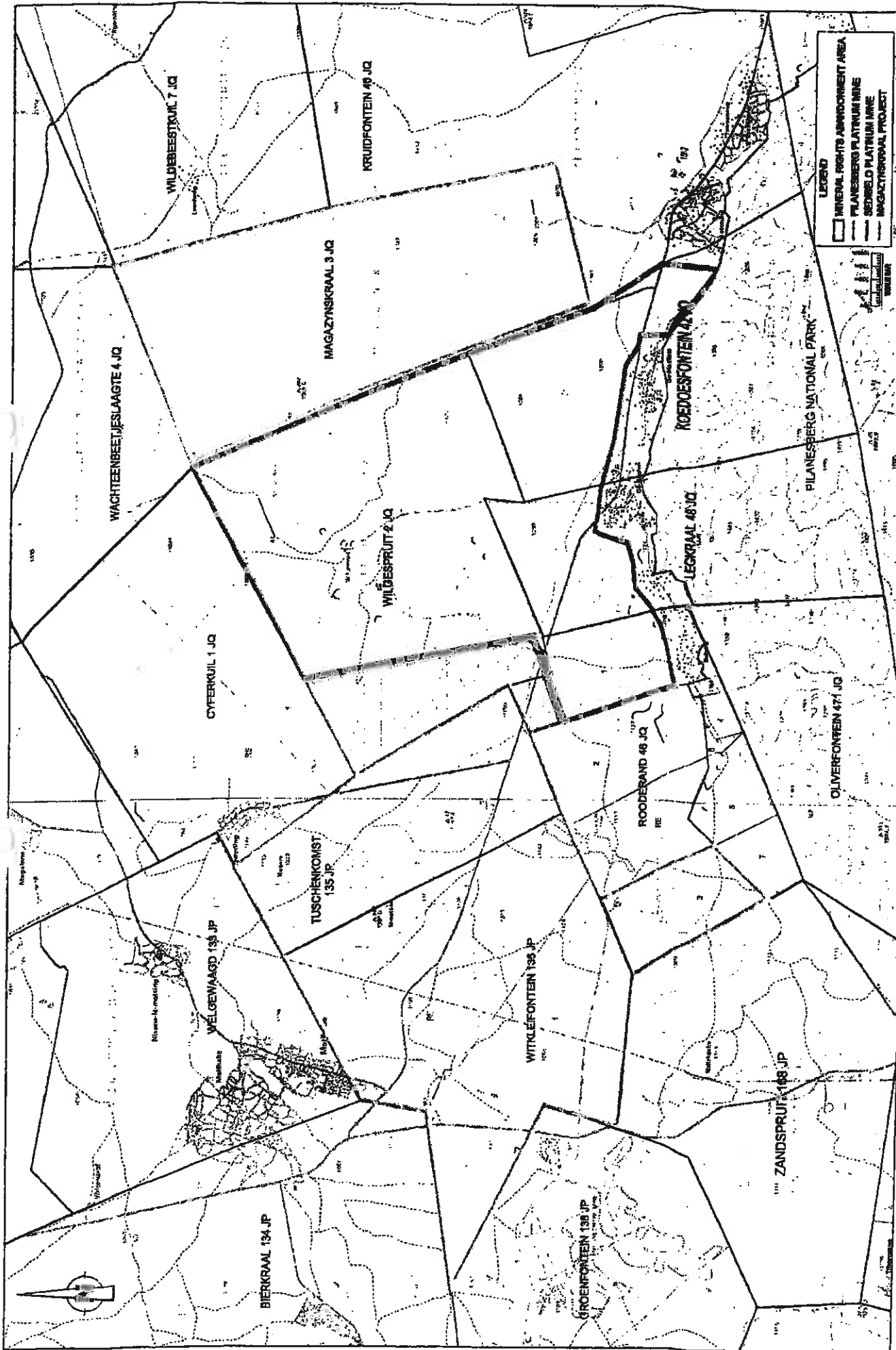

**LEGEND**

- MINERAL RIGHTS ADJACENT AREA
- ▬ PILANESBERG PLATINUM MINE
- ▬ BEDIBELO PLATINUM MINE
- ▬ MAGAZYNKRAAL PROJECT

LOCALITY PLAN SHOWING MINING RIGHT AREAS FOR  
 PILANESBERG PLATINUM MINE, BEDIBELO PLATINUM MINE AND  
 THE MAGAZYNKRAAL PROJECT

Date :	10/2011	Scale :	A8 SHOWN
Project No :	B001-03 & B007-19	APPENDIX A	



**Mataba Environmental Engineers (Pty) Ltd**  
 Consulting Engineers & Scientists

NOTE FOR CONCEPTUAL USE ONLY

Please stamp/sign and return as proof of delivery.

RECEIVED BY: NKOSI Jacqueline  
DATE: 29/09/2011  
SIGNATURE: [Signature]

SLR

27 September 2011

DEPARTMENT OF RURAL DEVELOPMENT AND LAND REFORM  
76 VAN VELDEN STREET  
BRITS  
ATTENTION: MS JACQUELINE NKOSI

LANDOWNER NOTIFICATION  
ENVIRONMENTAL ASSESSMENT PROCESS FOR VARIOUS MINING DEVELOPMENTS IN THE  
MOSES KOTANE LOCAL MUNICIPALITY

Dear Jacqueline

1. INTRODUCTION

Following our telephone conversation earlier today, this letter serves as formal notification for various mining related Environmental Impact Assessments (EIAs) that will take place in the Moses Kotane Local Municipality of the North West Province. Further detail on the proposed projects is included below and the local setting is illustrated in Appendix A.

1.1. PILANESBERG PLATINUM MINE – TUSCHENKOMST PIT EXTENSION

Introduction to the proposed activities

Pilanesberg Platinum Mine (PPM) holds a mining right and currently operates an existing opencast platinum mine on the farms Tuschenkomst 135 JP and Witkleifontein 136 JP. As part of the proposed project, PPM is planning to extend the Tuschenkomst Pit and stormwater management infrastructure, enlarge the footprint of the existing waste rock dump, and establish a communications tower and construct a bridge over the Wilgespruit River. In addition, it is proposed that the provincial P50-1 be diverted around the pit extension area. At this stage of the EIA, a number of possible routes for the road diversion are being considered.

Farms and landownership

The farms that will be affected by the proposed pit expansion project, and the relevant landowner details, are included in Table 1 below.

**Table 1: Farms that will be affected by the proposed Tuschenkomst Pit Extension and Road Diversion**

Farm	Portion	Title deed number	Landowner
Wilgespruit 2 JQ	The farm*	T1230/1919BP	Bakgatla-Ba-Kgafela Tribe
Welgewaagd 133 JP	Remaining Extent	T10729/1926	Bakgatla Tribe
Rooderand 46 JQ	1	T8993/191BP	Republic of South Africa
	2	T16014/1971BP	
	3	T3648/1940BP	
Legkraal 45 JQ	The farm	T17606/1935BP	
Tuschenkomst 135 JP	The farm	T594/1938BP	
Bierkraal 134 JP	The farm	T9309/1938BP	

\* Note: In an agreement between PPM and the Itereleng Bakgatla Mineral Resources (IBMR), PPM will utilise the western portion of the farm Wilgespruit 2 JQ for its mining operations. This area is known as the Mineral Rights Abandonment Area (see Appendix A).

### 1.2. SEDIBELO PLATINUM MINE – CHANGES TO SURFACE INFRASTRUCTURE AT THE MINE

#### Introduction to the proposed activities

The Itereleng Bakgatla Mineral Resources (IBMR) hold the mining right and are in the process of developing an opencast and underground platinum mine on the farm Wilgespruit 2 JQ. As part of the proposed project, the IBMR plans to reposition and/or redesign the approved infrastructure and include additional infrastructure to better access the ore reserves, particularly in the ore reserves in the eastern portion of the mining right area.

#### Farms and landownership

The farms that will be affected as part of the proposed project, and the relevant landowner details, are included in Table 2.

**Table 2: Farms that will be affected by the project at Sedibelo Platinum Mine**

Farm	Portion	Title deed number	Landowner
Wilgespruit 2 JQ	The farm*	T1230/1919BP	Bakgatla-Ba-Kgafela Tribe
Koedoesfontein 42 JQ	The farm	T5841/1919BP	Palane Tchinangoe
Rooderand 46 JQ	1	T8993/191BP	Republic of South Africa
Legkraal 45 JQ	The farm	T17606/1935BP	

### 1.3. MAGAZYNSKRAAL PROJECT – ESTABLISHMENT OF AN UNDERGROUND PLATINUM MINING OPERATION

#### Introduction to the proposed activities

Richtrau No 123 (Pty) Ltd (Richtrau) holds prospecting rights for the farm Magazynskraal 3 JQ. As part of the proposed project, it is planned to submit a mining right application and develop an underground mining operation on Magazynskraal 3 JQ. At this stage various options are being considered for mineral processing, such as: a) utilise infrastructure on the neighbouring Sedibelo Platinum Mine; and b) establish a processing plant and related infrastructure on Magazynskraal 3 JQ.

Farms and landownership

The farms that will be affected as part of the proposed project, and the relevant landowner details, are included in Table 3 below.

**Table 3: Farms that will be affected by the Magazynskraal Project**

Farm	Portion	Title deed number	Landowner
Magazynskraal 3 JQ	The farm	T56447/2000 (by endorsement)	Republic of South Africa

## 2. ENVIRONMENTAL PROCESS

SLR Consulting (Africa) (previously Metago Environmental Engineers (Pty) Ltd), an independent consulting firm, has been appointed to conduct the EIAs for these projects. It is planned that the three above-mentioned projects will operate as a combined mining operation, and therefore Metago is proposing to conduct one environmental process to cover the three projects. However, as each mining/prospecting right is currently held by a different party, a separate set of documents will be produced to support each right. In this regard, a scoping report will be produced for each project; PPM will require an EIA/EMP amendment to cater for the extended pit; Sedibelo will require an EIA/EMP amendment to cater for the changes and additions to surface infrastructure; and Magazynskraal will require an EIA/EMP to cater for the proposed activities.

As the landowner for a number of the properties that will be affected by the proposed developments, the Republic of South Africa (care of the Department of Rural Development and Land Reform) will receive all future information and documentation related to the proposed projects.

Should you wish to discuss any aspect of the proposed projects please feel free to contact us.

Regards



Hylton Allison (PrSciNat)  
(PPM Project Manager)



Linda Munro (PrSciNat)  
(Sedibelo Project Manager)



Fiona Bolton (EAP)  
(Magazynskraal Project Manager)

*For SLR Consulting (Africa) (Pty) Ltd*

**Appendix A: Figure showing the local setting of the proposed developments**

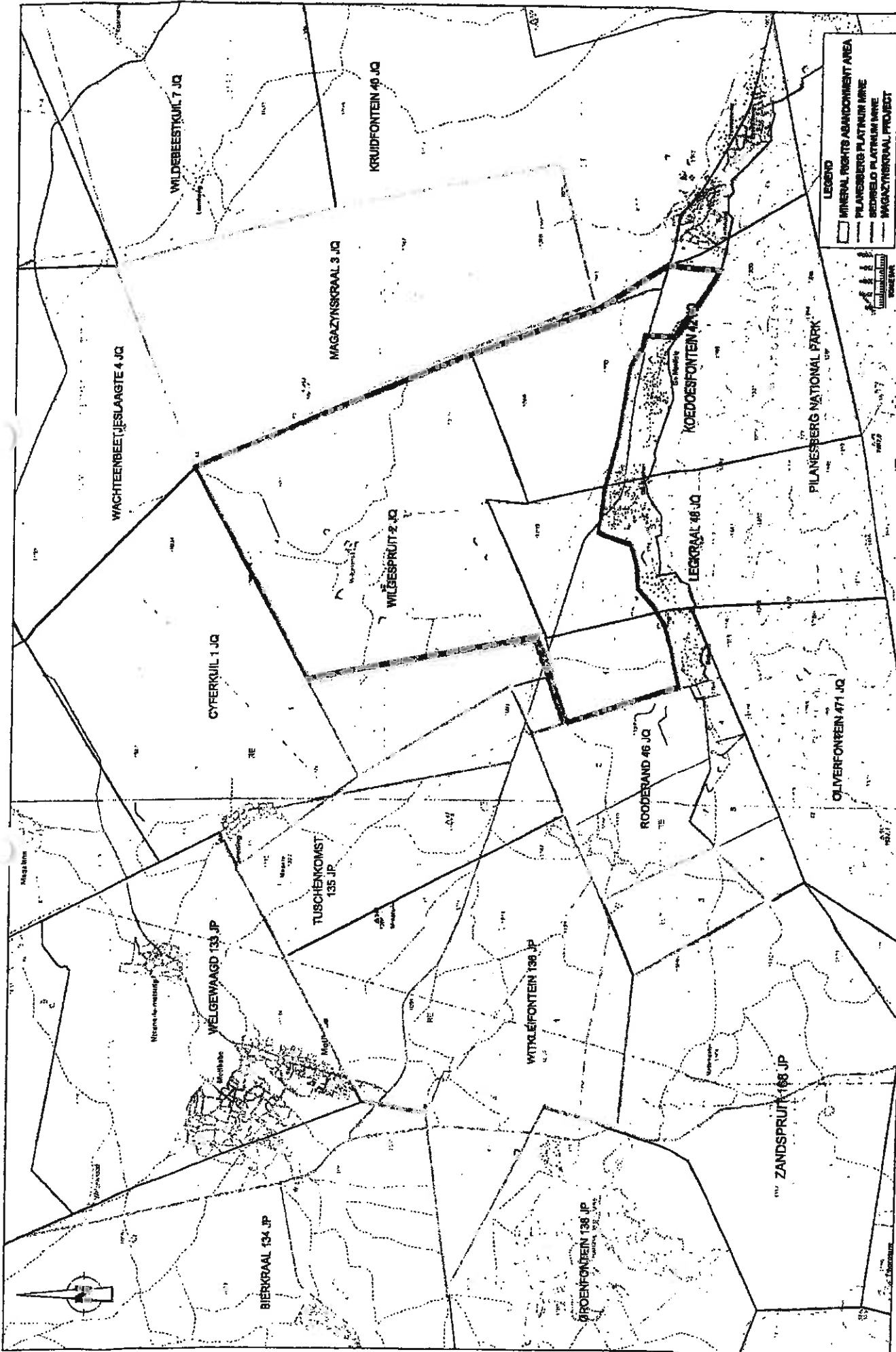

**Mtshago Environmental Engineers (Pty) Ltd**  
 Consulting Engineers & Scientists

LOCALITY PLAN SHOWING MINING RIGHT AREAS FOR  
 PILANESBERG PLATINUM MINE, SEDIBELO PLATINUM MINE AND  
 THE MAGAZYNSKRAAL PROJECT

Date : 10/2011 Scale : AS SHOWN  
 Project No : B007-08 & B007-19 APPENDIX A

NOTE FOR CONCEPTUAL USE ONLY

APPENDIX C: LOCALITY PLAN





APPENDIX C: LOCALITY PLAN

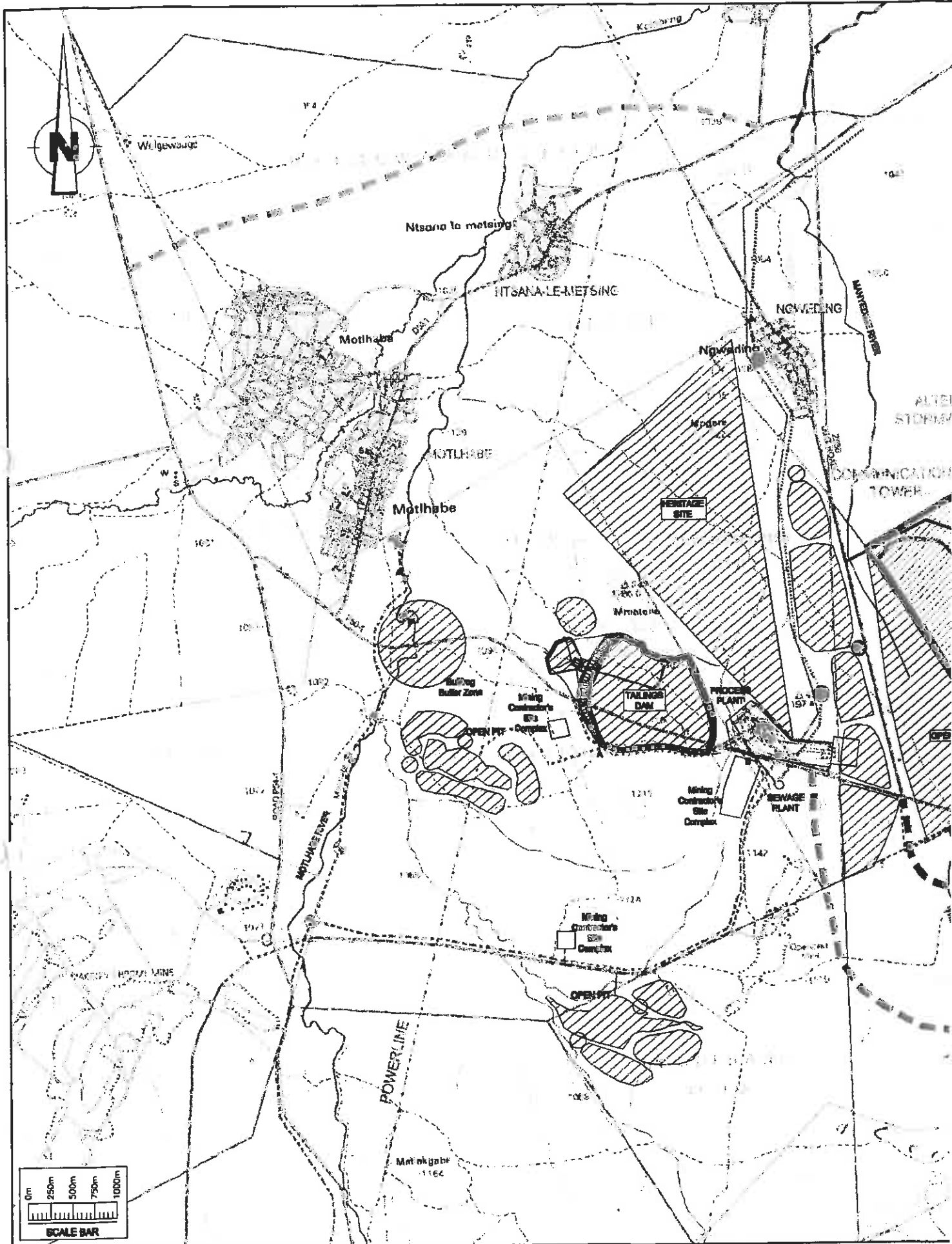

**SLR Consulting (Africa) (Pty) Ltd**  
 GLOBAL ENVIRONMENTAL SOLUTIONS

**EXTENSION O  
 AND DIVERSION C**

NOTE: MAP FOR CONCEPTUAL USE ONLY