

STANDS TO BE SITUATED ON:	
STAND *	STAND *
STAND *	STAND *
STAND *	STAND *
STAND *	STAND *
STAND *	STAND *
STAND *	STAND *
STAND *	STAND *
STAND *	STAND *
STAND *	STAND *
STAND *	STAND *
STAND *	STAND *
STAND *	STAND *
STAND *	STAND *
STAND *	STAND *
STAND *	STAND *
STAND *	STAND *
TO BE CONFIRMED	

NOTE KEY:

- *HP - HEAT PUMP
- W.C - WATER CLOSET
- W.H.B - WASH HAND BASIN
- *SH - SHOWER
- W/M - WASHING MACHINE
- R.C - REINFORCED CONCRETE
- B.I.C - BUILT IN CUPBOARD
- *DP - DOWN PIPE POSITION ON ROOF

FLOOR PLAN
SCALE 1:50

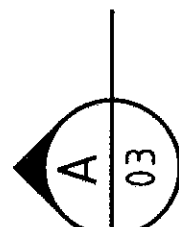
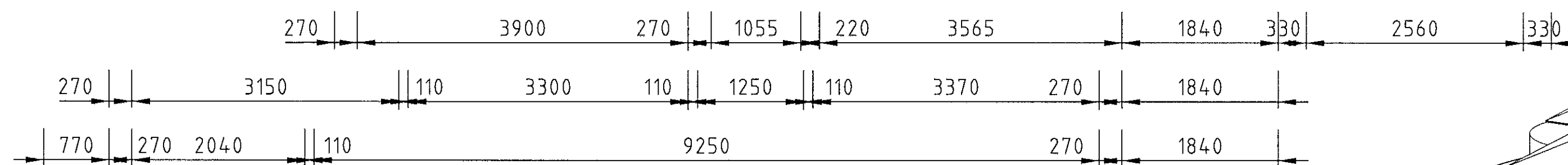

FENESTRATION	
FENESTRATION CALCULATIONS REQUIRED IF TOTAL AREA OF WINDOWS IS GREATER THAN 15% OF THE HOUSE AREA	
AREA OF HOUSE	= 82.220m ²
TARGETED 15%	= 12.333m ²
AREA OF WINDOWS	= <u>10.800m²</u>
FENESTRATION CALC. IS NOT REQUIRED	

BUILDER'S FLOOR AREA

GROUND STOREY	=	82.220m2
CAR PORT & STORE	=	20.160m2
OPEN PATIO	=	14.900m2
TOTAL FLOOR AREA	=	117.280m2

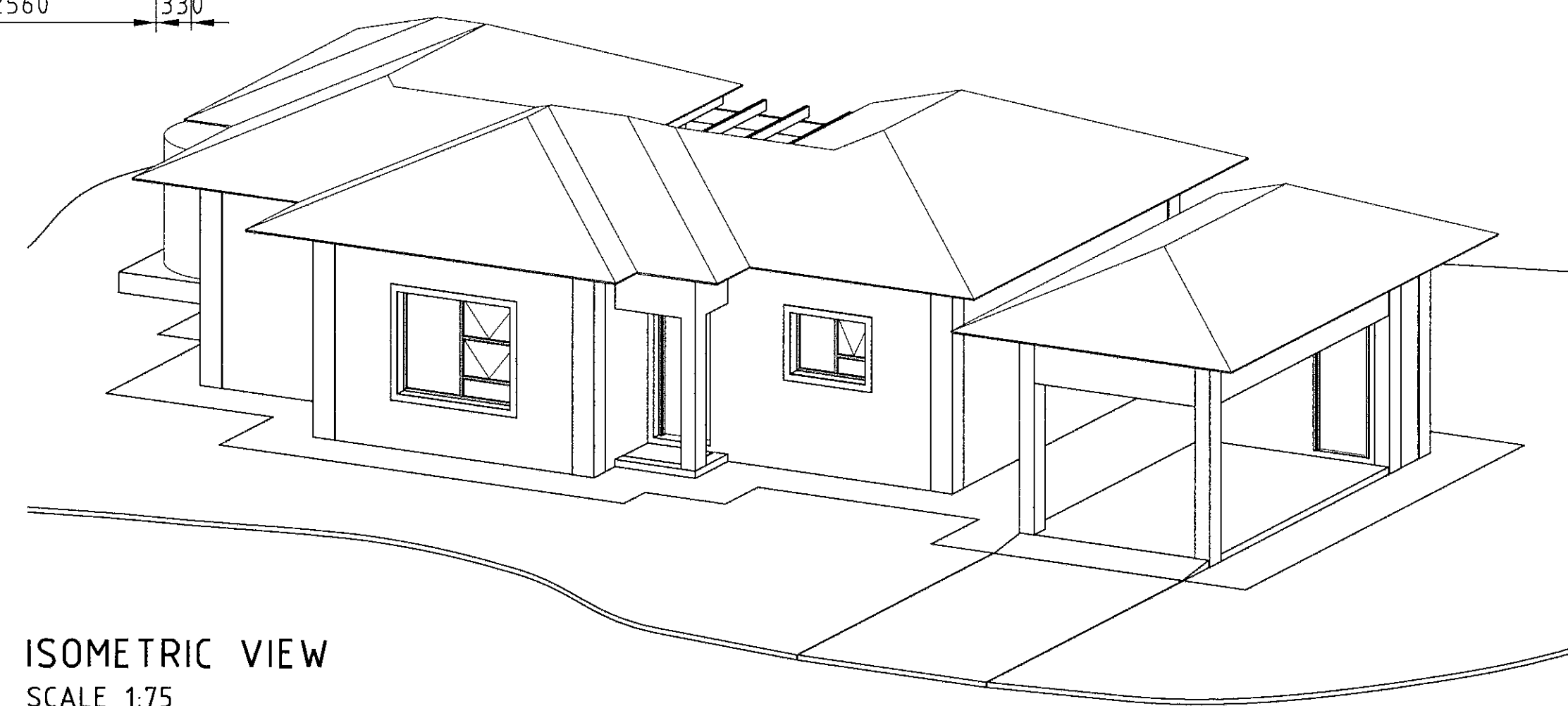
[illegible]

NOTES:

1. UNLESS INDICATED, ALL DIMENSIONS ARE IN mm.
2. ALL DRAWINGS TO BE READ IN CONJUNCTION WITH RELEVANT DESIGN CRITERIA AND SPECIFICATION DOCUMENTS.

NOTES





1. DO NOT SCALE DRAWING - ONLY DIMENSIONS SHOWN TO BE USED.

2. THE CONTRACTOR SHALL VERIFY ALL CONDITIONS, DIMENSIONS AND LEVELS ON THE SITE AND NOTIFY THE NEC SUPERVISOR OF ANY VARIATIONS BEFORE CONSTRUCTION.

0C	CLIENT REVIEW				2013-04-30
0A	CLIENT REVIEW	JA	MP	PM	2013-04-10
0B	CLIENT REVIEW	JA	MP	PM	2013-03-14
NO.	DESCRIPTION	BY	CHKD	APPD	DATE

REVISIONS

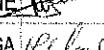
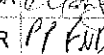
This Document including all design and information therein is Confidential Intellectual Property of Transmitt. Copyright and all other rights are reserved by Transmitt. This Document may only be used for its intended purpose.

CONTRACTOR / CONSULTANT					TRANSNET CAPITAL PROJECTS				
TITLE	NAME	SIGN	DATE		TITLE	NAME	SIGN	DATE	
DRAWN	J ABRANTES		13 04 05						
CHECKED	M PEREIRA		13 04 30						
DISC.LEAD	M.FOURIE		13 04 30						
ENG.MANAGER	P.MASINGA		13 08 20						
PROJECT MGR	H.BESTER		13 04 30						
OPERATING DIVISIONS									
TITLE	NAME	SIGN	DATE						
				.	PR.ENG. / PR.TECH./PR. ARCH				
				.	NAME			DATE	
				.	SIGNATURE				
				.	REG. NUMBER				
				.	SCALE:		1:50		

<h2 style="margin: 0;">H339473-3811-40-042-0002-001</h2>	
<h3 style="margin: 0;">Transnet Capital Projects</h3>	
<small>TRANSNET LTD (TRADING AS TRANSNET CAPITAL PROJECTS) : REG. NO. 1980000000006</small>	
<h3 style="margin: 0;">237 MAHATMA GANDHI ROAD</h3>	
DURBAN TEL: 031 361 1696	P.O. BOX 1073, DURBAN FAX: 0866 770815
<h2 style="margin: 0;">TFR POSTMASBURG HOUSING</h2>	
<h3 style="margin: 0;">HOUSE TYPE 2 - 2 BEDROOM UNIT</h3>	
<h3 style="margin: 0;">GROUND STOREY PLAN AND ISOMETRIC</h3>	
<h3 style="margin: 0;">ARRANGEMENT GENERAL</h3>	

H339473-3-811-A-GA-0002-04-0B	ELEVATIONS
H339473-3-811-A-GA-0002-03-0B	SECTION A-A AND SCHEDULES
H339473-3-811-A-GA-0002-02-0A	ARTISTS IMPRESSION
DRAWING NO.	REFERENCE
REFERENCE DRAWINGS	

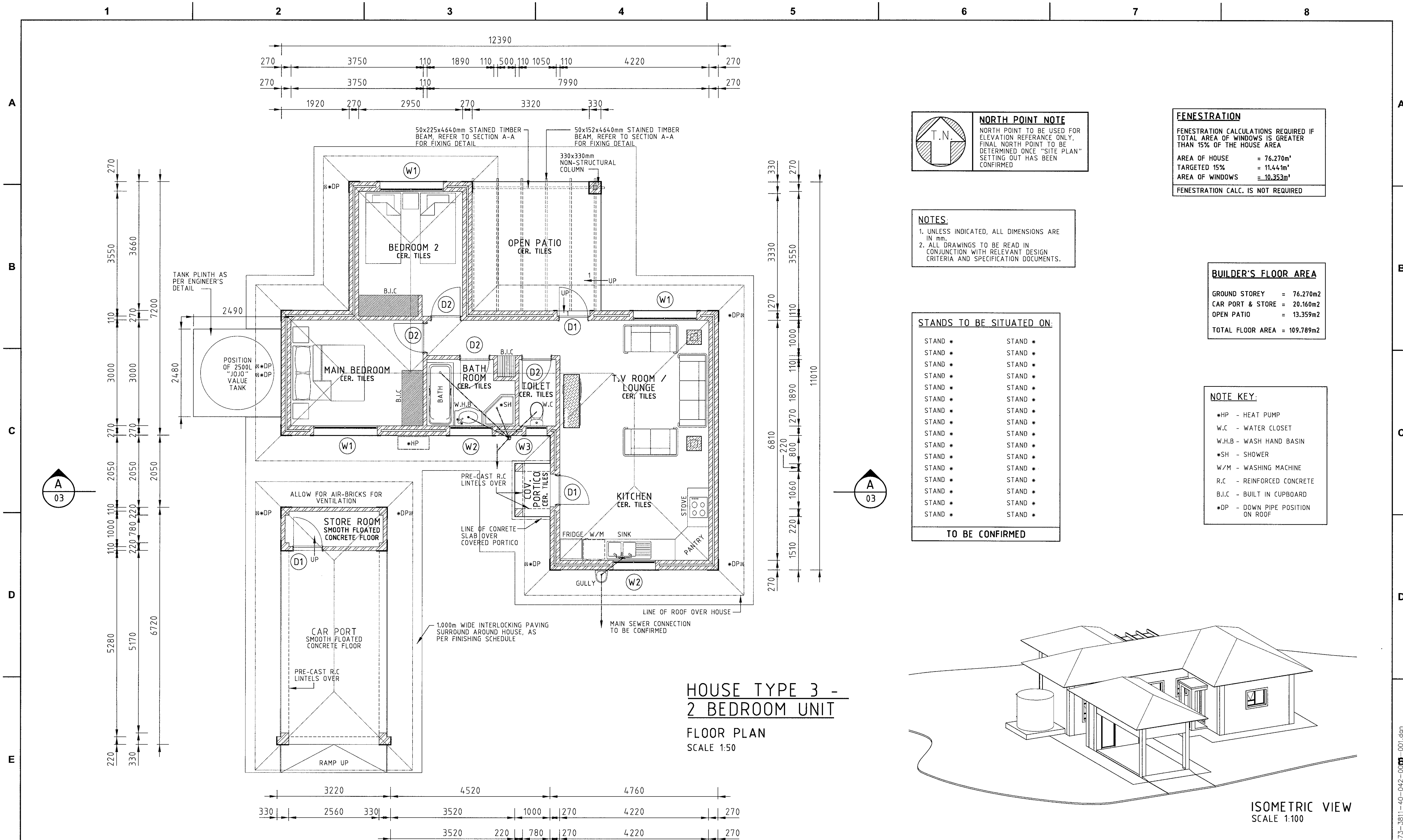







H339473-3-811-A-GA-0003-04-0C	ELEVATIONS
H339473-3-811-A-GA-0003-03-0C	SECTION A-A AND SCHEDULES
H339473-3-811-A-GA-0003-02-0A	ARTISTS IMPRESSION
DRAWING NO.	REFERENCE
REFERENCE DRAWINGS	

NOTES

- 1. DO NOT SCALE DRAWING - ONLY DIMENSIONS SHOWN TO BE USED.**
- 2. THE CONTRACTOR SHALL VERIFY ALL CONDITIONS, DIMENSIONS AND LEVELS ON THE SITE AND NOTIFY THE NEC SUPERVISOR OF ANY VARIATIONS BEFORE CONSTRUCTION.**

[illegible]

CONTRACTOR / CONSULTANT				TRANSNET CAPITAL PROJECTS			
TITLE	NAME	SIGN	DATE	TITLE	NAME	SIGN	DATE
DRAWN	J.ABRANTES		13 04 08				
CHECKED	M.PEREIRA		13 05 29				
DISC LEAD	M.FOURIE		13 05 29				
ENG.MANAGER	P.MASINGA		12 05 31				
PROJECT MGR	H.BESTER		12 05 31				
OPERATING DIVISIONS				PR.ENG. / PR.TECH/PR. ARCH			
TITLE	NAME	SIGN	DATE	NAME	F.PIENVAR		DATE
				SIGNATURE			13 05
				REG. NUMBER	850383		
				SCALE :	1:50		

<h2 style="margin: 0;">H339473-3811-40-042-0003-001</h2>	
<h3 style="margin: 0;">Transnet Capital Projects</h3>	
<small>TRANSCNET LTD (TRADING AS TRANSCNET CAPITAL PROJECTS) : REG. NO. 1960020009006</small>	
<small>237 MASHATUA GANDHI ROAD</small>	
<small>DURBAN TEL: 031 361 1696</small>	<small>0866 770815</small>
<small>P.O. BOX 1703, DURBAN FAX:</small>	
<h2 style="margin: 0;">TFR POSTMARBURG HOUSING</h2>	
<h3 style="margin: 0;">HOUSE TYPE 3 - 2 BEDROOM UNIT</h3>	
<h3 style="margin: 0;">GROUND STOREY PLAN AND ISOMETRIC</h3>	
<h3 style="margin: 0;">ARRANGEMENT GENERAL</h3>	

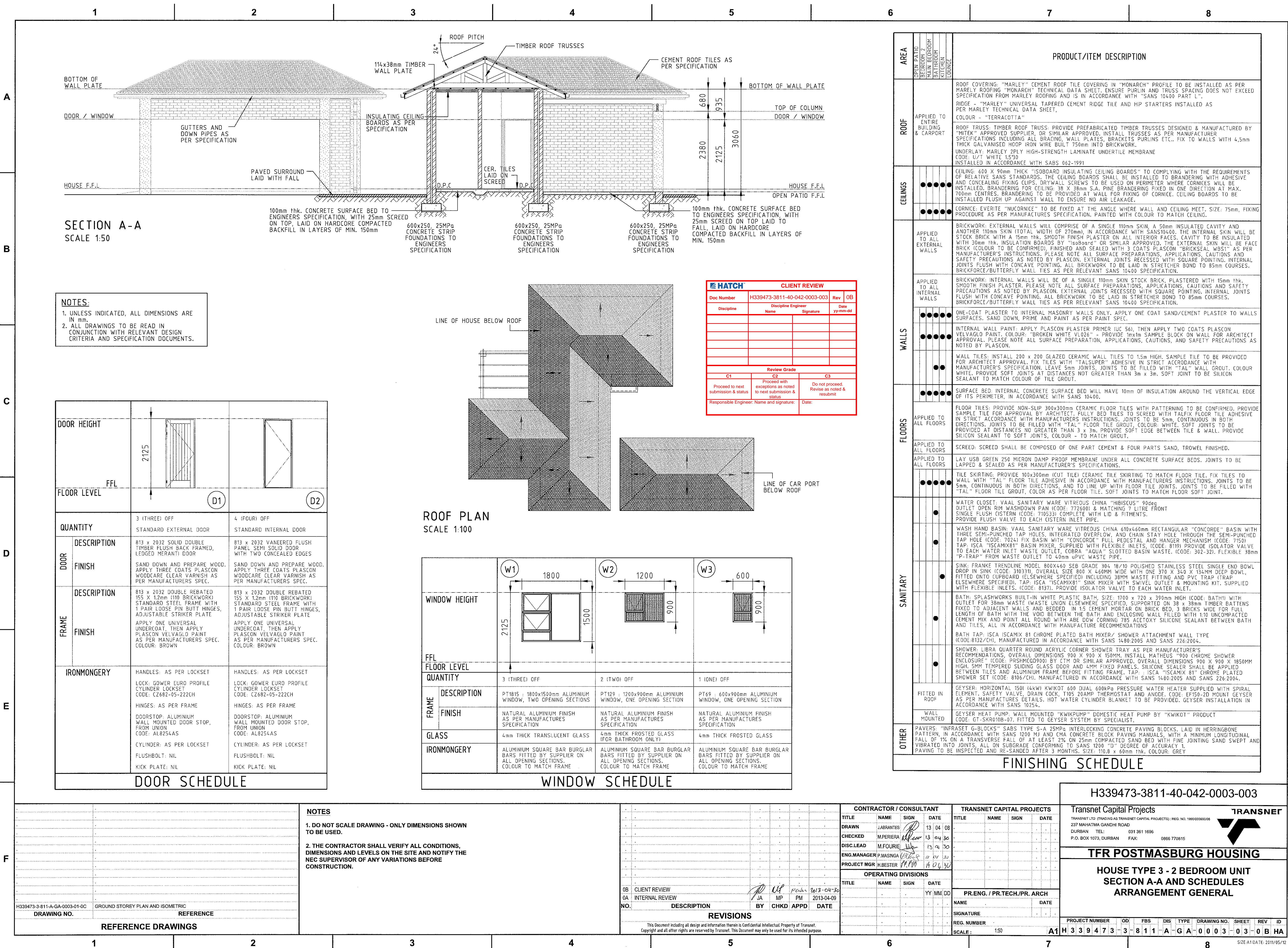

SECTION A-A
SCALE 1:50

ROOF PLAN
SCALE 1:100

Table with 4 columns: Door, Description, Quantity, and Ironmongery. It lists specifications for three types of doors: Standard External Door, Standard Internal Door, and a double door with a frame.

DOOR SCHEDULE

Table with 4 columns: Window, Description, Quantity, and Ironmongery. It lists specifications for three types of windows: PT1815, PT129, and PT69.

WINDOW SCHEDULE

Table with 4 columns: Area, Product/Item Description, and other details. It lists materials and specifications for various parts of the house, including roof covering, trusses, ceilings, walls, floors, and sanitary fixtures.

FINISHING SCHEDULE

Table with 2 columns: Drawing No. and Reference. It lists drawing numbers and their corresponding references for the ground storey plan and isometric.

REFERENCE DRAWINGS

Table with 4 columns: Revisions, Description, and Date. It lists revisions to the drawing, including client review, internal review, and various reissues.

Table with 4 columns: Revisions, Description, and Date. It lists revisions to the drawing, including client review, internal review, and various reissues.

Table with 4 columns: Contractor/Consultant, Transnet Capital Projects, and other details. It lists the names and roles of the contractor and consultant.

Project information block including the project name 'H339473-3811-40-042-0003-003', the client 'Transnet Capital Projects', and the project location 'TFR POSTMASBURG HOUSING'.

POSTMASBURG STATION PRECINCT

ROAD SETTING OUT DATA

PI No.	CH	YLo	XLo	Radius (m)	DA D M S	TL (m)	AL (m)
Const:							
PI 40	0.000	-6320.097	313235.671				
PI 41	323.484	-6050.001	3133057.652				
PI 42	0.000	-6077.815	3132225.470				
PI 43	39.667	-6110.973	313247.243				
PI 44	0.000	-6087.046	313211.496				
PI 45	39.230	-6054.253	3133189.963				
PI 46	0.000	-6042.794	3133068.580				
BC 47	74.283	-5980.621	3133027.929				
PI 47		-5969.200	3133020.462				
EC 47	95.748	-5961.687	3133031.853	13.7	89°46'12"	13.645	21.465
PI 48	248.698	-5877.473	3133159.531				
PI 49	0.000	-5989.584	3133033.790				
PI 50	24.485	-6003.066	3133013.351				
PI 51	0.000	-5922.395	3133091.424				
PI 52	347.312	-5931.704	3132901.359				
PI 53	0.000	-5969.384	3133056.764				
BC 54	39.801	-5847.460	3133089.983				
PI 54		-5841.427	3133099.124	11	89°45'14"	10.953	17.231
EC 54	57.033	-5832.260	3133093.130				
BC 55	139.863	-5762.933	3133047.802				
PI 55		-5753.727	3133041.782	11	90°00'00"	11.000	17.279
EC 55	157.142	-5759.746	3133032.575				
PI 56	196.895	-5781.501	3132999.303				
PI 57	0.000	-5869.384	3133056.764				
PI 58	33.706	-5887.951	3133028.632				
PI 59	0.000	-5887.951	3133028.632				
BC 60	13.000	-5877.101	3133021.472				
PI 60		-5866.251	3133014.311	13	90°00'00"	13.000	20.420
EC 60	33.420	-5873.412	3133003.461				
BC 61	54.020	-5884.759	3132986.268				
PI 61		-5891.920	3132975.418	13	90°00'00"	13.000	20.420
EC 61	74.441	-5902.770	3132982.579				
BC 62	100.441	-5924.470	3132966.900				
PI 62		-5935.320	3133004.061	13	90°00'00"	13.000	20.420
EC 62	120.861	-5928.159	3133014.911				
BC 63	141.461	-5916.812	3133032.104				
PI 63		-5909.651	3133042.954	13	90°00'00"	13.000	20.420
EC 63	161.881	-5898.801	3133035.793				
PI 64	174.871	-5887.959	3133028.638				
PI 67	0.000	-5781.501	3132999.303				
PI 68	34.157	-5800.316	3132970.795				
PI 69	0.000	-5800.316	3132970.795				
BC 70	13.000	-5789.466	3132963.634				
PI 70		-5778.616	3132956.473	13	90°00'00"	13.000	20.420
EC 70	33.420	-5785.777	3132945.623				
BC 71	54.020	-5797.124	3132928.430				
PI 71		-5804.285	3132917.580	13	90°00'00"	13.000	20.420
EC 71	74.441	-5815.135	3132924.741				
BC 72	100.441	-5836.835	3132939.082				
PI 72		-5847.685	3132946.223	13	90°00'00"	13.000	20.420
EC 72	120.861	-5840.524	3132957.073				
BC 73	141.461	-5829.177	3132974.266				
PI 73		-5822.016	3132965.116	13	90°00'00"	13.000	20.420
EC 73	161.881	-5811.166	3132977.955				
PI 74	174.871	-5800.325	3132970.800				
PI 75	0.000	-5693.618	3132941.841				
PI 76	34.608	-5712.682	3132912.957				
PI 77	0.000	-5712.682	3132912.957				
BC 78	13.000	-5701.832	3132905.796				
PI 78		-5690.982	3132898.635	13	90°00'00"	13.000	20.420
EC 78	33.420	-5698.143	3132887.785				
BC 79	54.020	-5709.490	3132870.592				
PI 79		-5716.651	3132859.742	13	90°00'00"	13.000	20.420
EC 79	74.441	-5727.501	3132866.903				
BC 80	100.441	-5749.201	3132881.225				
PI 80		-5760.051	3132888.398	13	90°00'00"	13.000	20.420
EC 80	120.861	-5752.880	3132899.238				
BC 81	141.461	-5741.543	3132916.429				
PI 81		-5734.382	3132927.279	13	90°00'00"	13.000	20.420
EC 81	161.881	-5723.532	3132920.118				
PI 82	174.871	-5712.690	3132912.962				
PI 83	0.000	-5667.235	3132918.052				
PI 84	81.588	-5612.312	3132986.159				
PI 85	0.000	-5606.171	3132940.070				
PI 86	124.360	-5674.644	3132836.258				

HATCH DRAWING No: H339473-3834-10-014-0002-001

Transnet Capital Projects
 TRANSNET LTD (TRADING AS TRANSNET CAPITAL PROJECTS) : REG. NO. 1990000000000
 237 MAHATMA GANDHI ROAD
 DURBAN TEL: 031 361 1696
 P.O. BOX 1073, DURBAN FAX: 0866 770815

TFR POSTMASBURG HOUSING

PROJECT GENERAL AND SITE WIDE ROADS (NORTH) LAYOUT

PROJECT NUMBER	OD	FBS	DIS	TYPE	DRAWING NO.	SHEET	REV	ID
H339473	3	8	3	4	C	LA	0002	01
0	1	0	1	0	1	0	1	0

SIZE A1 DATE: 2011/05/12

NOTES

1. DO NOT SCALE DRAWING - ONLY DIMENSIONS SHOWN TO BE USED.

2. THE CONTRACTOR SHALL VERIFY ALL CONDITIONS, DIMENSIONS AND LEVELS ON THE SITE AND NOTIFY THE NEC SUPERVISOR OF ANY VARIATIONS BEFORE CONSTRUCTION.

KEY

- 80mm INTERLOCKING CONCRETE PAVING
- 60mm INTERLOCKING CONCRETE PAVING
- CONCRETE CROSS BEAMS
- MOUNTABLE KERB

NO.	DESCRIPTION	BY	CHKD	APPD	DATE
0C	CLIENT APPROVAL				
0B	CLIENT REVIEW				
0A	INTERNAL REVIEW				

REVISIONS

This Document including all design and information herein is Confidential Intellectual Property of Transnet. Copyright and all other rights are reserved by Transnet. This Document may only be used for its intended purpose.

CONTRACTOR / CONSULTANT

TITLE	NAME	SIGN	DATE
DRAWN	S.HALL		29/05/13
CHECKED	M.BRONDANI		29/05/13
DISC.LEAD	H.STRIDOM		29/05/13
ENG.MANAGER	P.MASINGA		31/05/13
PROJECT MGR	H.BESTER		31/05/13

TRANSNET CAPITAL PROJECTS

TITLE	NAME	SIGN	DATE

OPERATING DIVISIONS

TITLE	NAME	SIGN	DATE

PR.ENG. / PR.TECH./PR. ARCH

NAME	SIGNATURE	DATE
S.HALL		29/05/13

SCALE: 1:1000

H339473-3-834-C-LA-0003-01	ROADS (SOUTH) - LAYOUT
H339473-3-834-C-LA-0001-01	ROADS - OVERALL LAYOUT
DRAWING NO.	REFERENCE

REFERENCE DRAWINGS