

Zone	NHBRC Class	Amount of movement due to heave mm	Competent founding level
A	H2	20mm	>2,5 to >3,4m
B	R/S1	<5mm	0,2m to 1m with avg 0,6m
C	H3	>30	2,5m+

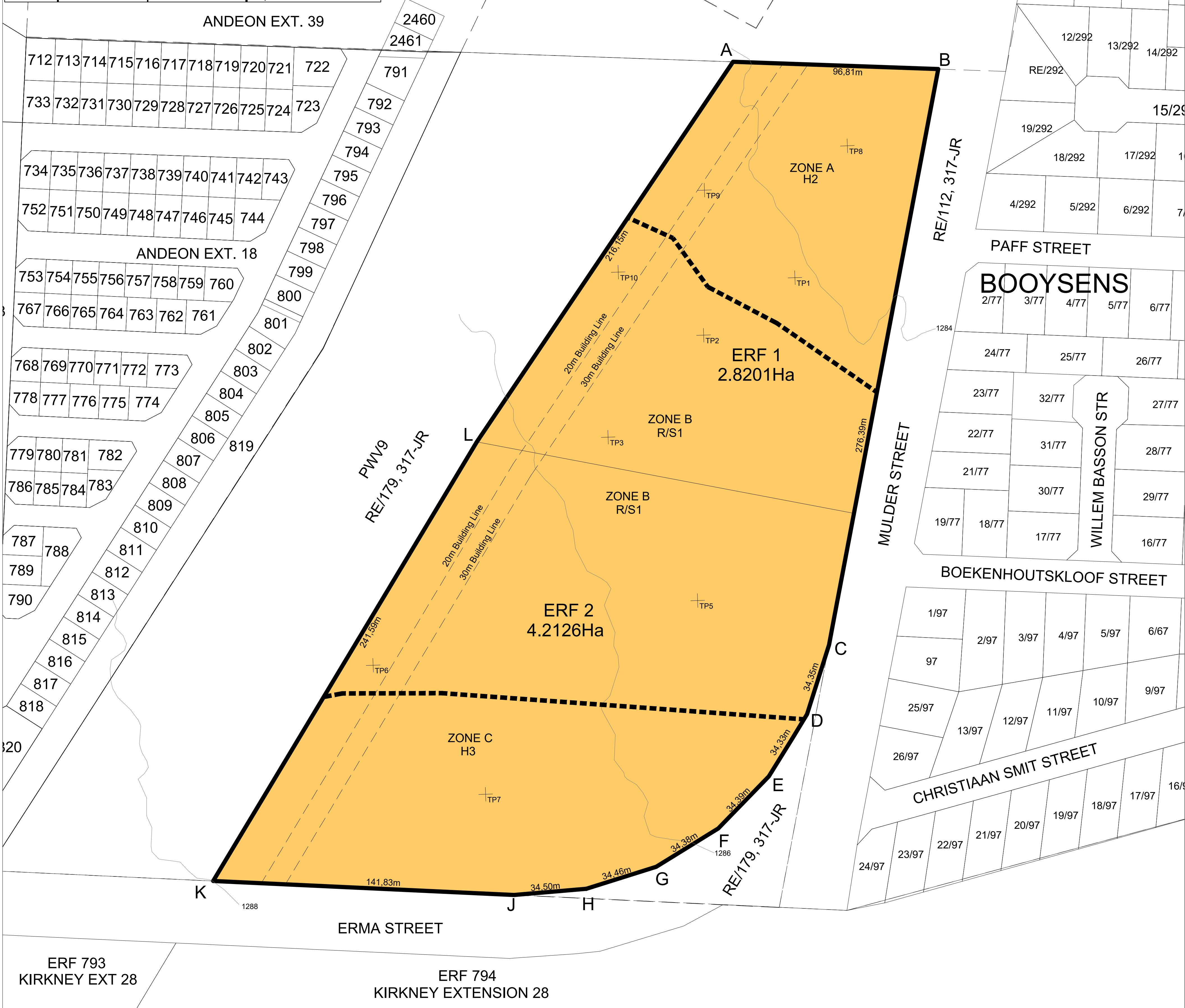

GENERAL NOTES

1. TOWNSHIP BOUNDARY
A-B-C-D-E-F-G-H-J-K-L-A
2. CONTOUR LINES
The Contour lines are in accordance with the standards laid down in of the City of Tshwane Municipal Planning By-Law, 2016.

..... DATE

Eamon Swart

- ### 3. CO-ORDINATES
- The Co-ordinate reference is based on LO 29° system. Baseplan mapping was done by:

..... DATE

Eamon Swart

- 4. DIMENSIONS**
All dimensions shown on the plan are approximate,
scaled in meters and subject to final survey

5. GEOLOGICAL
It is hereby certified that the layout of the township
complies with the recommendations and
requirements set out in the Geotechnical Report
Ref. K9884-01 dated December 2021.

Engineering Geologist: SP Kok (Pr Sci Nat)
Firm: Geo Buro Geotechnical Surveys

- 6. FLOODLINE**
It is hereby certified that in accordance with the Water Act (Act 36 of 1998), it is hereby stated that this township is NOT affected by a flood with an expected frequency of one every 50 years and on every 100 years in the public stream.

PR. Engineer: Arno Beck (Pr. Eng)
Firm: Civil Craft Consulting Engineers

- DATE

7. Erf 1 and Erf 2 will be consolidated.

PROPOSED TOWNSHIP ANDEON EXTENSION 47

SITUATED ON PORTION 183
OF THE FARM
ZANDFONTEIN NO. 317 - JR

CITY OF TSHWANE METROPOLITAN MUNICIPALITY

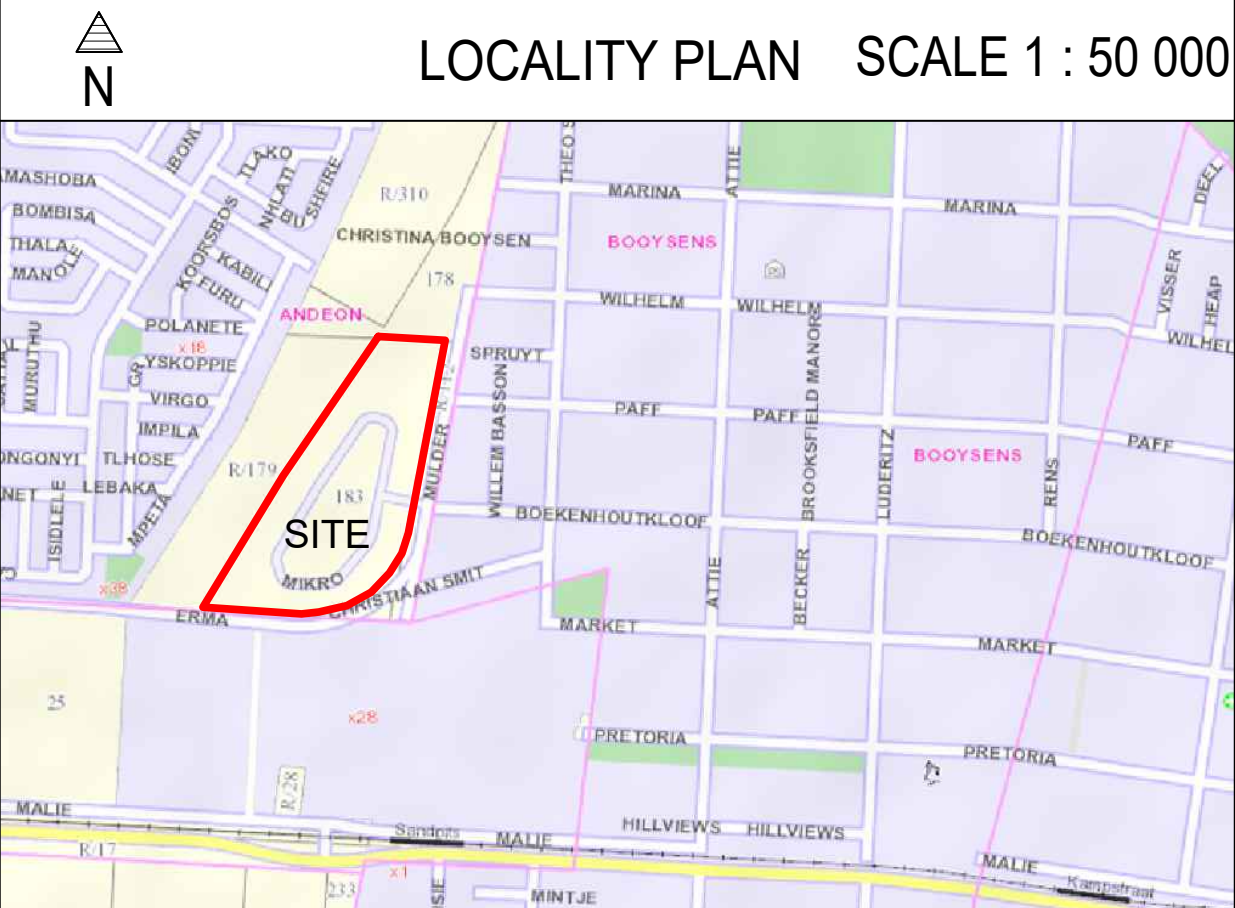

SCHEDULE OF ERVEN

ZONING	LAND USE	± ha	%	NUMBERS	QUANTITY
RESIDENTIAL 3		7.0327	100%	1 - 2	2
TOTAL		7.0327	100		144

NOTES

-
- OUTSIDE BOUNDARY OF TOWNSHIP
 FARM BOUNDARY
 GEOTECHNICAL ZONES
 GEOLOGICAL INSPECTION PIT

DATE	TYPE OF AMENDMENT

<u>REGISTERED OWNER:</u> (PTY) LTD (REG. NO:)	<u>DESIGNED AND DRAWN:</u> Anton Mathey
---	--



P.O. Box 754
Auckland Park
Tel: (011) 541-3800

Date:	FEB 2022
Scale:	1 : 5 500
PLAN No:	CPD ADN47/1