

## APPENDIX D: PETROLEUM EXPLORATION WELL DRILLING APPLICATION AREA

- Appendix 4.1: Regulation 2(2) plan of the Well Drilling ER Application Area
- Appendix 4.2: List of properties within the Target Areas/Areas of Interest
- Appendix 4.3: Corner points of the Target Areas

**REGULATION 2(2) PLAN OF LAND  
UNDER APPLICATION FOR AN  
EXPLORATION RIGHT FOR OIL, GAS AND  
NATURAL GAS**

PERMIT No. : \_\_\_\_\_  
 PASA REFERENCE No. : \_\_\_\_\_  
 SIGNATURE : \_\_\_\_\_  
 DATE : \_\_\_\_\_  
 CHIEF EXECUTIVE OFFICER PETROLEUM  
 AGENCY SA - CAPE TOWN

APPLICANT: \_\_\_\_\_  
 RHINO OIL & GAS EXPLORATION  
 SOUTH AFRICA LTD

SIGNATURE: \_\_\_\_\_  
 DATE: \_\_\_\_\_



SCALE 1:250 000 (A0)



**LEGEND**

- denotes technical co-operation permit area
- denotes farm portion boundary
- denotes parent farms boundary
- denotes Administrative District boundary
- denotes Provincial boundary

**AREA DESCRIPTION**

The figure 1 to 31, middle of stream, 32, middle of stream, 33, middle of stream, 34, middle of stream, 35 to 139, Excluding the figure 140 to 142, middle of stream, 143, middle of stream, 144, middle of stream, 145, middle of stream, 146, and the figure 147 to 156, middle of stream, 157, and the figure 158 to 167, middle of stream, 168 to 174 represents 2647 farms and farm portions identified hereto together measuring approximately 6005 six thousand and fifty square kilometres of land situated partly in the Administrative Districts of Bothaville, Bultfontein, Kroonstad, Lindley, Odendaalsrus, Theunissen, Viljoenskroon, Welkom and Wesselsbron in the Province of Free State the subject of this application for a Technical Co-operation Permit in terms of Section 76 of the Mineral and Petroleum Resources Development Act 2002 (28 of 2002)

**NOTES**

1. All co-ordinates are in the Hartbeeshoek 94 datum - W027
2. All sides are rhumb lines: i.e. lines of constant geographical direction.
3. This plan was framed from information provided by the Petroleum Agency SA and the Chief Surveyor General.

Prepared by: R. C. ABRAHAMSE - PLS No. 0002  
 Professional Land Surveyor

in accordance with Regulation 2(2) of the regulations in terms of the Mining Titles Registration Act 16 of 1967,  
 provided that the figure depicted and described on this plan, the area of the figure and the co-ordinates listed thereon are subject to change, as may be necessary, to conform to the requirements in respect of the definition of co-ordinated point, contained in regulation 3 of the regulations in terms of the Mining Titles Registration Act, 16 of 1967

PASA REFERENCE No. 122/108 & 109

Signature: *R. C. Abrahamse*

date	19 January 2022
scale	1 : 250 000 (A0)
drawing ref & no.	ER 318 (Rev. A) (M.B.)
drawing no.	Free State Precinct (sheet 1 of 14)

**dh+a** david hellig-abrahamse  
 professional land surveyors  
 2nd floor walden street chambers  
 35 walden street, cape town  
 Tel : +27 021 426 2613  
 info@dha.co.za www.dha.co.za

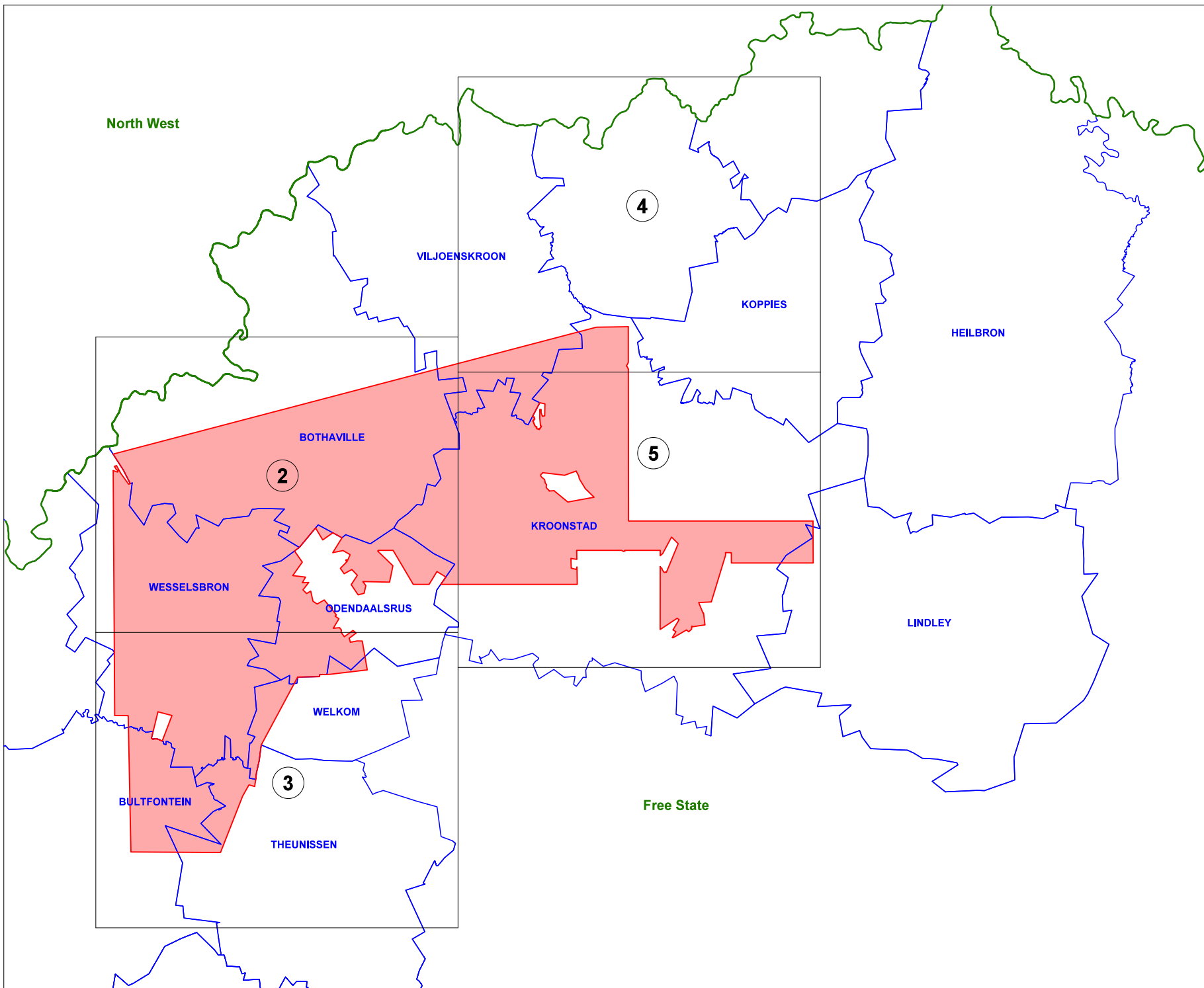

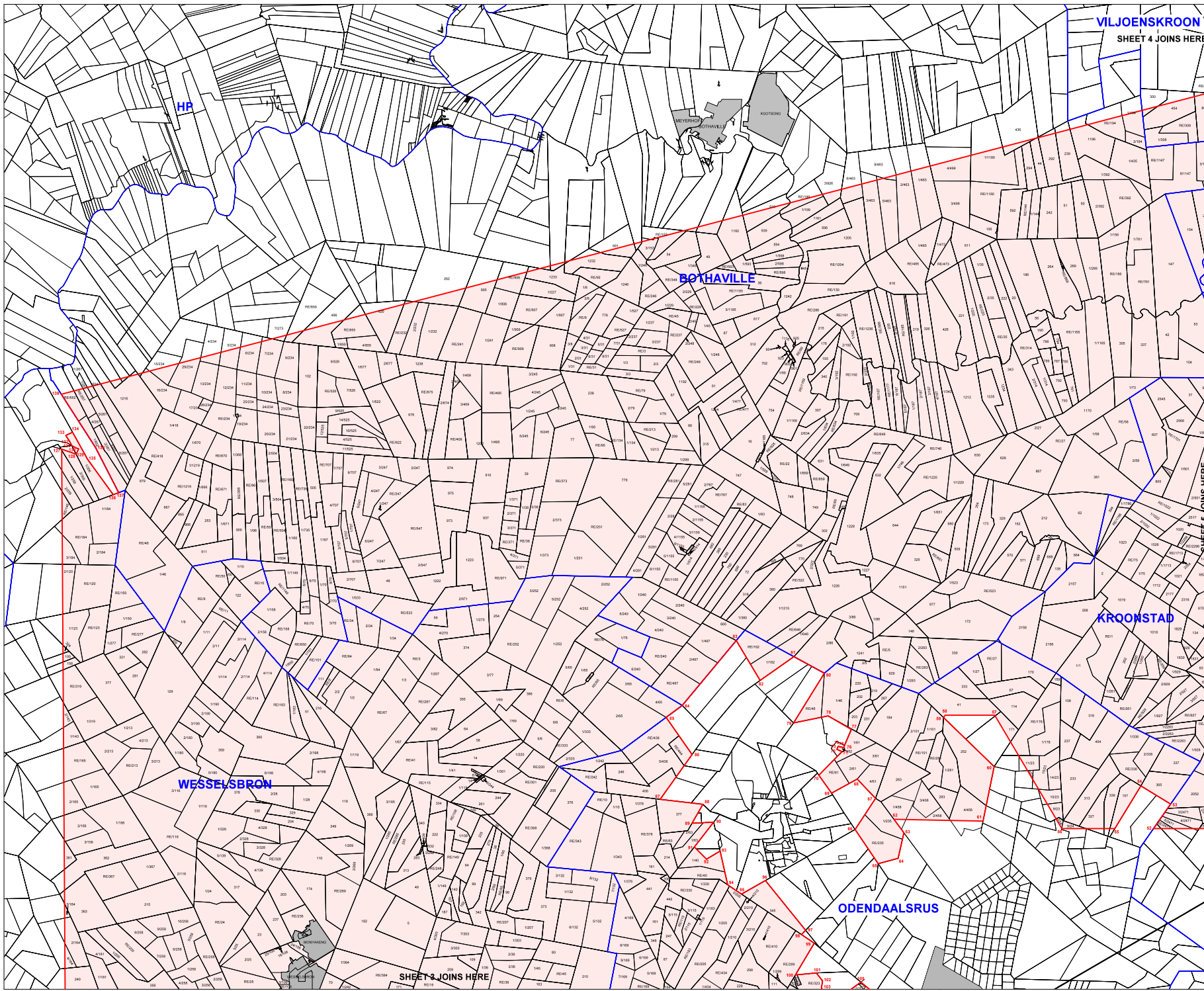

**REGULATION 2(2) PLAN OF LAND UNDER APPLICATION FOR AN EXPLORATION RIGHT FOR OIL, GAS AND NATURAL GAS**

PERMIT No. : \_\_\_\_\_  
 PASA REFERENCE No. : \_\_\_\_\_  
 SIGNATURE : \_\_\_\_\_  
 DATE : \_\_\_\_\_  
 CHIEF EXECUTIVE OFFICER PETROLEUM AGENCY SA - CAPE TOWN  
 APPLICANT: RHINO OIL & GAS EXPLORATION SOUTH AFRICA LTD  
 SIGNATURE: \_\_\_\_\_  
 DATE: \_\_\_\_\_

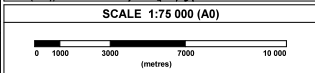
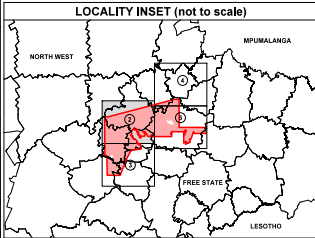
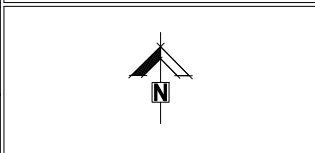

**LEGEND**

- denotes technical co-operation permit area
- denotes farm portion boundary
- denotes parent farms boundary
- denotes Administrative District boundary
- denotes Provincial boundary

**AREA DESCRIPTION**

The figure 1 to 31, middle of stream, 32, middle of stream, 33, middle of stream, 34, middle of stream, 35 to 130. Excluding the figure 140 to 142, middle of stream, 143, middle of stream, 144, middle of stream, 145, middle of stream, 146, and the figure 147 to 158, middle of stream, 157, and the figure 159 to 167, middle of stream, 168 to 174 represents 2047 farms and farm portions identified hereto together measuring approximately 6005 six thousand and two square kilometres of land situated partly in the Administrative Districts of Bothaville, Bullfontein, Koonstad, Lindley, Odendaalsrus, Teyateyanan, Viljoenskroon, Wolfontein and Vriesburg in the Province of Free State the subject of this application for a Technical Co-operation Permit in terms of Section 76 of the Mineral and Petroleum Resources Development Act 2002 (28 of 2002).

- NOTES**
- All co-ordinates are in the Hartbeeshoek 94 datum - WGS27
  - All sides are rumb lines. i.e. lines of constant geographical direction.
  - This plan was framed from information provided by the Petroleum Agency SA and the Chief Surveyor General.

Prepared by: R. C. ABRAHAMSE - PLS No. 0002  
 Professional Land Surveyor

in accordance with Regulation 2(2) of the regulations in terms of the Mining Titles Registration Act 16 of 1957.

provided that the figure depicted and described on this plan, the area of the figure and the co-ordinates listed thereon are subject to change, as may be necessary, to conform to the requirements in respect of the definition of co-ordinated point, contained in regulation 3 of the regulations in terms of the Mining Titles Registration Act, 16 of 1957

PASA REFERENCE No. 122/108 & 109

Signature: Abrahamse

date: 19 January 2022  
 scale: 1:75 000 (A0)  
 drawing ref & no.: ER 318 (Rev. A) (M.B.)  
 drawing no.: Free State Precinct (sheet 2 of 14)

**david helleg+abrahamse**  
 professional land surveyors  
 2nd floor wales street chambers  
 38 wales street, cape town  
 Tel : +27 021 426 2613  
 info@dha.co.za www.dha.co.za

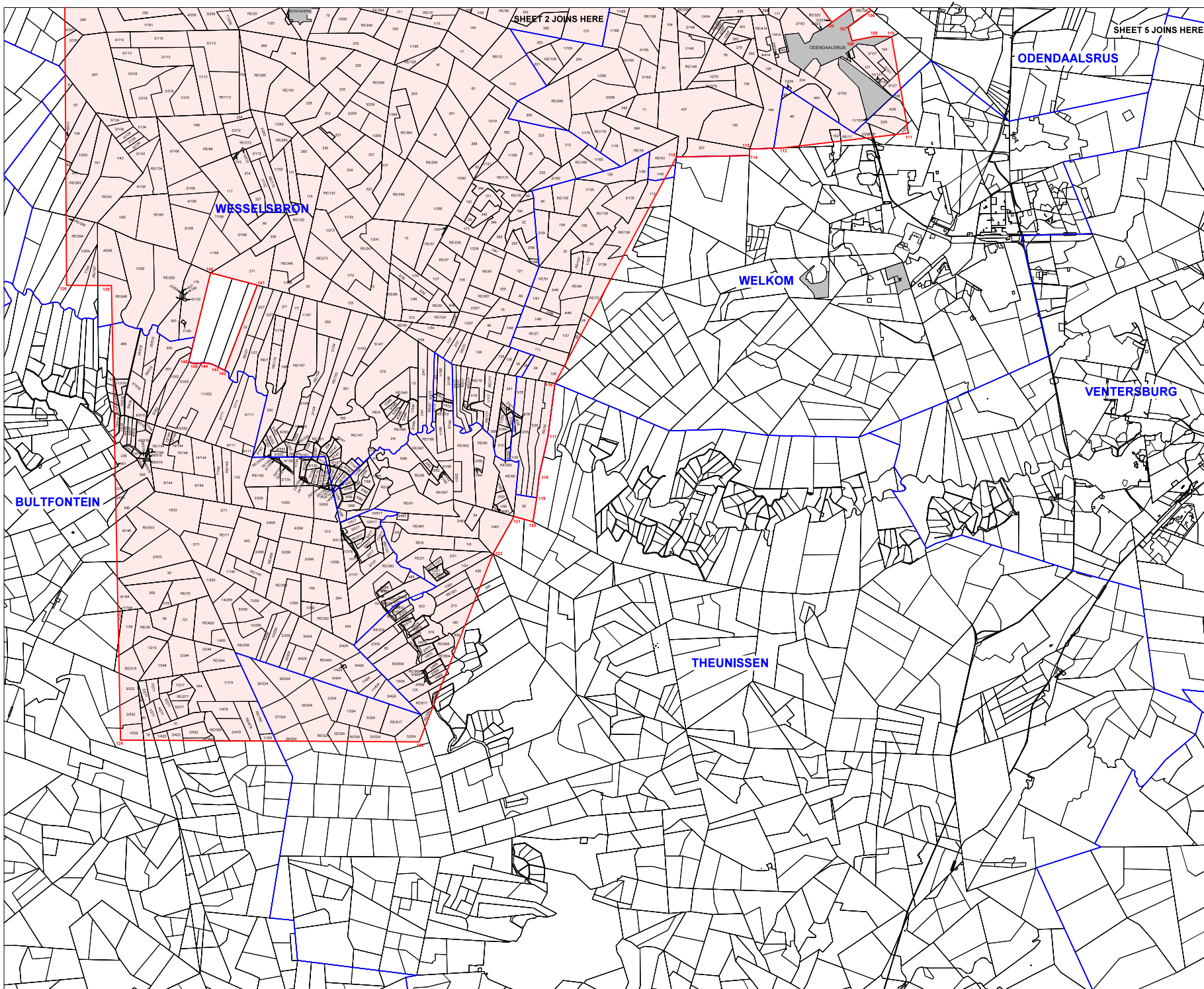

**REGULATION 2(2) PLAN OF LAND UNDER APPLICATION FOR AN EXPLORATION RIGHT FOR OIL, GAS AND NATURAL GAS**

PERMIT No. : \_\_\_\_\_  
 PASA REFERENCE No. : \_\_\_\_\_  
 SIGNATURE : \_\_\_\_\_  
 DATE : \_\_\_\_\_  
 CHIEF EXECUTIVE OFFICER PETROLEUM AGENCY SA - CAPE TOWN

APPLICANT: RHINO OIL & GAS EXPLORATION SOUTH AFRICA LTD

SIGNATURE: \_\_\_\_\_  
 DATE: \_\_\_\_\_

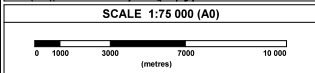
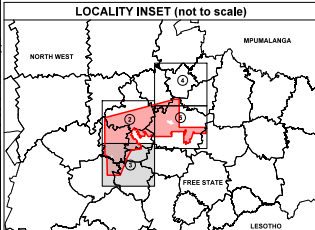
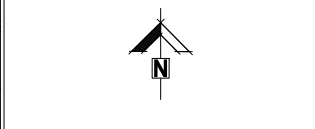

**LEGEND**

	denotes technical co-operation permit area
	denotes farm portion boundary
	denotes parent farms boundary
	denotes Administrative District boundary
	denotes Provincial boundary

**AREA DESCRIPTION**

The figure 1 to 31, middle of stream, 32, middle of stream, 33, middle of stream, 34, middle of stream, 35 to 130, Excluding the figure 140 to 142, middle of stream, 143, middle of stream, 144, middle of stream, 145, middle of stream, 146, and the figure 147 to 158, middle of stream, 157, and the figure 159 to 167, middle of stream, 168 to 174 represents 2047 farms and farm portions identified hereto together measuring approximately 6026 six thousand and two hundred and forty square kilometres of land situated partly in the Administrative Districts of Buthville, Bultfontein, Koonstad, Lindsey, Odendaalsrus, Theunissen, Vigelansbronn, Welkom and Vesselsbronn in the Province of Free State the subject of this application for a Technical Co-operation Permit in terms of Section 76 of the Mineral and Petroleum Resources Development Act 2002 (28 of 2002).

**NOTES**

1. All co-ordinates are in the Hartbeeshoek 94 datum - WGS27
2. All sides are rhumb lines i.e. lines of constant geographical direction.
3. This plan was framed from information provided by the Petroleum Agency SA and the Chief Surveyor General.

Prepared by: R. C. ABRAHAMSE - PLS No. 0002  
 Professional Land Surveyor

In accordance with Regulation 2(2) of the regulations in terms of the Mining Titles Registration Act 19 of 1957, provided that the figure depicted and described on this plan, the area of the figure and the co-ordinates listed thereon are subject to change, as may be necessary, to conform to the requirements in respect of the definition of co-ordinated point, contained in regulation 3 of the regulations in terms of the Mining Titles Registration Act, 16 of 1997

PASA REFERENCE No. 1221108 & 109

Signature : Abrahamse

date : 19 January 2022  
 scale : 1 : 75 000 (A0)  
 drawing ref & no. : ER 318 (Rev. A) (M.B.)  
 drawing no. : Free State Precinct (sheet 3 of 14)

**david helwig-abrahamse**  
 professional land surveyors  
 2nd floor wales street chambers  
 35 wales street, cape town  
 Tel : +27 021 426 2613  
 info@dhaq.co.za www.dhaq.co.za

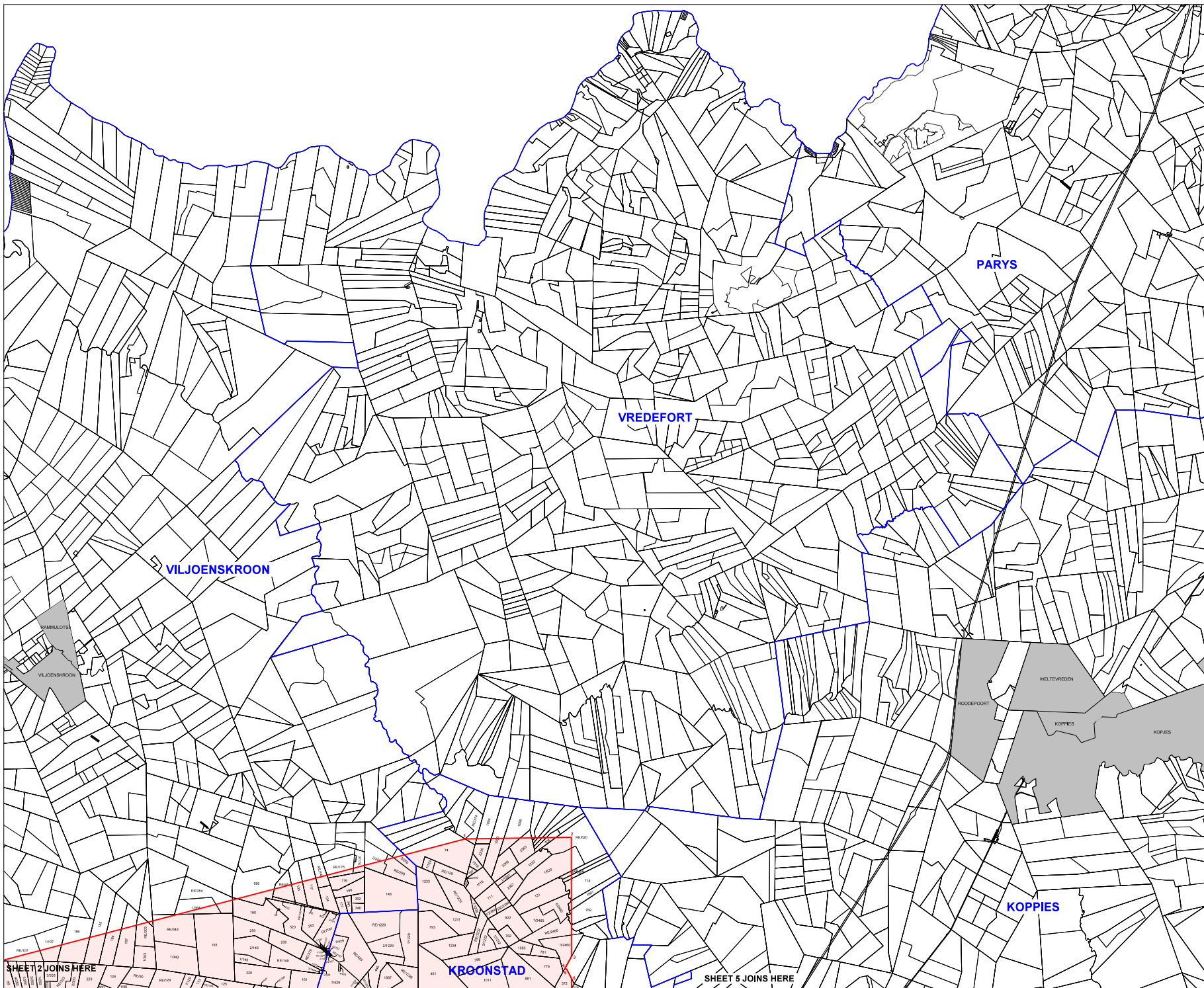

**REGULATION 2(2) PLAN OF LAND UNDER APPLICATION FOR AN EXPLORATION RIGHT FOR OIL, GAS AND NATURAL GAS**

PERMIT No. : \_\_\_\_\_

PASA REFERENCE No. : \_\_\_\_\_

SIGNATURE : \_\_\_\_\_

DATE : \_\_\_\_\_

CHIEF EXECUTIVE OFFICER PETROLEUM AGENCY SA - CAPE TOWN

---

APPLICANT: \_\_\_\_\_ RHINO OIL & GAS EXPLORATION SOUTH AFRICA LTD \_\_\_\_\_

SIGNATURE: \_\_\_\_\_

DATE: \_\_\_\_\_

---

N

**LOCALITY INSET (not to scale)**

**SCALE 1:75 000 (A0)**

**LEGEND**

- denotes technical co-operation permit area
- denotes farm portion boundary
- denotes parent farms boundary
- denotes Administrative District boundary
- denotes Provincial boundary

**AREA DESCRIPTION**

The figure 1 to 31, middle of stream, 32, middle of stream, 33, middle of stream, 34, middle of stream, 35 to 139, Excluding the figure 140 to 142, middle of stream, 143, middle of stream, 144, middle of stream, 145, middle of stream, 146, and the figure 147 to 156, middle of stream, 157, and the figure 158 to 167, middle of stream, 168 to 174 represents 2647 farms and farm portions identified hereto together measuring approximately 6005 six thousand and forty square kilometres of land situated partly in the Administrative Districts of Bloemfontein, Buffalo City, Kooxstad, Lintley, Oudtshoorn, Teyateyanan, Viljoenskroon, Wolkom and Vreesburg in the Province of Free State subject of this application for a Technical Co-operation Permit in terms of Section 76 of the Mineral and Petroleum Resources Development Act 2002 (28 of 2002)

**NOTES**

1. All co-ordinates are in the Hartbeeshoek 94 datum - W027
2. All sides are rhumb lines. I.e. Lines of constant geographical direction.
3. This plan was framed from information provided by the Petroleum Agency SA and the Chief Surveyor General.

Prepared by: R. C. ABRAHAMSE - PLS No. 0002  
Professional Land Surveyor

In accordance with Regulation 2(2) of the regulations in terms of the Mining Titles Registration Act 19 of 1997,  
provided that the figure depicted and described on this plan, the area of the figure and the co-ordinates listed thereon are subject to change, as may be necessary, to conform to the requirements in respect of the definition of co-ordinated point, contained in regulation 3 of the regulations in terms of the Mining Titles Registration Act, 19 of 1997

PASA REFERENCE No. 122/108 & 109

Signature: *Abrahamse*

date: 19 January 2022

scale: 1:75 000 (A0)

drawing ref & no. ER 318 (Rev. A) (M.B.)

drawing no. Free State Precinct (sheet 4 of 14)

david hellig-abrahamse  
professional land surveyors  
2nd floor wals street chambers  
35 wals street, koppies town  
Tel : +27 021 426 2613  
info@dhaqa.co.za www.dhaqa.co.za

dh+a

SHEET 2 JOINS HERE

KROONSTAD

SHEET 5 JOINS HERE

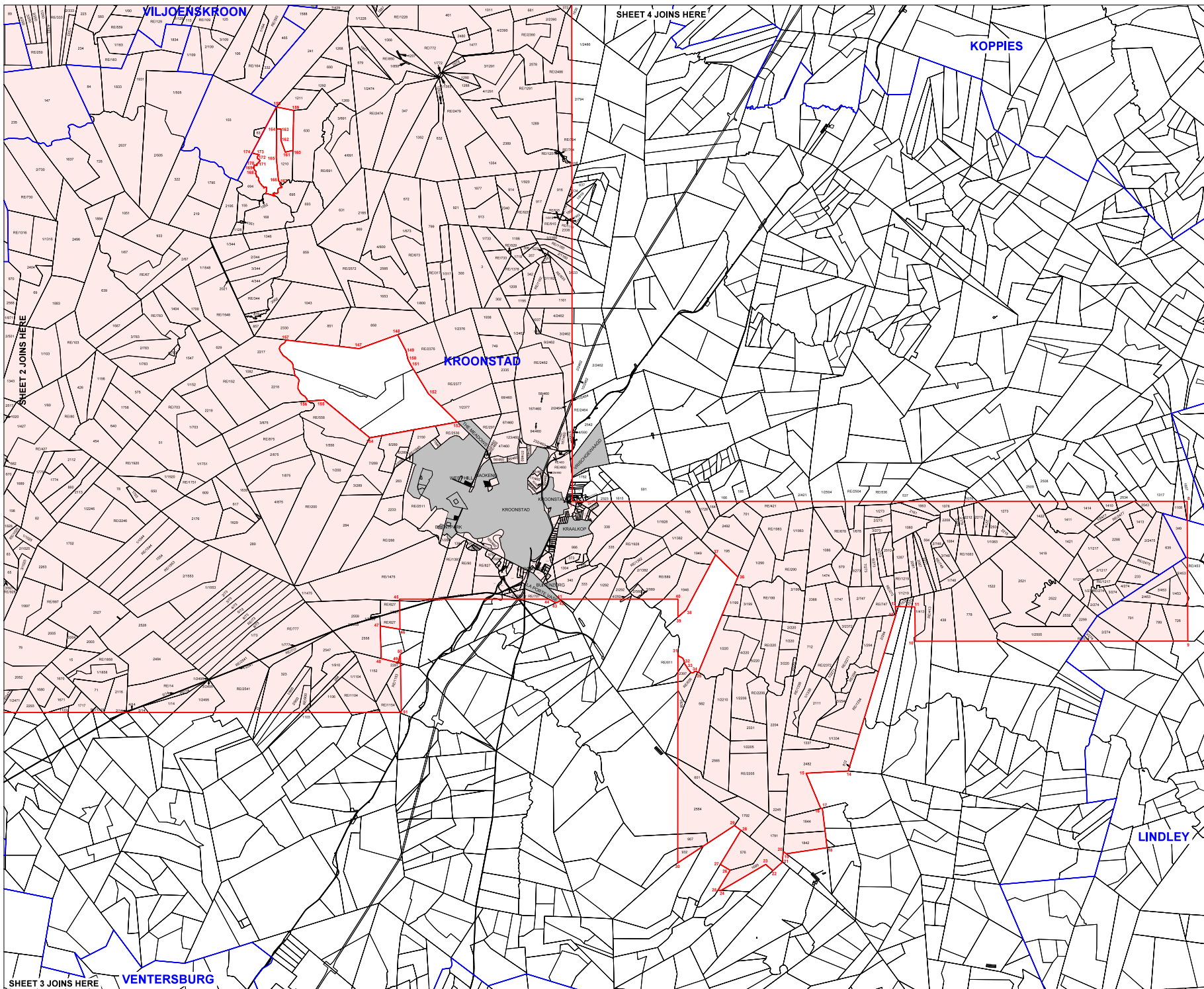

SHEET 4 JOINS HERE

SHEET 2 JOINS HERE

SHEET 3 JOINS HERE

**REGULATION 2(2) PLAN OF LAND UNDER APPLICATION FOR AN EXPLORATION RIGHT FOR OIL, GAS AND NATURAL GAS**

PERMIT No. : \_\_\_\_\_

PASA REFERENCE No. : \_\_\_\_\_

SIGNATURE : \_\_\_\_\_

DATE : \_\_\_\_\_

CHIEF EXECUTIVE OFFICER PETROLEUM AGENCY SA - CAPE TOWN

APPLICANT: RHINO OIL & GAS EXPLORATION SOUTH AFRICA LTD

SIGNATURE: \_\_\_\_\_

DATE: \_\_\_\_\_

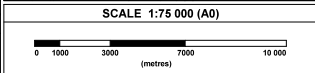
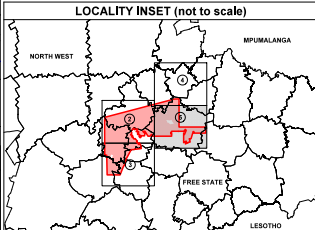

**LEGEND**

	denotes technical co-operation permit area
	denotes farm portion boundary
	denotes parent farms boundary
	denotes Administrative District boundary
	denotes Provincial boundary

**AREA DESCRIPTION**

The figure 1 to 31, middle of stream, 32, middle of stream, 33, middle of stream, 34, middle of stream, 35 to 130, Excluding the figure 140 to 142, middle of stream, 143, middle of stream, 144, middle of stream, 145, middle of stream, 146, and the figure 147 to 156, middle of stream, 157, and the figure 158 to 167, middle of stream, 168 to 174 represents 2047 farms and farm portions identified hereto together measuring approximately 605 (one thousand and five) square kilometres of land situated partly in the Administrative Districts of Butha Buthe, Buffalo, Kromstad, Lindley, Oudendaluis, Theunissen, Viljoenskroon, Walker and Vrededorp in the Province of Free State the subject of this application for a Technical Co-operation Permit in terms of Section 76 of the Mineral and Petroleum Resources Development Act 2002 (28 of 2002).

- NOTES**
1. All co-ordinates are in the Hartbeeshoek 94 datum - W027
  2. All sides are rumb lines, i.e. lines of constant geographical direction.
  3. This plan was framed from information provided by the Petroleum Agency SA and the Chief Surveyor General.

Prepared by: R. C. ABRAHAMSE - PLS No. 0002  
Professional Land Surveyor

In accordance with Regulation 2(2) of the regulations in terms of the Mining Titles Registration Act 19 of 1957, provided that the figure depicted and described on this plan, the area of the figure and the co-ordinates listed thereon are subject to change, as may be necessary, to conform to the requirements in respect of the definition of co-ordinated point, contained in regulation 3 of the regulations in terms of the Mining Titles Registration Act, 16 of 1957

PASA REFERENCE No. 122/108 & 109

Signature: Abrahamse

date: 19 January 2022

scale: 1:75 000 (A0)

drawing ref & no.: ER 318 (Rev. A) (M.B.)

drawing no.: Free State Precinct (sheet 5 of 14)

**david hellig-abrahamse**  
professional land surveyors  
2nd floor walle street chambers  
35 walle street, cape town  
Tel : +27 021 426 2613  
info@dha.co.za www.dha.co.za

**APPENDIX 4.2:**

**LIST OF PROPERTIES WITHIN THE TARGET AREAS/AREAS OF INTEREST**





**FREE STATE FARM SCHEDULE - ADMINISTRATIVE DISTRICT OF BOTHAVILLE.**

FARM NO.	PORTION NO.	FARM NO.	PORTION NO.	FARM NO.	PORTION NO.	FARM NO.	PORTION NO.	FARM NO.	PORTION NO.	FARM NO.	PORTION NO.	FARM NO.	PORTION NO.	FARM NO.	PORTION NO.
3	1	70	7	187	RE	240	1	304		473	RE	632		767	RE
3	2	70	8	191	RE	240	2	305		477	1	634	1	769	
3	3	70	RE	192	1	240	3	307		477	RE	634	2	770	
3	RE	72		192	2	240	4	312		485	1	634	RE	778	
5	2	73	1	192	3	240	5	314	1	485	RE	635	1	779	
5	RE	77		192	RE	240	6	314	2	495	1	644		785	
8	1	79	1	193		240	RE	314	RE	495	RE	645		787	
8	2	79	2	194	1	241	1	315		496		646	1	788	
8	3	79	RE	194	2	241	RE	318		497	1	646	RE	789	
8	RE	83	1	194	RE	242		320	2	497	2	649	1	790	
16		83	RE	199	1	245	1	322	2	497	RE	649	RE	791	
20		85	1	199	RE	245	3	322	RE	499	3	650	1	792	
22	1	85	RE	212		245	4	325		499	4	650	RE	793	
22	RE	86	1	213	1	245	5	326		504	1	651	1	794	
27	2	86	2	213	RE	245	6	329		504	2	651	RE	855	1
27	RE	86	3	215		245	8	330		504	3	652	1	855	4
31	1	87		219		246	1	337		504	RE	652	RE	855	RE
31	2	92	RE	220	1	246	RE	338	RE	505		659	RE	859	1
31	3	95	1	220	RE	247	1	340		507	1	664		859	RE
31	4	95	RE	221		247	2	342	1	507	RE	665		865	
31	5	96	1	222		247	3	343		509		666	1	866	
31	6	96	RE	227	1	247	4	348	1	510		667		867	
31	7	99	1	229	1	247	5	348	RE	511		670	1	868	RE
31	8	99	RE	229	2	247	6	354		523	1	670	RE	871	
31	RE	101	1	229	RE	247	7	366	RE	523	RE	671	1	879	
35	1	101	RE	230		247	RE	368	1	525	4	671	RE	900	
35	2	102		232	1	248	1	368	RE	525	9	674	2	903	
35	RE	104		232	2	248	2	371	1	525	10	675	1	905	
36		106		232	RE	248	RE	371	2	525	11	675	RE	906	1
38	1	130	RE	234	1	251	1	371	3	525	12	676		906	RE
38	2	134	1	234	4	251	RE	371	4	525	14	677	1	907	1
38	RE	134	RE	234	5	253		371	5	526	6	677	2	907	RE
39		135		234	6	262		371	RE	526	7	681		908	
42		144	1	234	7	264		373	1	526	RE	682		909	1
44		144	RE	234	8	267	1	373	2	527	1	688		909	RE
45	1	146		234	9	267	2	373	RE	527	RE	689		910	
45	2	147		234	10	267	3	380	1	533	1	690		914	1
45	RE	152		234	11	267	4	380		533	RE	700		914	2
46	1	153	3	234	12	267	5	381		547	2	702		915	
46	RE	153	RE	234	13	267	6	385		547	RE	707	1	916	
48		156	1	234	15	267	7	392	1	570		707	2	923	
49		156	RE	234	16	267	RE	392	2	571		707	3	924	
50		158	1	234	17	269	1	392	RE	592		707	4	925	
51		158	2	234	19	269		399		593	1	707	5	926	3
53		158	RE	234	20	273	7	409	1	593	RE	707	6	928	1
54		160	1	234	21	281	1	409	2	594		707	7	928	RE
56		160	RE	234	22	281	2	409	3	596		707	9	937	
58	1	172		234	23	281	3	409	RE	598	1	707	RE	939	
58	2	173		234	24	281	4	418	1	598	2	709		961	
58	RE	176		234	25	281	5	418	RE	598	RE	735	1	971	2
61		185	1	234	26	281	RE	426		604		735	RE	971	RE
62		185	2	234	29	283	1	435	1	611		746	1	973	
66		185	RE	234	RE	283	2	436		617		746	RE	974	
67		186		235		283	RE	463	1	620		747		975	
68		187	1	237	1	286	RE	463	2	622	1	748		977	
70	1	187	2	237	2	292		463	3	622	RE	749		980	
70	3	187	3	237	3	294		463	5	628		754		1147	1
70	4	187	4	237	RE	299	1	463	6	629		761	1	1147	2
70	5	187	5	238		299		463	8	630		761	RE	1147	3
70	6	187	6	239		302		473	1	631		767	2	1147	8

**REGULATION 2(2) PLAN OF LAND**

**UNDER APPLICATION FOR AN  
EXPLORATION RIGHT FOR OIL, GAS  
AND NATURAL GAS**

**PERMIT No.:** \_\_\_\_\_

**PASA REFERENCE No.:** \_\_\_\_\_

**SIGNATURE:** \_\_\_\_\_

**DATE:** \_\_\_\_\_

**CHIEF EXECUTIVE OFFICER PETROLEUM  
AGENCY SA : CAPE TOWN**

**APPLICANT: RHINO OIL & GAS EXPLORATION  
SOUTH AFRICA LTD**

**SIGNATURE:** \_\_\_\_\_

**DATE:** \_\_\_\_\_

Prepared by: R. C. Abrahamse - PLS No. 0002  
Professional Land Surveyor

in accordance with Regulation 2(2) of the regulations in terms of the Mining Titles Registration Act 16 of 1967, provided that the figure depicted and described on this plan, the area of the figure and the co-ordinates listed thereon are subject to change, as may be necessary, to conform to the requirements in respect of the definition of co-ordinated point, contained in regulation 3 of the regulations in terms of the Mining Titles Registration Act, 16 of 1967

PASA REFERENCE No. 12/2/108 & 109

Signature : *R. C. Abrahamse*

Date 19 January 2022

Reference No. ER 318 (Rev. A)

Drawing No. FREE STATE FARMS (sheet 8 of 14)

**dh+a**  
david hellig+abrahamse  
professional land surveyors  
2nd floor wale street chambers  
38 wale street, cape town  
Tel : +27 021 426 2613  
info@dhac.co.za www.dhale.co.za

**FREE STATE FARM SCHEDULE - ADMINISTRATIVE DISTRICTS OF BOTHAVILLE and BULTFONTEIN .**

BOTHAVILLE		BULTFONTEIN													
FARM NO.	PORTION NO.	FARM NO.	PORTION NO.	FARM NO.	PORTION NO.	FARM NO.	PORTION NO.	FARM NO.	PORTION NO.	FARM NO.	PORTION NO.	FARM NO.	PORTION NO.	FARM NO.	PORTION NO.
1147	RE	19		146	9	390	RE	517	4						
1149	1	20		175	1	392	1	517	5						
1149	RE	30		183	1	392	RE	517	6						
1151		38	1	183	RE	420	1	517	7						
1155	1	38	RE	194	6	420	RE	517	8						
1155	2	39		194	7	422	1	517	9						
1155	3	51		199		422	2	517	10						
1155	4	70	1	205	3	422	3	517	11						
1155	5	70	RE	205	5	422	RE	517	12						
1155	6	71	2	205	7	424	1	517	RE						
1155	9	71	3	212	1	424	2	532	1						
1155	RE	71	RE	215	1	424	4	532	2						
1161		88	14	215	RE	424	5	532	3						
1165	1	111	1	218		424	6	533	1						
1165	RE	111	2	236		424	7	533	2						
1166		111	5	244	1	424	8	533	RE						
1167		111	6	244	2	424	9	540							
1169	1	111	8	244	3	424	10	544							
1169	RE	121		244	RE	424	11	546							
1170		130	1	259	1	424	RE	549							
1176		130	2	259	2	450	3	554							
1177	RE	130	3	259	4	459	3	558	RE						
1180	1	130	4	259	6	478	1	561							
1180	RE	130	5	259	7	478	2								
1182		130	6	259	10	478	RE								
1185	3	130	7	259	12	485									
1185	RE	130	8	259	14	495	2								
1192		130	9	259	RE	495	RE								
1196		130	10	269		499									
1202		130	11	277	1	500									
1204	RE	130	12	277	2	501									
1205		130	13	277	3	512									
1212		130	14	277	4	516	3								
1214		130	15	277	6	516	4								
1215	1	130	18	277	7	516	5								
1216		130	19	277	8	516	6								
1219	1	130	22	277	RE	516	7								
1219	RE	130	23	294		516	8								
1220	1	130	24	298	1	516	9								
1220	RE	130	25	298	2	516	10								
1222		130	26	298	3	516	11								
1223		130	RE	298	4	516	12								
1226		133		310		516	13								
1227		137	2	352	1	516	14								
1228		137	3	352	2	516	15								
1232		137	RE	352	5	516	16								
1233		140	1	352	10	516	28								
1234		140	RE	352	11	516	29								
1235		144	1	371	7	516	30								
1236	RE	144	7	378	1	516	31								
1238		144	8	379	1	516	34								
1241		144	9	379	3	516	35								
1242		144	10	379	4	516	36								
1246		144	12	379	8	516	37								
		144	13	379	10	516	38								
		144	14	380	1	516	39								
		144	15	380	2	516	40								
		144	RE	380	5	516	42								
		145	1	380	RE	517	2								
		145	RE	390	1	517	3								

REGULATION 2(2) PLAN OF LAND

UNDER APPLICATION FOR AN  
EXPLORATION RIGHT FOR OIL, GAS  
AND NATURAL GAS

PERMIT No.: \_\_\_\_\_

PASA REFERENCE No.: \_\_\_\_\_

SIGNATURE: \_\_\_\_\_

DATE: \_\_\_\_\_

CHIEF EXECUTIVE OFFICER PETROLEUM  
AGENCY SA : CAPE TOWN

APPLICANT: RHINO OIL & GAS EXPLORATION  
SOUTH AFRICA LTD

SIGNATURE: \_\_\_\_\_

DATE: \_\_\_\_\_

Prepared by: R. C. Abrahamse - PLS No. 0002  
Professional Land Surveyor

in accordance with Regulation 2(2) of the regulations in  
terms of the Mining Titles Registration Act 16 of 1967,  
provided that the figure depicted and described on this  
plan, the area of the figure and the co-ordinates listed  
thereon are subject to change, as may be necessary, to  
conform to the requirements in respect of the definition  
of co-ordinated point, contained in regulation 3 of the  
regulations in terms of the Mining Titles Registration  
Act, 16 of 1967

PASA REFERENCE No. 12/2/108 & 109

Signature : *R. C. Abrahamse*

Date 19 January 2022

Reference No. ER 318 (Rev. A)

Drawing No. FREE STATE FARMS (sheet 9 of 14)

**dh+a** david hellig+abrahamse  
professional land surveyors  
2nd floor wale street chambers  
38 wale street, cape town  
Tel : +27 021 426 2613  
info@dhaa.co.za www.dhale.co.za

FREE STATE FARM SCHEDULE - ADMINISTRATIVE DISTRICTS OF ODENDAALSRUS, THEUNISSEN and LINDLEY.															
ODENDAALSRUS								THEUNISSEN				LINDLEY			
FARM NO.	PORTION NO.	FARM NO.	PORTION NO.	FARM NO.	PORTION NO.	FARM NO.	PORTION NO.	FARM NO.	PORTION NO.	FARM NO.	PORTION NO.	FARM NO.	PORTION NO.	FARM NO.	PORTION NO.
10	1	153	2	246		434	RE	8	1	324	5	274	2		
10	RE	153	11	247		437		8	2	324	26	274	3		
18	1	154		252		438	5	8	RE	324	27	274	RE		
18	RE	156		253		438	RE	21	1	324	28	453	1		
20		157		254		441		21	2	324	29	453	2		
23	6	159		257		442		21	6	324	30	453	3		
23	9	161		263		443		21	7	324	32	453	5		
23	10	162	1	275	1	444	RE	21	8	324	33	453	RE		
23	11	162	RE	275	RE	452		21	9	324	35	726			
23	14	169	1	278		454		21	11	324	RE	789			
23	15	169	2	281	1	456		21	12	332	1	791			
24	3	169	3	281	RE	458	1	21	RE	332	2				
24	9	169	4	283		458	2	61		332	3				
27	1	169	5	287		458	3	62	1	332	4				
27	RE	169	6	295		458	4	62	2	332	5				
40	1	169	7	297	1			62	3	332	6				
40	RE	169	8	297	2			62	4	332	RE				
41		169	9	297	3			65		335	1				
43	1	169	10	297	RE			69	1	335	2				
43	RE	169	RE	298				69	2	350	RE				
46	1	170		299	1			69	RE	381	1				
46	RE	171		299	RE			83		381	RE				
55		176	1	300				88	1	384					
61	1	176	RE	313				88	2	436					
61	2	178	1	316				88	3	461	1				
61	3	178	RE	323	2			88	4	461	2				
61	4	181		323	3			88	5	461	3				
61	RE	183	1	323	4			88	6	461	RE				
63	1	183	RE	323	RE			88	7	508					
63	2	184		327				88	9	547	RE				
63	RE	198	2	330	1			88	10	552	1				
67		198	6	330	RE			88	11	552	RE				
71		198	RE	333				88	12	568	16				
87		200		336				88	13	569	1				
101	1	201		337				88	16	569	2				
101	2	202		338	1			88	17	569	3				
101	RE	203		338	2			88	RE	569	4				
104		205	1	338	RE			89	5	569	6				
108		205	2	339				89	RE	569	RE				
109	1	205	RE	343	1			90	1	570	1				
109	RE	206	1	343	RE			90	2	570	2				
111		206	2	345				90	3	570	3				
114		206	RE	348				90	4	570	RE				
115	1	210	1	349				90	5	572	1				
115	2	210	2	365				90	RE	572	2				
115	3	210	3	376	1			91	1	572	3				
115	5	210	4	377				91	RE	572	4				
115	RE	214		378	1			92		572	RE				
125		219		378	RE			94		578	1				
127	2	220		383				125		578	2				
127	3	221		401				185		578	3				
127	7	224	1	410	1			186	1	578	4				
127	8	224		410	RE			186	2	578	RE				
127	10	228		414	1			186	3	593	RE				
127		233		414	2			186	6	604	1				
130		235	1	414	3			186	RE	604	RE				
146		235	RE	414	4			273		608	RE				
148	1	237		414	RE			324	1	616					
148	2	242	1	421				324	2	617	RE				
148	RE	242	RE	434	1			324	3	623					

REGULATION 2(2) PLAN OF LAND

UNDER APPLICATION FOR AN  
EXPLORATION RIGHT FOR OIL, GAS  
AND NATURAL GAS

PERMIT No.: \_\_\_\_\_

PASA REFERENCE No.: \_\_\_\_\_

SIGNATURE: \_\_\_\_\_

DATE: \_\_\_\_\_

CHIEF EXECUTIVE OFFICER PETROLEUM  
AGENCY SA : CAPE TOWN

APPLICANT: RHINO OIL & GAS EXPLORATION  
SOUTH AFRICA LTD

SIGNATURE: \_\_\_\_\_

DATE: \_\_\_\_\_

Prepared by: R. C. Abrahamse - PLS No. 0002  
Professional Land Surveyor

in accordance with Regulation 2(2) of the regulations in  
terms of the Mining Titles Registration Act 16 of 1967,  
provided that the figure depicted and described on this  
plan, the area of the figure and the co-ordinates listed  
thereon are subject to change, as may be necessary, to  
conform to the requirements in respect of the definition  
of co-ordinated point, contained in regulation 3 of the  
regulations in terms of the Mining Titles Registration  
Act, 16 of 1967

PASA REFERENCE No. 12/2/108 & 109

Signature : *R. C. Abrahamse*

Date 19 January 2022

Reference No. ER 318 (Rev. A)

Drawing No. FREE STATE FARMS (sheet 10 of 14)

**dh+a** david hellig+abrahamse  
professional land surveyors  
2nd floor wale street chambers  
38 wale street, cape town  
Tel : +27 021 426 2613  
info@dhaa.co.za www.dhale.co.za







**FREE STATE FARM SCHEDULE - ADMINISTRATIVE DISTRICTS OF WESSELSBRON and WELKOM.**

WESSELSBRON				WELKOM											
FARM NO.	PORTION NO.	FARM NO.	PORTION NO.	FARM NO.	PORTION NO.	FARM NO.	PORTION NO.	FARM NO.	PORTION NO.	FARM NO.	PORTION NO.	FARM NO.	PORTION NO.	FARM NO.	PORTION NO.
318	3	353	5	17	RE										
318	5	353	6	24											
319	1	353	7	26											
319	RE	353	8	27	1										
320		353	RE	27	RE										
321		354		29	1										
323		355		29	2										
325		356		29	3										
326		358	1	29	4										
327		358	RE	29	5										
328	1	359		32											
328	2	360		35	1										
328	3	361		35	2										
328	4	362		35	3										
328	RE	363		35	4										
329		364	1	35	5										
330		364	RE	35	6										
331	2	366		35	7										
331	3	367	1	35	8										
332		367	RE	35	RE										
333	1	368	1	36	1										
333	2	368	RE	39	3										
333	RE	371		46	1										
334		372		46	2										
335		373		46	3										
336		374		46	4										
337		376		46	RE										
339		377		48											
340		378		58											
341		379		72	RE										
342		381		83											
344		382		84											
345		383		91	1										
346		384	1	91	RE										
348	1	384	RE	107	1										
348	RE	385	RE	107	RE										
349	1	386		108											
349	2			111											
349	3			112											
349	4			120											
349	5			128											
349	6			130											
349	7			135	1										
349	RE			135	2										
350	1			135	RE										
350	2			138	1										
350	3			138	RE										
350	4			140											
350	5			158											
350	RE			162											
351	1														
351	2														
351	3														
351	4														
351	RE														
352															
353	1														
353	2														
353	3														
353	4														

REGULATION 2(2) PLAN OF LAND

UNDER APPLICATION FOR AN  
EXPLORATION RIGHT FOR OIL, GAS  
AND NATURAL GAS

PERMIT No.: \_\_\_\_\_

PASA REFERENCE No.: \_\_\_\_\_

SIGNATURE: \_\_\_\_\_

DATE: \_\_\_\_\_

CHIEF EXECUTIVE OFFICER PETROLEUM  
AGENCY SA : CAPE TOWN

APPLICANT: RHINO OIL & GAS EXPLORATION  
SOUTH AFRICA LTD

SIGNATURE: \_\_\_\_\_

DATE: \_\_\_\_\_

Prepared by: R. C. Abrahamse - PLS No. 0002  
Professional Land Surveyor

in accordance with Regulation 2(2) of the regulations in terms of the Mining Titles Registration Act 16 of 1967, provided that the figure depicted and described on this plan, the area of the figure and the co-ordinates listed thereon are subject to change, as may be necessary, to conform to the requirements in respect of the definition of co-ordinated point, contained in regulation 3 of the regulations in terms of the Mining Titles Registration Act, 16 of 1967

PASA REFERENCE No. 12/2/108 & 109

Signature : *R. C. Abrahamse*

Date 19 January 2022

Reference No. ER 318 (Rev. A)

Drawing No. FREE STATE FARMS (sheet 14 of 14)

<b>dh+a</b>	<b>david hellig+abrahamse</b> professional land surveyors 2nd floor wale street chambers 38 wale street, cape town Tel : +27 021 426 2613 info@dhaa.co.za www.dhale.co.za
-------------	--





NAME	Y	X	NAME	Y	X	NAME	Y	X	REGULATION 2(2) PLAN OF LAND UNDER APPLICATION FOR AN EXPLORATION RIGHT FOR OIL, GAS AND NATURAL GAS	
166	-8 597.86	3 040 702.14							PERMIT No.: _____	
167	-8 691.29	3 040 796.71							PASA REFERENCE No.: _____	
168	-7 443.39	3 039 439.29							SIGNATURE: _____	
169	-7 347.71	3 039 379.60							DATE: _____	
170	-7 323.39	3 039 326.82							CHIEF EXECUTIVE OFFICER PETROLEUM AGENCY SA : CAPE TOWN	
171	-7 339.94	3 039 247.35							APPLICANT: RHINO OIL & GAS EXPLORATION SOUTH AFRICA LTD	
172	-7 363.45	3 039 193.43							SIGNATURE: _____	
173	-7 439.23	3 039 142.87							DATE: _____	
174	-7 006.45	3 039 037.18							Prepared by: R. C. Abrahamse - PLS No. 0002 Professional Land Surveyor	
									in accordance with Regulation 2(2) of the regulations in terms of the Mining Titles Registration Act 16 of 1967, provided that the figure depicted and described on this plan, the area of the figure and the co-ordinates listed thereon are subject to change, as may be necessary, to conform to the requirements in respect of the definition of co-ordinated point, contained in regulation 3 of the regulations in terms of the Mining Titles Registration Act, 16 of 1967	
									PASA REFERENCE No. 12/2/108 & 109	
									Signature : <i>R. C. Abrahamse</i>	
									Date	19 January 2022
									Reference No.	ER 318 (Rev. A)
									Drawing No.	FREE STATE FARMS (sheet 7 of 14)
									 <b>david hellig+abrahamse</b> professional land surveyors 2nd floor wale street chambers 38 wale street, cape town Tel : +27 021 426 2613 <a href="mailto:info@dhaa.co.za">info@dhaa.co.za</a> <a href="http://www.dhale.co.za">www.dhale.co.za</a>	