



ENVIRONMENTAL  
MANAGEMENT  
GROUP

PUBLIC  
PARTICIPATION  
REPORT

PROPOSED NURSING  
COLLEGE AND  
NURSING  
ACCOMMODATION  
DEVELOPMENT IN  
KIMBERLEY

## Contents

|   |    |
|---|----|
| INTRODUCTION.....                                     | 3  |
| APPROACH AND METHODOLOGY .....                        | 3  |
| PUBLIC PARTICIPATION PROCESS CONDUCTED .....          | 3  |
| NEWSPAPER ADVERTISEMENT .....                         | 3  |
| SITE NOTICES.....                                     | 6  |
| DISTRIBUTION OF BACKGROUND INFORMATION DOCUMENT ..... | 13 |
| POTENTIAL ENVIRONMENTAL IMPACTS .....                 | 19 |
| ENVIRONMENTAL AUTHORISATION AND WULA PROCESS .....    | 20 |
| NOTIFICATION SENT TO LOCAL AUTHORITY AND I&AP'S.....  | 23 |
| LIST OF STAKEHOLDERS .....                            | 24 |
| RESPONSES RECEIVED FROM I&APS .....                   | 25 |
| CONCLUSION .....                                      | 26 |

**ABBREVIATIONS**

|          |  |
|----------|--|
| BID      | Background Information Document  |
| DWS      | Department of Water and Sanitation   |
| RI&APS   | Registered Interested & Affected Parties   |
| I&APS    | Interested & Affected Parties  |
| PPP      | Public Participation Process   |
| DFFE     | Department of Forestry, Fisheries and The Environment                                |
| DAEARDLR | Department of Agriculture, Environmental Affairs, Rural Development, and Land Reform |
| EA       | Environmental Authorization  |
| DPWR     | Department of Public Works and Roads   |
| BAR      | Basic Assessment Report  |
| EAP      | Environmental Assessment Practitioner  |

## INTRODUCTION

The Public Participation Process (PPP) forms an integral part of the rectification application process. It provides people with the opportunity to raise their issues and concerns about the proposed Nursing college and student accommodation development in Kimberley, Northern Cape Province. A comprehensive public participation process was conducted by EMG Consultants, to ensure that all identified Interested and Affected Parties (I&APs) were informed of the proposed project and their input is able to influence decision-making process with regards to the development.

## APPROACH AND METHODOLOGY

The Public Participation Process was conducted as per Regulation 39, 40, 41, 42, 43 & 44 of the Environmental Impact Assessment Regulations 2014 (as amended 07 April 2017) and the Public Participation Guidelines, 2017 were considered. Steps, which were taken to inform the identified I&APs and surrounding community of the proposed development included:

- ♣ Newspaper advertisement;
- ♣ On site Notice and Posters;
- ♣ Notifications, i.e. Distribution of Background Information Document (BID) to neighbouring property Owners & Stakeholders.

## PUBLIC PARTICIPATION PROCESS CONDUCTED

The methods that were undertaken during conducting of the public participation process as discussed in detail below.

## NEWSPAPER ADVERTISEMENT

The project was advertised in a local newspaper, Noordkaap Bulletin 17<sup>th</sup> of June 2021 to inform the I&APs of the proposed nursing college and student Accommodation Development.

## NOTICE OF APPLICATION FOR ENVIRONMENTAL IMPACT ASSESSMENT

Notice is hereby given in terms of regulation 41 of Government Notice No. R328 under the National Environmental Management Act (Act 107 of 1998) as amended 7 April 2017, as well as in terms of the National Water Act (Act 36 of 1998) Section 21 of intent to carry out the following project:

### APPLICATION FOR THE PROPOSED NURSING COLLEGE AND NURSING ACCOMMODATION DEVELOPMENT

**NEMA: Listing Notice 1 (NO. 327, 07 APRIL 2017)**

|      |    |  |
|------|----|--|
| R327 | 27 | The clearance of an area of 1 hectare or more, but less than 20 hectares of indigenous vegetation, except where such clearance of indigenous vegetation is required for-<br>(i) the undertaking of a linear activity; or<br>(ii) <del>conservation</del> purposes undertaken in accordance with a maintenance management plan. |
|------|----|--|

**NWA: Section 21 (ACT NO. 36 of 1998) as amended**

(a) ~~taking~~ water from a water resource;

**LOCATION:** Kimberley, situated on the farm ~~Bultfontein~~, 80 on remaining extent, Sol ~~Plaatje~~ Local Municipality

**PROPONENT:** Department Roads and Public Works Northern Cape

**CONSULTANT:** ENVIRONMENTAL MANAGEMENT GROUP  
PO BOX 37473  
LANGENHOVEN PARK, 9330  
TEL: 051 412 6350  
CELL PHONE: 083 678 3032  
EMAIL: [cknugen@envmgrp.com](mailto:cknugen@envmgrp.com)

In order to ensure that you are identified as an interested and/or affected party, please submit your name, contact information and interest in the matter to the consultant given above. A Background Information Document (BID) will be available at the Sol ~~Plaatje~~ Local Municipality and the Mental Health Hospital.

A BID document will also be made available on request.

Thirty days are allowed for your comments to reach us as per NEMA (Act 107, 1998, amended 7 April 2017), GNR 328.

ADVERTISER NEWS



The Flamingo Casino's Harvest Grill & Wine is a family-friendly à la carte steakhouse.  
PHOTO: SUPPLIED

# Voucher up for grabs

One reader of NoordkaapBulletin stands the chance of winning a meal voucher to the value of R1 000 – compliments of Flamingo Casino – to spend at the Harvest Grill & Wine restaurant in Kimberley for Father's Day on Sunday (20th).

Flamingo Casino's Harvest Grill & Wine is a family-friendly à la carte steakhouse with an extensive menu.

Executive sous chef, Francis Hegarty, and his team have curated a grill special that will appeal to dads.

"We want to give the man of the house something that he loves to eat, but doesn't have to cook himself."

Treat your dad this Father's Day with a mixed grill special with chips and a local beer or cold drink at Harvest Grill & Wine. Lunch will be served from 12:30 to 1:00.

Come hungry and spend the day together as a family over a delicious Sunday lunch."

**Terms and conditions**  
The prize is not transferable for cash.

The winner will need to redeem the prize on Father's Day.

Only entries with valid contact details – name, surname, cellphone number and email address – will be considered.

**Rules for entering**

To stand a chance to win with Flamingo Casino and NoordkaapBulletin, use these sentences to express why your dad is so special.

Send your entry, accompanied by your name, surname, cellphone number and email address, to [helena.hartard@mediana.com](mailto:helena.hartard@mediana.com) or send a message on the Facebook page NoordkaapBulletin.

The closing date for entries is Friday (18th) at 12:00. The winner will be contacted during the day.

# Follow Flamingo Casino for news updates by visiting its Facebook page.

## NOTICE OF APPLICATION FOR ENVIRONMENTAL IMPACT ASSESSMENT

Notice is hereby given in terms of regulation 41 of Government Notice No. R326 under the National Environmental Management Act (Act 107 of 1998) as amended 7 April 2017, as well as in terms of the National Water Act (Act 36 of 1998) Section 21 of intent to carry out the following project:

### APPLICATION FOR THE PROPOSED NURSING COLLEGE AND NURSING ACCOMMODATION DEVELOPMENT

NEMA: Listing Notice 1 (NO. 327, 07 APRIL 2017)

|      |    |  |
|------|----|--|
| R327 | 12 | The development of-<br>(i) infrastructure or structures with a physical footprint of 100 square metres or more;<br>(ii) if no development setback exists, within 32 metres of a watercourse, measured from the edge of a watercourse   |
| R327 | 27 | The clearance of an area of 1 hectare or more, but less than 20 hectares of indigenous vegetation, except where such clearance of indigenous vegetation is required for-<br>(i) the undertaking of a linear activity; or<br>(ii) maintenance purposes undertaken in accordance with a maintenance management plan. |

**NWA: Section 21 (ACT NO. 36 of 1998) as amended**

(a) taking water from a water resource;  
(c) impeding or diverting the flow of water in a watercourse;  
(i) altering the bed, banks, course or characteristics of a watercourse;  
**LOCATION:** Kimberley, situated on the farm Bulfontein, 80 on remaining extent, Sol Plaatje Local Municipality

**PROPOSITOR:** Department Roads and Public Works Northern Cape  
**CONSULTANT:** ENVIRONMENTAL MANAGEMENT GROUP  
PO BOX 37473  
LANGENHOVEN PARK, 9330  
TEL: 051 412 6350  
CELL PHONE: 083 678 3032  
EMAIL: [clrugen@emwmp.com](mailto:clrugen@emwmp.com)

In order to ensure that you are identified as an interested and/or affected party, please submit your name, contact information and interest in the matter to the consultant given above. A Background Information Document (BID) will be available at the Sol Plaatje Local Municipality and the Mental Health Hospital.

A BID document will also be made available on request.  
**Thirty days are allowed for your comments to reach us as per NEMA (Act 107, 1998, amended 7 April 2017), GNR 326.**

 **public works & infrastructure**  
Department  
Public Works and Infrastructure  
REPUBLIC OF SOUTH AFRICA

**DEPARTMENT OF PUBLIC WORKS & INFRASTRUCTURE TENDERS CLOSING 02 JULY 2021 AT 11h00**

Documents sold are Non- Refundable

| SERVICE DESCRIPTIONS:  |  |
|--|--|
| PF35/2021  | <b>WARRENTON MAGISTRATE COURT:</b> Provisioning of cleaning services for a period of 36 months. (900m <sup>2</sup> ) <b>DOCUMENT: R100.00.</b><br><br>Compulsory briefing session on the 25 <sup>th</sup> June 2021 at 09h00. Venue: In the Court Room. Interested bidders are advised to book a time slot with the Project Leader not later than 09h00 on the 25 <sup>th</sup> June 2021.   |
| PF37/2021  | <b>KATHU MAGISTRATE COURT:</b> Provisioning of cleaning services for a period of 36 months. (1300m <sup>2</sup> ) <b>DOCUMENT: R100.00.</b><br><br>Compulsory briefing session on the 24 <sup>th</sup> June 2021 at 09h00. Venue: Kathu Magistrate Court. Interested bidders are advised to book a time slot with the Project Leader not later than 09h00 on the 24 <sup>th</sup> June 2021. |
| Tender to be awarded to the highest scoring acceptable tender. Points will be allocated for:<br>a. Price and Preference: according to formula in PPPFA: Regulations 2017<br>b. Tenderer must comply with the Pre-qualification criteria for Preferential Procurement. A tenderer having stipulated minimum BBSEE status level of contributor: Level 1<br>c. Certificates will be verified with issuing institutions. Bidders are required to submit proof of BBSEE status level of contributor, failure to do so may result in a disqualification. |  |
| NOTE: Documents will be sold at a non-refundable deposit. Contact for Bid information: General Enquiries:<br>Mrs G Aysen Ms N. Diale<br>053 838 5221 053 838 5275 / 082 826 0053   |  |

Tender documents available from: Department of Public Works Infrastructure  
Old Magistrates Office  
21-23 Market Square, KIMBERLEY, 8301

 **public works & infrastructure**  
Department  
Public Works and Infrastructure  
REPUBLIC OF SOUTH AFRICA

**DEPARTMENT OF PUBLIC WORKS & INFRASTRUCTURE TENDERS CLOSING 07 JULY 2021 AT 11h00**

Documents sold are Non- Refundable

| SERVICE DESCRIPTIONS:   |  |
|---|--|
| LS08/2021   | <b>POSTMASBURG DEPT OF EMPLOYMENT AND LABOUR:</b> Alternative office accommodation – 475m <sup>2</sup> and 08 parking bays for a period of 5 years. <b>DOCUMENT: R200.00</b> |
| LS09/2021   | <b>UPINGTON SASSA LOCAL OFFICE:</b> New office accommodation – 788m <sup>2</sup> and 06 parking bays and 1 bay for a truck for a period of 5 years. <b>DOCUMENT: R300.00</b> |
| LS10/2021   | <b>NIUWOUDTVILLE SASSA: LOCAL OFFICE:</b> New office accommodation – 74.55m <sup>2</sup> and 01 parking bay for a period of 5 years. <b>DOCUMENT: R100.00</b>                |
| LS11/2021   | <b>PAMPIERSTAD SASSA: LOCAL OFFICE:</b> New office accommodation – 192m <sup>2</sup> and 01 parking bay for a period of 5 years. <b>DOCUMENT: R100.00</b>                    |
| Tender to be awarded to the highest scoring acceptable tender. Points will be allocated for:<br>a. Price and Preference: according to formula in PPPFA: Regulations 2017<br>b. Tenderer must comply with the Pre-qualification criteria for Preferential Procurement. Category A, B, C and D<br>c. Certificates will be verified with issuing institutions. Bidders are required to submit proof of BBSEE status level of contributor, failure to do so may result in a disqualification.<br>d. Functionality is applicable as pre-qualification criteria. Minimum functionality will be 50%. |  |
| NOTE: Documents will be sold at a non-refundable deposit OR can be downloaded from the Departmental Website: <a href="http://www.publioworks.gov.za/tenders">www.publioworks.gov.za/tenders</a><br>Contact for Bid information: General Enquiries:<br>Mrs G Aysen Ms S. Molokomme<br>053 838 5221 053 838 5275  |  |

Tender documents available from: Department of Public Works Infrastructure  
Old Magistrates Office  
21-23 Market Square, KIMBERLEY, 8301

## SITE NOTICES

Site notices was placed on site and in the surrounding area to bring the proposed development to the attention of I&APs including surrounding land users.

# NOTICE OF APPLICATION FOR ENVIRONMENTAL IMPACT ASSESSMENT

Notice is hereby given in terms of regulation 41 of Government Notice No. R328 under the National Environmental Management Act (Act 107 of 1998) as amended 7 April 2017, as well as in terms of the National Water Act (Act 36 of 1998) Section 21 of intent to carry out the following project:

## APPLICATION FOR THE PROPOSED NURSING COLLEGE AND NURSING ACCOMMODATION DEVELOPMENT

**NEMA: Listing Notice 1 (NO. 327, 07 APRIL 2017)**

|      |    |   |
|------|----|---|
| R327 | 27 | The clearance of an area of 1 hectare or more, but less than 20 hectares of indigenous vegetation, except where such clearance of indigenous vegetation is required for-<br>(i) the undertaking of a linear activity; or<br>(ii) <u>maintenance</u> purposes undertaken in accordance with a maintenance management plan. |
|------|----|---|

**NWA: Section 21 (ACT NO. 36 of 1998) as amended**

(a) taking water from a water resource;

**LOCATION:** Kimberley, situated on remaining extent of Erf Number 42854, Sol Fleetjie Local Municipality

**PROPONENT:** Department Roads and Public Works Northern Cape

**CONSULTANT:** ENVIRONMENTAL MANAGEMENT GROUP  
PO BOX 37473  
LANGENHOVEN PARK, 8330  
TEL: 051 412 6350  
CELL PHONE: 083 678 3032  
EMAIL: [ckruger@envmgp.com](mailto:ckruger@envmgp.com)

In order to ensure that you are identified as an interested and/or affected party, please submit your name, contact information and interest in the matter to the consultant given above. A Background Information Document (BID) will be available at the Sol Fleetjie Local Municipality and the Mental Health Hospital.

A BID document will also be made available on request.

**Thirty days are allowed for your comments to reach us as per NEMA (Act 107, 1998, amended 7 April 2017), GNR 326.**















PROPOSED NURSING COLLEGE DEVELOPMENT IN KIMBERLEY  
PUBLIC PARTICIPATION REPORT





PROPOSED NURSING COLLEGE DEVELOPMENT IN KIMBERLEY  
PUBLIC PARTICIPATION REPORT

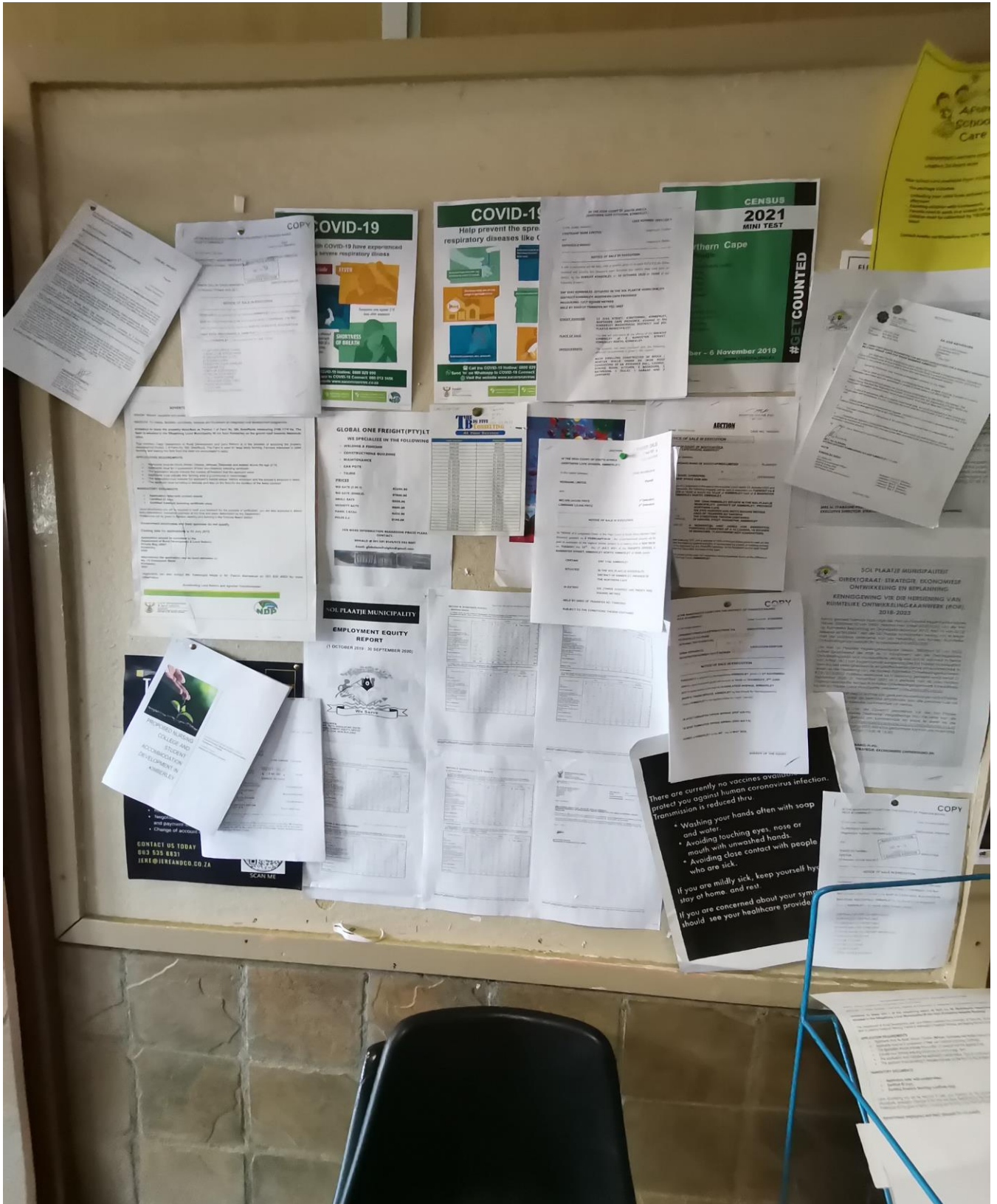

PROPOSED NURSING COLLEGE DEVELOPMENT IN KIMBERLEY  
PUBLIC PARTICIPATION REPORT

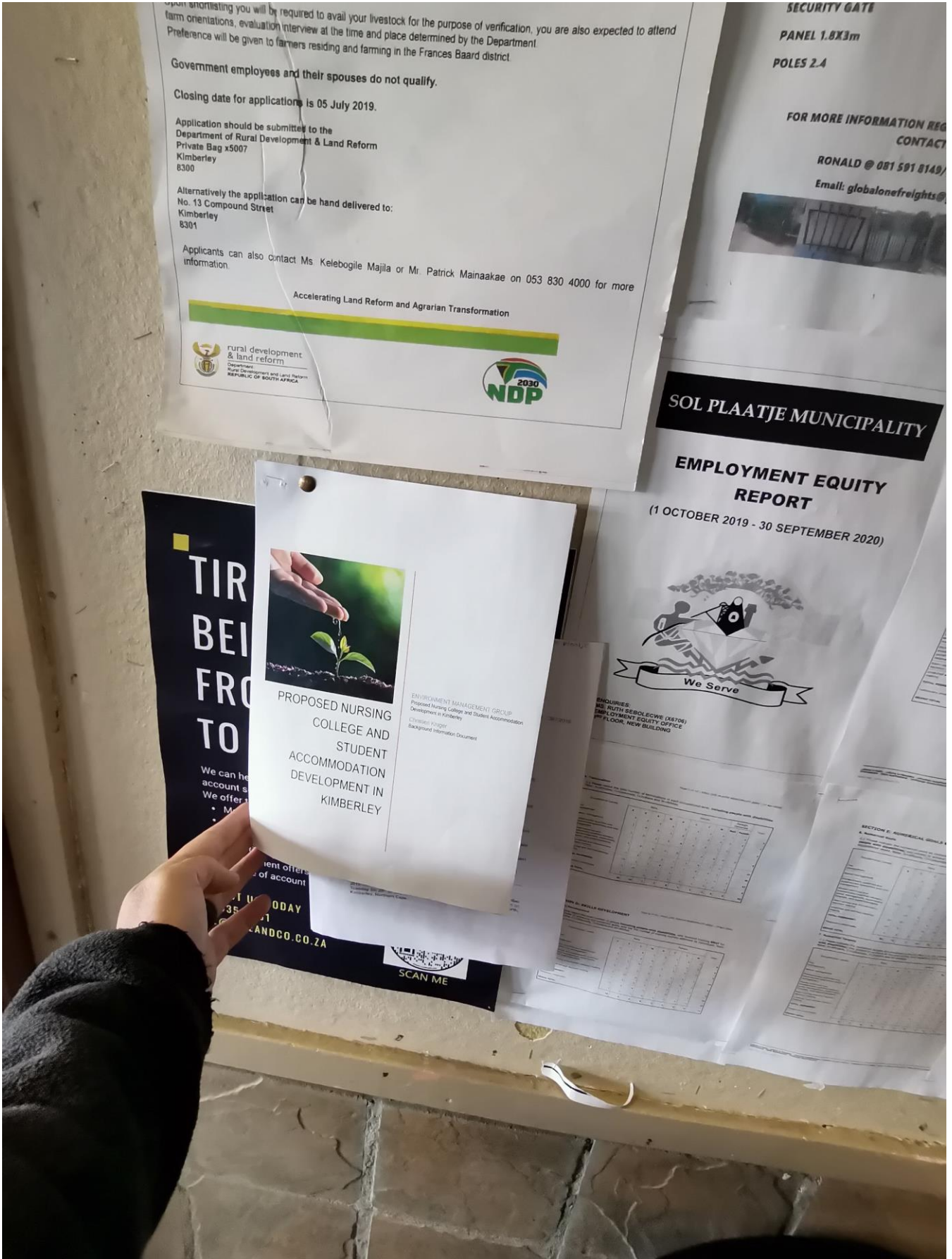



## DISTRIBUTION OF BACKGROUND INFORMATION DOCUMENT



# PROPOSED NURSING COLLEGE AND STUDENT ACCOMMODATION DEVELOPMENT IN KIMBERLEY

### ENVIRONMENT MANAGEMENT GROUP

Proposed nursing college and student accommodation development in Kimberley, Northern Cape Province.

### CHRISTIEN KRUGER

Background Information Document

## Background Information document for the Proposed nursing college and student accommodation development in Kimberley, Northern Cape Province.

April 2021

### INTRODUCTION

Environmental Management Group is applying for Environmental Authorisation on behalf of the Department of Roads and Public Works Northern Cape for the proposed Nursing College phase two (2) and the Student Accommodation Development.

### LOCALITY

The development will take place in Kimberley on remaining extent of Erf Number 42654 which falls under the Sol Plaatje Local Municipality, in the Northern Cape Province.

### ENVIRONMENTAL AUTHORISATION

Prior to the commencement of the proposed development, Environmental Authorisation in terms of the National Environmental Management Act (NEMA), 107 of 1998, as amended 7 April 2017 is required from the competent authority (DENC). The Environmental Assessment Process will be conducted in terms of the 2014 NEMA environmental impact assessment (EIA) Regulations, GNR 326 as amended.

According to the National Environmental Management Act (Act 107 of 1998) as amended 7 April 2017, Listing Notice 1 (NO. 327, 07 APRIL 2017) – R 327 the following activity applicable to this project:

- ♣ **Activity 27:** The clearance of an area of 1 hectare or more, but less than 20 hectares of indigenous vegetation, except where such clearance of indigenous vegetation is required for-
  - (i) the undertaking of a linear activity; or
  - (ii) maintenance purposes undertaken in accordance with a maintenance management plan.

### PURPOSE OF THIS DOCUMENT

EMG has prepared this document to inform you about:

- ♣ The proposed project;
- ♣ The current understanding of the baseline environmental and social conditions;
- ♣ The required environmental assessment processes;
- ♣ Possible environmental impacts and proposed specialist studies;
- ♣ How you can have input into the Environmental Authorization;
- ♣ Impact Assessment and Basic Assessment processes.

### YOU'RE ROLE

You have been identified as an interested and/or affected party (I&AP) who may want to be informed about the proposed project and have input into the environmental assessment processes and environmental reports.

You have an opportunity to review this document and provide your initial comments to us for incorporation in the environmental assessment process. You will also be given the opportunity to provide input at the public meeting, if the need arises. And to review and comment on some reports:

- ♣ Basic Assessment Report

**Comments will be recorded and included in the reports submitted to the relevant authorities for decision-making.**

### HOW TO RESPOND

If you are interested in receiving further information on the project, please register your details with the persons listed below. Responses to this document can be submitted by means of the attached comments sheet and/or through communication with the persons listed below.

Christien Kruger

Tel: 051 412 6350 or Fax: 051 412 6351

E-mail: [ckruger@envmqp.com](mailto:ckruger@envmqp.com)

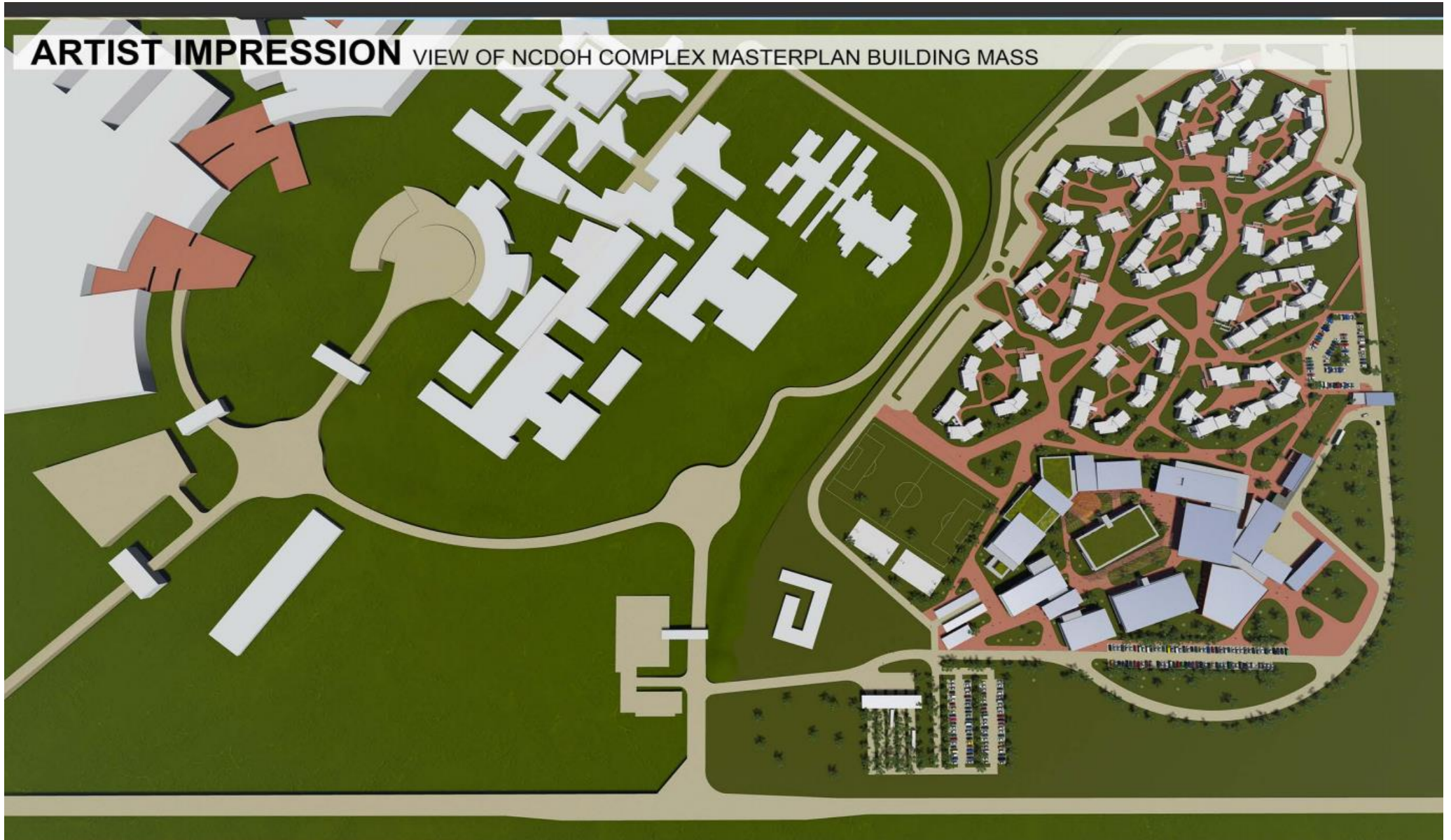



# SITEPLAN PHASE 2A & 2B

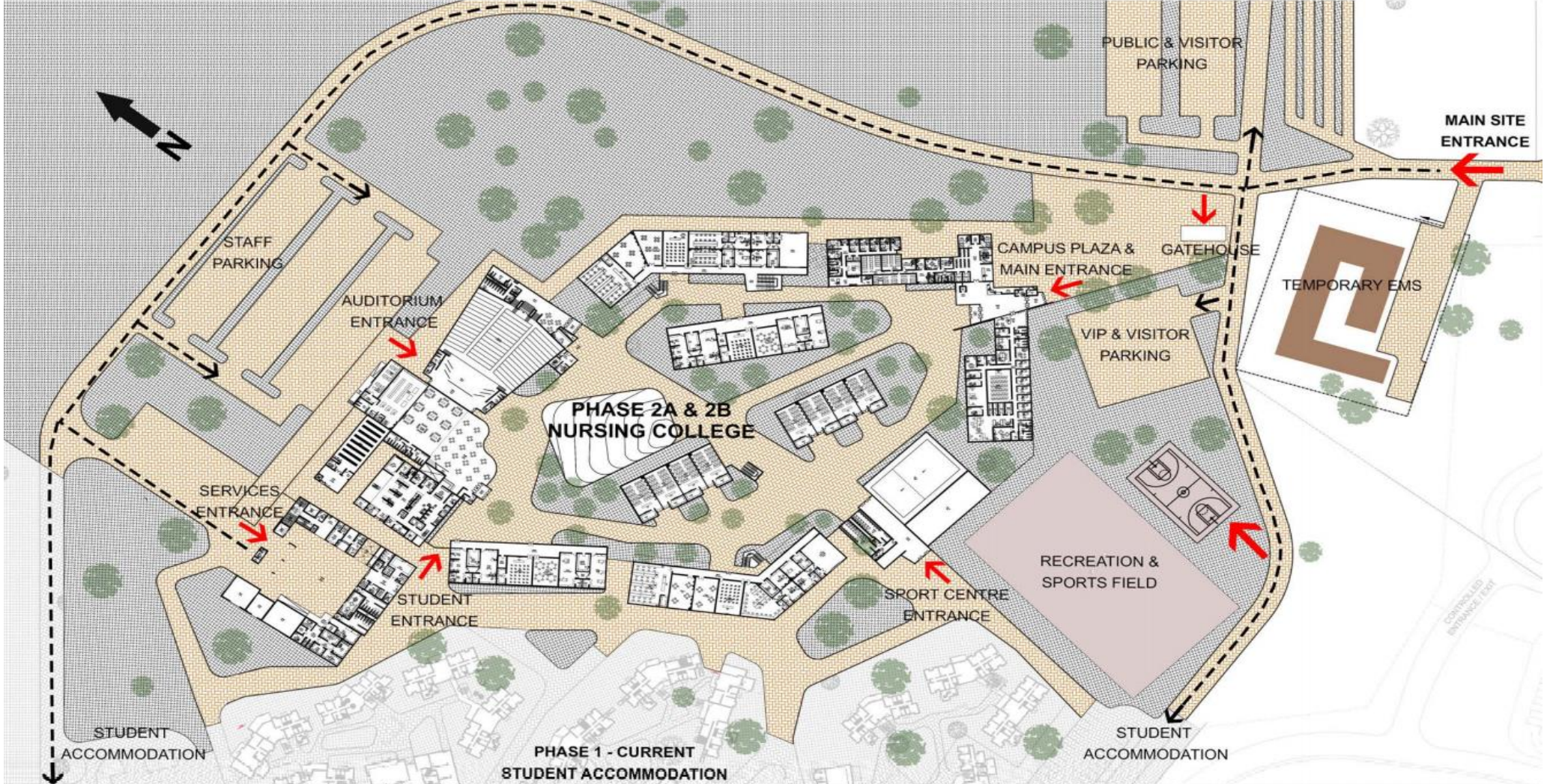



# CAMPUS ANALYSIS

## RINGS OF SECURITY

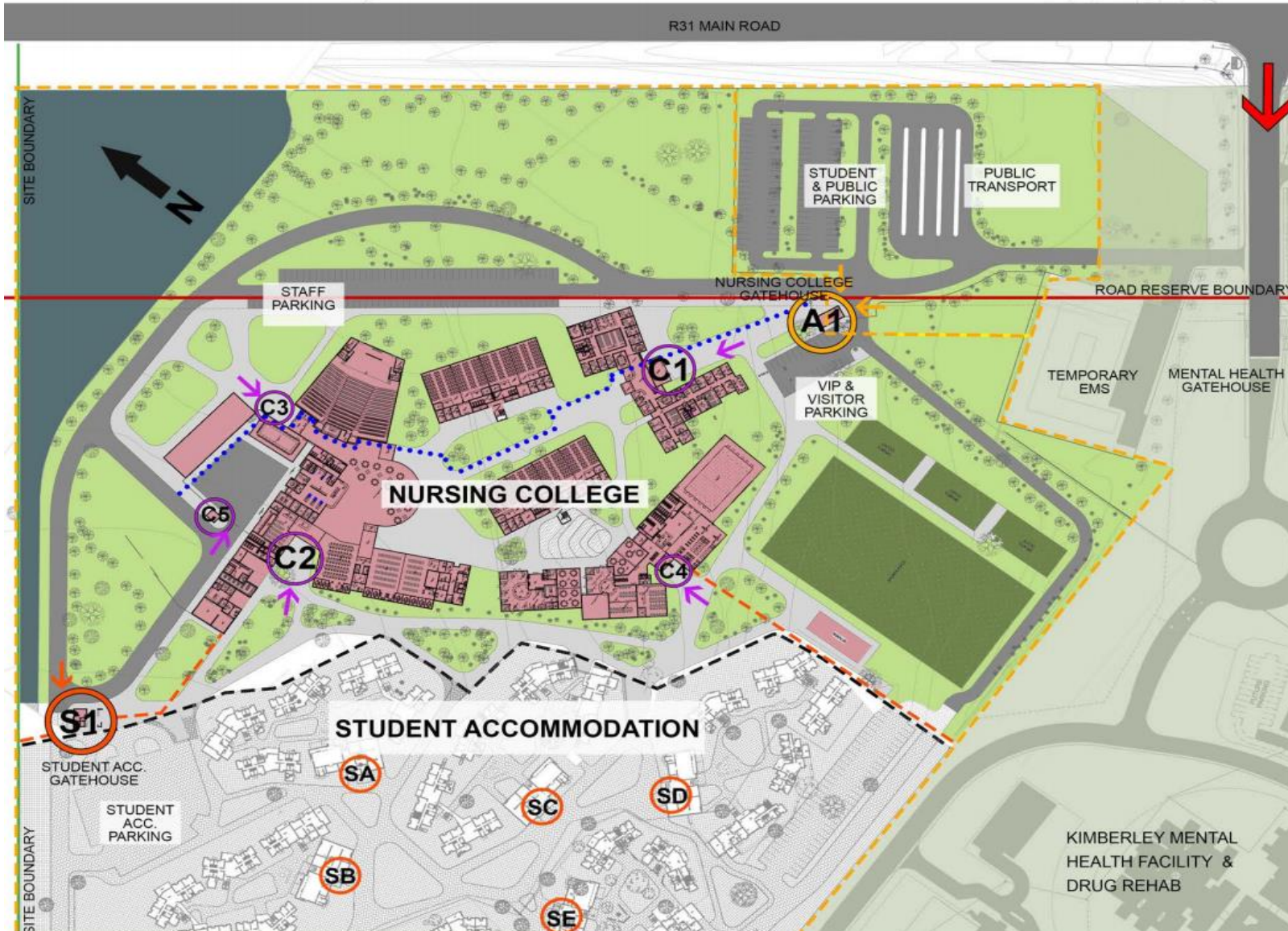

### PRIMARY RING

**NURSING COLLEGE CAMPUS**  
MAIN GATEHOUSE, PERIMETER FENCE AND PARKING AREAS  
**A1 - MAIN CAMPUS GATEHOUSE**  
VEHICULAR & PEDESTRIAN

### SECONDARY RING

**NURSING COLLEGE**  
STUDENTS, STAFF, VISITORS AND SUPPORT SERVICES  
**C1 - MAIN COLLEGE ENTRANCE**  
(VISITORS & STUDENTS)  
**C2 - STUDENT ENTRANCE**  
(VISITOR & STAFF)  
**C3 - STAFF ENTRANCE**  
(VISITOR & STAFF)  
**C4 - STUDENT ENTRANCE**  
**C5 - SERVICES ENTRANCE (VEHICULAR)**

### SECONDARY RING

**STUDENT ACCOMMODATION**  
GATEHOUSE AND ACCOMMODATION CLUSTER CONTROL  
**S1 - STUDENT ACC. GATEHOUSE**  
VEHICULAR & PEDESTRIAN  
**SA - CLUSTER A ACCOMMODATION**  
**SB - CLUSTER B ACCOMMODATION**  
**SC - CLUSTER C ACCOMMODATION**  
**SD - CLUSTER D ACCOMMODATION**  
**SE - CLUSTER E ACCOMMODATION**  
10X CLUSTERS IN TOTAL

### ACCESS CONTROL



## PROJECT DESCRIPTION

Environmental Management Group is applying for Environmental Authorization on behalf of the Northern Cape Department: Roads and Public Works for the development as mentioned above. The development is situated in the southern parts of Kimberley, which falls within the Sol Plaatje Municipality. Construction of the Kimberley nursing college phase two (2) is underway on the remaining extent of Erf Number 42654. The nursing college is nearest to Kimberley and immediately south of the R31 route from Kimberley to Daniëlskuil and next to the Kimberley Mental Health Hospital. The development will accommodate the educational facility and housing of approximately 600 students. The college will include various simulation, instruction, and academic classrooms to learn in a safe and controlled environment (Figure designs/layout). The college will additionally incorporate spaces for both sport and recreation.

Environmental Authorization in terms of the National Environmental Management Act (NEMA), 107 of 1998, as amended 7 April 2017 is required from the competent authority (DENC). According to the National Environmental Management Act (Act 107 of 1998) as amended 7 April 2017, Listing Notice 1 (NO. 327, 07 APRIL 2017) – R 327 the following activity applicable to this project:

**R327: Activity 27** The clearance of an area of 1 hectare or more, but less than 20 hectares of indigenous vegetation, except where such clearance of indigenous vegetation is required for-  
(i) the undertaking of a linear activity; or  
(ii) maintenance purposes undertaken in accordance with a maintenance management plan.

The Nursing College will require the establishment of the following infrastructure:

- ♣ Cafeteria/ Support services – 1000sqm
- ♣ Laundry- 300sqm
- ♣ Kitchen- 600sqm
- ♣ Convenience shop- 340sqm
- ♣ Auditorium- 1400sqm
- ♣ Administration buildings- 1870sqm
- ♣ 4 Simulation buildings- 3740sqm
- ♣ Academic instruction buildings- 1000sqm
- ♣ Sports center- 1200sqm
- ♣ Student parking
- ♣ Sports field
- ♣ Clinic
- ♣ 24hr computer lab

The Kimberley mental health hospital is situated immediately south of the proposed development. The Kimberley mental health hospital has obtained its own environmental authorization. The development of the nursing college phase two (2) and student accommodation requires its own environmental authorization separate of the already obtained EA for the Kimberley mental health hospital.

**Waste:** The proponent is taking necessary steps to ensure that waste generated through the proposed development will be properly disposed of. The fact that no hazardous or medical waste will be produced by the facility is also reassuring from an environmental and public health perspective. It's important to note, however, that even non-hazardous waste can have a negative impact on the environment if it's not properly disposed of. The proponent must outline how waste will be collected, transported, and disposed of in compliance with local regulations and best practices.

The Architect's designs concerning the sewer layout/ sewer reticulation system of the proposed development (Kimberley nursing college phase two) and these infrastructure of the designs are designed in a such a manner that will relatively limit a serious harm to the environment, particularly if it is not handled properly. A sewer reticulation system helps to prevent the release of hazardous waste into the environment, protecting natural resources like waterways, soil, and air. And the implementation of an effective sewer reticulation system can help reduce the costs associated with hazardous waste management, by minimizing the volume of hazardous waste that needs to be transported and disposed of off-site, a facility can save on transportation and disposal costs.

The Sol Plaatje Local Municipality will most likely play a fundamental role in the approval of the steps that will be taken to ensure that waste is disposed of in an environmentally sustainable manner. The proponent needs to work closely with the local municipality to ensure that the waste generated by the proposed development is handled in an environmentally responsible and sustainable way. This will help to minimize the impact of the facility on the environment and promote the health and well-being of the local community

**Water:** The proponent is taking necessary steps to ensure that the water needs for the proposed development will be met sustainably. Drilling additional boreholes and building a backup storage reservoir will give support to ensure a reliable supply of water for the proposed development while using borehole water for non-potable uses like watering gardens and sports fields can help to reduce the demand for potable water. The proponent will be obtaining approval from the local municipality and a relevant water use license authorization for this activity. This indicates that the proponent is taking the necessary steps to comply with local regulations and best practices for water management.

According to the new designs for the Kimberley nursing college phase two (2), Architects have taken comprehensive steps to ensure storm water management is taken into account in the designs of the proposed development. Storm water runoff can be a major source of pollution and environmental damage, so it is important to manage it properly by incorporating the design features from the architects and the designs can significantly minimize the environmental impacts of the proposed development and ensure the long-term sustainability of the water supply.

**(a) taking water from a water resource;**

Environmental features: Several camel thorn trees on the site will have to be removed due to the development. A DAFF permit will be applied for the removal of these trees. There exists a storm water channel on the north western border of the site. A comprehensive storm water plan and a flood delineation will be included in the basic assessment report. Eskom will supply the electricity for the facility.

## POTENTIAL ENVIRONMENTAL IMPACTS

Below is a preliminary list of potential impacts identified at this stage of the process and will be investigated as part of the environmental assessment process. The list will be refined during the course of the Basic Assessment Process.

- ♣ Safety:
- ♣ Biodiversity:
- ♣ Surface water:
- ♣ Groundwater:
- ♣ Heritage/cultural and paleoanthropological resources:
- ♣ Land use:

## ENVIRONMENTAL AUTHORISATION AND WULA PROCESS

The environmental assessment processes will be conducted to inform the competent authorities in their decision-making. These processes are conducted simultaneously.

### STEPS IN THE ENVIRONMENTAL AUTHORISATION PROCESSES

The environmental authorisation processes provides information on the project and environment in which it is being undertaken; identifies, in consultation with registered interested & affected parties (RI&APs), the potential negative as well as positive impacts of the project; and reports on management measures required to mitigate impacts to an acceptable level. The likely process steps and timeframes are provided below. RI&APs and other stakeholders on the project's database will receive notification of public participation opportunities in advance.

### PUBLIC PARTICIPATION

Public Participation provides Stakeholders and I&APs the opportunity to raise issues of concern and comment on the proposed activity. Notify other regulatory authorities and I&APs of project and environmental assessment (via newspaper advertisements, site notices and this BID document)

Public meeting with I&APs and regulatory authorities (if required)

Submit application to the DAEARDLR (14 days)

Submit draft BAR to the DAEARDLR

Public & authority review of draft BAR (30 calendar days) Update the draft BAR with comments received during the review period

Submit updated Final BAR to the DAEARDLR

Review of the Final BAR by the DAEARDLR (107 calendar days)

Submit WUL technical report and application forms to DWS

Circulate decision to RI&APs on the project database.

### **PARTIES INVOLVED IN THE ENVIRONMENTAL APPLICATION PROCESSES**

#### **IAPs**

- ♣ Surrounding landowners, land users and communities
- ♣ Parastatals

#### **KEY STAKEHOLDERS**

- ♣ Department of Agriculture and Rural Development
- ♣ Department of Water and Sanitation (DWS)
- ♣ Department of Heritage (SAHRA)

#### **LOCAL AUTHORITIES**

- ♣ Frances Baard District Municipality
- ♣ Sol Plaatjie Local Municipality
- ♣ Mayor & Ward Councillor

**Please let us know if there are any additional parties that should be involved.**

**PROPOSED NURSING COLLEGE DEVELOPMENT IN KIMBERLEY  
PUBLIC PARTICIPATION REPORT**

| <b>PROCESS STEPS (in accordance with GN326)</b>  | <b>RESPONSIBLE PARTY</b> | <b>TIMEFRAME</b> |
|--|--------------------------|------------------|
| 1. Initial communication to clarify the application with the Authorising Department.           | EAP                      | 1 day            |
| 2. EAP to conduct a site investigation   | EAP                      | 1 day            |
| 3. EAP to submit Application for Environmental Authorisation to the competent authority.       |                          | 1 day            |
| 4. Competent authority Accepts Application.  | DAEARDLR                 | 14 day           |
| 5. EAP to compile a Basic Assessment Report subjected to 30 days Public Participation Process. | EAP                      | 90 day           |
| 6. EAP to submit Final Basic Assessment Report inclusive of comments to competent authority.   | EAP                      | 1 day            |
| 7. Competent authority to grant or decline Approval for Environmental Authorisation.           | DAEARDLR                 | 107 day          |
| 8. Environmental Authorisation subject to 20 day appeal process.                               | EAP                      | 20 day           |
| 9. Final Approval of Environmental Authorisation.  | DAEARDLR                 | 1 day            |





NOTIFICATION SENT TO LOCAL AUTHORITY AND I&AP'S

PROPOSED NURSING COLLEGE AND NURSING ACCOMMODATION DEVELOPMENT BID - Message (HTML)

FILE MESSAGE

Ignore Delete Reply Forward Meeting Message Tracking Show

Wed 30 Jun 2021 08:04

Christen Kruger <ckruger@enwmpb.com>

**PROPOSED NURSING COLLEGE AND NURSING ACCOMMODATION DEVELOPMENT BID**

To: 'ntsviale@ncq.gov.za'; 'vandyg@nvs.gov.za'; 'fatima.rulers@fbdm.co.za'; 'ngantsh@sciplaafie.org.za'; 'bohluwayo@sciplaafie.org.za'; 'bonsilemahamba@gmail.com'; 'graceganacc@gmail.com'

Cc: 'mtd@enwmpb.com'

Message Kimberley BID.PDF (1 MB)

Quick Steps: Kathu Landfill, Team Email, Reply & Delete, To Manager, Done, Create New

Rules, OneNote, Mark Unread, Tags, Categorize, Follow Up, Translate, Find, Related, Select, Zoom

One Student

For detailed information and details of development, please visit [www.kimberley.gov.za/development/development.html](http://www.kimberley.gov.za/development/development.html).

**APPLICATION FOR THE PROPOSED NURSING COLLEGE AND NURSING ACCOMMODATION DEVELOPMENT**

With your kind support, I am pleased to announce that the proposed Nursing College and Nursing Accommodation Development is now open for public participation. The project is a key component of the development of the proposed Nursing College and Nursing Accommodation Development in Kimberley. The project is a key component of the development of the proposed Nursing College and Nursing Accommodation Development in Kimberley. The project is a key component of the development of the proposed Nursing College and Nursing Accommodation Development in Kimberley.

On 23 June 2021, the proposed Nursing College and Nursing Accommodation Development was open for public participation. The project is a key component of the development of the proposed Nursing College and Nursing Accommodation Development in Kimberley. The project is a key component of the development of the proposed Nursing College and Nursing Accommodation Development in Kimberley.

Your cooperation and support are appreciated.

Should you have any queries, please contact me on the number below.

Christen Kruger  
 Director: Nursing & Community Health Services  
 Kimberley Municipality  
 P.O. Box 1000  
 Kimberley 8100  
 Tel: 053 933 3333  
 Fax: 053 933 3333  
 Email: [ckruger@enwmpb.com](mailto:ckruger@enwmpb.com)



## LIST OF STAKEHOLDERS

| <b>List of Stakeholders and I&amp;AP's</b>                 |                              |  |   |                          |
|--|------------------------------|--|---|--------------------------|
| <b><u>Department / Organisation</u></b>                    | <b><u>Contact Person</u></b> | <b><u>E-Mail Address</u></b>   | <b><u>Address</u></b>                                   | <b><u>Contact Nr</u></b> |
| Department: Agriculture, Land Reform and Rural Development | Mrs Monnapula Tswaile        | <a href="mailto:mtswaile@ncpg.gov.za">mtswaile@ncpg.gov.za</a>               | 224 du Toitspan Road<br>Kimberley<br>8300               | 053 802 5600             |
| Northern Cape Department of Water & Sanitation             | Mr G Van Dyk                 | <a href="mailto:vandykg@dws.gov.za">vandykg@dws.gov.za</a>                   | 28 Central Road<br>Beaconsfield<br>Kimberley<br>8300    | (053) 836 7600           |
| Frances Baard District Municipality - MM                   | Ms Mamikie Bogatsu           | <a href="mailto:fatima.ruiters@fbdm.co.za">fatima.ruiters@fbdm.co.za</a>     | 51 Drakensberg Avenue, Carters Glen,<br>Kimberley, 8300 | 053 838 0998             |
| Sol Plaatje Local Municipality - Mayor                     | Mr SP Mabilo                 | <a href="mailto:tkgantsi@solplaatje.org.za">tkgantsi@solplaatje.org.za</a>   | Jan Smuts Boulevard, Kimberley, 8300                    | 053 830 6911             |
| Sol Plaatje Local Municipality - MM                        | Mr B Dhluwayo                | <a href="mailto:bdhluwayo@solplaatje.org.za">bdhluwayo@solplaatje.org.za</a> | Jan Smuts Boulevard, Kimberley, 8300                    | 053 830 6911             |
| Ward 26 Councilor - Sol Plaatje Local Municipality         | Mr PJ Makhamba               | <a href="mailto:bonsilejmakhamba@gmail.com">bonsilejmakhamba@gmail.com</a>   | Jan Smuts Boulevard, Kimberley, 8300                    | 072 263 3876             |
|  | Mrs Grace Gama               | <a href="mailto:gracegamacc@gmail.com">gracegamacc@gmail.com</a>             |   | 0736798412               |

**PROPOSED NURSING COLLEGE DEVELOPMENT IN KIMBERLEY  
PUBLIC PARTICIPATION REPORT**

**RESPONSES RECEIVED FROM I&APS**

| <b>Person</b>  | <b>Comment</b>   | <b>Response</b>   |
|----------------|--|---|
| Mrs Grace Gama | Good day i am interested or affected party : my Name : Grace Gama contact 0736798412 intrested or affected party in development of maintenance purposes undertaken in maintenance managment plan setback exist within 32 meter of a watercourse measured from the edge of Mental Health Nursing Accommodation Development. | Hi Grace. Noted thanks. I will register you on our system.<br><br>Sampie Van Rooyen |
|                |  |   |
|                |  |   |
|                |  |   |
|                |  |   |
|                |  |   |

## CONCLUSION

It is concluded that the methods used to inform surrounding landowners, users, organs of state, and identified government authorities about the proposed development were deemed adequate. Additionally, all identified I&APs (Interested and Affected Parties) were given the opportunity to provide inputs regarding the proposed development.

This suggests that the public participation process was carried out in a manner that ensured that all stakeholders who may be affected by the proposed development were informed and had an opportunity to provide their input. This is an important aspect of the decision-making process, as it ensures that the concerns and perspectives of all relevant parties are taken into account. However, it's important to note that the adequacy of the public participation process can be subjective and depend on various factors, such as the complexity and scale of the development, the level of engagement from the community, and the resources available for the process. Therefore, it's crucial to continue to monitor and evaluate the effectiveness of the public participation process throughout the development process to ensure that all stakeholders' concerns are being adequately addressed.