



the denc

Department:  
Environment & Nature Conservation  
NORTHERN CAPE PROVINCE  
REPUBLIC OF SOUTH AFRICA

Private Bag X6102, Kimberley, 8300, Metlife Towers, T-Floor, Tel: 053 807 7300, Fax: 053 807 7328

## APPLICATION FORM FOR ENVIRONMENTAL AUTHORISATION

	(For official use only)
File Reference Number:	
NEAS Reference Number:	
Date Received:	
Receipt Number:	

**Application for authorisation in terms of the National Environmental Management Act, 1998 (Act No. 107 of 1998), (the Act) and the Environmental Impact Assessment Regulations, 2014 (the Regulations)**

### PROJECT TITLE

Williet Boerdery Olie Rivier Farm Pivot Expansion EIA

#### Kindly note that:

1. This application form is current as of 07 April 2017 as amended. It is the responsibility of the applicant to ascertain whether subsequent versions of the form have been published or produced by the competent authority.
2. The application must be typed within the spaces provided in the form. The sizes of the spaces provided are not necessarily indicative of the amount of information to be provided. Spaces are provided in tabular format and will extend automatically when each space is filled with typing.
3. Where applicable **black out** the boxes that are not applicable in the form.
4. The application must be completed in terms of Regulation 16 of GN R.326
5. The use of the phrase "not applicable" in the form must be done with circumspection. Should it be done in respect of material information required by the competent authority for assessing the application, it may result in the rejection of the application as provided for in the Regulations.
6. This application must be handed in at the offices of the relevant competent authority as determined by the Act and Regulations.
7. No faxed or e-mailed applications will be accepted. Only original signed copies will be accepted.
8. Unless protected by law, all information filled in on this application form will become public information on receipt by the competent authority. Any interested and affected party should and shall be provided with the information contained in this application on request, during any stage of the application process.
9. Should a specialist report or report on a specialised process be submitted at any stage for any part of this application, the terms of reference for such report and declaration of interest of the specialist must also be submitted.

10. Proof of payment must accompany this application. The application will not be processed without proof of payment unless one of the exclusions provided for the Fee Regulations (Fees for consideration and processing of applications for environmental authorisations and amendments thereto Government Notice.141, published on 28 February 2014 is applicable and such information in section 1 of this application form has been confirmed by this Department.

**Queries must be addressed to the contact hereunder:**

**Departmental Details**

**Postal address:**

Department of Environment and Nature Conservation  
Attention: Directorate: Environmental Quality Management  
Private Bag X6102  
KIMBERLEY  
8300

**Physical address:**

Department of Environment and Nature Conservation  
90 Long Street, Sasko Building  
KIMBERLEY  
8300

Queries should be directed to the Sub - Directorate: Impact Management:

Tel: (053) 807-7430  
Fax: (053) 831-3530

View the Department's website at <http://denc.ncape.gov.za/> for the latest version of the documents.

## 1. PROOF OF PAYMENT

Applicants are required to tick the appropriate box below to indicate that either proof of payment is attached or that, in the applicant's view, an exclusion applies. Proof and a motivation for exclusions must be attached to this application form in **Appendix 1**.

Proof of payment attached as **Appendix 1** ☒

Exclusion applies ☐

An applicant is excluded from paying fees if:

The activity is a community based project funded by a government grant; or  
The applicant is an organ of state.

TYPE OF EXCLUSION	Tick where applicable. Proper motivation must be attached to the application
The activity is a community based project funded by a government grant	
The applicant is an organ of state	

FEE AMOUNT	Fee
Application for an environmental authorisation for which basic assessment is required in terms of the Environmental Impact Assessment Regulations	R2 000
Application for an environmental authorisation, for which S&EIR is required in terms of the Environmental Impact Assessment Regulations	R10 000

Department of Environment & Nature Conservation' details for the payment of application fees:

Payment Enquiries:	
Ms. T. Leburu	
Tel.: (053) 807 7464/2	
Email: <a href="mailto:tmakaudi@ncpg.gov.za">tmakaudi@ncpg.gov.za</a>	
Cc: <a href="mailto:gletimela@ncpg.gov.za">gletimela@ncpg.gov.za</a>	
<b><u>BANKING DETAILS:</u></b>	
ACCOUNT NAME	: NORTHERN CAPE PROVINCIAL PAYMASTER GENERAL ENVIRONMENT & NATURE CONSERVATION
BANK	: STANDARD BANK SOUTH AFRICA
ACCOUNT NUMBER	: 240013751
BRANCH CODE	: 050002
REFERENCE TO BE USED BY APPLICANT	: EIA/25/19

## 2. PROJECT DESCRIPTION

Please provide a **detailed** description of the project.

The project will involve the expansion of agricultural activities on the property remaining extent of farm Olie Rivier 170 (registration division: Kimberley) by introducing 3 new pivots that will require the clearance of approximately 70 ha of vegetation, primarily for the growing of potatoes. The 3 pivots will be 40 ha (pivot 1), 20 ha (pivot 2) and 10 ha (pivot 3) in size. In year 1, potato seeds will be planted on 20 ha of pivot 1 and in year 2 potato seeds will be planted on the other 20 ha of pivot 1. Thereafter potato seeds will be planted on pivot 2 and 3 in years 3 and 4, respectively. Crop rotation will be done after each harvest by planting either corn, wheat, lucerne or peanuts on the pivots.

Crop rotation is the growing of different crops in succession on a specific field. This practise, if implemented correctly, can among other positive impacts improve soil health and fertility, maintain soil structure and integrity, and help combat pests and weeds. Crop rotation is important, especially when planting potatoes, as potatoes are known heavy feeders, meaning they can easily deplete soils of nutrients. If rotations are not done, it could lead to a low harvest yield the following year or heavy reliance on fertilisers. Crop rotation will also help prevent disease such as blight, which is commonly caused by repeatedly planting potatoes on the same land. Blight is caused by a fungus-like organism which spreads in the foliage of potatoes, causing a collapse and decay of foliage and infection of the potatoes.

Water for the pivots will be sourced from an existing borehole and pumped through an existing underground PVC pipe (315 mm in diameter), which will be extended toward the 40 ha pivot. The existing pipe is approximately 1200 m in length and is used to water pecan nut trees. The pipe will be extended by a further 500 m to reach the 40 ha pivot. The pipe is not a listed activity under the NEMA, however it will only be extended if Environmental Authorisation for the proposed pivots is granted. Water to be used on the farm was already listed with the Oranje Vaal Water Users Association on 17 August 2020 for 19 140 m<sup>3</sup>/ha.

Does the project form part of any of the Strategic Infrastructure Projects (SIPs) as described in the National Development Plan, 2011?	YES	<del>NO</del>
--	-----	---------------

If YES, please indicate which SIPs are applicable in **Appendix 1**.

Please indicate which sector the project falls under by crossing out the relevant block in the table below:

**Table 1**

Green economy + "Green" and energy-saving industries	Greenfield transformation to urban or industrial form (including mining)	
Infrastructure – electricity (generation, transmission & distribution)	Biodiversity or sensitive area related activities	
Oil and gas	Mining value chain	
Biofuels	Potential of metal fabrication capital & transport equipment – arising from large public investments	

Nuclear		Boat building	
Basic services (local government) – electricity and electrification		Manufacturing – automotive products and components, and medium and heavy commercial vehicles	
Basic services (local government) – area lighting		Manufacturing – plastics, pharmaceuticals and chemicals	
Infrastructure – transport (ports, rail and road)		Manufacturing – clothing textiles, footwear and leather	
Basic services (local government access roads)		Forestry, paper, pulp and furniture	
Basic services (local government) – public transport		Business process servicing	
Infrastructure – water (bulk and reticulation)		Advanced materials	
Basic services (local government) – sanitation		Aerospace	
Basic services (local government) – waste management		Basic services (local government) - education	
Basic services (local government) water		Basic services (local government) - health	
Agricultural value chain + agro-processing (linked to food security and food pricing imperatives)	X	Basic services (local government) - housing	
Infrastructure – information and communication technology		Basic services (local government) security of tenure	
Tourism + strengthening linkages between cultural industries and tourism		Other	
Basic services (local government) – public open spaces and recreational facilities			

Provide details on the anticipated socio-economic values associated with the proposed project

**Table 1**

Anticipated CAPEX value of the project on completion	R 2 225 000.00
What is the expected annual income to be generated by or as a result of the project?	Cross income R10 800 000.00
New skilled employment opportunities created in the construction phase of the project	~5
New skilled employment opportunities created in the operational phase of the project	~5
New un-skilled employment opportunities created in the construction phase of the project	~20
New un-skilled employment opportunities created in the operational phase of the project	~110
What is the expected value of the employment opportunities during the operational and construction phase?	R1 751 000.00 (first year)
What percentage of this value that will accrue to previously disadvantaged individuals?	92 %

The expected current value of the employment opportunities during the first 10 years	R18 849 000.00
What percentage of this value that will accrue to previously disadvantaged individuals?	94%

**Table 2**

Does the listed activity/ies applied for form part of a larger project which is not a listed activity itself e.g. a road that is a listed activity that is needed to access a drilling site where the drilling does not constitute a listed activity.	YES	NO
If indicated yes above, please provide a brief description on how the activity/ies relate to the larger project that forms part there of:		

### 3. GENERAL INFORMATION

Project applicant:	Williet Boerdery (Pty) Ltd		
Registration no (if any):	K2016/416405/07		
Trading name (if any):			
Responsible position, e.g. Director, CEO, etc.:	Director: Christiaan Jacobus Mülke		
Contact person:	Christiaan Jacobus Mülke		
Physical address:	The Willows, Douglas, 8730		
Postal address:	P.O. Box 31, Douglas, 8730		
Postal code:	8730	Cell:	082 925 9430
Telephone:	082 925 9430	Fax:	-
E-mail:	tmulke@live.co.za		

Provincial Authority:	Northern Cape Department: Agriculture, Environmental Affairs, Rural Development and Land Reform		
Contact person:	A. Nyakaza		
Postal address:	Private Bag X6120, Kimberley, 8301		
Postal code:	8301	Cell:	073 254 7144
Telephone:	027 718 8814	Fax:	-
E-mail:	aviwenyakaza.denc@gmail.com		

Local municipality	Siyancuma Local Municipality		
Contact person:	Hasting Nel		
Postal address:	PO Box 27, Douglas, 8730		
Postal code:	8730	Cell:	-
Telephone:	053 298 1810	Fax:	053 298 3141
E-mail:	geraldine@siyancuma.gov.za		

In instances where there is more than one local authority involved, please attach a list of those local authorities with their contact details as **Appendix 2**.

Landowner:	Christiaan Jacobus Mülke		
Contact person:	Christiaan Jacobus Mülke		
Postal address:	P.O. Box 31, Douglas, 8730		
Postal code:	8730	Cell:	082 925 9430
Telephone:	082 925 9430	Fax:	
E-mail:	tmulke@live.co.za		

In instances where there is more than one landowner, please attach a list of those landowners with their contact details as **Appendix 3**. If the applicant is not the owner or person in control of the land, proof of notice to the landowner or person in control of the land on which the activity is to be undertaken must be submitted in **Appendix 3**.

Identified Competent Authority to consider the application:	Northern Cape Department: Agriculture, Environmental Affairs, Rural Development and Land Reform
Reason(s) in terms of Sec 24C of NEMA 1998 as amended	In terms of Section 24C of the NEMA, the Northern Cape Department: Agriculture, Environmental Affairs, Rural Development and Land Reform is the competent authority because the proposed project is not listed as one of the listing or specified activities in terms of section 24(2).

#### 4. ENVIRONMENTAL ASSESSMENT PRACTITIONER (EAP) INFORMATION

EAP:	Pieter Hendrik Holtzhausen		
Professional affiliation/registration:	SACNASP (Professional Natural Scientist) Registration Number: 121880		
Contact person (if different from EAP):			
Company:	Environmental Impact Management Services (Pty) Ltd		
Physical address:	8 Dalmeny Road, Pine Park, 2194		
Postal address:	P.O. Box 2083, Pinetown, 2123, ZA		
Postal code:	2123	Cell:	082 770 0734
Telephone:	011 789 7170	Fax:	086 571 9047
E-mail:	pieter@eims.co.za		

If an EAP has not been appointed please ensure that an independent EAP is appointed as stipulated by Regulation 12 of GN R.326, dated April 2017 as amended, prior to the commencement of the process.

The declaration of independence and the Curriculum Vitae (indicating the experience with environmental impact assessment and the relevant application processes) of the EAP must also be submitted to the Department.

#### 5. SITE DESCRIPTION

Provide a detailed description of the site involved in the application.

Province	Northern Cape
District Municipality	Pixley Ka Seme District Municipality
Local Municipality	Siyancuma Local Municipality
Ward number(s)	Ward 6

Nearest town(s)	Douglas	
Farm name(s) and number(s)	Farm Olie Rivier 170 (registration division: Kimberly)	
Portion number(s)	Remaining Extent	
Coordinates of corner points of study area (if there are more than 7 co-ordinates, please attach a list as <b>Appendix 4</b> )  For linear developments a list of turning points must be attached	Latitude (S) (DDMMSS)	Longitude (E) (DDMMSS)
	See Appendix 4	

SG 21 Digit Code(s)

(If there are more than 4, please attach a list with the rest of the codes as **Appendix 4**)

C	0	3	7	0	0	0	0	0	0	0	0	0	1	7	0	0	0	0	0	0
1	2	3	4	5																

Please attach a copy of the title deed(s) and SG diagram(s) to the application as **Appendix 5**.

Please attach a copies of environmental authorisations obtained on the same property as **Appendix 6**.

Are there any other applications for Environmental Authorisation on the same property?	YES	NO
If YES, please indicate the following:		
Competent Authority		
Reference Number		
Project Name		
Please provide details of the steps taken to ascertain this information:		

## 6. ACTIVITIES TO BE AUTHORISED

For an application for authorisation that involves more than one listed activity that, together, make up one development proposal, all the listed activities pertaining to this application must be indicated.

Detailed description of listed activities associated with the project	
GN R. 984, Listing Notice 2, Activity 15: The clearance of an area of 20 hectares or more of indigenous vegetation.	Clearance of 70 ha indigenous vegetation to construct pivots for cultivation of potatoes.

Please note that any authorisation that may result from this application will only cover activities specifically applied for. Co-ordinate points indicating the location of each listed activity must be provided with the relevant report (i.e. either BAR or EIR).



Please provide a project map indicating any sensitive areas (e.g. critical biodiversity area, World Heritage Site, etc.) overlaid by the study area in **Appendix 7**.

A project schedule, indicating the different phases and timelines of the project, must be attached as **Appendix 8**.

## **7. PUBLIC PARTICIPATION**

Provide details of the public participation process proposed for the application as required by Regulation 41(2) of GN R. 326, dated April 2017.

### **IDENTIFICATION OF INTERESTED AND AFFECTED PARTIES**

The I&AP databases compiled for various past environmental authorisation processes in the vicinity of the proposed project have been utilised towards compiling a pre-notification register of key I&APs to be notified of the Environmental Authorisation Application. The I&AP database includes amongst others: landowners, communities, regulatory authorities and other specialist interest groups. Additional I&APs have been registered during the initial notification and call to register period.

### **INITIAL NOTIFICATION OF I&APS**

The PPP commenced on the 19th of November 2020 with an initial notification and call to register for a period of 14 days, ending on the 3rd of December 2020. Initial call to register notifications were conducted as presented below.

Registered letters, emails and facsimiles (faxes) were prepared and distributed to the identified relevant authorities, affected and adjacent landowners and legal occupiers, ward councillors and other pre-identified key stakeholders. The notification documents included the following information:

- The purpose of the proposed project;
- Details of the NEMA Regulations that are anticipated to be applicable and must be adhered to;
- List of anticipated activities to be authorised;
- Location and extent of activities to be authorised;
- Details of the affected properties (including a locality map or an indication of where the locality map may be viewed or obtained);
- Brief but sufficient detail of the intended operation to enable I&APs to assess/ surmise what impact the project will have on them or on the use of their land (if any);
- Initial call to register duration; and
- Contact details of the EAP.

In addition, a registration form was included in the registered letters, emails and facsimiles distributed to I&APs and it included a request for the following information from I&APs:

- Provide information on how they consider that the proposed project will impact on them or their socio-economic conditions;
- Make proposals as to how the potential impacts on identified environmental features, their infrastructure, and socio-economic concerns may be managed, avoided or mitigated;
- Details of the landowner and information on lawful occupiers;
- Details of any communities existing within the area;
- Details of any Tribal Authorities within the area;
- Details of any other I&APs that need to be notified;
- Details on any land developments proposed; and

- Any specific comments or concerns regarding the proposed calcination plant application for environmental authorisation.

4 Site notices were placed along, within and surrounding the perimeter of the proposed project area and its surroundings on 19 November 2020. The on-site notices included the following information:

- Project name;
- Applicant name;
- Project location;
- Description of the environmental authorisation application process;
- Legislative requirements; and
- Relevant EAP contact person details for the project.

One advertisement (English and Afrikaans) was placed on the 19th of November 2020 in the Noordkaap Bulletin newspaper with circulation in the vicinity of the project area. The details of the advertisements are presented below:

- Project name;
- Applicant name;
- Project location;
- Description of the environmental authorisation application process;
- Legislative requirements; and
- Relevant EAP contact person details for the project.

As stated in sections above, I&APs were provided a period from the 19th of November 2020 to the 3rd of December 2020, to register for the proposed project. It is important to note however, that I&AP registration is on-going and will continue through the EIA process.

#### NOTIFICATIONS REGARDING THE SCOPING AND EIA REPORTS

Notification regarding the availability of the Scoping Report during scoping phase and the EIA and EMP during the EIA phase will be done in the following manner:

- Registered letters with details on where the Report is available from, as well as the duration of the public review comment period, will be distributed to all registered I&APs (which includes key stakeholders, affected and surrounding landowners, and registered occupiers);
- Facsimile notifications with information similar to that in the registered letter described above, will be distributed to all registered I&APs; and
- Email notifications with a letter attachment containing the information described above will also be distributed to all registered I&APs.

Should any of the aspect(s) of the Public Participation process be considered unfeasible or unreasonable for this application, please complete Section 9 below.

#### 8. OTHER AUTHORISATIONS REQUIRED

LEGISLATION	AUTHORISATION REQUIRED		APPLICATION SUBMITTED	
<b>SEMA's</b>				
National Environmental Management: Air Quality Act	YES	<del>NO</del>	YES	<del>NO</del>
National Environmental Management: Biodiversity Act	<del>YES</del>	NO	YES	<del>NO</del>
National Environmental Management: Integrated Coastal Management Act	YES	<del>NO</del>	YES	<del>NO</del>
National Environmental Management: Protected Areas Act	YES	<del>NO</del>	YES	<del>NO</del>

National Environmental Management: Waste Act	YES	<del>NO</del>	YES	<del>NO</del>
<b>National legislation</b>				
Mineral Petroleum Development Resources Act	YES	<del>NO</del>	YES	<del>NO</del>
National Water Act	YES	<del>NO</del>	YES	<del>NO</del>
National Heritage Resources Act	YES	<del>NO</del>	YES	<del>NO</del>
Others: Please specify	YES	<del>NO</del>	YES	<del>NO</del>

## 9. LIST OF APPENDICES

		SUBMITTED	
Appendix 1	Strategic Infrastructure Projects	YES	<del>N/A</del>
Appendix 2	List of Local Municipalities (with contact details)	YES	<del>N/A</del>
Appendix 3	List of land owners (with contact details) and proof of notification of land owners.	YES	<del>NO</del>
Appendix 4	List of co-ordinates and/or SGIDs	<del>YES</del>	N/A
Appendix 5	Title deed(s) and SG diagram(s)	<del>YES</del>	NO
Appendix 6	Copies of Environmental Authorisations obtained for the same property	YES	<del>N/A</del>
Appendix 7	Map indicating triggered areas for GN R.985	YES	<del>NO</del>
Appendix 8	Project schedule	<del>YES</del>	N/A
Appendix 9	Declaration of Applicant	<del>YES</del>	NO
Appendix 10	Declaration of EAP	<del>YES</del>	NO

## APPENDIX 1 STRATEGIC INFRASTRUCTURE PROJECTS

<p><b>SIP 1: Unlocking the northern mineral belt with Waterberg as the catalyst</b></p> <ul style="list-style-type: none"> <li>• Unlock mineral resources</li> <li>• Rail, water pipelines, energy generation and transmission infrastructure</li> <li>• Thousands of direct jobs across the areas unlocked</li> <li>• Urban development in Waterberg - first major post-apartheid new urban centre will be a “green” development project</li> <li>• Rail capacity to Mpumalanga and Richards Bay</li> <li>• Shift from road to rail in Mpumalanga</li> <li>• Logistics corridor to connect Mpumalanga and Gauteng.</li> </ul>
<p><b>SIP 2: Durban-Free State-Gauteng logistics and industrial corridor</b></p> <ul style="list-style-type: none"> <li>• Strengthen the logistics and transport corridor between SA’s main industrial hubs</li> <li>• Improve access to Durban’s export and import facilities</li> <li>• Integrate Free State Industrial Strategy activities into the corridor</li> <li>• New port in Durban</li> <li>• Aerotropolis around OR Tambo International Airport.</li> </ul>
<p><b>SIP 3: South-Eastern node &amp; corridor development</b></p> <ul style="list-style-type: none"> <li>• New dam at Mzimvubu with irrigation systems</li> <li>• N2-Wild Coast Highway which improves access into KwaZulu-Natal and national supply chains</li> <li>• Strengthen economic development in Port Elizabeth through a manganese rail capacity from Northern Cape</li> <li>• A manganese sinter (Northern Cape) and smelter (Eastern Cape)</li> <li>• Possible Mthombo refinery (Coega) and transshipment hub at Ngqura and port and rail upgrades to improve industrial capacity and performance of the automotive sector.</li> </ul>
<p><b>SIP 4: Unlocking the economic opportunities in North West Province</b></p> <ul style="list-style-type: none"> <li>• Acceleration of investments in road, rail, bulk water, water treatment and transmission infrastructure</li> <li>• Enabling reliable supply and basic service delivery</li> <li>• Facilitate development of mining, agricultural activities and tourism opportunities</li> <li>• Open up beneficiation opportunities in North West Province.</li> </ul>
<p><b>SIP 5: Saldanha-Northern Cape development corridor</b></p> <ul style="list-style-type: none"> <li>• Integrated rail and port expansion</li> <li>• Back-of-port industrial capacity (including an IDZ)</li> <li>• Strengthening maritime support capacity for oil and gas along African West Coast</li> <li>• Expansion of iron ore mining production and beneficiation.</li> </ul>
<p><b>SIP 6: Integrated municipal infrastructure project</b></p> <p>Develop national capacity to assist the 23 least resourced districts (19 million people) to address all the maintenance backlogs and upgrades required in water, electricity and sanitation bulk infrastructure. The road maintenance programme will enhance service delivery capacity thereby impacting positively on the population.</p>
<p><b>SIP 7: Integrated urban space and public transport programme</b></p> <p>Coordinate planning and implementation of public transport, human settlement, economic and social infrastructure and location decisions into sustainable urban settlements connected by densified transport corridors. This will focus on the 12 largest urban centres of the country, including all the metros in South Africa. Significant work is underway on urban transport integration.</p>
<p><b>SIP 8: Green energy in support of the South African economy</b></p>

<p>Support sustainable green energy initiatives on a national scale through a diverse range of clean energy options as envisaged in the Integrated Resource Plan (IRP2010) and support bio-fuel production facilities.</p> <p><b>Indicate capacity in MW:</b></p> <p><b>SIP 9: Electricity generation to support socioeconomic development</b> Accelerate the construction of new electricity generation capacity in accordance with the IRP2010 to meet the needs of the economy and address historical imbalances. Monitor implementation of major projects such as new power stations: Medupi, Kusile and Ingula.</p> <p><b>Indicate capacity in MW:</b></p> <p><b>SIP 10: Electricity transmission and distribution for all</b> Expand the transmission and distribution network to address historical imbalances, provide access to electricity for all and support economic development. Align the 10-year transmission plan, the services backlog, the national broadband roll-out and the freight rail line development to leverage off regulatory approvals, supply chain and project development capacity.</p> <p><b>SIP 11: Agri-logistics and rural infrastructure</b> Improve investment in agricultural and rural infrastructure that supports expansion of production and employment, small-scale farming and rural development, including facilities for storage (silos, fresh-produce facilities, packing houses); transport links to main networks (rural roads, branch train-line, ports), fencing of farms, irrigation schemes to poor areas, improved R&amp;D on rural issues (including expansion of agricultural colleges), processing facilities (abattoirs, dairy infrastructure), aquaculture incubation schemes and rural tourism infrastructure.</p> <p><b>SIP 12: Revitalisation of public hospitals and other health facilities</b> Build and refurbish hospitals, other public health facilities and revamp 122 nursing colleges. Extensive capital expenditure to prepare the public healthcare system to meet the requirements of the National Health Insurance (NHI) system. The SIP contains major builds for 6 hospitals</p> <p><b>SIP 13: National school build programme</b> A national school build programme driven by uniformity in planning, procurement, contract management and provision of basic services. Replace inappropriate school structures and address basic service backlog and provision of basic services under the Accelerated School Infrastructure Delivery Initiative (ASIDI). In addition, address national backlogs in classrooms, libraries, computer labs and admin buildings. Improving the learning environment will strengthen outcomes especially in rural schools, as well as reduce overcrowding</p> <p><b>SIP 14: Higher education infrastructure</b> Infrastructure development for higher education, focusing on lecture rooms, student accommodation, libraries and laboratories, as well as ICT connectivity. Development of university towns with a combination of facilities from residence, retail to recreation and transport. Potential to ensure shared infrastructure such as libraries by universities, FETs and other educational institutions. Two new universities will be built - in Northern Cape and Mpumalanga.</p> <p><b>SIP 15: Expanding access to communication technology</b> Provide for broadband coverage to all households by 2020 by establishing core Points of Presence (POPs) in district municipalities, extend new Infraco fibre networks across provinces linking districts, establish POPs and fibre connectivity at local level, and further penetrate the network into deep rural areas. While the private sector will invest in ICT infrastructure for urban and corporate networks, government will co-invest for township and rural access, as well as for e-government, school and health connectivity.</p>	
---	--

<p>The school roll-out focus is initially on the 125 Dinaledi (science and maths-focussed) schools and 1525 district schools. Part of digital access to all South Africans includes TV migration nationally from analogue to digital broadcasting.</p>	
<p><b>SIP 16: SKA &amp;Meerkat</b>          SKA is a global mega-science project, building an advanced radio-telescope facility linked to research infrastructure and high-speed ICT capacity and provides an opportunity for Africa and South Africa to contribute towards global advanced science projects.</p>	
<p><b>SIP 17: Regional integration for African cooperation and development</b>          Participate in mutually beneficial infrastructure projects to unlock long-term socio-economic benefits by partnering with fast growing African economies with projected growth ranging between 3% and 10%.          The projects involving transport, water and energy also provide competitively-priced, diversified, short and medium to long-term options for the South African economy where, for example, electricity transmission in Mozambique (Cesul) could assist in providing cheap, clean power in the short-term whilst Grand Inga in the DRC is long-term.          All these projects complement the Free Trade Area (FTA) discussions to create a market of 600 million people in South, Central and East Africa.</p>	
<p><b>SIP 18: Water and sanitation infrastructure</b>          A 10-year plan to address the estimated backlog of adequate water to supply 1.4m households and 2.1m households to basic sanitation.          The project will involve provision of sustainable supply of water to meet social needs and support economic growth. Projects will provide for new infrastructure, rehabilitation and upgrading of existing infrastructure, as well as improve management of water infrastructure.</p>	

**APPENDIX 2 (IF APPLICABLE)  
LIST OF LOCAL MUNICIPALITIES**

This appendix is not applicable.

**APPENDIX 3  
LIST OF LAND OWNERS  
PROOF OF NOTIFICATION OF LAND OWNERS**

The applicant is the landowner of the property on which the project is proposed.



**APPENDIX 4 (IF APPLICABLE)**  
**LIST OF CO-ORDINATES AND/OR SGIDS**

<b>Vertices</b>	<b>Latitude</b>	<b>Longitude</b>
1	28°55'57.806"S	24°0'15.26"E
2	28°55'53.807"S	24°0'11.52"E
3	28°55'52.309"S	24°0'4.565"E
4	28°55'49.346"S	23°59'50.809"E
5	28°55'56.59"S	23°59'55.507"E
6	28°56'4.538"S	23°59'53.981"E
7	28°56'9.91"S	23°59'47.522"E
8	28°56'10.936"S	23°59'40.477"E
9	28°56'7.238"S	23°59'32.302"E
10	28°56'25.206"S	23°59'42.018"E
11	28°56'39.599"S	23°59'39.368"E
12	28°56'45.312"S	23°59'35.394"E
13	28°56'54.521"S	23°59'27.323"E
14	28°56'54.668"S	23°59'27.294"E
15	28°57'4.964"S	23°59'25.951"E
16	28°57'6.487"S	23°59'25.757"E
17	28°57'9.043"S	23°59'25.433"E
18	28°57'9.043"S	23°59'25.436"E
19	28°57'13.73"S	23°59'24.842"E
20	28°57'19.814"S	23°59'23.302"E
21	28°57'24.239"S	23°59'42.09"E
22	28°58'40.037"S	24°0'8.136"E
23	28°58'31.699"S	24°0'48.467"E
24	28°58'12"S	24°2'27.179"E
25	28°56'41.543"S	24°0'56.11"E

## APPENDIX 5 TITLE DEED(S) AND SG DIAGRAM(S)

Printed: 2020/11/04 13:47

### Deeds Office Property

C03700000000017000000



A LexisNexis® Product

GENERAL INFORMATION	
Date Requested	2020/11/04 13:47
Deeds Office	
Information Source	DEEDS OFFICE
Reference	1398
** This result is enriched with information from the WinDeed Database.	

PROPERTY INFORMATION	
Property Type	FARM
Farm Name	OLIE RIVIER
Farm Number	170
Portion Number	0 (REMAINING EXTENT)
Local Authority	NOT AVAILABLE
Registration Division	KIMBERLEY RD
Province	NORTHERN CAPE
Diagram Deed	GWQ26/3
Extent**	1212.0464 H
Previous Description	-
LPI Code	C03700000000017000000

OWNER INFORMATION	
<b>Owner 1 of 1</b>	
Type**	TRUST
Name	TIAAN TRUST
ID / Reg. Number	IT251/1996
Title Deed	T2568/2000
Registration Date	2000/08/10
Purchase Price (R)	ESTATE
Purchase Date	-
Share	-
Microfilm	-
Multiple Properties**	NO
Multiple Owners**	NO

ENDORSEMENTS (2)				
#	Document	Institution	Amount (R)	Microfilm
1	K223/1929S	-	-	-
2	K45/1981S	EX45/1981	-	-

HISTORIC DOCUMENTS (2)				
#	Document	Owner	Amount (R)	Microfilm
1	T1842/1964	MULKE CHRISTIAAN JACOBUS	-	-
2	T1659/1998	MULKE MARIA JOHANNA	ESTATE	-

\*\* This result is enriched with information from the WinDeed Database.

DISCLAIMER	
This report contains information gathered from our suppliers and we do not make any representations about the accuracy of the data displayed nor do we accept responsibility for inaccurate data. WinDeed will not be liable for any damage caused by reliance on this report. This report is subject to the terms and conditions of the <a href="#">WinDeed End User Licence Agreement (EULA)</a> .	

**Figure 1: Title Deed**

The numerical data of this diagram are sufficiently consistent. **F** Dg. B. 2084/1880.  
(Sgd) Alex C. Baile.  
Examiner.

Sides			Angles.			
ab	779	69	a	72	31	40
bc	1486	85	b	144	31	50
cd	725	10	c	62	0	30
de	879	50	d	180	25	30
ef	398	45	e	88	37	30
fa	1285	47	f	171	53	0

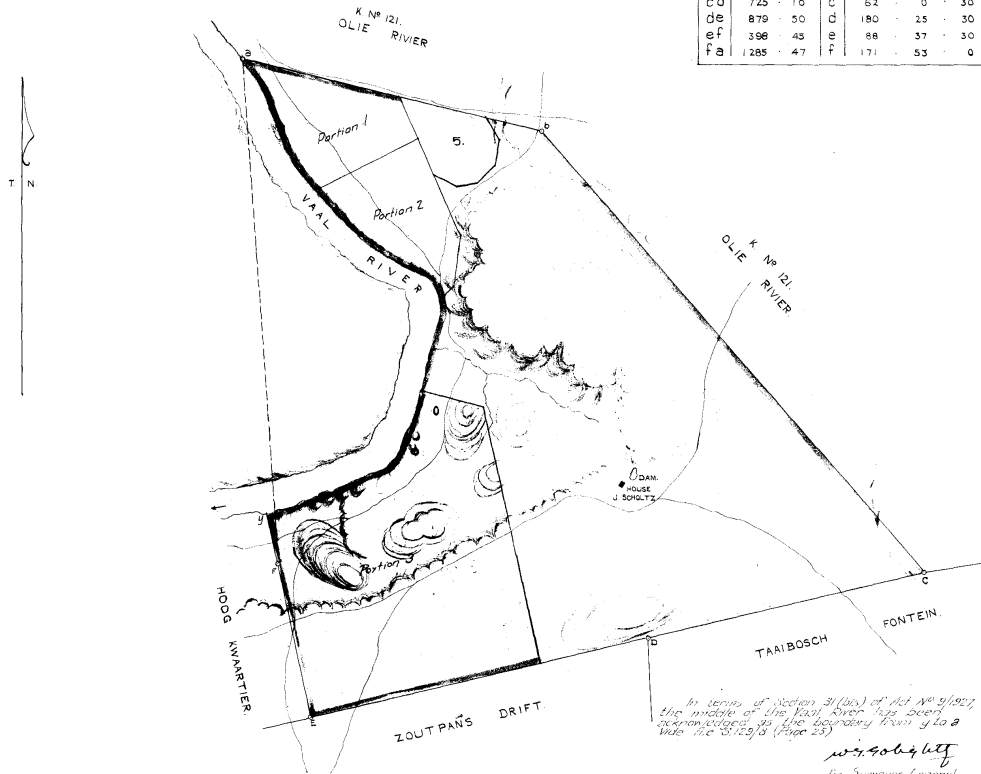

THE FARM OLIE RIVER No. 170  
KIMBERLEY

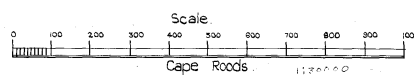

The above Diagram K. N° 122 represents 2352 Morgen of Land being the farm OLIE RIVER, situated in the Division of Kimberley, Griqualand West.

Bounded as shown above.

Surveyed and planned for Government by me  
(Sgd) H<sup>g</sup> Van Renen.  
Government Surveyor.  
1879.

Land Grant  
18<sup>th</sup> February, 1880  
Jacobus J. L. Scholtz.  
Gri. W. L. G. 28-3  
11. AUG. 1887  
No 1161-1887  
M. G. Hendrick

GM-8 (5670)  
GN-7 (5714)

B. 2084/1880  
S.M.

Figure 2: SG Diagram- Part A

*Handwritten: 100.0084/10.0*

	Source Married	Diag. No.	Sub-division	Married, 1st Part	Married, 2nd Part
170/1	E 2666/49	9244/49	Portion 1	124.8819	33/1951. 10.5/1951
170/2	"	9245/49	" 2	124.8824	74/54. 10.5/1951
170/3	E 1123/1953	4654/1953	Portion 3	629.0000	77/54. 10.5/1951
	404/2012	795/2012	Portion 5	49.8271 ha	T1120/2013 2.6N

Figure 3: SG Diagram- Part B

**APPENDIX 6 (IF APPLICABLE)**  
**COPIES OF ENVIRONMENTAL AUTHORISATIONS OBTAINED ON THE SAME PROPERTY**

No other environmental authorisations exist on the property of the proposed project.

**APPENDIX 7 (IF APPLICABLE)  
PROJECT MAP**

GN. R. 985, Listing Notice 3, was not triggered, therefore this appendix is not applicable.

## **APPENDIX 8 PROJECT SCHEDULE**

The project will involve the expansion of agricultural activities on the property remaining extent of farm Olie Rivier 170 (registration division: Kimberley) by introducing 3 new pivots that will require the clearance of approximately 70 ha of vegetation, primarily for the growing of potatoes. The 3 pivots will be 40 ha (pivot 1), 20 ha (pivot 2) and 10 ha (pivot 3) in size. Construction of the proposed pivots will commence directly after Environmental Authorisation is granted, this will entail the clearance of vegetation, soil preparation and setup of the centre pivot system. Production will commence 6 months after EA is granted. In year 1, potato seeds will be planted on 20 ha of pivot 1 and in year 2 potato seeds will be planted on the other 20 ha of pivot 1. Thereafter potato seeds will be planted on pivot 2 and 3 in years 3 and 4, respectively. Crop rotation will be done after each harvest by planting either corn, wheat, lucerne or peanuts on the pivots.

## APPENDIX 9

### DECLARATION OF THE APPLICANT

I, Christiaan Jacobus Mülke, declare that I -

- am, or represent<sup>1</sup>, the applicant in this application;
- have appointed / will appoint (delete that which is not applicable) an environmental assessment practitioner to act as the independent environmental assessment practitioner for this application / will obtain exemption from the requirement to obtain an environmental assessment practitioner<sup>2</sup>;
- will provide the environmental assessment practitioner and the competent authority with access to all information at my disposal that is relevant to the application;
- will be responsible for the costs incurred in complying with the Regulations, including but not limited to –
  - costs incurred in connection with the appointment of the environmental assessment practitioner or any person contracted by the environmental assessment practitioner;
  - costs incurred in respect of the undertaking of any process required in terms of the Regulations;
  - costs in respect of any fee prescribed by the Minister or MEC in respect of the Regulations;
  - costs in respect of specialist reviews, if the competent authority decides to recover costs; and
  - the provision of security to ensure compliance with conditions attached to an environmental authorisation, should it be required by the competent authority;
- will ensure that the environmental assessment practitioner is competent to comply with the requirements of the Regulations and will take reasonable steps to verify that the EAP
  - know the Act and the regulations, and how they apply to the proposed development
  - know any applicable guidelines
  - perform the work objectively, even if the findings do not favour the applicant
  - disclose all information which is important to the application and the proposed development
  - have expertise in conducting environmental impact assessments
  - complies with the Regulations
- will inform all registered interested and affected parties of any suspension of the application as well as of any decisions taken by the competent authority in this regard;
- am responsible for complying with the conditions of any environmental authorisation issued by the competent authority;
- hereby indemnify the Government of the Republic, the competent authority and all its officers, agents and employees, from any liability arising out of the content of any report, any procedure or any action which the applicant or environmental assessment practitioner is responsible for in terms of these Regulations;
- will not hold the competent authority responsible for any costs that may be incurred by the applicant in proceeding with an activity prior to obtaining an environmental authorisation or prior to an appeal being decided in terms of these Regulations;
- will perform all other obligations as expected from an applicant in terms of the Regulations;
- all the particulars furnished by me in this form are true and correct; and
- I realise that a false declaration is an offence in terms of regulation 71 and is punishable in terms of section 24F of the Act.

---

<sup>1</sup>If this is signed on behalf of the applicant, proof of such authority from the applicant must be attached.

<sup>2</sup>If exemption is obtained from appointing an EAP, the responsibilities of an EAP will automatically apply to the person conducting the environmental impact assessment in terms of the Regulations.



---

Signature<sup>3</sup> of the applicant<sup>4</sup>/ Signature on behalf of the applicant:

---

Name of company (if applicable):

---

Date:

---

Signature of the Commissioner of Oaths:

---

Date:

---

Designation:

Official stamp (below):

---

<sup>3</sup>Only original signatures will be accepted. No scanned, copied or faxed signatures will be accepted.

<sup>4</sup>If the applicant is a juristic person, a signature on behalf of the applicant is required as well as proof of such authority. An EAP may not sign on behalf of an applicant.

## APPENDIX 10

### DECLARATION OF THE EAP

I, Pieter Hendrik Holtzhausen, declare that –

General declaration:

- I act as the independent environmental practitioner in this application
- I will perform the work relating to the application in an objective manner, even if this results in views and findings that are not favourable to the applicant
- I declare that there are no circumstances that may compromise my objectivity in performing such work;
- I have expertise in conducting environmental impact assessments, including knowledge of the Act, Regulations and any guidelines that have relevance to the proposed activity;
- I will comply with the Act, Regulations and all other applicable legislation;
- I will take into account, to the extent possible, the matters listed in regulation 8 of the Regulations when preparing the application and any report relating to the application;
- I have no, and will not engage in, conflicting interests in the undertaking of the activity;
- I undertake to disclose to the applicant and the competent authority all material information in my possession that reasonably has or may have the potential of influencing - any decision to be taken with respect to the application by the competent authority; and - the objectivity of any report, plan or document to be prepared by myself for submission to the competent authority;
- I will ensure that information containing all relevant facts in respect of the application is distributed or made available to interested and affected parties and the public and that participation by interested and affected parties is facilitated in such a manner that all interested and affected parties will be provided with a reasonable opportunity to participate and to provide comments on documents that are produced to support the application;
- I will ensure that the comments of all interested and affected parties are considered and recorded in reports that are submitted to the competent authority in respect of the application, provided that comments that are made by interested and affected parties in respect of a final report that will be submitted to the competent authority may be attached to the report without further amendment to the report;
- I will keep a register of all interested and affected parties that participated in a public participation process; and
- I will provide the competent authority with access to all information at my disposal regarding the application, whether such information is favourable to the applicant or not
- all the particulars furnished by me in this form are true and correct;
- will perform all other obligations as expected from an environmental assessment practitioner in terms of the Regulations; and
- I realise that a false declaration is an offence in terms of regulation 71 of the Regulations and is punishable in terms of section 24F of the Act.

**Disclosure of Vested Interest (delete whichever is not applicable)**

- I do not have and will not have any vested interest (either business, financial, personal or other) in the proposed activity proceeding other than remuneration for work performed in terms of the Regulations;

---

Signature of the environmental assessment practitioner:

---

Environmental Impact Management Services (PTY) Ltd

Name of company:

---

12 February 2021

Date:

---

Signature of the Commissioner of Oaths:

---

Date:

---

Designation:

Official stamp (below)

