

Appendix E4: Proof of Notification of Proposed Activity to Organs of State

Adriaan Louis Botha

From: Chiara D'Egidio Kotze
Sent: 17 November 2016 03:31 PM
Subject: Notification: New Kathu Cemetery
Attachments: 2016-11-17 BA Notification letter english_Authorities Final.pdf

NOTICE OF THE BASIC ASSESSMENT PROCESS FOR NEW KATHU CEMETARY

Dear Authority,

The Gamagara Local Municipality is proposing to develop additional space for graves near the town of Kathu.

Please find the background information document for further information on the application and the proposed project.

Chiara D'Egidio Kotze

Environmental Assessment Practitioner
Synergistics - part of the SLR group

Email: ckotze@slrconsulting.com
Mobile: +27 73 277 7228
Tel: +27 11 467 0945
Ext: 2005
Fax: +27 11 467 0978

SLR Consulting (Fourways office)
Block 7 Fourways Manor Office Park
Cnr Roos and Macbeth Streets
Fourways, Johannesburg, 2060
South Africa



Industry



Infrastructure



Mining & Minerals



Oil & Gas



Planning & Development



Renewable & Low Carbon

Confidentiality Notice and Disclaimer

This communication and any attachment(s) contains information which is confidential and may also be legally privileged. It is intended for the exclusive use of the recipient(s) to whom it is addressed. If you are not the intended recipient, any disclosure, copying, distribution or any action taken or omitted to be taken in reliance on it, is prohibited and may be unlawful. If you have received this communication in error please email us by return mail and then delete the email from your system together with any copies of it. Please note that you are not permitted to print, copy, disclose or use part or all of the content in any way.

Emails and any information transmitted thereunder may be intercepted, corrupted or delayed. As a result, SLR does not accept any responsibility for any errors or omissions howsoever caused and SLR accepts no responsibility for changes made to this email or any attachment after transmission from SLR. Whilst all reasonable endeavours are taken by SLR to screen all emails for known viruses, SLR cannot guarantee that any transmission will be virus free.

Any views or opinions are solely those of the author and do not necessarily represent those of SLR Management Ltd, or any of its subsidiaries, unless specifically stated.

SLR Consulting (South Africa) (Proprietary) Limited and SLR Consulting (Africa) (Proprietary) Limited are both subsidiaries of SLR Management Ltd. Registered Office: Unit 7 Fourways Manor Office Park, Cnr Roos and Macbeth Street, Fourways, 2191, Gauteng, South Africa

From: Chiara D'Egidio Kotze

Sent: Thu 2016/11/17 03:31 PM

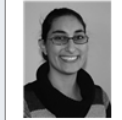

To:

Cc:

Bcc: tmthombeni@ncpg.gov.za; mokonopin@gmail.com; JacolineMa@daff.gov.za; fortunec@ncpg.gov.za; khannie@ncpg.gov.za; raisibe.sekepane@dmr.gov.za; makungoe@dws.gov.za; vdmerwe@nra.co.za; abrahamsn@nra.co.za; refliwe@gamagara.co.za; pierreb@gamagara.co.za; eilerdm@taologatsewe.gov.za

Subject: Notification: New Kathu Cemetery

Message 2016-11-17 BA Notification letter english_Authorities Final.pdf (3 MB)

NOTICE OF THE BASIC ASSESSMENT PROCESS FOR NEW KATHU CEMETARY

Dear Authority,

The Gamagara Local Municipality is proposing to develop additional space for graves near the town of Kathu.

Please find the background information document for further information on the application and the proposed project.

Chiara D'Egidio Kotze

Environmental Assessment Practitioner
Synergistics - part of the SLR group

Email: ckotze@slrconsulting.com

Mobile: +27 73 277 7228

Tel: +27 11 467 0945

Ext: 2005

Fax: +27 11 467 0978

SLR Consulting (Fourways office)
Block 7 Fourways Manor Office Park
Cnr Roos and Macbeth Streets
Fourways, Johannesburg, 2060
South Africa



See more about Chiara D'Egidio Kotze



PostNet Name:

Tel No.:

CIT Acc. No.:

POSTNET FOUR TRACK MAIL

21 455 827277 ACC010 1882

From: (Sender)

(Company Name)

Street Address

Suburb

City/Town

Contact

E-mail

Code

Insurance

Yes No If yes, state value

Domestic

OVERNIGHT COURIER 1100

NEXT DAY (24 - 48 HRS)

ECONOMY (48 HRS-72HRS)

WEDNESDAY COURIER

DAWN COURIER 0900

OTHER SPECIFY

SATURDAY AFTER HOURS

PUBLIC HOLIDAY/ AFTER HOURS

No. of Parcels

Description

Length in cm

Breadth in cm

Height in cm

Mass in kg

1 Envelope

40

30

1

250g

Total No. of Parcels

250

Total Vol

250

Total Mass

250g

POSTNET Courier

ACCEPTED BY POSTNET

Name

Signature

Date

Time

17/11/16 16:06

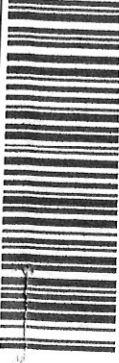

PN9182083

To: (Receiver)

(Company Name)

Street Address

Suburb

City/Town

Contact

E-mail

Code

Code

International

DOCUMENTS

NON-DOCUMENTS

WE HAVE SEEN AND AGREE TO THE STANDARD CONDITIONS OF CARRIAGE (OVERLEAF) WHICH SHALL APPLY TO THIS CONSIGNMENT AND TO ALL FUTURE CONSIGNMENTS ACCEPTED BY POSTNET. WE FURTHER DECLARE THAT THIS CONSIGNMENT DOES NOT CONTAIN DANGEROUS GOODS

EXPRESS PACK SECURITY

NUMBER ON LIP OF FLYER

SENDER

Name: C. Kote

Date: 17/11/2016

Signature: C. Kote

Time: 16:05

PROOF OF DELIVERY

Name: LUZANE

Date: 18-11-2016

Signature: [Signature]

Time: 15:57

ID No.:

www.postnet.co.za

To track your shipment go to: www.postnet.co.za



Project Reference: 755.23023.00008

File Ref. 2016-11-17 BA Notification letter english_Authorities Final

Date: 17 November 2016

ATTENTION: COMMENTING AUTHORITY

Dear Sir/Madam

NOTICE OF THE BASIC ASSESSMENT PROCESS FOR NEW KATHU CEMETARY

This letter serves to notify you of the proposed new Kathu Cemetery Project.

Introduction and Project Description

The Gamagara Local Municipality (Gamagara Municipality) proposes to develop additional space for graves in the town of Kathu. The existing Kathu Cemetery is located approximately 3.5 km north-east of central Kathu on the remaining extent of the farm Uitkoms 463 (immediately East of the N14 road), and falls within the Gamagara Municipality and John Taolo Gaetsewe District Municipality, in the Northern Cape.

The cemetery is nearing capacity and thus additional space is necessary due to the rapid expansion of the town of Kathu which is partly due to the resettlement of the Dingleton residents as a result of the expansion of the Sishen Iron Ore Mine. Due to the existing Kathu Cemetery being located in the protected Kathu Forest, extending the cemetery on the farm Uitkomst 463 is not possible. An alternative location has been proposed and is the only feasible alternative for the new cemetery. The best viable alternative is to establish a new cemetery on the remaining extent of the farm Lylyveld 545, approximately 13 km south of central Kathu (see appendix 1 for a locality map). The new Kathu Cemetery will be approximately 5 hectares (ha) in extent on land owned by the SIOC. The land for the new cemetery will be transferred to the Gamagara Municipality through a land swap agreement as part of the Dingleton Resettlement project.

Construction of the new Kathu Cemetery will include site clearance, establishing access to the cemetery, internal roads, fencing, ablution facilities linked to a possible septic tank system, a parking area for approximately 100 cars, night time security lighting, a borehole for water supply (to be taken from the existing Lylyveld mine pipeline that crosses the farm) and waste collection bins.

Basic Assessment Process

In terms of the National Environmental Management Act (NEMA; No. 107 of 1998) as amended, and the EIA Regulations (GNR 982-985, published on 4 December 2014), the proposed cemetery requires a Basic Assessment Process to be conducted. Notification is hereby given that the Gamagara Municipality is submitting an application for a New Kathu Cemetery to the Department of the Environment and Nature Conservation (DENC), who is the competent authority. The activities in terms of NEMA, identified at this stage, being applied for include:

Legislation	Listed Activity	Description	Competent Authority
NEMA	Listing Notice 1 GN R983 Activity 23	Development of a new cemetery.	DENC
	Listing Notice 1 GN R983 Activity 24	Possible construction and/or widening of roads	
	Listing Notice 1 GN R983 Activity 27	Clearance of indigenous vegetation	
	Listing Notice 1 GN R983 Activity 28	Institutional development on agricultural land	
	Listing Notice 1 GN R983 Activity 56	Possible construction and/or widening of roads	

Synergistics Environmental Services (Pty) Ltd (a SLR Group Company) has been appointed as the independent environmental practitioner responsible for undertaking the necessary environmental work and conducting the public participation process for the project

Please submit your initial comments by 09 December 2016. Should you know of anyone else who should be included on our database please send us their contact details.

Contact Details:

Chiara D'Egidio Kotze

ckotze@slrconsulting.com

Tel: (011) 467-0945

Fax: (011) 467-0978

Yours faithfully



Chiara D'Egidio Kotze

APPENDIX 1: LOCALITY MAP

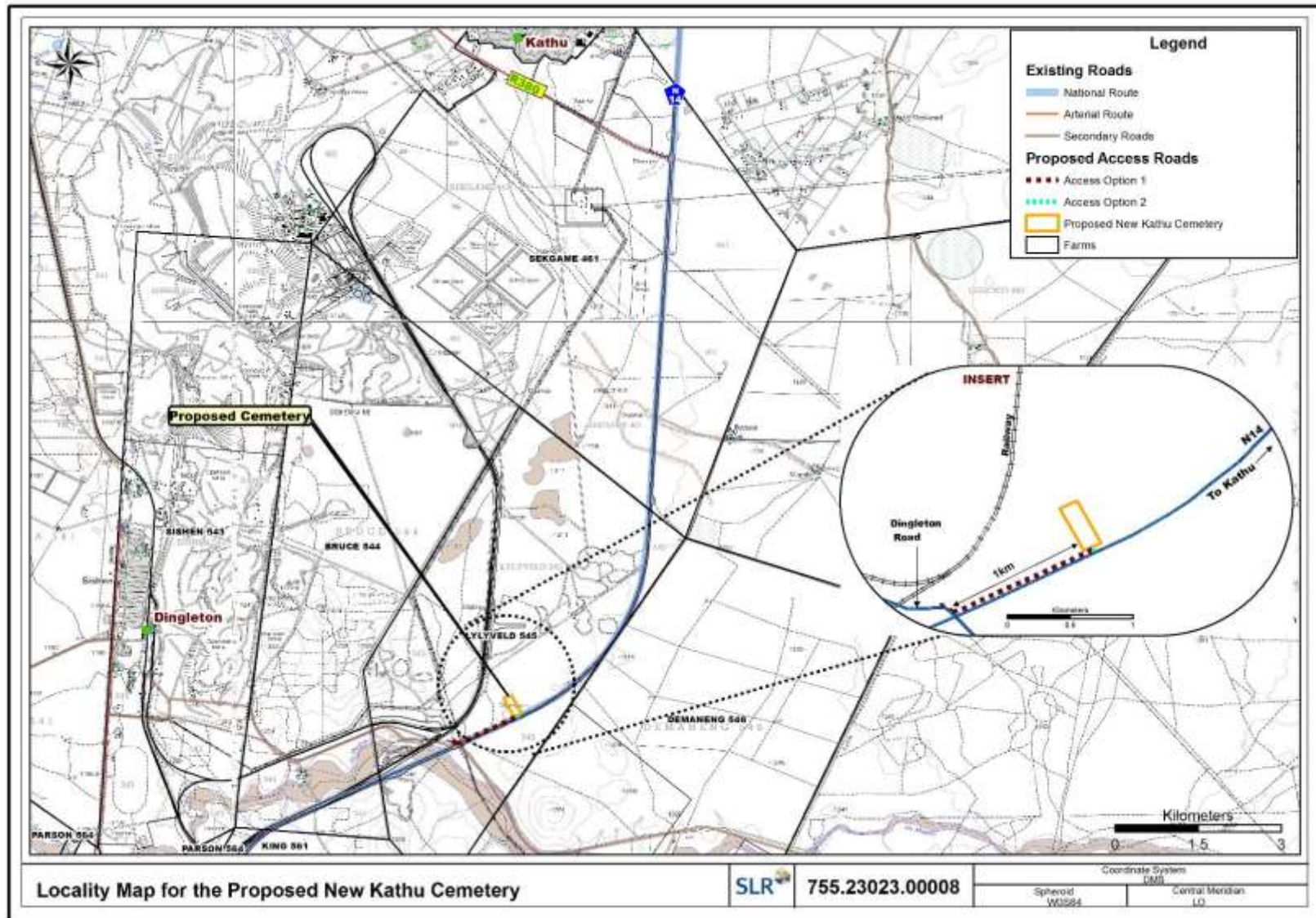

**GAMAGARA LOCAL MUNICIPALITY
BACKGROUND INFORMATION DOCUMENT FOR THE NEW KATHU CEMETERY**

REGISTRATION AND RESPONSE FORM FOR INTERESTED AND AFFECTED PARTIES

DATE		TIME	
PARTICULARS OF THE INTERESTED AND AFFECTED PARTY			
NAME			
POSTAL ADDRESS			
		POSTAL CODE	
STREET ADDRESS			
		POSTAL CODE	
WORK/ DAY TELEPHONE NUMBER		WORK/ DAY FAX NUMBER	
CELL PHONE NUMBER		E-MAIL ADDRESS	

PLEASE IDENTIFY YOUR INTEREST IN THE PROPOSED PROJECT

PLEASE WRITE YOUR COMMENTS AND QUESTIONS HERE (USE ADDITIONAL PAGES AS REQUIRED)

Please return completed forms to: Chiara D'Egidio Kotze
 Synergistics Environmental Services (Pty) Ltd
 (011) 467 0945 (Tel) and/or (011) 467 0978 (Fax)
ckotze@slrconsulting.com
 Please provide initial comments and queries by 09 December 2016
 Comments and queries can be provided throughout the process

GAMAGARA LOCAL MUNICIPALITY

NEW KATHU CEMETERY

Application for Environmental Authorisation in terms of the National Environmental Management Act (No.107 of 1998)

This is to certify that I

.....

in my capacity as a representative of

Department of Environment and Nature Conservation

have received the following documents:

Please tick box:

1 hard copy of the application for Environmental Authorisation in terms of the National Environmental Management Act (No.107 of 1998)	
---------------------------------------------------------------------------------------------------------------------------------------	--

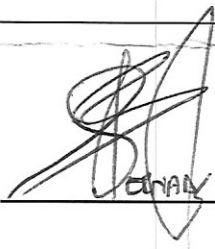
Signature:  _____

Date: 18-11-2016

Chiara D'Egidio Kotze

From: Nadia Goltz <ngoltz@ncpg.gov.za>
Sent: 15 December 2016 11:30 AM
To: e.louw3@gmail.com; jj089@lantic.net
Cc: Chiara D'Egidio Kotze <ckotze@slrconsulting.com>
Subject: Fwd: Notification: New Kathu Cemetery
Attachments: 2016-11-17 BA Notification letter english_Authorities Final.pdf

Dear Eben and Koos.
This notification was send on 23 November 2016.
For your attention.
Regards

Nadia Goltz

Department of Agriculture, Land Reform and Rural Development, Northern Cape Province

Directorate: Sustainable Resource Management
162 George Street
Private Bag X5018, Kimberley, 8300
Tel: (053) 838 9160,
Fax : 086 771 8754

"A transformed, vibrant agricultural sector for food security and sustainable rural development"

>>> NGoltz 2016/11/23 07:44 PM >>>

Nadia Goltz

Department of Agriculture, Land Reform and Rural Development, Northern Cape Province

Directorate: Sustainable Resource Management
162 George Street
Private Bag X5018, Kimberley, 8300
Tel: (053) 838 9160,
Fax : 086 771 8754

"A transformed, vibrant agricultural sector for food security and sustainable rural development"

>>> Chiara D'Egidio Kotze <ckotze@slrconsulting.com> 2016/11/17 01:30 AM >>>

NOTICE OF THE BASIC ASSESSMENT PROCESS FOR NEW KATHU CEMETARY

Dear Authority,

The Gamagara Local Municipality is proposing to develop additional space for graves near the town of Kathu.

Please find the background information document for further information on the application and the proposed project.

Chiara D'Egidio Kotze
Environmental Assessment Practitioner
Synergistics - part of the SLR group

Email: ckotze@slrconsulting.com<<mailto:ckotze@slrconsulting.com>>

Mobile: +27 73 277 7228

Tel: +27 11 467 0945

Ext: 2005

Fax: +27 11 467 0978

SLR Consulting (Fourways office)
Block 7 Fourways Manor Office Park
Cnr Roos and Macbeth Streets
Fourways, Johannesburg, 2060

South Africa

<<http://www.slrconsulting.com>>

[[cid:image004f32.PNG@b34c08f0.40882158](#)]

Confidentiality Notice and Disclaimer

This communication and any attachment(s) contains information which is confidential and may also be legally privileged. It is intended for the exclusive use of the recipient(s) to whom it is addressed. If you are not the intended recipient, any disclosure, copying, distribution or any action taken or omitted to be taken in reliance on it, is prohibited and may be unlawful. If you have received this communication in error please email us by return mail and then delete the email from your system together with any copies of it. Please note that you are not permitted to print, copy, disclose or use part or all of the content in any way.

Emails and any information transmitted thereunder may be intercepted, corrupted or delayed. As a result, SLR does not accept any responsibility for any errors or omissions howsoever caused and SLR accepts no responsibility for changes made to this email or any attachment after transmission from SLR. Whilst all reasonable endeavours are taken by SLR to screen all emails for known viruses, SLR cannot guarantee that any transmission will be virus free.

Any views or opinions are solely those of the author and do not necessarily represent those of SLR Management Ltd, or any of its subsidiaries, unless specifically stated.

SLR Consulting (South Africa) (Proprietary) Limited and SLR Consulting (Africa) (Proprietary) Limited are both subsidiaries of SLR Management Ltd.
Registered Office: Unit 7 Fourways Manor Office Park, Cnr Roos and Macbeth Street, Fourways, 2191, Gauteng, South Africa

This email and any files transmitted with it are confidential and intended solely for the use of the individual or entity to whom they are addressed. If you have received this email in error please notify the system manager. Please note

that any views or opinions presented in this email are solely those of the author and do not necessarily represent those of the company. Finally, the recipient should check this email and any attachments for the presence of viruses. The company accepts no liability for any damage caused by any virus transmitted by this email.



Track DHL Express Shipments

Here's the fastest way to check the status of your shipment. No need to call Customer Service – our online results give you real-time, detailed progress as your shipment speeds through the DHL network.

Result Summary

Waybill: 3035806815

Signed for by: T MTHOMBENI
Get Signature Proof of Delivery

Friday, February 17, 2017 at 10:05

1 Piece

Origin Service Area:

JOHANNESBURG - FOURWAYS - SOUTH AFRICA

Destination Service Area:

JOHANNESBURG OUTLYING - KIMBERLEY -
SOUTH AFRICA

Friday, February 17, 2017		Location	Time	Piece
8	Delivered - Signed for by : T MTHOMBENI	KIMBERLEY	10:05	1 Piece
7	With delivery courier	JOHANNESBURG OUTLYING - SOUTH AFRICA	08:48	1 Piece
6	Arrived at Delivery Facility in JOHANNESBURG OUTLYING - SOUTH AFRICA	JOHANNESBURG OUTLYING - SOUTH AFRICA	08:03	1 Piece
5	Departed Facility in JOHANNESBURG - SOUTH AFRICA	JOHANNESBURG - SOUTH AFRICA	02:40	1 Piece
4	Processed at JOHANNESBURG - SOUTH AFRICA	JOHANNESBURG - SOUTH AFRICA	02:40	1 Piece
Thursday, February 16, 2017		Location	Time	Piece
3	Arrived at Sort Facility JOHANNESBURG - SOUTH AFRICA	JOHANNESBURG - SOUTH AFRICA	20:46	1 Piece
2	The requested service has changed; for assistance please contact DHL	JOHANNESBURG - SOUTH AFRICA	20:05	
1	Shipment picked up	JOHANNESBURG - SOUTH AFRICA	16:05	

If you would prefer to speak to someone personally about the location of your shipment, please contact DHL Express Customer Service.

[Terms & Conditions](#)

[Tracking FAQs](#)

Deutsche Post DHL Group

This message was sent with High importance.

From: Chiara D'Egidio Kotze

Sent: Wed 2017/02/22 01:22 PM

To:

Cc:

Bcc: abrahamsn@nra.co.za; agrobler@landscapedynamics.co.za; Annelize.Harmse@transnet.net; assegaie@yahoo.com; Dekodr@nra.co.za; dirk.coetzee@assmang.co.za; dkthomelang@gmail.com; e.louw3@gmail.com; eilerdm@taologaetsewe.gov.za; elkn@mweb.co.za; elizna.badenhorst@assmang.co.za; fortunec@ncpg.gov.za; Gilbert.Nortier@transnet.net; JacolineMa@daff.gov.za; jj089@lantic.net; khannie@ncpg.gov.za; letoditumelo007@gmail.com; livhuwani.ndou@transnet.net; ludekefj@eskom.co.za; makungoe@dws.gov.za; Marina.Lourens@transnet.net; masegokgotiaekae@gmail.com; MofokeTM@eskom.co.za; nmokonopi@ncpg.gov.za; ngoltz@ncpg.gov.za; nhiggitt@sahra.org.za; NneneTM@eskom.co.za; Norman.Papenfus@transnet.net; pierreb@gamagara.co.za; raisibe.sekepane@dmr.gov.za; refilwe@gamagara.co.za; susanna@landscapedynamics.co.za; vdmerweF@nra.co.za; virginiam@gamagara.co.za; Wentzel.Radcliffe@transnet.net;



Subject: Notice of Revised Location - New Kathu Cemetery

Message 2017-02-22_Kathu cemetery revised location_IAPs&Authorities.pdf (2 MB)

REVISED LOCATION OF THE NEW KATHU CEMETERY

Dear Interested and Affected Parties,

Please find the attached notification of the revised location of the New Kathu Cemetery.

Kind Regards,

Chiara D'Egidio Kotze

Environmental Assessment Practitioner
Synergistics - part of the SLR group

Email: ckotze@slrconsulting.com

Mobile: +27 73 277 7228

Tel: +27 11 467 0945

Ext: 2005

Fax: +27 11 467 0978

SLR Consulting (Fourways office)
Block 7 Fourways Manor Office Park
Cnr Roos and Macbeth Streets
Fourways, Johannesburg, 2060
South Africa



This message was sent with High importance.

From: Chiara D'Egidio Kotze

Sent: Wed 2017/02/22 01:22 PM

To:

Cc:

ekn@mweb.co.za; elizna.badenhorst@assmanj.co.za; fortunec@ncpg.gov.za; Gilbert.Nortier@transnet.net; JacolineMa@daff.gov.za; jj089@lantic.net; khannie@ncpg.gov.za; letoditumelo007@gmail.com; livhuwani.ndou@transnet.net; ludekefj@eskom.co.za; makungoe@dws.gov.za; Marina.Lourens@transnet.net; masegokgotlaekae@gmail.com; MofokeTM@eskom.co.za; nmokonopi@ncpg.gov.za; ngoltz@ncpg.gov.za; nhiggitt@sahra.org.za; NneneTM@eskom.co.za; Norman.Papenfus@transnet.net; pierreb@gamagara.co.za; raisibe.sekepane@dmr.gov.za; refluwe@gamagara.co.za; susanna@landscapedynamics.co.za; vdmerwef@nra.co.za; virginiam@gamagara.co.za; Wentzel.Radcliffe@transnet.net; werner.voigt@angloamerican.com

Subject: Notice of Revised Location - New Kathu Cemetery

Message  2017-02-22_Kathu cemetery revised location_IAPs&Authorities.pdf (2 MB)



REVISED LOCATION OF THE NEW KATHU CEMETERY

Dear Interested and Affected Parties,

Please find the attached notification of the revised location of the New Kathu Cemetery.

Kind Regards,

Chiara D'Egidio Kotze

Environmental Assessment Practitioner
Synergistics - part of the SLR group

Email: ckotze@slrconsulting.com

Mobile: +27 73 277 7228

Tel: +27 11 467 0945

Ext: 2005

Fax: +27 11 467 0978

SLR Consulting (Fourways office)
Block 7 Fourways Manor Office Park
Cnr Roos and Macbeth Streets
Fourways, Johannesburg, 2060
South Africa



Delete Respond Quick Steps Move Tags Editing Zoom

From: Chiara D'Egidio Kotze Sent: Thu 2017/02/23 11:44 AM

To:

Cc: abrahamsn@nra.co.za; agrobler@landscapedynamics.co.za; Annelize.Harmse@transnet.net; assegaie@yahoo.com; Dekockr@nra.co.za; dirk.coetzee@assmang.co.za; dktthomelang@gmail.com; e.louw3@gmail.com; eilerdm@taologaetsewe.gov.za; ekn@mweb.co.za; elizna.badenhorst@assmang.co.za; fortunec@ncpg.gov.za; Gilbert.Nortier@transnet.net; JacquelineMa@daff.gov.za; jj089@lantic.net; khannie@ncpg.gov.za; letoditumelo007@gmail.com; livhuwani.ndou@transnet.net; ludekefj@eskom.co.za; makungoe@dws.gov.za; Marina.Lourens@transnet.net; masegokgotlaekae@gmail.com; MofokeTM@eskom.co.za; nmokonopi@ncpg.gov.za; ngoltz@ncpg.gov.za; nhiggitt@sahra.org.za; NneneTM@eskom.co.za; Norman.Papenfus@transnet.net; pierre@gamagara.co.za; raisibe.sekepane@dmr.gov.za; reflwe@gamagara.co.za; susanna@landscapedynamics.co.za; vdmerweF@nra.co.za; virginiam@gamagara.co.za; Wentzel.Raddiffe@transnet.net; werner.voigt@angloamerican.com

Subject: RE: Notice of Revised Location - New Kathu Cemetery Afrikaans

Message 2017-02-22_Kathu cemetery revised location_AFR.pdf (2 MB)



REVISED LOCATION OF THE NEW KATHU CEMETERY

Dear Interested and Affected Parties,

Please find attached the notification of the revised location of the New Kathu Cemetery in Afrikaans.

Kind Regards,

From: Chiara D'Egidio Kotze
Sent: 22 February 2017 01:22 PM
Subject: Notice of Revised Location - New Kathu Cemetery
Importance: High

REVISED LOCATION OF THE NEW KATHU CEMETERY

Dear Interested and Affected Parties,

Please find the attached notification of the revised location of the New Kathu Cemetery.

Kind Regards,

Chiara D'Egidio Kotze
Environmental Assessment Practitioner
Synergistics - part of the SLR group



Project Reference: 755.23023.00008

File Ref. 2017-02-22_Kathu cemetery revised location_IAPs&Authorities

Date: 22 February 2017

ATTENTION: INTERESTED AND AFFECTED PARTIES

Dear Sir/Madam

NOTICE OF REVISION OF THE POSITION OF THE NEW KATHU CEMETERY

In November 2016, you were notified of the proposed development of the New Kathu Cemetery, in Kathu, Northern Cape. This letter serves to notify you of the revised location of the New Kathu Cemetery.

Following commencement of the public participation process in November 2016, Eskom indicated that they were planning to apply for the construction of a new powerline which would intersect with the New Kathu Cemetery. In order to accommodate the Eskom powerline, the New Kathu Cemetery was moved. The revised location of the New Kathu Cemetery is near the original location, still located on the remaining extent of the farm Lyleveld 545 [land owned by the Sishen Iron Ore Company (Pty) Ltd] and is still 5 ha in extent. A map showing the revised location of the New Kathu Cemetery is included in Appendix 1. The Basic Assessment (BA) will consider the revised location of the New Kathu Cemetery. The BA will be available for public and authority review mid-March 2017; you will be notified of the review dates once finalised.

Synergistics Environmental Services (Pty) Ltd (a SLR Group Company) has been appointed as the independent environmental practitioner responsible for undertaking the necessary environmental work and conducting the public participation process for the project. Should you have any queries please submit your comments/queries to the person listed below.

Yours faithfully

Chiara D'Egidio Kotze
ckotze@slrconsulting.com; Tel: (011) 467-0945; Fax: (011) 467-0978

APPENDIX 1: LOCALITY MAP

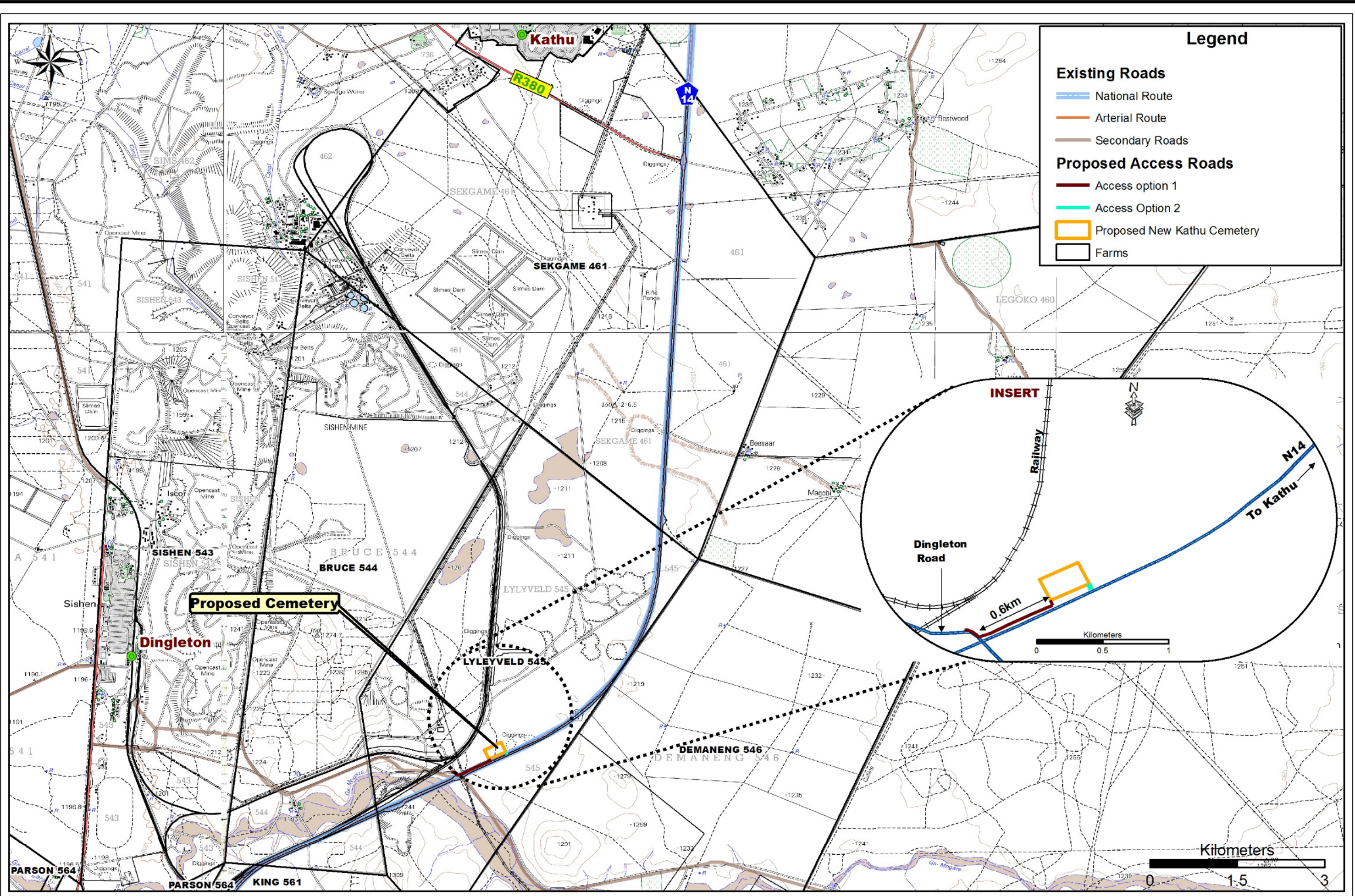

Legend

Existing Roads

- National Route
- Arterial Route
- Secondary Roads

Proposed Access Roads

- Access option 1
- Access Option 2

Proposed New Kathu Cemetery

- Proposed New Kathu Cemetery

Farms

- Farms

Locality Map for the Proposed New Kathu Cemetery

SLR 755.23023.00008

Coordinate System
DMS
Spheroid WGS84 Central Meridian LO

Chiara D'Egidio Kotze

From: Natasha Higgitt <nhiggitt@sahra.org.za>
Sent: 23 February 2017 11:54 AM
To: Chiara D'Egidio Kotze
Subject: Re: Notice of Revised Location - New Kathu Cemetery

Good morning,

Thank you for the update. Please ensure that the Basic Assessment report and all appendices are submitted to the SAHRIS Case file for review during the Public Participation phase of the project. Please inform me when this is completed, referencing the SAHRIS Case ID number.

Kind Regards,

Natasha Higgitt
Heritage Officer: Archaeology, Palaeontology and Meteorites Unit

South African Heritage Resources Agency
- A nation united through heritage -

T: +27 21 462 4502 | F: +27 21 462 4509 | C: +27 82 507 0378
E: nhiggitt@sahra.org.za | 111 Harrington Street | Cape Town

www.sahra.org.za

Natasha Higgitt
Heritage Officer: Archaeology, Palaeontology and Meteorites Unit

South African Heritage Resources Agency
- A nation united through heritage -

T: +27 21 462 4502 | C: +27 82 507 0378 | F: +27 21 462 4509
E: nhiggitt@sahra.org.za | 111 Harrington Street | Cape Town | 8001

www.sahra.org.za



From: "Chiara D'Egidio Kotze" <ckotze@slrconsulting.com>
Sent: Wednesday, 22 February, 2017 1:22:04 PM
Subject: Notice of Revised Location - New Kathu Cemetery

REVISED LOCATION OF THE NEW KATHU CEMETERY

Dear Interested and Affected Parties,

Please find the attached notification of the revised location of the New Kathu Cemetery.

Kind Regards,

Chiara D'Egidio Kotze
Environmental Assessment Practitioner
Synergistics - part of the SLR group

Email: ckotze@slrconsulting.com
Mobile: +27 73 277 7228
Tel: +27 11 467 0945
Ext: 2005
Fax: +27 11 467 0978

SLR Consulting (Fourways office)
Block 7 Fourways Manor Office Park
Cnr Roos and Macbeth Streets
Fourways, Johannesburg, 2060
South Africa

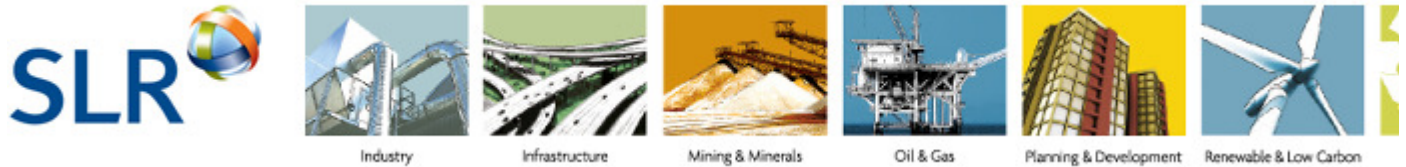

Confidentiality Notice and Disclaimer

This communication and any attachment(s) contains information which is confidential and may also be legally privileged. It is intended for the exclusive use of the recipient(s) to whom it is addressed. If you are not the intended recipient, any disclosure, copying, distribution or any action taken or omitted to be taken in reliance on it, is prohibited and may be unlawful. If you have received this communication in error please email us by return mail and then delete the email from your system together with any copies of it. Please note that you are not permitted to print, copy, disclose or use part or all of the content in any way.

Emails and any information transmitted thereunder may be intercepted, corrupted or delayed. As a result, SLR does not accept any responsibility for any errors or omissions howsoever caused and SLR accepts no responsibility for changes made to this email or any attachment after transmission from SLR. Whilst all reasonable endeavours are taken by SLR to screen all emails for known viruses, SLR cannot guarantee that any transmission will be virus free.

Any views or opinions are solely those of the author and do not necessarily represent those of SLR Management Ltd, or any of its subsidiaries, unless specifically stated.

SLR Consulting (South Africa) (Proprietary) Limited and SLR Consulting (Africa) (Proprietary) Limited are both subsidiaries of SLR Management Ltd. Registered Office: Unit 7 Fourways Manor Office Park, Cnr Roos and Macbeth Street, Fourways, 2191, Gauteng, South Africa

This electronic communication and its content(s) are subject to a disclaimer which can be accessed here: <http://mail.sahra.org.za/disclaimer.html>



Adriaan Louis Botha

From: Chiara D'Egidio Kotze
Sent: 17 November 2016 03:32 PM
To: virginiam@gamagara.co.za
Subject: Notification: New Kathu Cemetery
Attachments: 2016-11-17 BA Notification letter english_IAPs Final1.pdf

NOTICE OF THE BASIC ASSESSMENT PROCESS FOR NEW KATHU CEMETARY

Dear Virginia,

The Gamagara Local Municipality is proposing to develop additional space for graves near the town of Kathu.

Please find the background information document for further information on the application and the proposed project.

Please can you forward the attached document to all the ward councillors: Ward 1, Ward 2, Ward 3, Ward 4 and Ward 5.

Many thanks,

Chiara D'Egidio Kotze

Environmental Assessment Practitioner
Synergistics - part of the SLR group

Email: ckotze@slrconsulting.com
Mobile: +27 73 277 7228
Tel: +27 11 467 0945
Ext: 2005
Fax: +27 11 467 0978

SLR Consulting (Fourways office)
Block 7 Fourways Manor Office Park
Cnr Roos and Macbeth Streets
Fourways, Johannesburg, 2060
South Africa



Industry



Infrastructure



Mining & Minerals



Oil & Gas



Planning & Development



Renewable & Low Carbon

Confidentiality Notice and Disclaimer

This communication and any attachment(s) contains information which is confidential and may also be legally privileged. It is intended for the exclusive use of the recipient(s) to whom it is addressed. If you are not the intended recipient, any disclosure, copying, distribution or any action taken or omitted to be taken in reliance on it, is prohibited and may be unlawful. If you have received this communication in error please email us by return mail and then delete the email from your system together with any copies of it. Please note that you are not permitted to print, copy, disclose or use part or all of the content in any way.

Emails and any information transmitted thereunder may be intercepted, corrupted or delayed. As a result, SLR does not accept any responsibility for any errors or omissions howsoever caused and SLR accepts no responsibility for changes made to this email or any attachment after transmission from SLR. Whilst all reasonable endeavours are taken by SLR to screen all emails for known viruses, SLR cannot guarantee that any transmission will be virus free.

Any views or opinions are solely those of the author and do not necessarily represent those of SLR Management Ltd, or any of its subsidiaries, unless specifically stated.

SLR Consulting (South Africa) (Proprietary) Limited and SLR Consulting (Africa) (Proprietary) Limited are both subsidiaries of SLR Management Ltd. Registered Office: Unit 7 Fourways Manor Office Park, Cnr Roos and Macbeth Street, Fourways, 2191, Gauteng, South Africa



an agency of the
Department of Arts and Culture

T: +27 21 462 4502 | F: +27 21 462 4509 | E: info@sahra.org.za
South African Heritage Resources Agency | 111 Harrington Street | Cape Town
P.O. Box 4637 | Cape Town | 8001
www.sahra.org.za

Enquiries: Natasha Higgitt
Tel: 021 462 4502
Email: nhiggitt@sahra.org.za
CaseID: 10412

Date: Monday December 12, 2016
Page No: 1

Response to NID (Notification of Intent to Develop)

In terms of Section 38(2) of the National Heritage Resources Act (Act 25 of 1999)

Attention: Gamagara Local Municipality

The Gamagara Local Municipality (Gamagara Municipality) proposes to develop additional space for graves in the town of Kathu. The existing Kathu Cemetery is located approximately 3.5 km north-east of central Kathu on the remaining extent of the farm Uitkoms 463 (immediately East of the N14 road), and falls within the Gamagara Municipality and John Taolo Gaetsewe District Municipality, in the Northern Cape. The cemetery is nearing capacity and thus additional space is necessary due to the rapid expansion of the town of Kathu which is partly due to the resettlement of the Dingleton residents as a result of the expansion of the Sishen Iron Ore Mine. Due to the existing Kathu Cemetery being located in the protected Kathu Forest, extending the cemetery on the farm Uitkomst 463 is not possible. An alternative location has been proposed and is the only feasible alternative for the new cemetery. The best viable alternative is to establish a new cemetery on the remaining extent of the farm Lylyveld 545, approximately 13 km south of central Kathu. The new Kathu Cemetery will be approximately 5 hectares (ha) in extent on land owned by the SIOC. The land for the new cemetery will be transferred to the Gamagara Municipality through a land swap agreement as part of the Dingleton Resettlement project.

Thank you for notifying SAHRA of the proposed new Kathu Cemetery, on the remaining extent of the farm remaining extent of the farm Lylyveld 545, near Kathu, Northern Cape Province.

In terms of the National Heritage Resources Act, no 25 of 1999, heritage resources, including archaeological or palaeontological sites over 100 years old, graves older than 60 years, structures older than 60 years are protected. They may not be disturbed without a permit from the relevant heritage resources authority. This means that before such sites are disturbed by development it is incumbent on the developer to ensure that a **Heritage Impact Assessment (HIA)** is done as per Section 38(8) of the NHRA. This must include the archaeological component (Phase 1) any other applicable heritage components. The HIA must be conducted as part of the Environmental Impact Assessment (EIA) phase of the Environmental Authorisation Application in terms of the National Environmental Management Act, No 107 of 1998 (NEMA) and the NEMA EIA Regulations 2014.

The quickest process to follow for the archaeological component would be to contract a specialist (see

Our Ref:



an agency of the
Department of Arts and Culture

T: +27 21 462 4502 | F: +27 21 462 4509 | E: info@sahra.org.za
South African Heritage Resources Agency | 111 Harrington Street | Cape Town
P.O. Box 4637 | Cape Town | 8001
www.sahra.org.za

Enquiries: Natasha Higgitt
Tel: 021 462 4502
Email: nhiggitt@sahra.org.za
CaseID: 10412

Date: Monday December 12, 2016

Page No: 2

www.asapa.org.za) to provide a Phase 1 Archaeological Impact Assessment Report. The Phase 1 Impact Assessment Report will identify the archaeological sites and assess their significance. It should also make recommendations (as indicated in section 38) about the process to be followed. For example, there may need to be a mitigation phase (Phase 2) where the specialist will collect or excavate material and date the site. At the end of the process the heritage authority may give permission for destruction of the sites. If the property is very small or disturbed and there is no significant site the specialist may choose to send a letter to the heritage authority to indicate that there is no necessity for any further assessment. It must be noted that the proposed development is located approximately 14 km from the Kathu Archaeological Site which is currently pending declaration as a National Heritage Site.

Where bedrock is to be affected, or where there are coastal sediments, or marine or river terraces and in potentially fossiliferous superficial deposits, a Palaeontological Desk Top study must be undertaken to assess whether or not the development will impact upon palaeontological resources - or at least a letter of exemption from a Palaeontologist is needed to indicate that this is unnecessary. If the area is deemed sensitive, a full Phase 1 Palaeontological Impact Assessment will be required and if necessary a Phase 2 rescue operation might be necessary (see www.palaeontologicalsociety.co.za for qualified paleontologists).

Any other heritage resources that may be impacted such as built structures over 60 years old, sites of cultural significance associated with oral histories, burial grounds and graves, graves of victims of conflict, and cultural landscapes or viewsapes must also be assessed.

Please note that all Environmental Reports (Scoping Report and EIA) with all appendices must be submitted to the SAHRIS Case file in order for an informed comment to be issued.

Should you have any further queries, please contact the designated official using the case number quoted above in the case header.

Yours faithfully

Natasha Higgitt

Our Ref:



an agency of the
Department of Arts and Culture

T: +27 21 462 4502 | F: +27 21 462 4509 | E: info@sahra.org.za
South African Heritage Resources Agency | 111 Harrington Street | Cape Town
P.O. Box 4637 | Cape Town | 8001
www.sahra.org.za

Enquiries: Natasha Higgitt
Tel: 021 462 4502
Email: nhiggitt@sahra.org.za
CaseID: 10412

Date: Monday December 12, 2016
Page No: 3

Heritage Officer
South African Heritage Resources Agency

John Gribble
Manager: Maritime and Underwater Cultural Heritage Unit / Acting Manager: Archaeology, Palaeontology and Meteorites Unit
South African Heritage Resources Agency

ADMIN:
Direct URL to case: <http://www.sahra.org.za/node/375584>
(DENC, Ref:)



Project Reference: 755.23023.00008

File Ref. 2017-03-10_Kathu cemetery final location-de la fontaine

Date: 10 March 2017

ATTENTION: INTERESTED AND AFFECTED PARTIES

Dear Ms de la Fontaine,

NOTICE OF REVISION OF THE POSITION OF THE NEW KATHU CEMETERY

In September 2016, you were notified of the proposed development of the New Kathu Cemetery and attended a site visit, in Kathu, Northern Cape. This letter serves to notify you of the final location of the New Kathu Cemetery.

In November 2016, Eskom indicated that they were planning to apply for the construction of a new powerline. Cognisance was taken of the Eskom powerline route for the finalisation of the New Kathu Cemetery location. The location of the New Kathu Cemetery is near the original location of the site visit, still located on the remaining extent of the farm Lyleveld 545 [land owned by the Sishen Iron Ore Company (Pty) Ltd] and is still 5 ha in extent. A map showing the location of the New Kathu Cemetery is included in Appendix 1. The Basic Assessment will be available for public and authority review near the end of March 2017; you will be notified of the review dates once finalised.

Synergistics Environmental Services (Pty) Ltd (a SLR Group Company) has been appointed as the independent environmental practitioner responsible for undertaking the necessary environmental work and conducting the public participation process for the project. Should you have any queries please submit your comments/queries to the person listed below.

Yours faithfully

Chiara D'Egidio Kotze
ckotze@slrconsulting.com; Tel: (011) 467-0945; Fax: (011) 467-0978

APPENDIX 1: LOCALITY MAP

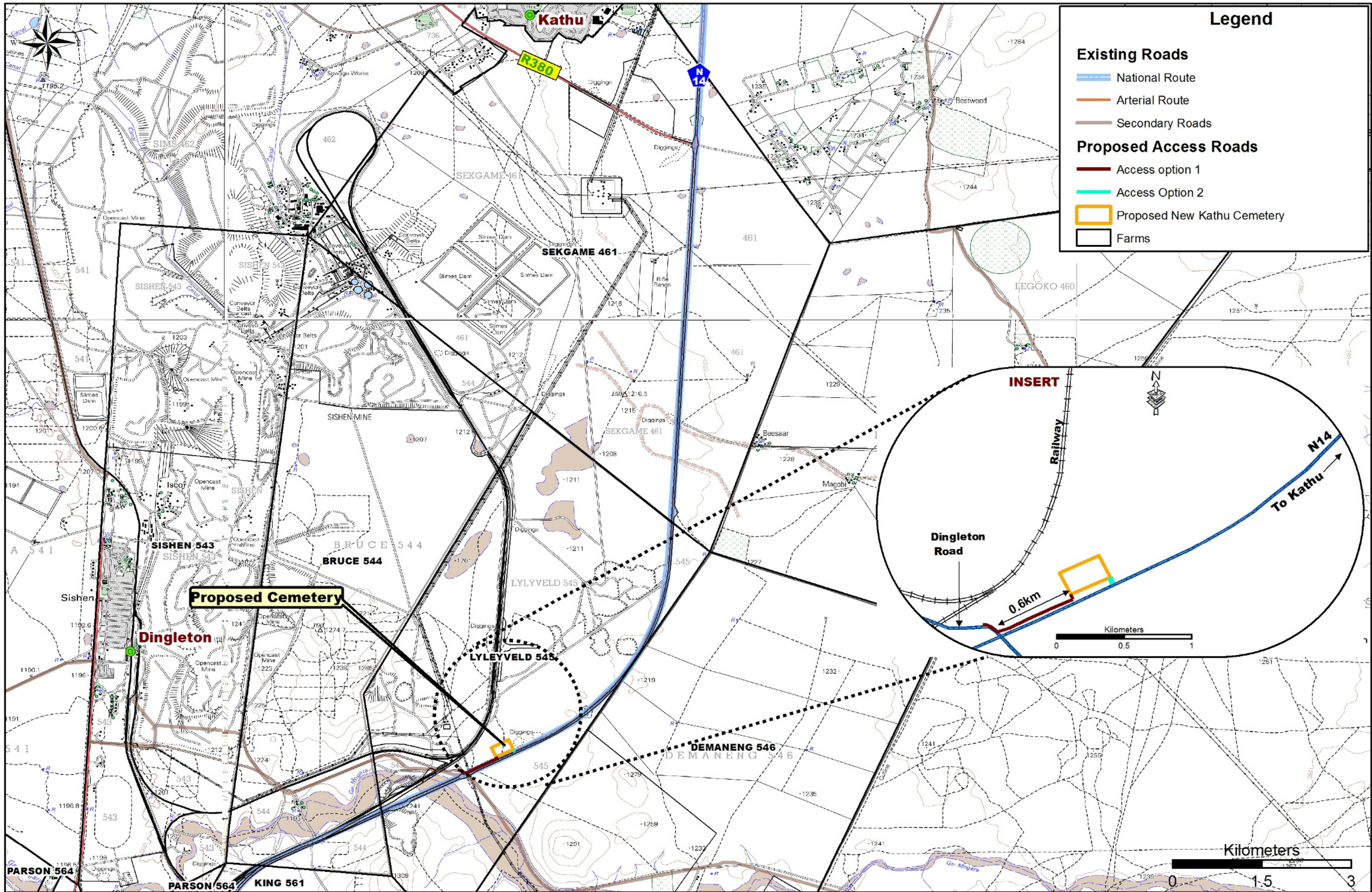

Legend

Existing Roads

- National Route
- Arterial Route
- Secondary Roads

Proposed Access Roads

- Access option 1
- Access Option 2

Proposed New Kathu Cemetery

- Proposed New Kathu Cemetery

Farms

- Farms

Locality Map for the Proposed New Kathu Cemetery

SLR 755.23023.00008

Coordinate System
DMS
Spheroid WGS84 Central Meridian LO

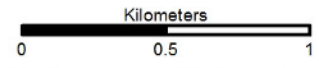
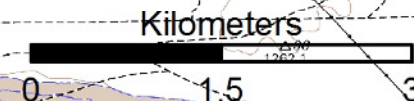

Chiara D'Egidio Kotze

From: Chiara D'Egidio Kotze
Sent: 10 March 2017 09:54 AM
To: Samantha De la Fontaine
Subject: New Kathu Cemetery final location
Attachments: 2017-03-10_Kathu cemetery final location-de la fontaine.pdf

Dear Ms de la Fontaine,

Please find the attached notification which provides the final location of the New Kathu Cemetery. In September 2016, you were notified of the proposed development of the New Kathu Cemetery by attending a site visit, in Kathu, Northern Cape. The attached letter serves to notify you of the final location.

The basic assessment report will be available for authority review near the end of March 2017 and you will be notified of its availability.

Kind regards,
Chiara

Chiara D'Egidio Kotze

Environmental Assessment Practitioner
Synergistics - part of the SLR group

Email: ckotze@slrconsulting.com
Mobile: +27 73 277 7228
Tel: +27 11 467 0945
Ext: 2005
Fax: +27 11 467 0978

SLR Consulting (Fourways office)
Block 7 Fourways Manor Office Park
Cnr Roos and Macbeth Streets
Fourways, Johannesburg, 2060
South Africa



Industry



Infrastructure



Mining & Minerals



Oil & Gas



Planning & Development



Renewable & Low Carbon

Confidentiality Notice and Disclaimer

This communication and any attachment(s) contains information which is confidential and may also be legally privileged. It is intended for the exclusive use of the recipient(s) to whom it is addressed. If you are not the intended recipient, any disclosure, copying, distribution or any action taken or omitted to be taken in reliance on it, is prohibited and may be unlawful. If you have received this communication in error please email us by return mail and then delete the email from your system together with any copies of it. Please note that you are not permitted to print, copy, disclose or use part or all of the content in any way.

Emails and any information transmitted thereunder may be intercepted, corrupted or delayed. As a result, SLR does not accept any responsibility for any errors or omissions howsoever caused and SLR accepts no responsibility for changes made to this email or any attachment after transmission from SLR. Whilst all reasonable endeavours are taken by SLR to screen all emails for known viruses, SLR cannot guarantee that any transmission will be virus free.

Any views or opinions are solely those of the author and do not necessarily represent those of SLR Management Ltd, or any of its subsidiaries, unless specifically stated.

SLR Consulting (South Africa) (Proprietary) Limited and SLR Consulting (Africa) (Proprietary) Limited are both subsidiaries of SLR Management Ltd. Registered Office: Unit 7 Fourways Manor Office Park, Cnr Roos and Macbeth Street, Fourways, 2191, Gauteng, South Africa