

Components

- (1) The figure ABCDr represents REMAINDER ERF 1947 WALMER
Vide Diagram No. 6328/1949 D/T 1951-281-14001
- (2) The figure ArFGHst represents REMAINDER ERF 1961 WALMER
Vide Diagram No. 7194/1946 D/T 1856.27.234
- (3) The figure tsvu represents ERF 1960 WALMER
Vide Diagram No. 7193/1946 D/T 1947. .24002
- (4) The figure uvJKLMNPQ represents ERF 11303 WALMER
Vide Diagram No. 5698/2006 D/T 2007. .20137

S.G. No.

226/2009

Approved

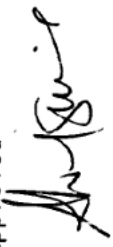

for Surveyor-General

2009.01.30

SHEET 1 OF 2 SHEETS

The figure A B C D E F G H J K L M N P Q
represents 43,7273 Hectares of land being

ERF 11305 WALMER

and comprises components (1) to (4) quoted above
situate in the Nelson Mandela Bay Municipality
Administrative District of Port Elizabeth
Province of Eastern Cape
Compiled in AUGUST 2007, by me,

JOHAN MEIRING (PLS 0393)
Professional Land Surveyor



This diagram is annexed to

No. T 27210/2009

d.d.

i.f.o.

The original diagrams are
as quoted above.

Registrar of deeds

LPI C0590038

File S/9175/7 V3

S.R. No. Compiled

T.P.

Comp. AO-2AA (3638)
BO-8CC/Z3 (2075)
BO-8CC/Z4 (2076)

S.G. No.

226/2009

Approved

for Surveyor-General

2009.01.30

SHEET 2 OF 2 SHEETS

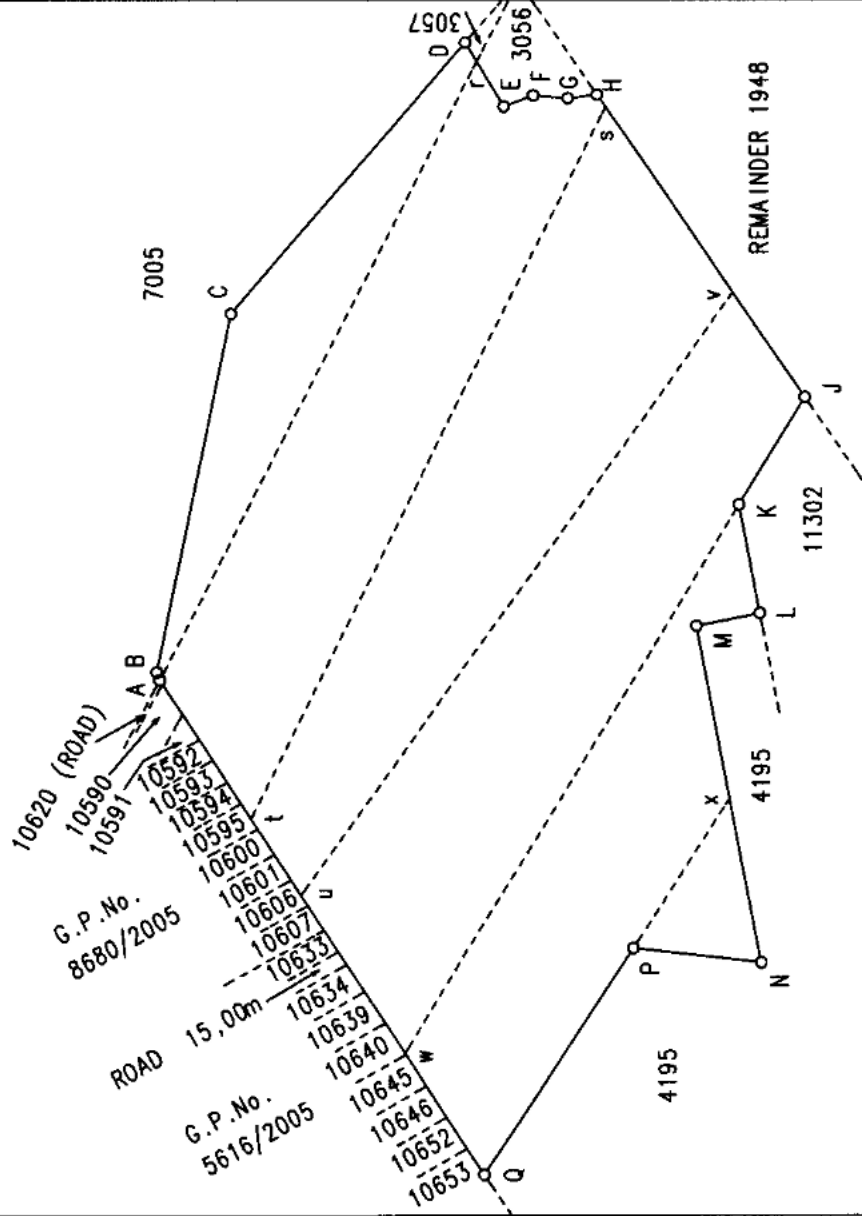
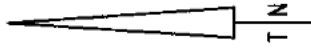

SCALE 1:7500

ERF 11305 WALMER

and comprises components (1) to (4) quoted on Sheet 1
 situate in the Nelson Mandela Bay Municipality
 Administrative District of Port Elizabeth
 Province of Eastern Cape
 Compiled in AUGUST 2007 , by me .

JOHAN MEIRING (PLS 0393)
 Professional Land Surveyor

Deeds Office Property



WALMER, 11305, 0 (CAPE TOWN)

GENERAL INFORMATION

Deeds Office CAPE TOWN
Date Requested 2014/06/30 10:39
Information Source DEEDS OFFICE
Reference 475764

PROPERTY INFORMATION

Property Type ERF
Erf Number 11305
Portion Number 0
Township WALMER
Local Authority NELSON MANDELA BAY METROPOLITAN MUNICIPALITY
Registration Division PORT ELIZABETH RD
Province EASTERN CAPE
Diagram Deed T27210/2009
Extent 43.7273H
Previous Description -
LPI Code C05900380001130500000

OWNER INFORMATION

Owner 1 of 1

Person Type GOVERNMENT
Name PROVINCIAL GOVERNMENT-EASTERN CAPE
Registration Number
Title Deed T66351/2013
Registration Date 2013/12/05
Purchase Price (R) 40,000,000
Purchase Date 2013/10/18
Share
Microfilm Reference
Multiple Properties NO
Multiple Owners NO

ENDORSEMENTS (4)

#	Document	Institution	Amount (R)	Microfilm
1	CONSOLIDATE FROM	TOWN WALMER ,ERF 1947 ,PRTN 0	UNKNOWN	-
2	CONSOLIDATE FROM	TOWN WALMER ,ERF 1961 ,PRTN 0	UNKNOWN	-
3	CONSOLIDATE FROM	TOWN WALMER ,ERF 1960 ,PRTN 0	UNKNOWN	-
4	CONSOLIDATE FROM	TOWN WALMER ,ERF 11303 ,PRTN 0	UNKNOWN	-

HISTORIC DOCUMENTS (3)

#	Document	Owner	Amount (R)	Microfilm
1	T27210/2009	CAPE ROADS & EXCAVATIONS PTY LTD	CCT	-
2	T27210/2009	PRIVATE ASSET MANAGEMENT PTY LTD	CCT	-
3	T27210/2009	WALMER HEIGHTS DEVELOPMENT PARTNERSHIP	CCT	-

DISCLAIMER

This report contains information gathered from our suppliers and we do not make any representations about the accuracy of the data displayed nor do we accept responsibility for inaccurate data. WinDeed will not be liable for any damage caused by reliance on this report. This report is subject to the terms and conditions of the [WinDeed End User Licence Agreement \(EULA\)](#).