

Appendix I

SITE LAYOUT

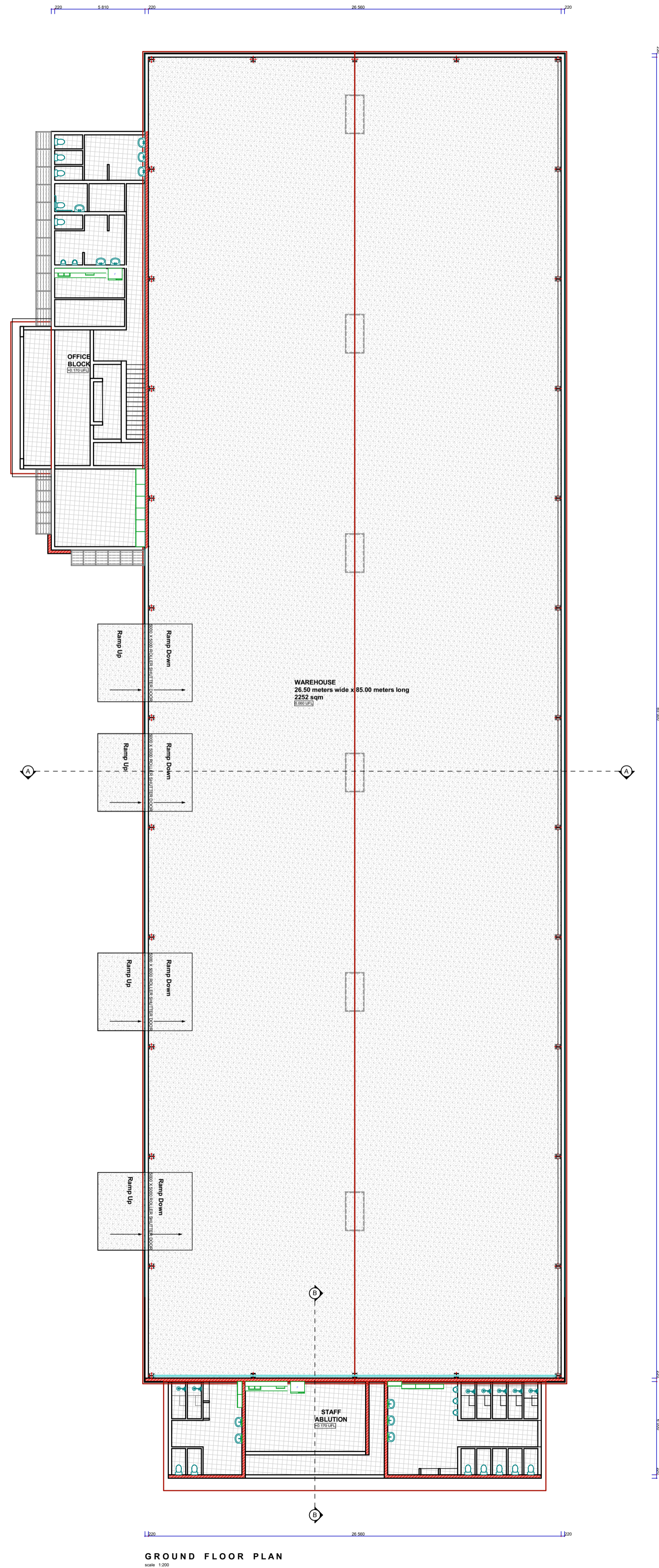



GROUND FLOOR PLAN
SCALE: 1:200

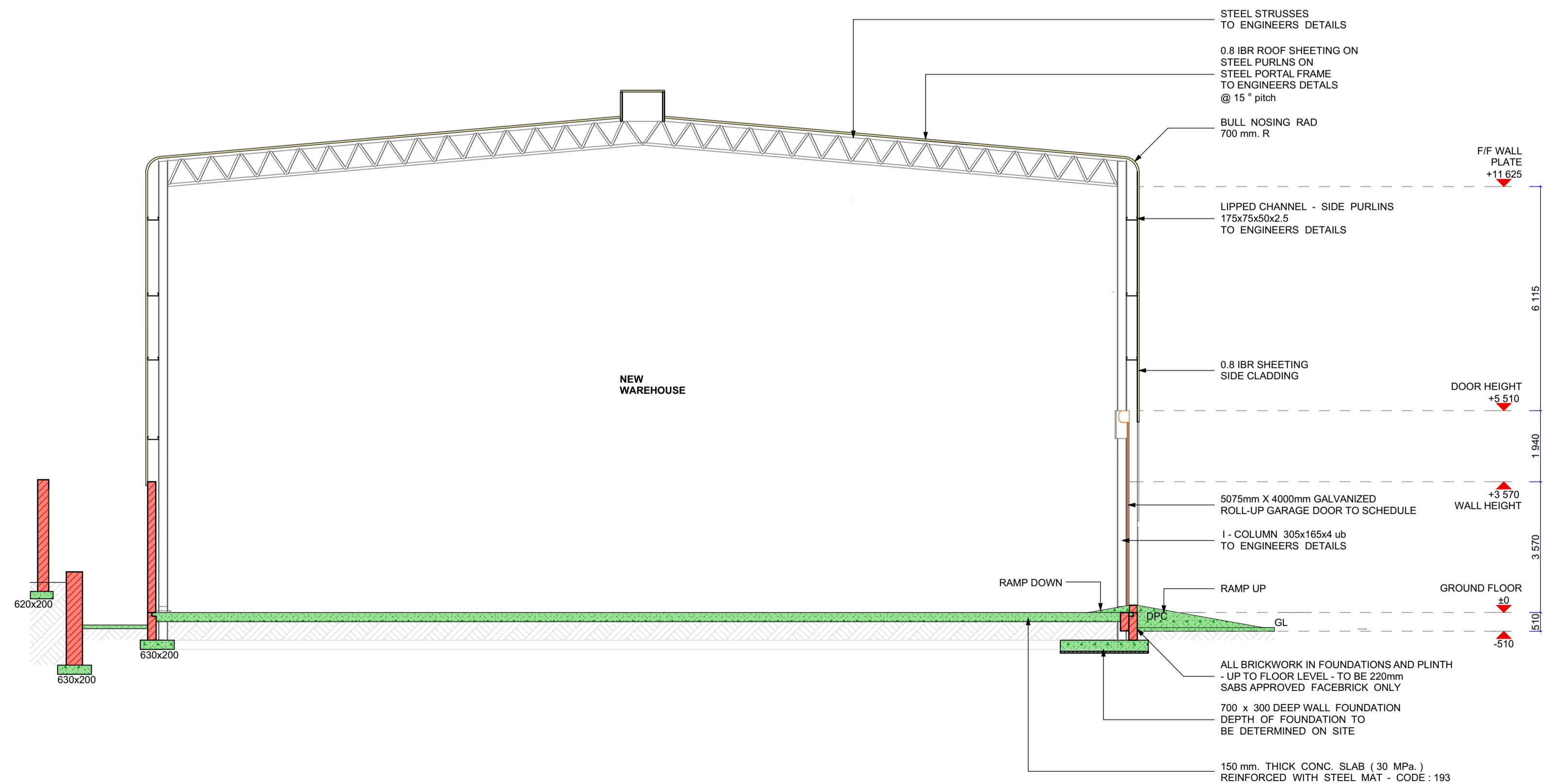

SECTION AA
SCALE: 1:100

ARCHITECTS NOTES

- Dimensions to be used in preference to scaling.
- Any discrepancies on drawings to be pointed out by the contractor prior to the implementation thereof.
- All dimensions to be checked on site prior to commencement of work.
- Plumbing contractor to liaise with architect prior to changing any layouts.
- All building work must comply to municipal and S.A.N.S. 10400 standards.

GENERAL NOTES

- All structural works to be carried out to structural engineers specification
- Any omissions, dimensions or errors to be reported to the architect

ROOF NOTES

- Concrete cement tiles on 38x38 battens @ 320 crs, on PDC underlay, on 114x38 rafters @ 750 crs, on 114x38 wall plate with insulation (according to SANS Part XA). All trusses to manufacturers specification @ min 17.5 deg pitch
- Sheeting roof on Sialation (according to SANS Part XA) @ 1500 crs, on rafters to manufacturers spec @ min 5 deg pitch

DRAINAGE NOTES

- All sewer and drainage reticulation to be in accordance to municipal regulation
- All sewerage to comply with closed sewers system to NBR standards
- Drainage shown is schematic and purely for directional purposes.
- ASVP to any fitting or appliance that has a vertical drop in excess of 1220mm
- Stub stacks and cleaning eye at all fittings with overflow gully at lowest point
- All bends to be long radius and fitted with inspection eye

MECHANICAL AND ELECTRICAL NOTES

- All work to comply with municipal By-Laws and regulations and S.A.N.S 10400
- All Engineer work to comply with the civil engineers design and specifications

STORM WATER NOTES

- Storm water layout to be done in accordance to local municipal By-Laws
- All work to comply with the civil engineers design and specifications.

WALL NOTES

- 110mm & 220mm SABS approved brick wall's with brick force every third course. Pre-Stressed lintols over all openings.
- DPC to all walls at floor level and under all window cills
- Vertical dip to any changes in floor level, dip to s.a.b.a 238
- All brickwork in foundations and plinth - up to floor level- to be 220mm SABS approved bricks only

ENERGY EFFICIENCY NOTE

- The installation, maintenance, repair and replacement of domestic solar water heating systems and thermal insulation to be in accordance with part XA SANS 10106
- Fenestration (Glazing) to be in accordance with part XA SANS 10400

Copyright reserved by ADS

DESIGNED BY: LEON ANGELL - SCHAU
DRAWN BY: PRINCE XOLANI BODLOZA
CHECKED BY: LEON ANGELL - SCHAU

OWNERS SIGNATURE

DESIGNERS SIGNATURE



www.adsbay.co.za

L. ANGELL - SCHAU (PrArchT)
S. A. C. A. P. Reg Number - T 0569
S. A. I. B. D. & N. H. B. R. C
P. O. BOX 101002 MEERENSEE, 3901
CELL: (076) 391 3283 / TEL: (035) 789 8720
E - MAIL: info@adsbay.co.za



Municipal Stamps

Project
FLOOR PLAN & SECTION

Title
**PROPOSED NEW WAREHOUSING
COMPLEX FOR R-BAY PROPERTIES
ON LOT 2306 & 2307
PIETERMARITZBURG,
KwaZULU - NATAL**

Date: 14 / 03 / 2023
Project No: 22071 - KM7 | Drawing No: 22071 - KM7 | Page: 1 | Category: 1 Building G1 & J3