

# Majuba Solar Energy Facility

Environmental sensitivity and layout map

## Legend

- Secondary road
- Majuba power station
- Affected farm portions
- Site Access Route
- 11kV/132kV Power Line
- Laydown Construction Area
- O&M Building
- Proposed Parking Area
- Proposed Connection Point
- Proposed PV Plant Substation
- PV Site

## Environmental Sensitivities:

- Wetland (No-go area)
- Wetland Buffer (30m\_No-go area)
- Eucalyptus-Pennisetum depression (Medium Ecological Sensitivity)
- Themeda-Helichrysum pilosellum Grassland (Medium Ecological Sensitivity)
- Semi-natural Grassland (Low Ecological Sensitivity)
- Medium Avifaunal Sensitivity

Scale: 1:8 500  
Projection: LO29  
Map Ref.: Majuba PV SEF - Env sens map\_16.03.16

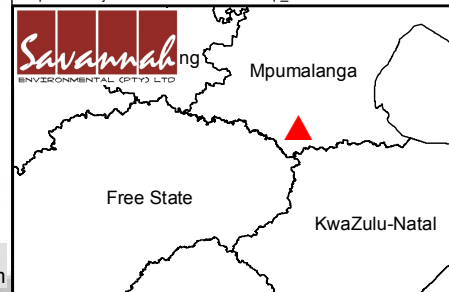

WITKOPPIES 81 HS

2/81

6/81

1/81

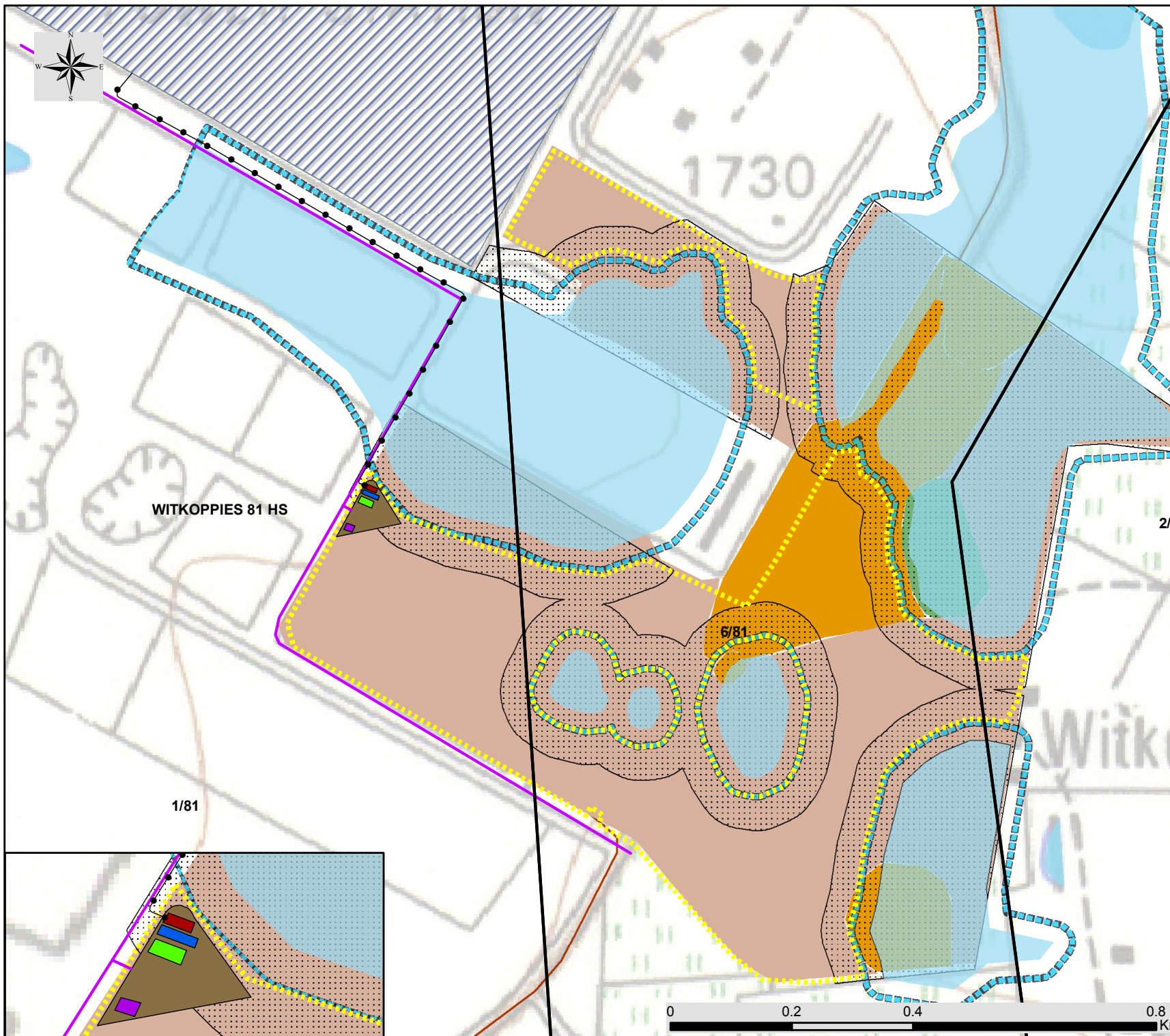
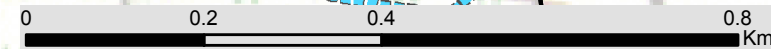



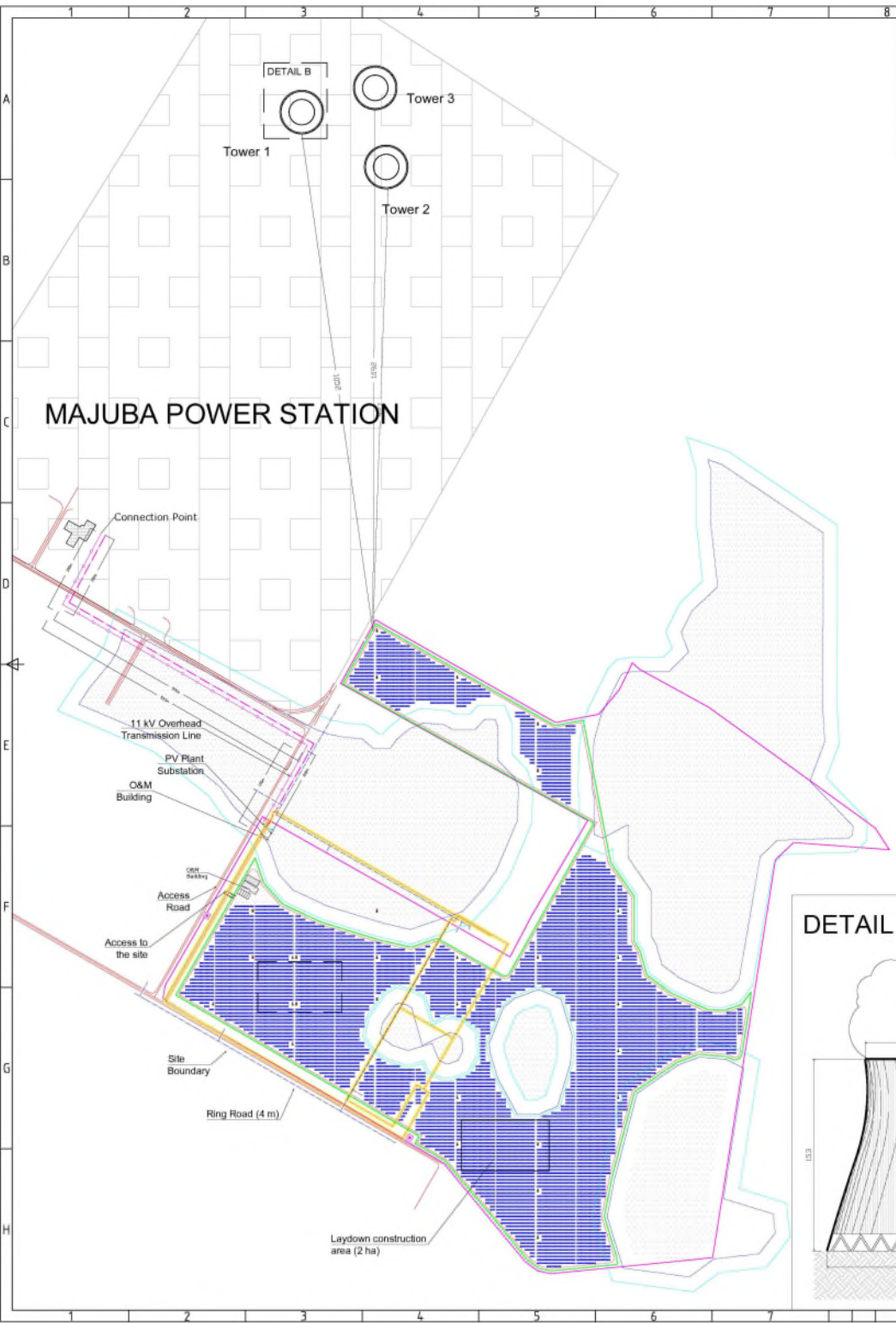

**DETAIL - A**

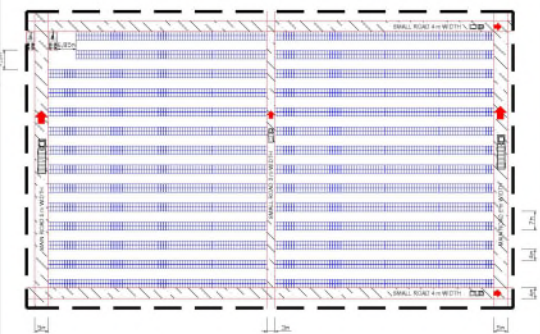

No. of modules per MVA: 4,400  
Power Peak: 1,000 kWp

**LEGEND**

- PV ROW
- MV CABIN
- SINGLE TIER FENCE
- EXISTING SUBSTATION
- Site boundary
- BURIED PIPES 100/300/500 mm
- BURIED CABLES
- 11 kV OVERHEAD TRANSMISSION LINE
- 88 kV PROPOSED OVERHEAD LINE FOR FUTURE EXPANSION
- 11 kV UNDERGROUND CABLE
- INTERNALISING ROADS 3.5 M WIDTH
- ACCESS ROAD TO POWER STATION
- PV PLANT SUBSTATION (10 x 32 m)
- O&M BUILDING (35 x 13 m)
- PARKING AREA
- LAYDOWN CONSTRUCTION AREA
- COOLING TOWERS 1-3
- WETLAND BUFFER 30 m
- WETLAND BOUNDARY
- WETLAND



**DETAIL - B**

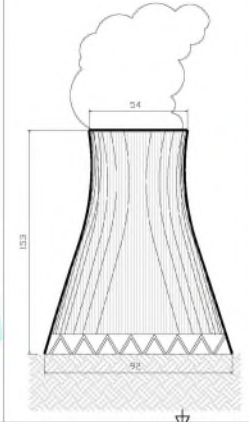

**Majuba PV Plant information**

Foot print area	96.9 ha
Indicative capacity	Up to 30 MW

**Site Corners Coordinates (WG 29)**

Cn. Nr.	Y(m)	X(m)
1	76574.8930	-2999400.0250
2	77013.1220	-2999579.0280
3	77119.2690	-2999493.2510
4	77672.309	-2999981.657
5	77424.472	-2999883.884
6	77285.975	-3000724.89
7	76973.555	-3000783.13
8	76721.544	-3000564.377
9	76160.054	-3000227.712
10	76338.498	-2999880.841
11	76881.711	-3000175.516
12	77049.158	-2999829.3610
13	76510.102	-2999534.0470

REVISIONS

NO	NAME	DATE	NOTE
01			
02			

**ESKOM HOLDING LIMITED**  
**GROUP TECHNOLOGY**  
**ESKOM ENTERPRISES PARK**

**Majuba PV Plant Indicative Layout**

NAME	DATE
PREPARED: Ciro Raposo	20/03/2015
DRAWN: Ciro Raposo	01/02/2015
CHECKED: Nhl Thukor	01/02/2015
ACCEPTED:	
SHEET SIZE: DIN A1	
SUPPERSEDED BY DRWG. NO:	
CAD FILE:	SCALE:

Production mark 009 34 - 1 - E  
Copying of this drawing, and using it to others and for use or communication of the contents thereof, are forbidden without express authority. Offenders are liable to the payment of damages. All rights are reserved in the event of the grant of a patent or the registration of a utility model or design.