

LEGEND

- Lawn**
Cynodon dactylon or approved species
- Coastal Dune & Grass Vegetation**
Low succulent and grass species
(See recommended list)

Proposed Plant List

Cape Flats Dune Strandveld:	size (hwx)
<i>Carpobrotus edulis</i>	0,15 x 1
<i>Carpobrotus acinaciformis</i>	0,15 x 1
<i>Carpobrotus edulis spp.</i>	0,15 x 1
<i>Pelargonium betulinum</i>	0,6 x 0,6
<i>Ruschia macowanii</i>	0,25 x 0,5
<i>Ruschia spp.</i>	>0,25
<i>Arctatis stoechadifolia</i>	0,2 x 0,5
<i>Cotyledon orbiculata</i>	0,3 x 1
<i>Lampranthus glaucus</i>	0,3 x 1
<i>Lampranthus stenus</i>	0,3 x 1
<i>Lampranthus tenuifolius</i>	0,2 x 0,5
<i>Mesembryanthemum articulatum</i>	0,3 x 0,8
<i>Mesembryanthemum spp.</i>	>0,2
Tufted Grasses:	
<i>Aristida junceiformis</i>	0,4 x 0,4
<i>Cenchrus ciliaris</i>	0,4 x 0,5
<i>Elegia fistulosa</i>	0,75 x 0,4
<i>Melinis nervigulumis</i>	0,6 x 0,6
<i>Themeda triandra</i>	0,5 x 0,5
Lawn:	
<i>Cynodon dactylon</i>	

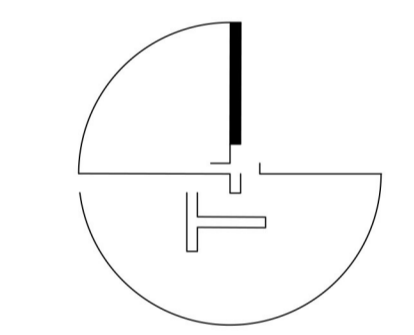

PROJECT TITLE

Muizenberg Beachfront

CLIENT



APPROVAL BY CLIENT
SIGNED

DRAWING TITLE

**PLANTING
Soft Landscape**

DRAWING NUMBER	REV.	DRAWING PURPOSE
124-14.1.2	B	APPROVAL
SCALE	DATE	DRAWN BY
1 : 500 @ A1	2022-12-17	PM

CHECKED BY
Ankia Bormans
Director & Principal Landscape Architect of TERRA+ Landscape Architect
Prof. Landscape Architect, Reg. No. 20197 (SACLAP)

SIGNED

This drawing is copyright protected and remains the property of TERRA+ Landscape Architects. Copyright is reserved by TERRA+, the drawing is issued on the condition that it is copied, otherwise reproduced, retained or disclosed to any person or organization, either wholly or in part only with the written consent from TERRA+ Landscape Architects.

