

**1. BLOCK B: GROUND FLOOR PLAN**  
Scale 1:100

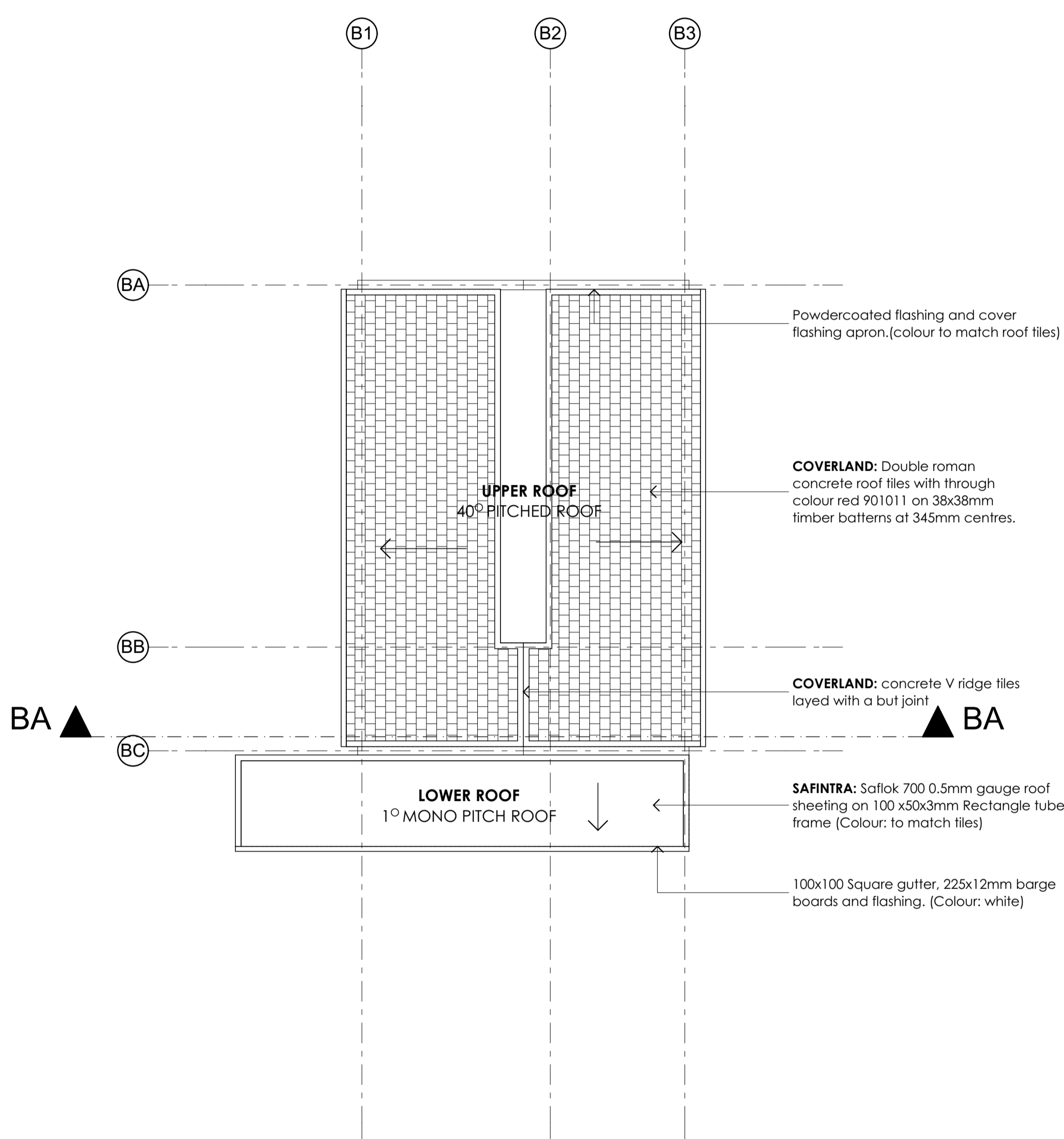

**2. BLOCK B: ROOF PLAN**  
Scale 1:100

**SPECIFICATION**

**ROOFS:**

ROOF CONSTRUCTION ACCORDING TO SABS 563,653,1245,SANS 10400 PART L, PART B, PART T & PART K, AS WELL AS ENGINEER'S DRAWINGS AND SPECIFICATIONS. PROVIDE ALL ROOF FLASHING TO ENSURE EFFICIENT WATERPROOFING. FLASHINGS TO MATCH ROOF.  
DOUBLE PITCHED ROOF AT 40°; COVERLAND DOUBLE ROMAN CEMENT ROOF TILES. ROOF SHEETING FIXED TO SA PINE TIMBER PURLINS AT CENTRES NOT EXCEEDING 345mm, SA PINE TIMBER TRUSSES AT CENTRES NOT EXCEEDING 760mm STRICTLY AS PER MANUFACTURER'S SPECIFICATION AND AS PER STRUCTURAL ENGINEERS SPECIFICATIONS.  
PROVIDE ALL NECESSARY ACCESSORIES, FIXINGS AND FLASHINGS. (ALL TO BE CONFIRMED)  
PROVIDE MIN. 130mm GLASS FIBRE FLEXIBLE INSULATION (min. R-value of 3.5) AND 225x12mm Nu-Tech FASCIA BOARDS OR SIMILAR APPROVED.  
ALL EXTERNALLY EXPOSED TIMBER TRUSSES AND PURLINS TO BE TREATED WITH CARBOLINUM. HURRICANE CLIPS TO BE USED WHERE PURLINS ATTACH TO TRUSSES.

**WINDOWS, DOORS & GATES:**  
SEE SCHEDULES.

**SOIL POISONING:**

SOIL INSECTICIDE AND HERBICIDE (TO COMPLY WITH SABS 0124) TO BE APPLIED UNDER ALL SURFACE BEDS AND PAVING, IN ACCORDANCE WITH MANUFACTURERS SPECIFICATION.  
BY A LICENSED APPLICATOR AND A CERTIFICATE ISSUED.  
POISONING OF GROUND AGAINST TERMITES: EXTERNAL AND INTERNAL FOUNDATION WALLS, FOUNDATIONS, CONCRETE SURFACE BEDS - CHLORDANE HEPTACHLOR ALDRIN -OR OTHER APPROVED. 25mm RIVERSAND OVER POISON.  
POISONING OF GROUND AGAINST WEEDS: HYVAX X OR SIMILAR APPROVED WEEDKILLER SPRAYED IN ACCORDANCE WITH MANUFACTURERS INSTRUCTIONS AT THE RATE OF 50g/m<sup>2</sup> ON COMPACTED LAYERS OF EARTH FILLING.

**REINFORCED CONCRETE:**

AS PER ENGINEER'S DRAWINGS AND SPECIFICATIONS. ALLOW FOR EXPANSION JOINTS AT 3M INTERVALS IN ALL CONCRETE FLOOR SLABS AS PER STRUCTURAL ENGINEER.

**WATERPROOFING:**

WALLS:  
ONE LAYER OF 375 MICRON "CONSUL PLASTICS" BRICKGRIP DPC EMBOSSED DAMP PROOF COURSE IN WALLS, WINDOWS, ETC.  
UNDER SURFACE BEDS: AS PER ENGINEER.  
FLOORS IN ANY LAUNDRY, KITCHEN, SHOWER, BATHROOM OR ROOM CONTAINING A TOILET PAN OR URINAL, SHALL HAVE A WATER RESISTANT FLOOR WHICH COMPRISES AN IMPERVIOUS MATERIAL LAID ON TOP OF, OR BONDED TO THE FLOORING SYSTEM, WHICH CAN HOLD ANY SURFACE WATER IN ANY WAY UNTIL SUCH TIME THAT THE WATER CAN EVAPORATE, BE DRAINED OR REMOVED, AND CAN ACCOMMODATE ANY MOVEMENT IN THE FLOORING SYSTEM WITHOUT LOSING ITS IMPERMEABLE PROPERTIES. ALL TO COMPLY WITH SANS 10400, PART J.

**WALLS:**

ALL WALLS TO BE OF COROBRIK OPAL SATIN FBS FACE BRICKS (OR SIMILAR APPROVED IN WRITING) WITH 12mm DEEP SQUARE RECESSED HORIZONTAL AND VERTICAL JOINTS WITH CEMENT MORTAR TO MATCH COLOUR OF BRICKWORK. WINDOW CILLS TO BE FACE BRICK ON EDGE WITH HOLES NEATLY FILLED WITH CONCRETE  
AT SIDES, FACE BRICK ROLLER COURSE OVER ALL WINDOWS, DOORS AND OPENINGS.  
BRICK FORCE: EVERY COURSE UP TO FFL AND EVERY 4th COURSE THEREAFTER. EVERY COURSE ABOVE ALL OPENINGS. EVERY 4th COURSE AT GABLES. CAVITY WALLS - 110mm  
BRICK FORCE WITH BUTTERFLIES. ENSURE PROPER OVERLAPS OF BRICK FORCE.

**EXPANSION JOINTS:**

PROVIDE EXPANSION JOINTS AS PER ENGINEER'S SPECIFICATIONS, AND TO COMPLY WITH SANS 10400 PART K.  
STRUCTURAL ENGINEER TO CHECK AND CONFIRM ALL DEMOLITION WORK.  
CONFIRM ALL LANDSCAPING, IRRIGATION, RETAINING WALLS AND PAVING ON SITE WITH CLIENT  
SITE OPERATIONS: CONTRACTOR TO PROVIDE SANITARY FACILITIES IN ACCORDANCE WITH THE DETAILED REQUIREMENTS OF SANS 10400-F, DURING THE CONSTRUCTION PERIOD.

LAY PAVING WITH FALL, 1:100 MIN. AWAY FROM BUILDING  
PROVIDE ALL NECESSARY SLEEVES FOR TELEPHONE, INTERNET AND ALARM CABLES AS PER ELECTRICAL ENGINEERS DRAWINGS AND DETAILS.

**GENERAL**

- This drawing is copyright reserved and remains the property of the architect.
- All work to be executed in strict compliance with SABS 10400
- All dimensions to be checked on the site and any discrepancies to be reported to the Architect immediately before commencing with any work.
- Written dimensions to be used in preference to scaled dimensions.
- Drawings may not be scaled from prints.
- All electrical and drainage work to be executed registered artisans.
- Where required, Architect's drawings to be read in conjunction with Engineer's drawings.
- Where required, Architect's drawings to be read in conjunction with Manufacturer's specification.



**NORTHERN CAPE DEPARTMENT OF EDUCATION**

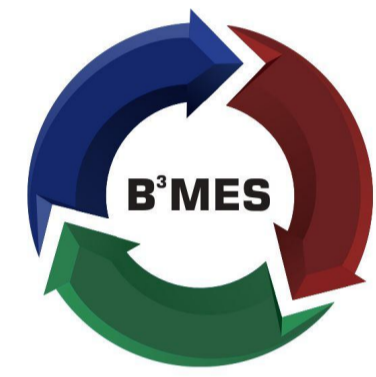

**BBB Mojaki Engineering Solutions**

Rev	Date	By	Description
P1	160117	WF	Issued for information
T1	040712	WF	Issued for TENDER

**Certificate by Competent person**  
This is to certify that the building design contemplated herein complies with the requirements of SANS 10400-XA on SANS 204

Architect: \_\_\_\_\_

Consulting engineer: \_\_\_\_\_

Project:  
**PROPOSED ADDITIONS & ALTERATIONS TO KIMBERLEY BOYS HIGH SCHOOL**

Client:  
**DEPARTMENT OF EDUCATION KIMBERLEY BOYS HIGH SCHOOL**

Address:  
**CORNER OF DALHAM AND MEMORIAL ROADS KIMBERLEY, NORTHERN CAPE**

Drawing title:  
**BLOCK B: GROUND FLOOR & ROOF PLAN**

Scale: **1:100 @ A1** Drawn by: **WF**

Date: **170116** Checked by: **PF**

Project No.: **B1602** Drawing nr.: **L01\_201** Rev nr.: **T1**