



Application for:

1. Environmental Authorisation under the National Environmental Act (Act 107 of 1998);

JULY 2012

Eskom Holdings Limited

APPLICATION FOR ENVIRONMENTAL AUTHORIZATION FOR THE DEVIATION AND RE- ALIGNMENT OF A 400KV POWER LINE

DEA Ref. No.: 14/12/16/3/1/6

1 ROLE PLAYERS

Eskom Holdings Limited (hereinafter referred to as Eskom) intends to deviate and re-align a portion of the existing Arnot Vulcan 400kv power line near the town of Middelburg, Mpumalanga.

This existing power line traverses Portions 14 and 35 of the farm Elandspruit 291 JS, which is currently being mined via open cast methods for coal and clay by Shanduka Coal (Pty) Ltd, sterilizing a portion of the mineral reserves. Mining activities are also occurring on Portion 67, 68 and 69 of the farm Elandspruit 291 JS by Elandspruit Colliery (Pty) Ltd (previously called Misty Seas (Pty) Ltd). Eskom is therefore applying for Environmental Authorization under the National Environmental Management Act (Act 107 of 1998) (NEMA) for the deviation and re-alignment of this 400kV power line so as to allow the various mining operations to access the full extent of their mineable reserves.

The National Department of Environmental Affairs (DEA) is the lead authority for the application. An application was submitted and a reference number has been issued. In addition, an application was made to DEA in terms of Section 20(4) of Government Notice R543 of NEMA for permission to downgrade the application from a full Scoping and Environmental Impact Assessment (EIA) Report to that of a Basic Assessment (BA) Report. The application to downgrade to a BA was granted by DEA on the 09th July 2012 and as such the project will follow the BA process.

PURPOSE OF THIS DOCUMENT

- To identify the role players relevant to the project.
- To give information on the proposed project and related activities.
- To provide an overview of the legislative background.
- To provide an overview of the EIA process.
- To describe the Public Participation Processes and how this fits into the process.
- To assist YOU to register as an Interested & Affected Party (I&AP) to participate in the process.
- To provide the opportunity for feedback from all I&APs.

ACRONYM DEFINITIONS:

BA: Basic Assessment Report

BID: Background Information Document

DEA: Department of Environmental Affairs (National)

EIA: Environmental Impact Assessment

EMP: Environmental Management Plan

I&AP: Interested and Affected Party

NEMA: National Environmental Management Act (NEMA), (Act 107 of 1998) as amended (Act 62 of 2008)

PPP: Public Participation Process

ROD: Record of decision

WHAT IS AN ENVIRONMENTAL AUTHORISATION APPLICATION?

An environmental authorisation application is a structured process as described in NEMA, whereby a company intending to conduct any of the scheduled activities must demonstrate that it adequately understands all the components of the proposed project and associated activities. The applicant must demonstrate that it has the financial resources to develop, operate and close the proposed project and that it adequately understands, and can pay for the mitigation measures needed to minimise or prevent long term impacts to the biophysical and social environment. The application is the initial step in the process which leads into either a Basic Assessment or, a scoping and full Environmental Impact Assessment study.

The reasons for applying to downgrade the application to a BA:

- Several power lines already traverse the area;
- Only Activity 8 of R545 triggers the need for a full scoping and EIA report. In terms of the definitions listed under NEMA for “construction” and “expansion” it can however be argued that this activity may not be applicable, as this application is for the deviation and re-alignment of an existing powerline and therefore could be considered a “modification” or “alteration” in terms of Activity 38 of R544.
- The extent of deviation / re-alignment is minimal (see attached plan).

Cabanga Concepts cc have been contracted as the independent environmental consultants appointed to conduct the necessary studies and oversee the various processes required in accordance with the various Acts listed above.

2 PROJECT DESCRIPTION AND ASSOCIATED ACTIVITIES:

The proposed project is situated within the Steve Tshwete Local Municipality, which falls under the Nkangala District Municipality of the Mpumalanga Province of South Africa. The Power line is located approximately 10 km South West of Middelburg Town and travels across the Middelburg Townlands Extension mining area (Shanduka Coal (Pty) Ltd); and the Elandspruit Colliery mining area (Elandspruit Colliery (Pty) Ltd).

The current position of the 400kV power line traverses these operations and as a result the various mining operations cannot mine the coal within the servitude areas. It is expected that the Life of Mine (LoM) for the various operations could be extended by a number of years should full access to these reserves be obtained.

Three (3) routes for the proposed deviation are being considered as indicated in Plan 1. A meeting has been held with all the landowners in question. The total length of the deviation as per the preferred option (Option A) will be approximately 3 km, traversing over five (5) different farm portions namely, Rietfontein 314 JS Portion 17 and Elandspruit 291 JS Portions 3, 26, 68 and 69.

It is anticipated that the following activities will take place with regards to the power line deviation:

- Construction of access/service roads;
- Construction of pylon foundations;
- Construction of pylons;
- Power supply, including testing and commissioning of the new power line;
- General rehabilitation activities of disturbed sites or surfaces of roads no longer required;
- Dismantling of existing power line; and
- Operation and maintenance of power line.

The operational phase of the project is indefinite and will include continuous maintenance activities of the towers and the associated servitudes.

2.1 Specialist Studies:

The following specialist studies have been identified, as it is anticipated that the proposed project could/will potentially impact on these aspects of the environment:

- Visual Assessment;
- Heritage and Archaeological Assessment as required by the SAHRA;
- Ecological Assessment (Special Focus on Avifauna); and
- Wetland Assessment.

3 ENVIRONMENTAL AUTHORISATIONS

3.1 National Environmental Management Act (NEMA):

As some of the proposed infrastructure and processes for site are deemed to be listed activities in terms of NEMA, an application for environmental authorisation is required.

The following listed activities may occur on site, and form part of the application:

- R.544, Activity 22: Construction of a road outside urban areas where no reserve exists, where the road is wider than 8m.
- R.544, Activity 38: The alteration of the route of an existing 400kV power line (diversion and re-alignment).
- R.545, Activity 8: The re-alignment of the 400kV power line.
- R.546, Activity 4: The construction of a road wider than 4 meters within a sensitive area.
- R.546, Activity 12: The removal of vegetation during the construction phase. This area falls within the grassland ecosystem.
- R.546, Activity 14: The clearance of 5ha or more of vegetation where 75% or more of the vegetation is indigenous within a sensitive area.

Activities listed in terms of Regulations 544 and 546 are subject to a Basic Assessment Report process, whilst those listed under Regulation 545 are subject to a Scoping and EIA process. Thus, activity No. 8 of R.545 would normally require that this application be subject to a Scoping and EIA report. However, as mentioned in the introduction the applicant has received permission to apply the BA process to this application. The BA will be accompanied by an Environmental Management Plan (EMP).

4 PUBLIC PARTICIPATION PROCESS (PPP)

This BID is the initial stage of the public participation process (PPP).

Public involvement is an essential component of the process. It addresses the right of Interested and Affected Parties (I&APs) to be informed of the proposed activities and to be involved in decisions that affect them. It also affords the environmental practitioner the opportunity to assess and address the issues and concerns raised by I&APs thus allowing us to assess all the potential impacts of the proposed project.

4.1 How do YOU register to be involved in the process

We encourage you to review the information presented to you in this background information document (BID) and to register as an I&AP for the

Basic Assessment Process:

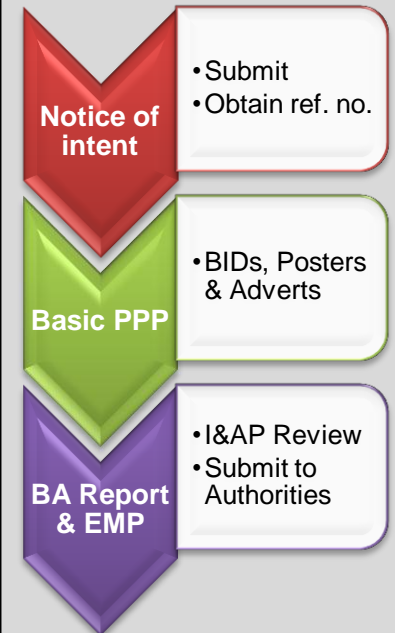

Scoping &EIA/EMP process:

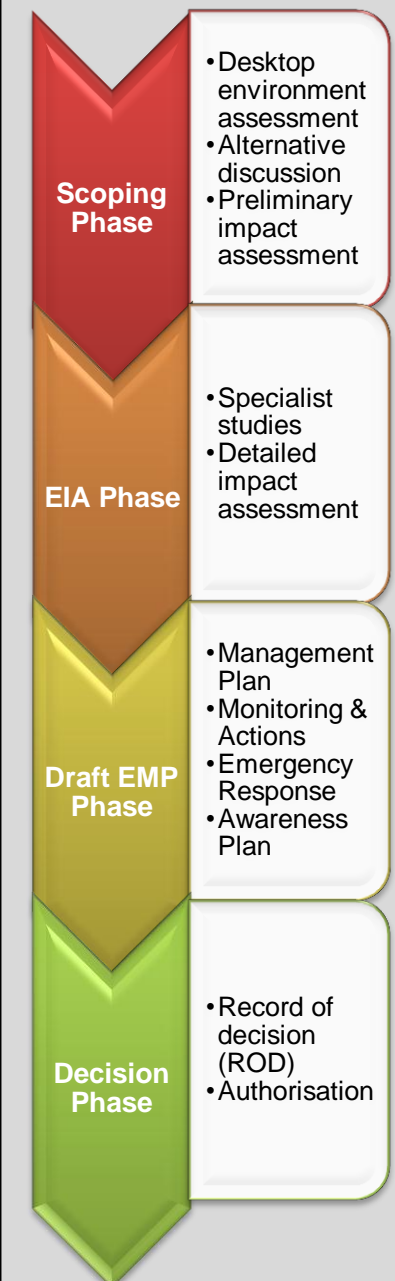

WHO ARE I&APS?

I&APs are people who will be directly or indirectly affected by, or have any interest in, the project.

I&AP participation in relation to the BA process:

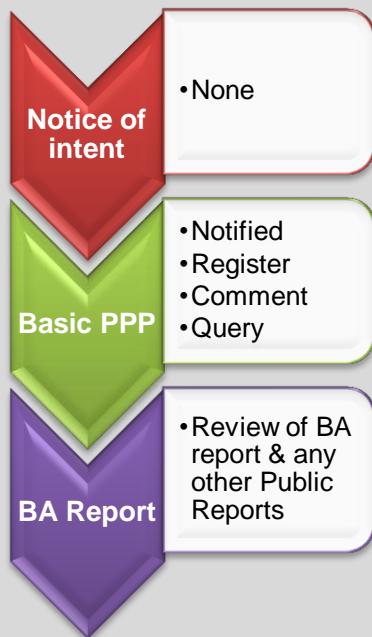

I&AP participation in relation to the Scoping/EIA process:



project. Anyone who has a direct stake or anyone who has interest in the project can register as an I&AP.

YOU CAN REGISTER BY:

- Completing the attached response sheet and returning it to us on or before the **27th August 2012.**
- By contacting us and registering your name, contact details, postal address, email address or facsimile to ensure any documents can be delivered to you.
- By responding to newspaper adverts or posters and contacting us directly with your details.
- By submitting your comments on any of the reports generated through the authorisation processes to us.

4.2 YOUR Involvement Phase

Kindly, complete the attached questionnaire and return this to the address / fax number indicated above. The purpose of this questionnaire is to register you as an I&AP and to highlight any environmental or socio-economic impacts you may be aware of / concerned about in order that these be sufficiently addressed.

Please contact us should you know of any other person / organisations that could potentially be affected, or that would benefit from participating in the PPP.

The relevant environmental reports will be made available for public review. All registered I&APs will be notified of the reports' availability. Any comments / concerns forthcoming will be consolidated into the PPP report and submitted to the various authorities along with the environmental reports. For this reason we request that you complete the attached registration form, and highlight any potential impacts you believe may be of importance.

Should you require further information or have any comments / responses with regards to this project, please do not hesitate to contact us.

4.3 Public Meeting

In addition, you are hereby invited to attend a public meeting for the power line deviation project. Members of Eskom, Cabanga Concepts as well as Shanduka Coal will be available to meet with the public and discuss any queries and/or concerns.

The purpose of the meeting will be to introduce the proposed project and application process to the public and to ensure that all potential impacts are adequately identified and assessed during the authorisation process.

MEETING DATE: 16th August 2012

TIME: 11:00am

VENUE: BusMid Building, Chamber of Commerce, R555 (Walter Sisulu Rd), Middelburg, Mpumalanga

Please RSVP on or before 10th August 2012.

4.4 Our Contact Details:

Ian Troskie

Tel: (011) 794 7534

Fax: (011) 794 6946

E-mail: ian@cabangaconcepts.co.za

Post: Postnet Suite 470

Private Bag X3

Northriding , 2162

JULIE 2012

Eskom Beperk

AANSOEK OMTRENT OMGEWINGS MAGTIGING VIR DIE AFWYKING EN HERLINERING VAN 'N 400KW KRAGLYN

DOS Verwysings. No.: 14/12/16/3/1/6

1 ROLSPELERS

Eskom Beperk (wat hierna as Eskom verwys) is van plan om 'n gedeelte van die reeds bestaande Arnot Vulcan 400kW Kraglyn te afwyk en herlineer, wat naby die dorp van Middelburg op Mpumalanga geleë is.

Die reeds bestaande Kraglyn kruis Erfdele 14 en 35 van die Plaas Elandspruit 291 JS, waar daar huidiglik aan steenkool en klei gemyn word deur middle van oopgroef metodes. Die word deur Shanduka Steenkool (Edms) Bpk onderneem, waardeur 'n porsie van die minerale reserwes gesteriliseer word. Mynbou aktiwiteite is ook voorkomend op Erfdele 67, 68 en 69 van die plaas Elandspruit 291 JS geleë by Elandspruit Steenkoolmyn (Edms) Bpk (voorheen bekend as Misty Seas (Edms) Bpk). Daarom doen Eskom aansoek rondom Omgewings Magtiging onder die Nasionale Omgewing Beheers Wet (Wet 107 van 1998) (bekend as "NEMA") vir die afwyking en herlinering van die 400kW kraglyn so ver as om dit vir verskillende mynbou bewerkings moontlik te maak om volle toegang tot hul mynbare reserwes te kry.

Die Nasionale Departement van Omgewings Sake (DOS) is die Vooraanstaande Mandaat vir die aansoek. 'n aansoek was ingedien en verwysings was al reeds uitgereik. Boonop was daar 'n aansoek aan DOS gemaak in terme van wetsartikel 20(4) van die Staats Kennis R543 van NEMA omtrent toestemming om die degradering van die aansoek vanaf 'n volledige onderneming van groot omvangs en Omgewings Impak Evalueerings (OIE) na die van 'n Basiese Evalueerings (BE) Verslag. Die aansoek omtrent die degradering na 'n BE verslag was deur DOS toegestaan op 9 Julie 2012 en dus sal die projek die BE proses aanpak en volg.

Die volgende is as redes uiteengesit omtrent die aanwending om die aansoek na 'n BE te degradeer:

- Verskeie Kraglyne deurskry alreeds deur die area ;
- Slegs aktiwiteit 8 van R545 loods die noodsaaklikheid vir 'n volledige onderneming van groot omvangs en Omgewings Impak Evalueerings (OIE) verslag. In terme van die definisies wat onder NEMA gelys word vir "konstruksie" en "uitbreiding" alhoewel dit geredeneer kan word dat die aktiwiteit nie van toepassing mag wees nie. Aangesien die aansoek vir afwyking en herlinering van 'n reeds bestaande Kraglyn van toepassing is. En juis daarom kan dit as 'n "modifikasie" of "verandering" in terme van Aktiwiteit 38 van R544.
- Die omvang van afwyking/herlinering is minimaal (sien asseblief die aangehegte plan).

Cabanga Konsepte BK is gekontrakteur as die onafhanklike omgewings konsultante aangestel om die nodige studies uit te voer en om toesig te hê oor die verskeie prosesse wat vereis word in ooreenstemming met die verskillende Wette wat bo gelys word.

2 PROJEK BESKRYWING EN GEASSOSIEERDE AKTIVITEITE

Die voorgestelde projek is geleë binne in die Steve Tshwete Plaaslike Munisipaliteit, wat onder die Nkangala Distriks Munisipaliteit val, in die Mpumalana Privinsie van Suid-Afrika. Die Kraglyn is geleë ongeveer 10 km Suid Wes vanaf die Middelburg se dorp en beweeg oor die Middelburgse Dorpsgebeids Mynbou Uitbreidings area (Shanduka Steenkool (Edms) Bpk) en die Elandspruit Steenkool Mynbou area (Elandspruit Steenkoolmyn (Edms) Bpk).

Die huidige posisie van die 400kW kraglyn kruis die bogenoemde myn bedrywighede as gevolg daarvan kan die Myn bedrywighede nie die steenkool myn wat binne-in die serwituut area val nie.

Dit word verwag dat die Lewe van Myn (LvM) vir die verskillende bedrywighede verleng kan word, met die aantal jare sou volle toegang tot die reserves verkry word.

Daar is drie (3) roetes vir die voorgestelde afwyking, gevolg deur 'n vergadering saam met al die grondeienaars te sprake. Die totale lengte van die afwyking soos per Opsie A aangedui sal ongeveer 3km wees. Beide roete opsies sal oor vyf (5) verskillende Plaas erfdele kruis, naamlik: Rietfontein 314 JS Erfdeel 17 en Elandspruit 291 JS Erfdele 3, 26, 68 en 69.

Daar word voorsien dat die volgende aktiwiteite sal plaasvind met betrekking tot die kraglyn afwyking:

- Konstruksie van toegangs/diens paaie;
- Konstruksie van kragmas fondasies;
- Konstruksie van kragmaste;
- Krag voorsiening , insluitende die toetsing en kommisering van die nuwe kraglyn;
- Algemene rehabilitasie aktiwiteite van gesteurde terreine of Pad oppervlaktes wat nie meer benodig word nie.
- Ontmanteling van die bestaande kraglyn ;
- Bewerking en instandhouding van die kraglyn.

Die operasionele fase van die projek is onbepaald en sal aanhoudende instandhoudings aktiwiteite van die kragmaste en die geassosieerde serwitute insluit.

2.1 Gespesialiseerde Studies:

Die volgende gespesialiseerde studies is geïdentifiseer, as gevolg dat daar voorsien was dat die voorgestelde projek 'n potensiale impak op die volgende aspekte van die omgewing kan/sal hê:

- Visuele Evaluering
- Erfenis en Argeologiese Evaluering wat deur SAHRA vereis word
- Ekologiese Evaluering (Met spesiale fokus op fauna) ; en
- Vleiland Evaluering

3 OMGEWINGS MAGTIGING

3.1 Nasionale Omgewings Magtigings Wet (NEMA):

Annagesien daar van die voorgestelde infrastrukture en prosesse vir die terein beskou gaan word as gelysde aktiwiteite in terme van NEMA, word 'n aansoek omtrent omgewings magtiging steeds vereis.

Die volgende word gelys as aktiwiteit wat op die terrein mag voorkom, en vorm ook deel van die aansoek:

- R.544, Aktiwiteit 22: Die konstruksie van 'n pad buite stadsgebiede waar daar geen reserve uitgange bestaan nie, waar die pad van meer as 'n wydte van 8m bestaan.
- R.544, Aktiwiteit 38: Die afwisseling van 'n roete van 'n reeds bestaande 400kW kraglyn (afleiding en herlinering).
- R.545, Aktiwiteit 8: Die herlinering van die 400kW kraglyn.
- R.546, Aktiwiteit 4: Die konstruksie van 'n pad met 'n wydte van meer as 4 meter met binne- in 'n sensitiewe area.
- R.546, Aktiwiteit 12: Die verwydering van plantgroei gedurende die konstruksie fase. Die area val binne-in die weiveld se ekosisteem.
- R.546, Aktiwiteit 14: Die verwydering van plantgroei van 5ha of meer waar 75% of meer uit inheemse plantegroei bestaan met binne-in 'n sensitiewe area.

Gelysde aktiwiteite in terme van Regulasies 544 en 546 is subjektief aan 'n Basiese Evaluering Verslags proses , terwyl die wat onder 545 gelys word is subjektief aan 'n omvangs en OIE proses . Juis aktiwiteit 8 van R545 sal normaal wegs vereis dat die aansoek aan 'n omvangs en Omgewings Impak Evaluering (OIE) verslag subjektief word. Nogtans, soos voorheen genoem in die inleiding, die applikant het toestemming ontvang om aansoek omtrent 'n Basiese Evaluering (BE) Verslag. Die BE sal vergesel word met 'n Omgewings Beheer Plan (OBP)

4 PUBLIEKE DELNEMINGSPROSES (PDP)

Hierdie Agtergrondse Inligtings dokument (AID) is die aanvangs stadium vir die publieke deelnemings proses (PDP).

Publieke betrokkenheid is 'n essensiële komponent van die proses. Dit spreek die regte van Belangstellende en Aanstelleriger Partye (B&Aps) om ingelig te word rondom die voorgestelde aktiwiteite en om in besluite betrokke te raak wat hulle mag affekteer. Dit gee die Omgewings Praktisyn die geleentheid vir evaluering en om die geskilpunte en kommernisse wat deur die B&Aps beswaar is aan te spreek. Juis laat dit vir ons toe om al die potensiale impakte op die voorgestelde projek te evalueer.

4.1 Hoe registreer U omtrent u betrokkenheid in die proses?

Ons wil u aanmoedig om die inligting wat aan u voorgestel is in hierdie agtergrondse inligtings dokument (AID) te hersien en as 'n B&Aps te registreer vir die projek. Enigeen wat 'n direkte inset besit of enigeen wat 'n belangstelling in die projek het kan as 'n B&Aps registreer.

U KAN REGISTREER DEUR:

- Voltooiing van die aangehegte Terugvoeringsvorm en dit na ons toe terug stuur voor maar nie later as **27^{de} Augustus 2012**.
- Om met ons direk in kontak te tree en u naam, kontak gegewens, Pos Adres, epos adres of faksimilee om te verseker enige dokumente kan na u afgelewer word.
- Deur middel van beantwoording gerig aan koerant advertensies of plakkate en om direk met ons in kontak te tree met u gegewens.
- Deur middel van u kommentaar, indiening op enige van die verslae wat deur die magtigings proses na ons toe gegeneer word.

4.2 U Betrokkenheid fase

Daar word asseblief vriendelik van u versoek om die aangehegte vraelys te voltooi en terug te stuur na die adres/bogenoemde faks nommer. Die doel van die vraelys is vir u om as 'n B&Aps te registreer en om enige omgewings of sosio-ekonomiese impakte waarvan u betrokke / kommernisse uit te lig en beklemtoon sodat die voldoende aangespreek kan word.

Tree asseblief met ons in kontak indien u van enige ander persone / organisasies wat moontlik geaffekteer kan word, of wat sal bevoordeel en daarvan baat deur middel van deelneming in die PDP.

Die relevante omgewings verslae sal vir publieke hersiening. Alle geregistreerde B&Aps sal in kennis gestel word. Enige naderende kommentaar / kommernisse sal gekonsolideer word in die publieke deelnemings proses (PDP) verslag en sal aan die verskeie Owerhede ingedien word met die omgewings verslae.

Vir die rede versoek ons asseblief dat u die aangehegte registrasie vorm voltooi, en enige moontlike impakte u mag glo wat van belang mag wees uit te lig en te beklemtoon.

Indien u verdere inligting verlang of daar enige kommentaar / terugvoering met betrekking tot hierdie projek; moet asseblief nie huiwer om met ons direk in kontak te tree nie.

4.3 Publieke Veragdering

U word addisioneel uitgenooi om 'n Openbare veragdering by te woon vir die lyn afwykings projek. Lede van Eskom Cabanga Konsepte sowel as Shanduka Steenkool sal beskikbaar wees om met die publiek te ontmoet en enige navrae e/of kommernisse te bespreek .

Die doel van hierdie vergadering is om die voorgestelde projek en aansoek proses aan die publiek voor te stel en te verseker dat alle potensiale impakte doeltreffend geïdentifiseer en evalueer word gedurende die magtigings proses .

VERGADERINGS DATUM: 16^{de} Augustus 2012

TYD: 11:00am

VERGADERPLEK: BusMid Building, Chamber of Commerce, R555 (Walter Sisulu Rd), Middelburg, Mpumalanga

RSVP/a.asb VVOR MAAR NIE LATER AS 10^{de} Augustus 2012.

Eskom Holdings Limited

Application for a 400kV Power Line Deviation: RESPONSE SHEET

Please assist us by filling this response sheet and returning it by fax, to (011) 794 6946

Question 1: Personal Information

Name and Surname	
Farm Name/Organisation	

Question 2: To what extent has the background information document met your expectations?

Please tick (✓) one (1) of the following:

Completely	<input type="checkbox"/>
Satisfactory	<input type="checkbox"/>
Partly	<input type="checkbox"/>
Not at all	<input type="checkbox"/>

If your expectations have not been met, please indicate why?

Question 3: Has the background information document provided you with sufficient information about the project?

Please tick (✓) one (1) of the following:

Completely	<input type="checkbox"/>
Satisfactory	<input type="checkbox"/>
Partly	<input type="checkbox"/>
Not at all	<input type="checkbox"/>

If your expectations have not been met, please indicate why?

Insufficient information provided	<input type="checkbox"/>
Information provided was too technical	<input type="checkbox"/>

Question 4: Please specify what aspects of the project you are interested in.

Please tick (✓) one (1) of the following:

All aspects	<input type="checkbox"/>	Employment opportunities	<input type="checkbox"/>
Eco-tourism	<input type="checkbox"/>	Business opportunities	<input type="checkbox"/>
Air pollution, noise, dust visual pollution	<input type="checkbox"/>	Local economic development	<input type="checkbox"/>
Ground and/or surface water pollution	<input type="checkbox"/>	Mine closure and rehabilitation	<input type="checkbox"/>
Natural habitat: land and animal Life	<input type="checkbox"/>	Future of your town	<input type="checkbox"/>
Health, safety and security	<input type="checkbox"/>	Please specify the town:	<input type="text"/>
Other (please specify)	<input type="text"/>		

Question 5: Are you aware of any of the following with regards to the proposed project (please specify details below):

Please tick (✓) which is applicable and detail below (if need be please attached separate page):

Potential Physical Impacts	<input type="checkbox"/>
Potential Social Impacts	<input type="checkbox"/>
Potential sites of cultural significance (potential heritage sites, graves etc.)	<input type="checkbox"/>
Rare or endangered animals and / or plants	<input type="checkbox"/>

Question 6: Are there any other questions or concerns that you have about the project?

[Kindly specify below and the project team will respond to these in due course]

Question 7: Are there any other parties or organisations that you think should know about the project?

Question 8: Do you want to be kept informed about the future stages of this study and remain registered as an I&AP?

Please tick (✓) one (1) of the following:

No thank you!	<input type="checkbox"/>
Yes please!	<input type="checkbox"/>

Tel:	<input type="text"/>
Fax:	<input type="text"/>
Cell:	<input type="text"/>
Email:	<input type="text"/>
Postal Address:	<input type="text"/>

Plan 1: Route Options

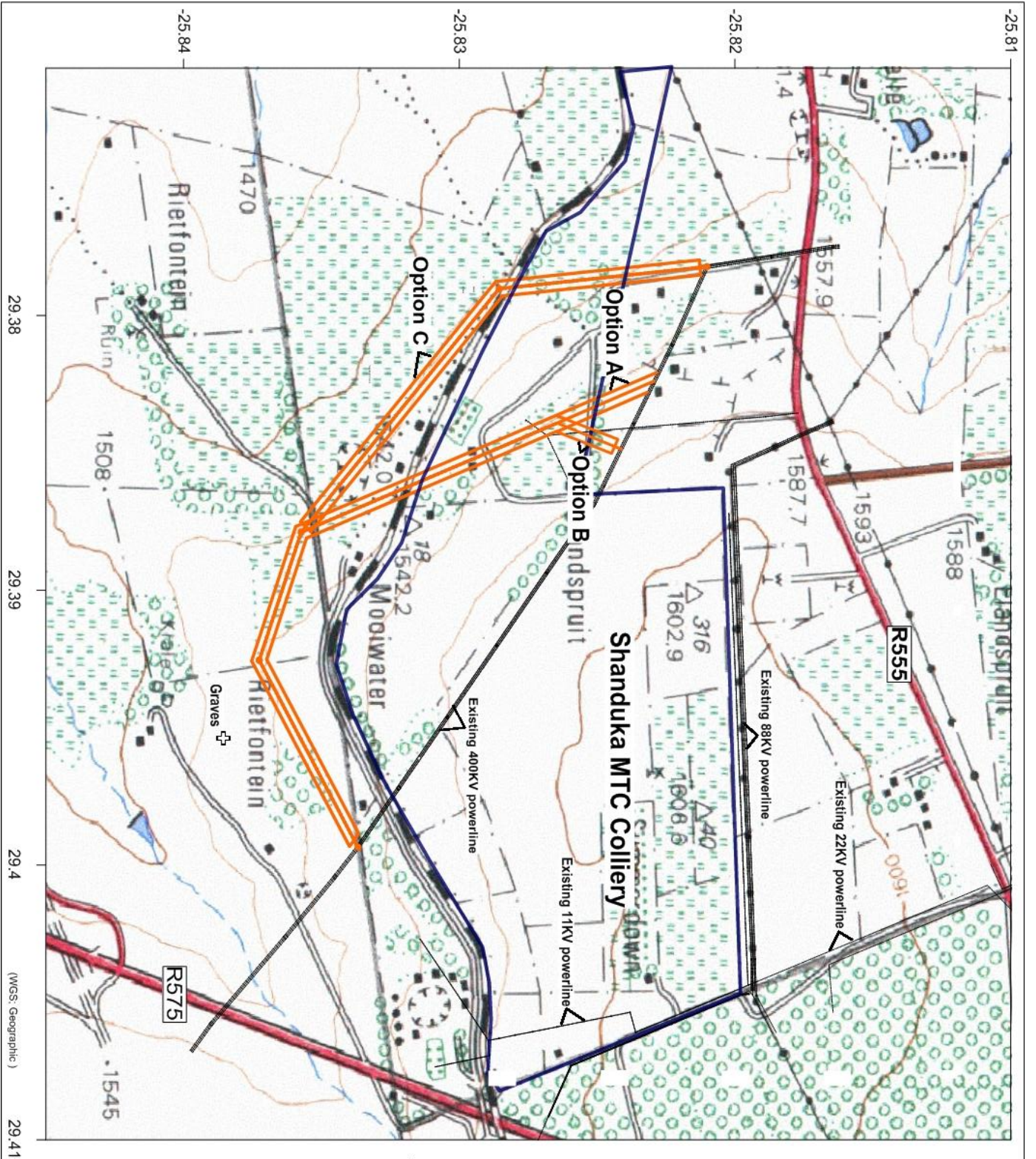

<p>LEGEND</p> <ul style="list-style-type: none"> Contours Non-Perennial Rivers Main Roads Dirt Roads Farm Roads Railway Lines MTC Extension Mining Boundary Existing Powerlines Powerline Deviation Options Graveyard 	<p>Coordinates (DDMM): 25° 49.880'S 29° 23.160'E</p> <p>TITLE: Deviation Options</p> <p>DRAWN BY: Michael Barnes Environmental Consultant</p> <p>DATE: July 2012</p> <p>CLIENT: Eskom</p> <p>PROJECT: Proposed Arnot-Vulcan 400KV Powerline Deviation</p> <p>LOCATION: Middelburg, Mpuimalanga</p> <p>SCALE: 0 250 500 750 (m)</p> <p>MAP: Topographic 1:50000; 2529CD</p>	<p>6 Beyers Office Park Tel: +27(0)11 794 7534 Bosbok Road Fax: +27(0)11 794 6946 Randparkridge Email: Jane@cabangaconcepts.co.za</p> <p>CABANGA concepts We plant the seed!</p>
--	---	---