

# BACKGROUND INFORMATION DOCUMENT

PROPOSED COAL MINING PERMIT TOGETHER WITH THE APPLICATION FOR ENVIRONMENTAL AUTHORIZATION FOR THE PROPOSED **PORTION OF THE REMAIN EXTENT OF THE FARM WINKEL 431 IS**, SITUATED IN THE MAGISTERIAL DISTRICT OF ERMELO. DRME REF: **MP30/5/1/1/3/12667 MP**

**Prepared by: Geo-Aspex (Pty) Ltd**

**Prepared for: Maverick Trading 919 CC**

**Geo-Aspex (Pty) Ltd** has been appointed as an independent Environmental Consultant by **Maverick Trading 919 CC** to conduct Environmental Impact Assessment (EIA), Compile an Environmental Management Plan (EMP) and undertake Public Participation Process (PPP). This is done for processes of acquiring environmental authorization for the proposed Mining Permit application within the **Portion of the Remain Extent of the Farm Winkel 431 IS**, Situated in the magisterial district of Ermelo, Mpumalanga Province.

## PURPOSE OF THIS BACKGROUND INFORMATION DOCUMENT

The Purpose of this Background Information Document (BID) is to provide a perfunctory description of the project and outline EIA processes to be followed and contributions from Interested and Affected Parties (IAPs) on the issues related to the project in question, allowing comments and concerns to be raised.

Results of the EIA, both negative and positive will be submitted and made available to the relevant Departments such as the Department of Mineral Resources and if requested, Environmental Affairs, Water and Sanitation, Landowners and other interested stakeholders.

This Background Information Document therefore requests and invites IAPs to comment on the environmental, physical, social and economic impacts associated with the proposed Mining Activities. Be assured that your comments are of great value as they ensure that relevant issues are taken into consideration. Attached at the end of this document is a registration form, kindly complete it and send it back to Livhuwani Sigwadi through given means of communication.

## PROJECT DESCRIPTION

Mining activities will be undertaken over a period of two (2) years. This project will entail an open cast method of excavation. The mine design will be developed according to the dimension of the mineral applied deposit within the project area, but overall mining activities will be limited to an area of 5 Ha as per mining permit requirements. The top soil will be stockpiled elsewhere on site preferably next to the permit boundary and will be used during rehabilitation period. Once a box cut has been made, the overburden and mineral resources where necessary will be loosened by blasting. The loosened material will then be loaded onto trucks by excavators. A haul road will be situated at the side of the pit, forming a ramp up which trucks can drive, carrying ore and waste rock. Waste rock will be piled up at the surface, near the edge of the open pit (waste dump). The waste dump will be tiered and stepped, to minimize degradation. All the activities will be guided by the project's EMP such that the project does not impact the environment negatively.

## REGULATORY FRAMEWORK

Therefore, EIA process to be undertaken will be conducted in accordance with the National Environmental Management Act (Act 38 of 1998) and Environmental Impact Assessment regulations as amended (April 2017).

The activity is to extract the existence and occurrence of **Coal** therefore; this will be conducted in accordance with Mineral and Petroleum Resources Development Act, (Act 28 of 2002). Other regulatory guidelines to be followed include: National Water Act, 1998 (Act

36 of 1998), National Air Quality Standards (GN 1210: 2009) and National Dust Control Regulations (GN 275: 2017).

### **BASIC AND ENVIRONMENTAL IMPACT ASSESSMENT PROCESSES**

These are planning and decision-making tools used in identifying potential environmental, economic and social consequences of a proposed activity prior the commencement of the activity.

These together with the public issues and concerns are to be identified sufficiently early so that they can be assessed and incorporated into the final reports when/if necessary.

These tools are regarded crucial because they are utilized in order to demonstrate to the relevant stakeholders about the potential impacts, which in turn leads to the Mining application process being a success or declined.

### **PUBLIC PARTICIPATION PROCESS**

Public Participation remains a cornerstone of the Environmental Impact Assessment process. It ensures provision of relevant and enough information with openness and transparency. Public Participation process presents to IAPs, an opportunity to understand what the project is about, and affords them an opportunity to make valuable contributions towards the EIA process.

IAP can be any person, group of persons or organization interested in or affected by the proposed activity, and any organ of state that may have jurisdiction over any aspect of the activity.

The key objective of PPP during the Scoping phase is to afford the IAPs with an opportunity to comment and provide valuable inputs during the planning phase of the project.

For this specific proposed project, IAPs will be given a period of 30 days to comment and raise issues/concerns with regards to this BID.

Kindly keep the following dates:

- ❖ Stakeholder engagement and consultation: **16 July 2021 - 15 August 2021**
- ❖ Review of Draft Basic Assessment Report: **16 August 2021– 14 September 2021**
- ❖ Submission of the Final EMPr: **17 September 2021**

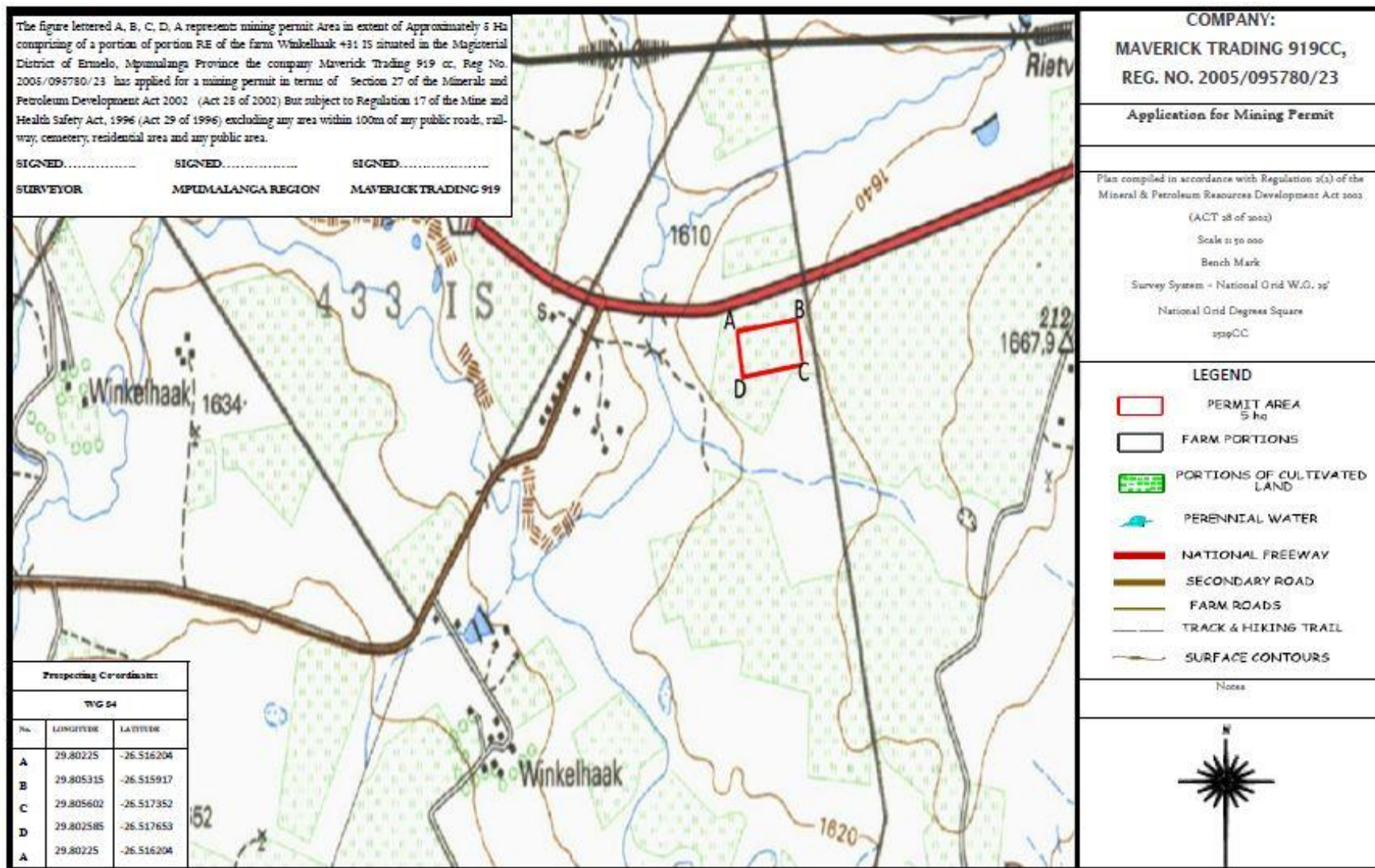

Figure 1: Map that shows the location of the proposed area

PROPOSED COAL MINING PERMIT TOGETHER WITH THE APPLICATION FOR ENVIRONMENTAL AUTHORIZATION FOR THE PROPOSED PORTION OF THE REMAIN EXTENT OF THE FARM WINKEL 431 IS, SITUATED IN THE MAGISTERIAL DISTRICT OF ERMELO. DRME REF: MP30/5/1/1/3/12667 MP

**I&APs REGISTRATION & COMMENT SHEET**

Attention: **Livhuwani Sigwadi**

Email: [livhuwani@geoaspex.co.za](mailto:livhuwani@geoaspex.co.za)

Cell: **076 6529 062**

Name				Surname			
Company							
Position							
Address							
Tel No.				Fax No.			
E-mail				Cell No.			
Method preferred for further communication:				Email	Postal	or	Fax
<b>Indicate your interest in the above-mentioned project</b>							
<b>Provide your comments here:</b>							
<b>Provide your questions here:</b>							
<b>Add any person you think may be interested and affected parties:</b>							
Full names							
Address							
E-mail							
Contact No.							