

BACKGROUND INFORMATION DOCUMENT

Application:

PROSPECTING RIGHT APPLICATION FOR COAL ON REMAINING EXTENT OF THE FARM ZOETFONTEIN 94 HT AND PORTIONS OF THE REMAINING EXTENT OF THE FARM GOEDGEVONDEN 95 HT.

Prepared by:



Prepared for:

**M AND N
COLLIERY**

Magisterial District: **Dr Pixley kaSeme**

INTRODUCTION AND THE PURPOSE OF THIS DOCUMENT

Singo Consulting (Pty) Ltd has been appointed as an independent Environmental Consultant by **M and N Colliery** to conduct Environmental Impact Assessment (EIA), compile Environmental Management Programme report (EMPr) and undertake Public Participation Process (PPP). This is done for processes of acquiring Environmental Authorization for the proposed Prospecting Right Application within Remaining Extent of the Farm Zoetfontein 94 HT and portion of the Remaining Extent of the Farm Goedgevonden 95 HT situated in the Magisterial District of Dr Pixley Ka Seme in the Mpumalanga Province. The Department of Mineral Resources and Energy (DMRE) reference for this project is: **MP 30/5/1/1/2/17718 PR**.

The Purpose of this Background Information Document (BID) is to provide a perfunctory description of the project and outline EIA processes to be followed and contributions from Interested and Affected Parties (I&APs) on the issues related to the project in question, allowing comments and concerns to be raised. Results of the EIA through a BAR & EMPr, both negative and positive will be submitted and made available to the relevant Departments such as the Department of Mineral Resources and Energy and if requested, Environmental Affairs, Water and Sanitation, Landowners and other interested stakeholders.

This BID requests and invites I&APs to comment on the environmental, physical, social and economic impacts associated with the proposed Prospecting Right activities. Be assured that your comments are of great value as they ensure that relevant issues are taken into consideration. Attached at the end of this document is a registration form, kindly complete it and send it back to **Ms Sithokozile Gcabashe** through given means of communication also attached there.

PROJECT DESCRIPTION

M AND N COLLIERY has lodged for a Prospecting Right for Coal mineral that may exist within the application area, in terms of the Mineral and Petroleum Resources Development Act, 2002 (Act 28 of 2002, as amended) (MPRDA). The application area is located approximately 17.8 km North-East of Wakkerstroom of South Africa and it covers an area of approximately 1 278.28 ha in extent

Prospecting activities will be undertaken over a period of five (5) years and are designed in phases, each phase conditional on the success of the previous phase. Both invasive and non-invasive methods will be implemented. Desktop study of the area has commenced, and this incorporates desktop geographical and geological mapping. This will be followed by detailed geochemical and geotechnical surveys. In turn, this is followed by detailed geophysical studies and later, a detailed drilling, sampling, assaying and mineralogical study. Diamond core drilling methods will be utilised to prospect in situ ore deposits. To ensure or minimise impacts on the receiving environment, All the activities will be guided by the project's EMPr.

REGULATORY FRAMEWORK

Therefore, EIA process to be undertaken will be conducted in accordance with the National Environmental Management Act (Act 107 of 1998) and Environmental Impact Assessment regulations as amended (April 2017).

The activity is to extract the existence and occurrence of the applied minerals; therefore, this will be conducted in accordance with Mineral and Petroleum Resources Development Act, (Act 28 of 2002). Other regulatory guidelines to be followed include National Water Act, 1998 (Act 36 of 1998), National Air Quality Standards (GN 1210: 2009) and National Dust Control Regulations (GN 827: 2013).

All the mentioned acts and guidelines will accurately be followed to ensure that identified impacts are assessed and mitigated according to their significance so that the protection of the receiving environment and populations is met.

Figure 1: Regulation 2.2 map and Locality of the proposed project area

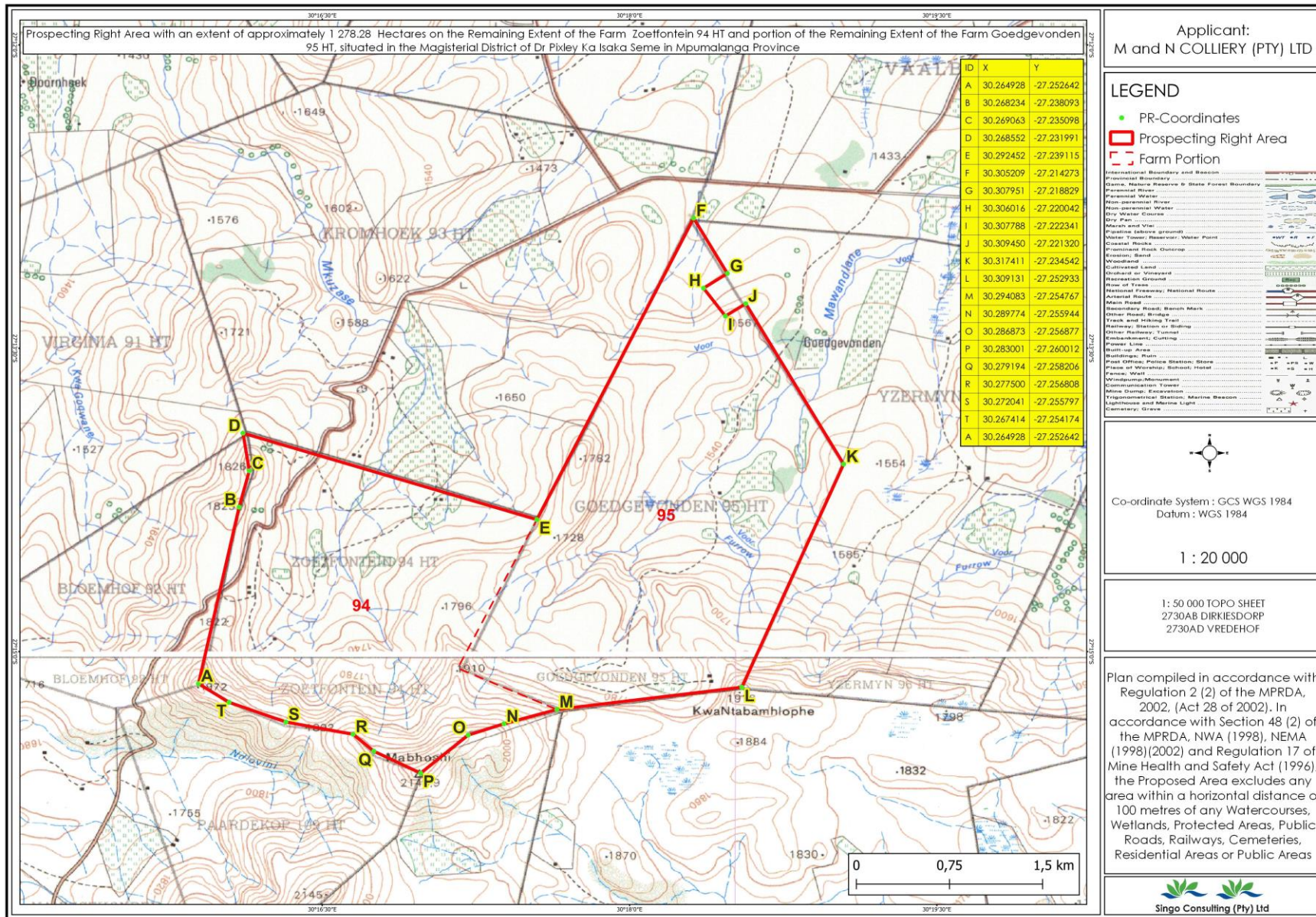

Locality Map

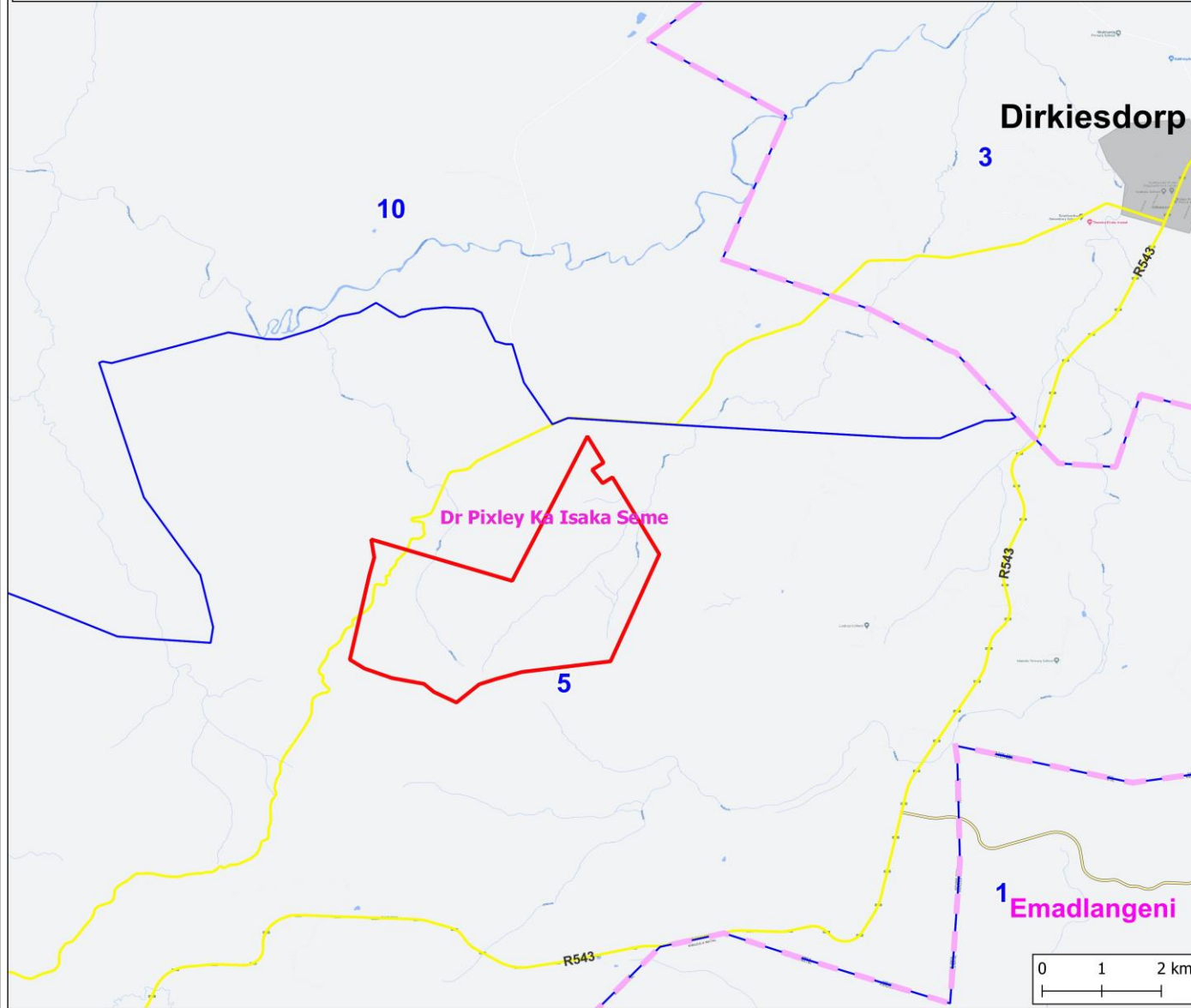

Applicant:
M and N COLLIERY (PTY) LTD

LEGEND

- Prospecting Right Area
- Secondary Road
- Tertiary Road
- Residential Area/Town
- Ward
- Local Municipality



Co-ordinate System : GCS WGS 1984
Datum : WGS 1984

1 : 50 000

Project Location

Prospecting Right Area on the Remaining Extent of the Farm Zoetfontein 94 HT and portion of the Remaining Extent of the Farm Goedgevonden 95 HT, situated in the Magisterial District of Dr Pixley Ka Isaka Seme in Mpumalanga Province



Figure 2: Google Earth image of the proposed project area



Image © 2022 Maxar Technologies

BASIC AND ENVIRONMENTAL IMPACT ASSESSMENT PROCESSES

These are planning and decision-making tools used in identifying potential environmental, economic and social consequences of a proposed activity prior the commencement of the activity.

These together with the public issues and concerns are to be identified sufficiently early so that they can be assessed and incorporated into the final reports when/if necessary.

These tools are regarded crucial because they are utilized in order to demonstrate to the relevant stakeholders about the potential impacts, which in turn leads to the Prospecting Right Application process being a success or declined.

PUBLIC PARTICIPATION PROCESS

Public Participation remains a cornerstone of the EIA process. It ensures provision of relevant and enough information with openness and transparency. PPP presents to I&APs, an opportunity to understand what the project is about, and affords them an opportunity to make valuable contributions towards the EIA Process

I&AP can be any person, group of persons or organization interested in or affected by the proposed activity, and any organ of state that may have jurisdiction over any aspect of the activity.

The key objective of PPP during the EIA Process is to afford the I&APs with an opportunity to comment and provide valuable inputs during the planning phase of the project.

For this specific proposed project, I&APs will be given a period of 30 days to comment and raise issues/concerns with regards to this project.

Kindly keep the following dates:

Announcement of the project:

2nd of December 2022

Review of Draft BAR & EMPr:

24th of January 2023- 22nd of February 2023

Note that you have until the 22nd of February 2023 to submit your comments to Ms Sithokozile Gcabashe using the details on the comment sheet.



Office No: 870, 5 Balalaika Street,
Tasbet Park Ext 2, Witbank, 1040
Cell: +27 82 577 6395
Tel: +27 13 692 0041
Fax: +27 86 5144 103
Email: sithokozile@singoconsulting.co.za
: admin@singoconsulting.co.za

REGISTRATION & COMMENT SHEET

DMRE REF: MP 30/5/1/1/2/17718 PR.

Attention: Ms Sithokozile Gcabashe

Email: sithokozile@singoconsulting.co.za

| | | | | |
|---|-------------|----------------|--------------------------------|----------------------------------|
| Title | Name | Surname | | |
| Company | | | | |
| Designation | | | | |
| Address | | | | |
| Tel No. | | | Fax No. | |
| E-mail | | | Cell No. | |
| I would like to receive my notifications be (mark with "X"): | | | Post <input type="checkbox"/> | E-mail: <input type="checkbox"/> |
| | | | Phone <input type="checkbox"/> | Fax: <input type="checkbox"/> |
| Please indicate why you would have an interest in the above-mentioned project. | | | | |
| | | | | |
| | | | | |
| | | | | |
| | | | | |
| | | | | |
| | | | | |
| Please provide your comments and questions here: | | | | |
| | | | | |
| | | | | |
| | | | | |
| | | | | |
| | | | | |
| | | | | |
| | | | | |
| | | | | |
| <i>Please feel free to attach a separate document</i> | | | | |
| Please add any person you think may be interested and affected parties: | | | | |
| Full name | | Company | | |
| Address | | | | |
| E-mail | | | Contact No. | |