

APPLICANT:

UPWARD SPIRAL 1471 (PTY) LTD

708 Sprankel Crescent,
Brakpan, 1550

Contact person: Jacqueline
Meegen Pahad

Cell No.: 078 347 3141

Fax No.: +27 86 652 7678

Email: mosaic@hotmail.co.za

DMRE Ref: MP 30/5/1/1/3/13464 MP

CONSULTANT:



P/Bag X7297, Postnet Suite 87,
Witbank, 1035
Office 870
05 Balalaika St
Tasbet Part Ext 2
Witbank

EAP: Daniel Tshinavhe

Cell: 076 456 4443

Email: admin@singoconsulting.co.za

daniyel@singoconsulting.co.za



INTRODUCTION AND THE PURPOSE OF THIS DOCUMENT

Singo Consulting (Pty) Ltd has been appointed as an independent Environmental Consultant by **Upward Spiral 1471 (Pty) Ltd** to conduct Environmental Impact Assessment (EIA) through Basis Assessment, Compile an Environmental Management Programme report (EMPr) and undertake Public Participation Process (PPP). This is done for processes of acquiring Environmental Authorization for the proposed Mining Permit Application for **Coal, Pseudocoal, Torbanites, Aggregate and Sand** on **portion of the Remaining Extent** of the Farm **Bloekombos 414 JS**, under the Magisterial District of **Witbank, Mpumalanga Province** with **DMRE Ref: MP 30/5/1/1/3/13464 MP**

The Purpose of this Background Information Document (BID) is to provide a perfunctory description of the project and outline EIA processes to be followed and contributions from Interested and Affected Parties (I&APs) on the issues related to the project in question, allowing comments and concerns to be raised. Results of the EIA through basic assessment, both negative and positive will be submitted and made available to the relevant Departments such as the Department of Mineral Resources and if requested, Environmental Affairs, Water and Sanitation, Landowners, and other interested stakeholders.

This Background Information Document therefore requests and invite I&APs to comment on the environmental, physical, Social and economic impacts associated with the proposed Mining Activities. Be assured that your comments are of great value as they ensure that relevant issues are taken into consideration. Attached at the end of this document is a registration form, kindly complete it and send it back to **Mr Daniel Tshinavhe** through given means of communication also attached there.

Notice is hereby given in terms of the Mineral and Petroleum Resources Development Act (MPRDA) (Act 28 of 2002) and EIA regulations 2014, published under Government Notice No. 982 in Gazette No. 3822 of 8 December 2014, amended on 7 April 2017, that **Upward Spiral 1471 (Pty) Ltd** has an intention to mine **Coal, Pseudocoal, Torbanites, Aggregate and Sand** on the aforementioned portion.

Be assured that your comments are of great value as they ensure that relevant issues are taken into consideration. **Attached at the end of this document is a registration form**, kindly complete it and send it back to

PROJECT DESCRIPTION

Mining Permit Application has been submitted for the extraction of **Coal, Pseudocoal, Torbanites, Aggregate and Sand** resources on the property mentioned above. The Mining Permit is situated approximately 1.2 km northwest of Leeuwpoort Colliery, 4.95 km northeast of Kwa-Guqa, 264 m west of Siyanqoba and about 3.89 km Northwest of Klarinet refer to **Figure 1** and **Figure 2** for project location.

Mining activities will be undertaken over a period of two (2) years. This project will entail an open cast method of excavation. The mine design will be developed according to the dimension of the applied mineral deposit within the project area, but overall mining activities will be limited to an area of 5 Ha as per mining permit requirements. The topsoil will be stockpiled elsewhere on site preferably next to the farm boundary and will be used during rehabilitation period. Once a box cut has been made, the overburden and mineral resources where necessary will be loosened by blasting. The loosened material will then be loaded onto trucks by excavators. A haul road will be situated at the side of the open cast, forming a ramp up which trucks can drive, carrying ore and waste rock. Waste rock will be piled up at the surface, near the edge of the open cast (waste dump). The waste dump will be tiered and stepped, to minimize degradation. All the activities will be guided by the project's EMPr such that the project does not impact the environment negatively.

REGULATORY FRAMEWORK

The EIA process through BAR & EMPR to be undertaken will be conducted in accordance with the National Environmental Management Act (Act 107 of 1998) and Environmental Impact Assessment regulations as amended (April 2017).

The activity is to extract the existence and occurrence of the applied mineral; therefore, this will be conducted in accordance with Mineral and Petroleum Resources Development Act, (Act 28 of 2002). Other regulatory guidelines to be followed include: National Water Act, 1998 (Act 36 of 1998), National Air Quality Standards (GN 1210: 2009) and National Dust Control Regulations (GN No. 827 of 2013).

These all will accurately be followed to ensure that identified impacts are assessed and mitigated according to their significance so that the protection of the receiving environment and populations is met.

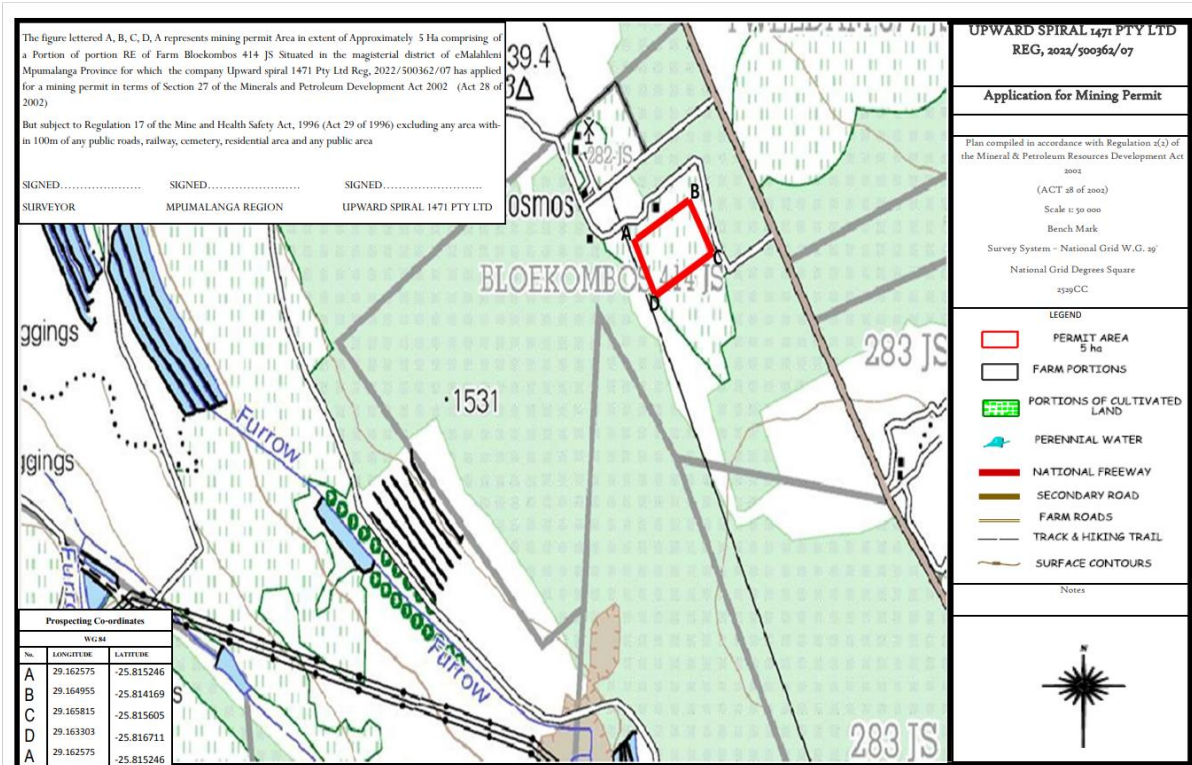

Figure 1: Regulation 2.2 map

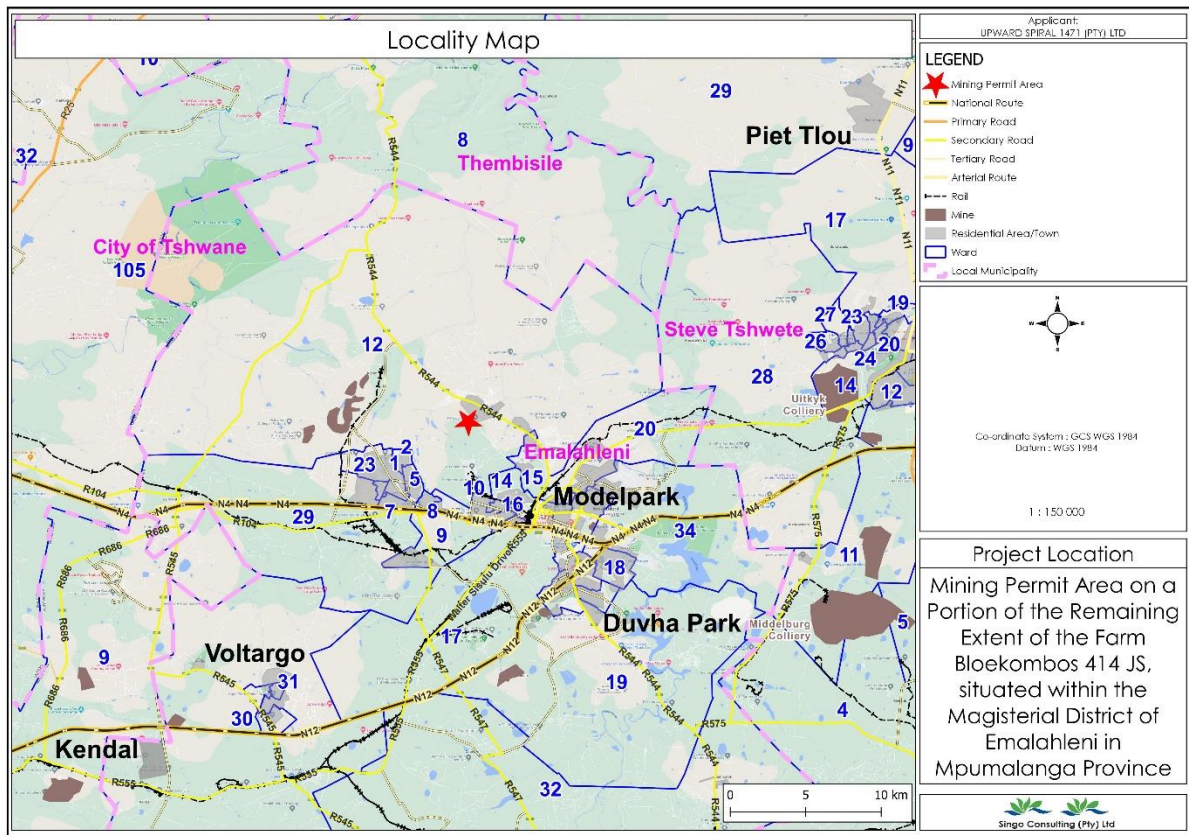

Figure 2: Locality Map

BASIC AND ENVIRONMENTAL IMPACT ASSESSMENT & PUBLIC PARTICIPATION PROCESS

These are planning and decision-making tools used in identifying potential environmental, economic, and social consequences of a proposed activity prior the commencement of the activity.

These together with the public issues and concerns are to be identified sufficiently early so that they can be assessed and incorporated into the final reports when/if necessary.

These tools are regarded crucial because they are utilized in order to demonstrate to the relevant stakeholders about the potential impacts, which in turn leads to the Mining application process being a success or declined.

Public Participation remains a cornerstone of the Environmental Impact Assessment process. It ensures provision of relevant and enough information with openness and transparency. Public Participation process presents to I&APs, an opportunity to understand what the project is about, and affords them an opportunity to make valuable contributions towards the EIA process.

I&AP can be any person, group of persons or organization interested in or affected by the proposed activity, and any organ of state that may have jurisdiction over any aspect of the activity.

Kindly keep the following dates:

- Announcement of the project: **16 December 2022**
- Review period of the draft BAR & EMPr: **7 February 2023 – 08 March 2023**

The BAR & EMPr will be available at **eMalahleni Local Municipality, Lynville Public Library and Klarinet Public Library** and a soft copy upon request from Singo Consulting (Pty) Ltd using the detailed EAP's contact's below, via emails; Dropbox link; Google drive; WeTransfer, etc.



Singo Consulting (Pty) Ltd

Address: Office 870, 5 Balalaika Street,
Tasbet Park Ext 2, eMalaheni

Cell: 076 356 4443

Email: [daniyel@singoconsulting.co.za/](mailto:daniyel@singoconsulting.co.za)

admin@singoconsulting.co.za

REGISTRATION & COMMENT SHEET-(MINING PERMIT REF MP 30/5/1/1/3/13464 MP).

| | | |
|---|-------------------------------|----------------------------------|
| Title | Name | Surname |
| Company | | |
| Designation | | |
| Address | | |
| Tel No. | Fax No. | |
| E-mail | Cell No. | |
| I would like to receive my notifications be (mark with "X"): | Post <input type="checkbox"/> | E-mail: <input type="checkbox"/> |
| | | Fax: <input type="checkbox"/> |
| Please indicate why you would have an interest in the above-mentioned project. | | |
| | | |
| | | |
| | | |
| | | |
| | | |
| | | |
| | | |
| | | |
| | | |
| Please provide your comments and questions here: | | |
| | | |
| | | |
| | | |
| | | |
| | | |
| | | |
| Please feel free to attach a separate document | | |
| Please add any person you think may be interested and affected parties: | | |
| Full name | Company | |
| Address | | |
| E-mail | Contact No. | |