

# BACKGROUND INFORMATION DOCUMENT

<b>Application:</b>		<b>Prepared by:</b>	<b>Prepared for:</b>
Prospecting right application for Coal on portion 4 of the Zonderfout 226 IR		 Singo Consulting (Pty) Ltd	Abelusi Logistics and Projects (Pty) Ltd
<b>Magisterial District:</b>	Delmas		

## INTRODUCTION AND THE PURPOSE OF THIS DOCUMENT

**Singo Consulting (Pty) Ltd** has been appointed as an independent Environmental Consultant by **Abelusi Logistics and Projects**

to conduct Environmental Impact Assessment (EIA), Compile a Basic Assessment Report (BAR), Compile an Environmental Management Programme report (EMPr) and undertake Public Participation Process (PPP). This is done for processes of acquiring Environmental Authorization for the proposed Prospecting right Application **on portion 4 of Zonderfout 226 IR**, under the **Magisterial District of Delmas, Mpumalanga Province. (DMRE Ref: MP 30/5/1/1/2/17345 PR)**

The Purpose of this Background Information Document (BID) is to provide a perfunctory description of the project and outline EIA processes to be followed and contributions from Interested and Affected Parties (I&APs) on the issues related to the project in question, allowing comments and concerns to be raised.

Results of the EIA, both negative and positive will be submitted and made available to the relevant Departments such as the Department of Mineral Resources and if requested, Environmental Affairs, Water and Sanitation, Landowner and other interested stakeholders.

This Background Information Document therefore requests and invite I&APs to comment on the environmental, physical, social and economic impacts associated with the proposed Prospecting Activities. Be assured that your comments are of great value as they ensure that relevant issues are taken into consideration. Attached at the end of this document is a registration form, kindly complete it and send it back to **Ms Buhle Malatjie** through given means of communication also attached there.

## PROJECT DESCRIPTION

Prospecting right Application has been submitted for the extraction of **coal** resource on the properties mentioned above.

This proposed prospecting Area, as seen in approximately 9.31 km North-East of Delmas, about 5.73 km North-West of Pinewood and approximately 5.05 km North-East of Botleng. It can be accessed via N12.

Prospecting activities will be undertaken over a period of five (5) years and are designed in phases, each phase conditional on the success of the previous phase. Both invasive and non-invasive methods will be implemented. Invasive are those activities which have footprint or cause harm (if not mitigated or managed properly) or those that have a physical impact on the environment, while non-invasive do not cause any harm or effects on the environment.

**Non-invasive:** Desktop study of the area has commenced, and this incorporates desktop geographical and geological mapping. This will be followed by detailed geochemical and geotechnical surveys. In turn, this is followed by detailed geophysical studies.

**Invasive:** A detailed drilling, sampling, assaying and mineralogical study will be carried out. Diamond drilling method will be utilised to prospect **Coal** To ensure or minimise impacts on the receiving environment, All the activities will be guided by the project's BAR & EMPr.



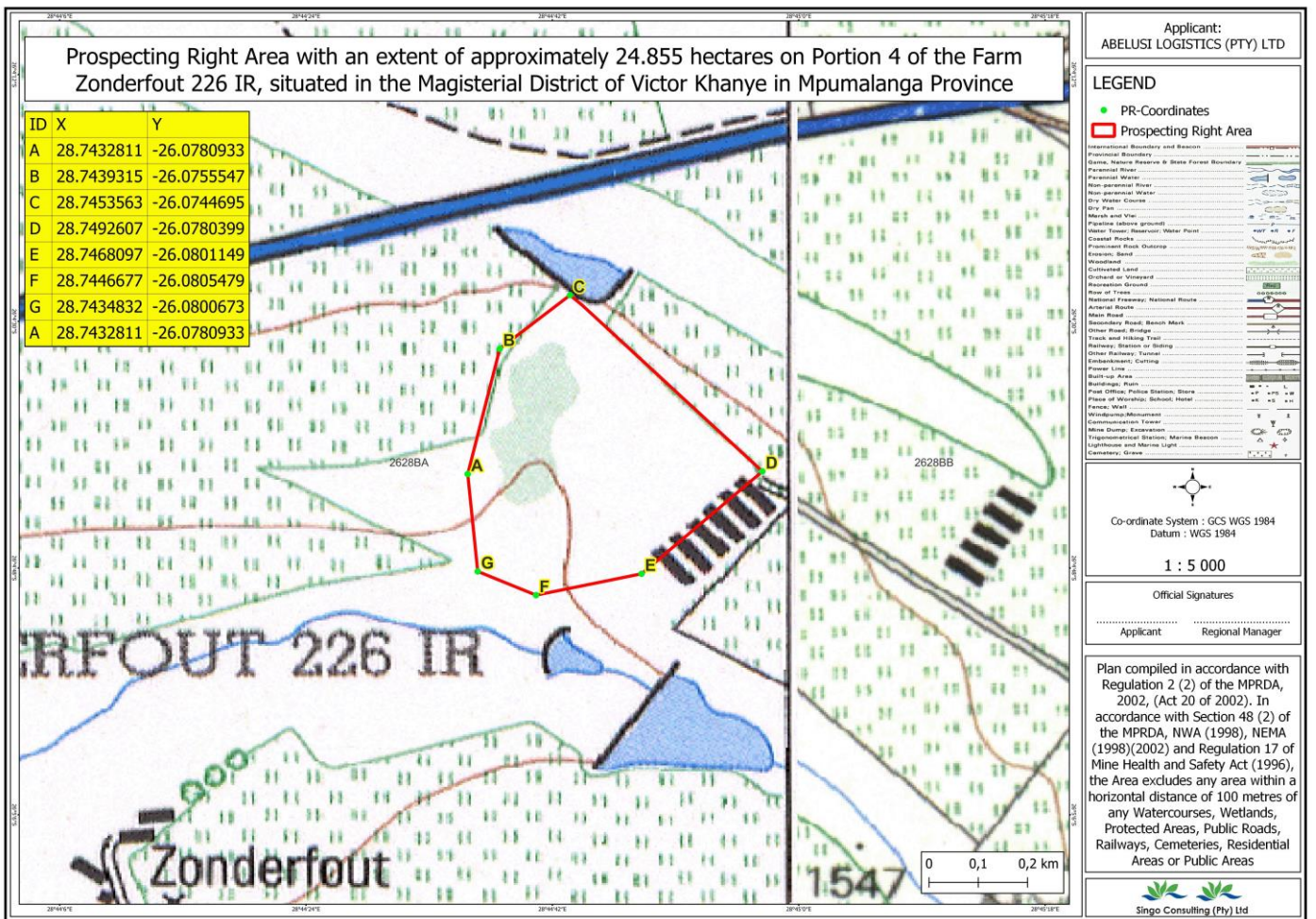

Figure 1: Regulation 2.2 map of the proposed project area (-26,0780933 ; 28.7432811)

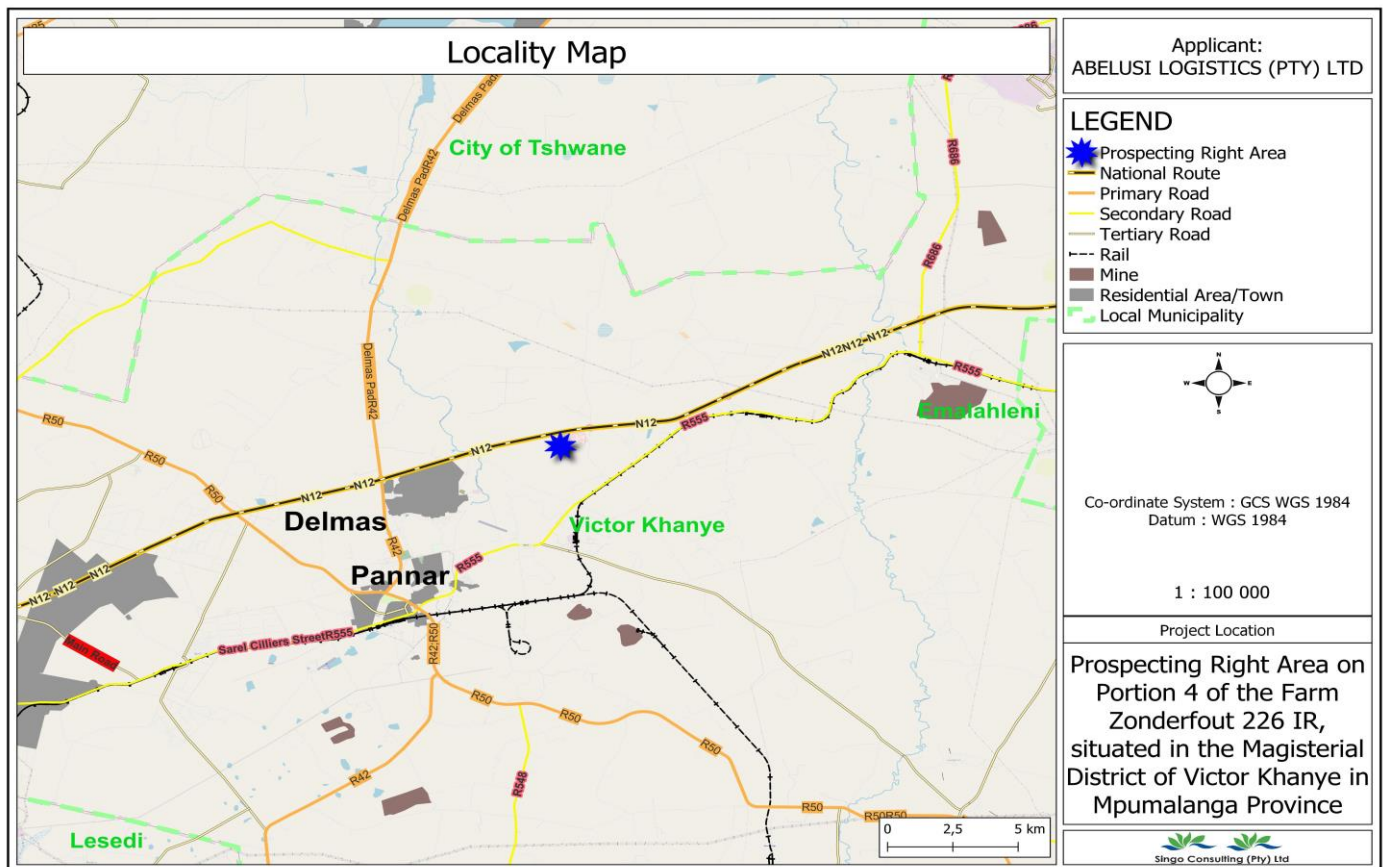

Figure 2: Locality Map of the proposed project area.

## REGULATORY FRAMEWORK

Therefore, EIA process to be undertaken will be conducted in accordance with the National Environmental Management Act (Act 107 of 1998) and Environmental Impact Assessment regulations as amended (April 2017).

The activity is to extract the existence and occurrence of the applied minerals; therefore, this will be conducted in accordance with Mineral and Petroleum Resources Development Act, (Act 28 of 2002). Other regulatory guidelines to be followed include: National Water Act, 1998 (Act 36 of 1998), National Air Quality Standards (GN 1210: 2009) and National Dust Control Regulations (GN 36974: 2013 ).

All the mentioned acts and guidelines will accurately be followed to ensure that identified impacts are assessed and mitigated according to their significance so that the protection of the receiving environment and populations is met.

## BASIC AND ENVIRONMENTAL IMPACT ASSESSMENT PROCESSES

These are planning and decision-making tools used in identifying potential environmental, economic and social consequences of a proposed activity prior the commencement of the activity.

These together with the public issues and concerns are to be identified sufficiently early so that they can be assessed and incorporated into the final reports when/if necessary.

These tools are regarded crucial because they are utilized in order to demonstrate to the relevant stakeholders about the potential impacts, which in turn leads to the Prospecting right application process being a success or declined.

## PUBLIC PARTICIPATION PROCESS

Public Participation remains a cornerstone of the Environmental Impact Assessment process. It ensures provision of relevant and enough information with openness and transparency. Public Participation process presents to I&APs, an opportunity to understand what the project is about, and affords them an opportunity to make valuable contributions towards the EIA process.

I&AP can be any person, group of persons or organization interested in or affected by the proposed activity, and any organ of state that may have jurisdiction over any aspect of the activity.

The key objective of PPP during the EIA Process is to afford the I&APs with an opportunity to comment and provide valuable inputs during the planning phase of the project.

For this specific proposed project, I&APs will be given a period of 30 days to comment and raise issues/concerns with regards to this BID.

Kindly keep the following dates:

Announcement of the project: **Friday the 24th of June 2022**

Stakeholder engagement and consultation:

**the 24th of June 2022 to Saturday the 23rd of July 2022**

Review of Draft BAR & EMPr:

**Sunday 24th of July 2022 to Tuesday the 23rd of August 2022**

 <b>Singo Consulting (Pty) Ltd</b>	<b>Office No 870, 5 Balalaika Street</b> <b>Tasbet park Ext 2</b> <b>, Emalaheni</b> <b>Cell: +27 72 307 3508</b> <b>Tel: +27 13 692 0041</b> <b>Fax: +27 86 5144 103</b> <b>Email: <a href="mailto:buhle@singoconsulting.co.za">buhle@singoconsulting.co.za</a></b> <b>: <a href="mailto:admin@singoconsulting.co.za">admin@singoconsulting.co.za</a></b>
--	---

**REGISTRATION & COMMENT SHEET**

**Prospecting right application for coal on portion 4 of Zonderfout 226 IR by**  
**Abelusi Logistics and Projects (Pty) Ltd.**

Attention: **Buhle Malatjie**

Email: [buhle@singoconsulting.co.za](mailto:buhle@singoconsulting.co.za)

Title	Name	Surname		
Company				
Designation				
Address				
Tel No.			Fax No.	
E-mail			Cell No.	
I would like to receive my notifications be (mark with "X"):		Post:	<input type="checkbox"/>	E-mail:
		SMS:	<input type="checkbox"/>	Fax:
<b>Please indicate why you would have an interest in the above-mentioned project.</b>				
<b>Please provide your comments and questions here:</b>				
<i>Please feel free to attach a separate document</i>				
<b>Please add any person you think may be interested and affected parties:</b>				
Full name			Company	
Address				
E-mail			Contact No.	