

# BACKGROUND INFORMATION DOCUMENT



2022

**PROSPECTING RIGHT APPLICATION FOR THE PURPOSE OF PROSPECTING COAL ON PORTION OF PORTION 6 OF THE FARM KLEINFONTEIN 49 IS, SITUATED IN THE MAGISTERIAL DISTRICT OF STEVE TSHWETE, MPUMALANGA PROVINCE**

**DMRE REF: MP 30/5/1/1/2/17383 PR**



Office 870

5 Balalaika Street

Tasbet park, Ext 2

Witbank

1040

Tel No.: +27 13 6920 041

Fax No.: +27 86 5144 103

Cell No.: +27 84 9485 793

Email: [ayanda@singoconsulting.co.za](mailto:ayanda@singoconsulting.co.za)

**PREPARED ON BEHALF OF:**



23 Beatty Street

Witbank Ext 5,

1035

Mpumalanga, South Africa

Tel No.: 013 591 1711

Cell No.: +27 79 530 7662

Fax No.: +27 86 544 8825

Email: [Info@trengineering.co.za](mailto:Info@trengineering.co.za)

## INTRODUCTION AND THE PURPOSE OF THIS DOCUMENT

Singo Consulting (Pty) Ltd has been appointed as an independent Environmental Consultant by TR Engineering Project (Pty) Ltd to conduct Environmental Impact Assessment (EIA), Compile an Environmental Management Programme Report (EMPr) and undertake Public Participation Process (PPP). This is done for processes of acquiring environmental authorization for the proposed prospecting for **Coal** on Portions of portion 6 of the Farm **Kleinfontein 49 IS**, situated In the Magisterial District of Steve Tshwete, Mpumalanga Province

The Purpose of this Background Information Document (BID) is to provide a perfunctory description of the project and outline EIA processes to be followed and contributions from Interested and Affected Parties (I&APs) on the issues related to the project in question, allowing comments and concerns to be raised.

Results of the EIA through BAR & EMPr, both negative and positive will be submitted and made available to the relevant Departments such as the Department of Mineral Resources and Energy and if requested, Environmental Affairs, Water and Sanitation, Landowners, and other interested stakeholders.

This Background Information Document therefore requests and invites I&APs to comment on the environmental, physical, social, and economic impacts associated with the proposed Prospecting Activity. Be assured that your comments are of great value as they ensure that relevant issues are taken into consideration. Attached at the end of this document is a registration form, kindly complete it and send it back to **Mr. Ayanda Vilakazi** through given means of communication also attached here.

## PROJECT DESCRIPTION

Prospecting Right Application has been submitted for the prospecting of Coal on the property mentioned above. This Prospecting Area, as seen in figure 1 below, is situated approximately 9.17 km south of Nkomati. Also refer to figure 2 below for locality map of the proposed area.

Prospecting activities will be undertaken over a period of five (5) years and are designed in phases, each phase conditional on the success of the previous phase. Both Invasive and non-invasive methods will be implemented. Desktop study of the area has commenced, and this incorporates desktop geographical and geological mapping. This will be followed by geochemical and geotechnical surveys. In turn, this is followed by detailed geophysical studies and later, a detailed drilling, sampling, assaying and mineralogical study. Percussion drilling and Diamond drilling methods will be utilized to prospect **coal**. To ensure or minimize impacts on the receiving environment, all the drilling activities will be guided by the project's EMPr.

## REGULATORY FRAMEWORK

The proposed Prospecting activity is involved with some sort of physical alteration to accommodate for example drill rigs and site offices. Therefore, EIA process to be undertaken will be conducted in accordance with the National Environmental Management Act (Act 107 of 1998) and Environmental Impact Assessment regulations as amended (April 2017).

The activity is to prospect the existence and occurrence of **Coal** therefore this will be conducted in accordance with Mineral and Petroleum Resources Development Act, (Act 28 of 2002). Other regulatory guidelines to be followed include National Water Act, 1998 (Act 36 of 1998), National Air Quality Standards (GN 1210: 2009) and National Dust Control Regulations (GN 827: 2013) as amended.

These all will accurately be followed to ensure that identified impacts are assessed and mitigated according to their significance so that the protection of the receiving environment and populations is met.

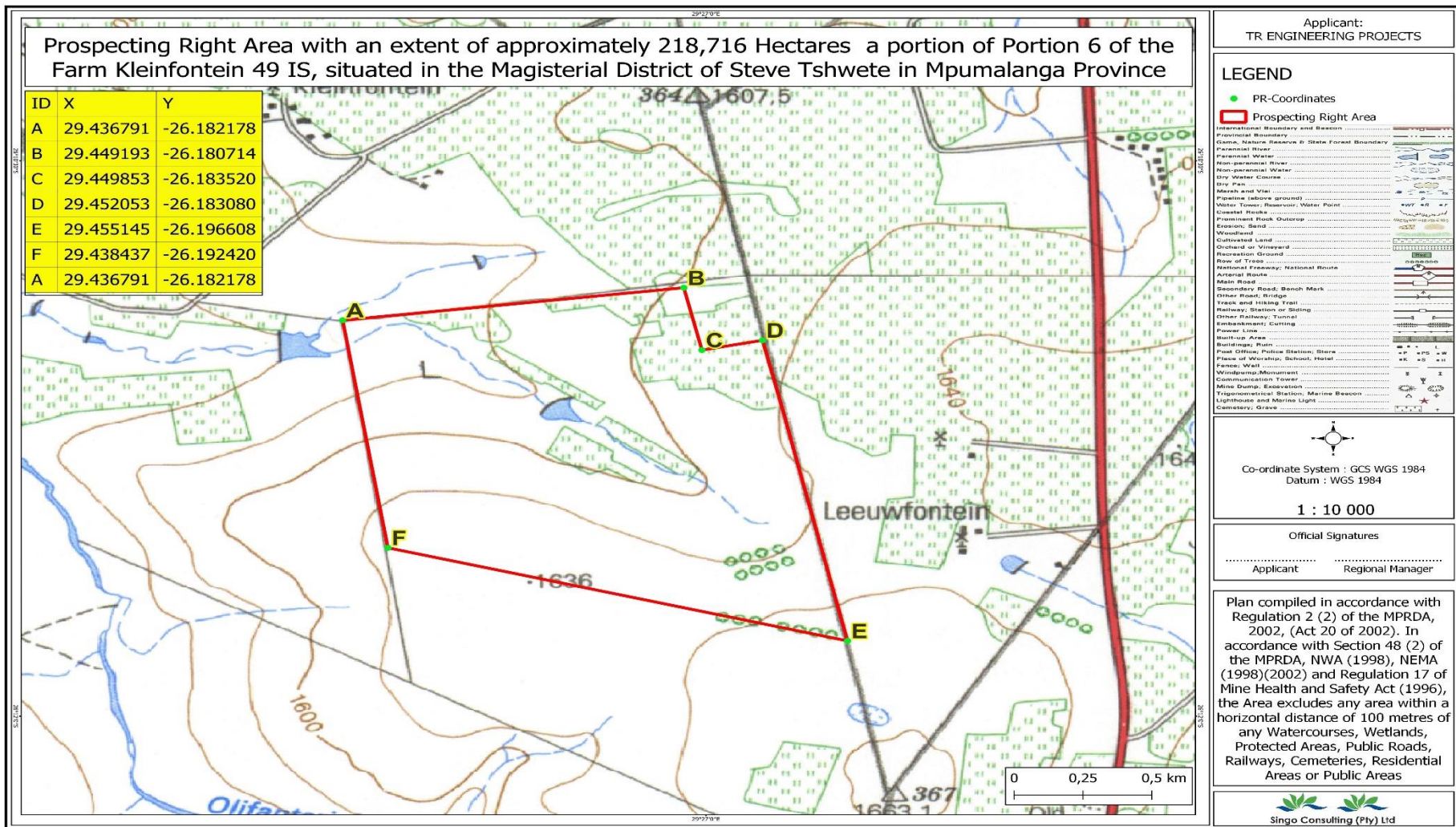

Figure 1: Regulation map of the proposed area.

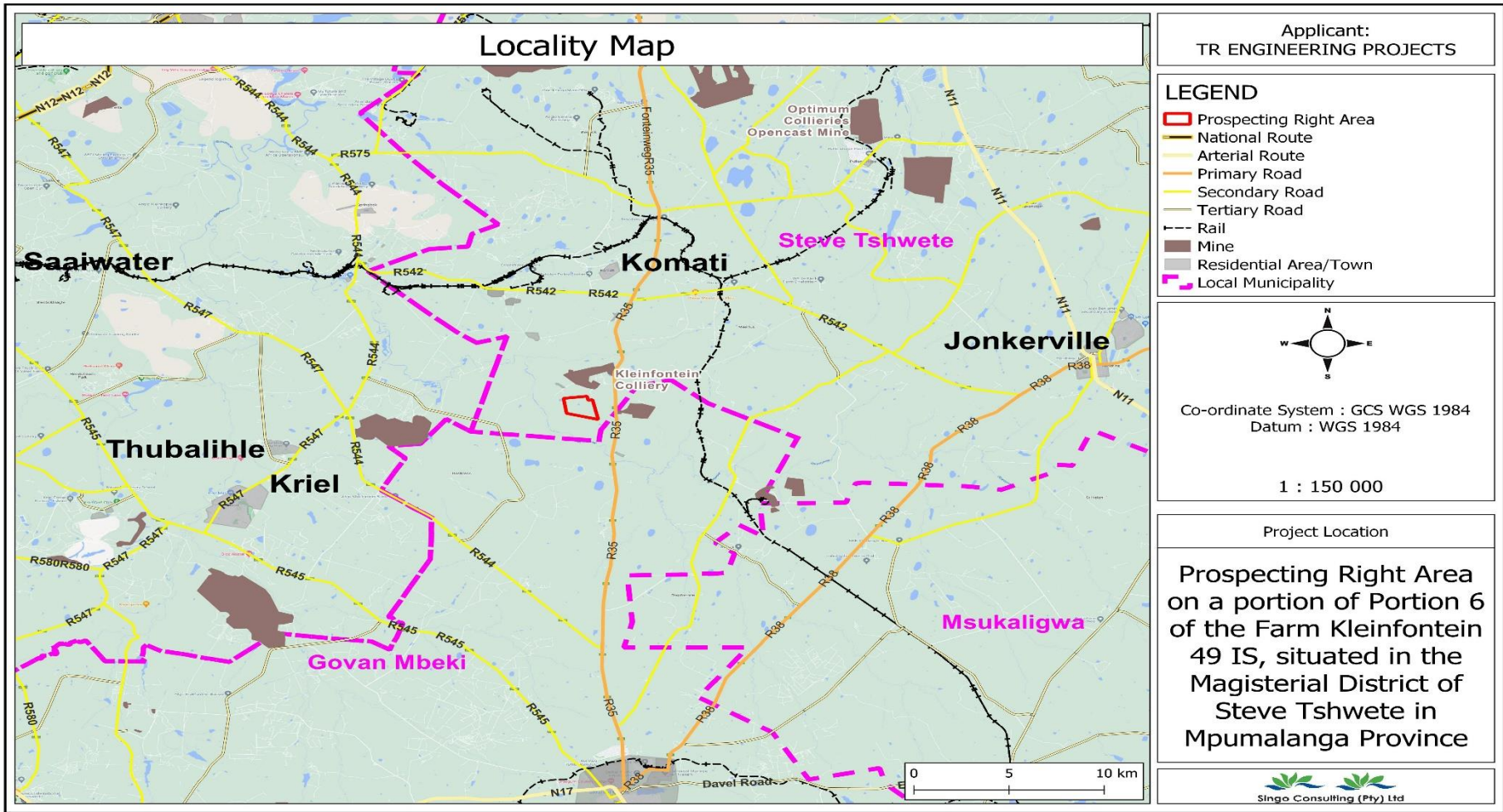

Figure 2: Locality Map of the proposed project

## BASIC AND ENVIRONMENTAL IMPACT ASSESSMENT PROCESSES

These are planning and decision-making tools used in identifying potential environmental, economic, and social consequences of a proposed activity prior the commencement of the activity.

These together with the public issues and concerns are to be identified sufficiently early so that they can be assessed and incorporated into the final reports when/if necessary.

These tools are regarded crucial because they are utilized in order to demonstrate to the relevant stakeholders about the potential impacts, which in turn leads to the prospecting application process being a success or declined.

## PUBLIC PARTICIPATION PROCESS

Public Participation remains a cornerstone of the Environmental Impact Assessment process. It ensures provision of relevant and enough information with openness and transparency. Public Participation process presents to I&APs, an opportunity to understand what the project is about, and affords them an opportunity to make valuable contributions towards the EIA process.

I&APs can be any person, group of persons or organization interested in or affected by the proposed activity, and any organ of state that may have jurisdiction over any aspect of the activity.

The key objective of PPP is to afford the I&APs with an opportunity to comment and provide valuable inputs during the planning phase of the project.

For this specific proposed project, I&APs will be given a period of 30 days to comment and raise issues/concerns with regards to the BAR and EMPr which will be available at the **Gerald Sekoto Public Library** and via email upon request.

- ✦ Kindly note the following dates:
- ✦ Announcement of the Prospecting Right Application: **20<sup>th</sup> of May 2022**
- ✦ Stakeholder engagement and consultation: **20<sup>th</sup> May 2022 – 19<sup>th</sup> of June 2022**
- ✦ Review of Draft BAR & EMPr: **20<sup>th</sup> of June 2022 – 19<sup>th</sup> of July 2022.**



Office No: 870, 5 Balalaika Street,  
 Tasbet Park Ext 2,  
 Witbank  
 1040  
 Cell: +27 84 948 5793  
 Tel: +27 13 692 0041  
 Fax: +27 86 5144 103  
 Email: [ayanda@singoconsulting.co.za](mailto:ayanda@singoconsulting.co.za)  
[admin@singoconsulting.co.za](mailto:admin@singoconsulting.co.za)

**REGISTRATION & COMMENT SHEET**

**PROSPECTING RIGHT APPLICATION FOR THE PURPOSE OF PROSPECTING COAL ON PORTION OF PORTION 6 OF THE FARM KLEINFONTEIN 49 IS, SITUATED IN THE MAGISTERIAL DISTRICT OF STEVE TSHWETE, MPUMALANGA PROVINCE  
 DMRE REF: MP 30/5/1/1/2/17383 PR**

Attention: **Ayanda Vilakazi**

Email: [ayanda@singoconsulting.co.za](mailto:ayanda@singoconsulting.co.za)

Date			
Title	Name	Surname	
Company			
Designation			
Address			
Tel No.		Fax No.	
E-mail		Cell No.	
I would like to receive my notifications be (mark with "X"):	Post <input type="checkbox"/>	E-mail: <input type="checkbox"/>	<input type="checkbox"/>
		Fax: <input type="checkbox"/>	<input type="checkbox"/>
<b>Please indicate why you would have an interest in the above-mentioned project.</b>			
<b>Please provide your comments and questions here:</b>			
<i>Please feel free to attach a separate document</i>			
<b>Please add any person you think may be interested and affected parties:</b>			
Full name		Company	
Address			
E-mail		Contact No.	