

BACKGROUND INFORMATION DOCUMENT

PROSPECTING RIGHT AND ENVIRONMENTAL AUTHORIZATION APPLICATION FOR THE PURPOSE OF PROSPECTING FOR COAL ON PORTION 27 OF THE FARM WITKLIP 232 IR, SITUATED IN THE DELMAS MAGISTERIAL DISTRICT, MPUMALANGA PROVINCE.

Prepared by:



Sinao Consultina (Pty) Ltd

Prepared for:



Thanyane Holdings

INTRODUCTION AND THE PURPOSE OF THIS DOCUMENT

Singo Consulting (Pty) Ltd has been appointed as an independent Environmental Consultant by **THANYANE HOLDINGS (PTY) LTD** to conduct Environmental Impact Assessment (EIA), Compile Basic Assessment Report (BAR) & Environmental Management Programme report (EMPr) and to undertake Public Participation Process (PPP). This is done for processes of acquiring Environmental Authorization for the proposed Prospecting Right application **Coal** on portion 27 of the Farm **Witklip 232 IR**, situated in the Delmas Magisterial District, Mpumalanga Province with **DMRE Ref: MP 30/5/1/1/2/17310 PR**

The Purpose of this Background Information Document (BID) is to provide a perfunctory description of the project and outline EIA processes through BAR & EMPr to be followed and contributions from Stakeholders, Interested and Affected Parties (I&APs) on the issues related to the project in question, allowing comments and concerns to be raised.

Results of the EIA (BAR & EMPr), both negative and positive will be submitted and made available to the relevant Departments such as the Department of Mineral Resources & Energy and if requested, Environmental Affairs, Water and Sanitation, Landowners, and other interested stakeholders.

This Background Information Document therefore requests and invite I&APs to comment on the environmental, physical, social, and economic impacts associated with the proposed Prospecting Activities. Be assured that your comments are of great value as they ensure that relevant issues are taken into consideration.

Attached at the end of this document is a registration form, kindly complete it and send it back to **Mr Daniel Tshinavhe** through given means of communication also attached there.

PROJECT DESCRIPTION

Prospecting Right Application has been submitted for the Purpose of prospecting **Coal** on properties mentioned above. This Proposed Prospecting Area, as seen in figure 1 below is situated approximately 4.88 km North of Botleng, 1.4 km east of Eloff and less than 30m from Delmas West. The proposed site can be accessed from the R50 on the southern side and the R555 on the northern side

Prospecting activities will be undertaken over a period of five (5) years and are designed in phases, each phase conditional on the success of the previous phase. Both invasive and non-invasive methods will be implemented. Invasive are those activities which have footprint or cause harm (if not mitigated or managed properly) or those that have a physical impact on the environment, while non-invasive do not cause any harm or effects on the environment.

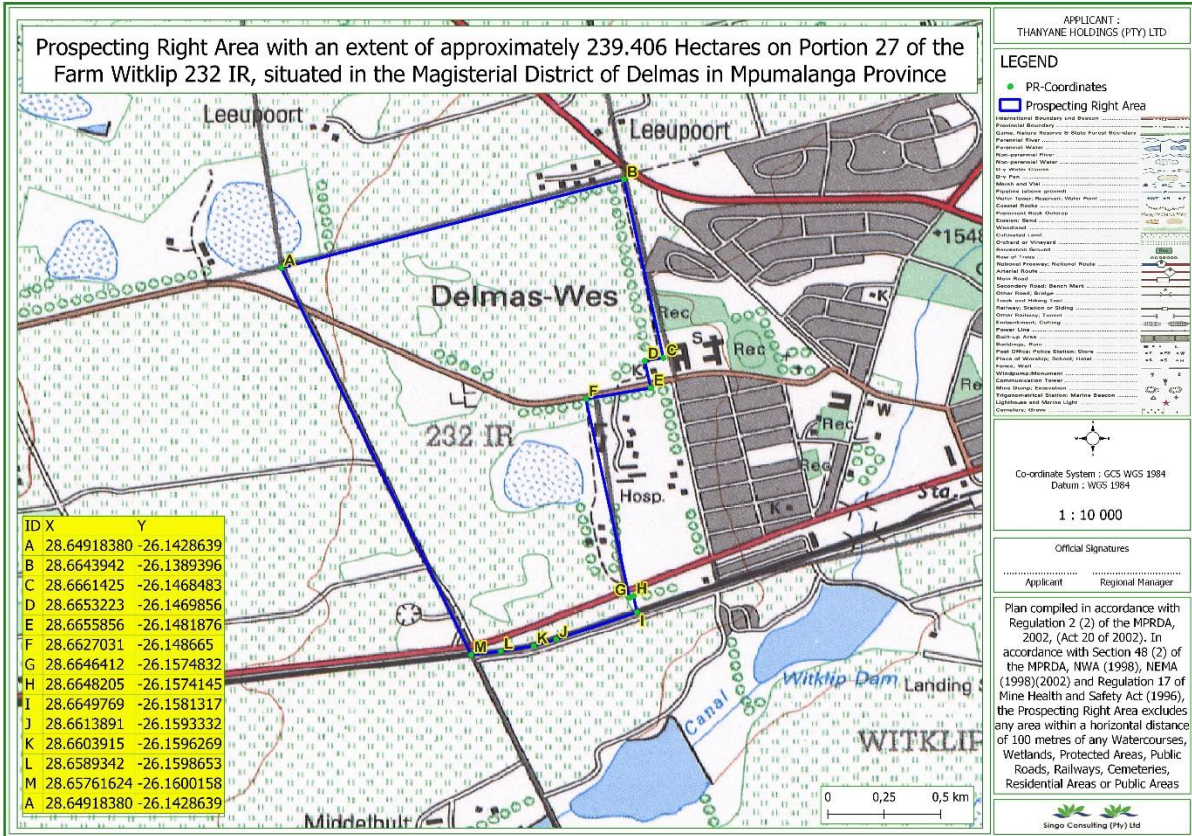

Figure 1: Regulation 2(2) Map with coordinates of the Proposed Project Area.

Non-invasive: Desktop study of the area has commenced, and this incorporates desktop geographical and geological mapping. This will be followed by detailed geochemical and geotechnical surveys. In turn, this is followed by detailed geophysical studies.

Invasive: A detailed drilling, sampling, assaying and mineralogical study will be carried out. Diamond method will be utilised to prospect in situ of Coal. To ensure or minimise impacts on the receiving environment, All the activities will be guided by the project's BAR & EMPr.

REGULATORY FRAMEWORK

Therefore, EIA (BAR & EMPr) process to be undertaken will be conducted in accordance with the National Environmental Management Act (Act 107 of 1998) and Environmental Impact Assessment regulations as amended (April 2017).

The activity is to prospect the existence and occurrence of Coal therefore, this will be conducted in accordance with Mineral and Petroleum Resources Development Act, (Act 28 of 2002). Other regulatory guidelines to be followed include National Water Act, 1998 (Act 36 of 1998), National Air Quality Standards (GN 1210: 2009) and National Dust Control Regulations (GN 36974: 2013).

These all will accurately be followed to ensure that identified impacts are assessed and mitigated according to their significance so that the protection of the receiving environment and populations is met.

BASIC AND ENVIRONMENTAL IMPACT ASSESSMENT PROCESSES

These are planning and decision-making tools used in identifying potential environmental, economic, and social consequences of a proposed activity prior the commencement of the activity. These together with the public issues and concerns are to be identified sufficiently early so that they can be assessed and incorporated into the final reports when/if necessary.

These tools are regarded crucial because they are utilized to demonstrate to the relevant stakeholders about the potential impacts, which in turn leads to the Mining application process being a success or declined.

PUBLIC PARTICIPATION PROCESS

Public Participation remains a cornerstone of the Environmental Impact Assessment process. It ensures provision of relevant and enough information with openness and transparency. Public Participation process presents to I&APs, an opportunity to understand what the project is about, and affords them an opportunity to make valuable contributions towards the EIA (BAR & EMPr) process.

I&AP can be any person, group of persons or organization interested in or affected by the proposed activity, and any organ of state that may have jurisdiction over any aspect of the activity. The key objective of PPP is to afford the I&APs with an opportunity to comment and provide valuable inputs during the planning phase of the project.

For this specific proposed project, I&APs will be given a period of 30 days to comment and raise issues/concerns with regards to the proposed project.

Kindly keep the following dates:

- ❖ Stakeholder engagement and consultation: **On-going throughout the process of compiling the BAR & EMPr**
- ❖ Review of draft Basic Assessment Report (BAR) and Environmental Management Programme report (EMPr): **20th of July 2022 – 20th of August 2022**

This report will be available at the **Delmas Public Library (Cnr Sarel Cillies & Van Riebeeck Ln, Delmas, 2210)**. Furthermore, the report will be available upon request, via email from the respective EAP.

For comments or concerns about the proposed project, please contact Singo Consulting (Pty) Ltd, using the detailed EAP's contacts below



Office No: Office 870
 5 Balalaika Street
 Tasbet park, Ext 2
 Witbank, 1040
Cell: +27 60 412 6357
Tel: +27 13 692 0041
Fax: +27 86 5144 103
Email: daniyel@singoconsulting.co.za
[: admin@singoconsulting.co.za](mailto:admin@singoconsulting.co.za)

REGISTRATION & COMMENT SHEET-DMRE REF: MP 30/5/1/1/2/ 17310 PR.

Attention: **Daniel Tshinavhe**

Email: daniyel@singoconsulting.co.za

Title	Name	Surname
Company		
Designation		
Address		
Tel No.	Fax No.	
E-mail	Cell No.	
I would like to receive my notifications be (mark with "X"):	Post <input type="checkbox"/>	E-mail: <input type="checkbox"/> Fax: <input type="checkbox"/>
Please indicate why you would have an interest in the above-mentioned project.		
Please provide your comments and questions here:		
Please feel free to attach a separate document		
Please add any person you think may be interested and affected parties:		
Full name	Company	
Address		
E-mail	Contact No.	