

BACKGROUND INFORMATION DOCUMENT

Prospecting right Application for Coal on portion 8 of the farm Eenzaamheid 534 JR, in the magisterial district of Witbank, in Mpumalanga

Prepared by:



Prepared for:



INTRODUCTION AND THE PURPOSE OF THIS DOCUMENT

Singo Consulting (Pty) Ltd has been appointed as an independent Environmental Consultant by **Mashige Building Construction and Consultant** to conduct Environmental Impact Assessment (EIA), Compile an Environmental Management Programme report (EMPr) and undertake Public Participation Process (PPP). This is done for processes of acquiring environmental authorization for the proposed Prospecting Right application on portion 8 of the **farm Eenzaamheid 534 JR**, situated in the magisterial district of Witbank, Mpumalanga Province. **(DMRE REF: MP 30/5/1/1/2/17271 PR)**

The Purpose of this Background Information Document (BID) is to provide a perfunctory description of the project and outline EIA processes (through BAR & EMPr) to be followed and contributions from Interested and Affected Parties (I&APs) on the issues related to the project in question, allowing comments and concerns to be raised.

Results of the processes, both negative and positive will be submitted and made available to the relevant Departments such as the Department of Mineral Resources and if requested, Environmental Affairs, Water and Sanitation, Landowners and other interested stakeholders.

This Background Information Document therefore requests and invite I&APs to comment on the environmental, physical, social and economic impacts associated with the proposed Prospecting Activities. Be assured that your comments are of great value as they ensure that relevant issues are taken into consideration. Attached at the end of this document is a registration form, kindly complete it and send it back to **Mr Jiyane Simangaliso** through given means of communication also attached there.

PROJECT DESCRIPTION

Prospecting Right Application has been submitted for the prospecting of **Coal** on the property mentioned above.

This Prospecting Area, as seen in figure 1 below and 2 is situated Approximately 1.33 km Southeast of **Balmoral** and Approximately 10.54 km East of **Kwa-Guqa**.

Prospecting activities will be undertaken over a period of five (5) years and are designed in phases, each phase conditional on the success of the previous phase. Both invasive and non-invasive methods will be implemented. Desktop study of the area has commenced, and this incorporates desktop geographical and geological mapping. This will be followed by detailed geochemical and geotechnical surveys. In turn, this is followed by detailed geophysical studies and later, a detailed drilling, sampling, assaying and mineralogical study. Diamond core drilling methods will be utilised to prospect in situ ore deposits. To ensure or minimise impacts on the receiving environment, All the activities will be guided by the project's EMPr.

REGULATORY FRAMEWORK

Therefore, EIA process through the compilation of a BAR & EMPr will be undertaken will be conducted in accordance with the National Environmental Management Act (Act 107 of 1998) and Environmental Impact Assessment regulations as amended (April 2017).

The activity is to prospect the existence and occurrence of Gold therefore, this will be conducted in accordance with Mineral and Petroleum Resources Development Act, (Act 28 of 2002). Other regulatory guidelines to be followed include: National Water Act, 1998 (Act 36 of 1998), National Air Quality Standards (GN 1210: 2009) and National Dust Control Regulations (GN 36974: 2013).

These will all be accurately followed to ensure that identified impacts are assessed and mitigated according to their significance so that the protection of the receiving environment and populations is met.

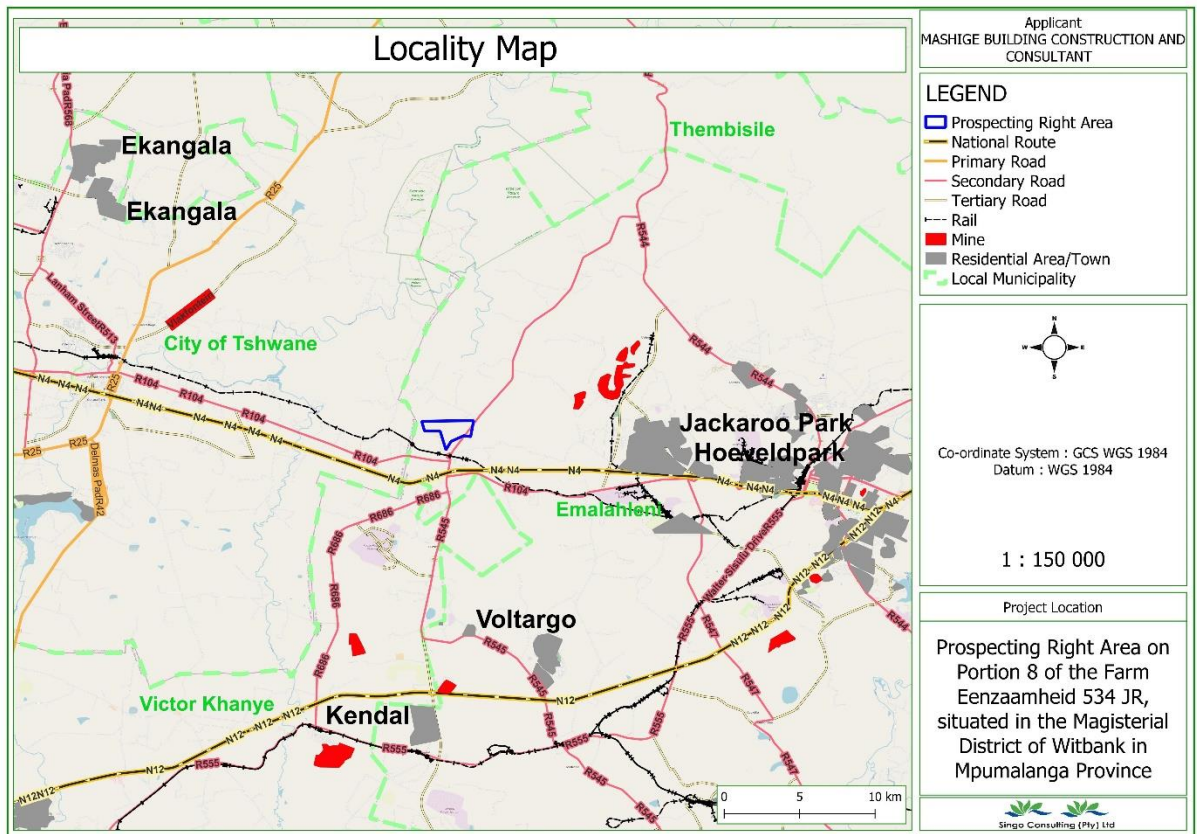

FIGURE 1: LOCALITY MAP OF THE PROPOSED PROJECT.

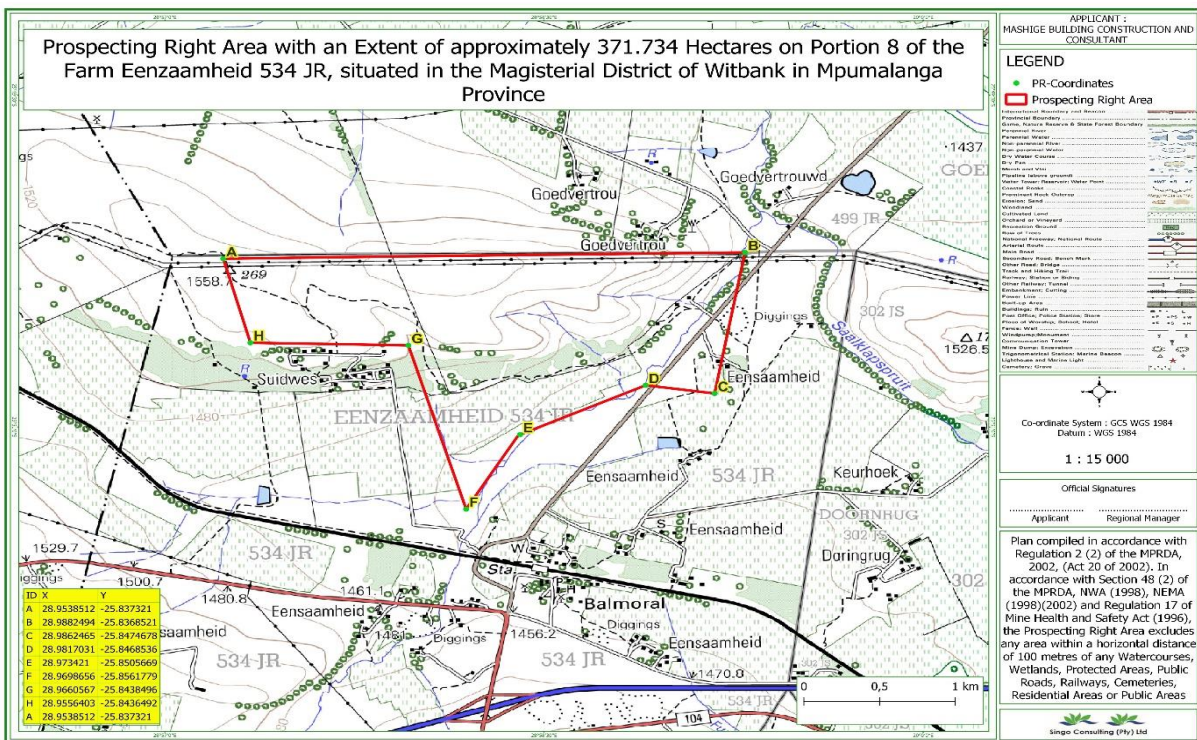

Figure 2: REGULATION 2.2 MAP

BASIC AND ENVIRONMENTAL IMPACT ASSESSMENT PROCESSES

These are planning and decision-making tools used in identifying potential environmental, economic, and social consequences of a proposed activity prior the commencement of the activity.

These together with the public issues and concerns are to be identified sufficiently early so that they can be assessed and incorporated into the final reports when/if necessary.

These tools are regarded crucial because they are utilized in order to demonstrate to the relevant stakeholders about the potential impacts, which in turn leads to the prospecting rights application process being a success or declined.

PUBLIC PARTICIPATION PROCESS

Public Participation remains a cornerstone of the Environmental Impact Assessment process. It ensures provision of relevant and enough information with openness and transparency. Public Participation process presents to I&APs, an opportunity to understand what the project is about, and affords them an opportunity to make valuable contributions towards the EIA process.

I&APs can be any person, group of persons or organization interested in or affected by the proposed activity, and any organ of state that may have jurisdiction over any aspect of the activity.

The key objective of PPP during the compilation of the BAR & EMPr is to afford the I&APs with an opportunity to comment and provide valuable inputs during the planning phase of the project.

For this specific proposed project, I&APs will be given a period of 30 days to comment and raise issues/concerns with regards to this BID.

Kindly keep the following dates:

❖ Stakeholder engagement and consultation: **On-going throughout the process of compiling the BAR & EMPr**

❖ Review of Draft Basic Assessment Report: **Monday the 28th of March 2022 - Tuesday the 3rd of May 2022.**

The Report will be made available at The Lynnville Public Library and Emalahleni local Municipality. Furthermore, the report will be available upon request, via email from the respective EAP.

For comments or concerns about the proposed project, please contact Singo Consulting (Pty) Ltd, using the detailed EAP's contacts below.



Office No: 870
 Balalaika Street,
 Tasbet Park Ext 2, Witbank
 1035
Tel: +27 72 832 1117/ +27 13 692 0041
Fax: +27 86 5144 103
Email: simangaliso@singoconsulting.co.za/
admin@singoconsulting.co.za

REGISTRATION & COMMENT SHEET (DMRE REF: MP 30/5/1/1/2/17271 PR)

Attention: **Jiyane Simangaliso**

Email: simangaliso@singoconsulting.co.za

Title	Name	Surname
Company		
Designation		
Address		
Tel No.	Fax No.	
E-mail	Cell No.	
I would like to receive my notifications be (mark with "X"):	Post <input type="checkbox"/>	E-mail: <input type="checkbox"/> Fax: <input type="checkbox"/>
Please indicate why you would have an interest in the above-mentioned project.		
Please provide your comments and questions here:		
<i>Please feel free to attach a separate document</i>		
Please add any person you think may be interested and affected parties:		
Full name	Company	
Address		
E-mail	Contact No.	