

S.G. No. 441/2017

APPROVED:

Bidaba

for SURVEYOR-GENERAL

DATE: 11-07-2017

SHEET 1 OF 3 SHEETS

ACT 16 OF 2013

SPLUMA 01/2015 BA (DP)

GENERAL PLAN

(CONSISTING OF 3 SHEETS)

* 20 ERVEN NUMBERED 1097-1115 AND 1306 SHEFFIELD BEACH

COMPRISING PORTIONS 744-763

of the farm Lot 61 No. 1521

(SITUATE ON PORTION 581 (of 290) of the farm Lot 61 No. 1521 vide Diagram S.G. No. 2109/1993 and Deed of Transfer No. 16558/1997)

SITUATE IN THE KWADUKUZA MUNICIPALITY REGISTRATION DIVISION - FU, PROVINCE OF KWAZULU-NATAL

* PORTIONS 744-763 REDESIGNATED AS ERVEN 1097-1115 AND 1306 SHEFFIELD BEACH

SERVITUDE NOTES

- Portions 744 to 745 and 751 to 761 are all subject to a 3,00 metre wide Planting and Services Servitude as shown.
- Portions 757 and 760 are both subject to a Non-development Servitude as shown.
- Portions 757, 759, 760 and 763 are all subject to a Wetland Buffer servitude as shown.
- Portion 763 is subject to a Pump Site Servitude vide diagram S.G. No. 1520/1956 and Deed of Transfer No. 5701/1957

AREAS	
PORTION No.	SQUARE METRES
744	1248
745	1231
746	1112
747	924
748	923
749	930
750	948
751	1213
752	939
753	1100
754	1132
755	1257
756	1232
757	4082
758	929
759	990
760	1065
761	1167
762	2477
763	2,5087 ha

BEACON DESCRIPTIONS

- MAIN FIGURE
 A, B, C, J ----- 16mm Iron peg
 D ----- 20mm Iron pipe
 E ----- 12mm Iron peg
 F ----- 12mm Iron peg in concrete
 G ----- no beacon
 H ----- 16mm Iron peg in concrete
- ERF BEACONS
 746a, 748a ----- no beacons
 All other beacons ----- 12mm Iron peg
- INDICATORY BEACONS
 X1, X2, X3 ----- 12mm Iron peg
- REFERENCE MARKS
 RM3, RM4 ----- 16mm Iron peg below the ground

CO-ORDINATES

System : WGS 31
Constants Y +0.00 X +3 200 000.00

MAIN FIGURE

SIDES (metres)	ANGLES OF DIRECTION	Y		X	
		Y	X	Y	X
A B	321.59.10	- 24 722.65	+ 62 645.28		
B C	327.30.10	- 24 824.31	+ 62 776.33		
C D	47.18.00	- 24 840.27	+ 62 801.38		
D E	44.47	- 24 813.50	+ 62 826.08		
E F	58.14	- 24 797.23	+ 62 867.46		
F G	137.38	- 24 801.55	+ 62 925.44		
G H	224.57	- 24 702.16	+ 63 020.28		
H A	226.78	- 24 586.61	+ 62 827.72		
INDICATORY DATA					
J C	0.19	- 24 702.30	+ 63 020.15		

INDICATORY BEACONS

X1	- 24 727.59	+ 62 940.88
X2	- 24 728.57	+ 62 931.87
X3	- 24 735.08	+ 62 921.23

BLOCK CORNERS

BLOCK CORNERS		BLOCK CORNERS	
Y	X	Y	X
101	- 24 741.58	+ 62 982.66	+ 62 877.85
102	- 24 727.39	+ 62 981.96	+ 62 861.99
103	- 24 717.13	+ 62 978.07	+ 62 861.48
104	- 24 692.53	+ 62 946.27	+ 62 862.03
105	- 24 686.70	+ 62 935.38	+ 62 856.63
106	- 24 680.71	+ 62 907.61	+ 62 852.46
107	- 24 671.84	+ 62 886.96	+ 62 848.96
108	- 24 666.89	+ 62 879.03	+ 62 849.25
109	- 24 657.75	+ 62 870.30	+ 62 859.23
110	- 24 651.20	+ 62 871.76	+ 62 877.03
111	- 24 646.24	+ 62 868.01	+ 62 896.00
112	- 24 646.02	+ 62 861.62	+ 62 903.78
113	- 24 652.09	+ 62 857.09	+ 62 912.94
114	- 24 670.97	+ 62 875.52	+ 62 939.91
115	- 24 676.71	+ 62 884.36	+ 62 944.47
116	- 24 685.37	+ 62 905.93	+ 62 972.22
117	- 24 687.49	+ 62 912.93	+ 62 975.75
118	- 24 690.81	+ 62 915.27	+ 62 973.29
119	- 24 695.69	+ 62 911.04	+ 62 931.06
120	- 24 702.49	+ 62 901.12	+ 62 928.22
121	- 24 705.30	+ 62 894.53	+ 62 909.37

SHEET INDEX



CERTIFIED A TRUE COPY OF THE ORIGINAL DOCUMENT!

Carla Jane Martin
 CARLA JANE MARTIN
 COMMISSIONER OF OATHS
 PRACTISING ATTORNEY IN S.A.
 GARLICK & BOUSFIELD INCORPORATED
 7 TORISVALE CRESCENT, LA LAGUNA

Surveyed in April 2015, May 2016 and January-February 2017 by me

C. J. Fourie

C. J. Fourie
Professional Land Surveyor
Registration No. PLS 1078

File No. 1521 VOL. 2 SHEFFIELD BEACH/3 VOL3

Survey Records: SR 124/2017

Compilation: FU - 30 - 21A

S.G. No. 441/2017

APPROVED

S. Mkhabela

for SURVEYOR-GENERAL

DATE: 11 - 07 - 2017

SHEET 2 OF 3 SHEETS

ACT 16 OF 2013

SPLUMA 01/2015 BA (DP)

GENERAL PLAN (CONSISTING OF 3 SHEETS)

ERVEN 1097-1115 AND 1306 SHEFFIELD BEACH
COMPRISING PORTIONS 744-763
of the farm Lot 61 No. 1521

SITUATE IN THE KWAZULU-NATAL MUNICIPALITY
REGISTRATION DIVISION - FU, PROVINCE OF KWAZULU-NATAL
SCALE 1:300



Surveyed in April 2015, May 2016 and
January-February 2017 by me

C.J. Louie
Professional Land Surveyor
Registration No. FLS 1076

File No. 1521 VOL. 2
SHEFFIELD BEACH/3 VOL3
Survey Record: SB 132/2017
Compilation: FD - 30 - 21A

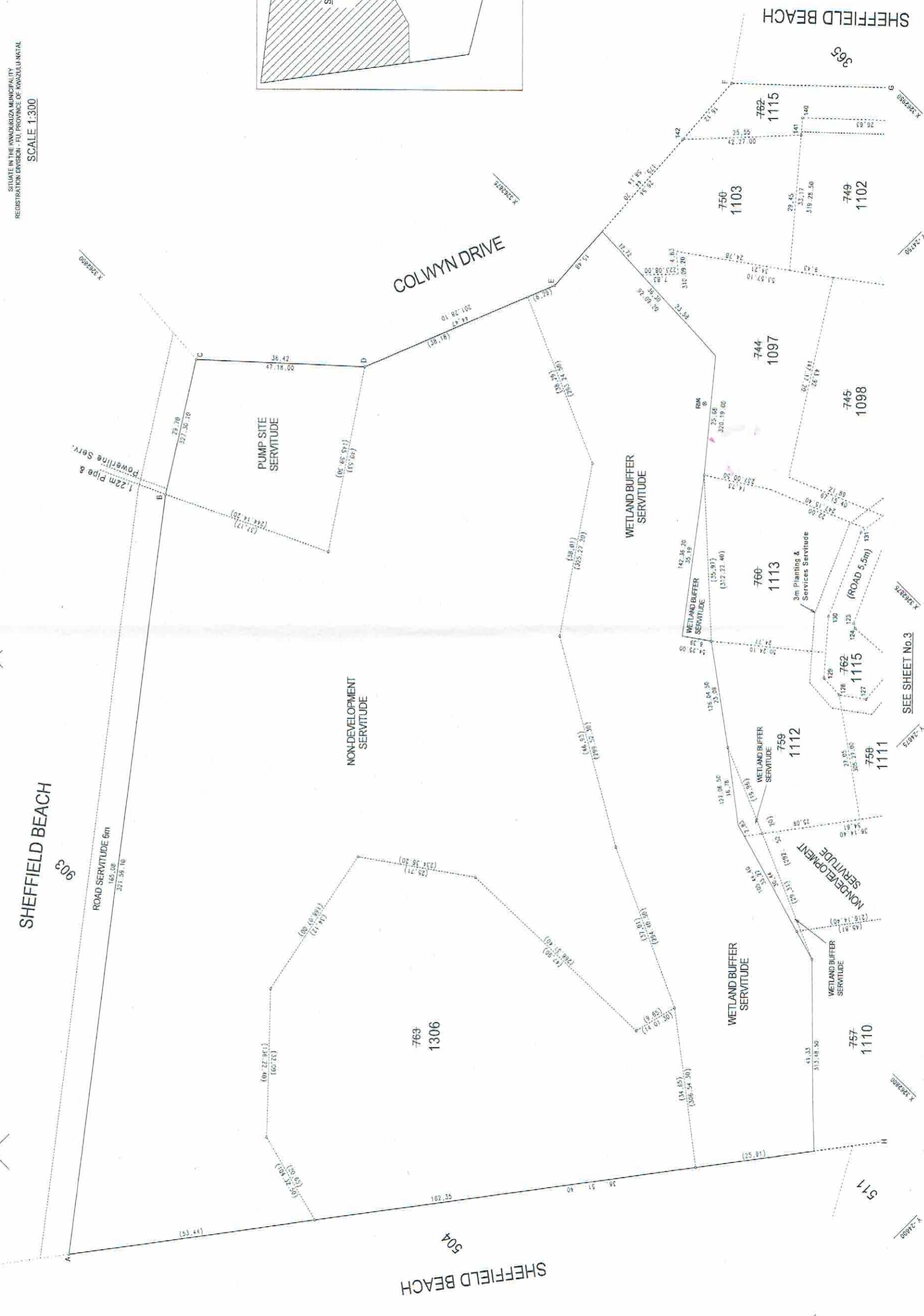

SEE SHEET No.3

S. G. No. 441/2017

APPROVED:

Sudhakar

DATE: 11-07-2017

SHEET 3 OF 3 SHEETS

ACT 16 OF 2013
SPLUMA 01/2015 BA (DP)

GENERAL PLAN

(CONSISTING OF 3 SHEETS)

ERVEN 1097-1115 AND 1106 SHEFFIELD BEACH
COMPRISING PORTIONS 744-763
of the farm Lot 61 No. 1521

SITUATE IN THE KWAZULU MUNICIPALITY
REGISTRATION DIVISION - FOL PROVINCE OF KWAZULU-NATAL
SCALE 1:300

SEE SHEET No.2

NON-DEVELOPMENT
SERVITUDE

WETLAND BUFFER
SERVITUDE

WETLAND BUFFER
SERVITUDE

NON-DEVELOPMENT
SERVITUDE

WETLAND BUFFER
SERVITUDE

CONSERVATION SERV. 15m

COLWYN DRIVE

SHEFFIELD BEACH

SHEFFIELD BEACH

SHEFFIELD BEACH

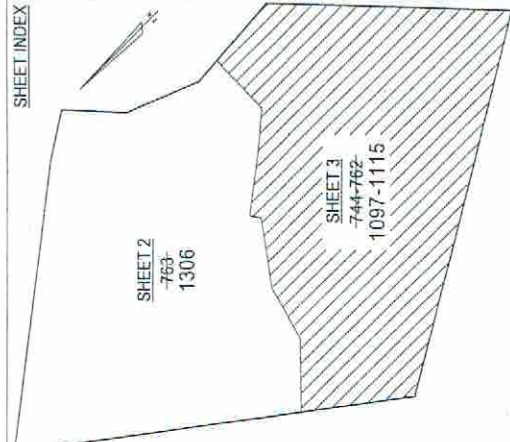
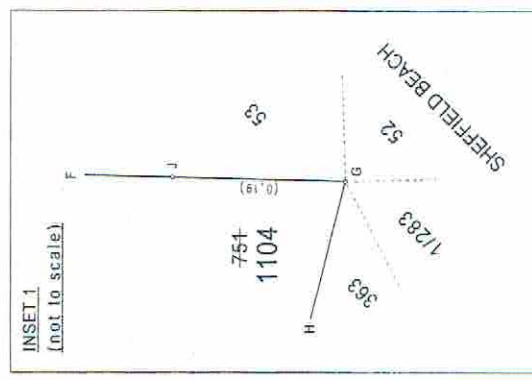

Surveyed in April 2015, May 2016 and
January-February 2017 by me

C. J. Fennie
Professional Land Surveyor
Registration No. R5 1008

File No. 1521 VOL. 2
SHEFFIELD BEACH/3 VOL. 3
Survey Records: SR 124/2017
Compilation: FO - 10 - 21A

