



COPYRIGHT

THIS DRAWING IS SUBJECT TO COPYRIGHT AND MAY NOT BE REPRODUCED IN WHOLE OR PART OR IN ANY MANNER WHATSOEVER WITHOUT WRITTEN PERMISSION FROM THE ARCHITECT

LEGEND:

-  9.5mm suspended gypsum ceiling, skimmed & painted.
-  9.5mm raked gypsum ceiling in between timber rafters, skimmed & painted. Ceiling boards to be moisture resistant where used externally.
-  Skimmed & painted concrete soffit.

AUTHORITY STAMPS

SIGNATURES

- ARCHITECT
STEFANO VATTERONI
- CLIENT
- ENGINEER

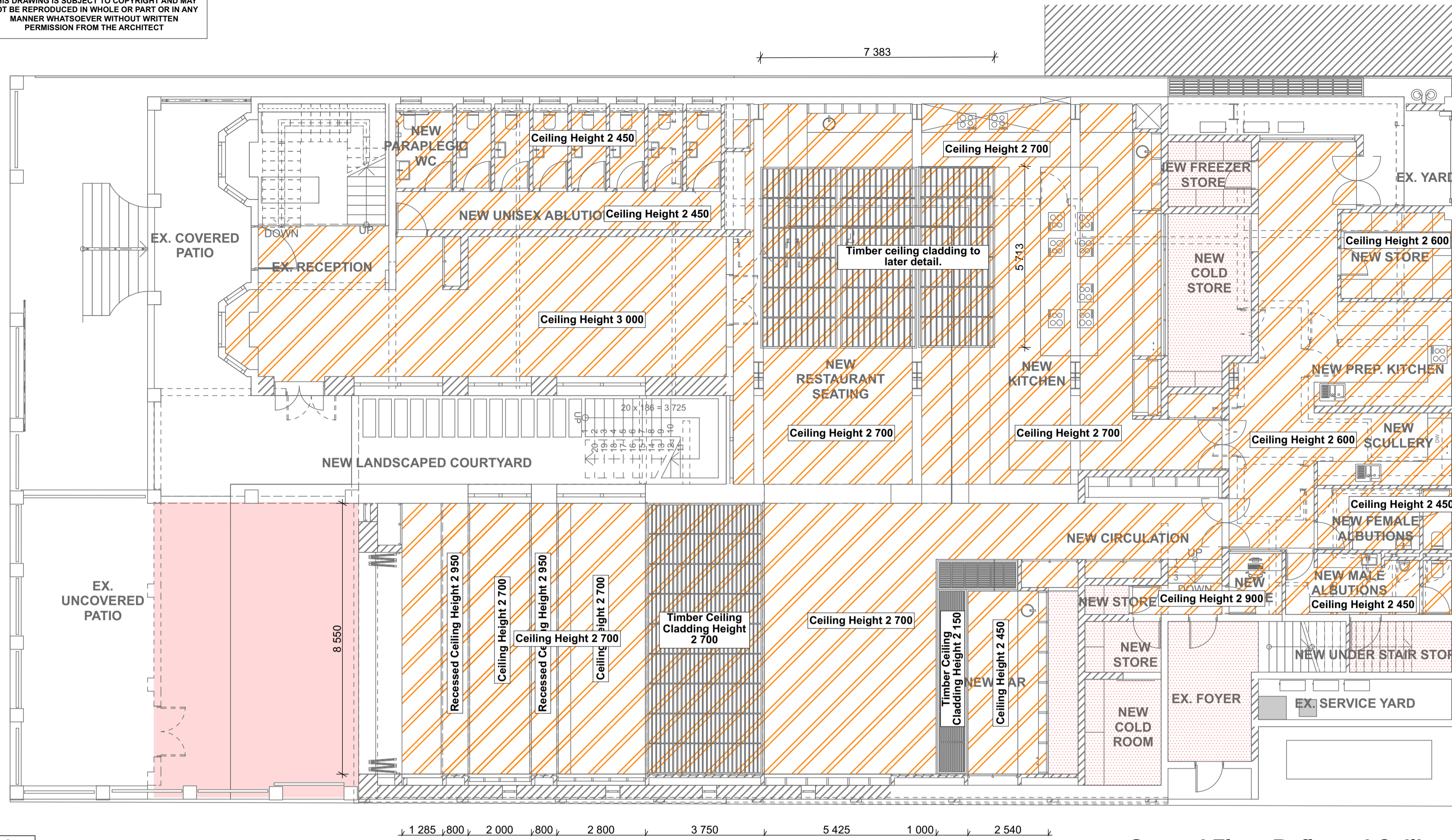

Ground Floor Reflected Ceiling Plan
1:100

1.

-

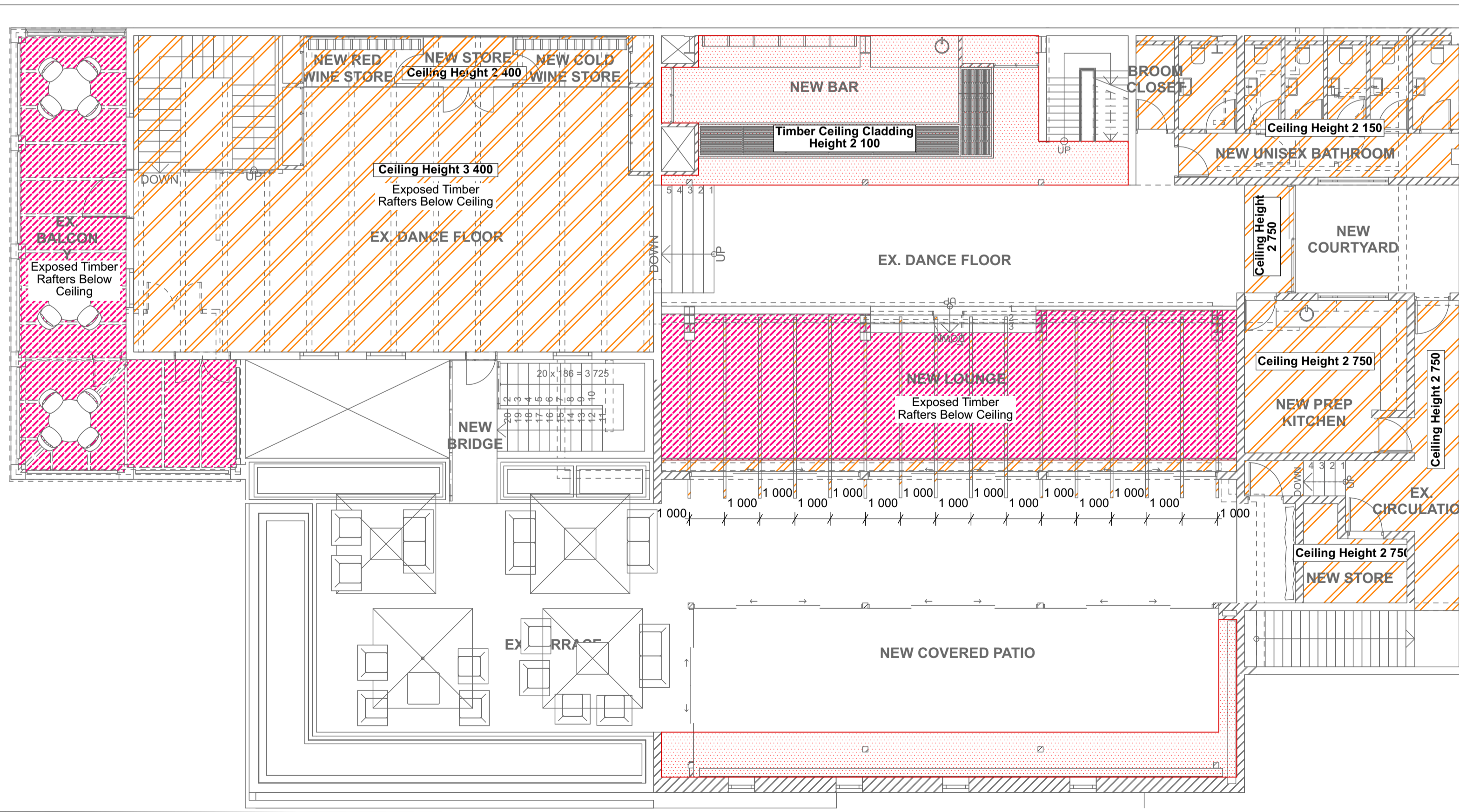

First Floor Reflected Ceiling Plan
1:100

2.

-

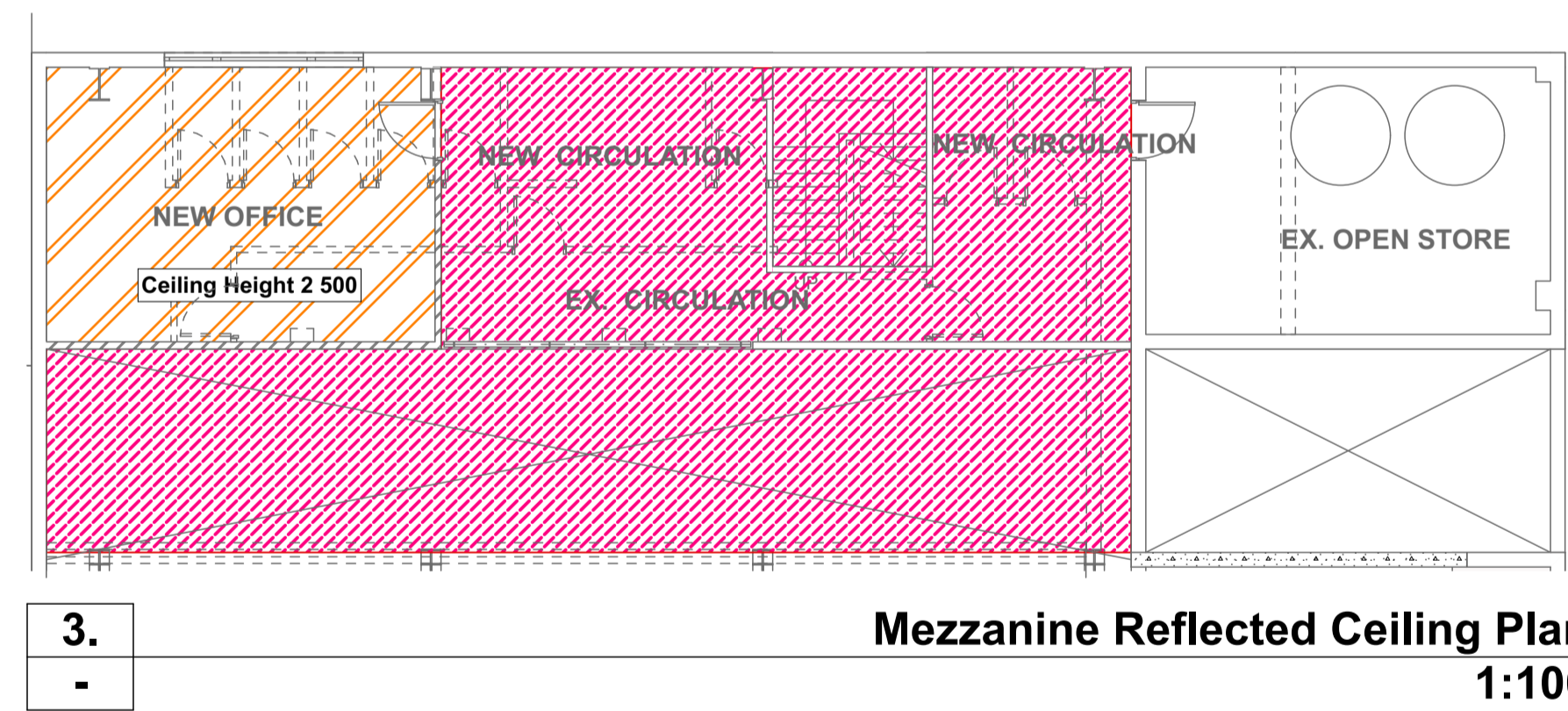

Mezzanine Reflected Ceiling Plan
1:100

3.

-



COUNCIL SUBMISSION

REV	DATE	DESCRIPTION	REVISIONS



Stefano Vatteroni Architects
B.Arch (UCT) Pr. Arch. M.I. Arch. CIA KZ-NIA

SOUTH AFRICA
SUITE 41A ROYAL PALMS
GATEWAY USMANGA phone +27 - 082820257
Durban
KZN 4320
stefanovatteroni@zyma.com
reg: 2010/05329423 SACAP NO: 7189

MALAWI
P.O. BOX 820 LILONGWE
reg: MBRS 1022118 MIA reg: 746

Client Information
Names:
Contact No: #Client Phone Number
Email: #Client E-mail

Job Title
**PROPOSED REFURBISHMENT WITH
ADDITIONS & ALTERATIONS**

ZHYMA RESTAURANT
153 FLORIDA ROAD, DURBAN
ERF 910

Drawing Name
REFLECTED CEILING PLANS

Drawn on Apple Mac computer using Archicad 23 by
NKCUBEKO NDLELA 2023/04/28
Checked by Date
STEFANO VATTERONI 2023/04/28

Drawing Scale
1:10000

Building Occupancy **A1**

Layout ID Page Size Revision
CS.107 A1