

Elaine

From: Annlin Matabane <amatabane@sahra.org.za>
Sent: Monday, 01 July 2019 11:21 AM
To: elaine@lokisa.co.za
Cc: Mimi Seetelo; Thingahangwi Tshivhase
Subject: RE: NOTICE FOR BASIC ASSESSMENT - PROPOSED TELECOMMUNICATION MAST FOR VODACOM - BS 0151974 RIETPAN REF NR GAUT 002/19-20/E2405

Good Day,

I trust this finds you well. Please assist me with the relevant Case ID on SAHRIS for processing.

Thank you,

From: Mimi Seetelo <MSeetelo@sahra.org.za>
Sent: 07 June 2019 05:14 AM
To: Thingahangwi Tshivhase <TTshivhase@sahra.org.za>
Cc: Annlin Matabane <amatabane@sahra.org.za>
Subject: FW: NOTICE FOR BASIC ASSESSMENT - PROPOSED TELECOMMUNICATION MAST FOR VODACOM - BS 0151974 RIETPAN REF NR GAUT 002/19-20/E2405

fyi

From: Elaine <elaine@lokisa.co.za>
Sent: Friday, 24 May 2019 9:38 AM
To: Mimi Seetelo <MSeetelo@sahra.org.za>
Subject: NOTICE FOR BASIC ASSESSMENT - PROPOSED TELECOMMUNICATION MAST FOR VODACOM - BS 0151974 RIETPAN REF NR GAUT 002/19-20/E2405

M. Seetelo

SAHRA

NOTICE OF AN ENVIRONMENTAL IMPACT ASSESSMENT PROCESS FOR BASIC ASSESSMENT – PROPOSED TELECOMMUNICATION MAST FOR VODACOM – BS 0151974 RIETPAN (PORTION 28 OF THE FARM GROENFONTEIN NO 395 IR) REF NR GAUT 002/19-20/E2405

Attached please find notice for your attention.

Elaine Minnaar
LOKISA ENVIRONMENTAL CONSULTING CC
TEL (012) 346 7655
FAX (012) 346 6074
Cel: 082 493 9616
elaine@lokisa.co.za
www.lokisa.co.za

Mimi Seetelo

Manager: Burial Grounds Graves

South African Heritage Resources Agency
- A nation united through heritage -

T: 012 320 8490/ 4965| C:| F:+27 12 320 8486
E: MSeetelo@sahra.org.za | 432 Paul Kruger Street | Pretoria |

www.sahra.org.za



Annlin Matabane

Burial Grounds Graves: Intern

South African Heritage Resources Agency
- A nation united through heritage -

T: 012 320 8490 /4968| C:| F:+27 12 320 8486
E: amatabane@sahra.org.za | 432 Paul Kruger Street | Pretoria |

www.sahra.org.za



Reyneke, Sandra (S)

F (N109 647)

From: Elaine <elaine@lokisa.co.za>
Sent: Friday, May 24, 2019 9:36 AM
To: Gas-Sherq
Subject: NOTICE FOR BASIC ASSESSMENT - PROPOSED TELECOMMUNICATION MAST FOR VODACOM - BS 0151974 RIETPAN REF NR GAUT 002/19-20/E2405
Attachments: AD notice Rietpan.doc; Acknowledgment of Receipt of Notice.doc; P2660-05-Rietpan-Lattice Layout.pdf; P2660-02-Rietpan-Topographic Map.pdf; P2660-03-Rietpan-Cadastral.pdf; P2660-04-Rietpan-Site Plan.pdf

S. Reyneke

SASOL GAS

NOTICE OF AN ENVIRONMENTAL IMPACT ASSESSMENT PROCESS FOR BASIC ASSESSMENT – PROPOSED TELECOMMUNICATION MAST FOR VODACOM – BS 0151974 RIETPAN (PORTION 28 OF THE FARM GROENFONTEIN NO 395 IR) REF NR GAUT 002/19-20/E2405

Attached please find notice for your attention.

Elaine Minnaar
LOKISA ENVIRONMENTAL CONSULTING CC
TEL (012) 346 7655
FAX (012) 346 6074
Cel: 082 493 9616
elaine@lokisa.co.za
www.lokisa.co.za

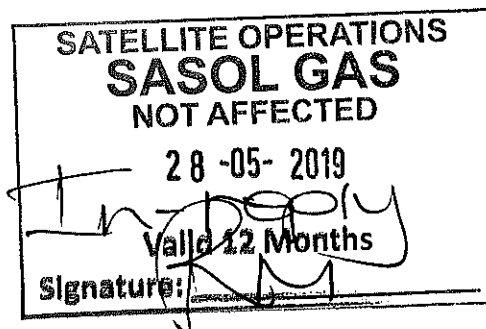

**NOTICE OF AN ENVIRONMENTAL IMPACT ASSESSMENT PROCESS FOR BASIC
ASSESSMENT –
PROPOSED TELECOMMUNICATION MAST FOR VODACOM – BS 0151974 RIETPAN
(PORTION 28 OF THE FARM GROENFONTEIN NO 395 IR)
REF NR GAUT 002/19-20/E2405**

Notice is given in terms of Listing Notice 3 of the Environmental Impact Assessment Regulations, 2014 (as amended) under the National Environmental Management Act, 1998 (Act No 107 of 1998, as amended) that the Environmental Assessment Practitioner is conducting a public participation process on behalf of Vodacom, for the submittal of a Basic Assessment Report to the Gauteng Department of Agriculture and Rural Development (GDARD) for the following activity as identified in terms of section 24(2) and 24d.

Activity listed under GN R985:

Activity 3- The Development of masts or towers of any material or type used for telecommunication broadcasting or radio transmission purposes where the mast or tower: (a) to be placed on a site not previously used for this purpose; and (b) will exceed 15m in height (c) Gauteng (iv) Sites identified as a Critical biodiversity areas and Ecological support areas (ESAs); (v) Sites identified within threatened ecosystems listed in terms of the National Environmental Management Act: Biodiversity Act (Act No. 10 of 2004); (vi) Sensitive areas identified in an environmental management framework adopted by relevant environmental authority.

Project Name: BS 0151974 Rietpan

Project Description: The project entails the Construction of a 45m Lattice Mast within the footprint size of 10m x 10m area and a support container. The site is to accommodate three service providers.

Project Location: The site is situated approximately 6,7km west of the R51 and 8,7km north east of the R23, Lesedi Local Municipality.

Co-ordinates S: 26°32'26.93" E: 28°30'35.10"

Date of Placement of Notice: 23 May 2019

Environmental Consultant: Lokisa Environmental Consulting CC has been appointed as the Environmental Consultants and Elaine Minnaar can be contacted at P.O Box 219, Groenkloof, 0027. Tel: 012 346 7655 Fax: 012 346 6074 Email: elaine@lokisa.co.za

In order to ensure that you are identified as Interested and/or Affected parties please submit in writing the following:

- Contact name
- Telephone Number & Postal Details, and
- Interest in the matter

to the contact person given above within 30 days of publication of this advertisement.

(23 May 2019 – 24 June 2019)

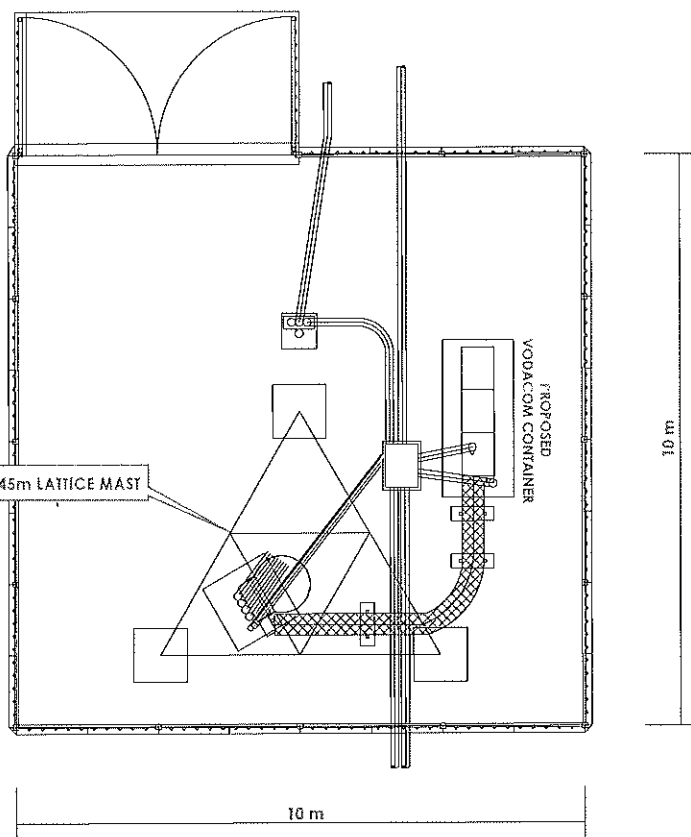

**LATTICE MAST LAYOUT:
RIETPAN**



vodacom

PROJECT DETAILS

SITE NAME: RIETPAN
SITE NUMBER: BS 0151974

PROPERTY DESCRIPTION

**PORTION 28 OF THE FARM
GROENFONTEIN 395 IR**

LOCAL AUTHORITY

LESEDI LOCAL MUNICIPALITY

NOTES

Latitude: 26° 32' 26.93" S
Longitude: 28° 30' 35.10" E
Height above sea level (HASL): 1474m
Mast height: 45m
Mast type: Lattice Mast
Site footprint: 10m x 10m

CONTACT INFORMATION

VODACOM: Buyi Khoza 082 454 6114
TOWER PLANNERS: Umtebe 013 752 4710

PLAN NO: P2459_05

DATE: March 2019

SCALE: 1:2 000

UMSEBE
Development Services

**SPATIAL PLANNING FACILITATION
PROJECT MANAGEMENT CS**

Address: 175
Lime St. 37 Oranje Street, P.O. Box 16507
Midrand 1709
Tel: 013 752 4710 Fax: 011 752 0970
www.umsebe.co.za

**TOPOGRAPHIC MAP:
RIETPAN**



vodacom

PROJECT DETAILS

SITE NAME: RIETPAN
SITE NUMBER: BS 0151974

PROPERTY DESCRIPTION

**PORTION 28 OF THE FARM
GROENFONTEIN 395 IR**

LOCAL AUTHORITY

LESEDI LOCAL MUNICIPALITY

NOTES

Latitude: 28° 32' 26.93" S
Longitude: 28° 30' 35.10" E
Height above sea level (HASL): 1674m
Mast height: 45m
Mast type: Lattice Mast
Site footprint: 10m x 10m

CONTACT INFORMATION

VODACOM: Busi Khoza 082 454 6114
TOWN PLANNERS: Umsebe 013 752 4710

Legend

- Site
- ▨ Pin 28
- Land parcels

PLAN NO: P2640.02	DATE: March 2019	SCALE: 1:60 000
<p>UMSEBE Development Planners</p>		
<p>SPATIAL PLANNING FACILITATION PROJECT MANAGEMENT GIS Suite 3, 39 Empire Street, O.R. Tambo International Airport, Joburg, 1501, 2592 9970 Tel: 013 752 4710, www.umsebe.co.za</p>		

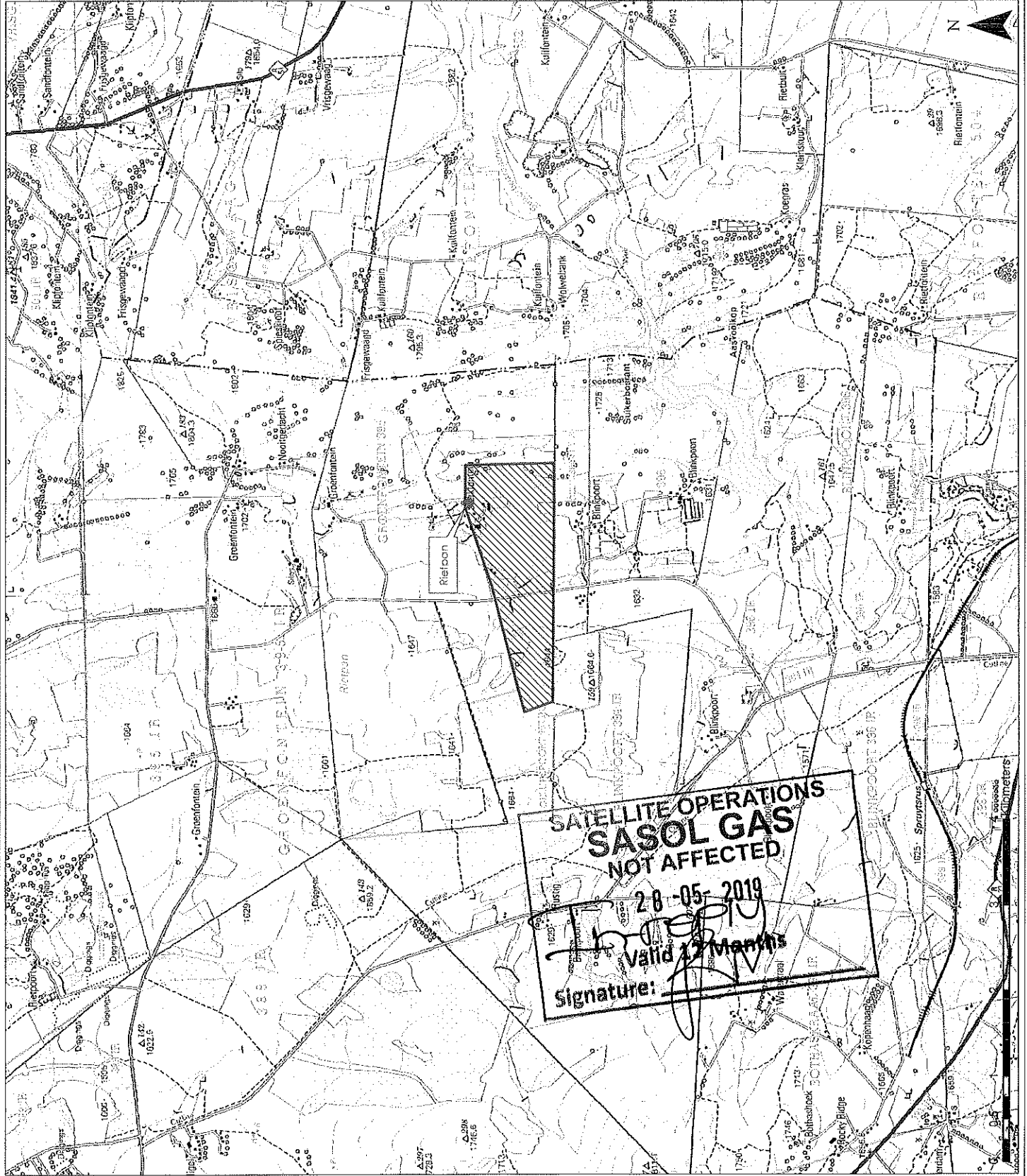

CADASTRAL INFORMATION:
RIETPAN



vodacom

PROJECT DETAILS

SITE NAME: RIETPAN
SITE NUMBER: BS 0151974

PROPERTY DESCRIPTION

**PORTION 28 OF THE FARM
GROENFONTEIN 395 IR**

LOCAL AUTHORITY

LESEDI LOCAL MUNICIPALITY

NOTES

Latitude: 26° 32' 26.93" S
Longitude: 28° 30' 35.10" E

Height above sea level (HASL): 1674m
Mast height: 45m
Mast type: Lattice Mast
Site footprint: 10m x 10m

CONTACT INFORMATION

VODACOM: Busi Khoza 082 454 6114
TOWN PLANNERS: Umsebe 013 752 4710

Legend

- Site
- Pin 28
- Farm portions
- Buildings

PLAN NO: P2660_03
DATE: March 2019
SCALE: 1:15 000

UMSEBE
Development Partners
SPATIAL PLANNING FACILITATION
PROJECT MANAGEMENT GIS
Suite 3, 39 Barkas Street, P.O. Box 12357
Nelson Mandela Square, Sandton, 2009
Tel: 011 752 4710
www.umsebe.co.za

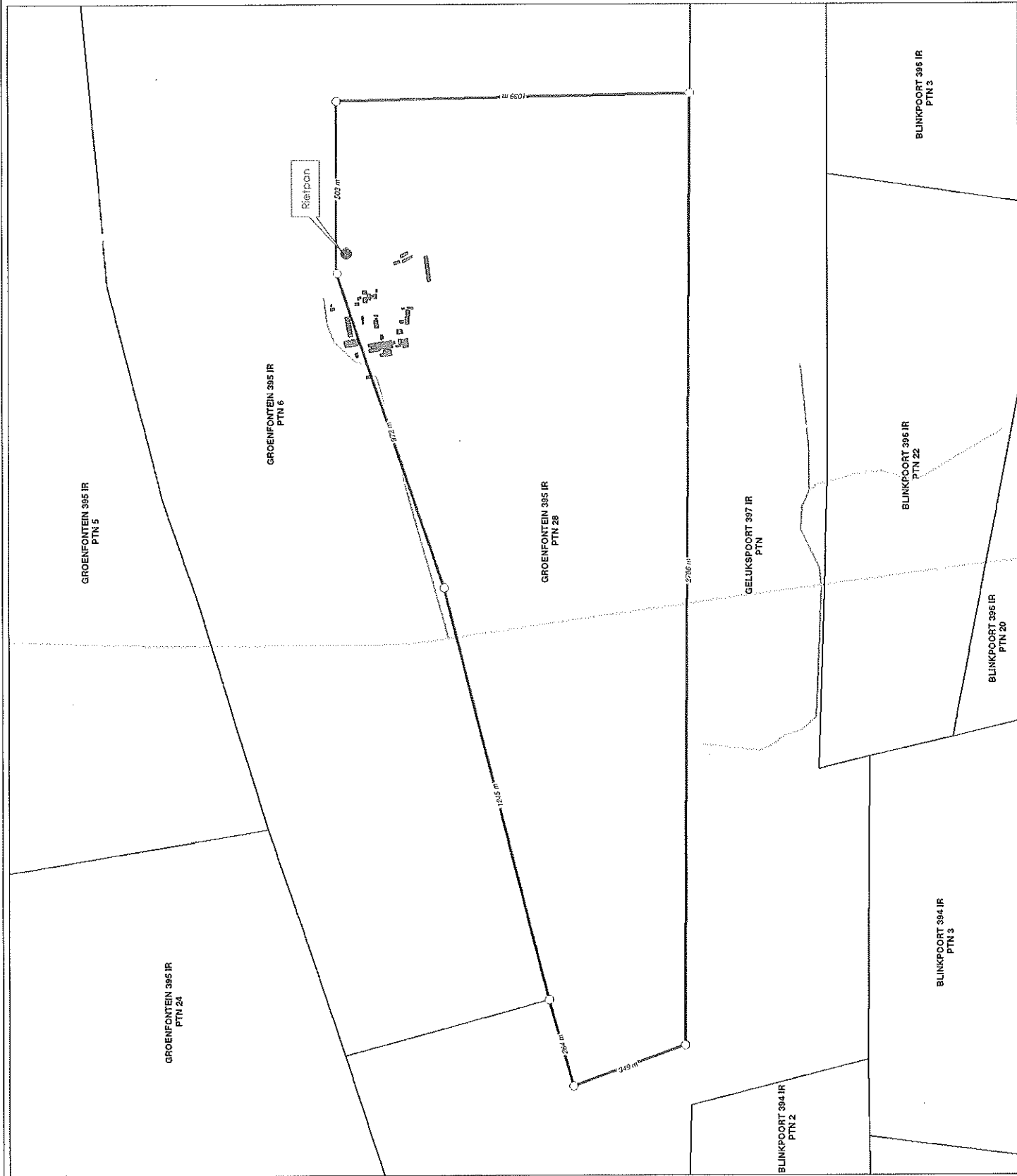

SITE PLAN:
RIETPAN



vodacom

PROJECT DETAILS

SITE NAME: RIETPAN
SITE NUMBER: BS 0151974

PROPERTY DESCRIPTION

**PORTION 28 OF THE FARM
GROENFONTEIN 395 IR**

LOCAL AUTHORITY

LESEDI LOCAL MUNICIPALITY

NOTES



Latitude: 26° 32' 26.93" S
Longitude: 28° 30' 35.10" E

Height above sea level (HASL): 1674m
Mast height: 45m
Mast type: Lattice Mast
Site footprint: 10m x 10m

CONTACT INFORMATION

VODACOM: Busi Khoza 082 454 6114
TOWN PLANNERS: Umsebe 013 752 4710

Legend

-  Mast
-  Land parcels

PLAN NO: PS660_04

DATE: March 2019

SCALE: 1:250

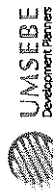

UMSEBE
Development Planners
SPATIAL PLANNING FACILITATION
PROJECT MANAGEMENT GIS
Suite 8 39 Brink Street, P.O. Box 12297
Midrand 1685
Tel: 013 752 4710 Fax: 013 752 4710
www.umsebe.co.za

PORTION 28 OF THE FARM
GROENFONTEIN 395 IR

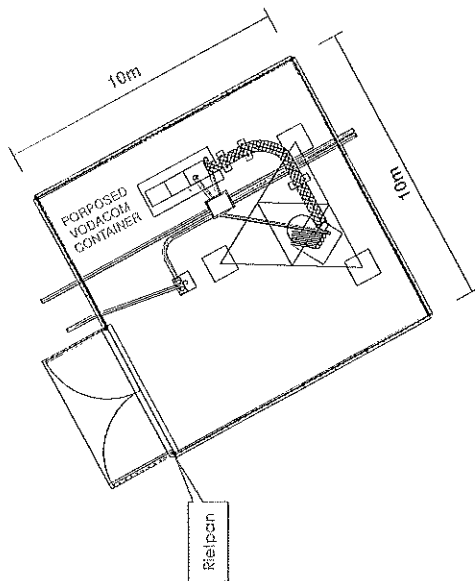



Ref: PYP/W1/07/05/NC/43294

Ms Elain Minnaar
 Lokisa Environmental Consulting CC
 PO Box 219
GROENKLOOF
 0027

Dear Ms Minnaar

**ROW APPLICATION FOR THE PROPOSED TELECOMMUNICATION MAST FOR
 VODACOM – BS 0151974 RIETPAN – ON PORTION 28 OF THE FARM GROENFONTEIN
 NO. 395-IR, LESEDI LOCAL MUNICIPALITY**

Your letter with reference number GAUT 002/19-20/E2405 dated 24 May 2019 has reference.

Transnet Pipelines, a division of Transnet SOC Limited, is not affected by the proposal as indicated on the Groenfontein No. 395-IR Cadastral/Lesedi Local Municipality Locality and Site/Project Layout Plans. This wayleave period is valid for **thirty-six (36) months from the date on this letter.**

Your awareness of the existence of Transnet's pipeline servitudes and concern for their integrity is appreciated.

Yours Sincerely

Thami Hadebe (Mr)
Servitude Management

Date: 24 May 2019

A division of
Transnet SOC Ltd
 Registration Number
 1990/000900/30

202 Anton Leimbode (Smith) Street
 Durban
 4001

P.O. Box 3113
 Durban, South Africa, 4000
 T +27 31 361 1301
 F +27 31 361 1314

Directors: Dr PS Molefe (Chairperson) MS Mahomed* (Acting Group Chief Executive) UN Fikelepi RJ Ganda ME Letlape DC Matshoga Adv OM Motaung Dr FS Mufamadi AP Ramabulana GT Ramphaka LL von Zeuner MD Gregg-Macdonald* (Acting Chief Financial Officer)

*Executive

Group Company Secretary: NE Khumalo

www.transnet.net