

Plan Showing

**PROPOSED SUBDIVISION OF ERF 12696 DURBAN INTO PORTIONS 1, 2 & REMAINDER**

Situate in the eThekweni Municipality :Central Operational Entity, Registration Division FU,Province of KwaZulu-Natal.

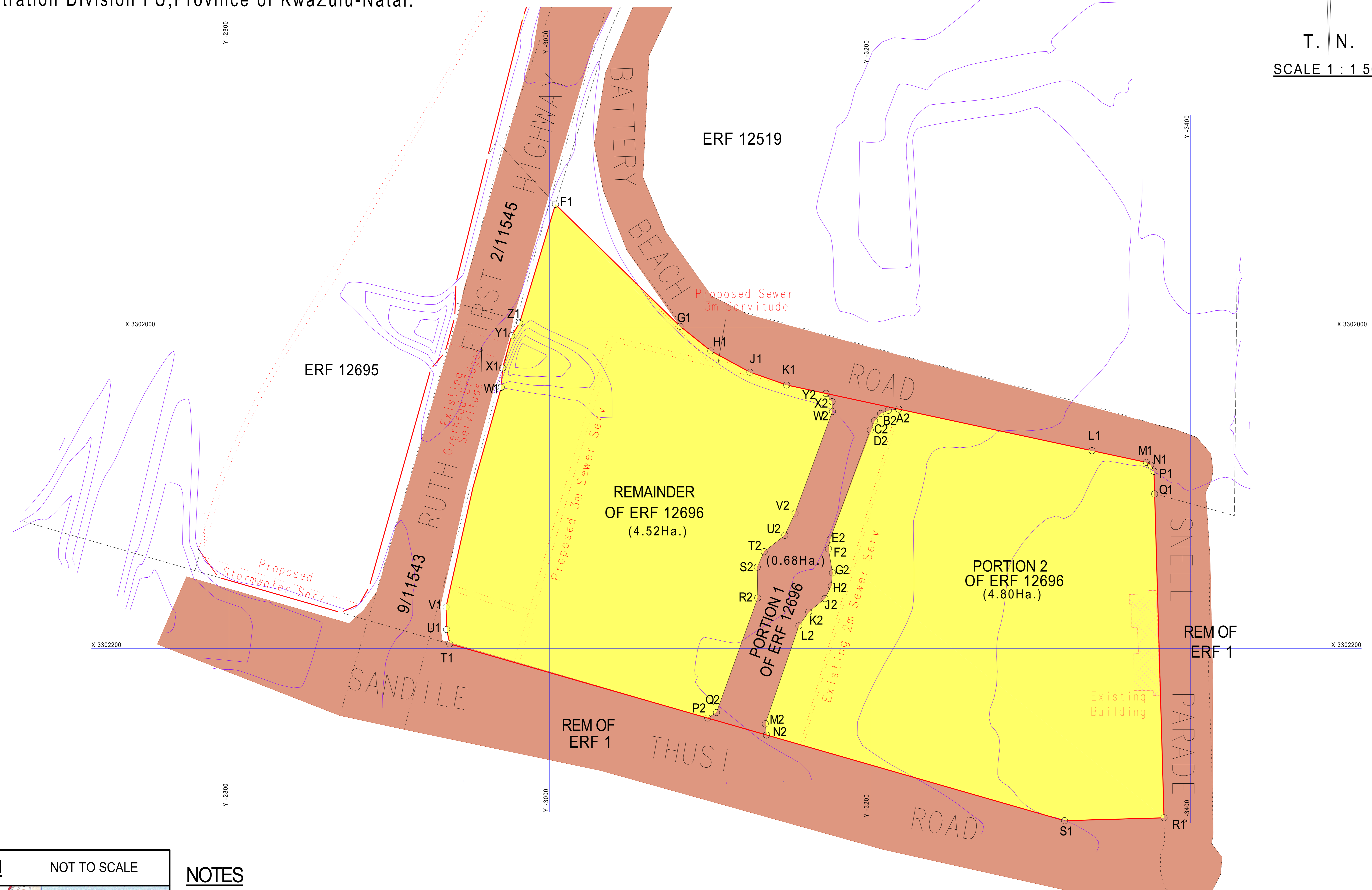
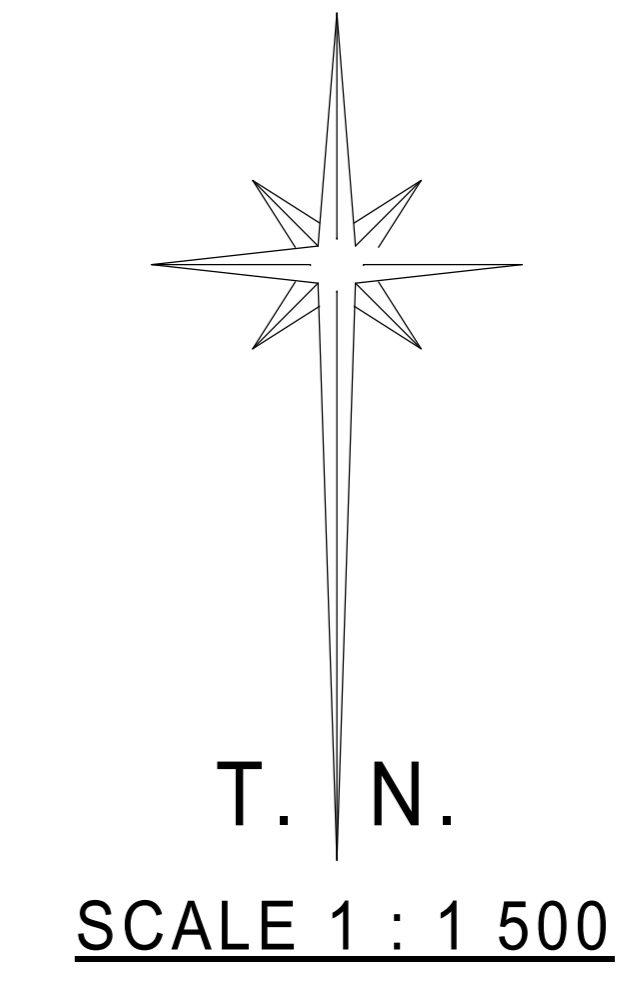

REVISION NOTES.

REV NO.	DESCRIPTION	DATE
001	Consolidation Application.	02/2015
002	CONSOL & SUBDIVISION	05/2016
003	REDESIGNATION	05/2016
004	REDESIGNATION 02	05/2016
005	Plan Update	03/2021

OWNER : ETHEKWINI MUNICIPALITY  
 EXISTING USAGE : GOVERNMENT AND MUNICIPAL  
 DIAGRAM : TO BE CREATED  
 DEED : NOT YET REGISTERED  
 STREET ADDRESS : 31 BATTERY BEACH ROAD  
 191 SNELL PARADE

ALL MEASUREMENTS AND AREAS ARE APPROXIMATE AND SUBJECT TO ACTUAL SURVEY

Prepared by : *W.I.M. Turnbull*  
 W.I.M. TURNBULL Professional Land Surveyor

FILE: Q:DUR11543\APPLICATIONS DATE: March 2021  
 DRAWING : DUR11543 Applic-Plan2 Rev05

Prepared by : **BUTTON & O'CONNOR INC.**  
 Professional Land Surveyors

Telephone 031-2662278 P.O. Box 1863  
 Fax : 031-2669753 Westville  
 16 Westville Centre, 3630  
 52 Norfolk Terrace,  
 Westville. 3630

Tel : (039) 7271564 P.O. Box 1921  
 Fax : (039) 7271564 Kokstad  
 34 Strachan Street 4700  
 Kokstad 4700

REVISION NO : 005  
 DRAWN BY : A.N

LOCALITY SKETCH NOT TO SCALE

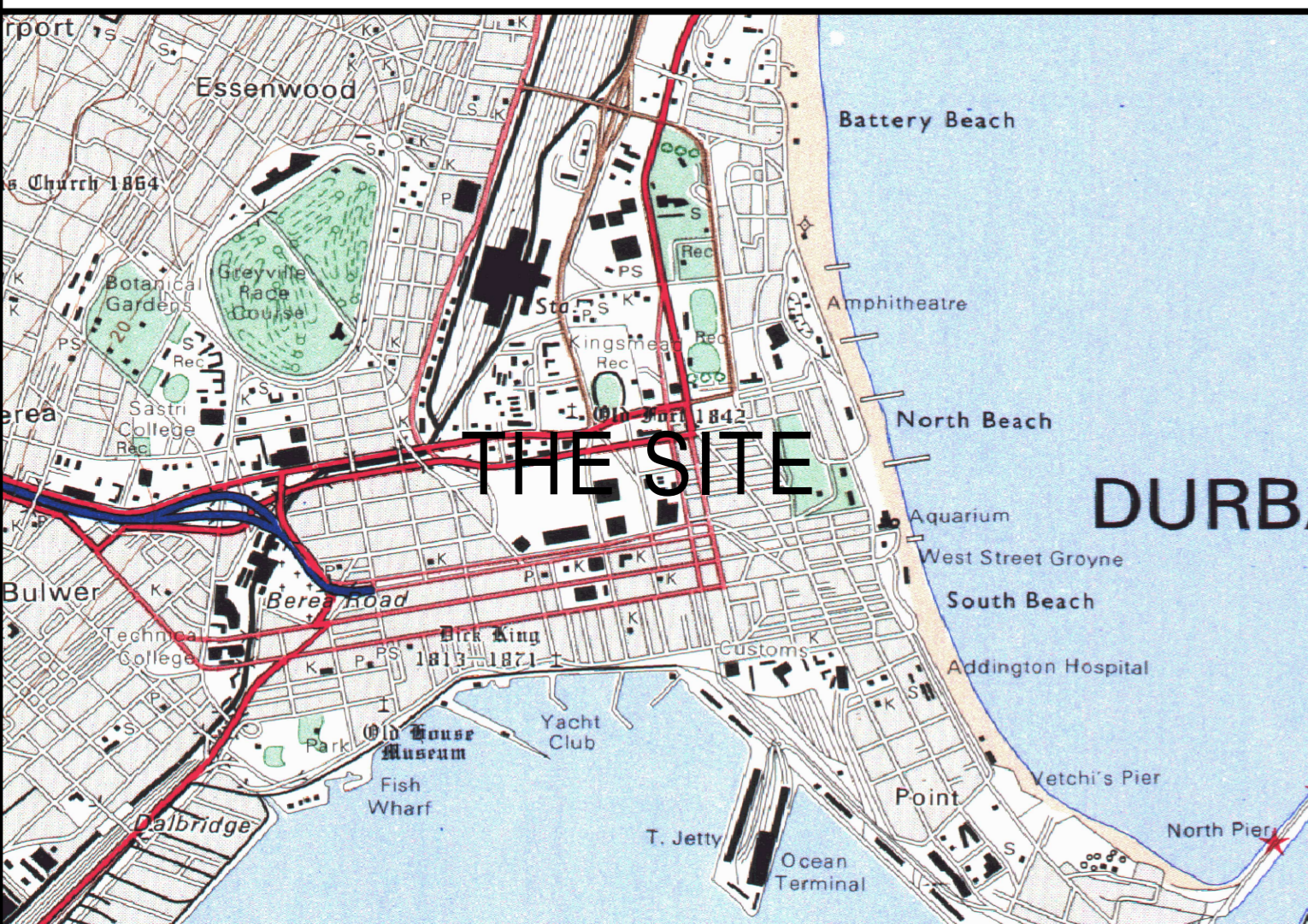

NOTES

- 1) The figure F1-Z1 represents Erf 12696 Durban
- 2) The figure A2-Y2 represents Portion 1 of Erf 12696 Durban, measuring 0.68Ha. in extent.
- 3) The figure A2,L1,M1,N1,P1,Q1,R1,S1,N2,M2,L2,K2,J2,H2,G2,F2,E2,D2,C2,B2 represents Portion 2 of Erf 12696, measuring 4.80Ha. in extent.
- 4) The figure F1,G1,H1,J1,K1,Y2,X2,W2,V2,U2,T2,S2,R2,Q2,P2,T1,U1,V1,W1,X1,Y1,Z1 represents the Remainder of Erf 12696 Durban, measuring 4.52Ha. in extent.
- 5) Data has been compiled from previous surveys and other sources.