

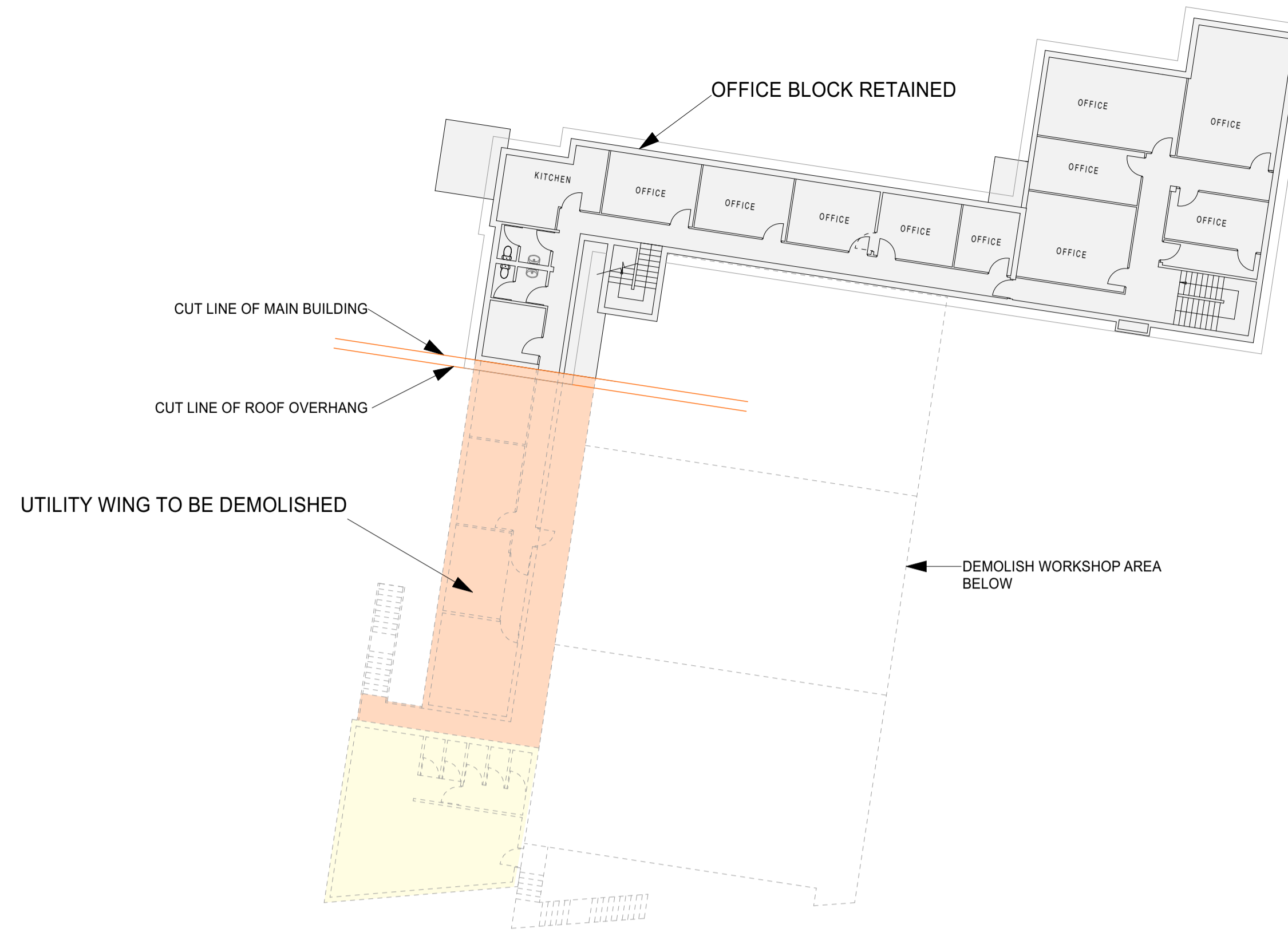

UTILITY WING TO BE DEMOLISHED

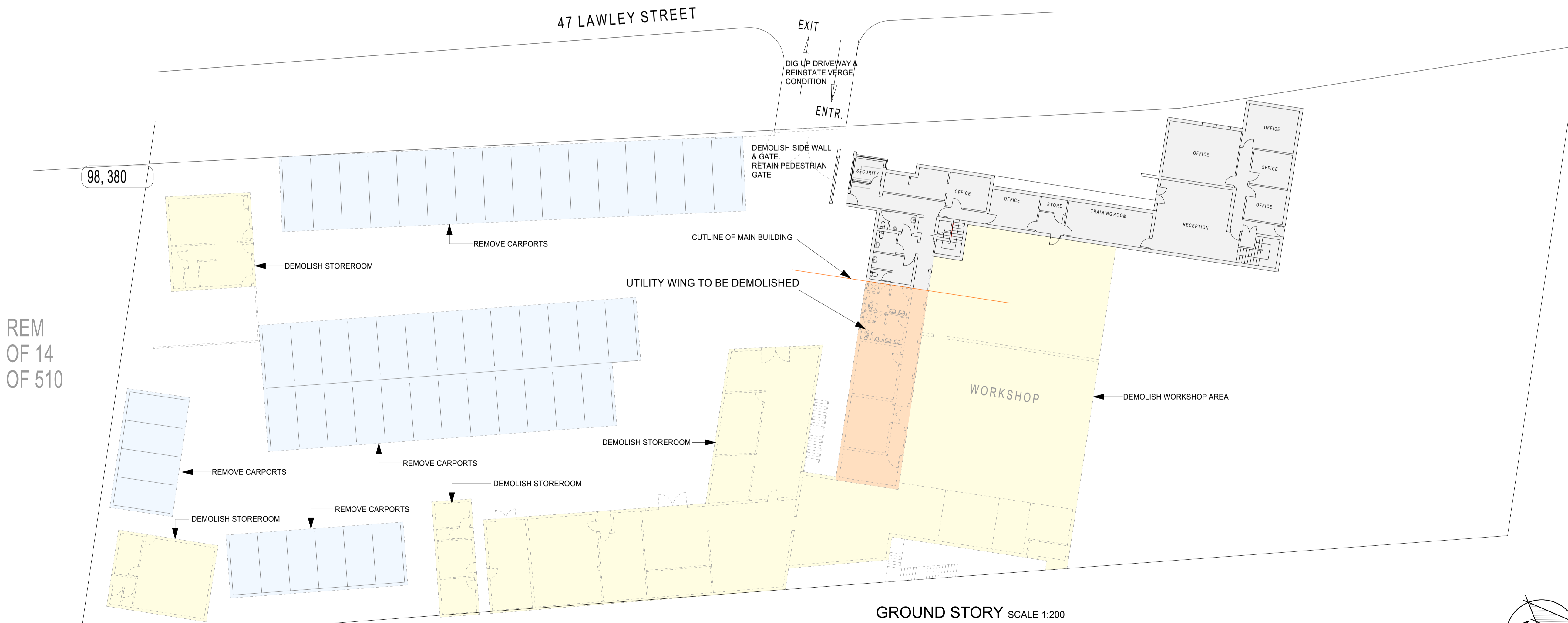

FIRST STORY SCALE 1:200



GROUND STORY SCALE 1:200

COPYRIGHT
 MAB ARCHITECTS are the proprietors of all rights including copyrights in this material. No reproductions are permitted without written consent and statement.
 The elements shown on this drawing are prototypical design only. They may not be utilized, altered, the specification changed, or implemented in part, or in whole, in any structure without notification and written approval being issued by MABIKHWEZI ARCHITECTS cc

- GENERAL CONSTRUCTION NOTES**
1. Figured dimensions are to be taken in preference to scaling from the drawing.
 2. All relevant details, levels, dimensions must be checked on site before commencement of work. Any discrepancies to be reported to the MABIKHWEZI ARCHITECTS cc Office immediately.
 3. All work to be carried out in strict accordance with local authority requirements, national building regulations & the SANS standards.



236, Ninth Avenue, Windermere, 4001 P.O. Box 37069, Overport 4067
 Tel: (031) 303 2633 Fax: (031) 312 0896
 Email: admin@mabarchitects.co.za Website: www.mabarchitects.co.za

PROJECT TITLE & CLIENT INFORMATION

Tanker Services | Jacobs Depot

25,33,41,47,85,91 LAWLEY STREET, DURBAN
 REM 9,10,11,12,13 ERF 510 JACOBS

DRAWING DESCRIPTION
 AMAFA APPLICATION
 DEMOLISHING LAYOUT

SCALE 1:100, 1:1	PLOT DATE 2023/09/22	DATE Mar 2022	DRAWN GG
PROJECT No- DRAWING NUMBER 17008 A.04		REVISION	

