

Reference	CAD-Line Survey-LOU
Effective Date	06/12/2016
Revision	0

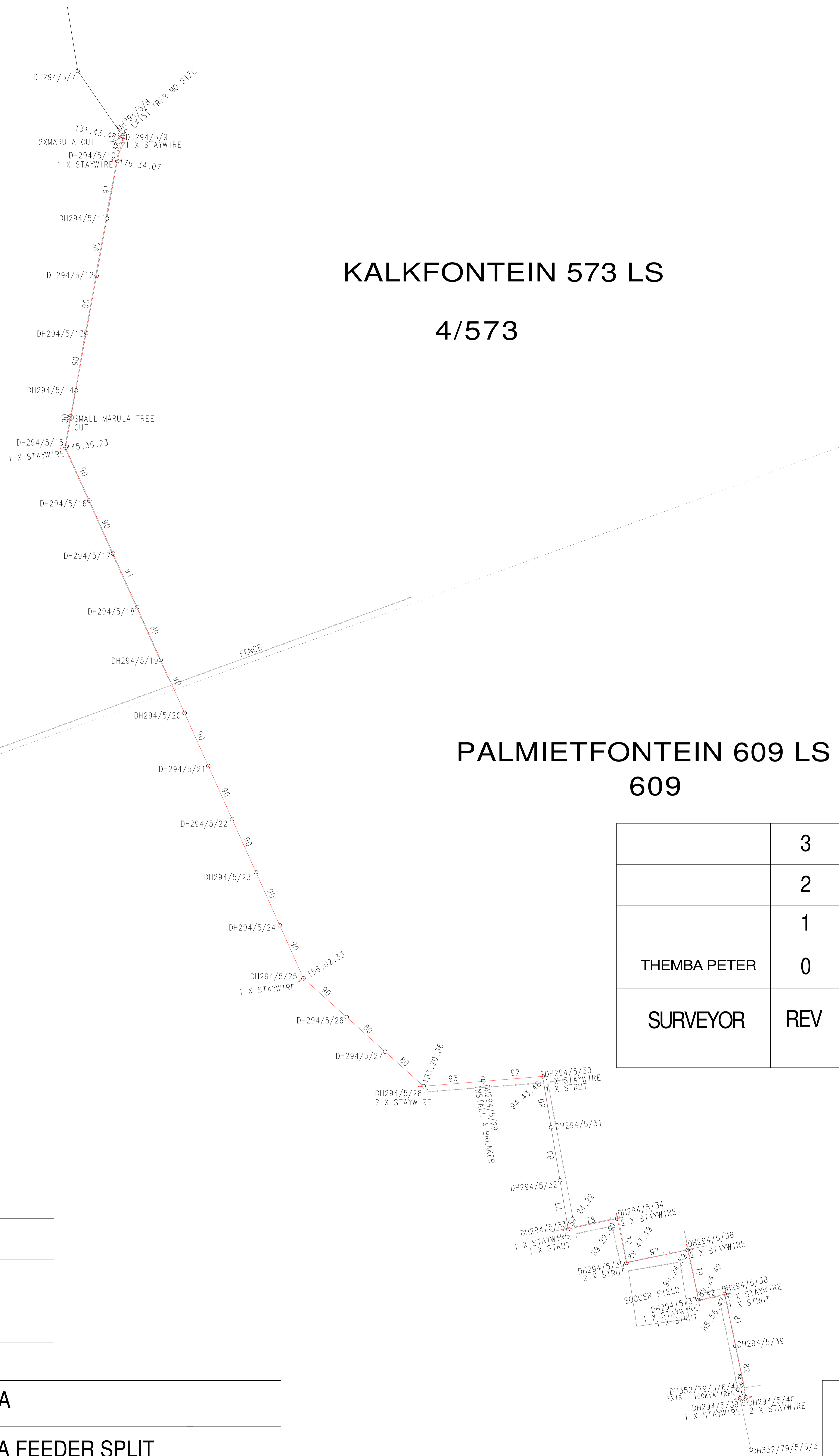

KALKFONTEIN 573 LS

4/573

PALMIETFONTEIN 609 LS

609

	3	
	2	
	1	
THEMBA PETER	0	10/03/2022
SURVEYOR	REV	SURVEY DATE

LEGEND

	NEW MV LINE
	EXIST. MV LINE
	NEW LV LINE
	T.O.O.L

FEEDER NAME: DENDRON HLAHLA	
PROJECT NO: DENDRON HLAHLA FEEDER SPLIT	
CONDUCTOR:	CUSTOMER: ESKOM
LENGTH OF LINE: 2609.8M	PROPERTY: PALMIETFONTEIN 609 LS PTN 4 KALKFONTEIN 573 LS
SURVEYOR: ELALINI SURVEYS	
DRAUGHTSPERSON: THEMBA PETER [+27 63 025 2777]	SCALE: [1:2 500] PAGE: [1] of [1]

THIS DRAWING IS THE PROPERTY OF ESKOM
Disclaimer: Eskom is not responsible for any errors displayed on this drawing