



DEPARTMENT OF ROADS AND TRANSPORT
DEPARTEMENT VAN PAAIE VERVOER
LEFAPHA LA DITSELA LE DIPALANGWA
UMNYANGO WEZEMIGWAQO NEZOKUTHUTHA

Enquiry / Navrae : Mr M Mogane
Ref / Verw : 1/1/3/1/3-18885

Mr. Theuns van Brackel
Professional Planning and Property
Services
P O Box 3237
RANDBURG
2125

7 0 MAR 2011

Sir/Madam

PROPOSED TOWNSHIP: DELMORE PARK EXTENSION 7

Your letter Delmore Park X 7 dated 14 December 2010 has reference

The Department apologizes for the inconvenience caused. You are kindly informed that the amendments as shown on Plan No. 2588/A3 dated February 2009 are acceptable to this Department.

Yours faithfully

**DEPUTY DIRECTOR: TRANSPORT AND DEVELOPMENT
FACILITATION
MR DA EMETT**

Contours are in accordance with the standards laid down in regulation 18(2) and (3) of the Town Planning and Townships regulations, 1986 Contours are in 1,0m intervals Date : Sea Level



RE/24/85

DRIEFONTEIN 85-IR

DELMORE PARK EXTENSION 2

KATONKEL STREET

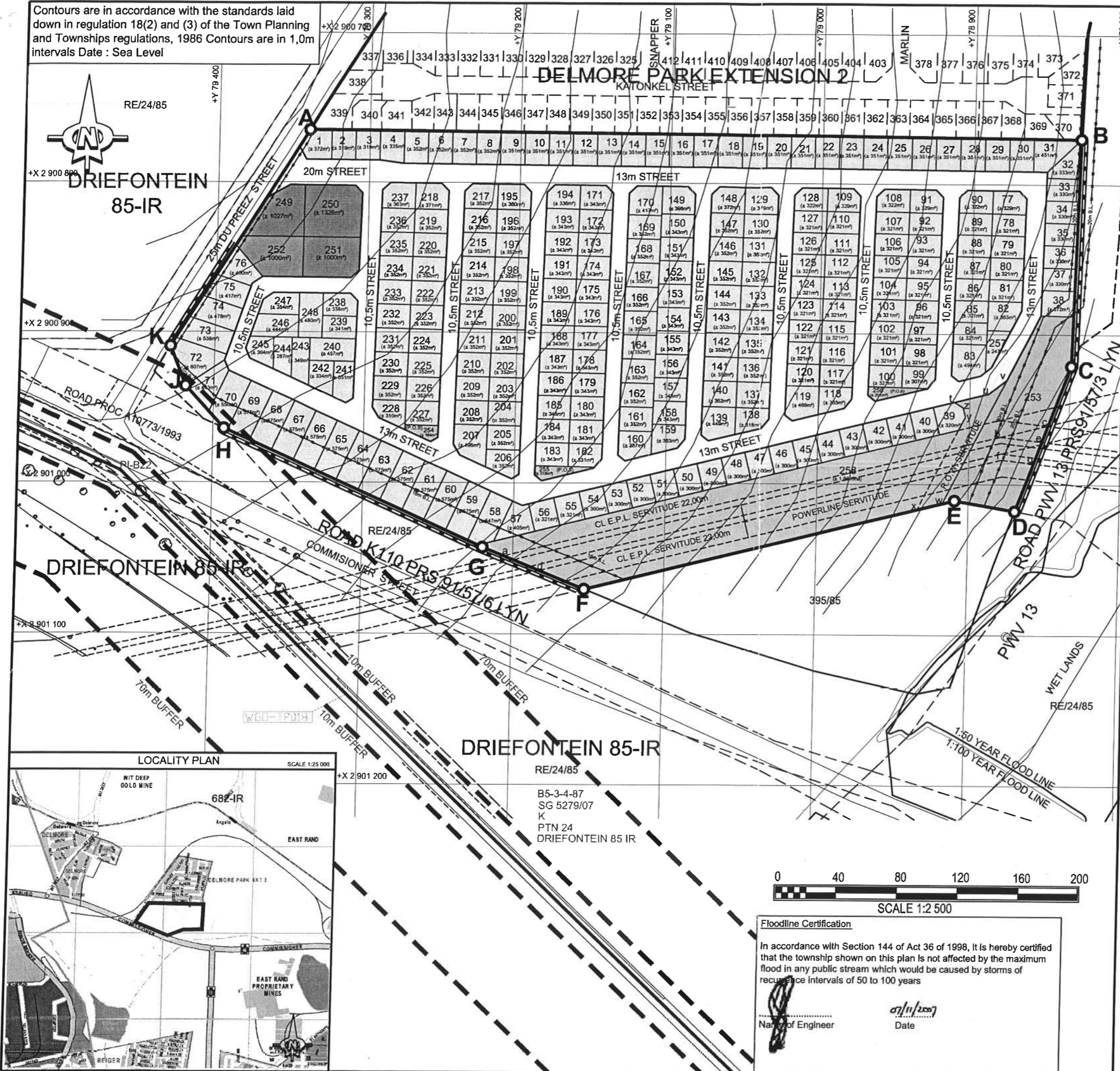

**PROPOSED TOWNSHIP
DELMORE PARK
EXTENSION 7**

Situated on a Part of Portion 396 of the farm Driefontein 85 IR
- Province of Gauteng

LAND USE TABLE

LAND-USE	NOTATION	No. OF STANDS	AREA (ha)	% OF TOTAL AREA
RESIDENTIAL 1	1 - 248	248	8,9114	61,70
INSTITUTION	249 - 251	3	0,3353	2,32
MUNICIPAL	253	1	0,5088	3,52
PLACE OF INSTRUCTION	252	1	0,1000	0,69
PRIVATE OPEN SPACE	254 - 258	5	1,4437	10,00
ROADS			3,1445	21,77
TOTAL		258	14,4437	100,00

1. The figure "ABCDEFGHJKA" represents Proposed Delmore Park Extension 7 situated on a Part of Portion 396 of the farm Driefontein 85 IR, measuring 14,4437ha in extent.
2. The lines abc, be and dfg represent the centre lines of an Electric Transmission Servitude extending 11 metres on either side of the lines, Vide Diagram S.G.No. 9703/1995.
3. The figure "tyvwxyz" represents a Right of Way Servitude in favour of Portion 395 of the farm Driefontein 85 IR.
4. All areas and dimensions are approximate and subject to final survey.
5. The township falls under the jurisdiction of the Ekurhuleni Metropolitan Municipality - Boksburg Delivery Centre
6. Base plan information was obtained from Compu Plan Planning and GIS Solutions.
7. Line of no access
8. Building Line



PLAN NO:

2588/A3

Date:

FEBRUARY 2009



312 Kent Avenue, 2nd Floor, Randburg
P.O. Box 3337 Randburg 2125

Tel: 011 781 9017 Fax: 011 781 9018
Cel: 083 307 9243
e-mail: tjvb@absamail.co.za

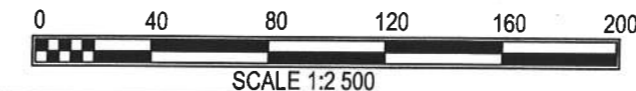

Floodline Certification

In accordance with Section 144 of Act 36 of 1998, It is hereby certified that the township shown on this plan is not affected by the maximum flood in any public stream which would be caused by storms of recurrence intervals of 50 to 100 years

Name of Engineer: _____ Date: 07/11/2009