

SIDES METERS	ANGLES OF DIRECTION	CO-ORDINATES (System WGS 84)			
		Y	X		
		0	+37 00 000.0		
AB	397.0	283 44 17	A	-31835.330	62790.455
BC	614.8	13 42 30	B	-32220.900	62884.800
CD	397.8	101 14 0	C	-32075.230	63482.055
DA	632.2	193 45 10	D	-31685.030	63404.555

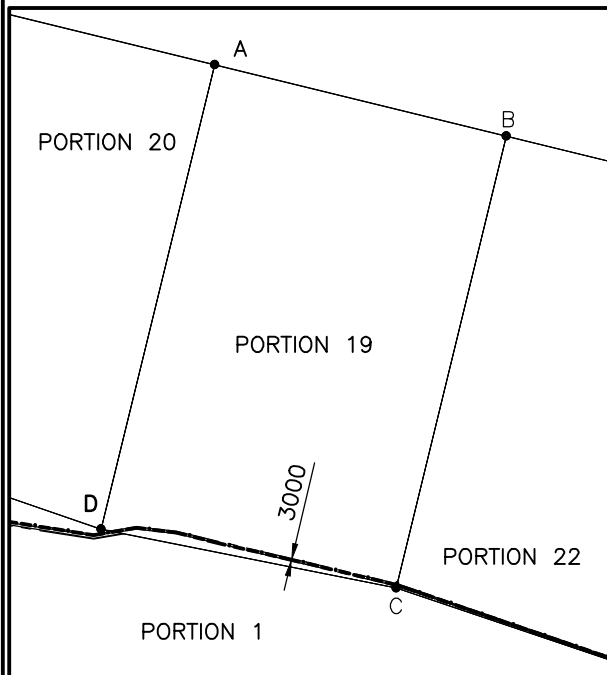

CO-ORDINATES (System WGS 84)		
POINT	Y	X
a	-31697.604	3763407.052
b	-31705.808	3763408.682
c	-31731.499	3763401.208
d	-31731.582	3763404.238
e	-31784.968	3763407.449
f	-31784.620	3763410.429
g	-32076.519	3763476.770
h	-32075.823	3763479.688

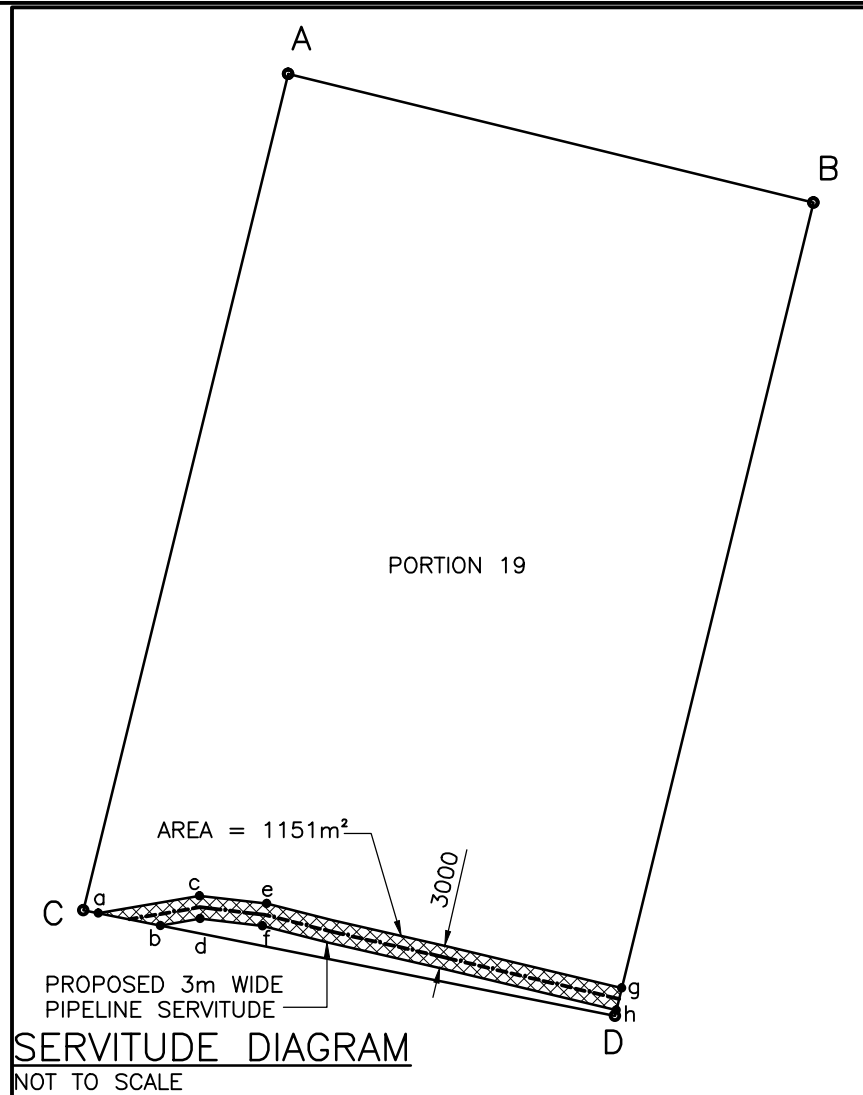

THE FIGURE A B C D REPRESENTS 24.7664 HECTARES OF LAND BEING PORTION 19 (A PORTION OF SEA VIEW WEST) OF THE FARM SEA VIEW

DESIGNED	RDB	APPROVED	SCALE
DRAWN	SM		1 : 10000
CHECKED	GC	PROJECT MANAGER	DATE
		DIRECTOR	03/12/08

NELSON MANDELA BAY MUNICIPALITY
SEAVIEW BULK WATER

PORTION 19
S.G. No 2310/70

BOSCH STEMELE
Consulting Engineers • Project Managers

BOSCH STEMELE (PTY) LTD.
P.O. BOX 27158, GREENACRES, P.E. 6057.
BLOCK 2, GROUND FLOOR, GREENACRES OFFICE PARK
2nd AVENUE, NEWTON PARK, PORT ELIZABETH, 6045, RSA
TELEPHONE: (041) 363 0598 TELEFAX: (041) 363 7646
E-mail: bspe@boschstemele.co.za
www.boschstemele.co.za

COPYRIGHT AND USE OF THIS DRAWING IS RESERVED BY BOSCH STEMELE

DRAWING NUMBER **8003/011/011J** A4 REVISION **0**