



NOTES

1. ALL SETTING OUT TO BE UNDERTAKEN BY A REGISTERED PROFESSIONAL LAND SURVEYOR.
2. PROVIDE ALL SERVICES PRIOR TO CONSTRUCTION.
3. ALL WORK AREAS TO BE REINSTATED (PREMIX, CONCRETE, ETC.)
4. MUNICIPALITY TO EXECUTE ALL CONNECTIONS INTO MUNICIPAL LINES.
5. SUPPLY AND INSTALLATION TO COMPLY WITH SANS 1200.
6. ALL LEVELS AND DIMENSIONS TO BE VERIFIED ON SITE.
7. THIS DRAWING IS TO BE READ IN CONJUNCTION WITH THE ARCHITECTURAL, FIRE ENGINEERING, MECHANICAL ENGINEERING, ELECTRICAL ENGINEERING AND STRUCTURAL ENGINEERING DRAWINGS.
8. ALL WORK IS TO BE EXECUTED IN ACCORDANCE WITH SANS 1200.
9. OTHER THAN PDF COPIES, NO CONSTRUCTION DRAWINGS WILL BE ISSUED IN A DIGITAL FORMAT TO THE CONTRACTOR.
10. CONTRACTOR TO PROVIDE AN AS-BUILT SURVEY OF ALL WORKS CONSTRUCTED UPON COMPLETION OF THE PROJECT.

**MATERIAL COMPLIANCE TESTING**

1. RESULTS OF COMPACTION AND CBR TESTS ON IN-SITU SUB-BASE MATERIAL AND FILLED SUB-BASE MATERIAL MUST BE SUBMITTED TO THE ENGINEER FOR APPROVAL BEFORE THE UPPER LAYERWORKS ARE IMPORTED TO THE SITE AND PLACED.

**FREQUENCY OF TESTS**

1. CBR TESTS 1 PER 500m<sup>2</sup>
2. COMPACTION TESTS - MIN. 2 PER SITE / LOT

NOTE: COMPACTION TESTS WILL BE REQUIRED FOR EACH OF THE VARYING LAYERWORKS THAT IS IMPORTED AND COMPACTED IN PLACE.

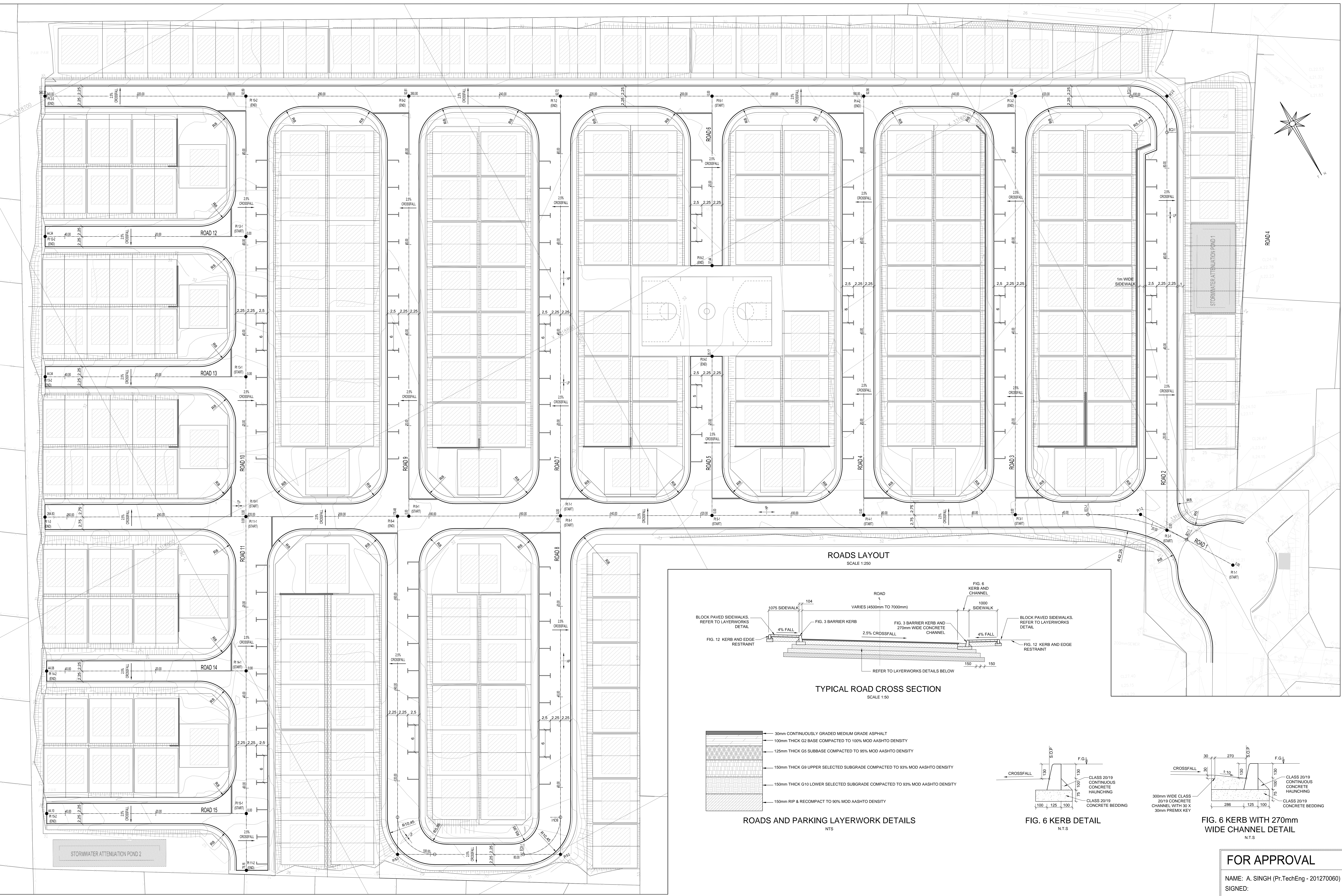

ROADS LAYOUT  
SCALE 1:250

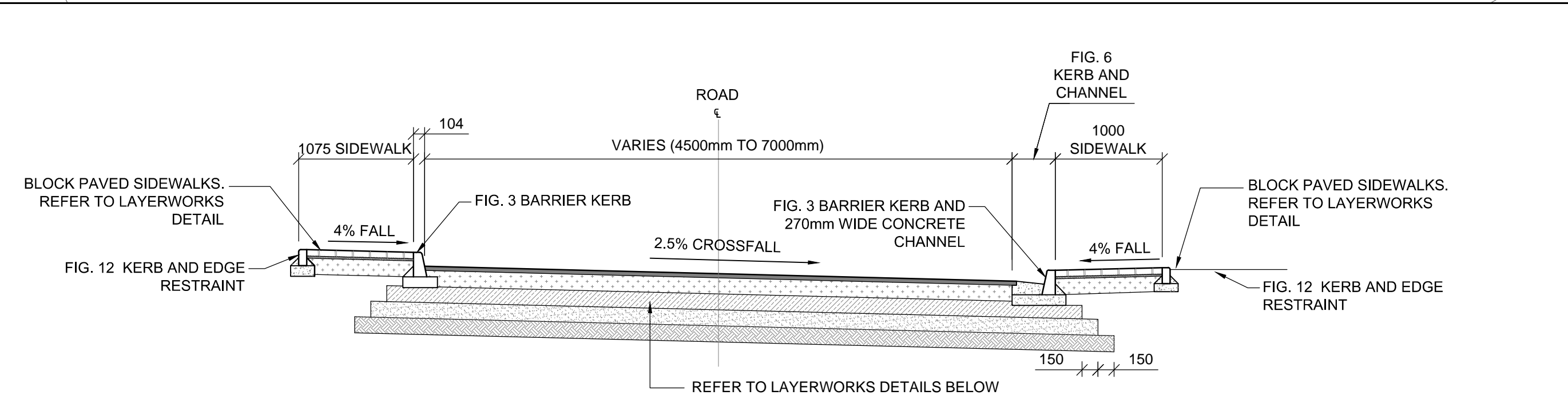

TYPICAL ROAD CROSS SECTION  
SCALE 1:50

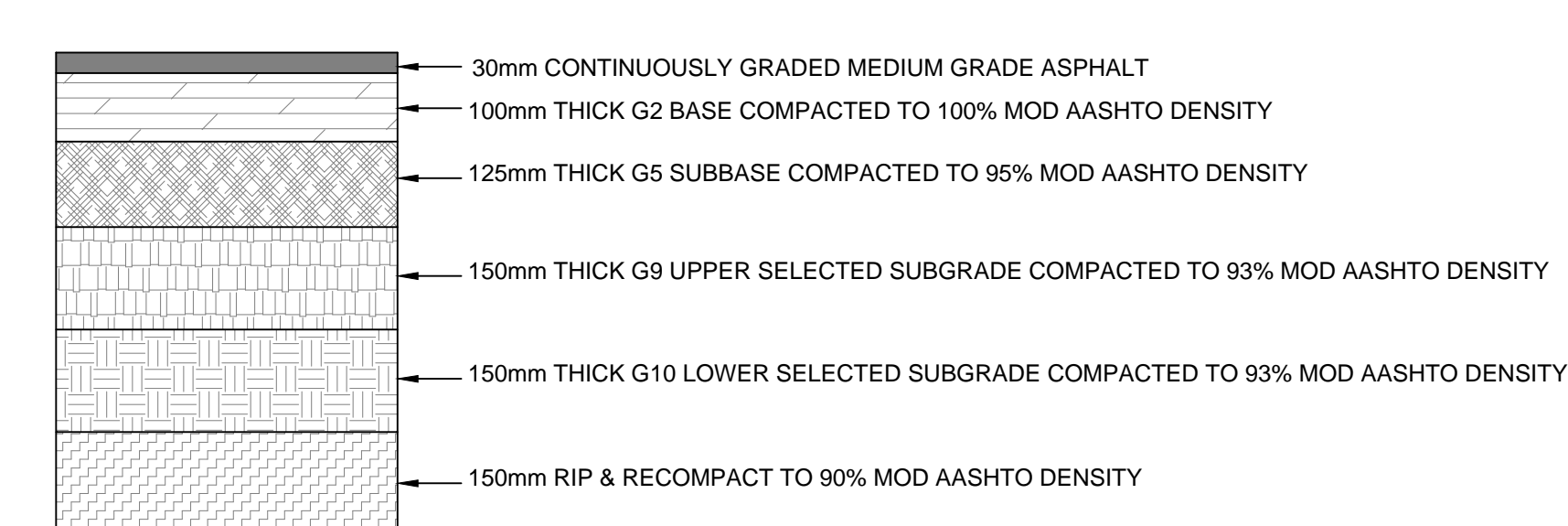

ROADS AND PARKING LAYERWORK DETAILS  
N.T.S.

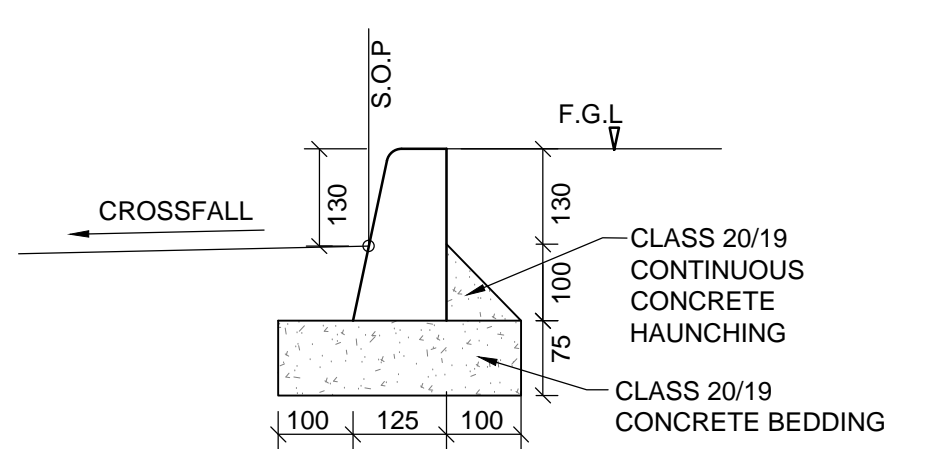

FIG. 6 KERB DETAIL  
N.T.S.

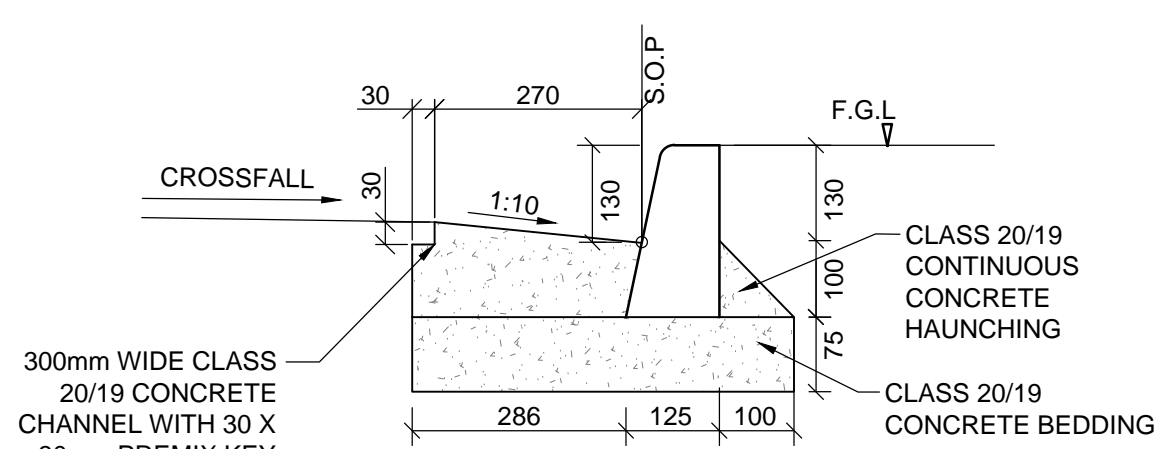

FIG. 6 KERB WITH 270mm WIDE CHANNEL DETAIL  
N.T.S.

P1 2017.07.10 FOR APPROVAL

Revision	Date	Description
		NOTE: No construction work to commence until land and servitude acquisitions have been completed.

Acquisitions completed:

Date: \_\_\_\_\_ Engineer: \_\_\_\_\_

UNDERGROUND SERVICES CHECKED

SERVICE	DATE	SIGNATURE
S/W DRAINS		
SEWERS		
WATER MAINS		
G.P. CABLES		
ELECTRIC CABLES		
S.A.R. CABLES		
E.S.C. CABLES		
OIL PIPE LINE		

NOTE: Only underground services affected by new construction work are shown. Care must be taken during construction to avoid damage to underground services such as sewers, drains, cables, water mains and connections. Wherever possible these must be located before work proceeds.

Contract No. \_\_\_\_\_

Engineer: \_\_\_\_\_



Project Title

KANKU ROAD HOUSING DEVELOPMENT

ROAD LAYOUTS AND DETAILS

SCALES AS SHOWN Date 2017.07.10

Designed A. SINGH Checked A. SINGH

Drawn K. GOVENDER Surveyed RA. LOGAN & ASSOCIATES

Manager (HUMAN SETTLEMENTS)

Deputy Head

Head

Drawing No. 429/1000 Sheet 1 of 1 Rev P1

FOR APPROVAL

NAME: A. SINGH (Pr.Tech-Eng - 201270060)

SIGNED:

DATE: