

**Photos and location of the site
notices**

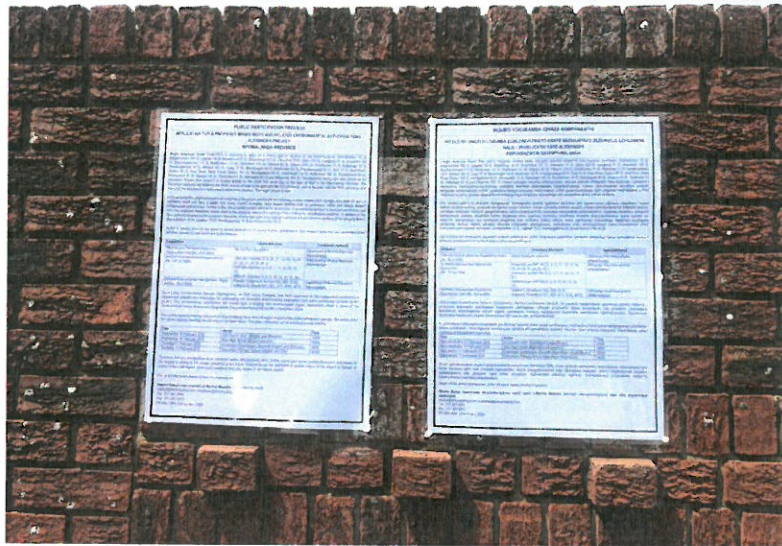

1. Govan Mbeki Local Municipality, Secunda



2. Bus Stop next to Kuiersaam , Secunda



3. Trichardt Post Office



4. Intersection of the Trichardt and Bethal Gravel Roads



5. Intersection of the R545 & Trichardt Gravel Road



6. Intersection of the R545 & Road to Alzu Feeds



7. Intersection of the R545 & the R547



8. Kriel Civic Centre, eMalahleni Municipality



9. Hoerskool Kriel High School



10. Evangelies-Gereformeerde Kerk, Kriel



11. Fence Along Kafferstad Farm



12. Intersection of the R545 and Kafferstad Road



13. Intersection of the Bethal and Kafferstad Gravel Road



14. Fence Along Bethal Gravel Road on Vaalkop Farm

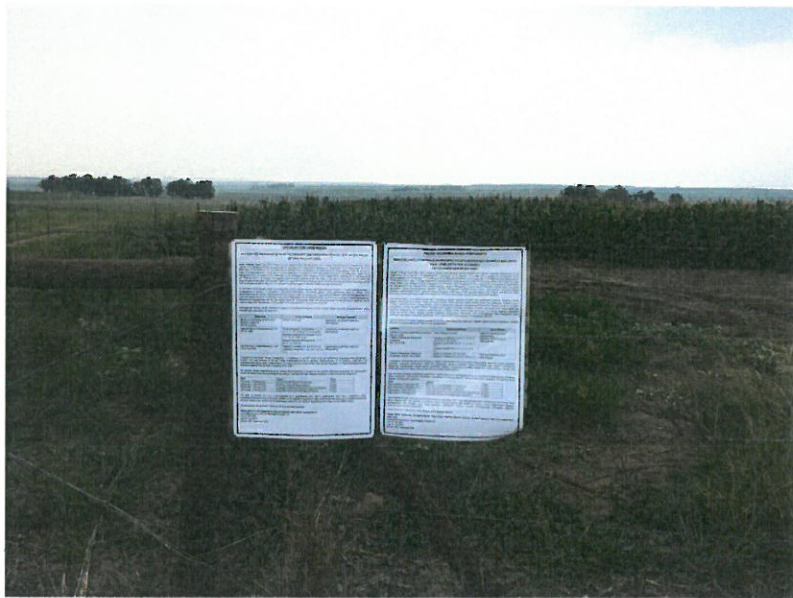

15. Fence Along Bethal Gravel Road on Alexander Farm



16. Intersection of the R545 and the road to Yzervarkfontein Farm



17. Intersection of the R545 and the road to Ongezien Farm



18. Bethal Civic Centre, Govan Mbeki Municipality

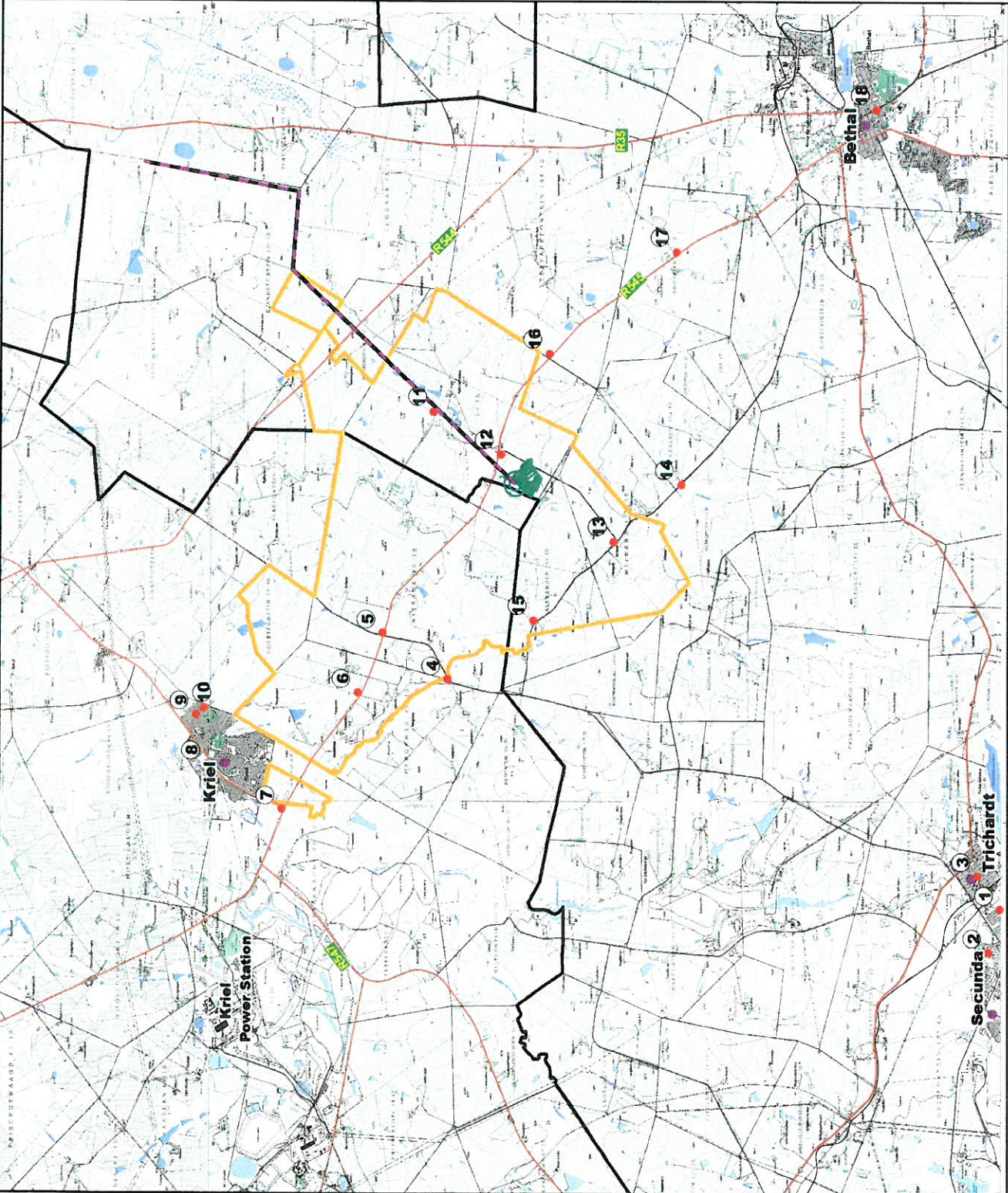

Legend

- Site Notice Locations
- Place Names
- Proposed Conveyor Route
- Shaft Complex
- Main Roads
- ▭ Proposed Alexander Mining Right Area
- ▭ Local Municipalities



SLR Synergistics is an SLR group company

750.01080.00002

Site Notice Locations

Coordinate System
DMS
Central Meridian
LO29

Spheroid
Hartebeesthoek '94