

Project Details:

THE OAKS 153 MR
FINAL PROSPECTING

A PORTION OF THE REMAINING
EXTENT OF THE FARM THE OAKS
153 MR

Office reference: LWC115/RFM
Date: 26 September 2019

Applicant:
MAKESHIFT 1182 (PTY) LTD

Contact Details:
10 Bender Street
Hillcrest
Kimberley
8301
Tel:
Cel: 061 394 7150
Fax: 086 606 6315

Client Signature:

Signed: _____
Date: _____

Scale: 1:40 000
Accurate if printed on full A3 size paper

CONSULTANTS
19 Park Road • Belgravia • Kimberley
PO Box 3226 • Kimberley • 8300
Tel: 053 831 7634 • Fax: 086 606 6315
lindie@liwico.co.za

FINAL PROPOSED DRILL HOLE LOCALITIES

Projection: WGS 84

CONSTANT	East	South
1	28.29280	22.96377
2	28.29123	22.97268
3	28.28966	22.98160
4	28.29706	22.93795
5	28.29593	22.94594
6	28.29906	22.92811
7	28.29436	22.95485
8	28.30062	22.91919
9	28.30299	22.96005
10	28.31082	22.91548
11	28.30769	22.93331
12	28.30612	22.94222
13	28.30925	22.92439
14	28.30143	22.96896
15	28.30456	22.95114
16	28.31851	22.93043
17	28.31694	22.93935
18	28.32007	22.92152
19	28.31942	22.96977
20	28.31309	22.96866

FINAL PROSPOSED BULK SAMPLE LOCALITIES

Projection: WGS 84

CONSTANT	East	South
1	28.29887	22.95487
2	28.30638	22.96995
3	28.31521	22.91915
4	28.30258	22.93212
5	28.31294	22.94501

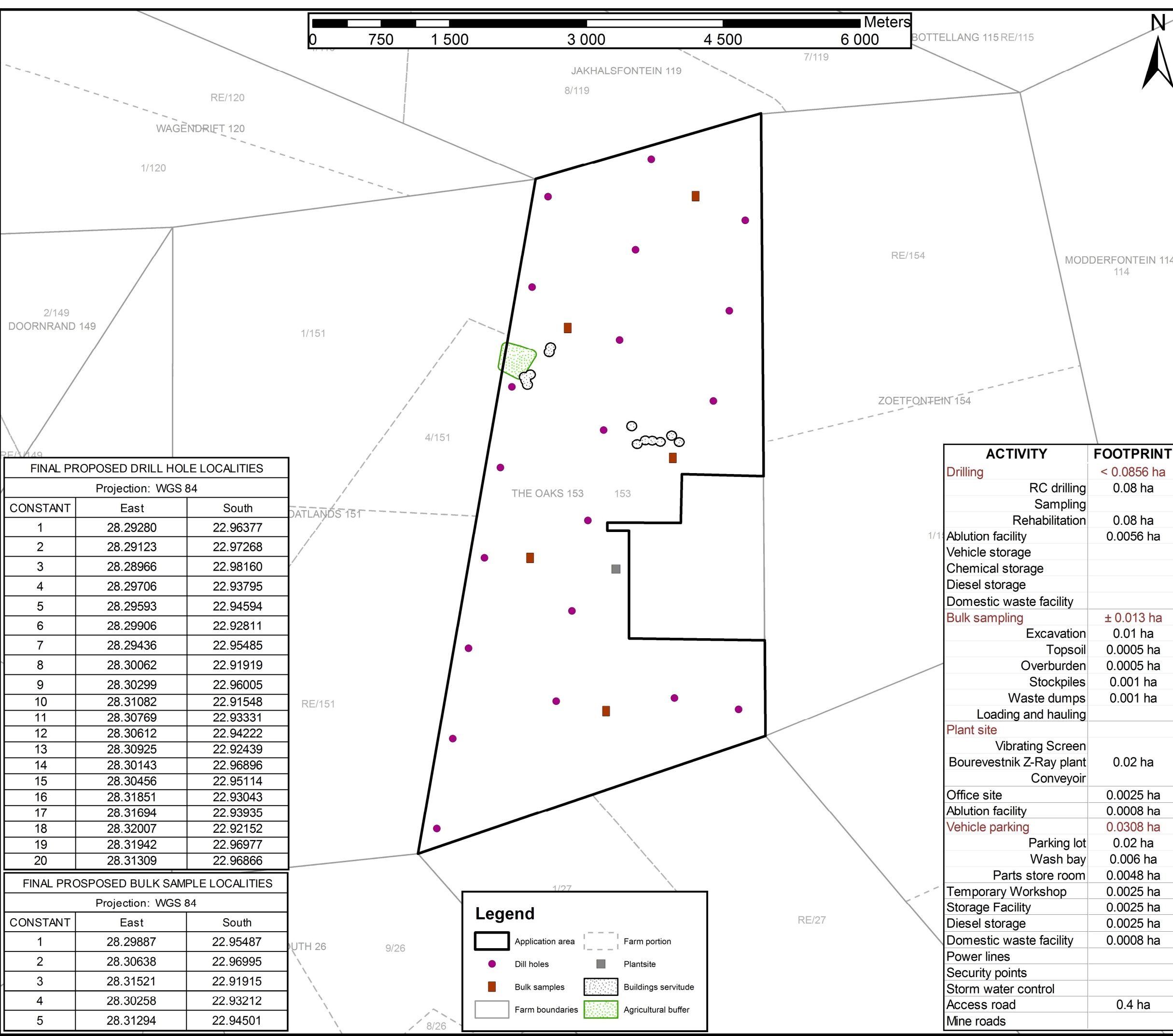

Legend

- Application area (thick black line)
- Farm portion (dashed line)
- Drill holes (purple dot)
- Plantsite (grey square)
- Bulk samples (orange square)
- Buildings servitude (stippled area)
- Farm boundaries (thin black line)
- Agricultural buffer (green hatched area)

ACTIVITY	FOOTPRINT
Drilling	< 0.0856 ha
RC drilling	0.08 ha
Sampling	
Rehabilitation	0.08 ha
Ablution facility	0.0056 ha
Vehicle storage	
Chemical storage	
Diesel storage	
Domestic waste facility	
Bulk sampling	± 0.013 ha
Excavation	0.01 ha
Topsoil	0.0005 ha
Overburden	0.0005 ha
Stockpiles	0.001 ha
Waste dumps	0.001 ha
Loading and hauling	
Plant site	
Vibrating Screen	
Bourevestrik Z-Ray plant	0.02 ha
Conveyoir	
Office site	0.0025 ha
Ablution facility	0.0008 ha
Vehicle parking	0.0308 ha
Parking lot	0.02 ha
Wash bay	0.006 ha
Parts store room	0.0048 ha
Temporary Workshop	0.0025 ha
Storage Facility	0.0025 ha
Diesel storage	0.0025 ha
Domestic waste facility	0.0008 ha
Power lines	
Security points	
Storm water control	
Access road	0.4 ha
Mine roads	