

053 963 1081  
018 011 1925  
072 998 6008

087 231 7021  
info@milnex-sa.co.za

4 Botha Street  
SCHWEIZER-RENEKE

Waterberry Street,  
Waterberry Square,  
1st floor, Office 7  
POTCHEFSTROOM

C/o Welgevonden &  
Memorial Street,  
Roylglen Office Park  
KIMBERLEY

[www.milnex-sa.co.za](http://www.milnex-sa.co.za)

**TO:**  
**SOUTH AFRICAN HERITAGE RESOURCES AGENCY**  
**UPLOAD ON WEBSITE**  
<https://sahris.sahra.org.za/>

**09 March 2021**

**For attention:** Mr Graham Avery

**OPPORTUNITY TO APPEAL: THE GRANTING OF AN ENVIRONMENTAL AUTHORISATION FOR THE PROPOSED PROSPECTING RIGHT APPLICATION COMBINED WITH A WASTE LICENSE APPLICATION FOR THE PROSPECTING OF DIAMONDS (ALLUVIAL & GENERAL) NEAR PRIESKA ON PORTION 12, REMAINING EXTENT OF PORTION 29 (PORTION OF PORTION 13) AND PORTION 31 (PORTION OF PORTION 29) OF THE FARM READS DRIFT 74, REGISTRATION DIVISION; HERBERT. NORTHERN CAPE PROVINCE. DMR REF: NC30/5/1/1/2/12345PR**

1. Milnex CC Environmental Consultants was appointed by **Steinmann Groep (Pty) Ltd** to undertake the Environmental Impact Assessment process as required by Regulation 21 of the EIA regulations.
2. The Environmental Authorisation application for the Prospecting Right with bulk sampling combined with a Waste License application, has been **granted**.
3. An opportunity for appeal against the above mentioned decision is hereby given in terms of Government Notice No. 326 subsection 4(2) of the intent to carry out the above-mentioned activity.
4. Please refer to the following Dropbox link for a copy of the Environmental Authorisation and the reason for decision:  
<https://www.dropbox.com/sh/o94dcfszyl4nbif/AABbsXYbOmdQ70EweMthUNHga?dl=0>
5. Your attention as a key stakeholder for the above-mentioned project, is drawn to Chapter 2 of the National Appeal Regulations which regulates appeal procedures. Should you as a stakeholder wish to appeal; an appeal must, *inter alia*, be lodged as prescribed in regulation 4 of the National Appeal Regulations, 2014, with a Member of the Executive Council, Ministry of Environment and Nature Conservation within 20 days.
6. A copy of the Environmental Authorisation will be sent upon request and is also available at the Milnex offices in Schweizer-Reneke, 4 Botha Street, Schweizer-Reneke & Potchefstroom (Waterberry Street, Waterberry Square, 1st floor, Office 7, Potchefstroom) between 7:30AM and 5PM, Monday to Thursdays and between 7:30AM and 4PM on Fridays.
7. The decision and date of granting the Environmental Authorisation (EA) was on **03 March 2021** and was received on 5 March 2021.
8. Stakeholders have until **31 March 2021 (20 days)** to appeal. An appeal can be lodged with the

relevant department with the following details in writing by completing the appeal form obtainable from the Appeal Administrator:

Appeal to the Department of Environmental Affairs

Attention:	Directorate Appeals and Legal Review
Reference Number	<b>NC30/5/1/1/2/12354PR</b>
Email:	<a href="mailto:appealsdirector@environment.gov.za">appealsdirector@environment.gov.za</a>
By post:	Private Bag X 447, Pretoria, 0001
By facsimile:	(012) 359 3609
By hand:	Environmental House, Corner Steve Biko and Soutpansberg Street, Arcadia, Pretoria, 0083

Copy of the lodged appeal to the Department of Mineral Resources and Energy

Attention:	Regional Manager: Northern Cape Region
Reference Number	<b>NC30/5/1/1/2/12354PR</b>
Email:	<a href="mailto:Patricia.Makhuvele@dmre.gov.za">Patricia.Makhuvele@dmre.gov.za</a>
By facsimile	(053) 8328 593
By post:	Private Bag X6093, Kimberley, 8300
By hand:	Telkom Building, 41 Schmidtsdrift Street, Kimberley, 8300.

9. Contact person for the EA at Milnex CC Environmental Consultants is Ms. Lizanne Esterhuizen.

EAP:	Ms. Lizanne Esterhuizen		
Company:	Milnex CC Environmental Consultants		
Physical address:	Waterberry Street, Waterberry Square, 1st floor, Office 7, Potchefstroom		
Postal address:	P.O. Box 1086, Schweizer-Reneke		
Postal code:	2780	Cell:	
Telephone:	(018) 011 1925	Fax:	087 231 7021
E-mail:	<a href="mailto:Lizanne@milnex-sa.co.za">Lizanne@milnex-sa.co.za</a>		

10. A locality map has been attached for your convenience. We trust that you find the above in order. If there are any uncertainties or additional information required, please feel free to contact the undersigned.

Kind regards



**Lizanne Esterhuizen**  
**Per: Milnex CC**

**REFERENCE**

International Boundary and Beacon	
Provincial Boundary	
Protected Area	
Perennial River	
Non-perennial River	
Non-Perennial Water	
Dry Water Course	
Dry Pan	
Marsh and Vlei	
Pipeline (above ground)	
Water Tower; Reservoir; Water Point	
Coastal Rocks	
Prominent Rock Outcrop	
Erosion: Sand	
Woodland	
Cultivated Land	
Orchard or Vineyard	
Recreation Ground	
Row of Trees	

**REFERENCE**

National Freeway; National Route	
Arterial Route	
Main Road	
Secondary Road; Bench Mark	
Other Road; Bridge	
Track and Hiking Trail	
Railway: Station or Siding	
Other Railway: Tunnel	
Embankment; Cutting	
Power Line	
Build-up Area (High, Low Density)	
Buildings: Ruin	
Post Office; Police Station; Store	
Place of Worship; School; Hotel	
Fence; Wall	
Windpump; Monument	
Communication Tower	
Mine Dump; Excavation	
Trigonometrical Station; Marine Beacon	
Lighthouse and Marine Light	
Cemetery; Grave	

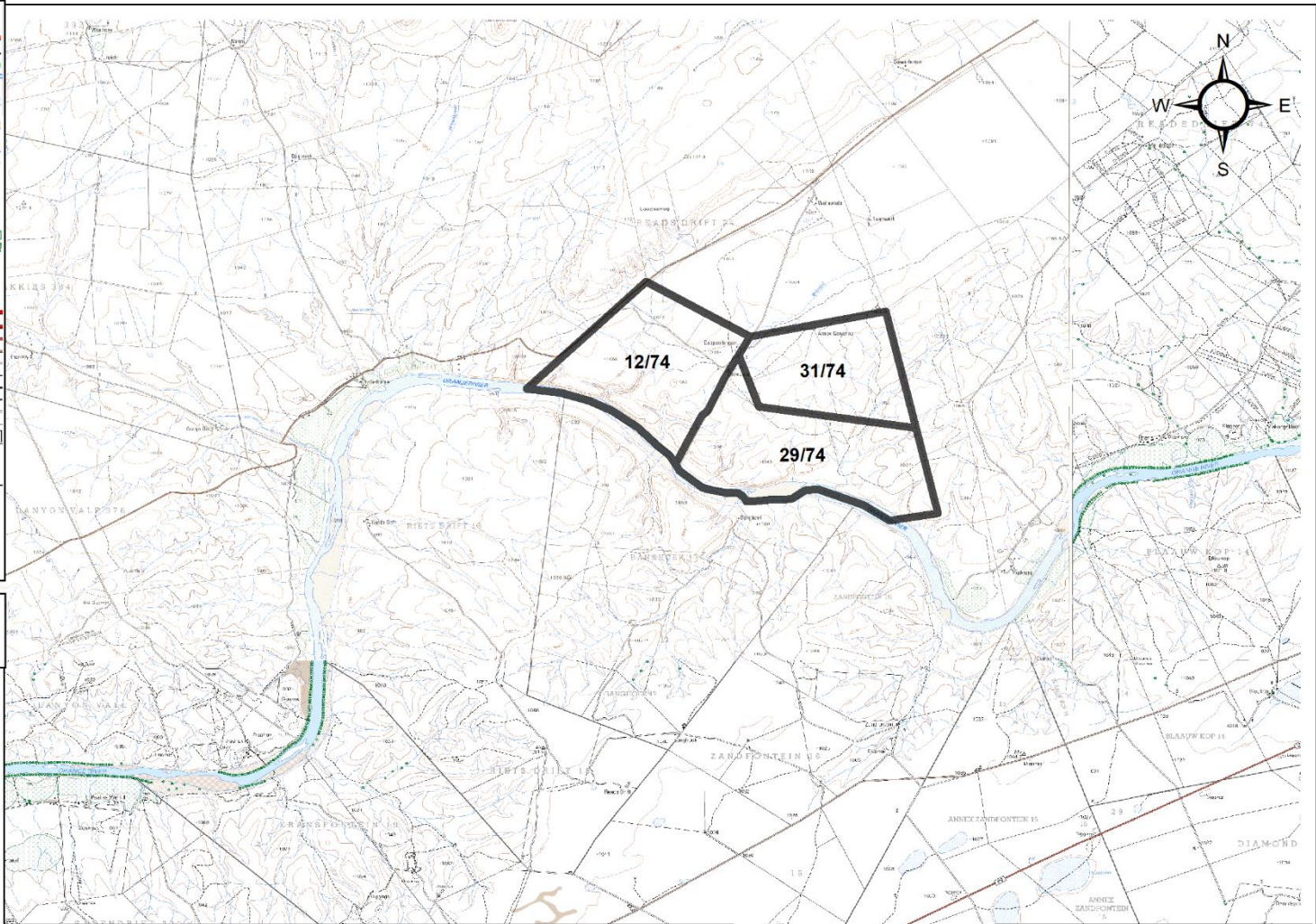

**NORTHERN CAPE PROVINCE LOCALITY MAP**



LOCALITY MAP: PROPOSED PROSPECTING AREA ON PORTION 12, THE REMAINING EXTENT OF PORTION 29 (PORTION OF PORTION 13) AND PORTION 31 (PORTION OF PORTION 29) OF THE FARM READS DRIFT 74.

REGISTRATION DIVISION: HERBERT RD  
DISTRICT MUNICIPALITY: PIXLEY KA SEME  
NEAR PRIESKA NORTHERN CAPE PROVINCE  
TOTAL EXTENT: 2 459.4556 ha

Adopted from the 1:50 000 Topographical Maps-2923AB, 2923BA, 2923AD AND 2923BC

APPLICANT:  
STEINMANN GROEP  
(PTY) LTD

GPS:  
29°12'25.122"S  
23°26'21.275"E

Signature:

Date:

Datum: D\_WGS\_1984  
Spheroid: WGS\_1984  
1:100 000

