

THIS APPROVAL DOES NOT AUTHORISE VEHICULAR ACCESS TO THE SITE.

Any person undertaking building operations in accordance with this plan is required to ascertain from the City Electrical Engineer the location of underground cables in the vicinity of the proposed works prior to the commencement thereof.

PRECAST CONCRETE FENCES ON BOUNDARIES
 BOUNDARY BEACONS TO BE EXPOSED AND POINTED OUT TO THE DISTRICT BUILDING OFFICER BY THE APPLICANT BEFORE ERECTION OF THE FENCE IS COMMENCED. THE BEACONS SHALL REMAIN EXPOSED AFTER COMPLETION OF THE WORK FOR A FINAL INSPECTION.

- NOTES:**
- Face to face street.
 - Servitudes: where applicable, fence to span servitude (bridged) & not to encroach more than .380.
 - Frontage works: top of foundations to be below road level where possible.
 - Use figured dimensions only.
 - P.C. fence not to retain more than 300 mm.
 - Fence not to encroach over boundary.
 - Fence to be erected on natural ground.
 - Foundations not to encroach over bndy line.

WALLING DETAILS

Section	Length	Height
A-B	5.5	2.0
B-C	5.2	2.0
C-D	2.8	2.0

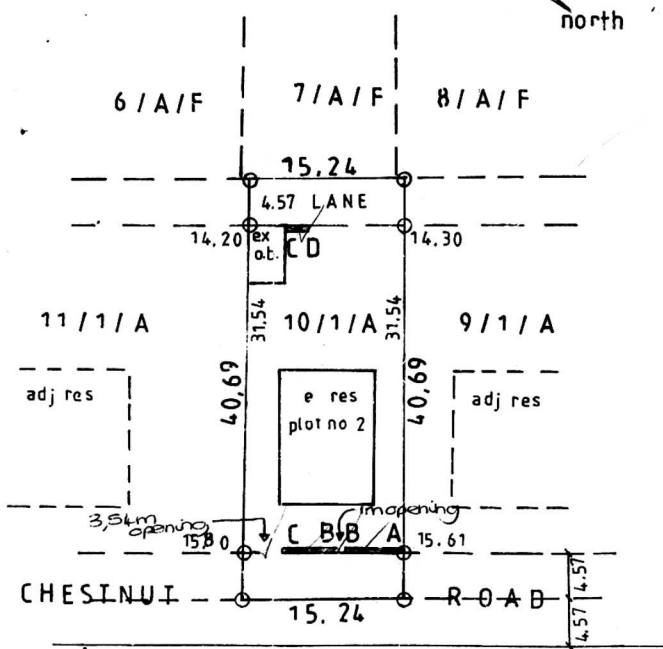

SITE PLAN - (1:500)

10 OF 1 OF A OF 9 OF BLOCK C OF TOWNLANDS OF DURBAN NO 1737

SHEET 1/1 COPY 2
CITY OF DURBAN
 PLAN NUMBER 0262/05/90/6
APPROVED: D. C. MACLEOD
 CITY ENGINEER
 15 MAY 1990
 DATE

[Handwritten signature]
 23/5/90

"It should be noted that this plan has been approved on the basis of information provided."

[Handwritten signature]
 OWNERS SIGNATURE

DURBAN CONC. FENCING
 P.O. BOX 10051 ASHWOOD 3605
 TELEPHONE: 7014466

DRAWN : *[Handwritten signature]*
 DATE : 09/05/90
 DRAWING NO : 3305
 SCALES : AS SHOWN
 CHECKED :

PROPOSED P.C. FENCE FOR: MR. S. ARDENDORFF - 32 CHESTNUT ROAD - GLENWOOD