

DOCUMENT REFERENCE NUMBER

REFERENCE NO

15/3/3/23/7

Date:

07 MAY 2008

A BESTBIER
EKURHULENI
METROPOLITAN MUNICIPALITY
P O BOX 215
BOKSBURG
1460

FILE

Quet

2008-05-21

Enquiries:

P. Jizana

Tel: 741-3548

Fax: 741-3553

FERRED TO

L Crema

D17036

Your reference.
7/2/23/7

Our reference
35816

Sir/Madam

PROPOSED DELMORE PARK EXTENSION 7 TOWNSHIP: PERMISSION TO CIRCULATE AND ADVERTISE

Your letter dated 30 January 2008 refers.

I wish to inform you that Eskom service is affected by this application as indicated on our attached Eskom's locality plan. Eskom's 44KV overhead powerline is affected by your application. The building restriction on a 44KV powerline is 11m from each line of the powerline. However Eskom will raise no objection to the proposed services provided it's rights and services are acknowledged and respected at all times, and the requirements as laid down by the Occupational Health and Safety Act No 85/1993, are complied with. As additional safety measures Eskom require that the following conditions are complied with:

1. **The applicant or his contractor must notify Eskom's Germiston Technical Service Centre-Contact person Mr Sam Rudman Tel 011 871 3060 at least seven (7) days prior to the commencement of any work whatsoever, under or in close proximity to Eskom's services.**
2. No mechanical equipment, including mechanical excavators, may be used under or in close proximity to Eskom's services without the prior approval of Eskom's authorised representatives
3. Any cost and claims due to interruptions or modifications to Eskom's services due to this application, will be borne by the applicant.

North Western Region

3 Lakeview Crescent Kleinfontein Office Park Private Bag X012 Benoni 1500 RSA
Tel +27 11 741 3500 Fax +27 11 741 3536 www.eskom.co.za

Directors: MV Moosa (Chairman) PJ Maroga (Chief Executive) M Bello (Nigerian) LCZ Cele Dr BM Count (British)
LG Josefsson (Swedish) WE Lucas-Bull PM Makwana E Marshall JRD Modise V Mohantal Rowjee AJ Morgan
SA Mpambani U Nene B Nqwababa* (*Executive Director) Company Secretary: M Adam
Eskom Holdings Limited Reg No 2002/015527/06



4. Eskom shall not be liable for the death of or injury to any person or for the loss of or damage to any property caused in whatsoever manner by the applicant, his employees, agents or contractors. The applicant indemnifies Eskom against all claims including claims for consequential damages by third parties which includes but is not limited to claims as a result of damage to, or interruption of or interference with Eskom's services or equipment. The applicant's attention is drawn to section 27(3) of the Electricity Act 1987.
5. Eskom must have ingress to and egress from its services at all times.
6. No excavations may be executed closer than 6 meters from any of Eskom's overhead power lines or 3 meters from any underground cables.
7. The consent is further subject to the land owner's permission for the proposed works as per this application. A copy of the permission must be filed with Eskom, seven (7) days before any work is carried out in the servitude area.
8. No blasting may be undertaken under or in close proximity of Eskom's services unless minimum charges with adequate matting is used, and then only under the strict supervision of Eskom's authorised representatives who require at least (30 days prior notification.)
9. Should the applicant or his contractor damage any of Eskom's unidentified services during commencement of any work whatsoever, then Eskom's 24 hour Fault number (0860-110-124) must be dialed immediately to report the incident.
10. Should the applicant or his contractor damage any of Eskom services as indicated or referred to in this letter of approval, this approval is automatically withdrawn.
A payment of R100 000.00 (One Hundred Thousand Rand), will be payable by the applicant before permission will be granted to proceed with any works related to the original application and the applicant will further be held liable for any cost incurred by Eskom due to damage of services and loss of income.

Eskom requires written acceptance of the abovementioned conditions within seven (7) days of the date of this letter, before commencement of any work by the applicant. After this period has lapsed, permission to work as per this application will be automatically withdrawn without further notification.

This approval is valid for a period of sixty (60) days from the date of this letter and becomes null and void after this period. A new application for approval must be submitted to Eskom if the stated works are not started within this sixty (60) day period.

Should the applicant not comply to any of these conditions as stipulated this approval is automatically withdrawn.

Yours faithfully

P. Jizana

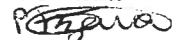

FOR: LAND DEVELOPMENT MANAGER

Estkow's 4V 44KV overhead electrical powerlines

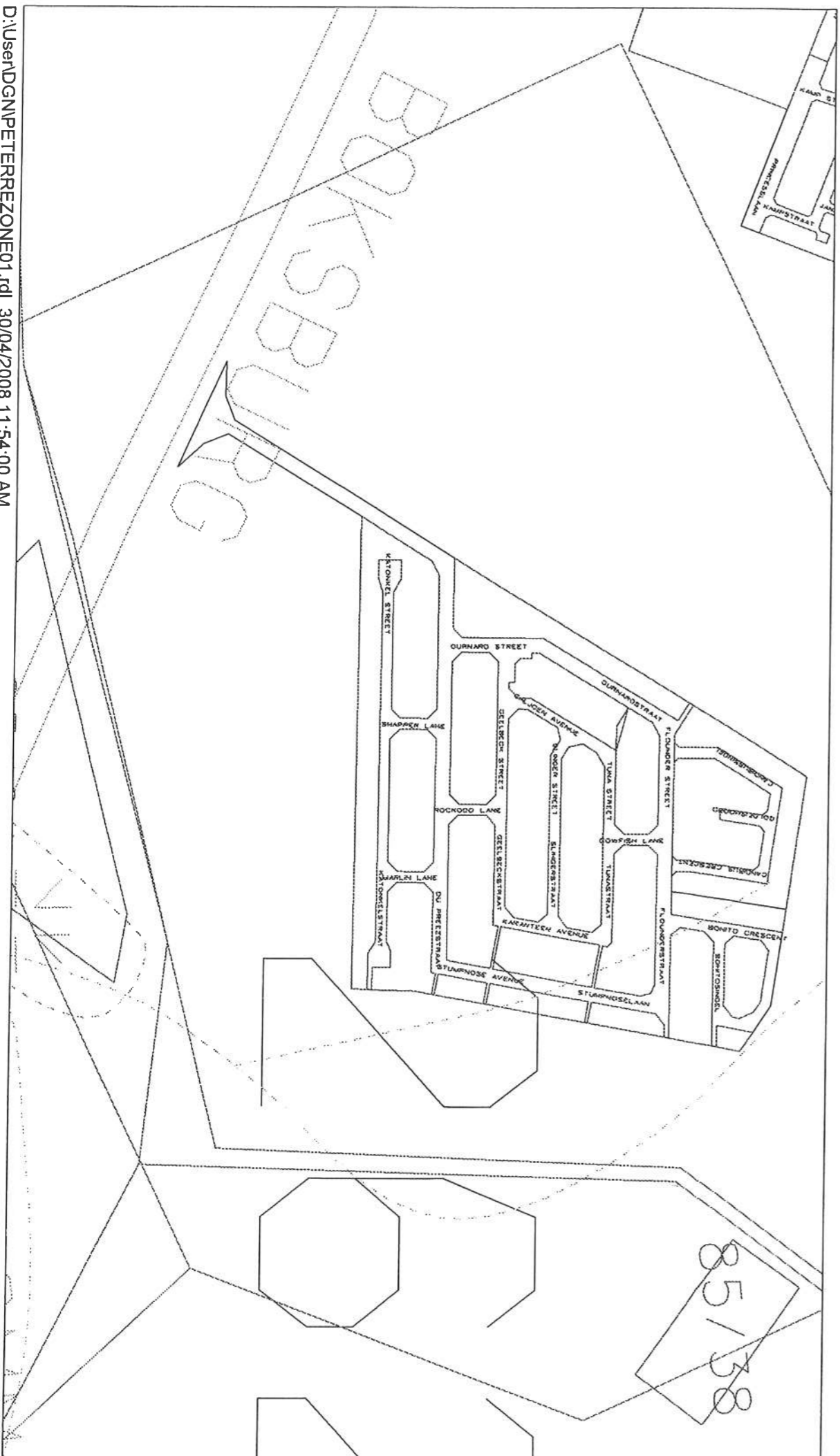

Contours are in accordance with the standards laid down in regulation 18(2) and (3) of the Town Planning and Townships regulations, 1986 Contours are in 1,0m intervals Date : Sea Level

DELMORE PARK EXTENSION 2

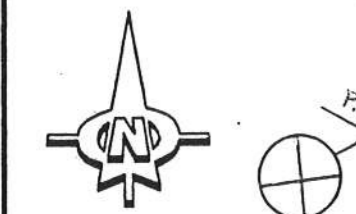
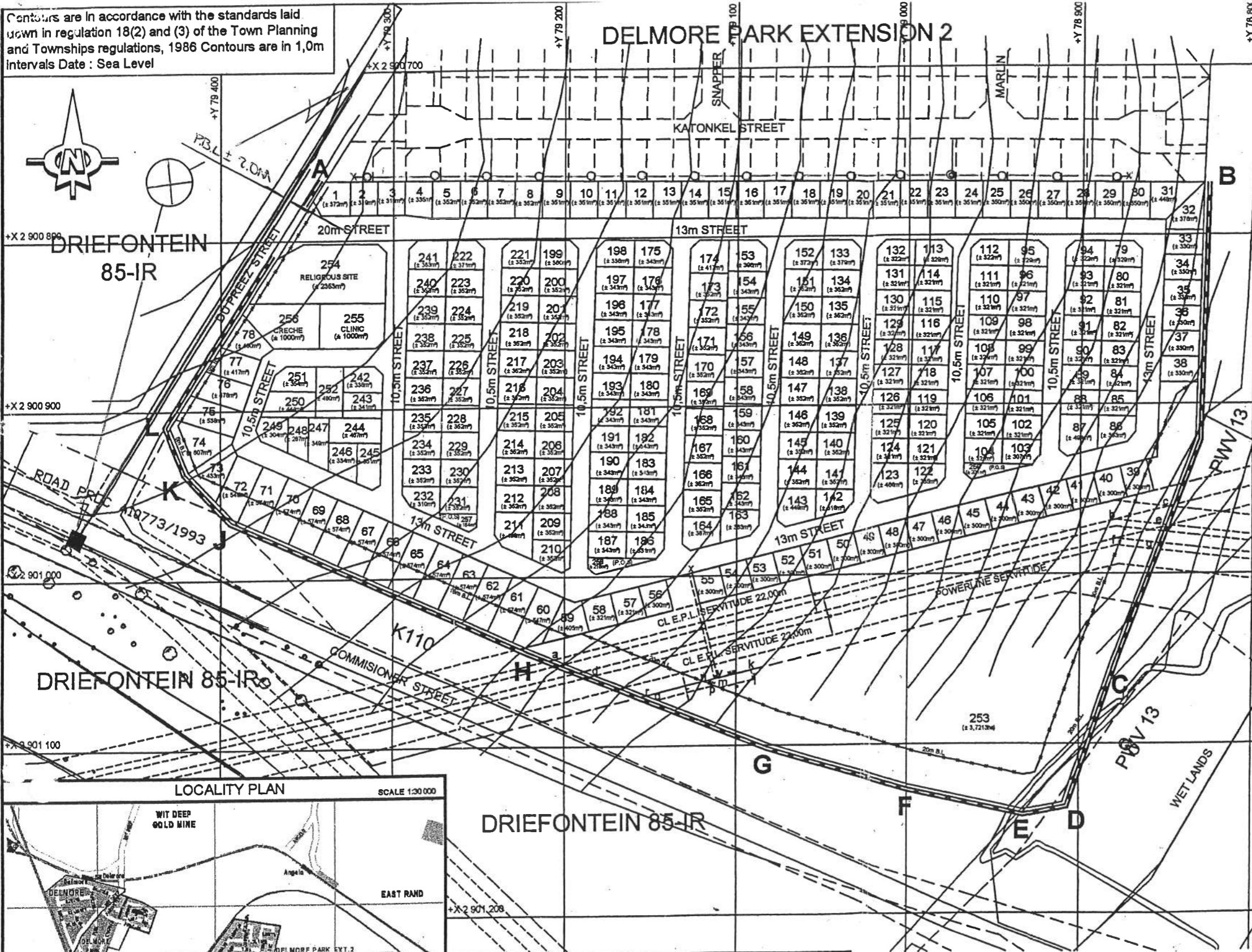

DRIEFONTEIN 85-IR

DRIEFONTEIN 85-IR

DRIEFONTEIN 85-IR

LOCALITY PLAN SCALE 1:30000



REFERENCE	VERWYSING
PLANT INDICATED IN BLUE	TOERUSTING IN BLOU AANGEDE
UNDERGROUND CABLE IN PIPE	ONDERGRONDSE KABEL IN PYP
UNDERGROUND CHAMBER WITH CABLE	ONDERGRONDSE KABEL PUT MET KABEL
BURIED CABLE	BEGRAAFDE KABEL
OVERHEAD CABLE	OOFHOOFSSE KABEL
DISTRIBUTION POINT	VERDEELPUNT
STAY	ANKER
STRUT	STUT
OPEN WIRE ROUTE	OOPOORRAAD ROETE
IMPORTANT CROSSING PIPELINE	BELANGRIKE KRUSING PYP LOOP
UNIMPORTANT CROSSING PIPELINE	ONBELANGRIKE KRUSING PYP LOOP
STREET DISTRIBUTION CABINET	STRAATVERDEELKABINET
PROPERTY BOUNDARY LINE	BEGRANSINGSREÏN
ALL UNDERGROUND PLANT at 0,6m DEEP	ALLE ONDERGRONDSE TOERUSTING IN 0,6m DIEP
FUTURE PLANT INDICATED IN GREEN	TOEKOMSTIGE TOERUSTING IN GROEN AANGEDE

Ekurhuleni
METROPOLITAN MUNICIPALITY

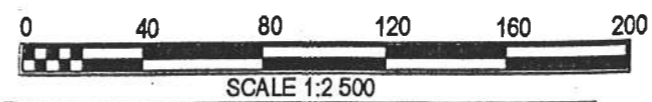

Floodline Certification

It is hereby certified that in accordance with section 144 of the national water act (Act 36 of 1956) that the floodline shown indicates the maximum level likely to be reached by floodwater on average once every 100 years.

07/11/2007
CONSULTING ENGINEER

PROPOSED TOWNSHIP DELMORE PARK EXTENSION 7

Situated on Portions 24 and 396 of the farm Driefontein 85 IR - Province of Gauteng

LAND USE TABLE

LAND-USE	NOTATION	No. OF STANDS	AREA (ha)	% OF TOTAL AREA
RESIDENTIAL 1	1 - 252	252	9,0286	55,03
RESIDENTIAL 3	253	1	3,7213	22,68
PLACE OF PUBLIC WORSHIP	254	1	0,2353	1,43
INSTITUTION	255	1	0,1000	0,61
PLACE OF INSTRUCTION	256	1	0,1000	0,61
PUBLIC OPEN SPACE	257 - 259	3	0,0583	0,36
ROADS			3,1625	19,28
TOTAL		259	16,4063	100,00

- The figure "ABCDEFGHJKLA" represents Proposed Delmore Park Extension 3 situated on Portion 396 & Part of Portion 24 of the farm Driefontein 85 IR, measuring 16,4063ha in extent.
- The lines abc, be and dfg represent the centre lines of an Electric Transmission Servitude extending 11 metres on either side of the lines, Vide Diagram S.G.No. 9703/1995.
- The figure "klmnk" represents a servitude for an electrical substation as indicated. The figure "npqr" represents a 4m wide electric powerline servitude. The line "xy" represents the eastern boundary of a 2m wide servitude.
- All sizes and dimensions are approximate and subject to final survey.
- The township falls under the jurisdiction of the Ekurhuleni Metropolitan Municipality - Boksburg Delivery Centre
- Base plan information was obtained from Compu Plan Planning and GIS Solutions.
- Line of no access
- Building Line

PLAN NO: 2588/A3

Date: NOVEMBER 2007

van Graaf
PROFESSIONAL PLANNING & PROPERTY SERVICES

312 Kent Avenue, 2nd Floor, Randburg
P.O. Box 3237 Randburg 2125
Tel: 011 781 9017 Fax: 011 781 9018
e-mail: tjvb@abamail.co.za