

R505 Road

Proposed BESS

SECTION DETAILS (Illustrative Purpose)
The trench details are for illustrative purpose only. Actual parameters may change during detailed engineering.

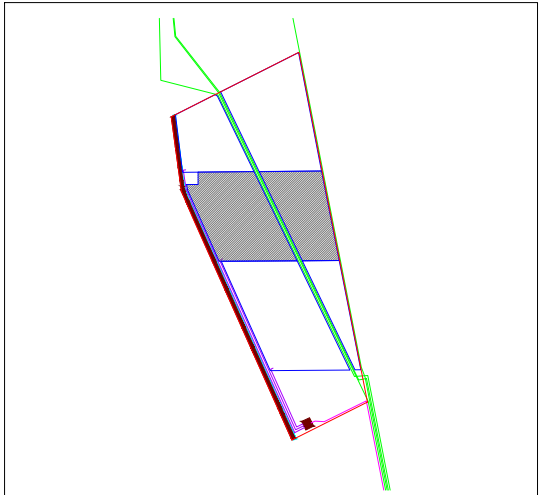
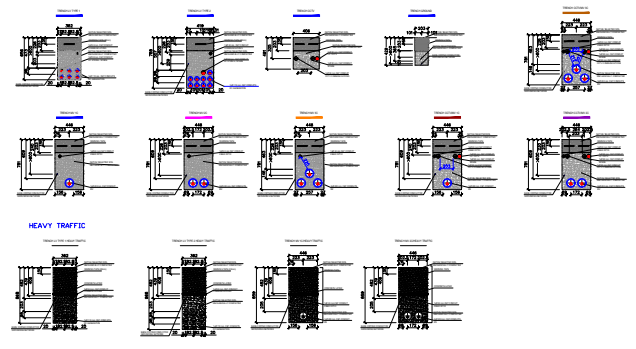

Legends	
	PV plant land Border, 269.2 Hectares
	EIA land Border, 300 Hectares
	Existing Power Lines
	2.8 MWac (2x1.4) Inverter & Transformer Station
	Rack 2V28
	Proposed Connection line Route
	Site Access Road Width: 10 - 12 m Total Length: ... m
	Perimeter Road Width: 8 m Total Length: ... m
	Internal Roads Width: 6 m Total Length: ... m
	Borrow pit
	Excess material
	Top soil
	Sub soil
	Scale: 1:5000 Unit: Meter

Foot Print			
Site	269.2 ha	Office Room	200 m2
EIA	300 ha	Staff Room	200 m2
Lay down area	1950 m2	Security Room	56 m2
Reserved Area for BESS	40000 m2	Substation	10000 m2

Subsolar Subsolar Company

Address :

Project :
Lerato Solar Power Plant (RF)(Pty) Ltd
157.8 MWdc Photovoltaic Power Plant

DWG No:

Title :
Preliminary Layout of PVP

Project Name : *Watershed 2*

Design : Technical Department of Subsolar Co.

Scale :
1:5000

Unit :
Meter

DATE :
2021.01.12

Electrical Parameters	
DC capacity of plant	157.8 MW
Number of modules	380 184 each 415 Wp (Modules are Bifacial type)
Number of Inverters	49 each 2.8 MWac