

**ERF 1211 PIERRE VAN RYNEVELD EXTENSION 2**

**AERIAL VIEW OF STUDY AREA**

FIGURE

2

**MARITENG  
CONSULTING  
ENGINEERS**

P.O. Box 8864 Tel: 011 902 4075  
Verwoerd Park Fax: 086 547 8882  
1453 Cell: 082 854 7358

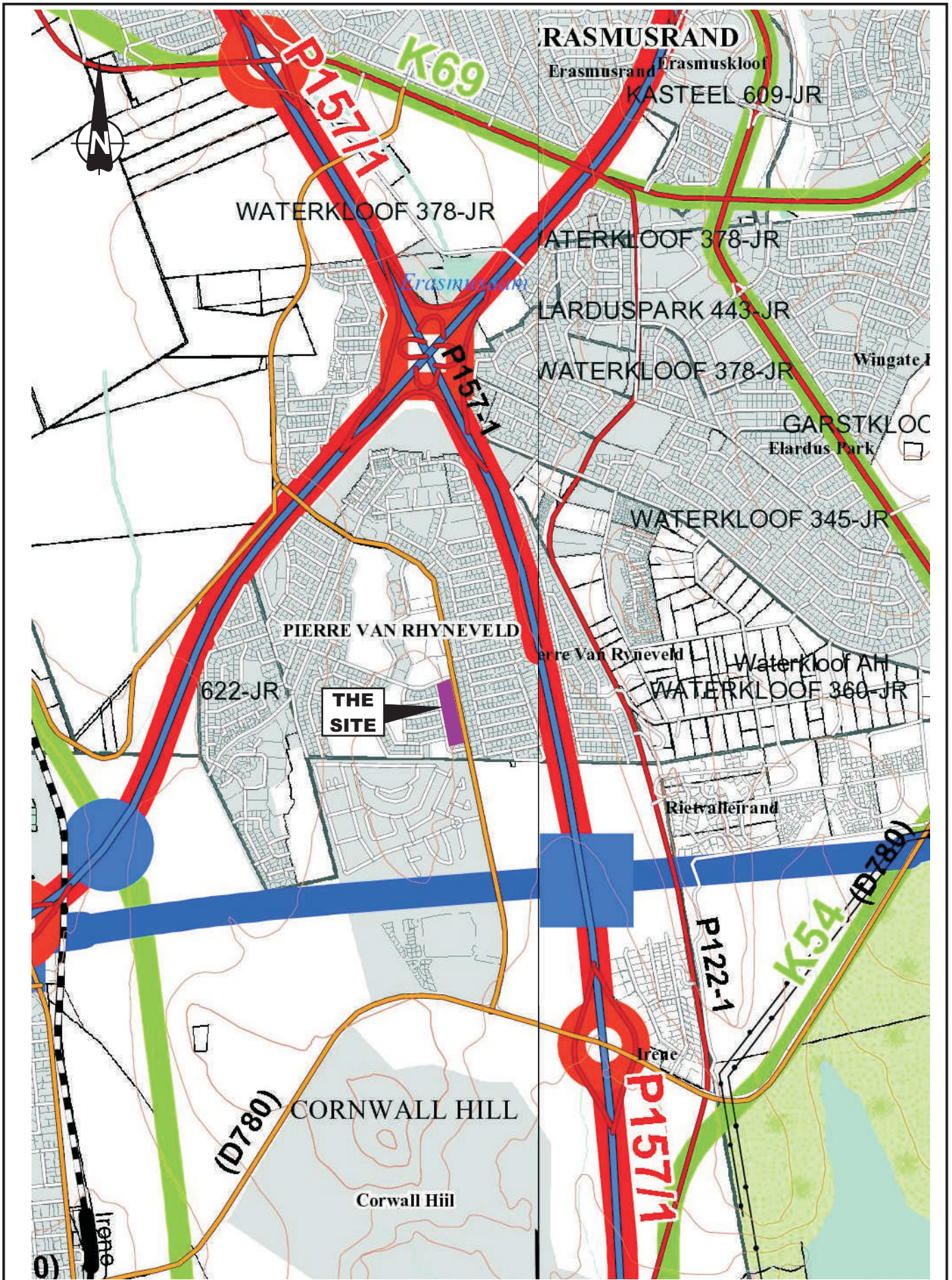

<b>M</b> ARITENG <b>C</b> ONSULTING <b>E</b> NGINEERS	P.O. Box 8864 Verwoerd Park 1453 Tel: 011 902 4075 Fax: 086 547 8882 Cell: 082 854 7358	<b>ERF 1211 PIERRE VAN RYNEVELD EXTENSION 2</b>	<b>FIGURE</b>
		<b>GAUTENG STRATEGIC ROAD NETWORK</b>	<b>3</b>

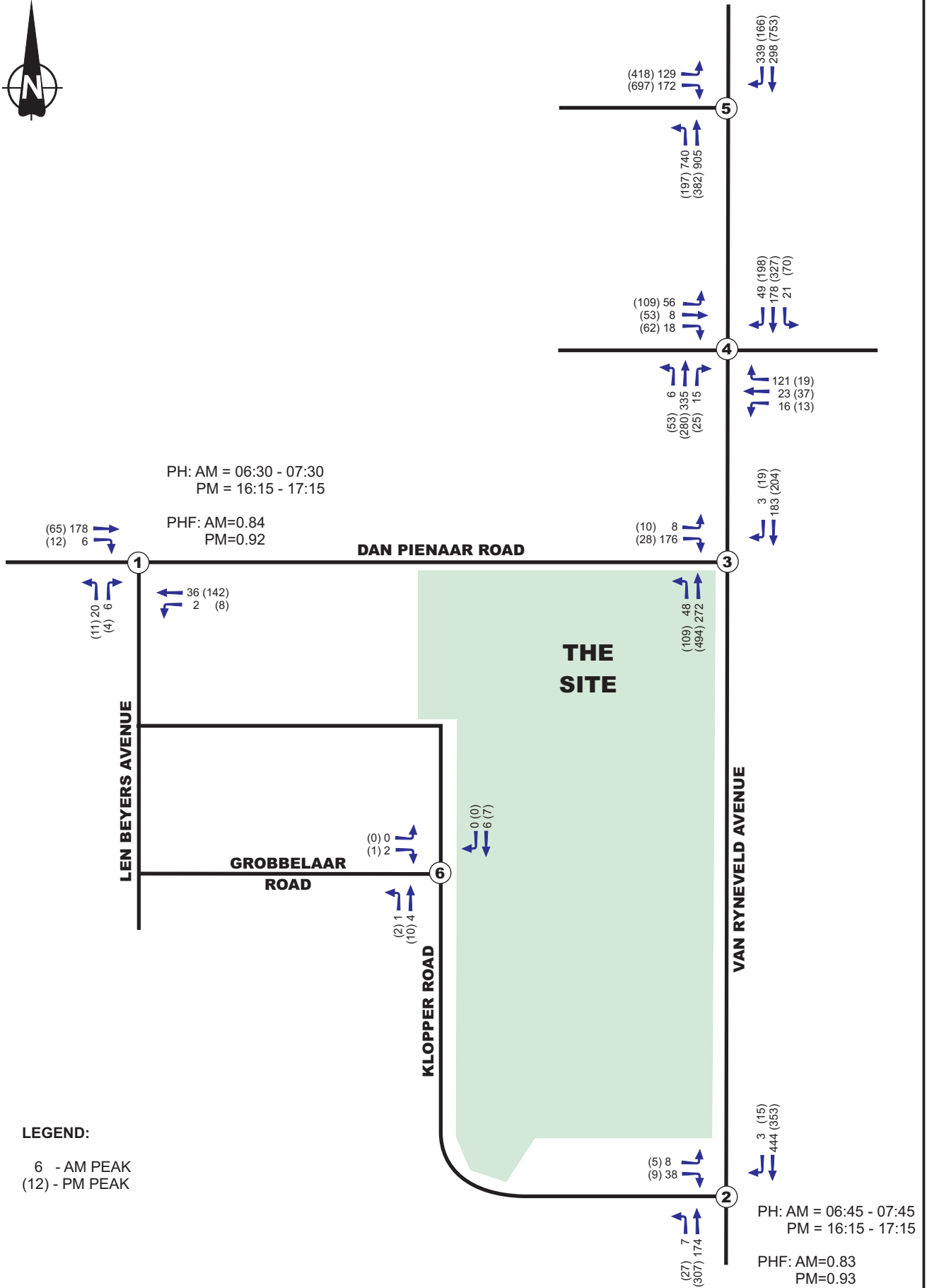

**M**ARITENG  
CONSULTING  
ENGINEERS

P.O. Box 8864  
Verwoerd Park  
1453

Tel: 011 902 4075  
Fax: 086 547 8882  
Cell: 082 854 7358

**ERF 1211 PIERRE VAN RYNEVELD EXTENSION 2**

**EXISTING WEEKDAY PEAK HOUR TRAFFIC VOLUMES - BACKGROUND TRAFFIC**

**FIGURE**

**4**

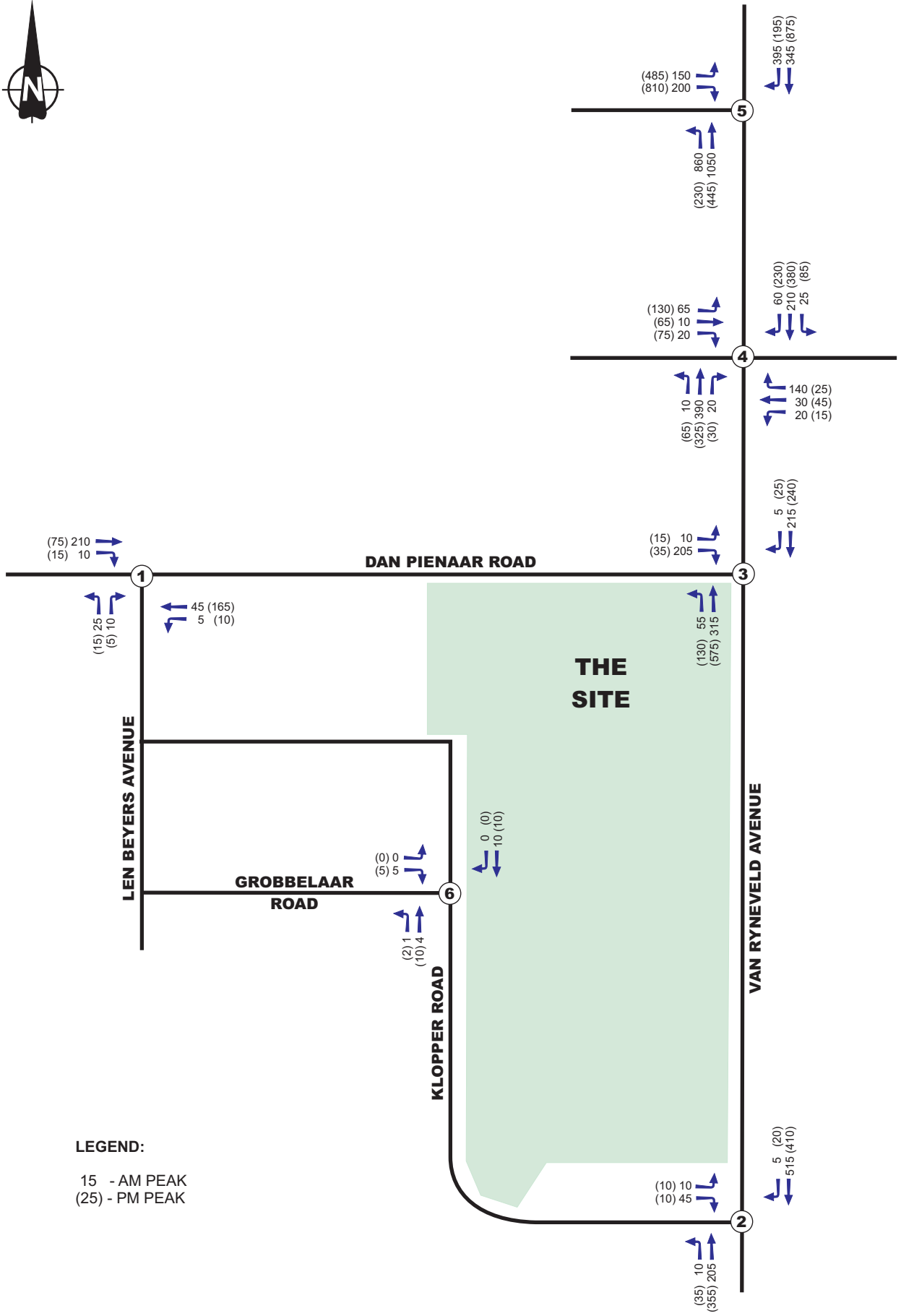

**M**ARITENG  
 CONSULTING  
 ENGINEERS

P.O. Box 8864  
 Verwoerd Park  
 1453

Tel: 011 902 4075  
 Fax: 086 547 8882  
 Cell: 082 854 7358

**ERF 1211 PIERRE VAN RYNEVELD EXTENSION 2**

**ESTIMATED (2022) WEEKDAY PEAK HOUR**

**TRAFFIC VOLUMES - BACKGROUND TRAFFIC**

**FIGURE**

**5**

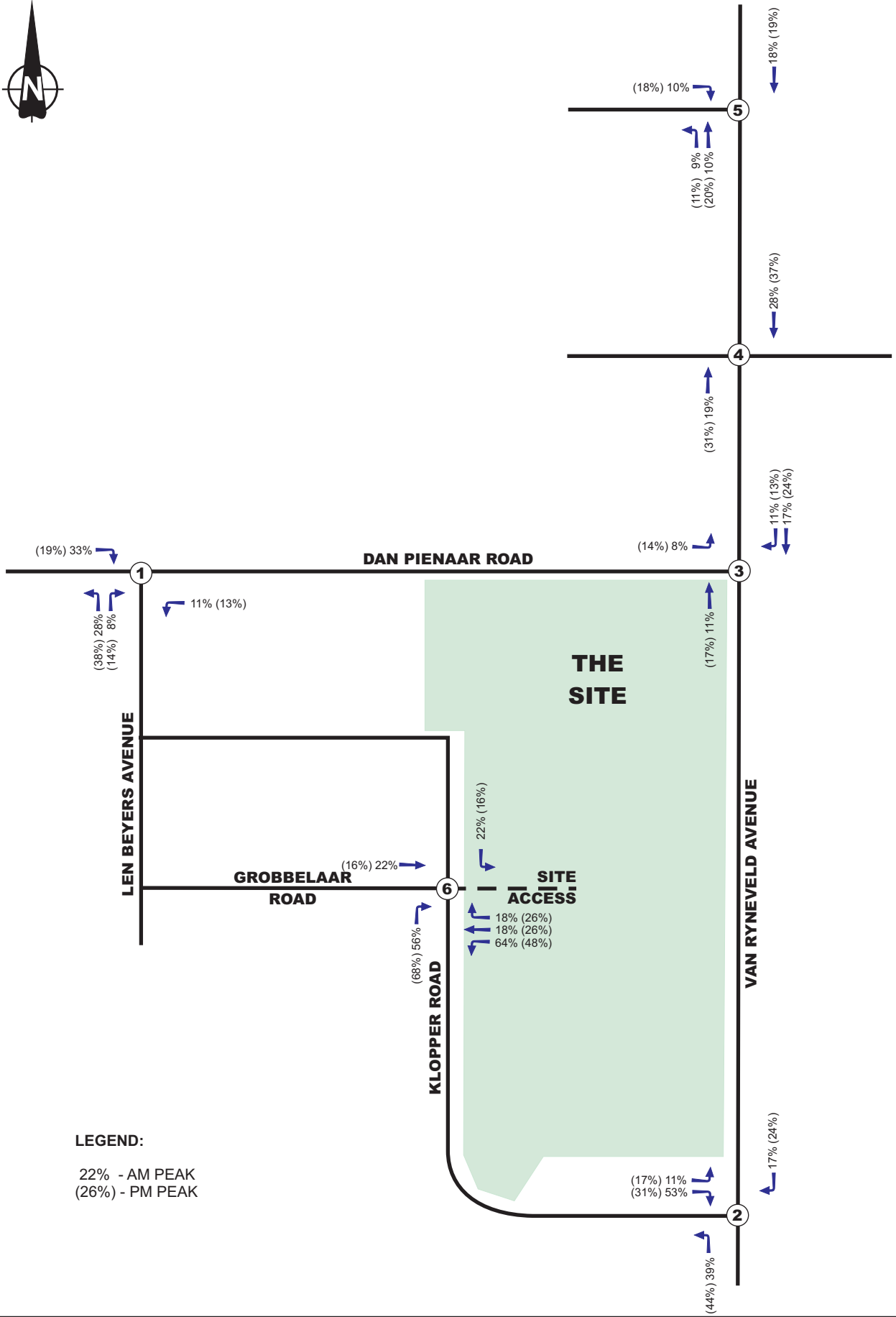

**LEGEND:**  
 22% - AM PEAK  
 (26%) - PM PEAK

**MARITENG CONSULTING ENGINEERS**  
 P.O. Box 8864  
 Verwoerd Park  
 1453  
 Tel: 011 902 4075  
 Fax: 086 547 8882  
 Cell: 082 854 7358

**ERF 1211 PIERRE VAN RYNEVELD EXTENSION 2**  
**TRIP DISTRIBUTION (%):**  
**PROPOSED DEVELOPMENT**

**FIGURE**  
**6**

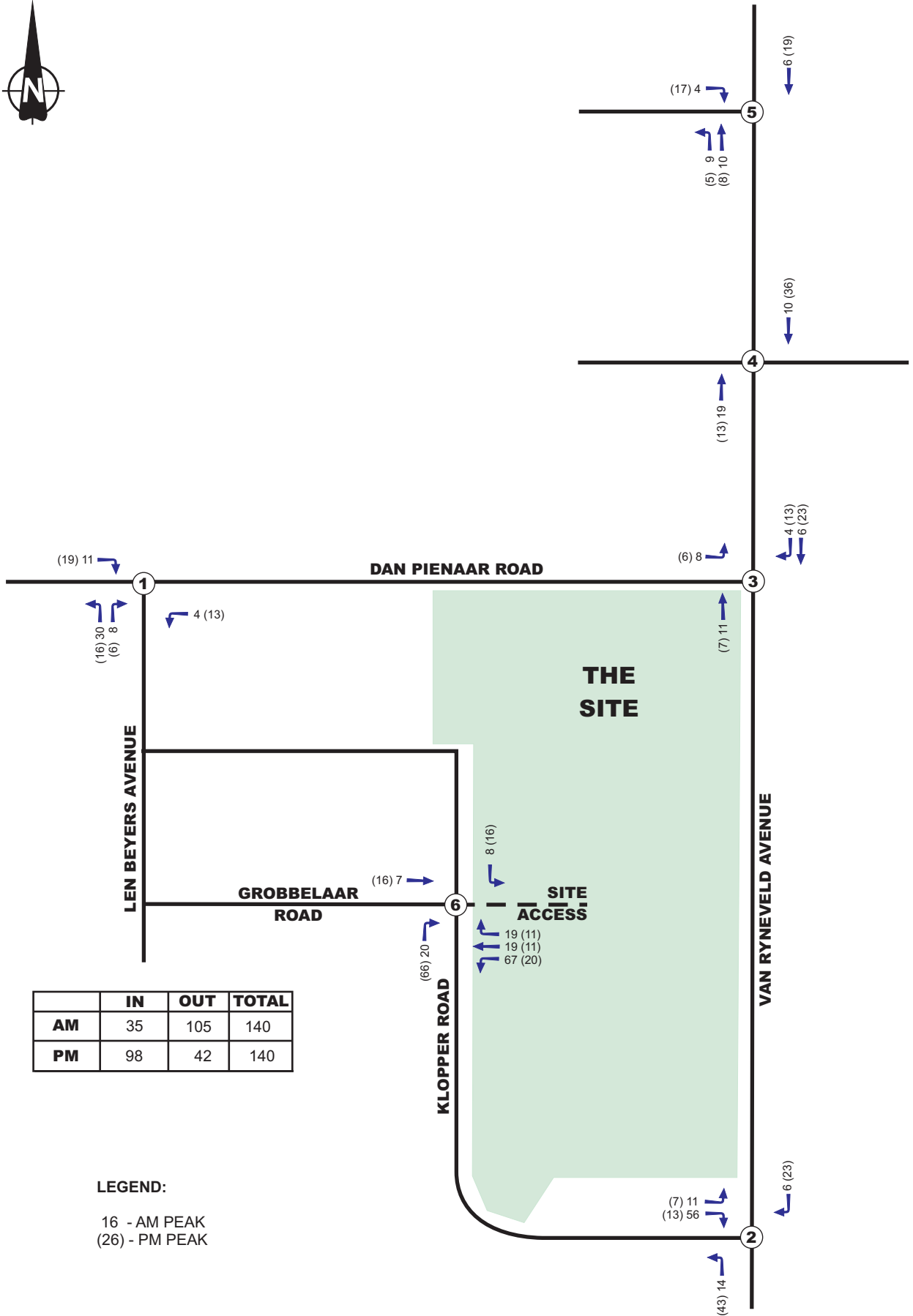

	IN	OUT	TOTAL
AM	35	105	140
PM	98	42	140

**LEGEND:**  
 16 - AM PEAK  
 (26) - PM PEAK

**MARITENG CONSULTING ENGINEERS**  
 P.O. Box 8864  
 Verwoerd Park  
 1453  
 Tel: 011 902 4075  
 Fax: 086 547 8882  
 Cell: 082 854 7358

**ERF 1211 PIERRE VAN RYNEVELD EXTENSION 2**  
**TRIP ASSIGNMENT (VEHICLES/HR) -**  
**PROPOSED DEVELOPMENT**

**FIGURE**  
**7**

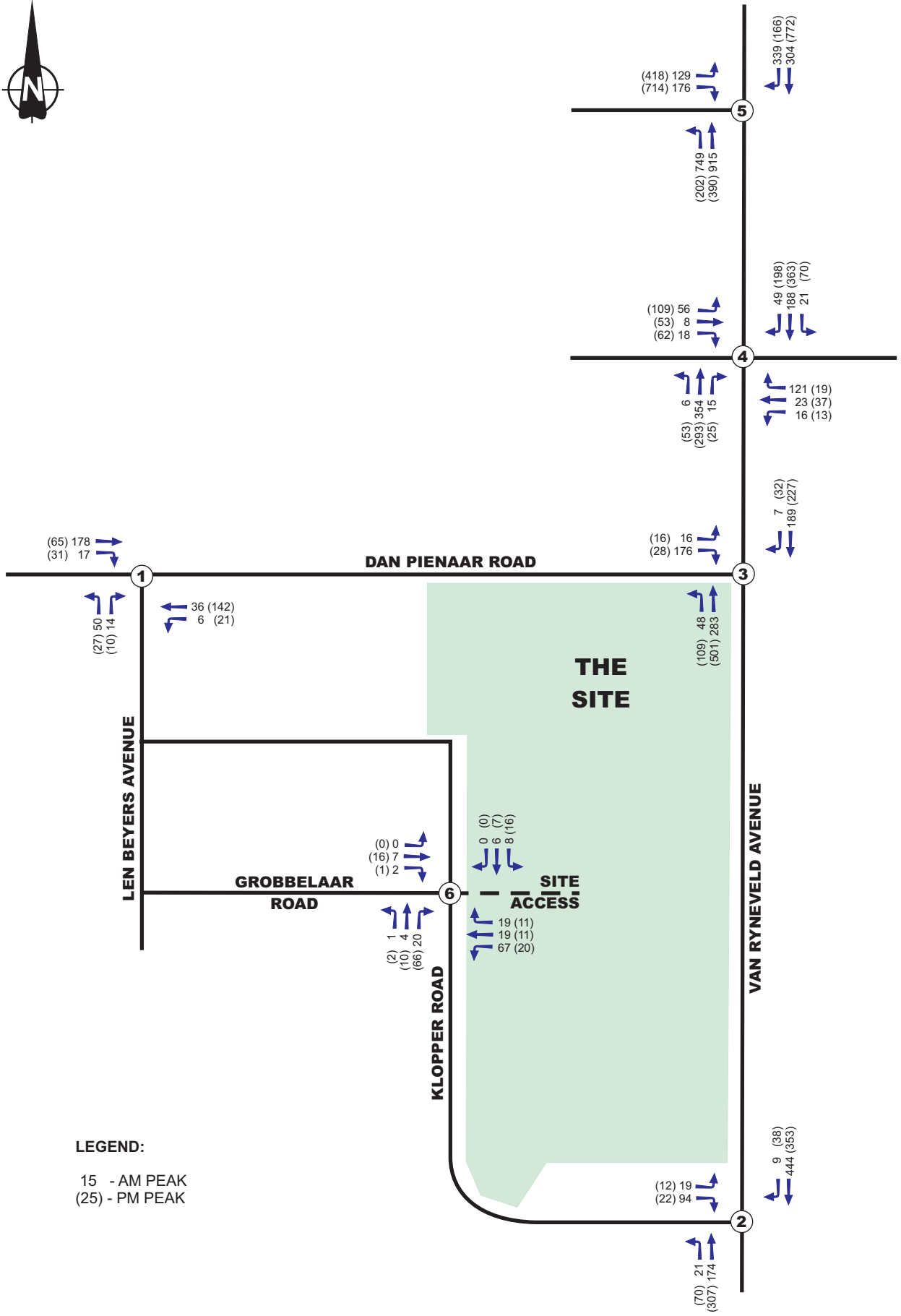

**LEGEND:**  
 15 - AM PEAK  
 (25) - PM PEAK

**MARITENG CONSULTING ENGINEERS**  
 P.O. Box 8864  
 Verwoerd Park  
 1453  
 Tel: 011 902 4075  
 Fax: 086 547 8882  
 Cell: 082 854 7358

**ERF 1211 PIERRE VAN RYNEVELD EXTENSION 2**  
**ESTIMATED (2017) WEEKDAY PEAK HOUR**  
**TRAFFIC VOLUMES - WITH DEVELOPMENT TRAFFIC**

**FIGURE**  
**8**



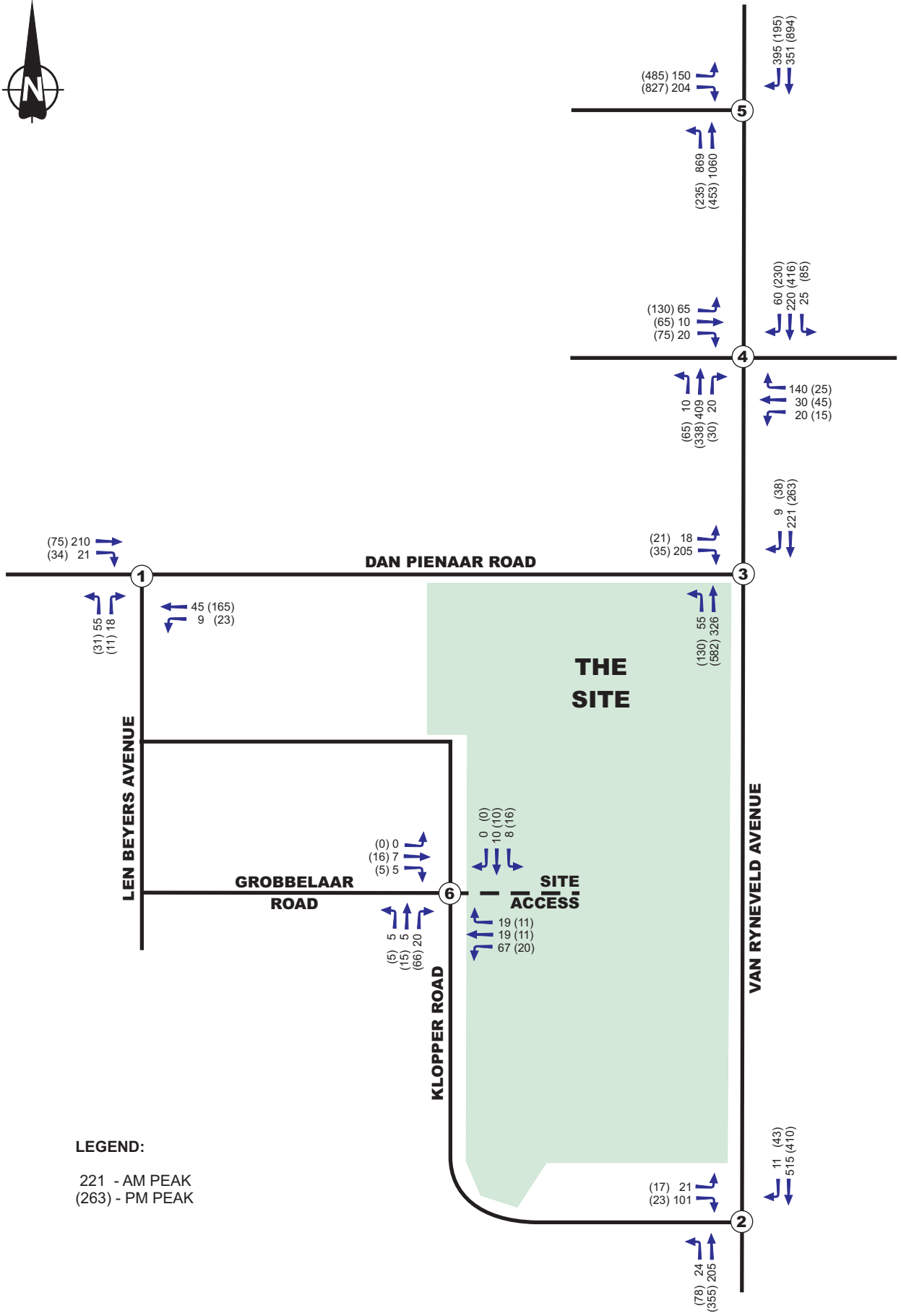

**LEGEND:**  
 221 - AM PEAK  
 (263) - PM PEAK

**MARITENG**  
**CONSULTING**  
**ENGINEERS**

P.O. Box 8864  
 Verwoerd Park  
 1453

Tel: 011 902 4075  
 Fax: 086 547 8882  
 Cell: 082 854 7358

**ERF 1211 PIERRE VAN RYNEVELD EXTENSION 2**

**ESTIMATED (2022) WEEKDAY PEAK HOUR**

**TRAFFIC VOLUMES - WITH DEVELOPMENT TRAFFIC**

**FIGURE**

**9**