

Plan Showing

1. PROPOSED SUBDIVISION OF THE FARM CROOKES NO.15723 INTO PROPOSED PORTIONS 1 TO 28 AND REMAINDER OF THE FARM CROOKES NO.15723

Situate in mKhambathini Municipality, Registration Division FT, Province of KwaZulu-Natal.

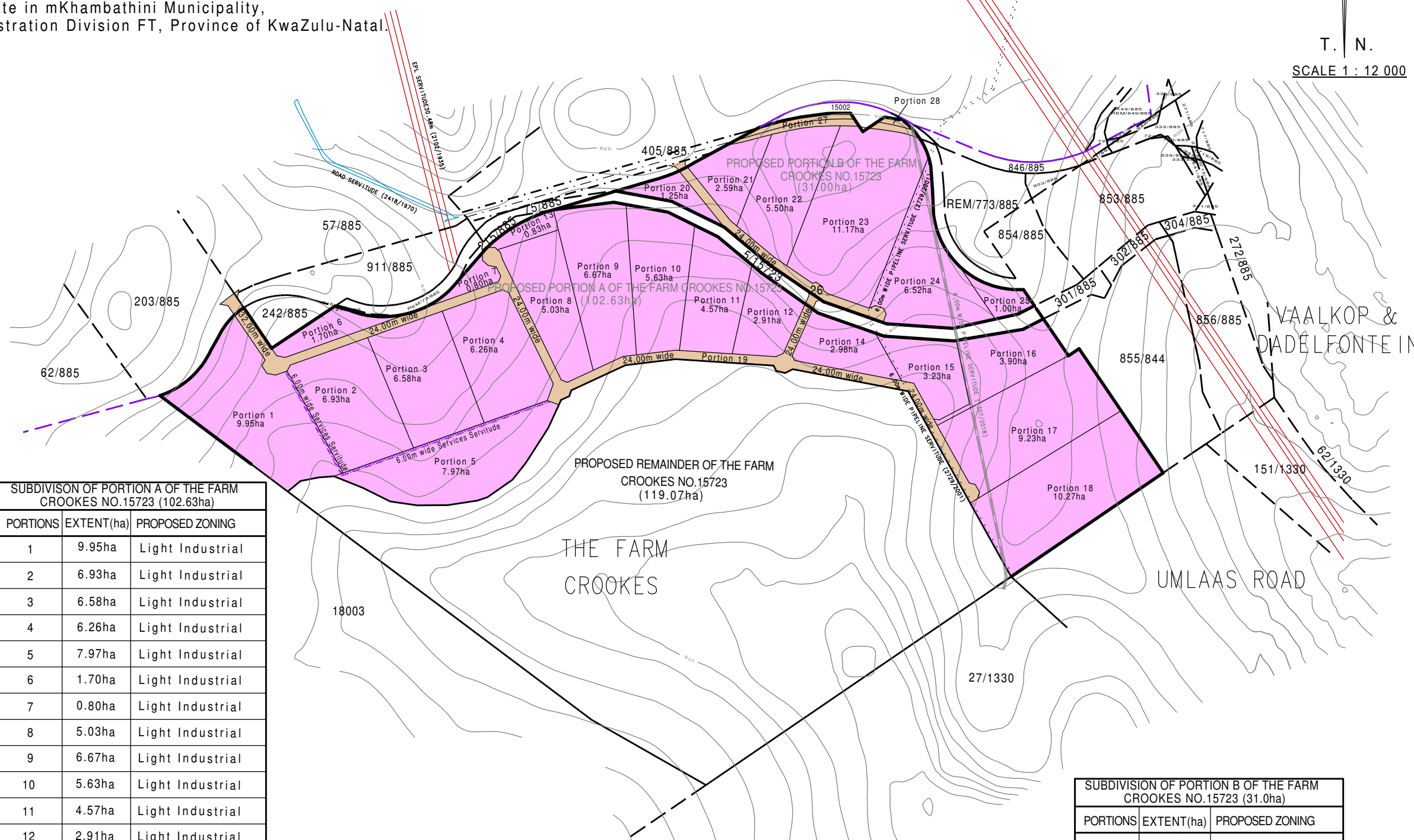
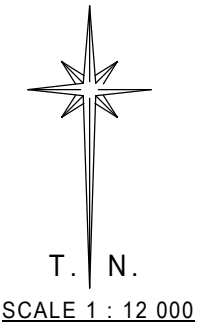

| SUBDIVISION OF PORTION A OF THE FARM CROOKES NO.15723 (102.63ha) | | |
|--|------------|------------------|
| PORTIONS | EXTENT(ha) | PROPOSED ZONING |
| 1 | 9.95ha | Light Industrial |
| 2 | 6.93ha | Light Industrial |
| 3 | 6.58ha | Light Industrial |
| 4 | 6.26ha | Light Industrial |
| 5 | 7.97ha | Light Industrial |
| 6 | 1.70ha | Light Industrial |
| 7 | 0.80ha | Light Industrial |
| 8 | 5.03ha | Light Industrial |
| 9 | 6.67ha | Light Industrial |
| 10 | 5.63ha | Light Industrial |
| 11 | 4.57ha | Light Industrial |
| 12 | 2.91ha | Light Industrial |
| 13 | 0.83ha | Light Industrial |
| 14 | 2.98ha | Light Industrial |
| 15 | 3.23ha | Light Industrial |
| 16 | 3.90ha | Light Industrial |
| 17 | 9.23ha | Light Industrial |
| 18 | 10.27ha | Light Industrial |
| 19 (ROAD) | 7.39ha | Road |
| 20 | 1.25ha | Light Industrial |

- NOTE:**
1. PORTION 25 TO BE CONSOLIDATED WITH PORTION 854(OF 844)OF THE FARM VAALKOP AND DADELFontein No.885
 2. - - - - - PIPELINE SERVITUDE 6,00m WIDE (SG No.2729/2001)
 3. ——— ROAD SERVITUDE 9,14m WIDE (SG No.3161/1969)
 4. ——— PIPELINE SERVITUDE 6,00m WIDE (SG No.1307/2018)
 5. ■■■■■ PROPOSED SERVICES SERVITUDE 6,00m WIDE

| SUBDIVISION OF PORTION B OF THE FARM CROOKES NO.15723 (31.0ha) | | |
|--|------------|------------------|
| PORTIONS | EXTENT(ha) | PROPOSED ZONING |
| 21 | 2.59ha | Light Industrial |
| 22 | 5.50ha | Light Industrial |
| 23 | 11.17ha | Light Industrial |
| 24 | 6.52ha | Light Industrial |
| ROADS: | | |
| 26 (ROAD) | 1.77ha | Road |
| 27 (ROAD) | 1.25ha | Road |
| 28 (ROAD) | 0.33ha | Road |

REVISION NOTES.

| REV NO. | DESCRIPTION | DATE |
|---------|-------------|---------|
| 001 | SUBDIVISION | 12/2021 |
| 002 | PLAN UPDATE | 01/2022 |
| 003 | PLAN UPDATE | 01/2022 |
| 004 | PLAN UPDATE | 01/2022 |
| 005 | PLAN UPDATE | 05/2022 |
| 006 | PLAN UPDATE | 05/2022 |

OWNER : TAMASA TRADING 288 cc
 PROPOSED USAGE : 1) LIGHT INDUSTRIAL
 2) CORE MIXED USE
 DIAGRAM : SV 874 Fol 90
 DEED : T31424/2005
 STREET ADDRESS : N/A

ALL MEASUREMENTS AND AREAS ARE APPROXIMATE AND SUBJECT TO ACTUAL SURVEY

Prepared by :
 W.I.M. TURNBULL Professional Land Surveyor

FILE: PMB52/APPLICATIONS
 DRAWING : PROPOSED SUBDIVISION
 REV06 (A3)
 DATE: MAY 2022

Prepared by :
BUTTON & O'CONNOR INC.
 Professional Land Surveyors

Telephone 031-2662278 P.O. Box 1863
 Fax : 031-2669753 Westville
 16 Westville Centre, 3630
 52 Norfolk Terrace,
 Westville. 3630

Tel : (039) 7271564 P.O. Box 1921
 Fax : (039) 7271564 Kokstad
 34 Strachan Street 4700
 Kokstad 4700

REVISION NO : 06
 DRAWN BY : NEM