

## BLAUWWILDEBEESTFONTEIN 16 JS Remainder of Portion 1

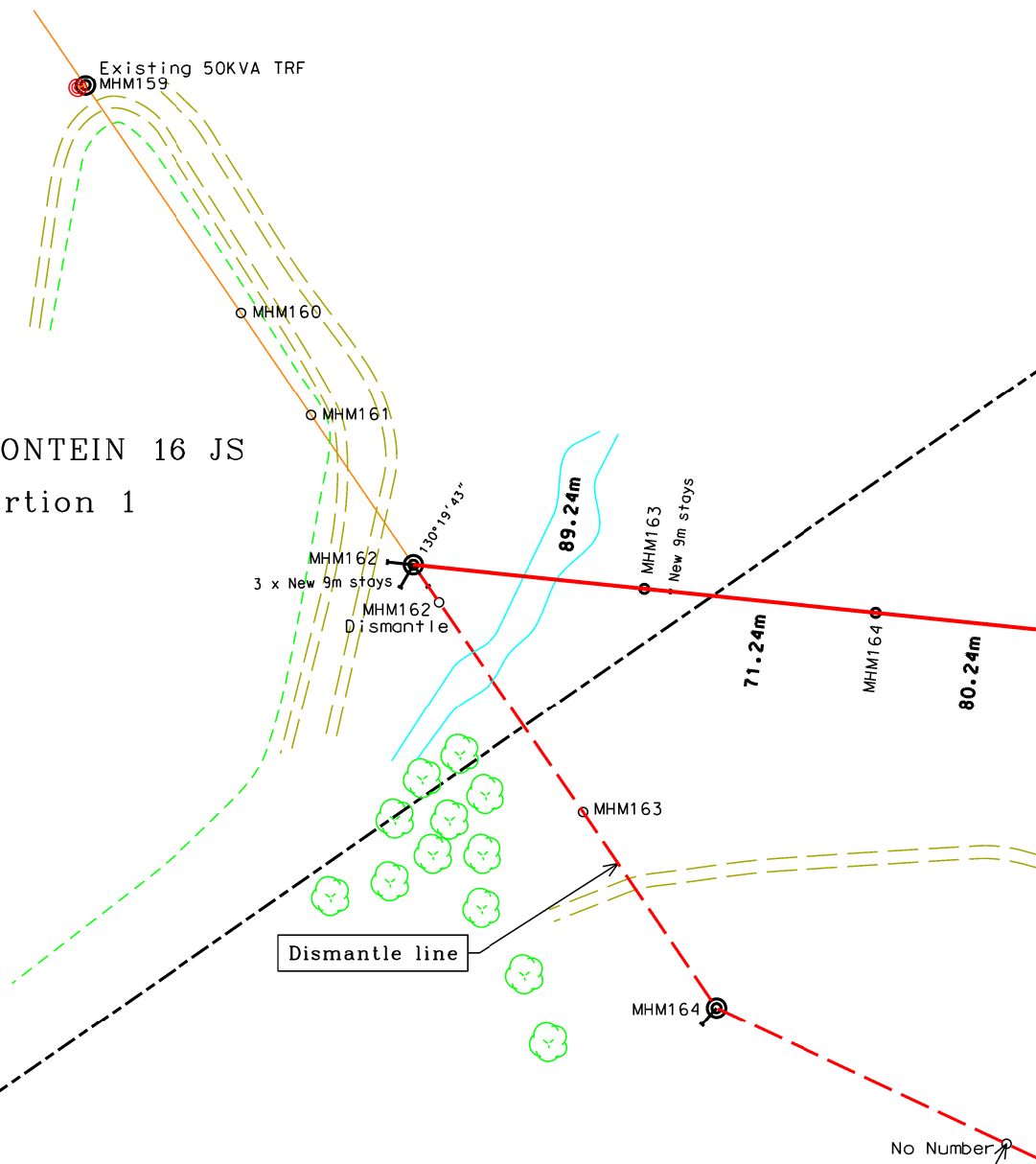

### LEGEND

	EXISTING MV LINE
	EXISTING LV LINE
	NEW MV LINE
	MV POLE BEND
	MV POLE INTERMEDIATE
	FARM BOUNDARY
	PORTION BOUNDARY
	STANDS
	FENCE
	EXISTING TELKOM LINE
	WATER PIPE LINE
	TAR ROAD
	GRAVEL ROAD

Existing links

	3	
	2	
	1	
	0	
SURVEYOR	REV	SURVEY DATE

FEEDER: MARBLE HALL / MOESRIVIER OVERHEAD 22KV	CUSTOMER: SCHOEMAN BOERDERY
PROJECT NO: GG315473625	
CONDUCTOR: MINK	PROPERTY: BLAUWWILDEBEESTFONTEIN 16 JS Portion 11, Rem of 12 and Rem of Portion1
LENGTH OF LINE: 787.88m Dismantle 801.91	
SURVEYOR: E V/D WESTHUIZEN	CONTACT DETAILS:
DRAUGHTSPERSON: AM SCHOEMAN	SCALE: 1 : 2500 (A4)      PAGE: 1 of 3

THIS DRAWING IS THE PROPERTY OF Eskom  
Disclaimer: Eskom is not responsible for any errors displayed on this drawing

## BLAUWWILDEBEESTFONTEIN 16 JS Remainder of Portion 12

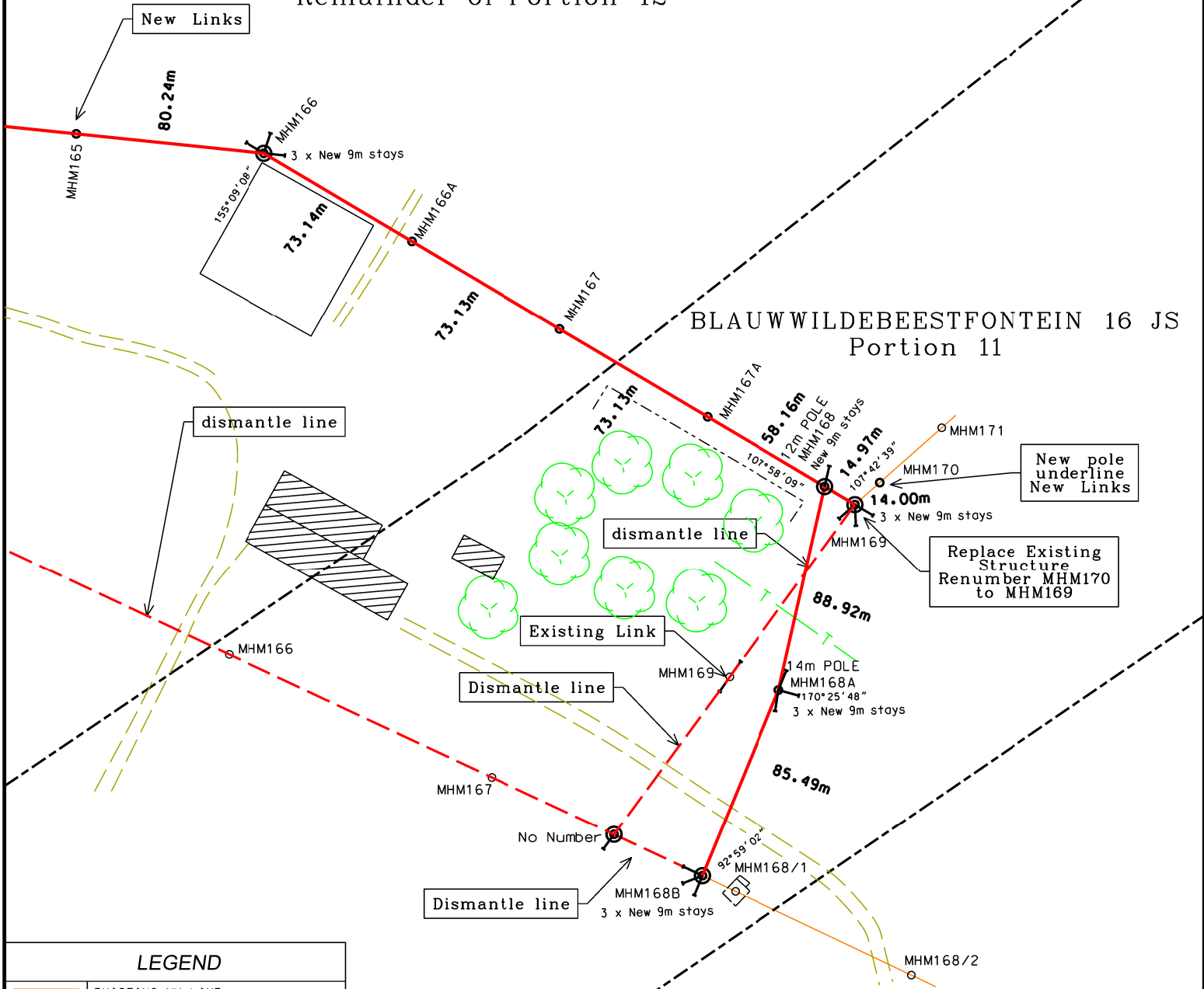

### LEGEND

	EXISTING MV LINE
	EXISTING LV LINE
	NEW MV LINE
	MV POLE BEND
	MV POLE INTERMEDIATE
	FARM BOUNDARY
	PORTION BOUNDARY
	STANDS
	FENCE
	EXISTING TELKOM LINE
	WATER PIPE LINE
	TAR ROAD
	GRAVEL ROAD

	3	
	2	
	1	
	0	
SURVEYOR	REV	SURVEY DATE

FEEDER: MARBLE HALL / MOESRIVIER OVERHEAD 22KV

CUSTOMER: SCHOEMAN BOERDERY

PROJECT NO: GG315473625

CONDUCTOR: MINK

PROPERTY: BLAUWWILDEBEESTFONTEIN 16 JS  
Portion 11, Rem of 12 and Rem of Portion 1

LENGTH OF LINE: 784.46m Dismantle 801.91

SURVEYOR: E V/D WESTHUIZEN

CONTACT DETAILS:

DRAUGHTSPERSON: AM SCHOEMAN

SCALE: 1 : 2500 (A4)

PAGE: 2 of 3



# POLOKWANE LAND DEVELOPMENT

PROFILE OF : TEL/LINE CROSSING

FEEDER : MARBLE HALL / MOSESRIVIER 22kV

PROJECT NO : GG315473625

CLIENT :SCHOEMAN BOERDERY

COMPILATION NO : 2529 AB N

SCALE HOR. 1 : 2500

VERT. 1 : 250

CONDUCTOR : MINK

SURVEYOR : TSHUKUDU SURVEY'S

WARM CURVE : 35 DEG

ATTACH. HEIGHT :

A = 9.8

B = 9.2

Min Sag Height = 1.09m  
between the New MV  
and Existing Telephone line

TEMPLATED BY :

E vd Westhuizen

DATE :

7/12/2019

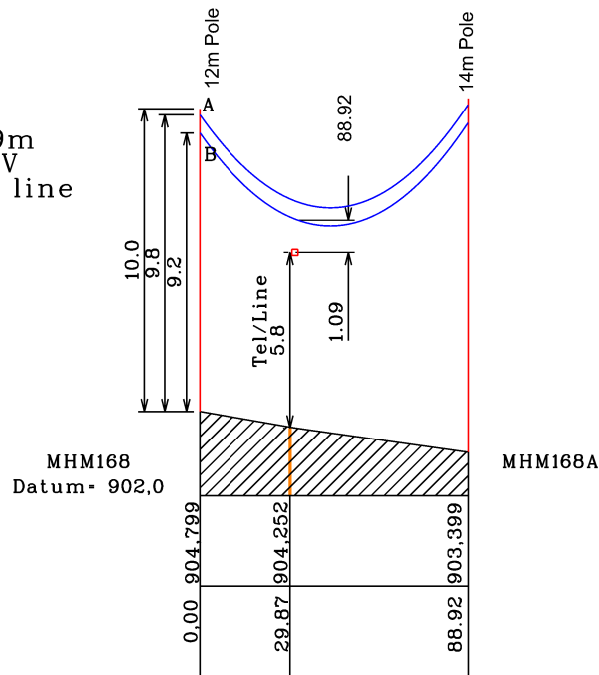

## BLAUWWILDEBEESTFONTEIN 16 JS Portion 11

