

TWYFELAAR 119 KT Remainder

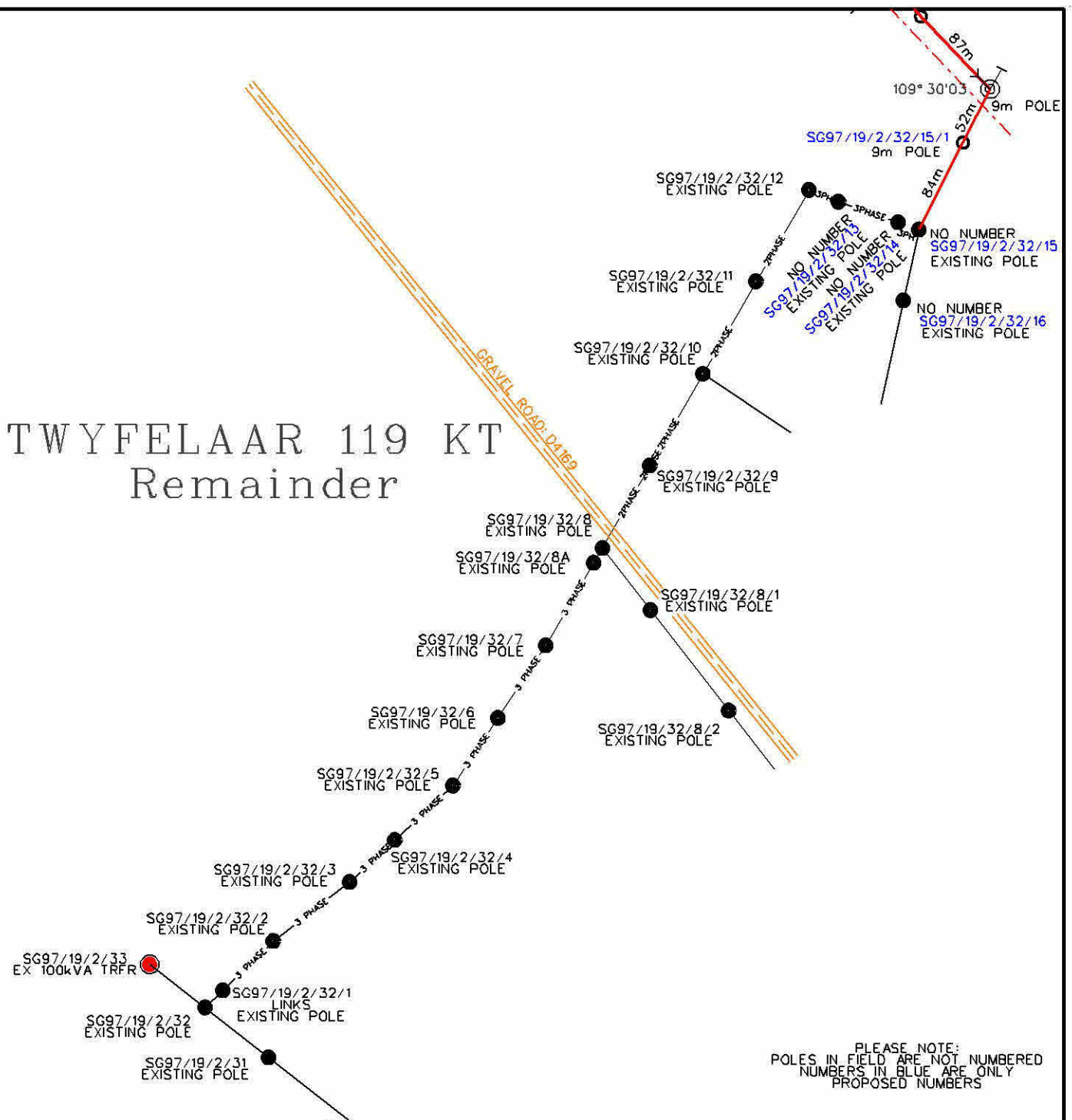

LEGEND

- Existing MV Line (22kV)
- Existing Pole
- ⊙ New Pole Under Line
- New TRF
- ▬ Road
- - - Fenced Stand
- 🌳 Tree

LJCC ENGINEERING SURVEY



P.O. BOX 12452
BENDOR 0699
TEL. (015) 297 7457
EMAIL: admin@ljcc.co.za

FEEDER: STEELPOORT/GROOTHOEK 22kV	CUSTOMER: KAVAR ENGINEERING	
PROJECT NO: H12-1131	PROPERTY: TWYFELAAR 119 KT	
CONDUCTOR: FOX	CONTACT DETAILS: (015) 297 7457	
LENGTH OF LINE: 0.684km	SCALE: 1 : 5 000	
SURVEYOR: A NEETHLING (082 463 1253)	PAGE: 1 of 2	
DRAUGHTSPERSON: A NEETHLING (082 448 2641)		

TWYFELAAR 119 KT Remainder

