

TOWN PLANNING SECTION  
 APPROVED  
 DATE 1980-04-2  
 SIGNATURE *[Signature]*

*Paul E. Norkis*  
 the registered owner of property described as  
 Lot 5 of Unit 1 of UCT  
 No 860  
 hereby acknowledge that any portion of the  
 precast walling erected upon the Durban City  
 Council's servitude area on the said property,  
 is erected and will remain there at my own risk,  
 and if damaged in the course of any Departmental  
 work carried out within the said servitude area, no  
 liability whatever shall attach to the Durban City  
 Council in respect of such damage.  
 Date 26.5.80  
 Signed *[Signature]*

**ORIGINAL**

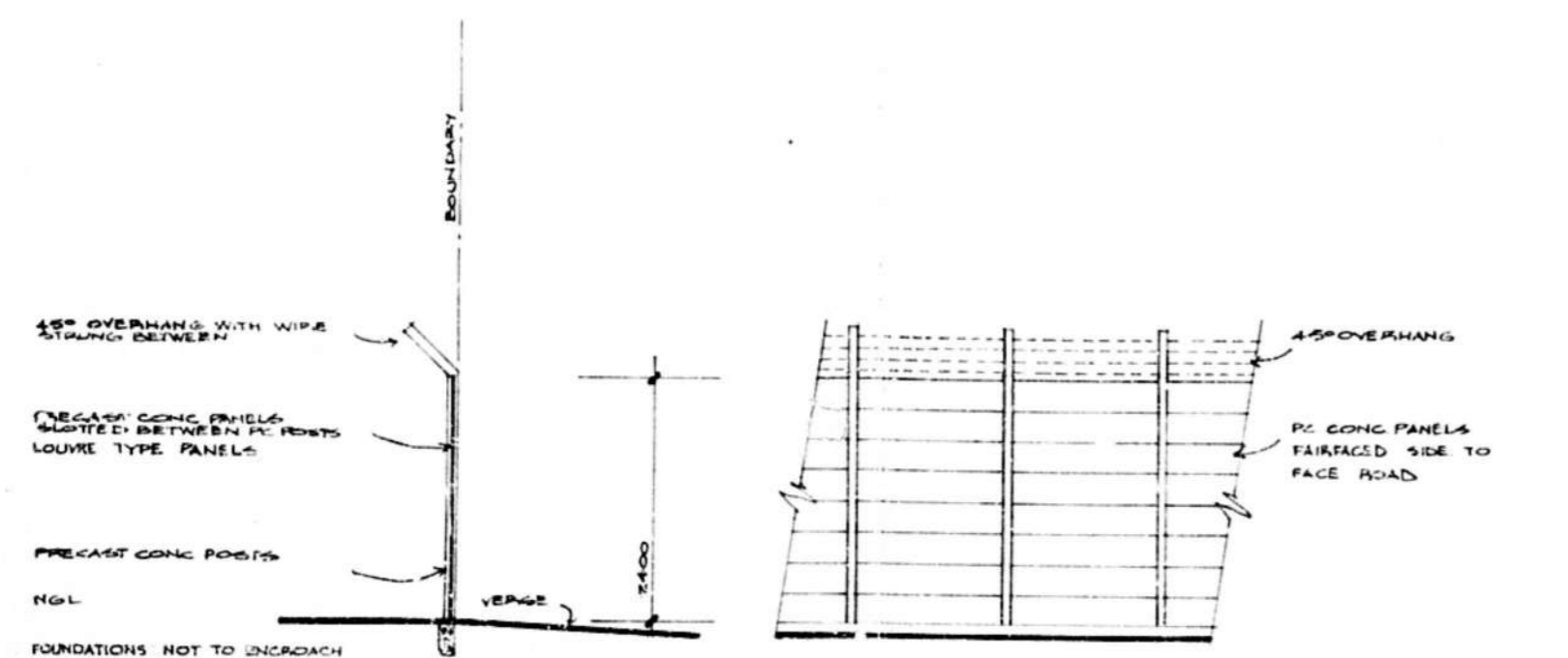

**SECTION THRU PART ELEVATION**  
**BOUNDARY FENCE** SCALE 1:50

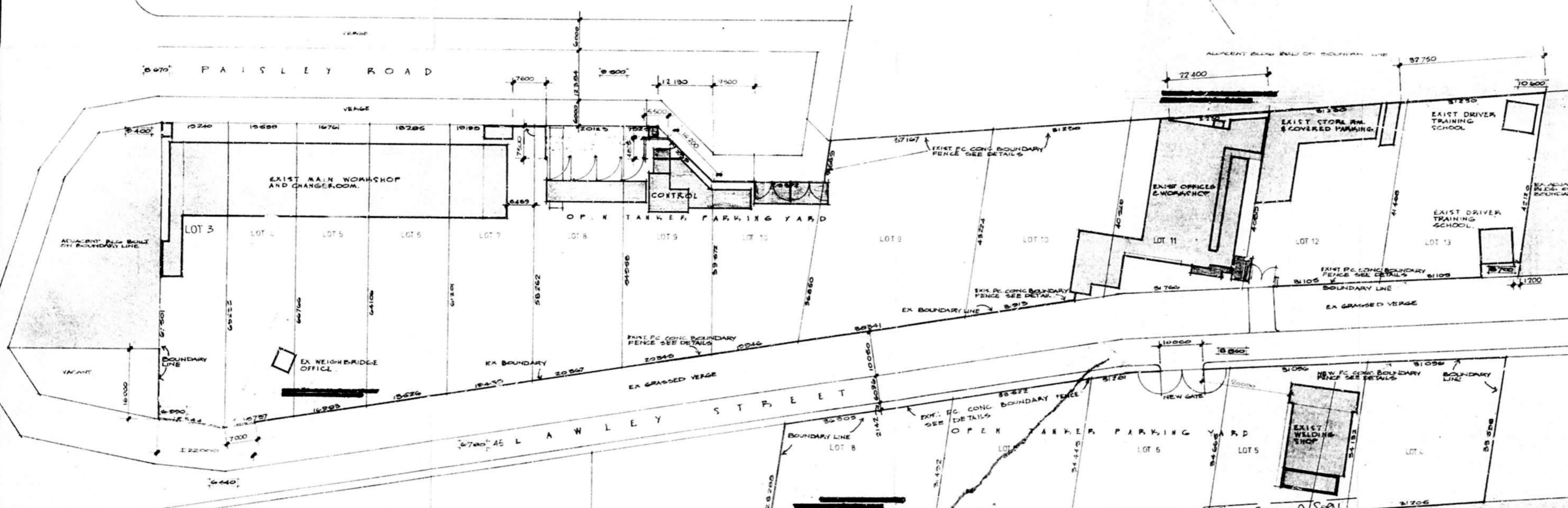

**SITE PLAN** SCALE 1:500  
**SITE DESCRIPTION**  
 LOTS 3-10 INCLUSIVE OF LOT 84 BLOCK C TOWNSHIP OF DURBAN WEST OF WENTWORTH  
 AND LOTS 4-13 INCLUSIVE OF WAH OF WENTWORTH HF 860  
 46 LAWLEY STREET  
 RATE NO. 281259  
**NOTE:**  
 FENCE NOT TO RETAIN MORE THAN 300MM.  
 FENCE AND FOUNDATIONS NOT TO ENCRoACH OVER BOUNDARIES.

**NOTE:**  
 CONTRACTOR TO CHECK ALL LEVELS & DIMENSIONS ON SITE

B. REVISED TO SUIT CITY ENGINEERS BY-LAWS  
 22-1-80  
 A. REVISED 30.10.1978

ALL SIZES  
 TO BE CHECKED  
 ON SITE

THIS PRINT FOR \_\_\_\_\_ DATE \_\_\_\_\_ BY \_\_\_\_\_

**TANKER SERVICES (PTY) LIMITED**  
 46 LAWLEY STREET  
 JACOBS 147 DURBAN

WORKING DRAWING FOR  
 BOUNDARY FENCE

**SITE PLAN**

**DRAWING NO**  
 7827/146

SCALE AS SHOWN  
 DATE DEC 1979  
 DRAWN \_\_\_\_\_

G. HIRLAY, MOORE, HARRIS, FELS AND PARTNERS  
 ARCHITECTS AND TOWNPLANNERS  
 HIGHWAY HOUSE, 93 JAN SMUTS HIGHWAY,  
 DURBAN. TELEPHONE 812221

