

N<sup>o</sup>130.

S. A. R.

HOPEFIELD HOETJES BAY RAILWAY.

Plan of Vredenburg Branch etc,  
showing Arrangement of Through Mileage.

<u>Through Mileage of Junction Points, Witteklip Nek =</u>	<u>Ms Chs</u> 80, 43.53	<u>from Kalabas Kraal.</u>
<u>Distance round Turning Loop to Junction Points</u>	<u>Chs</u> 28.91	
<u>Through Distance to Junction Points D<sup>o</sup></u> <u>via the Turning Loop.</u>	80, 72.44	D <sup>o</sup>
<u>Distance from Junction Points Witteklip Nek</u> <u>to Centre of Vredenburg Station.</u>	1, 36.895	
<u>Through Mileage of Vredenburg Station.</u>	82, 29.335	D <sup>o</sup>
<u>Distance from Centre of Vredenburg Station</u> <u>to Junction Points, Witteklip Nek.</u>	1, 36.895	
<u>Through Mileage of Junction Points D<sup>o</sup></u> <u>via Vredenburg.</u>	83, 66.23	D <sup>o</sup>

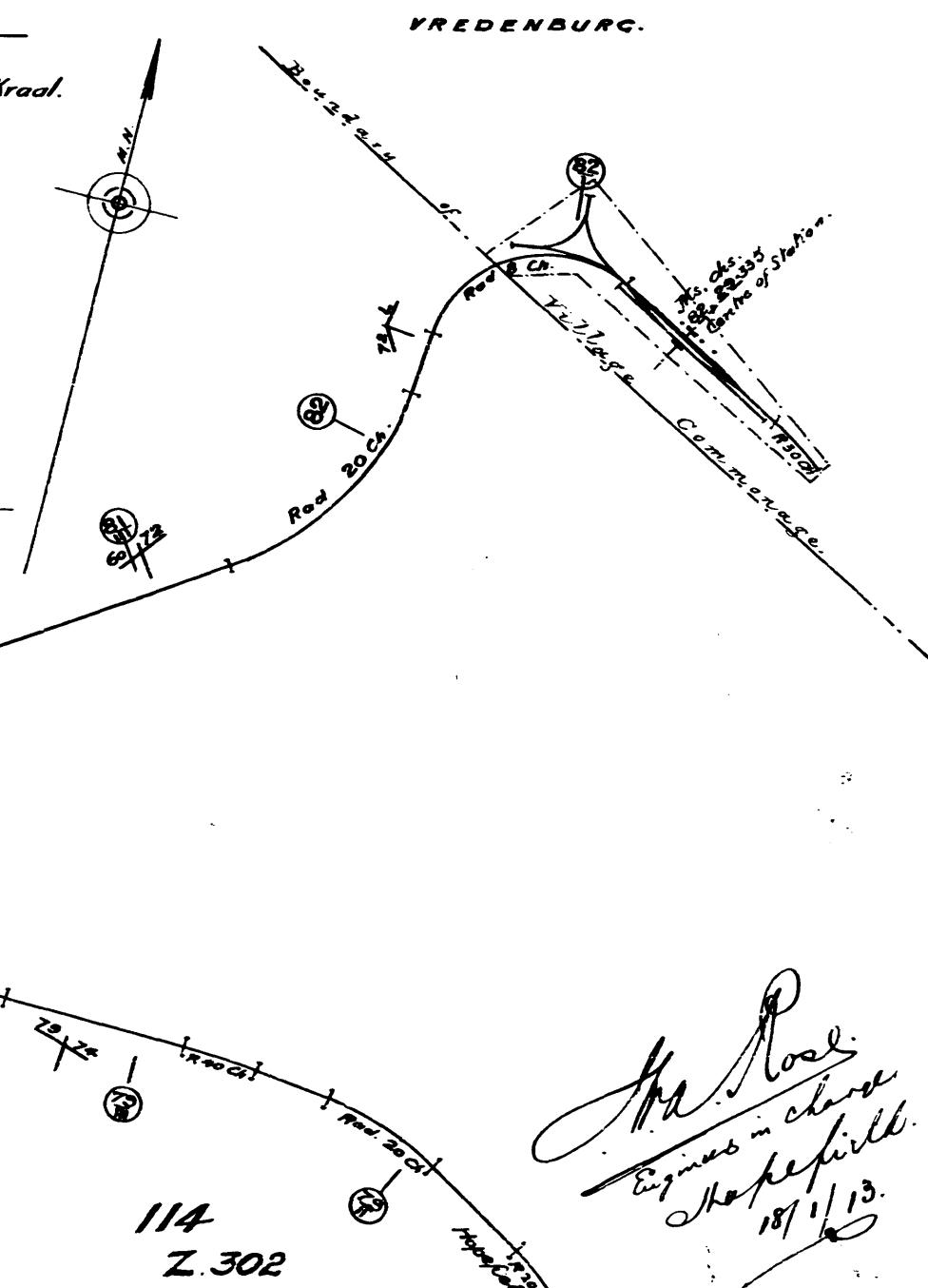

Ms. Chs.  
 80, 43.53  
 80, 72.44  
 82, 29.335  
 83, 66.23  
 from Kalabas Kraal  
 via Turning Loop to Vredenburg.

Distance for the  
 Through Journey  
 17 Chains, 30 links

SCALE, 10 chains to 1 inch.

MICROFILM  
-04-1084

114  
Z. 302

*Mr. Rose*  
 Engineer in charge  
 Hopefield  
 1871/13.