

- NOTES:
- FOR GENERAL NOTES REFER DRAWING J01599-00-G-101
 - ALL CONNECTIONS SHOWN ARE RECOMMENDATIONS ONLY. FINAL CONNECTION DESIGNS SHOULD BE SUBMITTED TO ENGINEER FOR WRITTEN APPROVAL.
 - CONCRETE DETAILS REFER DWG J01599-03-04-101 TO J01599-03-04-107
 - REINFORCEMENT DETAILS REFER DWG J01599-03-04-201 TO J01599-03-04-206

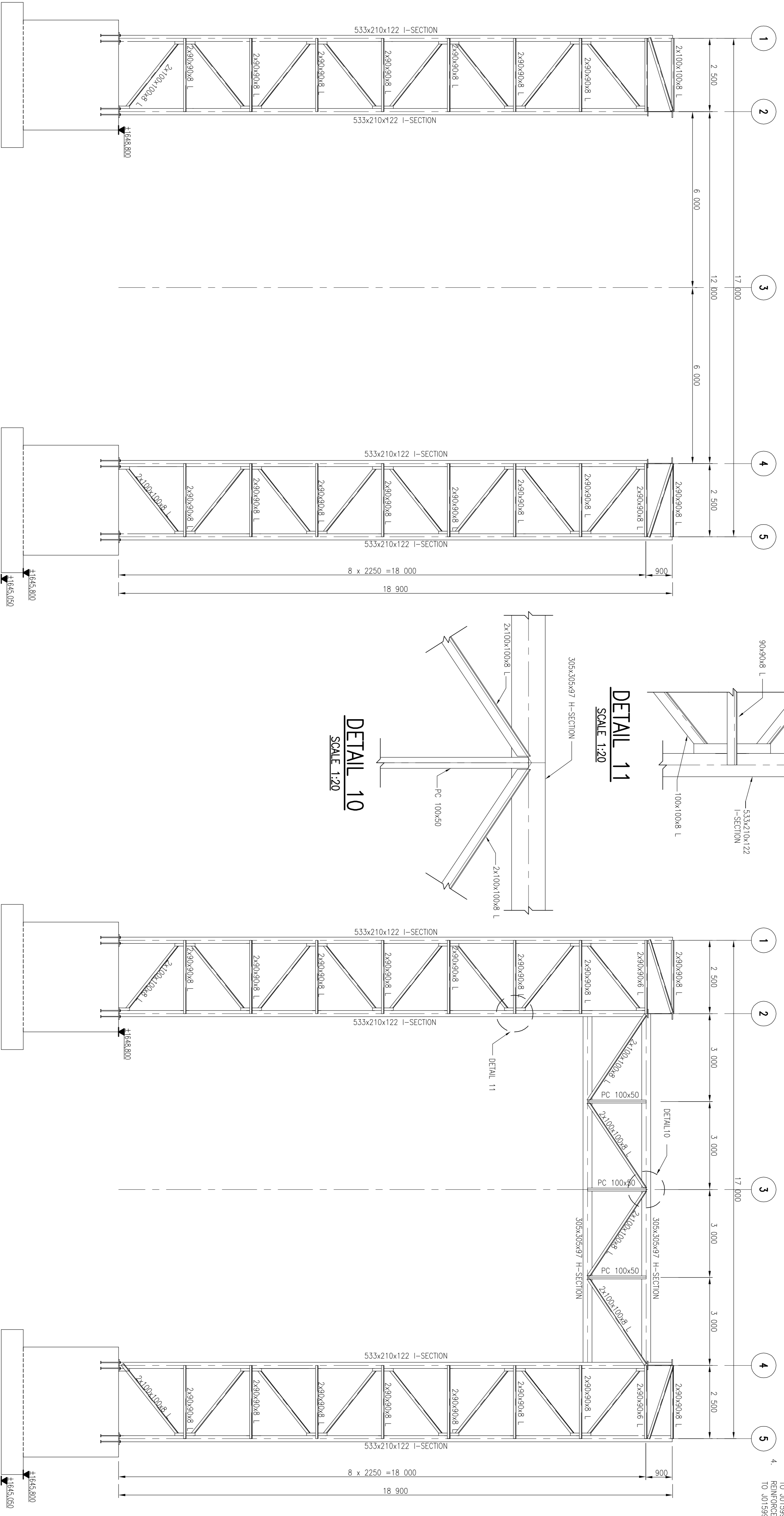

STEEL LAYOUT ON GL E, F & G
SCALE 1:75

STEEL LAYOUT ON GL H
SCALE 1:75

SECTION	SECTION NUMBER
01	1
	SHEET NUMBER

SHEET	DESCRIPTION	OTHER No.	REG. No.
1	LIST OF DRAWINGS		

ACID MINE DRAINAGE: WITWATERSRAND GOLD FIELDS

WESTERN BASIN

SHAFT PUMP STATION
SUPERSTRUCTURE : STRUCTURAL STEEL DETAILS
BRACING LAYOUT

FUNCTION	NAME	SIGNATURE
DESIGNED	M. PRINSHO	N/A
DRAWN	G. PRINSHO	N/A
DESIGN CHECKED	H. BARBERG	N/A
DESIGN REVISION	P. VILJOEN	N/A
APPROVAL - CONSULTANT		
BKS	H. BOSMAN	DATE: 06/09/12 20100329
TCA	C. RESHNER	SIGNATURE: SIGNED
THE MASTER HEAD OF THE PROJECT OFFICE BEARS THE ORIGINAL SIGNATURE OF APPROVAL		
BKS PROJ. No.	SUB No.	DISCIPLINE
J01599-01	04	212
CONTRACT NUMBER: TCA 08-041		



CLIENT:

CONSULTANT:

REGIONAL OFFICE: WATER ENGINEERING
185 SCHOEMAN STREET
PRETORIA 0001
Tel: +27 (0)12 431 3000
Fax: +27 (0)12 431 3038
Reg. No. 1986/00693/07

WOD No.	DATE	REVISION	DESCRIPTION
C-00	25/03/14	ISSUED FOR CONSTRUCTION	

ENGINEER:	DATE:	EXTERNAL APPROVAL:
CHECKER:	DATE:	DATE:
CHIEF ENGINEER / App (Pr. Eng):	DATE:	DIRECTOR (Pr. Eng):

PROVINCE:	GAUTENG	DISTRICT:	JOHANNESBURG
LOCALITY No.:	N/A	CONTRACT No.:	TCA 08-041
CALC. FILE:	N/A	KEYCODES:	SHEET REG. No.
			1 OF 1
		OTHER NUMBER:	REG. No.
			00