

SIDES Metres	ANGLES	CO-ORDINATES	
		Y	X
	Constants:	+ 20 000,00	+3100 000,00
AB	63,23	A 90 00 00	A + 4 086,95 + 79 442,47
BC	64,47	B 90 00 00	B + 4 024,48 + 79 432,64
CD	63,23	C 90 00 00	
DA	64,47	D 90 00 00	D + 4 076,94 + 79 506,15
		8L6	+ 4 597,91 + 79 622,23
		36L6	+ 4 582,52 + 79 516,50

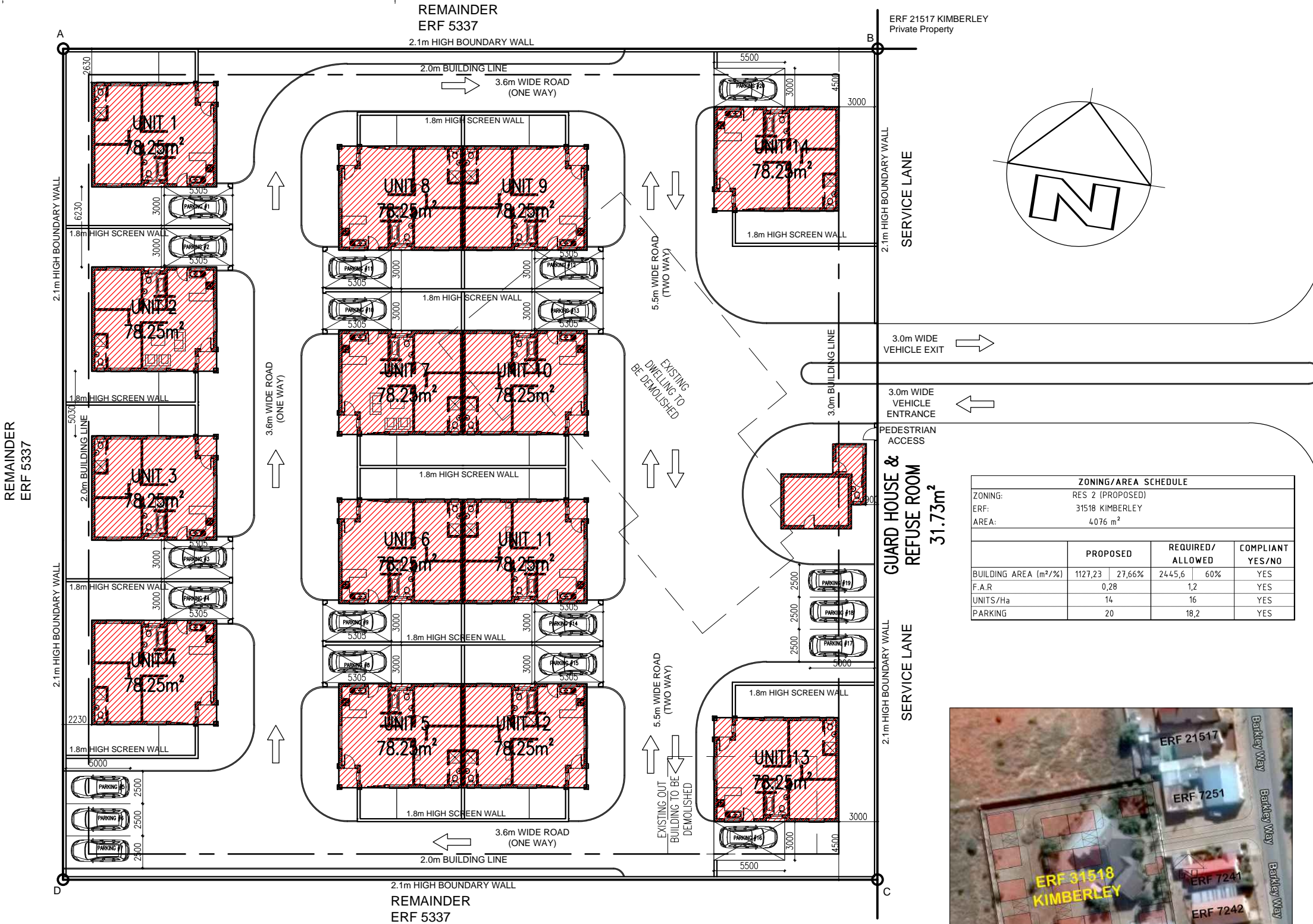

ZONING/AREA SCHEDULE					
ZONING:	RES 2 (PROPOSED)				
ERF:	31518 KIMBERLEY				
AREA:	4076 m²				
	PROPOSED	REQUIRED/ALLOWED	COMPLIANT YES/NO		
BUILDING AREA (m²/%)	1127,23 27,66%	2445,6 60%	YES		
F.A.R	0,28	1,2	YES		
UNITS/Ha	14	16	YES		
PARKING	20	18,2	YES		

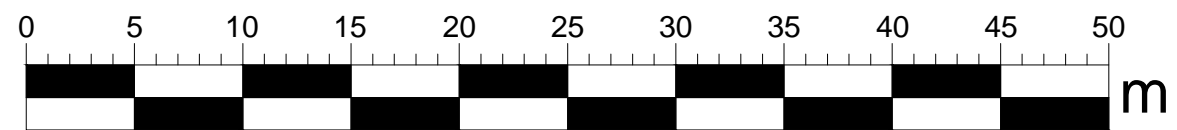

GENERAL NOTES:

1. THESE DRAWINGS ARE SUBJECT TO COPYRIGHT, NO REPRODUCTION OF ANY OF THE ELEMENTS CONTAINED HEREIN WILL BE ALLOWED WITHOUT THE WRITTEN CONSENT FROM THE DRAUGHTSPERSON/CLIENT.
2. ALL DIMENSIONS MUST BE CHECKED ON SITE PRIOR TO COMMENCEMENT OF CONSTRUCTION.
3. CONSTRUCTION AND MATERIALS MUST COMPLY WITH NBR INCLUDING ALL AMENDMENTS THEREOF AS WELL THE BY-LAWS OF THE LOCAL AUTHORITY.
4. THESE DRAWINGS ARE NOT TO BE SCALED.

SIGNATURES:

CLIENT: _____

ARCHITECT: _____

ENGINEER: _____

CLIENT: **Mr Ebrahim Ramzan**
47A Schools Lane
KIMBERLEY
0844770088

PROJECT NAME: **NEW DWELLING UNITS ON ERF 31518 KIMBERLEY**

DRAWN BY: **Rupert van Sittert**
 Cell: 0722 364 514
 Email: rupertvansittert@gmail.com

DRAWN: **RVS** CHECKED: **MJ**

DATE: **SEPT 2017** REV #: **201**

DRAWING TITLE: **SDP; ZONING/AREA SCHEDULE; LOCALITY MAP**

SCALE: **N/A** SHEET #/SHEET SIZE: **1/2**

PROJECT #: **0017/04** STATUS: **REZONING APP.**

DRAWING #: **2017-004-201-01**

SITE DEVELOPMENT PLAN - ERF 31518 KIMBERLEY

LOCALITY MAP