

LOCATION PLAN

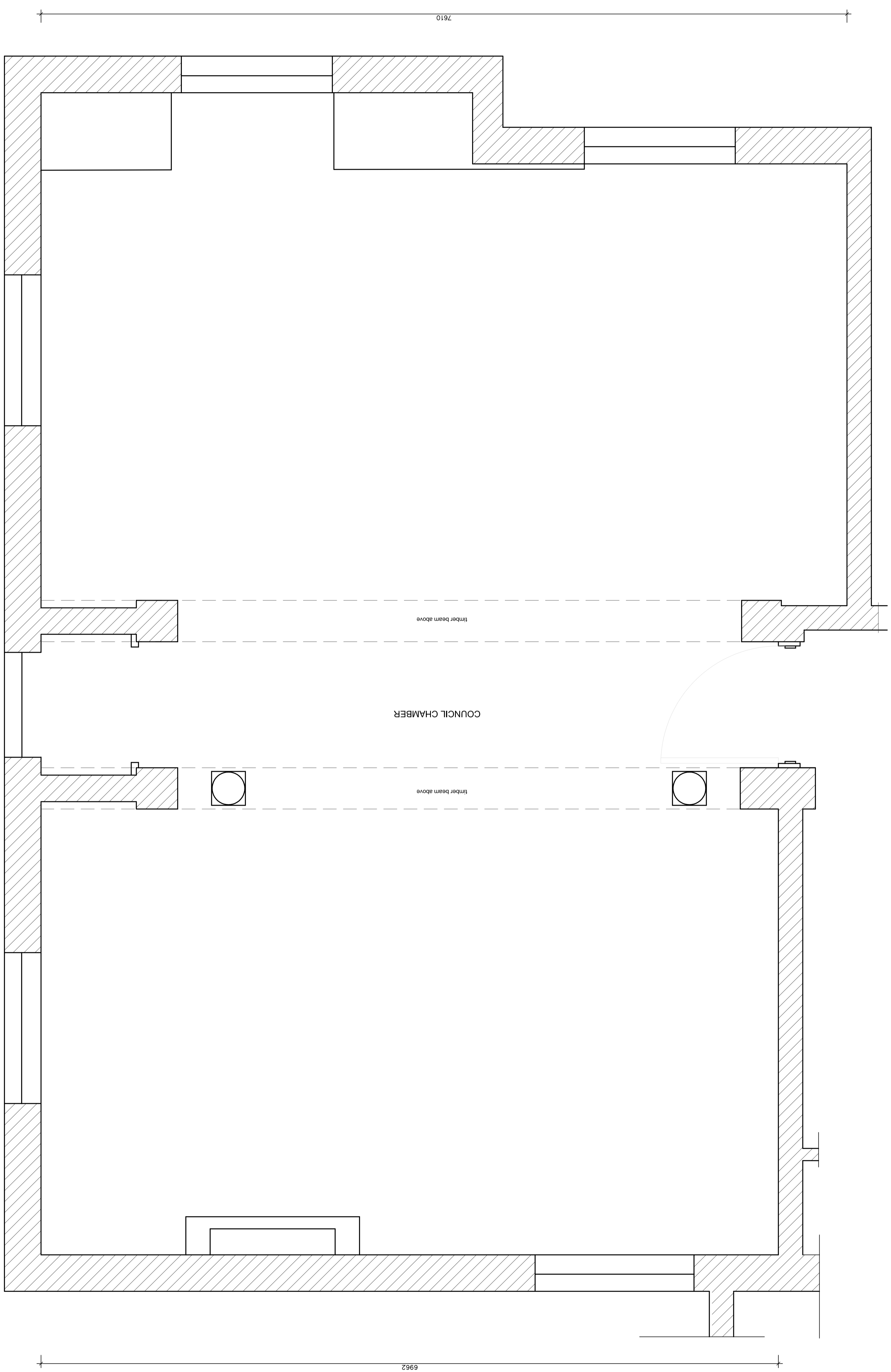

NO.	DATE	AMENDMENTS AND REVISIONS
1		AMENDMENTS BEFORE CONTRACT COMMENCED
2		REVISIONS AFTER CONTRACT HAS COMMENCED

PROVINCE OF KWA-ZULU NATAL
DEPARTMENT OF WORKS
 PRIVATE BAG X19041
 PIETERMARITZBURG
 3200

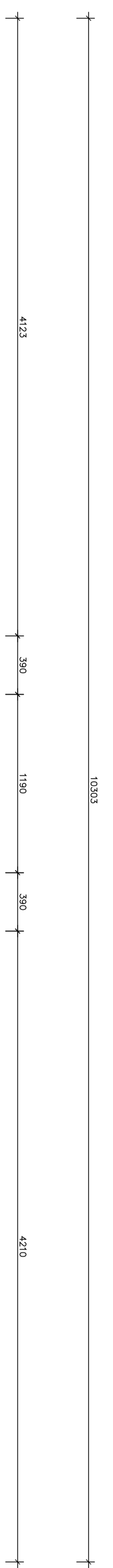

LVR architects
 9 Welby Heyward Drive
 Ashburton
 Pietermaritzburg
 3213
 Tel: (+27) 33 326 1425
 Fax: (+27) 86 670 8694
 eMail: admin@lvrarch.co.za

PROJECT
 DEPARTMENT OF PUBLIC WORKS
 KZN LEGISLATURE
 REHABILITATION & RESTORATION
 OF KZN LEGISLATURES LAW
 SOCIETY BUILDING
 WIMS 057929

DRAWING DESCRIPTION
 COUNCIL CHAMBER
 FLOOR PLAN

FORMAL NO.
057929-L01-206

SCALE	CHECKED	REV
1 : 20		
FILE NO. WIMS 057929	CLIENT	
DATE 25-01-2016	DRAWN N.M.	

COUNCIL CHAMBER FLOOR PLAN
 scale 1 : 20